

This document provides you with instructions on how to participate in Huawei's BETA projects. In the following sections, you will learn how to sign up, use, upgrade, and give any feedback or comments on issues related to Friendly User Test (FUT) activities on Huawei BETA app.

## 1 Precautions

1. It is recommended that you download, install, and upgrade the BETA app only in a secured Wi-Fi environment. (Note: We can only receive your feedback or comments when your device is connected to a Wi-Fi Network.)
2. Ensure that your device's operating system and software versions are compatible with the versions applicable for upgrade. (Note: Android Oreo updates are available for the following devices: the Mate 9, Mate 9 Pro, Honor 9, and the Honor 8 Pro. The names of individual models or devices may vary by country or region.)
3. Ensure that a local SIM card has been inserted into your device.

## 2 Operations

### 2.1 Log In

**Step 1** Connect your device to a Wi-Fi network.

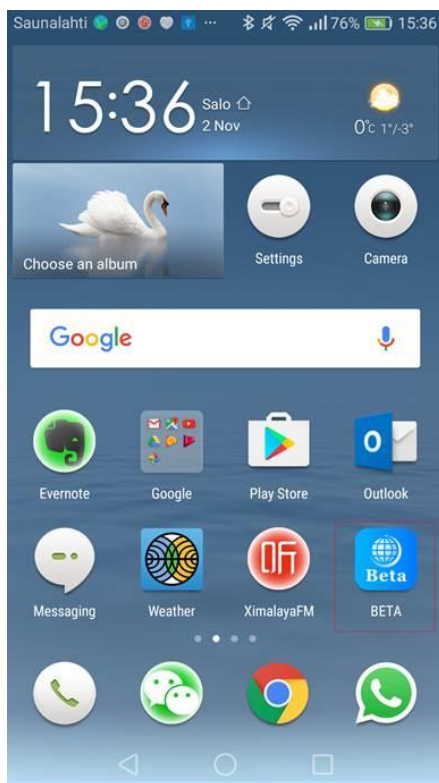

**Step 2** On your home screen, touch the logo of the BETA app to open it. Read the *BETA Terms and Conditions*, then select **Agree and Login** as shown in the following figure.



## 2.2 Join a Project

**Step 1** In your BETA app, go to **Personal** > **Join project** > **Available projects**. (Refresh the page if no projects are available.)

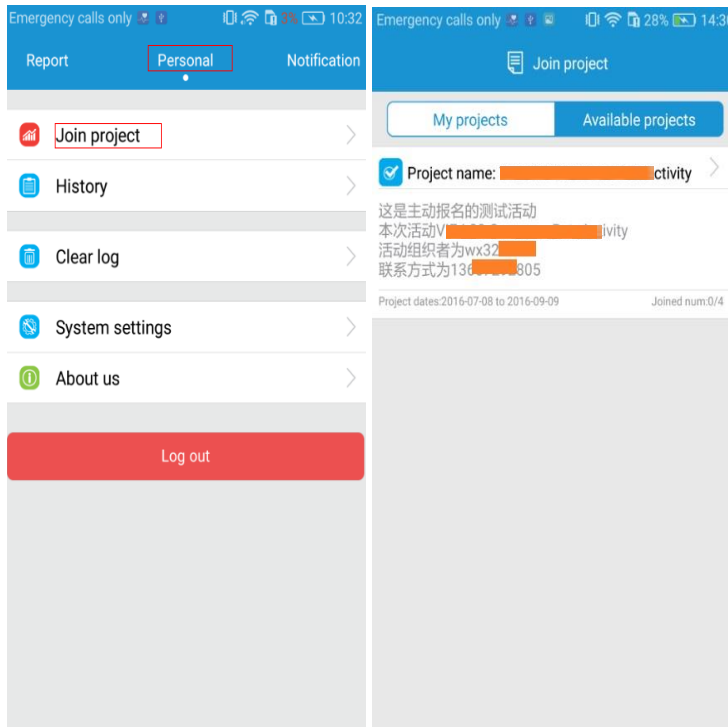

**Step 2** Select a project you are interested in and touch **Sign up**.

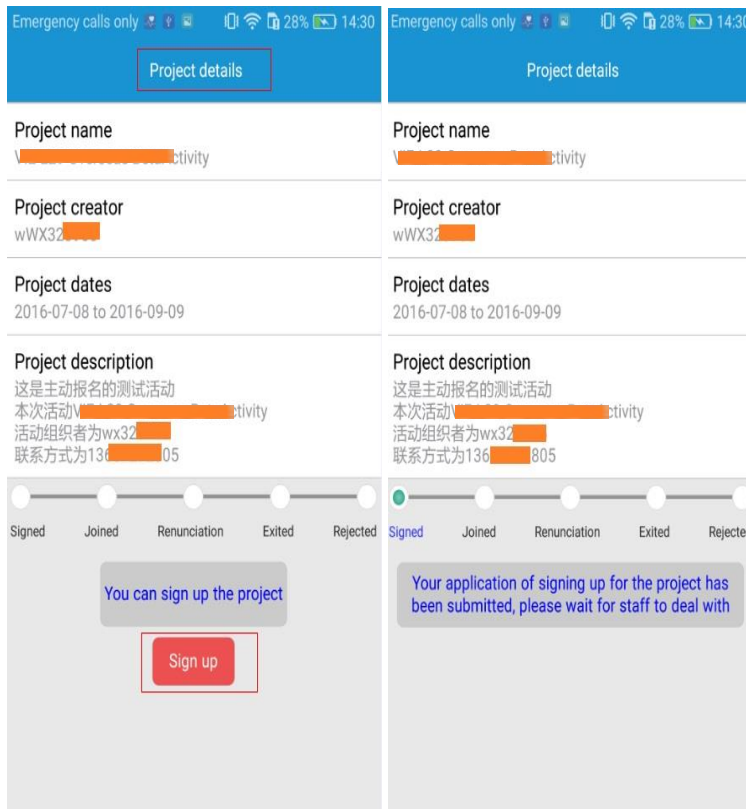

**Step 3** If you have successfully signed for the project, "You have joined the project" will be displayed in the **Project details**.

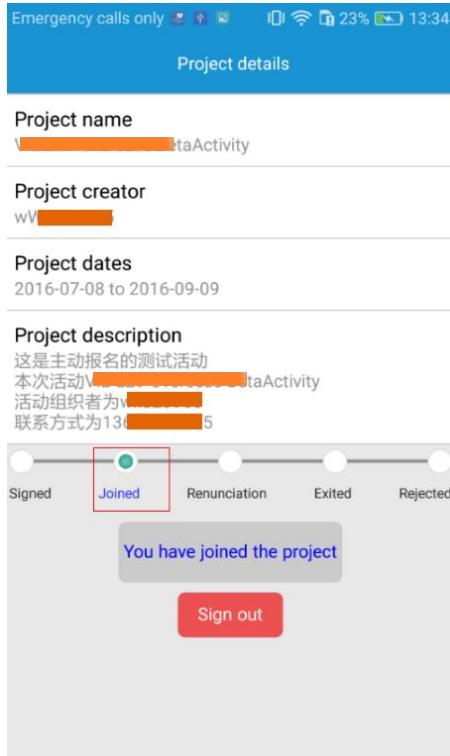

## 2.3 Feedback

To give feedback for the BETA app, touch **Report** and select the relevant topic.

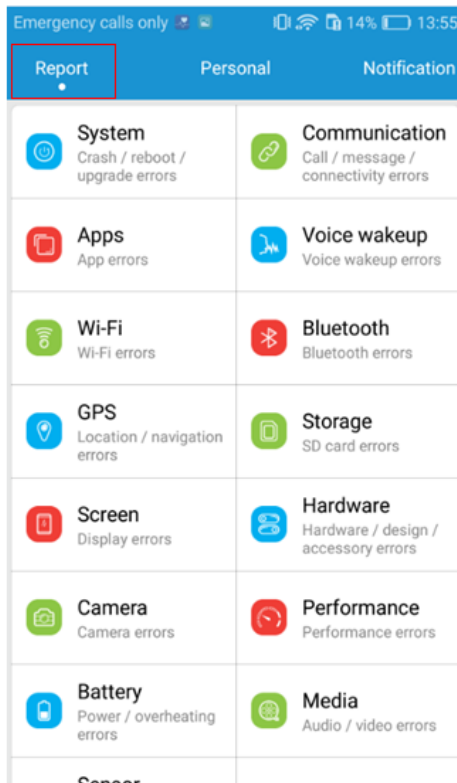

For example:

If you would like to report an issue regarding Wi-Fi, do the following:

1. **Step 1:** Touch **Report** and select **Wi-Fi**.
2. **Step 2:** Answer the ensuing questions. [Note: Questions marked with a red asterisk (\*) are mandatory.]
3. **Step 3:** If necessary, add a relevant attachment, such as a screenshot or video clip.
4. **Step 4:** Briefly describe the issue and touch **Submit**.

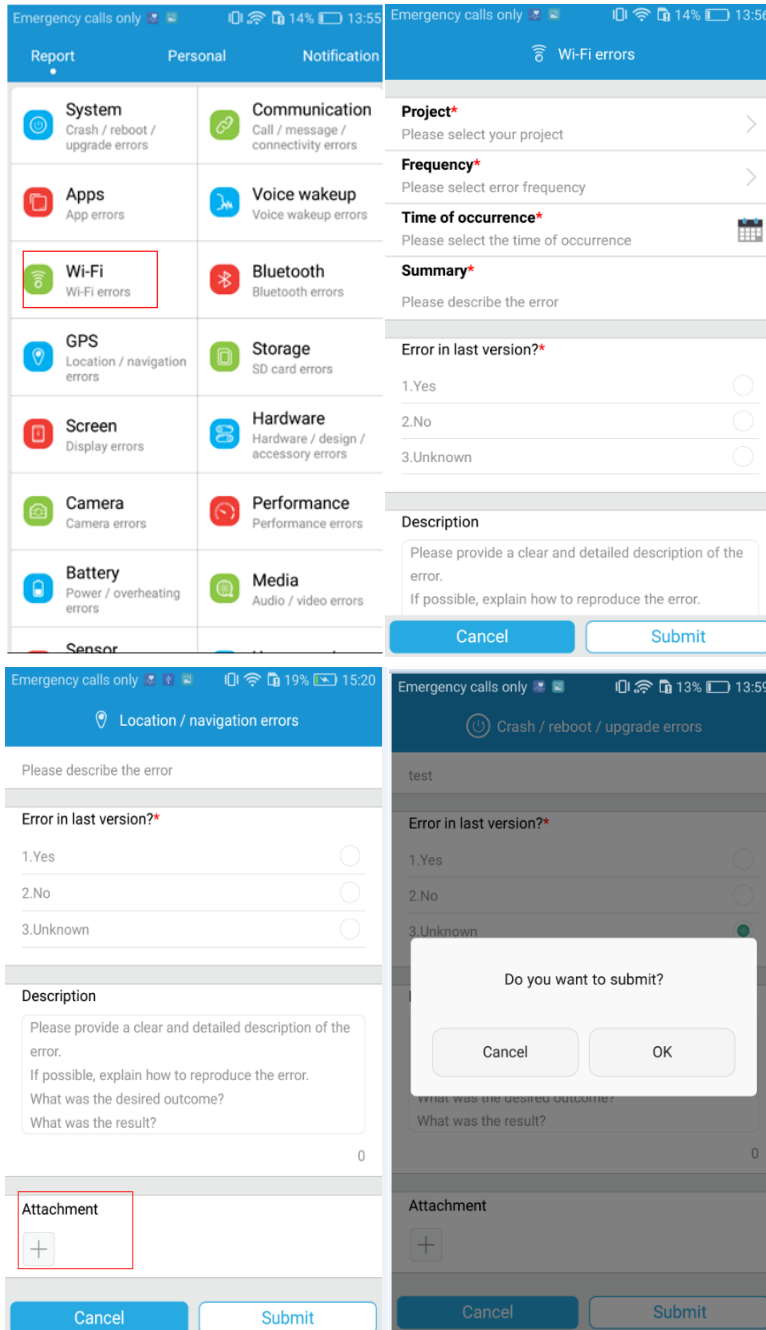

## 2.4 View and Modify a Project

After you have signed up for a project, you can view the project you have joined and then modify it. Touch **Personal** > **Join project** > **My projects**, then select the desired project, and a

list of the issues that you have submitted will be displayed. You can then touch **Modify** to make changes to this issue. (For example: Add details and attachments.)

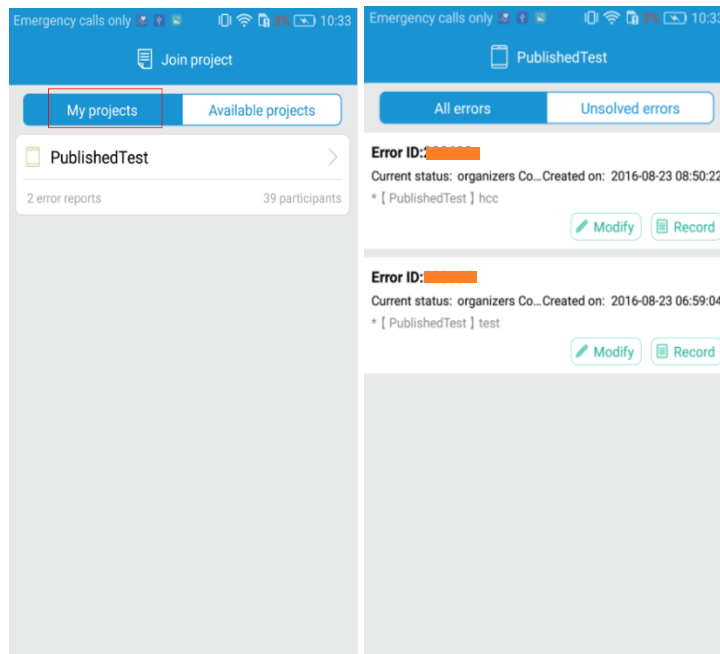

## 2.5 View and Upload Historical Records

You can also view the status of your feedback and check your case history. Go to **Personal** > **History** > **Outbox** to upload your logs. (Make sure logs have been successfully uploaded within 3 days, otherwise the upload will fail.)

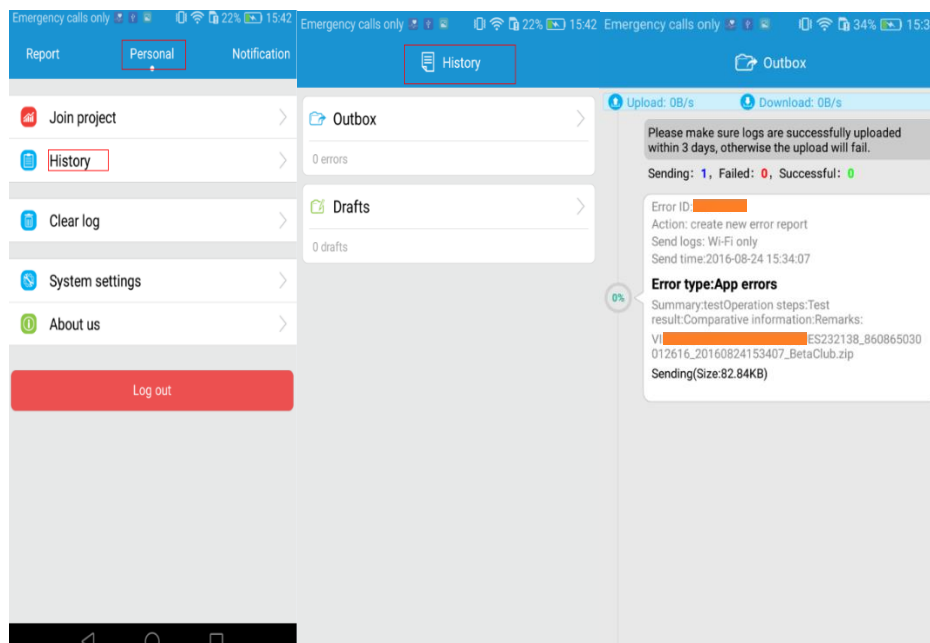

### 3 Sign Out

Touch **Personal** > **Join Project** > **Available project** > **Sign out**, and select **OK** to sign out of the project.

**Note:**

- If you have signed out from a project, you will no longer receive relevant updates or feedback issues within the BETA app.
- The new BETA app version will be more appropriate for devices that have been updated to EMUI 8.0. (*For more information, please contact our hotline personnel for assistance.*)

