

HUAWEI Y625 Smartphone FAQ



Issue 1.1
Date 2015-01-28

Huawei Technologies Co., Ltd.



Table of contents

1 Basic functions	7
1.1 Colors that the color scheme supports.....	7
1.2 Selling points of the product.....	7
1.3 Introduction to the phone keypad.....	8
1.4 Assemble the mobile phone	8
1.4.1 Open the battery cover.....	8
1.4.2 Install the UIM/SIM and microSD card	9
1.5 Introduction to the home screen.....	9
1.5.1 Quickly add/delete the home screen	9
1.5.2 Edit the home screen.....	9
1.5.3 How to move a shortcut icon	10
1.6 Contact	10
1.6.1 New contacts, establish a Caller ID.....	10
1.6.2 Contacts are imported/exported via a UIM/SIM card	14
1.6.3 How many contacts can be supported	16
1.6.4 Setting Group Contacts	16
1.7 SMS.....	17
1.7.1 How to switch the handwriting input method when editing a text.....	17
1.7.2 Delete or lock specific messages in the same session, and delete them in batches	18
1.7.3 The method for SMS forwarding/group sending and the maximum number of SMSs in group sending	19
1.7.4 The number of English words that a long SMS supports	20
1.7.5 How many SMSs can be saved in a mobile phone	20
1.8 Call functions.....	21
1.8.1 During a call, how to start three-way calling? What about switching the call?	21
1.9 MMS	22
1.9.1 Send MMS	22
1.9.2 Possible causes of failing to send / receive MMS, and the solution:	23
1.9.3 MMS is restricted by the file size / video format /resolution and other factors	24
1.9.4 Location for saving MMS attachments	24
1.10 Music	24
1.10.1 Introduction to meanings of artists, albums, songs and playlists	24
1.10.2 Add a Playlist	25

1.10.3 Introduction to Play Mode.....	26
1.10.4 Background play exit the Music, and the synchronization of lyrics	26
1.11 Camera Function.....	26
1.11.1 Can the camera function be used without an SD card?.....	26
1.11.2 The reason why some photos / video files cannot be opened	26
1.11.3 Default save path for camera files and the way to change	26
1.11.4 Editing photo / video files, and adding a frame for photos	27
1.11.5 Does it support HD video play?.....	27
1.11.6 Can camera shutter sound be set to silent?.....	27
1.11.7 How to switch between the front and rear cameras?	27
1.11.8 The format of photographs? Supported size of videotaped images?	27
1.11.9 Format of mobile phone photographs? The size of photographed images supported?	27
1.12 Streaming media	27
1.12.1 Can streaming media be played in the background during a call? Can it be automatically recovered?.....	27
1.12.2 Why the mobile phone can't play some streams?.....	27
1.12.3 Possible causes for poor results when online streaming media are playing.....	28
1.12.4 When an online video is played, playing and downloading are done simultaneously, which leads to insufficient memory on the phone.....	28
1.13 Bluetooth	28
1.13.1 Data file formats supported by Bluetooth transmission.....	28
1.13.2 How to transfer data files via Bluetooth.....	28
1.13.3 The phone cannot be searched by Bluetooth on other phones.	29
1.13.4 Effective transmission distance of Bluetooth.....	30
1.13.5 Possible reasons for failure to connect with other Bluetooth devices	30
1.13.6 Both Bluetooth and the computer are connected to the Internet, and Bluetooth has begun to transfer files	30
1.14 GPS navigation	30
1.14.1 What navigation software comes with the phone?.....	30
1.14.2 How to deal with missing navigation software data? How to deal with missing authorization documents or activation codes?.....	30
1.14.3 How to deal with the navigation software's failure to make a GPS search?	31
1.15 Does it support FM radio? How does the radio save the channels searched manually?	31
1.16 Does the phone support the downloading of themes; does it support dynamic wallpaper?.....	31
1.17 Does the phone support video calls or video chats?	32
1.18 Does it support screenshots, and what's the screenshot mode?.....	32
1.19 Does it support Flash? Is the flash software downloaded usable?.....	32
1.20 Headphone line order.....	32
1.21 Pre-set software name / version list in delivery.....	32
1.22 SD card compatibility test list	32
1.23 Summary of Basic Functions	33
2 Common settings.....	34

2.1 Email	34
2.1.1 Mailbox Setting	34
2.1.2 Does it support viewing Emails offline?	37
2.1.3 Gmail	37
2.1.4 Synchronize contacts and agenda: How to operate if synchronization becomes impossible	37
2.2 Wi-Fi setting	37
2.2.1 Connect to the Internet with Wi-Fi	37
2.2.2 What protocol of Wi-Fi does it support, and how much is the transmission rate of each protocol?	38
2.2.3 Sometimes, web pages cannot be opened via Wi-Fi connection	38
2.2.4 Unable to search for Wi-Fi signals	39
2.2.5 How to decide if it is the UIM/SIM or Wi-Fi access that is being used	39
2.2.6 Causes for Wi-Fi connection failure	39
2.2.7 Wi-Fi will automatically disconnect while in standby, how to solve it, and what is the default setting of the phone?	39
2.3 Network sharing and portable hotspots	40
2.4 Static IP for surfing via Wi-Fi.....	41
2.5 Connecting to a PC as a modem	42
2.6 Ringtone settings.....	43
2.6.1 The method to set ringtones for incoming calls.....	43
2.6.2 Incoming call/SMS vibrate setting method	43
2.6.3 How to set self-selected music as the incoming call/SMS ringtone?	44
2.6.4 How to set group ringtones	45
2.6.5 How to cancel the phone keypad tones?	46
2.7 Language and Keyboard Settings.....	47
2.7.1 What languages does it support? How to change the phone language?.....	47
2.7.2 Why can't it be used after installing other input methods?	47
2.7.3 Can the system font size be adjusted?	48
2.7.4 What input methods come with the phone?	49
2.7.5 How to switch the stroke input method?.....	49
2.7.6 How to turn off the input method vibrate	50
2.8 Internet-related settings	50
2.8.1 Clear the phone browser cache and history.....	50
2.8.2 Browser full screen and bookmark settings.....	50
2.8.3 Log in to the mailbox from web pages of the mobile phone.....	50
2.8.4 Does it support logging in to online banking?	51
2.8.5 Save pictures in the web page	51
2.8.6 Setting Modify Home Page.....	52
2.8.7 Save my favorite web pages	52
2.8.8 The phone cannot access the Internet: Method of setting network parameters	53
2.8.9 How to disable and enable mobile data	53
2.8.10 View or disconnect the current data connections.....	54

2.8.11 Does it support accessing the Internet when making a call?	54
2.8.12 What are the limitations of mobile data?	54
2.8.13 What is the function of the virtual private network VPN setting and how should it be set?	54
2.9 Screen lock setting	57
2.9.1 How to enable the PIN code to lock the screen?	57
2.9.2 How to set Face Unlock.....	59
2.9.3 How to enable the screen-unlocking pattern?	59
2.9.4 Will the phone be locked if the graphic lock is input incorrectly several times in succession? If I forget how to unlocking pattern, can I unlock them through GMAIL Email?	60
2.9.5 How to lock and unlock the screen?	60
2.10 Alarm function.....	60
2.10.1 Add /Cancel the alarm clock.	60
2.10.2 Does it support shutting down the alarm clock?	61
2.11 Applications	62
2.11.1 What formats of software does it support? Does it support JAVA?	62
2.11.2 How to obtain third-party applications?	62
2.11.3 Does it support the setting of the preferred installation location?	62
2.11.4 How to install, manage and uninstall programs?	62
2.11.5 Cause for installation failure and its solution	62
2.11.6 What software is preset on the phone? Which of them is customized by the business provider? Which of them is the software coming with the mobile phone? Can they be deleted? ..	62
2.12 Common problems with third-party applications	63
2.12.1 Third-party applications installed on the SD card may occupy the system memory of the phone.....	63
2.12.2 Causes for some phone numbers' failing to display in the place they belong to.	64
2.12.3 Online banking transactions	64
2.13 Data backup and recovery	64
2.13.1 Backup and recovery of contacts in Phone Book.....	64
2.13.2 Does it support backing up the directory of group contacts	64
2.13.3 How to use Cloud Backup – Backup and recovery	64
2.13.4 Which data does the phone support backing up?	64
2.14 Task Manager (Task Manager).....	64
2.14.1 Roles of the Task Manager	64
2.14.2 How to open the Task Manager.....	65
2.14.3 Introduction to Task Manager Interface	65
2.14.4 Related operations of the Task Manager.....	66
2.15 What are the features of cloud services?.....	66
2.16 Huawei Security Guard	67
2.17 Use Huawei's security guard blacklist.....	67
2.18 Weather Clock.....	67
2.19 Developer Options	68
2.20 Time Synchronization.....	69

2.21 Connecting to a PC to serve as a USB drive	69
2.22 Release the internal storage space of the phone	70
2.23 Adjust the screen brightness	70
2.24 Power-saving feature of the phone keypad backlight	71
2.25 Set Airplane mode	71
2.26 Restore the operation of factory settings	72
2.27 How to enter and exit the Safe Mode	72
2.28 Hi Suite	72
2.29 Support HDMI? How to use it?	73
2.30 Does it support TV-OUT? How to use it?	73
2.31 Does it support the OTG function? How to use it?	73
2.32 Status Indicator	73
2.33 Can different chargers be used at the same time?	73
2.34 Features of the new phone	74
3 Others	75
3.1 Power-saving tips	75
3.2 Tips for network traffic saving	75
3.3 How to manage it if the phone is running slow?	75
3.4 The wallpaper I set will automatically stretch, so can I set non-stretching wallpaper?	75
3.5 Enter the RECOVERY mode and restore the factory settings	76
3.6 Does it support Dimensional code?	76
3.7 Does it support 3D acceleration?	76
3.8 How to determine if the phone has been rooted by the user?	76
3.9 Does it come with a recorder?	77
3.10 Is there any film on the phone in delivery?	77
3.11 Does it support mobile TV? How to set it?	77
3.12 Does it support editing and browsing of word, excel, pot, puff?	77
3.13 How to clear the background programs of the phone?	77
3.14 How to take a screenshot	77
3.15 Does the phone support Google sync contacts?	77
3.16 Description of hot-swappable UIM/SIM phone cards	77
3.17 Which kind of card is applicable to Y625?	78
3.18 Conditions for the access to the Internet and description of the system	78

Note: A combination of pictures and texts must be made available, and for specific operations, interfaces must be provided in a combination of pictures and texts.

1 Basic functions

1.1 Colors that the color scheme supports

The phone supports two colors, white and black.

1.2 Selling points of the product

Fastest 3G network download speed up to 42 Mbps.

Comfortable hand holding and canvas finish.

Quad core high speed Processor.

Magic Touch and Motion control.

8MP rear camera with LED Flash.

Burstshot when phone locked.

Wifi Direct connection, high speed sharing.

EUI 2.3 lite.

1.3 Introduction to the phone keypad

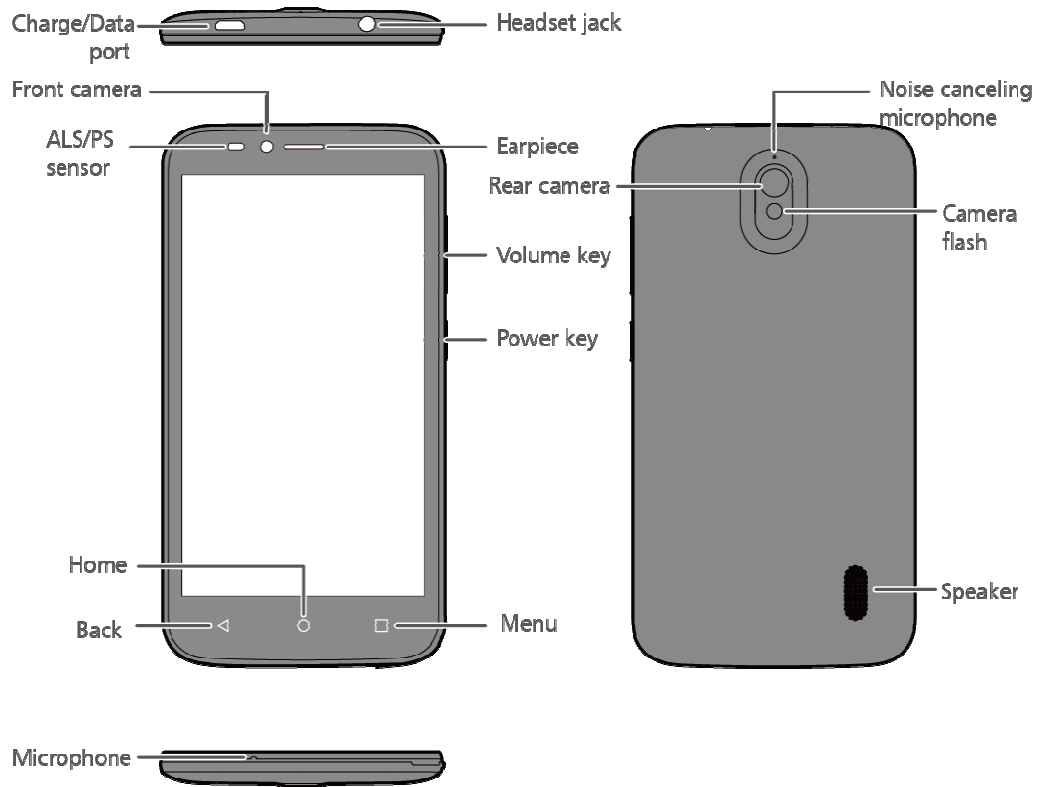

1.4 Assemble the mobile phone

1.4.1 Open the battery cover

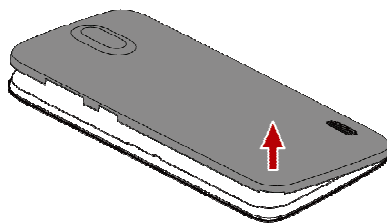

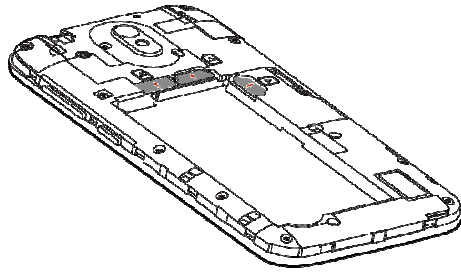

1.4.2 Install the UIM/SIM and microSD card



1.5 Introduction to the home screen

1.5.1 Quickly add/delete the home screen

On the home screen, slide with two fingers on the touch screen in two opposite directions, click  to add the home screen, and click  at the upper right corner of the screen thumbnail to delete the screen.

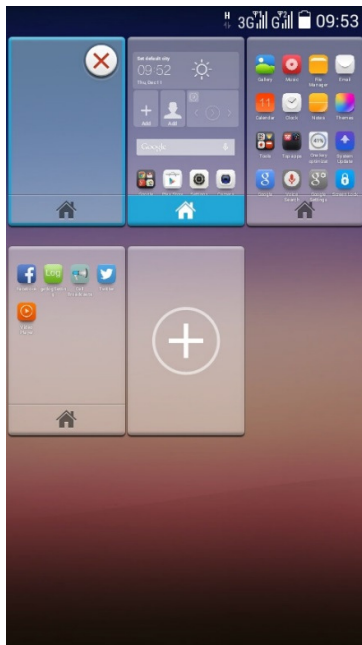

1.5.2 Edit the home screen

Hold an empty space on the desktop. The desktop settings menu will pop up. Click Edit the home screen.

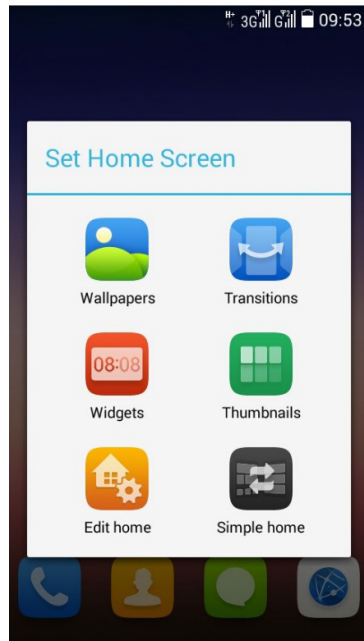

1.5.3 How to move a shortcut icon

Hold an application or a window gadget and then drag it to a space on the desktop.



1.6 Contact

1.6.1 New contacts, establish a Caller ID

1. New Contact

Open the Phone Book > Click add a contact icon at the lower right corner > Select the storage type and enter the contact editing interface > Enter the contact information > Discard/Done

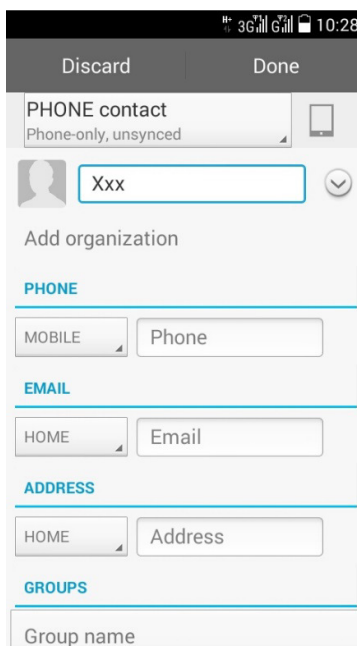
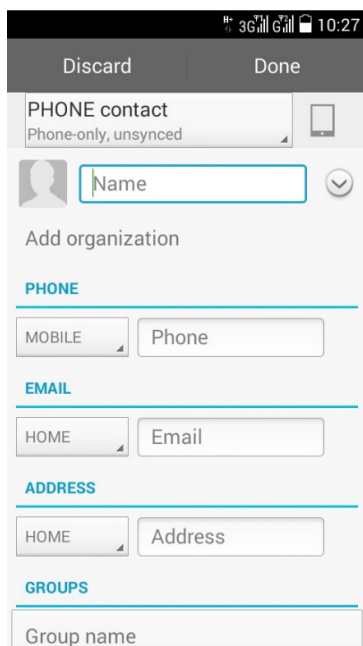
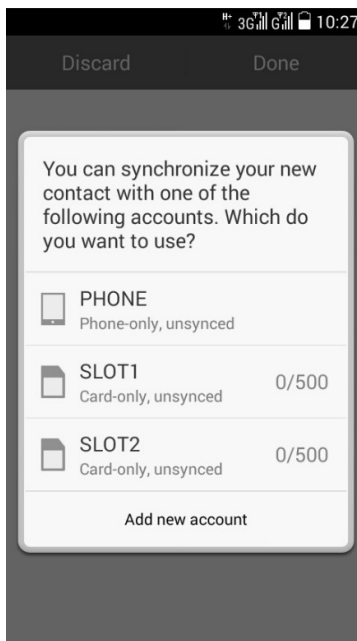
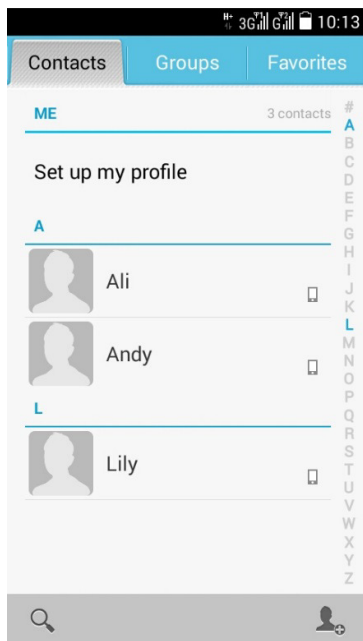

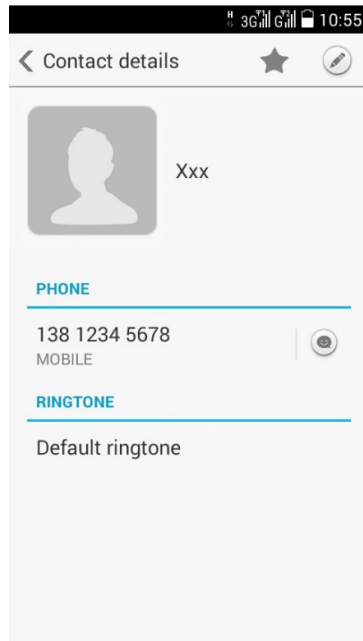

2. Establish a Caller ID

Method 1: Contact list > Open the contact details screen > Click the contact icon > Take photo or Choose photo from Gallery;

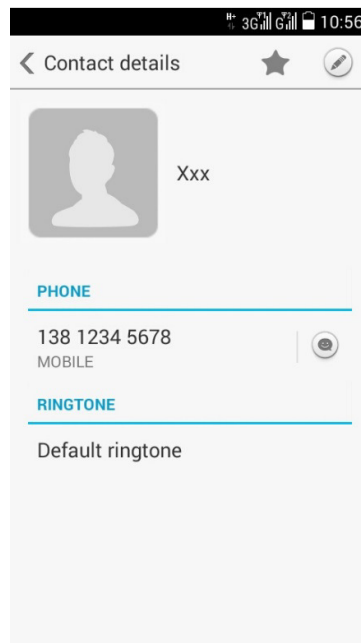
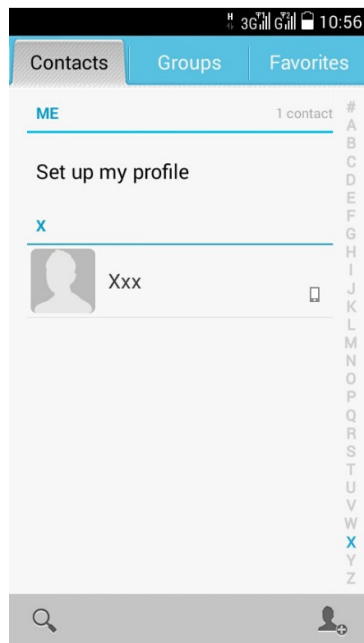

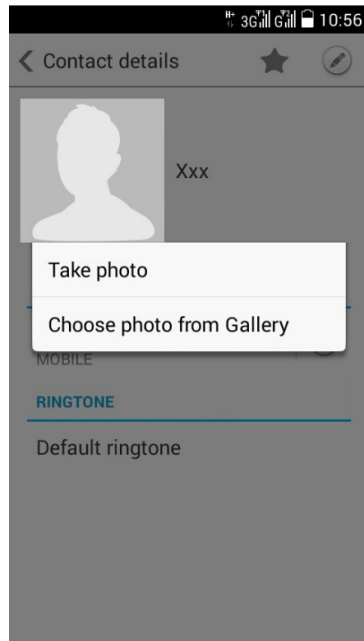

Method 2: Open the contact details interface > Click the Edit button > Enter the edit screen > Click the contact icon > Take photo or Choose photo from Gallery;

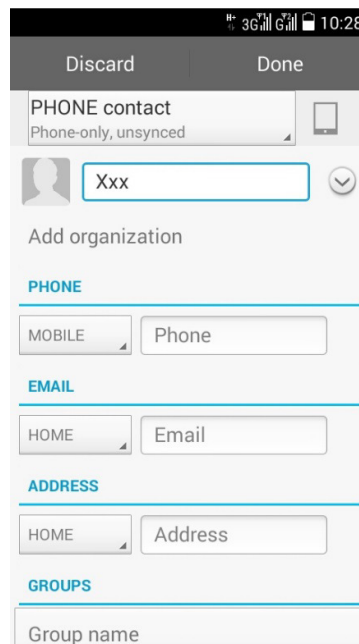
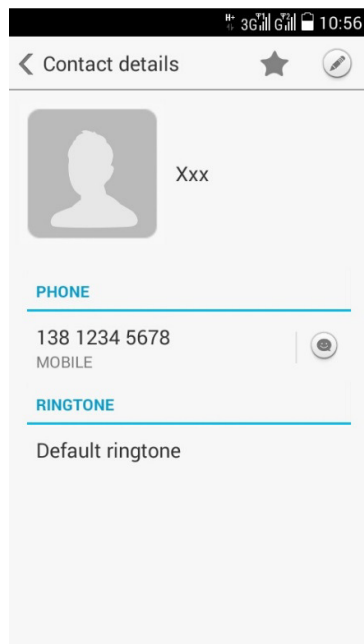

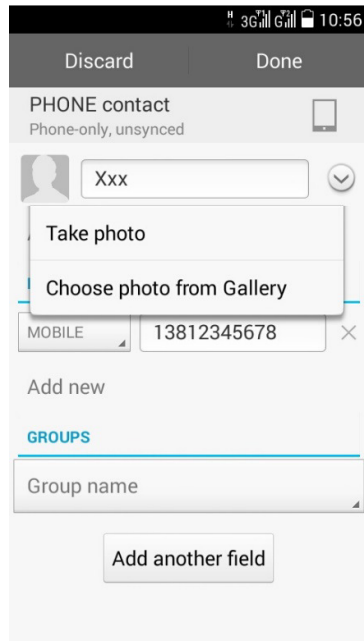

1.6.2 Contacts are imported/exported via a UIM/SIM card

1. Import contacts via a UIM/SIM card to a mobile phone

Contacts > Menu > Import/Export > Import from the UIM/SIM card > Select "Import from the UIM/SIM card" or "Import from the storage device" in the pop-up window > select the contacts in the UIM/SIM card to be imported > Click the button in the lower right corner.

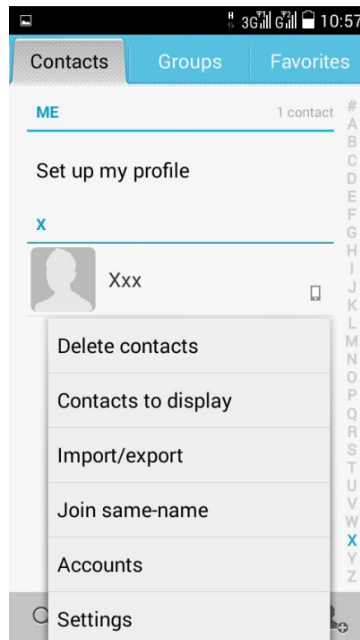
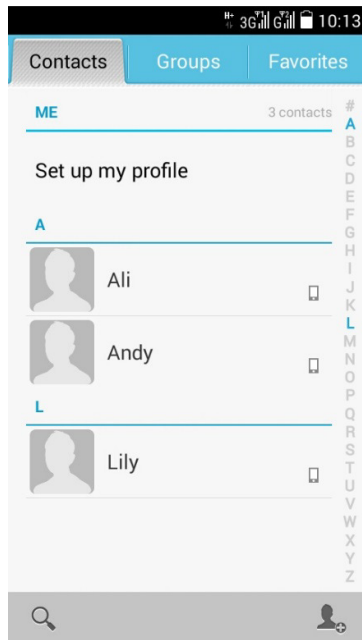

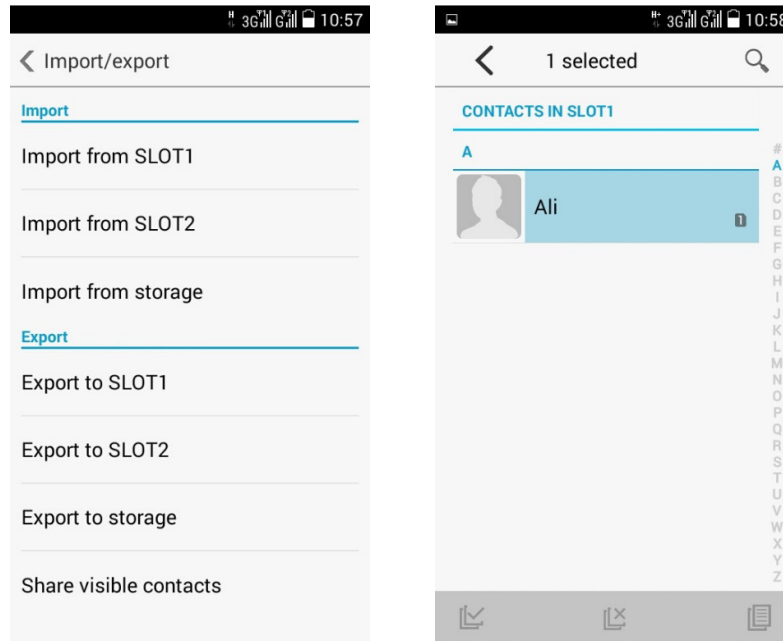

2. Export contacts in the storage card to the UIM/SIM card

Contacts > Menu > Import/Export > Export to the UIM/SIM card or Export to the storage device> Select the contacts to be exported > Click the button in the lower right corner

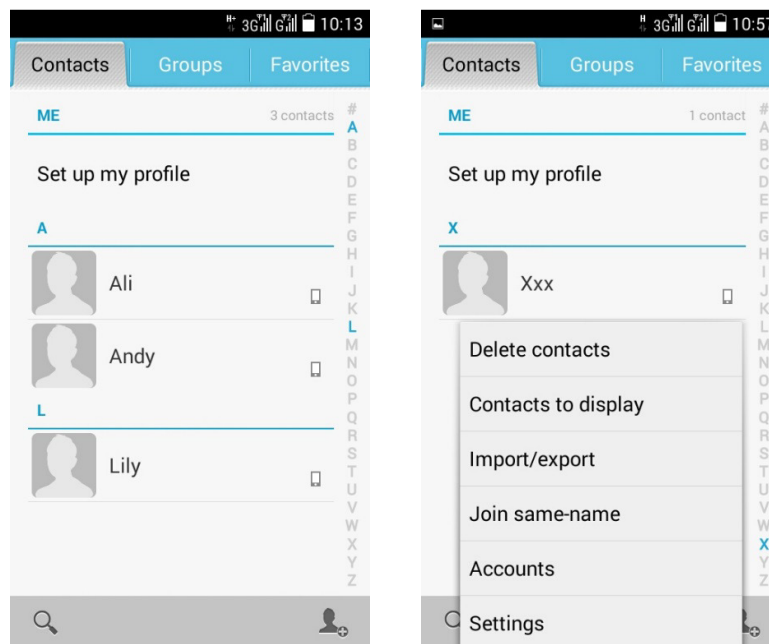

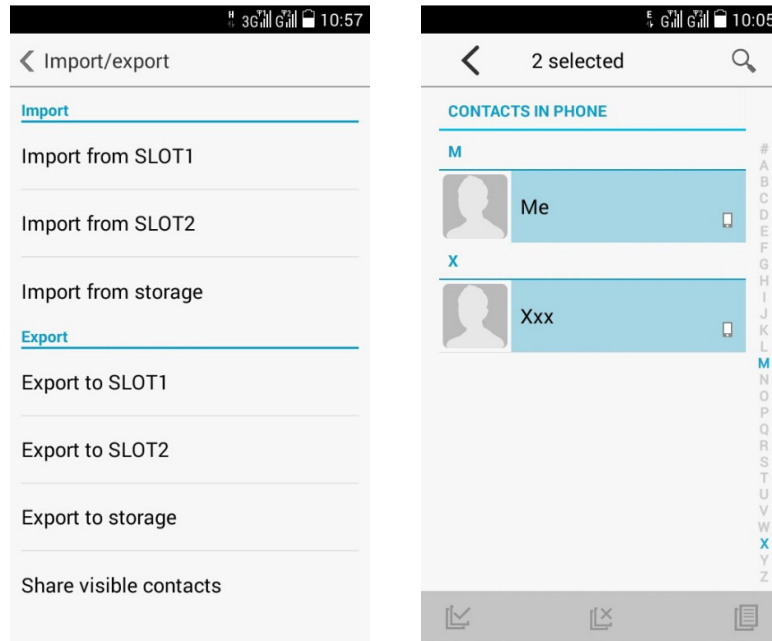

1.6.3 How many contacts can be supported

We can announce that the mobile phone can support no less than 2000 contacts, but the real numbers of the contacts depend on the remaining memory. The contacts in the UIM/SIM card are associated with the card.

1.6.4 Setting Group Contacts

Type 1: Contacts > Switch the tab page to the groups page > Select Group > Menu > Add members > Select members and click the icon in the lower right corner to add a member.

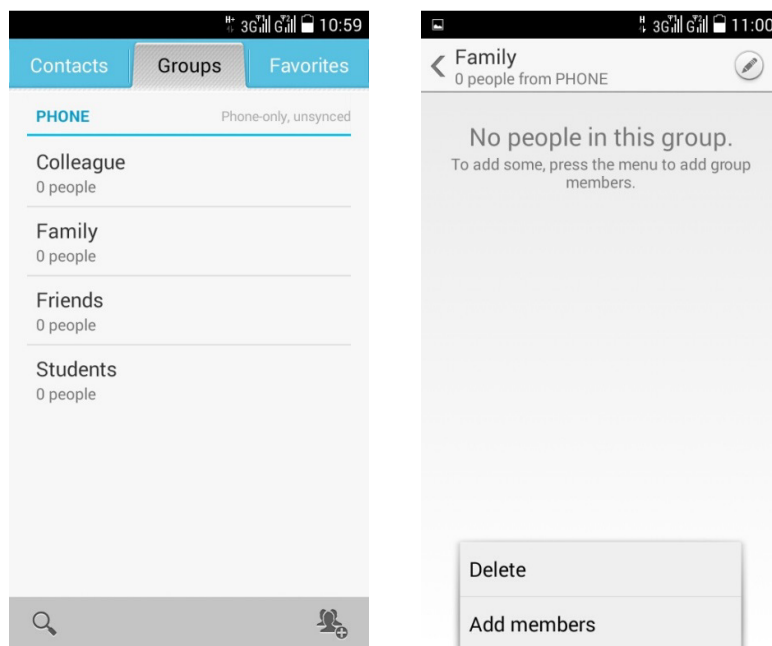

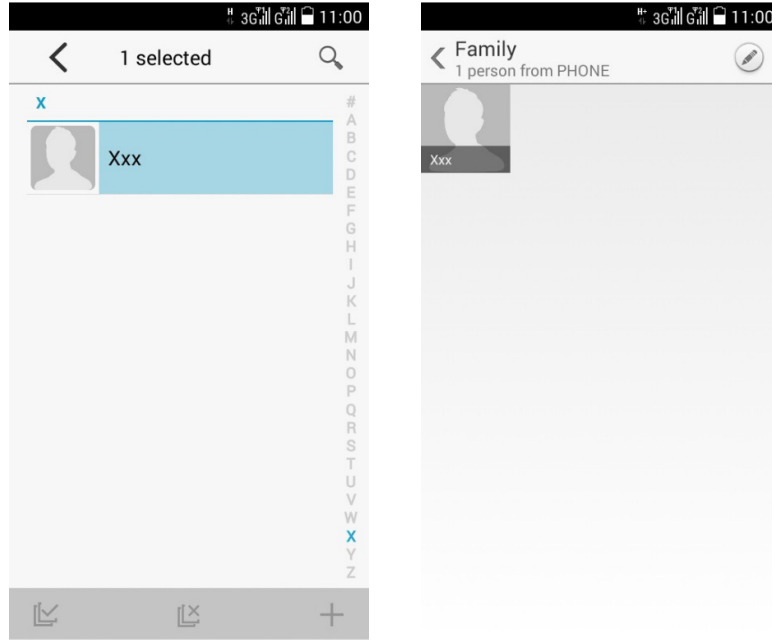

1.7 SMS

1.7.1 How to switch the handwriting input method when editing a text

Create a short message, click the input box, and a soft keyboard pops up with TouchPal by default; and then click **Languages** on the soft keyboard to choose the handwriting input method you want.

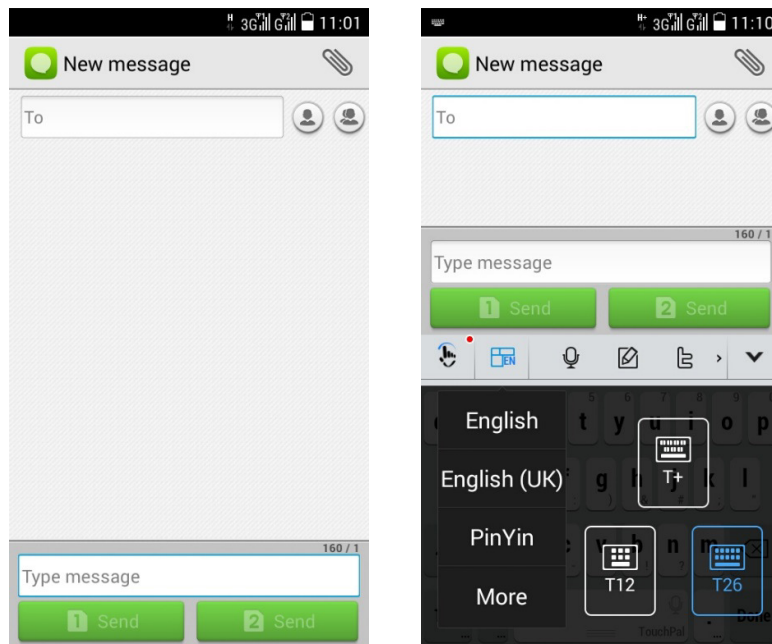

1.7.2 Delete or lock specific messages in the same session, and delete them in batches

In the message information screen, hold the text message to be locked, and select **Lock** to lock the message.

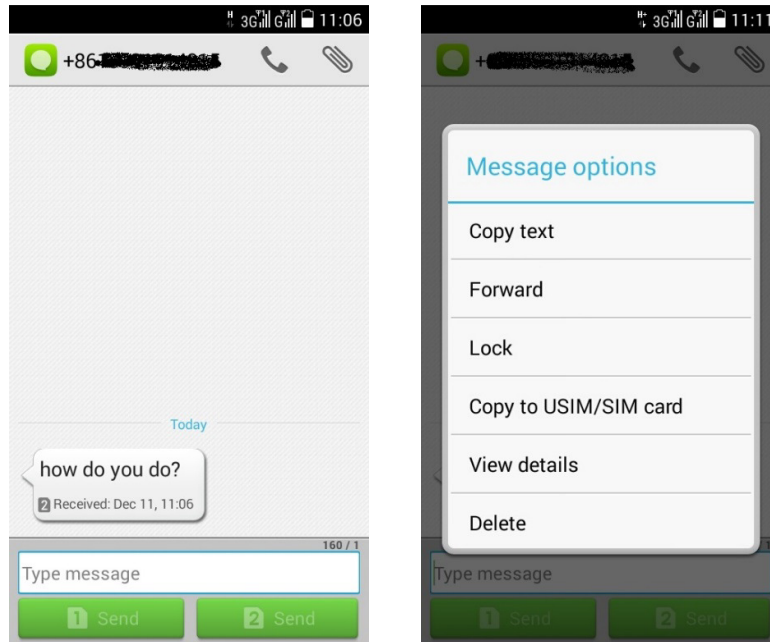



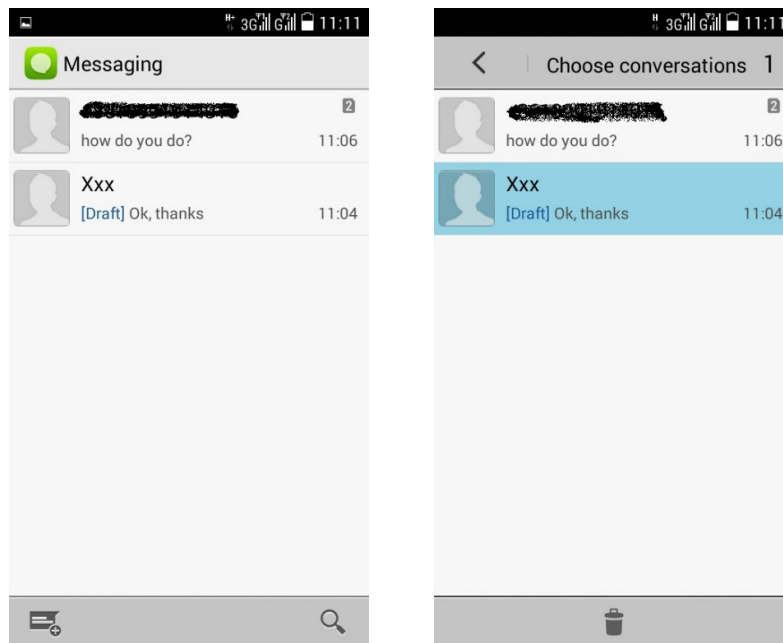

On the conversation screen, hold a conversation, select the conversation you want to delete, and press  to delete message in batches.

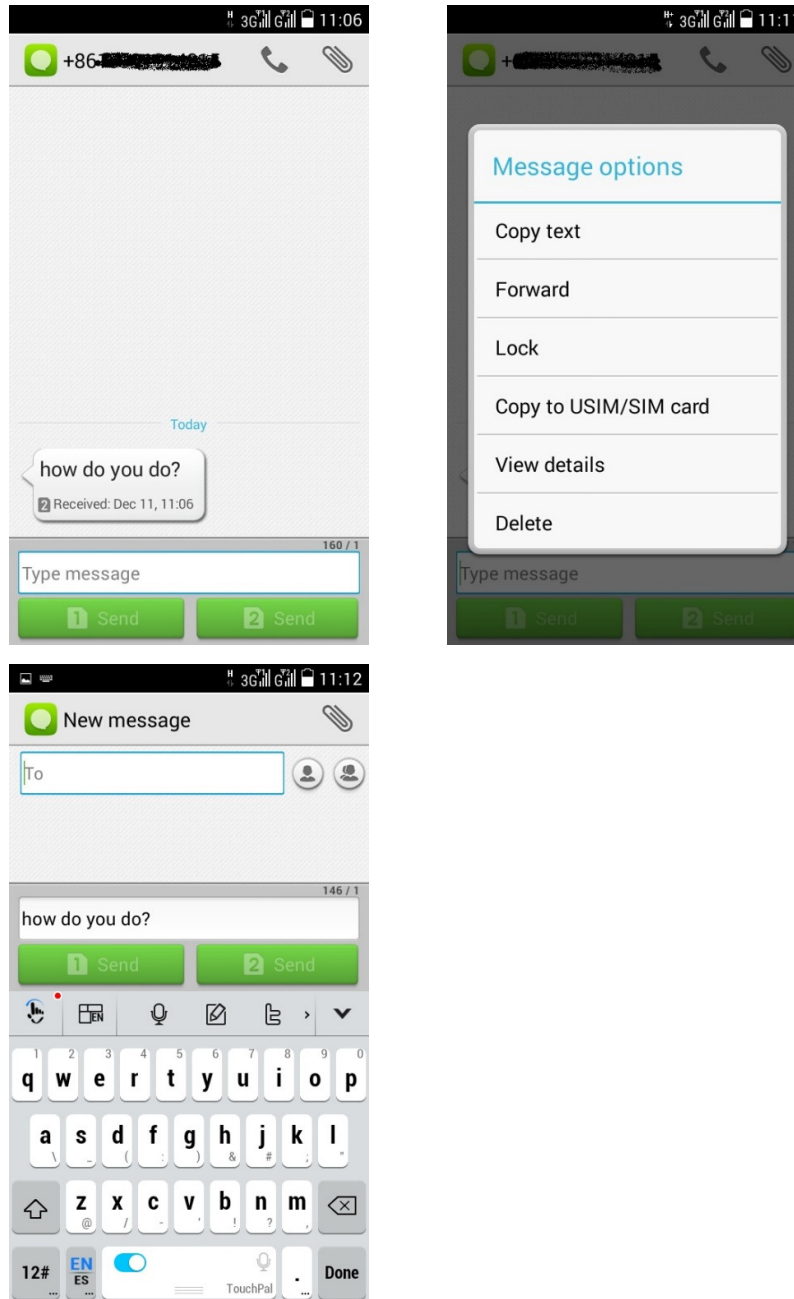

1.7.3 The method for SMS forwarding/group sending and the maximum number of SMSs in group sending

SMS forwarding: In the message information screen, hold a text message to be forwarded, select Forward, and forward it to the designated contact.



SMS group sending: Create a message, click  to enter the new information screen, click  to select the contact you want to add, click , and send the SMSs to the selected contact.

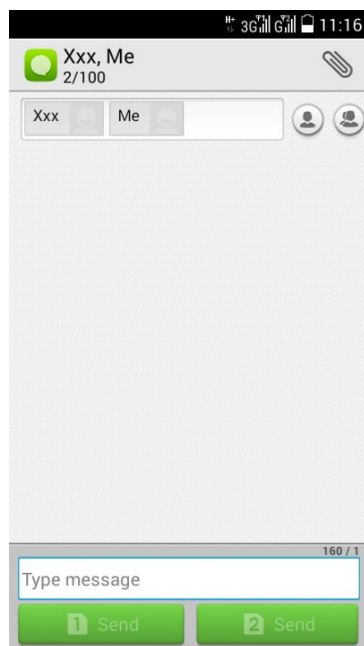
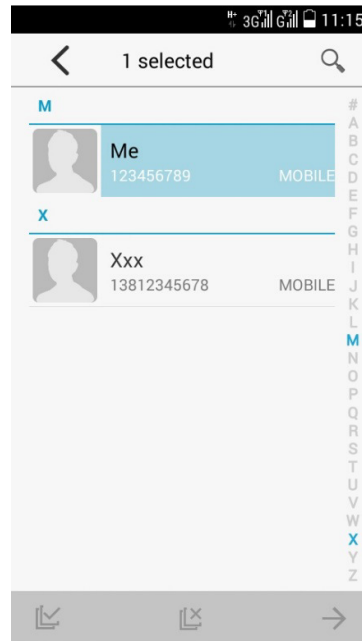
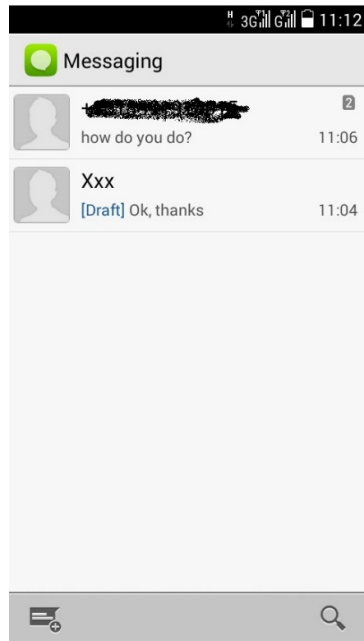

1.7.4 The number of English words that a long SMS supports

A long SMS supports up to 1530 English letters.

1.7.5 How many SMSs can be saved in a mobile phone

A conversation supports 500 SMSs or 50 MMSs (the user can modify it in the settings).

There is no limit for the total number of SMSs/MMSs in the mobile phone, which depends on the remaining storage space of the phone.

1.8 Call functions

1.8.1 During a call, how to start three-way calling? What about switching the call?

During the call, you can perform other operations at the bottom of the call interface:

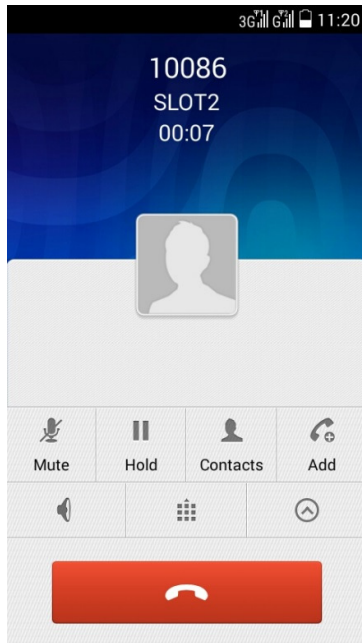

Click  to add a new call

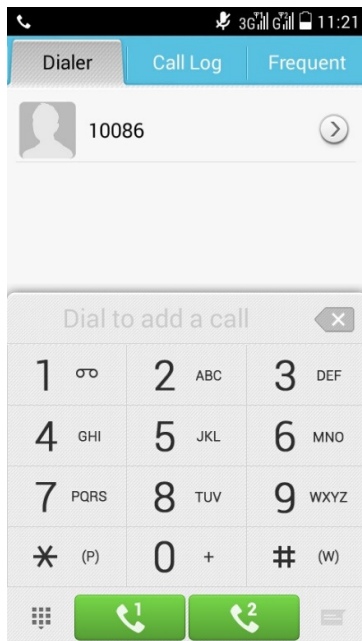

During the call, you can combine calls and keep a call on hold.

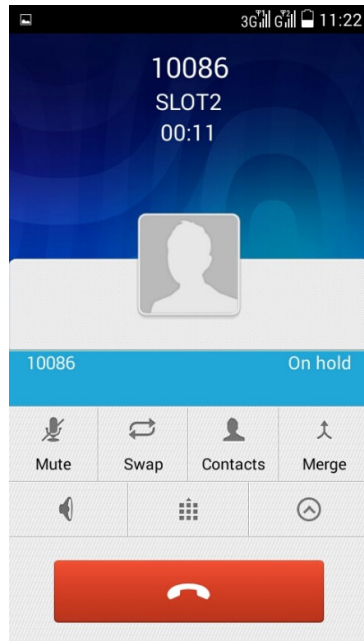

1.9 MMS

1.9.1 Send MMS

1. Enter the message menu, select **New message**, and compose a new message;
2. Input the recipient and edit the message content;
3. Press the Menu key, and then select **Add subject** (to automatically convert it into an MMS after adding a theme);
4. Click the  button on the top right corner to add an attachment. You can add pictures, audio or video (the multimedia files added are automatically converted to MMS);
5. After editing is complete, click **Send**.

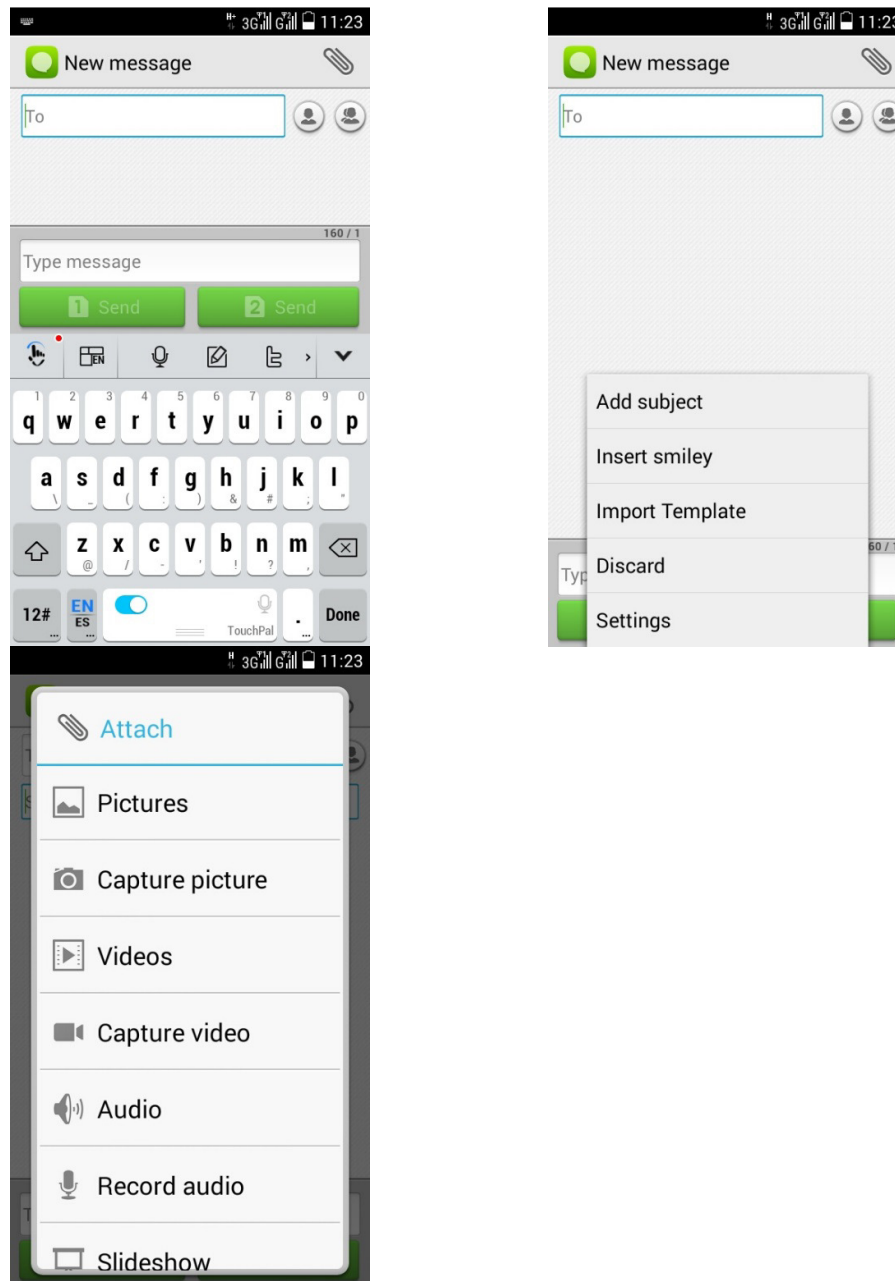

1.9.2 Possible causes of failing to send / receive MMS, and the solution:

Common saying: The network status or signal is bad, resulting in the failure to send MMS.

Solution: Try again later.

1. Being rejected on the network side (MMS Center) will lead to the failure of MMS sending.

Common saying: MMS cannot be sent due to busy network or other causes, causing the failure to send.

Solution: Try again later.

2. Being rejected on the network side (MMS Center) will lead to the failure of MMS sending.

Common saying 1: The recipient's number is incorrect, resulting in transmission failure.

Solution 1: Check whether the recipient number is correct. If wrong, please correct it before sending the MMS again.

Common saying 2: The edited MMS is over 300KB in size, causing the failure to send.

Solution 2: Delete some MMS content so that the MMS is smaller than 300KB in size, and then try it again.

3. Arrears.

Common saying: It is arrears that cause the failure to transmit.

Solution: Try it again after payment.

4. Insufficient memory will cause the failure to receive MMSs

Common saying: Insufficient phone memory.

Solution: Free the phone's memory so that the remaining space is greater than 300K

1.9.3 MMS is restricted by the file size / video format /resolution and other factors

If the video and audio files exceed the specified size (usually 300k), they cannot be added as an attachment. The picture resolution is automatically compressed if the image file is too large, and then the file is added to the MMS as an attachment. The image file received by the recipient is also a low-resolution picture.

1.9.4 Location for saving MMS attachments

After an MMS is received by the user, the MMS attachment is located in the data path, and is invisible to the user.

After the user saves the attachment, its storage location is: Download

1.10 Music

1.10.1 Introduction to meanings of artists, albums, songs and playlists

Artist: Classified by the singer, and songs belonging to the same singer are placed in a directory.

Album: Classified by the album title, and songs in the same album are placed in a directory.

Songs: Sorted by naming rules and stored in a large directory.

Playlist: You can set up a custom list to add your favorite music files to it.

1.10.2 Add a Playlist

1. On the music tab page, slide to the artist or album or song, and hold the track you want to add.
2. Select **Add to**
3. Select the playlist to be added or to create a new playlist.
4. The added track can be seen in the playlist in which it is added.

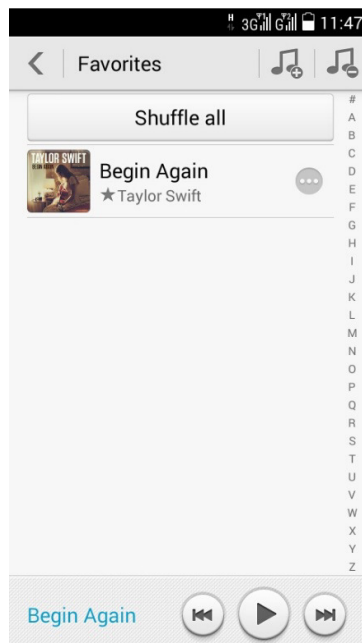
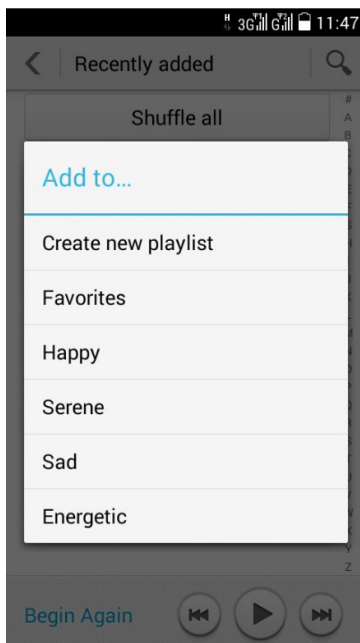
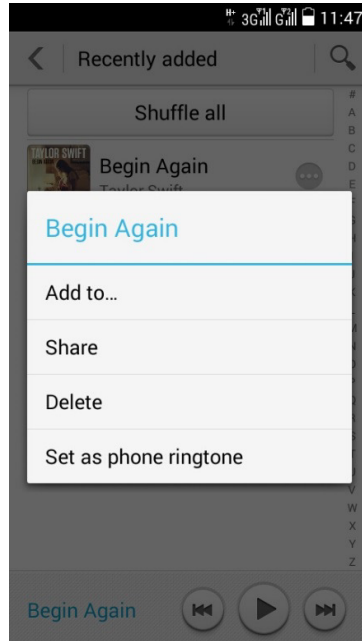
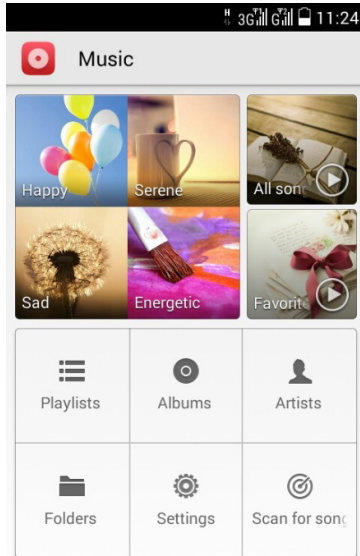

1.10.3 Introduction to Play Mode

1. Play (Default): Tracks in the Playlist are played in order from beginning to end and stop after all of them are played.
2. Random Play: Tracks in the Playlist are played randomly and then stop after each track is played.
3. Loop Playback: A track in the Playlist is played in order from beginning to end, and will be played back again from the beginning after it is played.
4. Loop Playback: The song being played is played repeatedly.
5. Play + Loop Playback of all the songs: Songs in the Playlist are played randomly and played repeatedly after completion.

1.10.4 Background play exit the Music, and the synchronization of lyrics

1. Background Play: Enter into Music + Player>Play any audio file>Press back or home key during the play.
2. Exit the Music: In the Music Playback interface, click the  button, and then press the back or home button to exit the music + application.

1.11 Camera Function

1.11.1 Can the camera function be used without an SD card?

The camera function of the phone can be used without an SD card

1.11.2 The reason why some photos / video files cannot be opened

1. The file format is not supported by the phone
2. The memory space of the phone is insufficient
3. The file is corrupted
4. The file is copy protected (files with the format of dcf)
5. If the phone resource is low, please close some opened third-party applications to consume the phone's resources
6. In rare cases where the mobile application or system has unknown errors, try restarting the phone

1.11.3 Default save path for camera files and the way to change

1. In Y625, the camera can set the priority storage location. Click  > Other > Priority storage location.

2. If no SD card is inserted, the default storage is the mobile phone's internal storage, and the storage path of the camera is File Management: Internal Storage \ DCIM \ Camera

3. When an SD card is inserted, the default storage location is the SD card, and the storage path of the camera is File Management: SD card \ DCIM \ Camera.

1.11.4 Editing photo / video files, and adding a frame for photos

1. Browsing photos: In browsing photos, press the Menu button > Select Rotate to the Left, Rotate to the Right or Edit, etc.

2. Videos cannot be edited

3. Support adding a frame.

1.11.5 Does it support HD video play?

Not supported.

1.11.6 Can camera shutter sound be set to silent?

Can't be set to silent. Click.

1.11.7 How to switch between the front and rear cameras?

Click  to switch the front and rear cameras

1.11.8 The format of photographs? Supported size of videotaped images?

MP4, 3GP 800*480

1.11.9 Format of mobile phone photographs? The size of photographed images supported?

Jpg, Max: 3264*2448

1.12 Streaming media

1.12.1 Can streaming media be played in the background during a call? Can it be automatically recovered?

1. If the streaming media is playing while you are on a call, the streaming media will automatically stop;

2. You must manually click the Play button to continue if you want to play the streaming media after hanging up the phone.

1.12.2 Why the mobile phone can't play some streams?

1. The phone does not support the file format.

The streaming media support the following audio / video encoding and file formats:

- Video encoding: MPEG4, H263, H264
- Audio encoding: AAC, AMR-NB/WB
- Supported file formats: 3gp, mp4
- Maximum encoding rate: 4Mbps

2. The network is not stable.

3. The memory of the phone is not sufficient.

1.12.3 Possible causes for poor results when online streaming media are playing

- 1.The effect of the source file itself is bad.
- 2.The network is not good.
- 3.The phone hardware has problems, such as damage to the display. Compare it with local video.
- 4.The phone's memory does not have enough space.
- 5.The phone's CPU is in high occupation.
- 6.There are too many programs running.

1.12.4 When an online video is played, playing and downloading are done simultaneously, which leads to insufficient memory on the phone.

A file downloaded when streaming media are played occupies RAM instead of mobile storage space, so it will not lead to insufficient phone memory.

1.13 Bluetooth

1.13.1 Data file formats supported by Bluetooth transmission

Images, audio, video, web pages, contacts and other commonly used data can be sent via Bluetooth.

1.13.2 How to transfer data files via Bluetooth

Enter into the music player or gallery and select any file you want to send, click in the right corner, and select **Share > Bluetooth** in the pop-up menu to transfer files.

Open your browser and enter into any page, press  > **to Share page > Bluetooth**.

Enter into the phone book, press **the Menu button** and a menu pops up, choose **to share the contacts displayed**, select the contacts **to be shared**, and click  > **Bluetooth**.

1.13.3 The phone cannot be searched by Bluetooth on other phones.

1. Bluetooth is not enabled.

Solution: On the home screen, click **Settings > Bluetooth**.

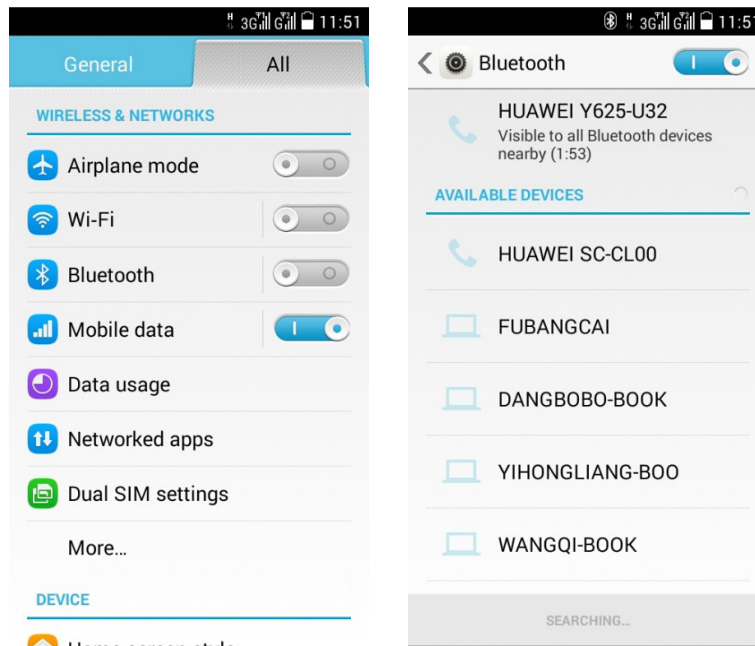

2. Bluetooth is on the invisible state after being enabled.

Solution: On the home screen, click **Settings > Bluetooth**, and click the first entry.

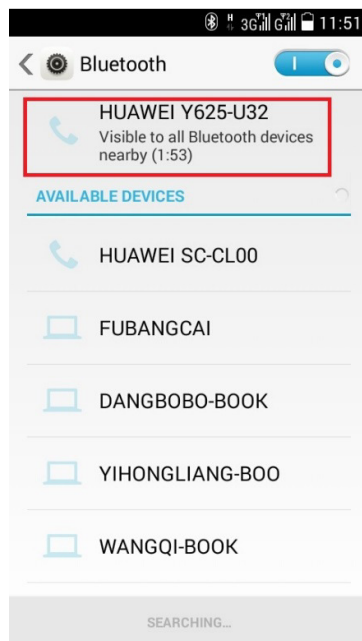

1.13.4 Effective transmission distance of Bluetooth

<10 m.

1.13.5 Possible reasons for failure to connect with other Bluetooth devices

The phone is able to support A2DP, AVRCP, HSP, OPP, HFP, PBAP, HID and other profiles; if it is confirmed that the connecting device also supports these profiles but still cannot be connected, please refer to the following situations:

1.Unable to search for other phones

Solution: The Bluetooth of other phones is turned on, and is ready to be searched.

2.Unable to search for a Bluetooth headset

Solution: Make sure the headset is ready to be searched for. For related settings, please refer to the instruction manual of the headset.

3.Unable to be connected with other phones when sending files

Solution: Make sure that the other phones support receiving files, or support receiving that type of file.

1.13.6 Both Bluetooth and the computer are connected to the Internet, and Bluetooth has begun to transfer files

Dial-up Internet access via Bluetooth is not supported.

File transfer between Bluetooth and PC requires Bluetooth or a Bluetooth adapter on the PC, and only pictures can be transferred.

The phone supports Bluetooth games. This feature is more dependent upon the design of third-party applications. The general steps are as follows:

- 1.Select to search for other Bluetooth devices in the game;
- 2.Find a Bluetooth device you connect, and preset the pairing;
- 3.Start the game;

1.14 GPS navigation

1.14.1 What navigation software comes with the phone?

Google Maps

1.14.2 How to deal with missing navigation software data? How to deal with missing authorization documents or activation codes?

- 1.If you are using the online map, make sure that mobile data or Wi-Fi is enabled.

2.If you are using offline maps, please confirm whether the offline map pack is lost. You can re-download the offline maps or enable the mobile data or Wi-Fi to use the online map.



The pre-set navigation software in the phone has no authorization file activation code.

1.14.3 How to deal with the navigation software's failure to make a GPS search?

- 1.If you are in the room, please go outdoors to use GPS search because the GPS cannot locate indoors.
- 2.If you are outdoors, check if there are any tall buildings and other shelters around, which will cause satellite signals to be unable to be received. Please try to choose an open place where the GPS search is possible.

1.15 Does it support FM radio? How does the radio save the channels searched manually?

It support FM radio, but you need to plug in your headphones before turning on the radio.

FM radio interface, click  and  to adjust the frequency, hold  under the screen to add the current channel.

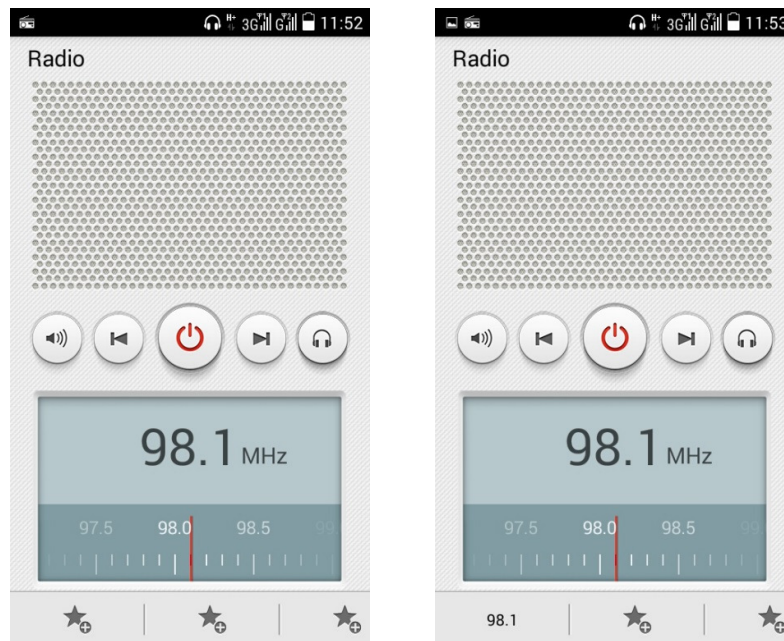

1.16 Does the phone support the downloading of themes; does it support dynamic wallpaper?

It dosen't support the downloading of themes and dynamic wallpaper.

1.17 Does the phone support video calls or video chats?

The phone does not support video calls;

1.18 Does it support screenshots, and what's the screenshot mode?

Mode 1: In the non-standby status, enter the interface to be screenshot, while holding down the volume “-” key and the power button for 2 seconds to make a screenshot.

Mode 2: On the home screen, pull down the status bar and click Screenshot to make screenshots.

1.19 Does it support Flash? Is the flash software downloaded usable?

The phone has no pre-set flash.

Video sites needing flash support generally provide a flash download service; besides, users can download it from the play store.

1.20 Headphone line order

In the standard configuration, the phone has no earphone.

1.21 Pre-set software name / version list in delivery

A list of pre-listed software, version number

1.22 SD card compatibility test list

A detailed list is required



Y625U project
memory card com

1.23 Summary of Basic Functions



Y625U Main
summary produc

2 Common settings

2.1 Email

2.1.1 Mailbox Setting

1.Adding Email Accounts

Enter the home menu > **Email**. The login account consists of manual setting and auto setting.

- Manual setup:

2.Account Settings interface > Enter the account number and password.

3.Click Manual setup.

4.Click POP3 to enter the incoming server-setting interface.

5.Click Next to enter the outgoing server-setting interface.

6.Click Next to enter the Email reception-setting screen, and select the Inbox check frequency.

7.Click Next to enter the Email interface and create a name and your name for the account.

8.Click Next to complete the login and enter the Inbox interface.

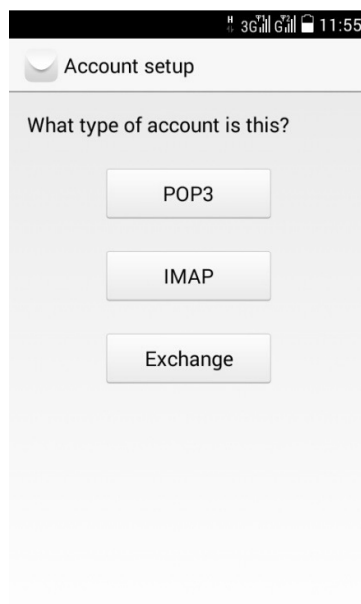
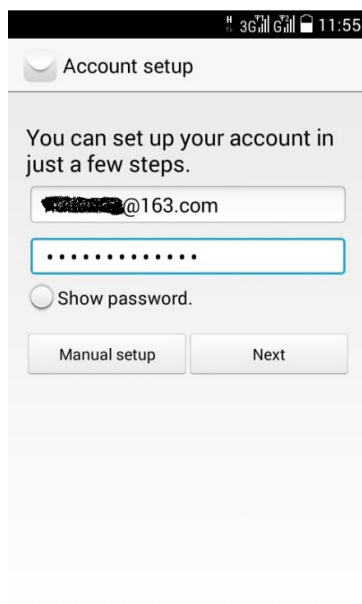

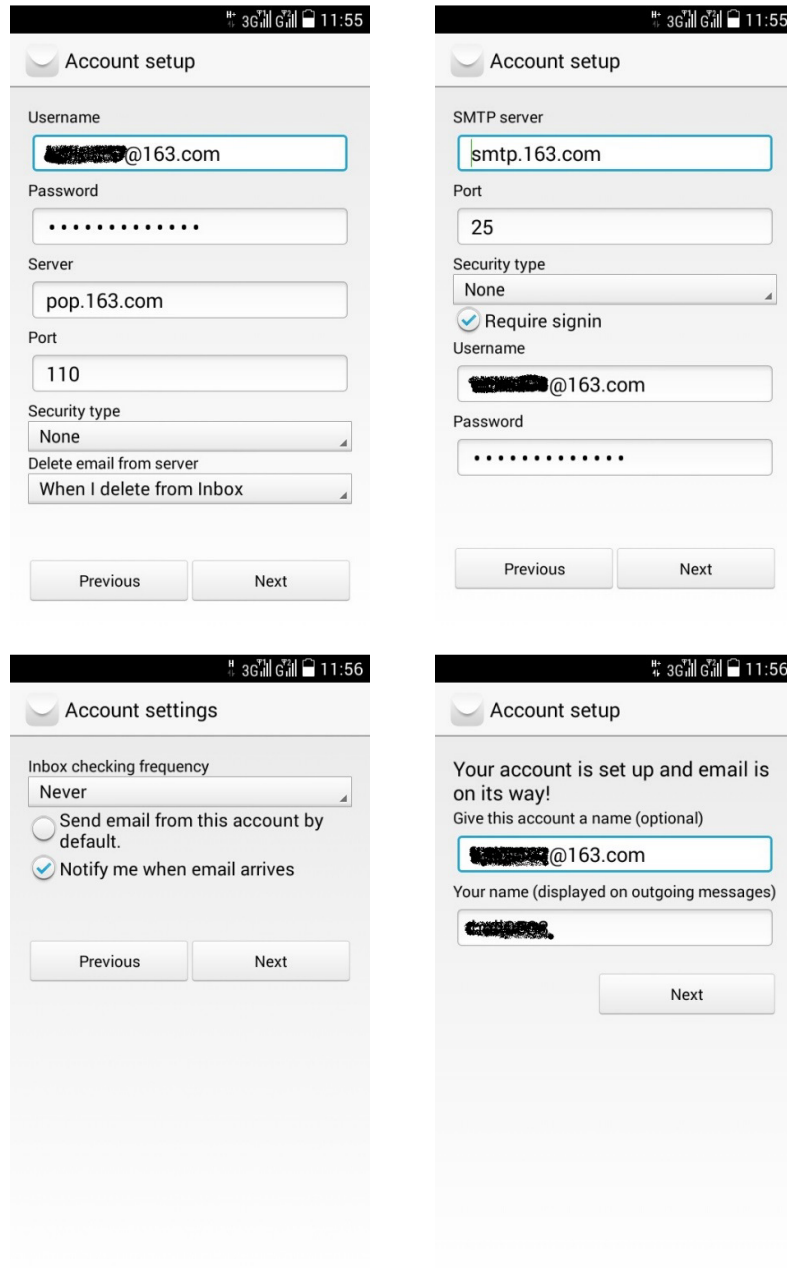

The screenshots illustrate the following steps in the email setup process:

- Account setup (Initial):** Fields for Username, Password, Server, Port, Security type, and Delete email from server.
- Account setup (SMTP):** Fields for SMTP server, Port, Security type, and Require signin.
- Account settings:** Options for Inbox checking frequency and Notify me when email arrives.
- Account setup (Confirmation):** Confirmation message and fields for Give this account a name and Your name.

- Auto Setting (Auto Setting requires parameters of the Email of this type to be set in the phone):

1. Account Settings interface > Input the account number and password.
2. Click Next.
3. Click Next to enter the Email reception-setting screen, and select the Inbox check frequency.
4. Click Next to enter the Email interface and create a name and your name for the account.
5. Click Next to complete the login and enter the inbox interface.

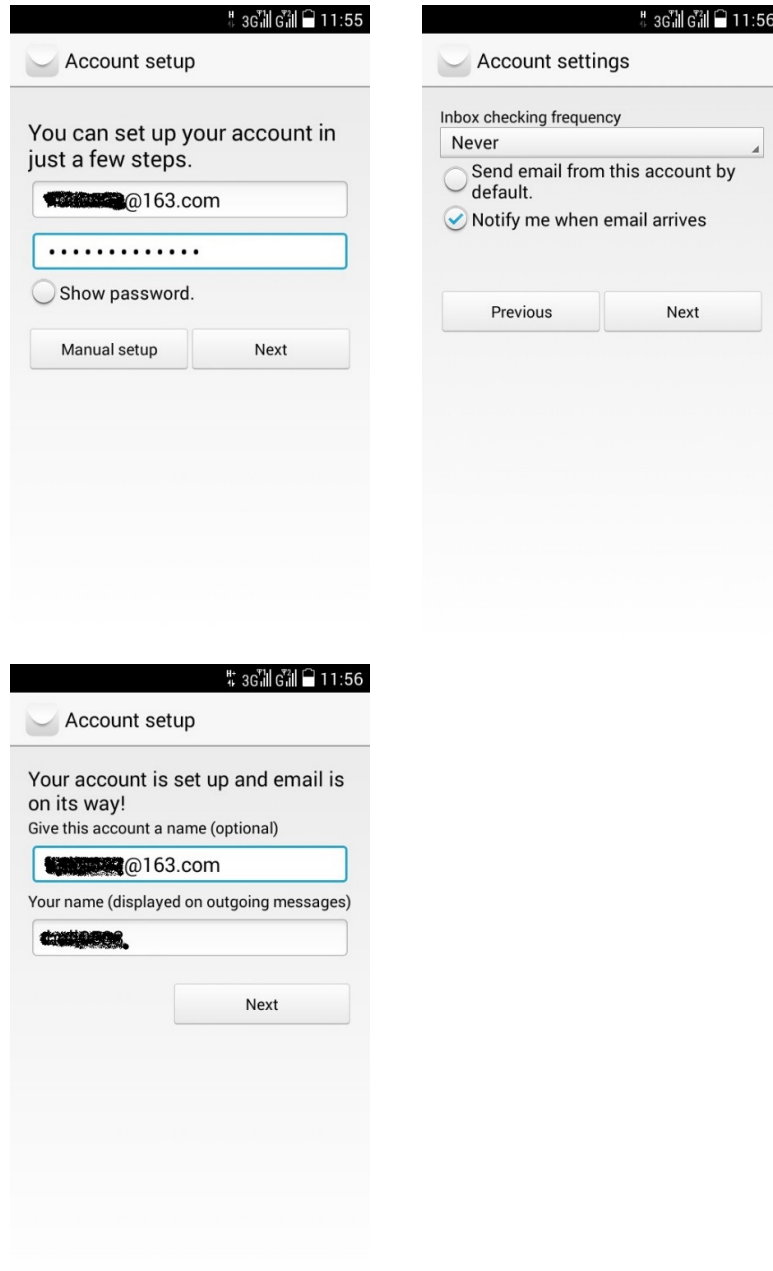

For non-preset Email accounts and the setting of the login process, users can log in to the Email service provider's website to search.

6. Sending Emails

In the Inbox screen, click  to enter the Write Email interface, edit the **Recipient**, **Subject**, **Content**, and then click **Send Email**.

7. View and delete Email

In the Inbox interface, click mail to view the message; Click  to delete the message.

8.Delete Email Account

Enter Email, click  > **Settings**, click the account you want to delete, and slide to the bottom to select Delete account.

2.1.2 Does it support viewing Emails offline?

It supports the offline viewing of Emails already downloaded.

2.1.3 Gmail

Enter the account-setting interface, and input the Email address and password, and click **Next** to complete the login automatically.

2.1.4 Synchronize contacts and agenda: How to operate if synchronization becomes impossible

Synchronization of contacts requires logging in to at least one Exchange account.

In the account-setting interface, select **Exchange**, check the configuration of the mailbox server from the Email service provider's website, and after the configuration is completed, the login is successful.

Enter the home menu, select **Settings > Synchronization options > check Synchronize this folder**, select the option of **Synchronize emails for how many recent days**.

If contact synchronization fails, please check the phone's data connection that is turned on and the Mailbox server that supports contact synchronization.

2.2 Wi-Fi setting

2.2.1 Connect to the Internet with Wi-Fi

1. On the home screen, click **Settings > Wi-Fi**.
2. If the Wi-Fi switch is turned off, drag the button to turn it on;
3. If it is turned on, the phone will automatically scan for available hotspots nearby. Click the hotspots to be connected, enter the correct password in the dialog box that appears, click Connect; after a successful connection to the hotspots, you can access the Internet via Wi-Fi.

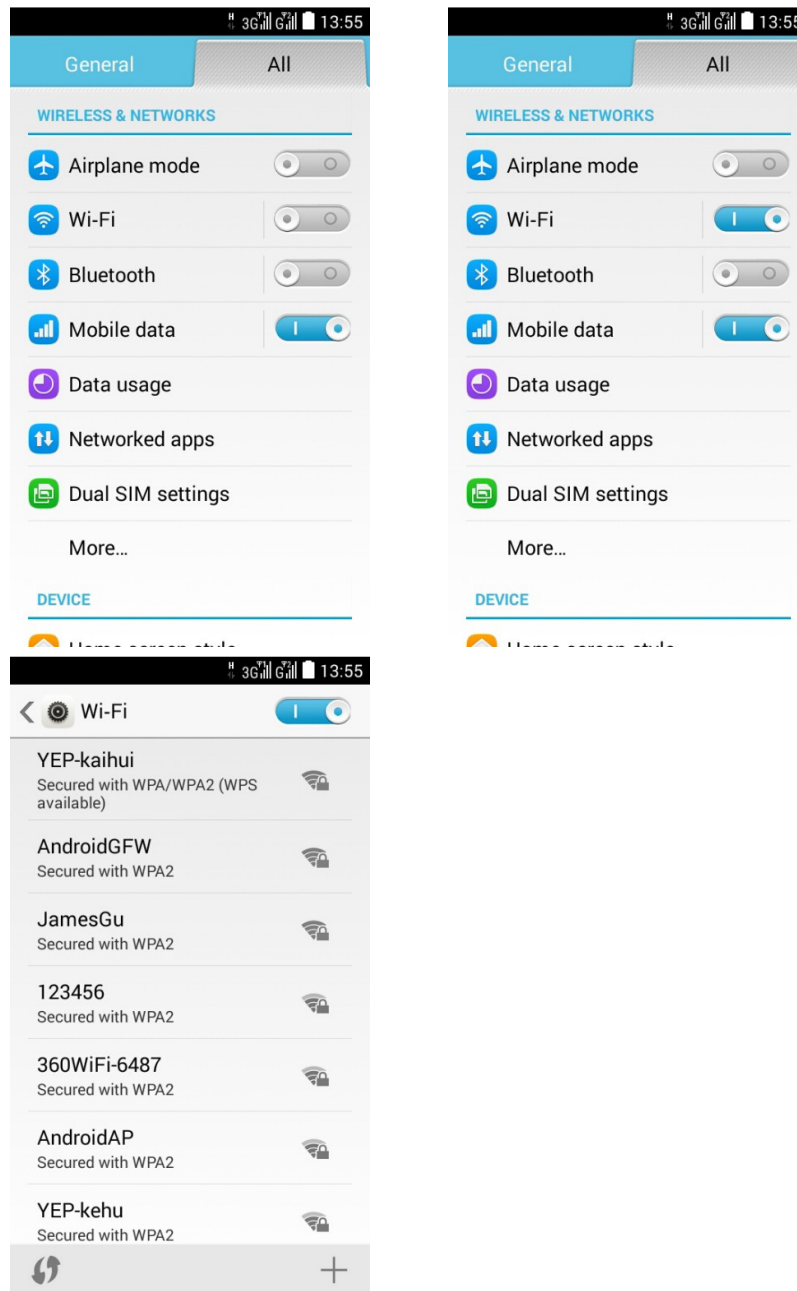

2.2.2 What protocol of Wi-Fi does it support, and how much is the transmission rate of each protocol?

The supported protocol is 802.11b/g/n.

2.2.3 Sometimes, web pages cannot be opened via Wi-Fi connection

The causes are as follows:

- 1.XDSL dial failure. In the connection of hotspots (for example, wireless router), use XDSL to connect to the Internet, and if XDSL dialing fails, Internet access will become impossible. Do try again after successful XDSL dialing.
- 2.Problem with DNS name resolution. If you cannot open the page but can log in to google apps, this indicates a problem with DNS resolution. (Verify if the DNS can be configured).
- 3.Wi-Fi hotspot access restrictions. If the currently connected hotspot itself is in the access-restricted state, the phone will not be able to access web pages.

2.2.4 Unable to search for Wi-Fi signals

After Wi-Fi is enabled, if Wi-Fi signals of the wireless router cannot be found, but other devices can search for Wi-Fi signals normally, then how to deal with it?

- 1.Determine whether the wireless router SSID is hidden.
- 2.Turn off the Wi-Fi and then turn on it again.
- 3.Restart the phone.

2.2.5 How to decide if it is the UIM/SIM or Wi-Fi access that is being used

After connecting to Wi-Fi, the charge on the UIM/SIM card will not be used, and the Wi-Fi priority is higher than the mobile data; check the Wi-Fi icon at the upper right corner of the screen, if there is a Wi-Fi icon, it means the Wi-Fi is already in use.

2.2.6 Causes for Wi-Fi connection failure

- 1.It is the result of user-entered password errors, so please pay attention to enabling the uppercase and lowercase letters.
- 2.Suddenly the signal becomes weak or there is no signal in hotspots, which will cause the connection to fail.

2.2.7 Wi-Fi will automatically disconnect while in standby, how to solve it, and what is the default setting of the phone?

This problem is sleep strategy. Method to enter: On the home screen, click Settings > Wi-Fi, and then click the menu button  and enter Advanced > Maintain Wi-Fi connection in sleep status, set it to "Always".

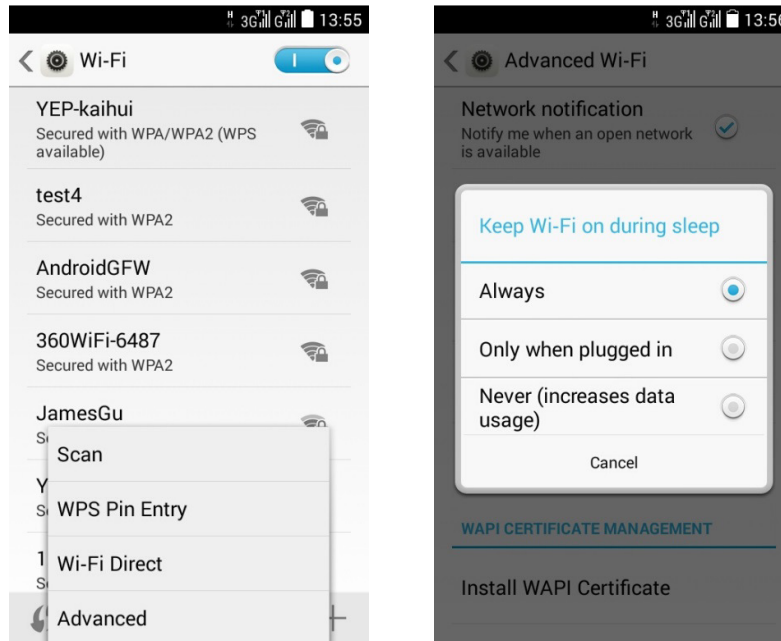

Note: The default setting is Always on the phone, which means the phone is always connected properly. If you adjust the sleep strategy, the phone will automatically disconnect in standby status. The meaning of three options is as follows:

Always: Always keep the Wi-Fi connection.

Only for the charging time: Only when the phone is being charged can it remain connected, if not, it will disconnect after 3 minutes in standby.

Never (which will increase data network traffic): disconnect in 3 minutes after entering standby status.

2.3 Network sharing and portable hotspots

The Wi-Fi hotspots of the phone means that the auxiliary machine accesses the Internet by connecting to the test machine after the hotspots are enabled on the test machine.

Method to enable: **Settings > More... > Mobile network and Portable Wi-Fi hotspots.**

After being turned on, the auxiliary phone will search for the test phone with Wi-Fi and connect to the Internet.

Also, configure the hot-spot name and encryption mode and other features in **Set up Wi-Fi hotspot.**

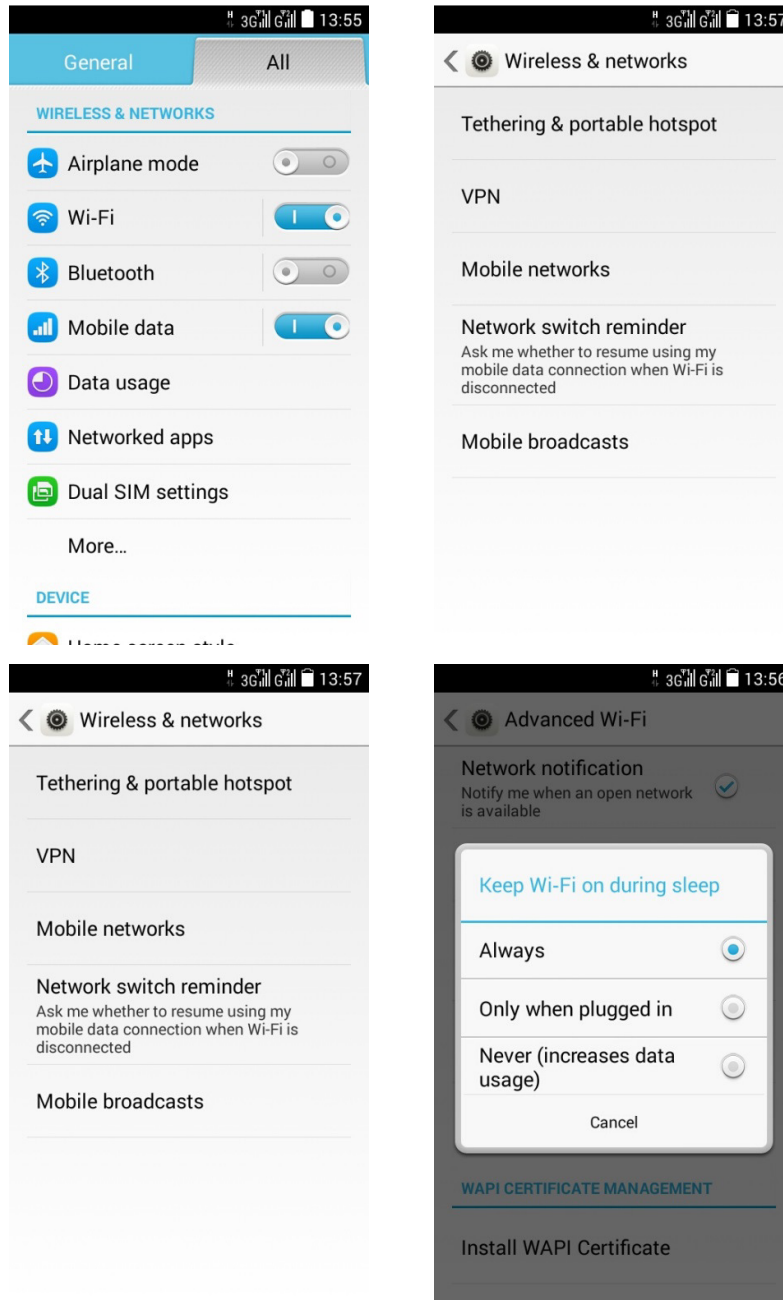

2.4 Static IP for surfing via Wi-Fi

Settings > **Wi-Fi**, click the hot spot to be connected, and in the pop-up dialog box, check **Show advanced options**; in the **IP settings**, select **Static**, and fill out **IP address** (Most of the settings is 192.168.1.**), **Gateway** (Most of them are 192.168.1.1), **Subnet prefix length** and **Domain name** (dns address) in turn.

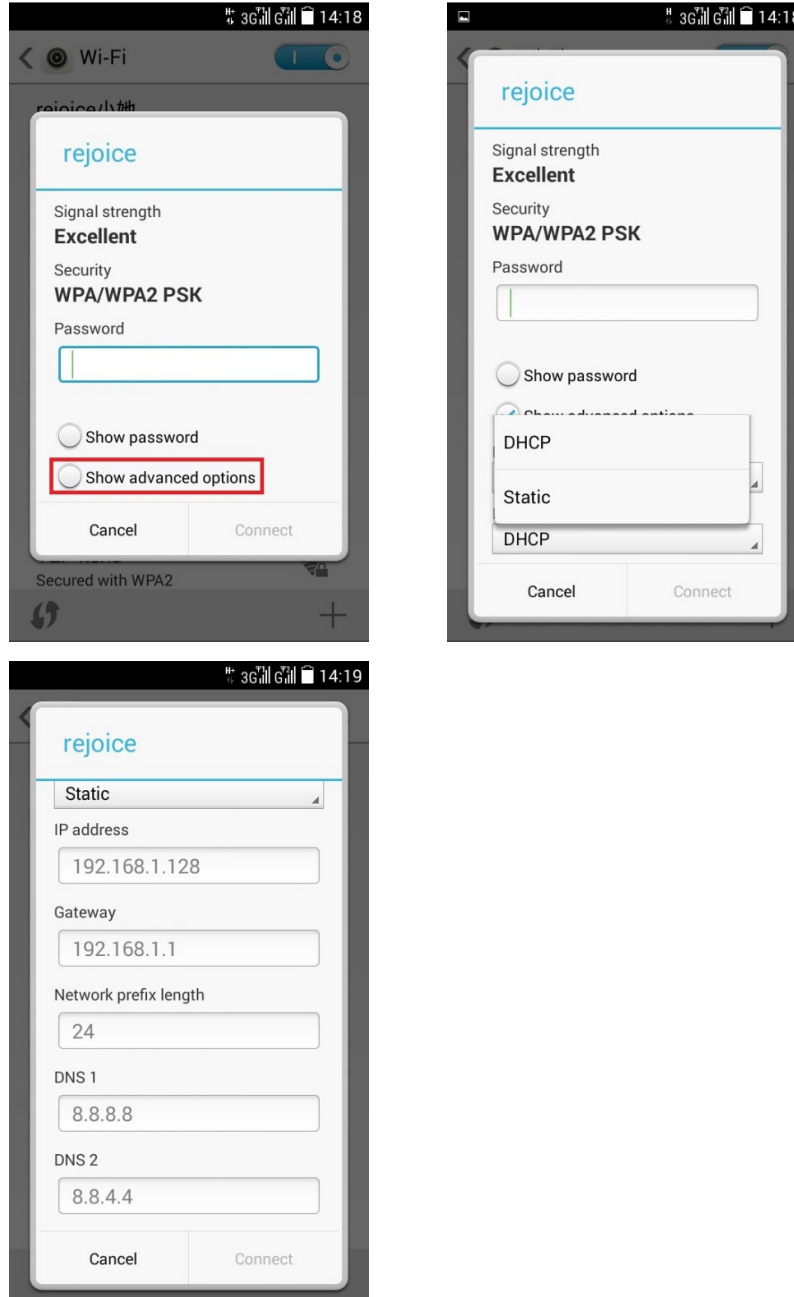

The biggest problem in using the Wi-Fi network is the failure to achieve the wait-free network connection, and it is a time-consuming job to obtain a dynamic IP address after connecting to a router. But you can realize rapid Internet access via Wi-Fi by with a static IP.

2.5 Connecting to a PC as a modem

Not supported

2.6 Ringtone settings

2.6.1 The method to set ringtones for incoming calls

On the home screen, click **Settings** > **Audio profiles** > **General** > Click **Voice call ringtones**.

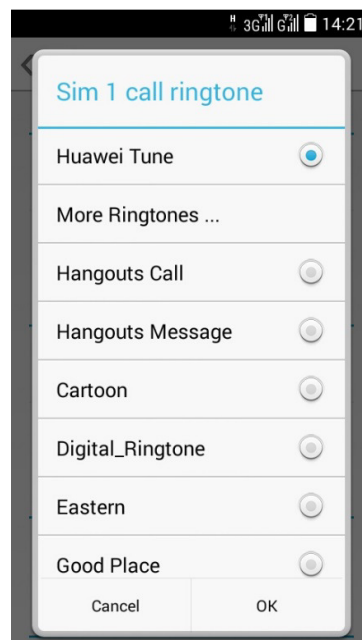
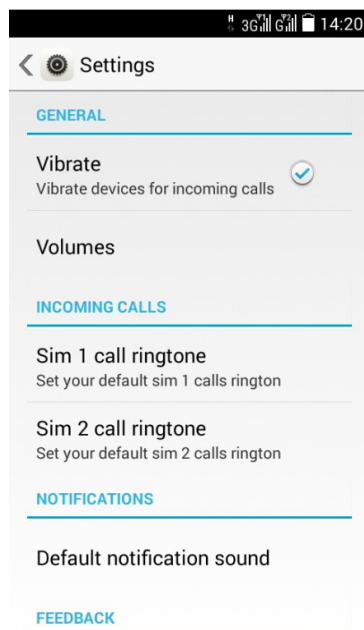
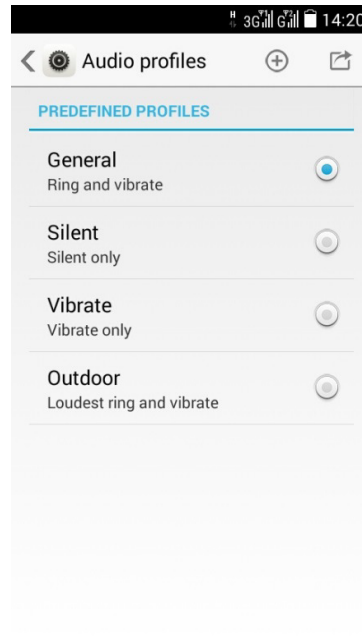
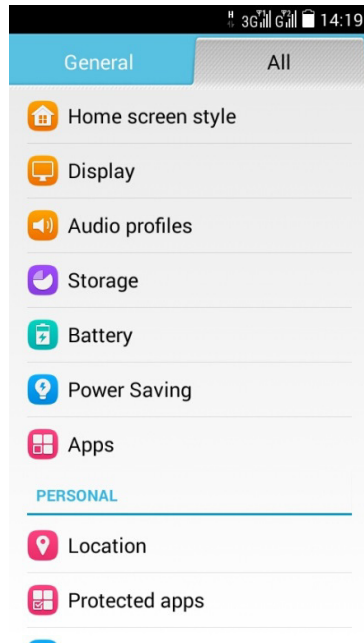

2.6.2 Incoming call/SMS vibrate setting method

On the home screen, click **Settings** > **Audio profiles** > **General** > **Vibrate**.

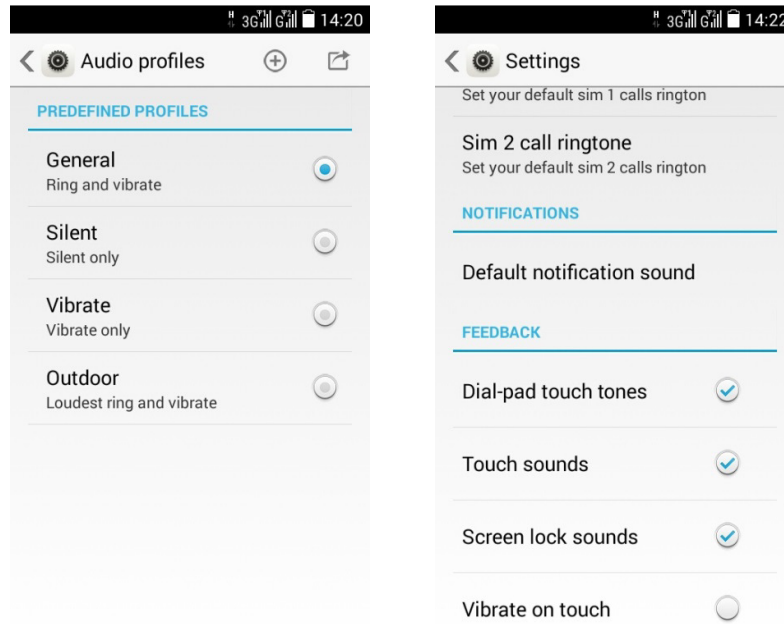

2.6.3 How to set self-selected music as the incoming call/SMS ringtone?

Enter the File Manager, hold the self-selected music file, and in the pop-up menu, select Set as the ringtone/notification ringtone.

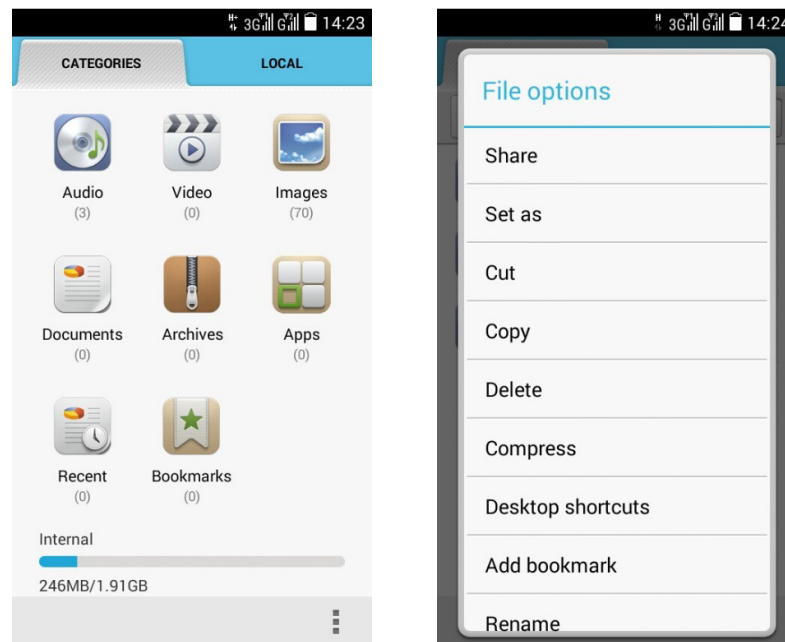

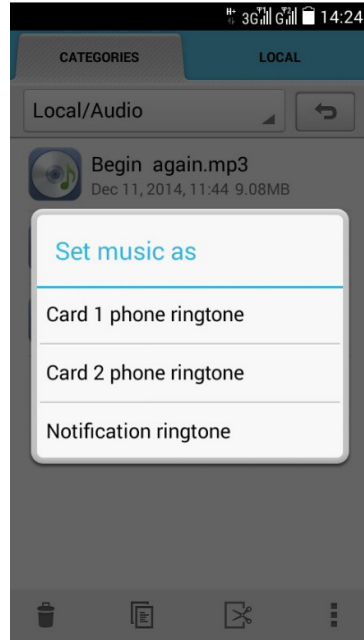

2.6.4 How to set group ringtones

Enter Contact, select the group tab, select a group added with group members, click to enter the details screen, and click the ringtone option to select the required group ringtones.

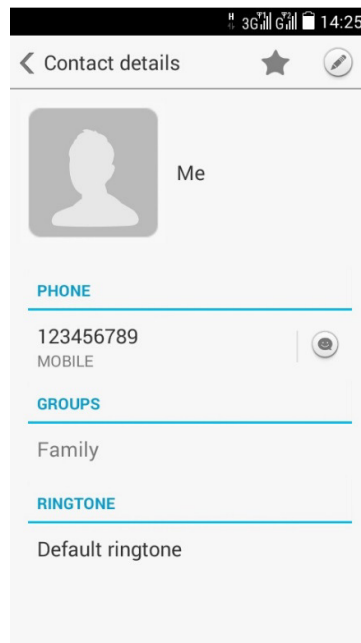
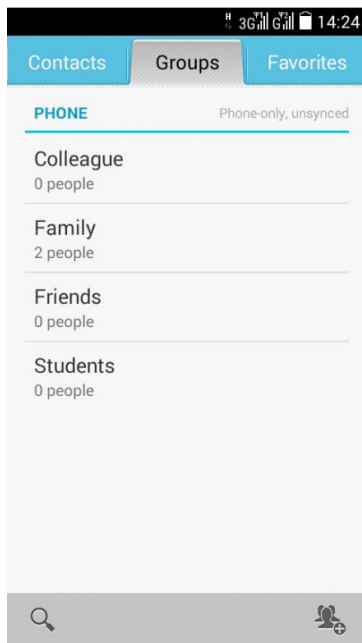

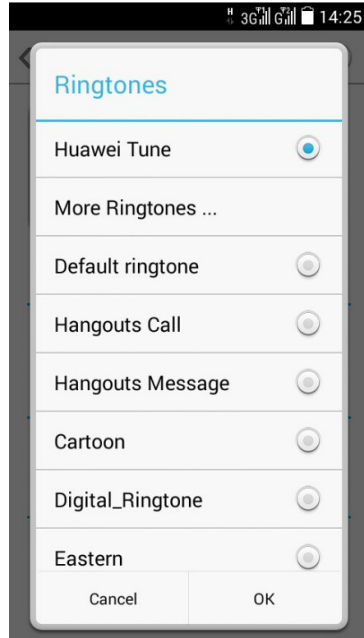

2.6.5 How to cancel the phone keypad tones?

On the home screen, click **Settings > Audio profiles > General >** Uncheck **Dial-pad touch tones**.

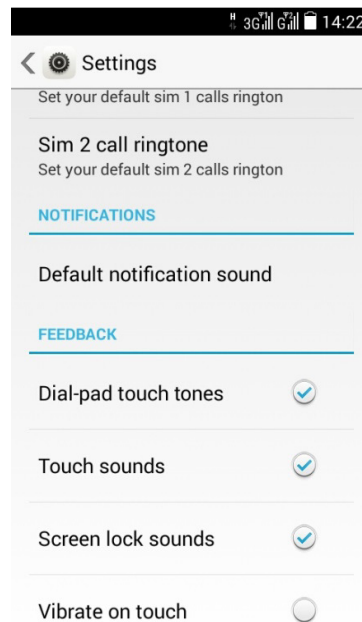
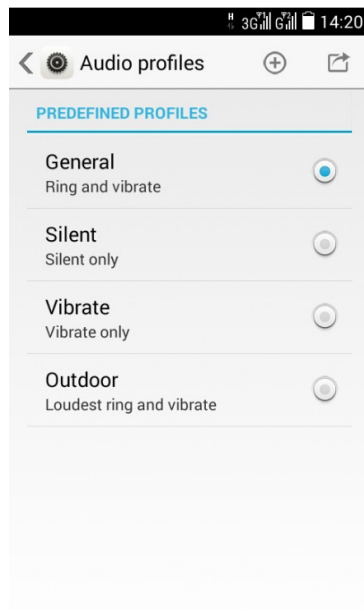

2.7 Language and Keyboard Settings

2.7.1 What languages does it support? How to change the phone language?

On the home screen, click **Settings** > **Language & input** > **Languages**, you can select one in the language list.

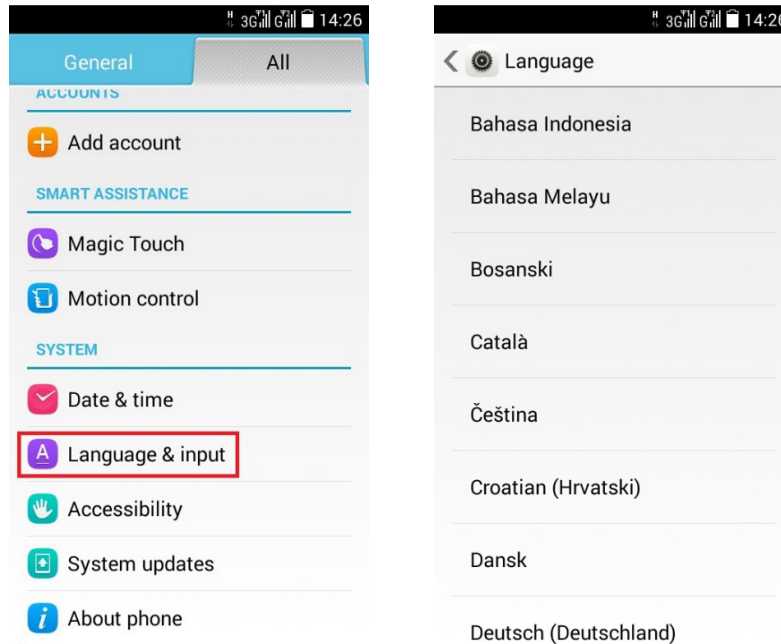

2.7.2 Why can't it be used after installing other input methods?

On the home screen, click **Settings** > **Language & input**, and in the keyboard and input method area, click **Default**, select one in the input method list.

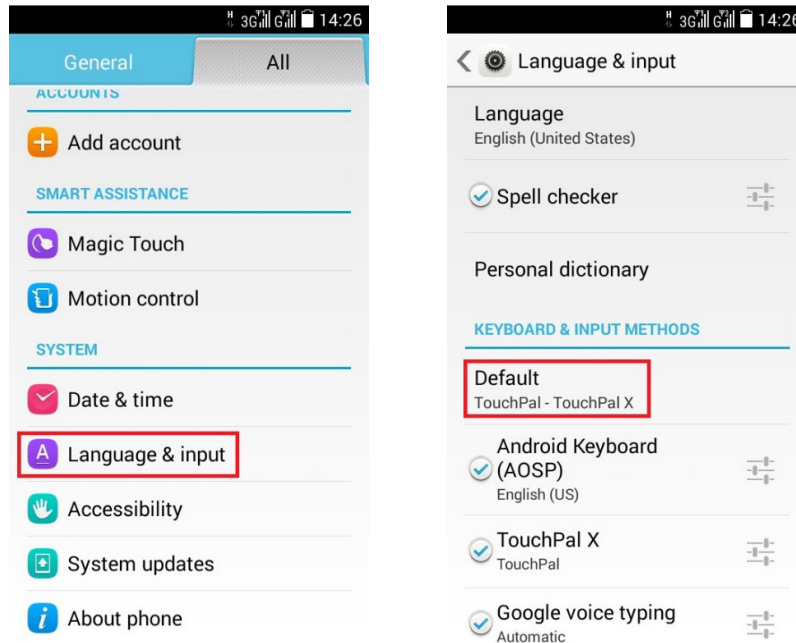

2.7.3 Can the system font size be adjusted?

On the home screen, click **Settings>Display>Font size**, you can select one in the font list.

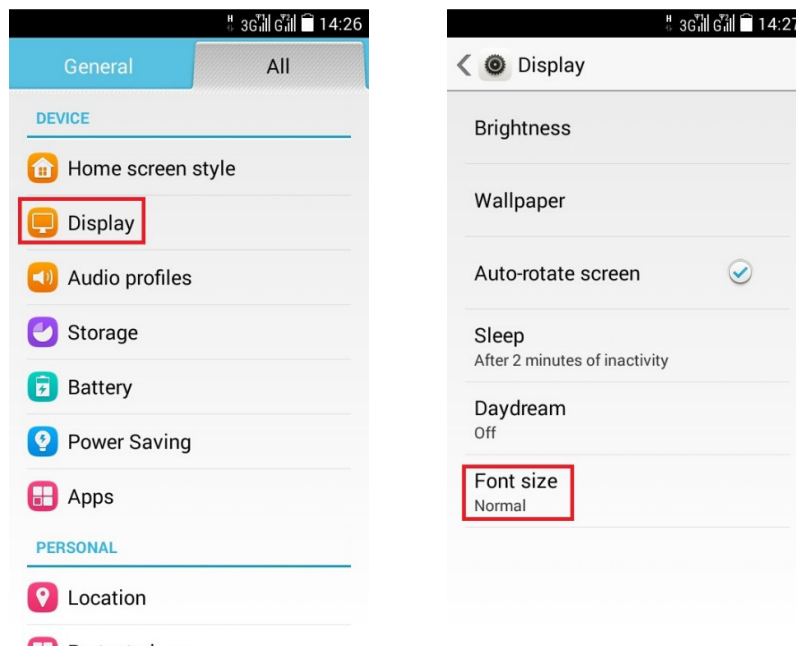

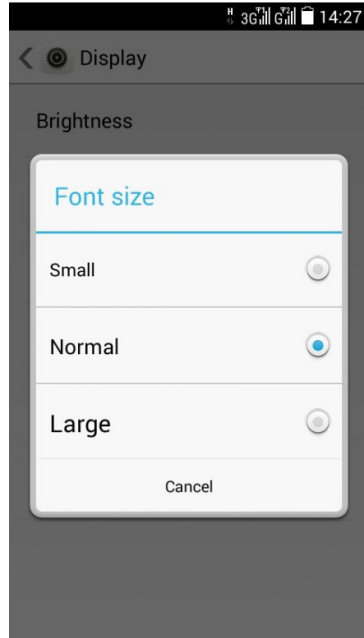

2.7.4 What input methods come with the phone?

Android keyboard, Touch Pal input method.

2.7.5 How to switch the stroke input method?

In the input screen, click **More**, to invoke Handwriting, Strokes and other input options, and here we select strokes input.

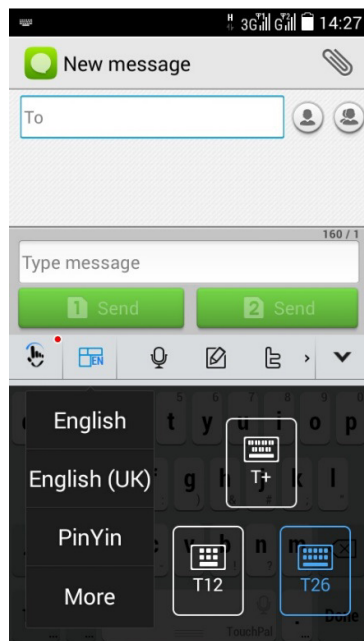

2.7.6 How to turn off the input method vibrate

For Android Keyboard, the method to disable vibrate: Click **Settings** > **Language & input** , and click **Android keyboard** to  uncheck the **Key vibrate**.

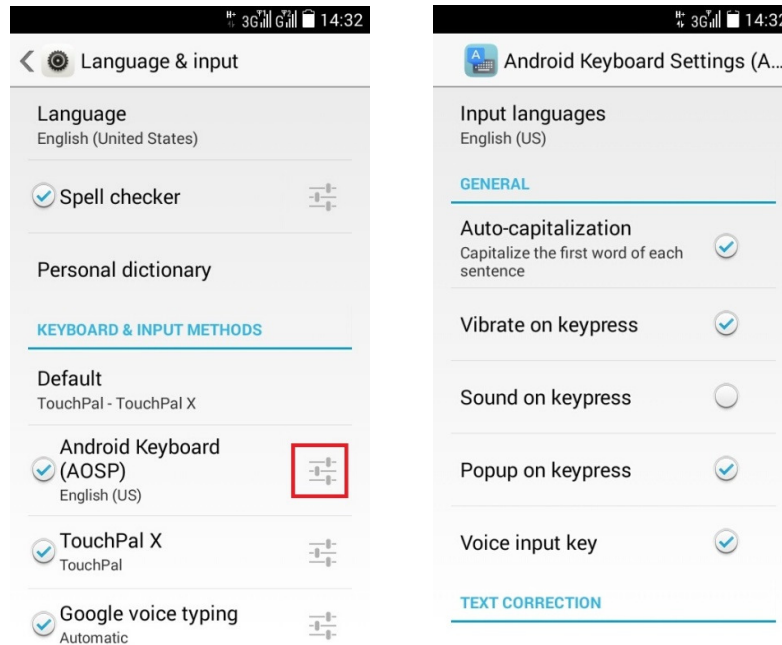

2.8 Internet-related settings

2.8.1 Clear the phone browser cache and history

In the browser interface, click the menu button, select **Settings** > **Privacy and security**, and then click **Clear Cache** and **Clear History**.

2.8.2 Browser full screen and bookmark settings

Full screen: In the browser interface, click the menu button, select **Settings** > **Laboratory**, **check Full screen**.

Bookmark: In the browser interface, click the menu button, select **Save to bookmark**, and then click **OK** to add a bookmark.

2.8.3 Log in to the mailbox from web pages of the mobile phone

Supported. Input the email address in the address bar to enter the login interface.

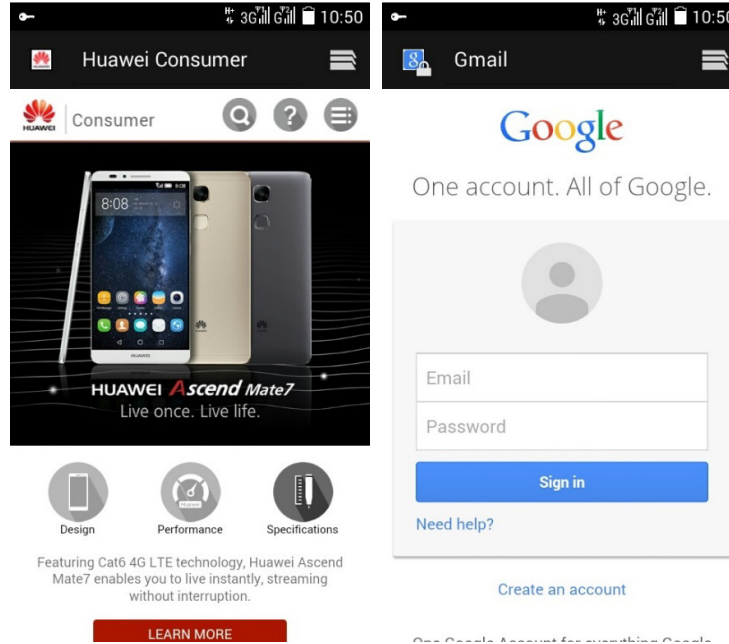

2.8.4 Does it support logging in to online banking?

Yes. It is required to install the relevant online banking client when the network is available. There may be problems in the access via the browser because some of the bank login plugins need to run under Microsoft's IE environment.

2.8.5 Save pictures in the web page

In the browser interface, hold the picture in the web page, and select **Save image** in the pop-up browser dialog box.

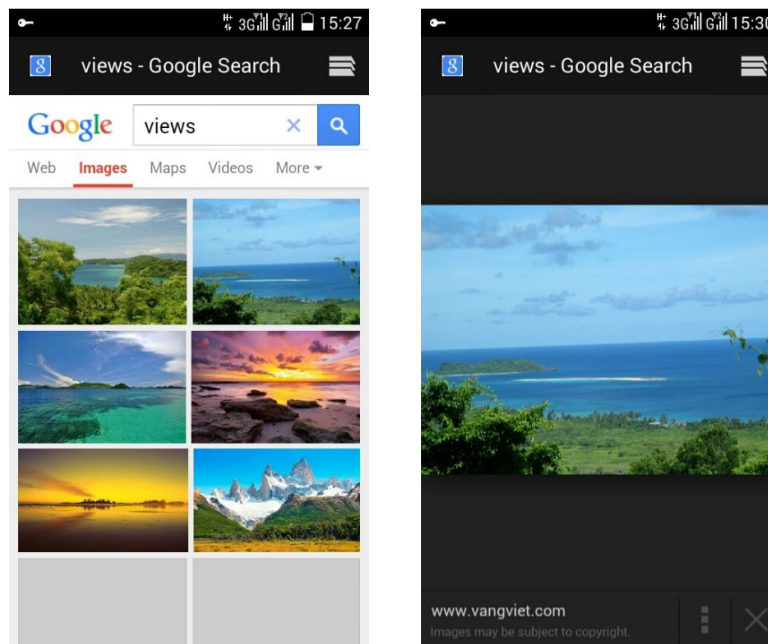

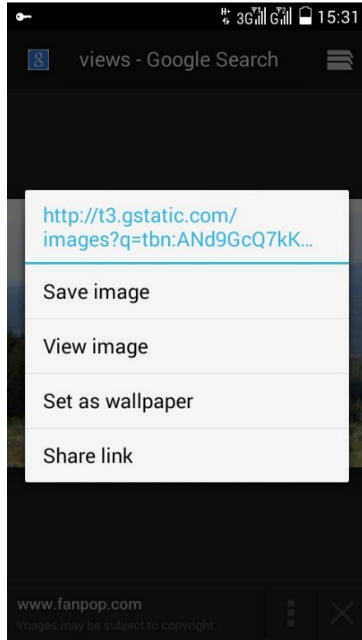

2.8.6 Setting Modify Home Page

In the browser interface, click the menu button, select **Settings > General > Set Homepage**.

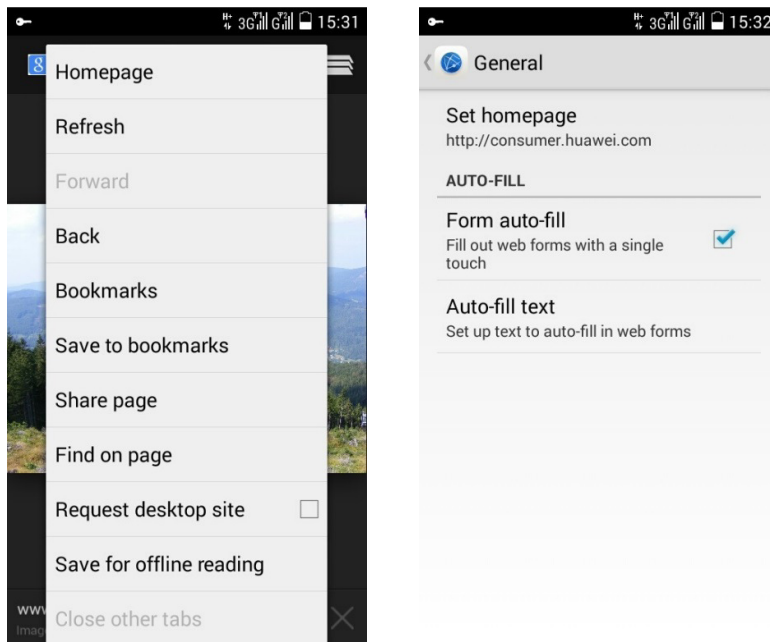

2.8.7 Save my favorite web pages

In the browser interface, click the menu button, and then click **Save for offline reading**.

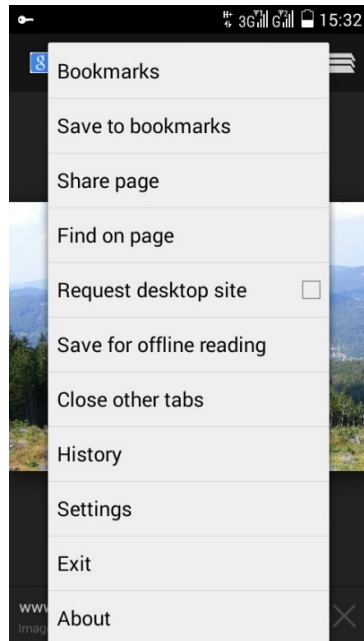

2.8.8 The phone cannot access the Internet: Method of setting network parameters

Insert the UIM/SIM card, and APN will automatically configure network parameters.



Viewing method: Enter the home menu, select **Settings > Wireless and Network > More... > Mobile Network > Access Point Name (APN)**.

When the parameter is set incorrectly, click the menu button on the APN interface ≡, and select **Reset to restore the default settings**.

2.8.9 How to disable and enable mobile data

The method to disable and enable mobile data:

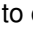

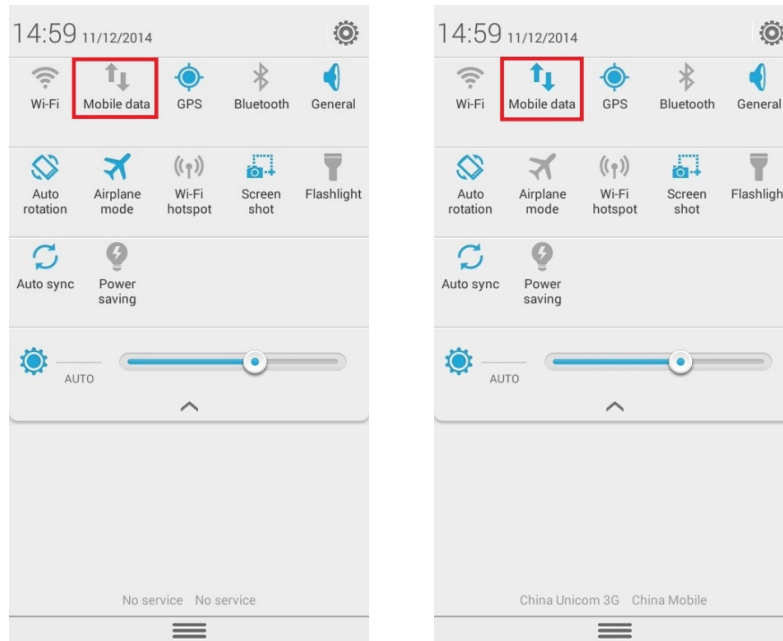

Enable the mobile data in the drop-down notification bar:

Drop down the notification bar on the screen, click the data switch  to enable mobile data, and then its status is highlighted .



2.8.10 View or disconnect the current data connections

Pull down the status bar to check if the data switch is highlighted.

- 3.If the data switch is highlighted  , it means the switch is enabled; the switch will become gray  after being clicked. At this time, you can disconnect the data link.
- 4.If the data switch becomes gray  , it means the switch is disabled; the switch will become highlighted  after being clicked. At this time, you can connect the data link.

2.8.11 Does it support accessing the Internet when making a call?

No.

2.8.12 What are the limitations of mobile data?

N/A.

2.8.13 What is the function of the virtual private network VPN setting and how should it be set?

VPN is defined as the establishment of a temporary and secure connection via a public network(usually the Internet), which is a secure and stable tunnel that passes through the disordered public network. A Virtual Private Network is an extension of the enterprise intranet. A Virtual Private Network can help remote users, corporate offices, business partners and suppliers establish a reliable secure connection with the company's intranet, and ensure the security of data transmission. A Virtual Private Network can be used for the growing global Internet access for mobile users in order to achieve a secure connection; it can be used for a virtual private line that implements secure communications between business websites, and used for the cost-effective connection to business partners' and users' secure extranet virtual private network.

VPN can provide features as follows: The firewall feature, authentication, encryption and channelization can help establish a private communications line between two or more business intranets in different places on the Internet through a special encrypted communication protocol, which is like mounting a private line, but it does not require actually laying a physical line like an optical cable. This is like applying for a private line to the Telecommunication Bureau, but requires neither the payment of the costs of laying the line nor buying routers and other hardware devices. VPN technology is originally one of the most important techniques with the router, and the software for switches, firewall devices or Windows 2000 also supports the VPN functionality. In a word, the core of VPN lies in the establishment of a virtual private network with the public network.

Step 1: On the home screen, click **Settings>More...>VPN** to set the screen PIN code, as shown in the figure

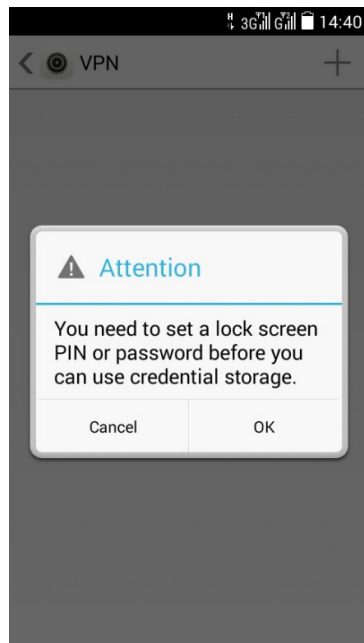

Step 2: Select the + above to add a virtual private network, as shown in the figure:

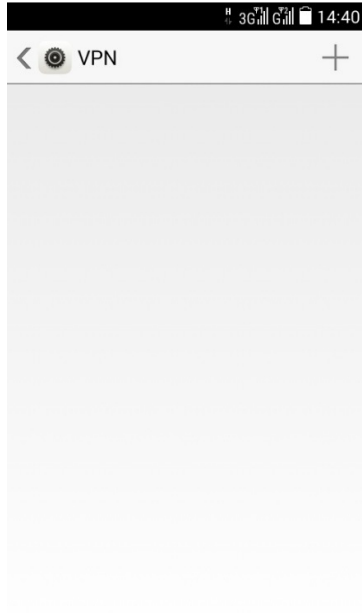

Step 3: Select "Add a Virtual Private Network" for configuration, with the type of PPTP, edit VPN's server address, and confirm to save, as shown in the figure:

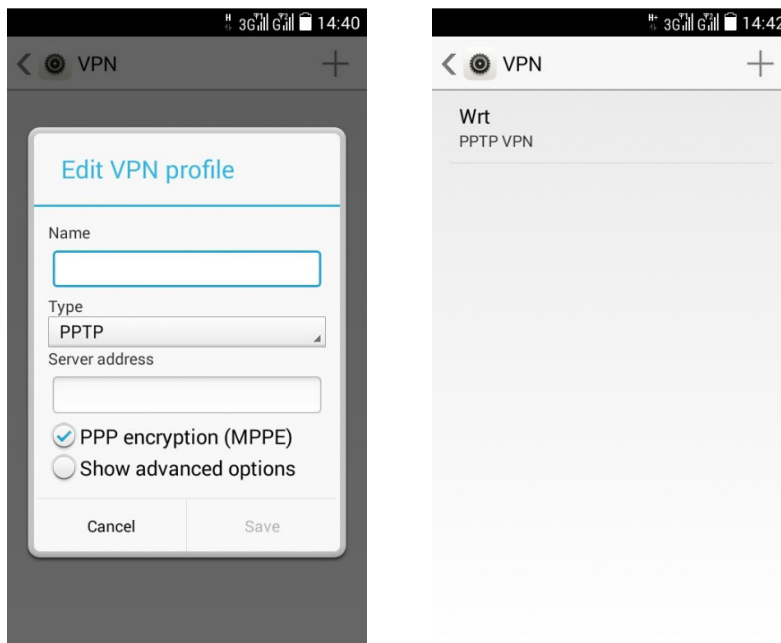

Step 5: Enter the already set VPN to log in to the account, as shown in the figure:

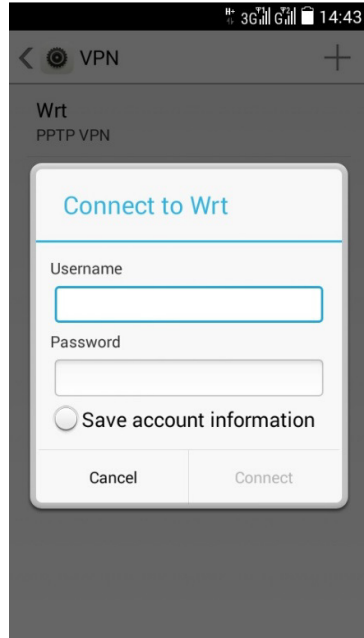

Step 6: Input the account and password, and then click "Connect", the flag for successful connection is the icon with a key in the status bar, and "Connected" is displayed under the account, as shown in the figure.

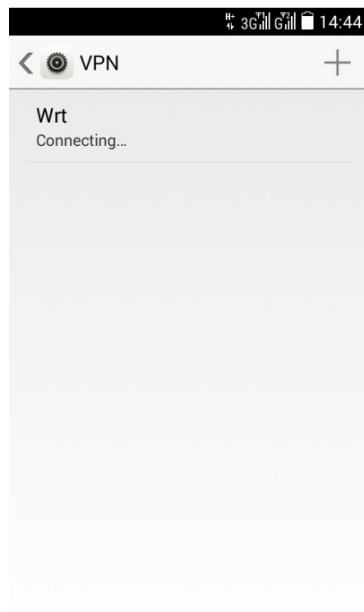

2.9 Screen lock setting

2.9.1 How to enable the PIN code to lock the screen?

1. Click **Settings > Security > Screen lock > PIN**.

2. Input the PIN code in the prompt box under " **choose your PIN** ".
3. Enter the previously entered PIN code again, and click **OK** to complete the setting of the PIN code.

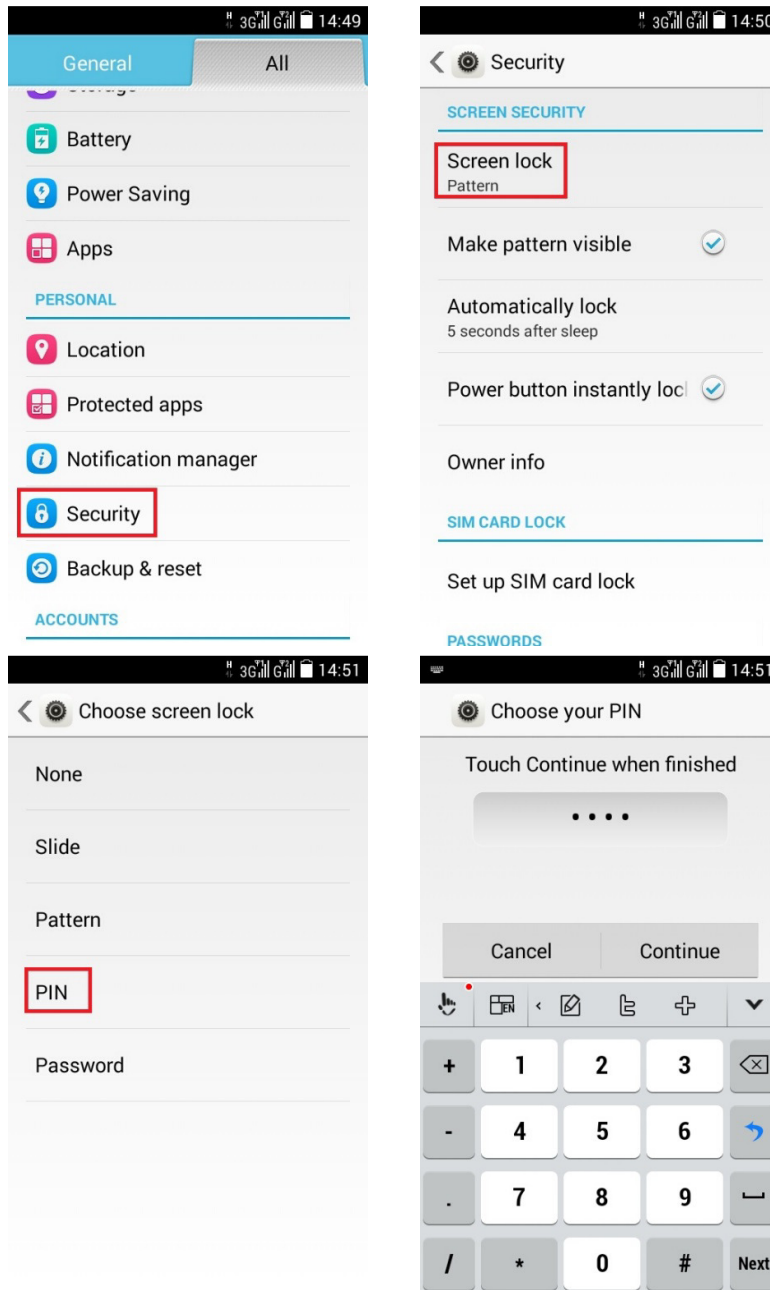

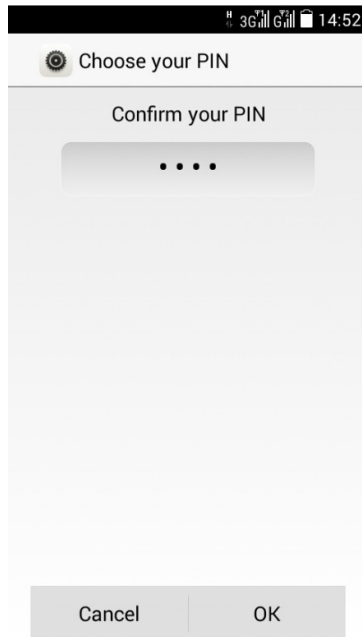

When clicking the power button or switching on/off the phone, the phone will enter the PIN code unlock interface by default. Enter the set PIN code and click **"OK"** to unlock the PIN code.

2.9.2 How to set Face Unlock

The phone does not support Face unlock.

2.9.3 How to enable the screen-unlocking pattern?

1. Click **Settings > Security > Screen lock > Pattern**.
2. In the **"choose your pattern"** interface, use your finger to sweep over the center of several circles to set the graphic style to be used to unlock, and then click "Continue".
3. Sweep over the screen in the above manner again, and click "OK" to complete the setting of the unlocking pattern.
4. When clicking the power button or switching on/off the phone, the phone will enter into the pattern unlocking interface by default, and sweep over the screen in the above manner to unlock.

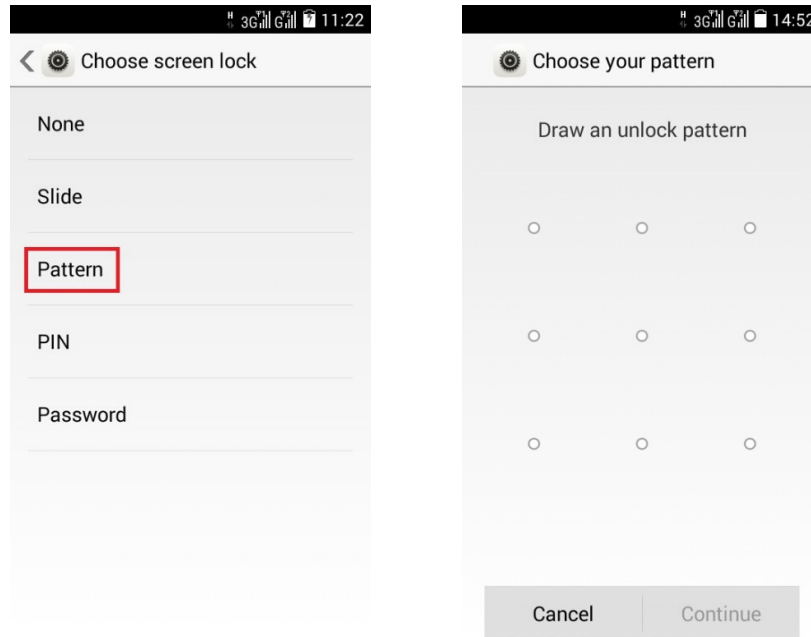

2.9.4 Will the phone be locked if the graphic lock is input incorrectly several times in succession? If I forget how to unlocking pattern, can I unlock them through GMAIL Email?

The phone will give a prompt if you have entered the wrong graphic lock for several times in succession. It will not be locked but will delay the next attempt.

If you forget the pattern, please send it to the customer service department for unlocking or updating the version again. Gmail messages cannot be used to unlock this phone.

2.9.5 How to lock and unlock the screen?

Lock: Press the power button to lock the screen.

Unlock: Press the power button to wake up the screen, and then follow the screen display to unlock by dragging, entering PIN, entering the pattern, etc.

2.10 Alarm function

2.10.1 Add /Cancel the alarm clock.

On the home screen, click **Clock**.

Click  again to enter the Alarm Clock interface.

Click **Add alarm** and set the alarm clock bell time.

Check **REPEAT**, and select the alarm clock cycle to be repeated.

Click **Ringtones**, and select the Alarm clock bell.

Check **Vibrate**, and set the phone to vibrate when the alarm clock bell rings.

Click **Label**, and input the name of the alarm clock time.

In the alarm clock interface, you can see a list of all current alarm clocks. Drag the button to cancel the alarm clock. Or hold an alarm clock record and click the trash can icon at the upper right corner to delete your selected alarm clock.

2.10.2 Does it support shutting down the alarm clock?

It supports shutting down the alarm clock.

2.11 Applications

2.11.1 What formats of software does it support? Does it support JAVA?

It supports App applications compiled with java language. If you want to install .jar or .jad programs, you need to install a java simulator (Jbed.apk, GZL-signed-Jbed.apk, etc.).

2.11.2 How to obtain third-party applications?

You can directly choose your desired applications from the pre-set play store for download and installation, or install the applications by connecting the computer and starting the PC software installed on the PC.

2.11.3 Does it support the setting of the preferred installation location?

Yes.

2.11.4 How to install, manage and uninstall programs?

Installation; you can install applications directly in the preset play store; if you want to install applications on the SD card, enter the file manager, locate the appropriate place for your applications, and click the application to install.

Uninstall: Settings > Storage > Click "Apply" > Click the application to be uninstalled > click Uninstall to uninstall; or enter the home screen, hold the application to be uninstalled, and drag it to the place of uninstallation to uninstall.

2.11.5 Cause for installation failure and its solution

Insufficient space: Please uninstall some unused applications, and delete unused files from the file manager.

Incompatible software versions: The previous Android 2.3 applications are installed in the present Android 4.4 version.

2.11.6 What software is preset on the phone? Which of them is customized by the business provider? Which of them is the software coming with the mobile phone? Can they be deleted?

Huawei basic applications	1	Huawei Music
	2	Backup
	3	File Managert
	4	Weather Clock
	5	Calender
	6	Notes

	7	Caculator
	8	Camera
	9	Gallery
	10	Themes
	11	Hota
	12	Wi-Fi direct
	13	Flashlight
Google GMS package (preinstalled according to google's policy)	14	Search
	15	Gmail
	16	ContactSync
	17	CalendarSync
	18	Hangouts/Talk
	19	Chrome
	20	Drive
	21	Google+
	22	Maps
	23	StreetView
	24	YouTube
	25	GooglePlayStore
	26	GooglePlayGames
	27	GooglePlayBooks
	28	GooglePlayMovies
	29	GooglePlayNewsstand
	30	GooglePlayMusic
	31	Widevine
	32	ConfigUpdater
Third party	33	WPS Office
	34	TouchPal input method

2.12 Common problems with third-party applications

2.12.1 Third-party applications installed on the SD card may occupy the system memory of the phone.

The phone does not support any third-party applications installed directly on the microSD card, but some can use the "Move to SD card" feature on the **Settings - Storage - View application** interface after installation. These applications will save some temporary data to

the storage area of the phone in running and thus occupies the system memory, which is normal.

2.12.2 Causes for some phone numbers' failing to display in the place they belong to.

Y625 don't support display the number's place they belong to. User may be install some third party software to support.

2.12.3 Online banking transactions

Supported. You need to download the appropriate client end to provide services.

2.13 Data backup and recovery

2.13.1 Backup and recovery of contacts in Phone Book

On the home screen, click **Tools** >  to back up and restore contacts.

1.Backup

On the home screen, click **Tools** > , and click **New backup**, check the data to be backed up, and click **Backup**. Set a password and click **OK**.

2.Recovery

On the home screen, click **Tools** > . In the backup file list, select the data file to be restored and click **Restore**. When **Recovery is complete** is displayed on the screen, click **OK**.

Before recovering contacts, make sure that you have backed up your contacts.

2.13.2 Does it support backing up the directory of group contacts

No.

2.13.3 How to use Cloud Backup – Backup and recovery

The phone currently does not support cloud backup and recovery.

2.13.4 Which data does the phone support backing up?

The phone supports backing up contacts, messages, call logs, system settings, browser bookmarks, mail accounts, calendar, App server and weather.

2.14 Task Manager (Task Manager)

2.14.1 Roles of the Task Manager

To manage all the applications that have been downloaded and are running.

2.14.2 How to open the Task Manager

3. Click **Settings > Apps**

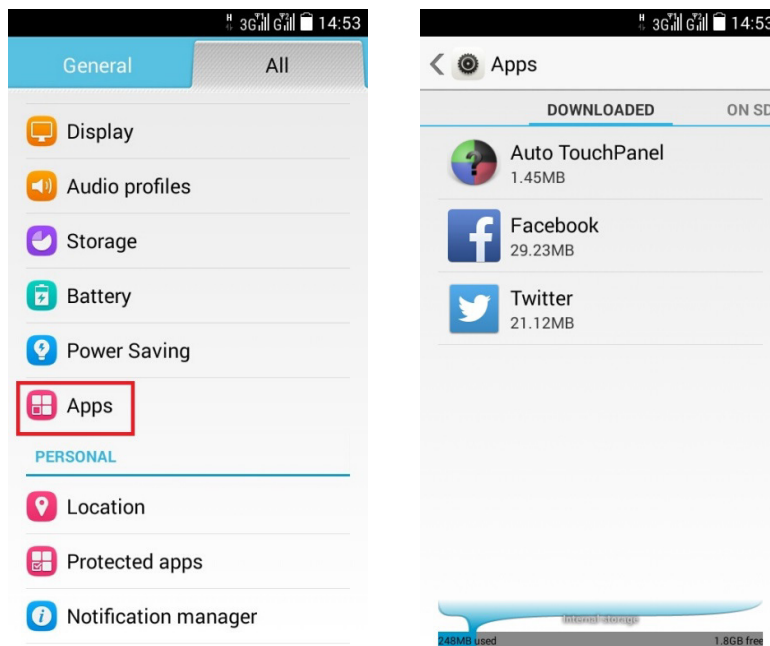

2.14.3 Introduction to Task Manager Interface

1. The above is the switching of all the label bars in the SD Card that have been downloaded and are running.
2. In the middle there is a list of applications
3. The following is the information related to memory usage

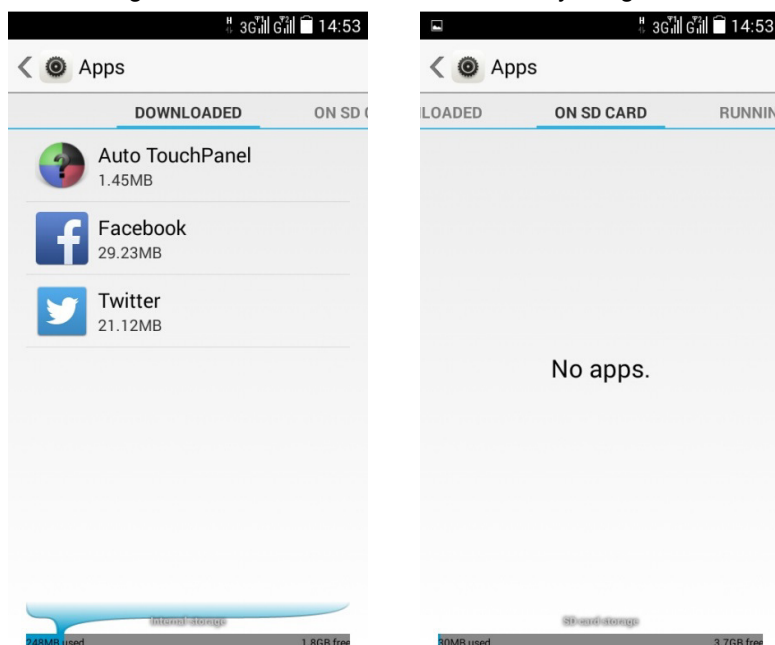

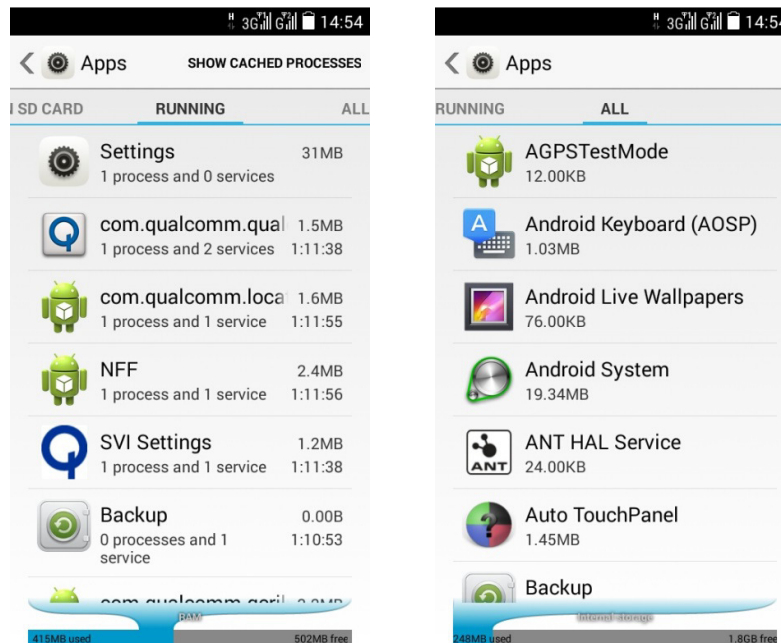

2.14.4 Related operations of the Task Manager

By switching tags, you can enter different lists of applications.

Enter specific applications for operations such as uninstall, stop, clear data, etc.

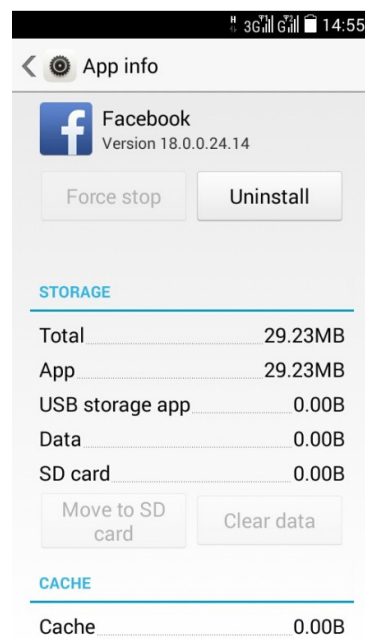

2.15 What are the features of cloud services?

It does not support the cloud service feature.

2.16 Huawei Security Guard

Y625 don't support HUAWEI Security Guard.

2.17 Use Huawei's security guard blacklist

NA

2.18 Weather Clock

You can manually update the weather on the home screen interface by clicking Update Time

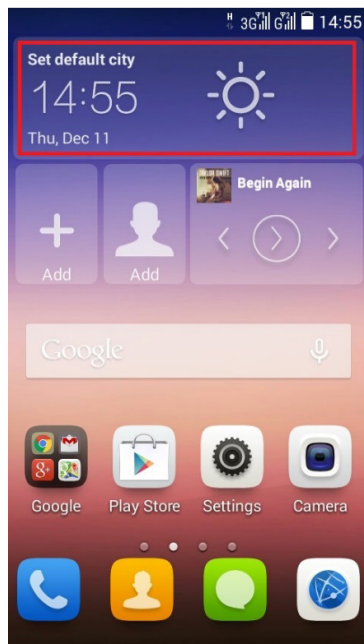

Enter the Weather app:

Click the icon indicating weather on the home screen or select Weather in the home menu

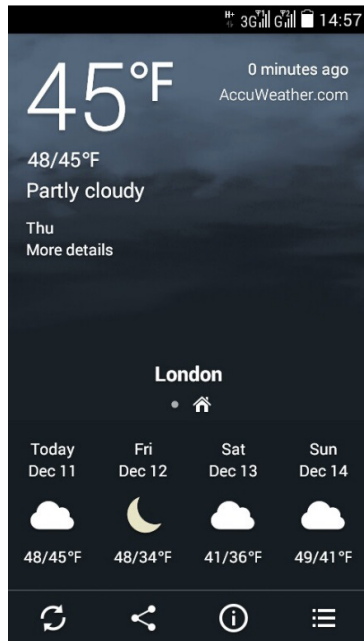

Enter the Clock app:

Click Clock Position on the home screen, or select the clock on the home menu.

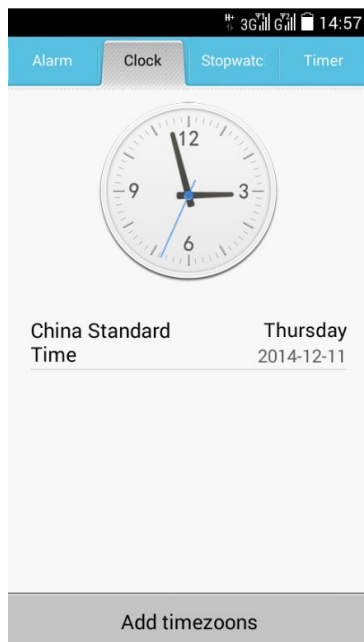

2.19 Developer Options

Users can **enable** / **disable** the developer options via the touch switch.

1. USB debugging: Used to enable the debug mode, by which you can debug a mobile phone with the adb command
2. Keep Awake: Used to prevent the screen from sleeping when charging

3. Allow mock location: Used to enable the mock location function
4. Desktop backup password: Used to set the backup password
5. Pointer location: Used to display the current touch data when you touch the screen
6. Display touch operation: Used to provide visual prompt for touch operation
7. Display the CPU usage: Used to display the usage of the current system CPU
8. Force GPU rendering: Used for acceleration with 2D hardware in applications
9. Animation zooming: Used to control the zooming speed
10. Background process limit: Used to limit the number of background processes
11. Display all "Applications are unresponsive": Used to display the "Application is unresponsive" dialog box for background applications.

2.20 Time Synchronization

It supports time synchronization.

On the home screen, click **Settings > Date & time**, and then check **Automatic date & time** and **Automatic time zone**.

2.21 Connecting to a PC to serve as a USB drive

It can identify the internal storage space in the microSD card and the phone by connecting the mobile phone with a PC via USB, but it cannot identify the phone memory.

Step: Drop down the menu and select the connection method as shown in the figure, and connect it by means of charging and then click it.

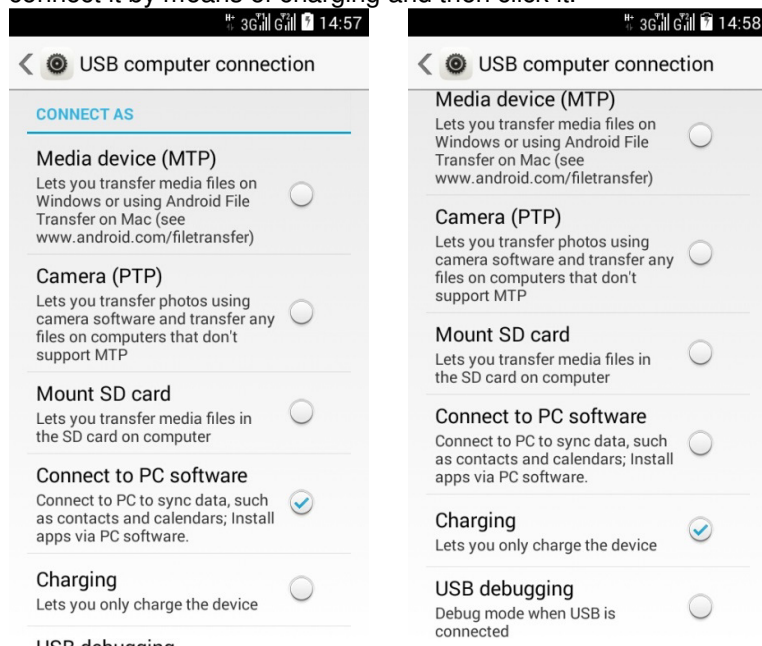

Media Device (MTP): Used for connecting with a computer (which needs to support MTP function) to transmit media files (images, sound recordings, movies and other files).

Camera (PTP): Used to transmit image files with PC, and it is a good method for PCs that support no MTP function.

Mounting SD card: Used for the transmission of files in the SD card on PC.

Connect to PC software: Connecting a PC to synchronize contacts, calendar and other data with PC side software to install applications on the mobile phone.

Charging mode: When connected to a PC, charge the mobile phone.

2.22 Release the internal storage space of the phone

Delete unused files: On the home screen, click **File Manager** to view files or folders, hold the file or folder you want to delete, and in the pop-up menu, select **Delete**.

2.23 Adjust the screen brightness

On the home screen, click **Settings** > **Display** > **Brightness**. You can set the brightness by checking " **Auto** " or manually sliding the slider below.

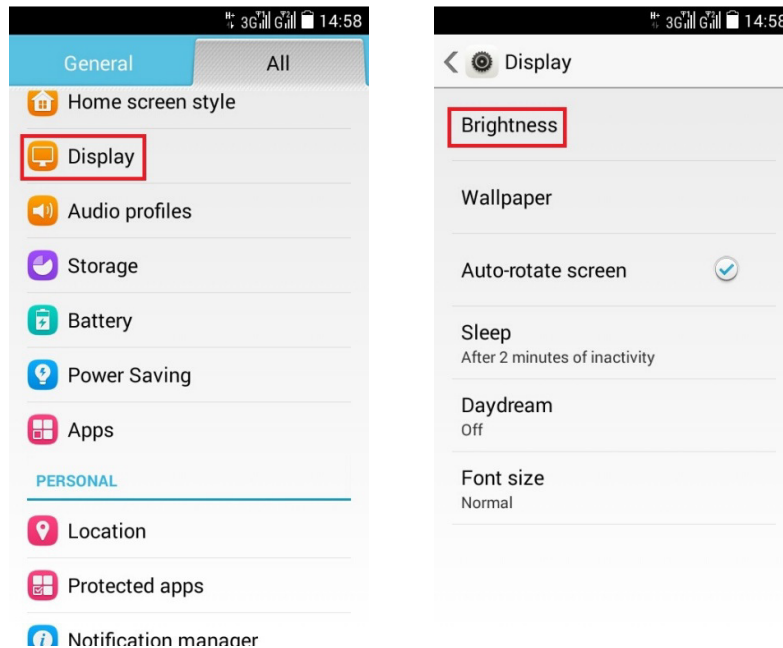

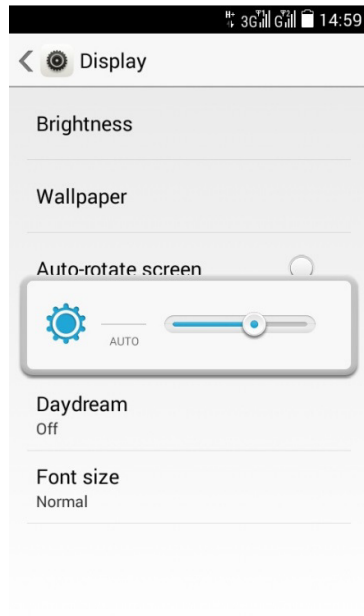

2.24 Power-saving feature of the phone keypad backlight

On the home screen, click **Settings** > **Power Saving** to active it.

2.25 Set Airplane mode

On the home screen, pull down the status bar, and click **Airplane mode** to turn on the airplane mode; uncheck it to turn off the airplane mode. In airplane mode, the wireless network is unavailable.

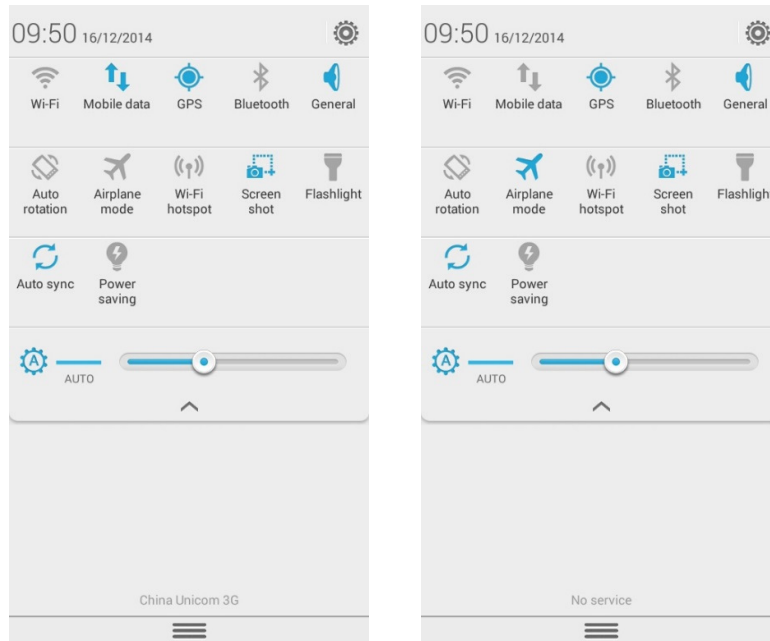

2.26 Restore the operation of factory settings

1. On the home screen, click .
2. click **Backup & Reset**.
3. Click **Factory data reset** > **Reset phone**.
4. Click **Erase everything**, and the phone begins to restore the factory settings, and then automatically restarts.

2.27 How to enter and exit the Safe Mode

Long press the power key until the the following windows popup.

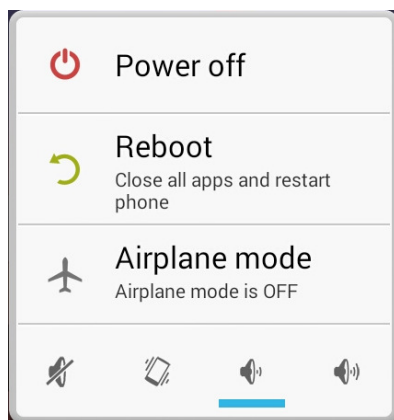

Click and hold the "Power off" menu, the following windows will be popup, select "Ok" to reboot to the Safe Mode.

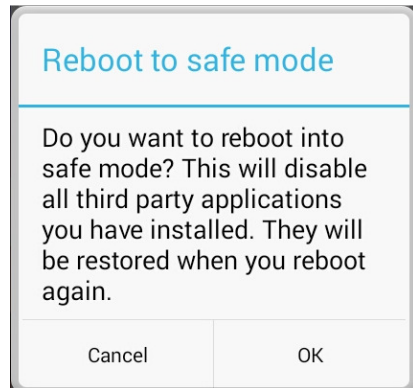

If you want to exit from the Safe Mode, only need to reboot the mobile phone.

2.28 Hi Suite

NA

2.29 Support HDMI? How to use it?

NA.

2.30 Does it support TV-OUT? How to use it?

Not supported.

2.31 Does it support the OTG function? How to use it?

Not supported.

Note: OTG is a new USB transmission technology to enable the phone to access a USB drive, digital camera or a keyboard, mouse and other external devices via an OTG adapter cable, with a high-definition video output mode of operation.

2.32 Status Indicator

NA

2.33 Can different chargers be used at the same time?

No

2.34 Features of the new phone

HUAWEI Y625 are Android powered smart mobile phones developed by Huawei with the latest Android 4.4 Kitkat OS from Google™. All including in a slim touch phone:

- Latest Android 4.4 kitkat OS
- Qualcomm MSM8212, Quad core, 1.2 GHz, Cortex A7 CPU
- High speed HSDPA +/HSUPA network up to **42Mbps/5.76Mbps**
- **8 MP** Auto Focus rear camera with LED Flash+ **2MP** Fix Focus front camera. Support Panorama, Audio note, Andio control, Water mark, Filter, Touch to capture, burst shoot etc.
- 5.0 inch FWVGA(854X480) IPS screen, full touch screen supporting 2 point multi-touch
- **Y625-U13, Y625-U43** support UMTS: 850/1900/2100 MHz
Y625-U21, Y625-U32 support UMTS: 900/2100 MHz
All of them support GSM/GPRS/EDGE: 850/900/1800/1900 MHz
- WCDMA+GSM , 3FF size SIM card standard (Micro sim card)

Y625-U13, Y625-U21 has only **one** SIM Card slot, but **Y625-U32, Y625-U43** support **Dual-SIM Card slot** and dual standby

- Wi-Fi 802.11 b/g/n, support Wi-Fi hotspot, Wi-Fi direct
- Bluetooth v4.0
- GPS/AGPS
- G-sensor for auto-rotate
- Proximity sensor for auto LCD backlight turn-off
- Ambient light sensor for auto LCD backlight adjusting
- 2000mAh Battery
- EMUI2.3 Lite
- Abundant Google applications(preinstalled according to google's policy)

3 Others

3.1 Power-saving tips

1. When using a mobile phone, press the power button to turn off the screen.
2. Screen brightness: Click Brightness in the drop-down menu to set the darker screen brightness.
3. Bluetooth and Wi-Fi: Power off the Bluetooth or Wi-Fi in the drop-down menu.
4. Mobile data: Disconnect the Mobile data in the drop-down menu if you don't need it.
5. GPS: Power off the GPS in the drop-down menu.

3.2 Tips for network traffic saving

1. When using the Mobile data, turn off the Mobile data function.
2. In the Wi-Fi environment, turn off the Mobile Data.
3. The wap sites can save more traffic than the www websites.

3.3 How to manage it if the phone is running slow?

1. If there are many programs running, you can close some programs running in the background. On the home screen, click **Settings** > **Apps** > **Running**, and select the application and then select **Stop**.
2. Too many applications and insufficient system disk space may cause the phone to run slowly, in this case, you can uninstall some applications to free up the space on the system disk and increase the memory.
3. If the CPU occupancy is high and many background processes are running, the phone will get stuck in operation. In this case, you can restart the phone, and the unused background processes and applications will be closed.

3.4 The wallpaper I set will automatically stretch, so can I set non-stretching wallpaper?

Not supported.

3.5 Enter the RECOVERY mode and restore the factory settings

If there is an upgrade package in the SD card, or the online update package has been downloaded, you can press the power button and the volume + button to enter the recovery mode in the off state. After then, you can press the volume up and down button, and then press the menu key to enter the appropriate function after selection.

Restore factory settings: On the home screen, click **Settings** > **Backup and reset** > **Restore factory settings**, and then click **Reset the phone**.

3.6 Does it support Dimensional code?

Not supported.

3.7 Does it support 3D acceleration?

Yes.

3.8 How to determine if the phone has been rooted by the user?

Use the adb shell command to view. If it displays \$, the phone has not been rooted. If it displays #, the phone has been rooted.

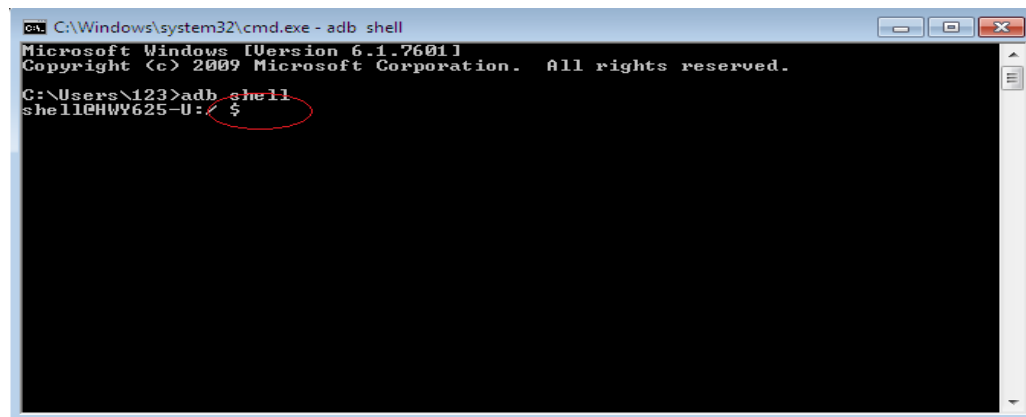

```
C:\Windows\system32\cmd.exe - adb shell
Microsoft Windows [Version 6.1.7601]
Copyright (c) 2009 Microsoft Corporation. All rights reserved.

C:\Users\123>adb shell
shell@HWY625-U:/ $
```

3.9 Does it come with a recorder?

Yes, it does.

3.10 Is there any film on the phone in delivery?

Yes.

3.11 Does it support mobile TV? How to set it?

N/A.

3.12 Does it support editing and browsing of word, excel, ppt, pdf?

Yes, you can use the preinstalled WPS office to edit or browsing these files.

3.13 How to clear the background programs of the phone?

On the home screen, hold the menu button, and click  to clear the background programs on the phone.

3.14 How to take a screenshot

In any screen, press the power button and Volume - button at the same time to capture the current screen. The drawn images are stored in the "Screenshots" folder under "Gallery" by default.

3.15 Does the phone support Google sync contacts?

Yes.

3.16 Description of hot-swappable UIM/SIM phone cards

Not supported.

3.17 Which kind of card is applicable to Y625?

Y625 supports WCDMA/GSM MicorUSIM or MicroSIM cards.

3.18 Conditions for the access to the Internet and description of the system

Y625 SLOT2 only supports the GSM network, namely, if a 4G card is used, it can only be registered to the 2G network.

The 2G mobile data is really slow. And SLOT2 is an additional card, so it cannot use mobile data unless SLOT1 is unavailable.