

## REPLACING THE SEAT PAD MOUNTING CLIPS

It is imperative that Human Touch<sup>®</sup> products are repaired in a manner that ensures product safety and regulatory compliance and that is fully consistent with the practices used during the manufacturing process. Therefore, Human Touch requires that all product repairs are performed using only factory-new parts and in accordance with these repair instructions. Failure to adhere to these instructions voids the product warranty and releases Human Touch from all liability for injury or product damage resulting from the repair.

SERVICE LEVEL: 2

**Tools Required:** Phillips-head screwdriver

**NOTE:** SAVE ALL REMOVED PARTS FOR USE DURING REASSEMBLY

1. Standing next to the chair, insert a flat-head screwdriver between the seat cushion and the chair frame, then pull up on the screwdriver to pry the seat clip away from the chair frame (Fig.1).
2. Repeat step 1 on the opposite side of the chair.

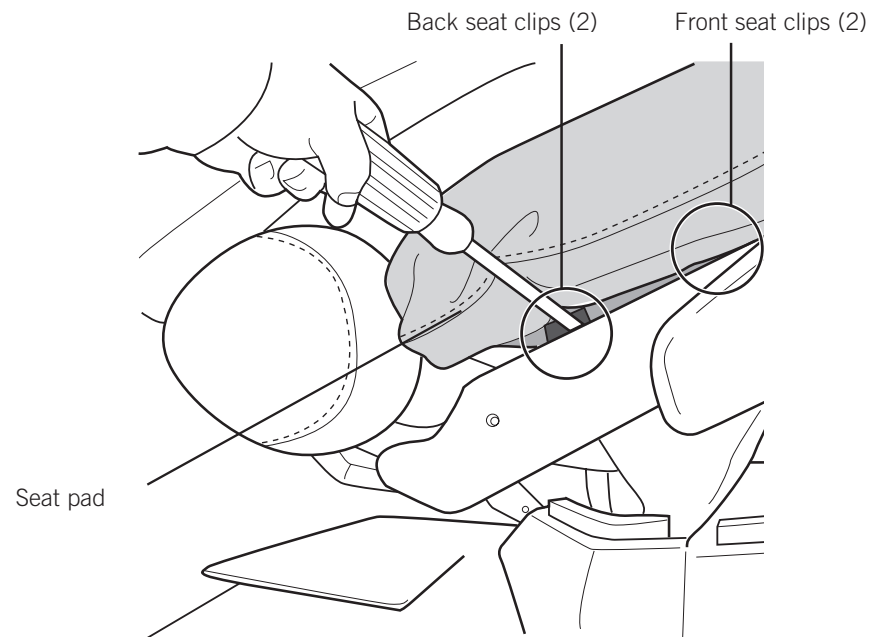

(Fig.1)

3. Standing in front of the chair, tip the seat pad upward and rest it against the backrest (Fig.2).
4. Using a Phillips-head screwdriver, remove the two screws that secure the broken mounting clip, then remove the clip (Fig.2).
5. Place the new clip into position, then secure it using the two screws.
6. Push the seat pad firmly back down into position.

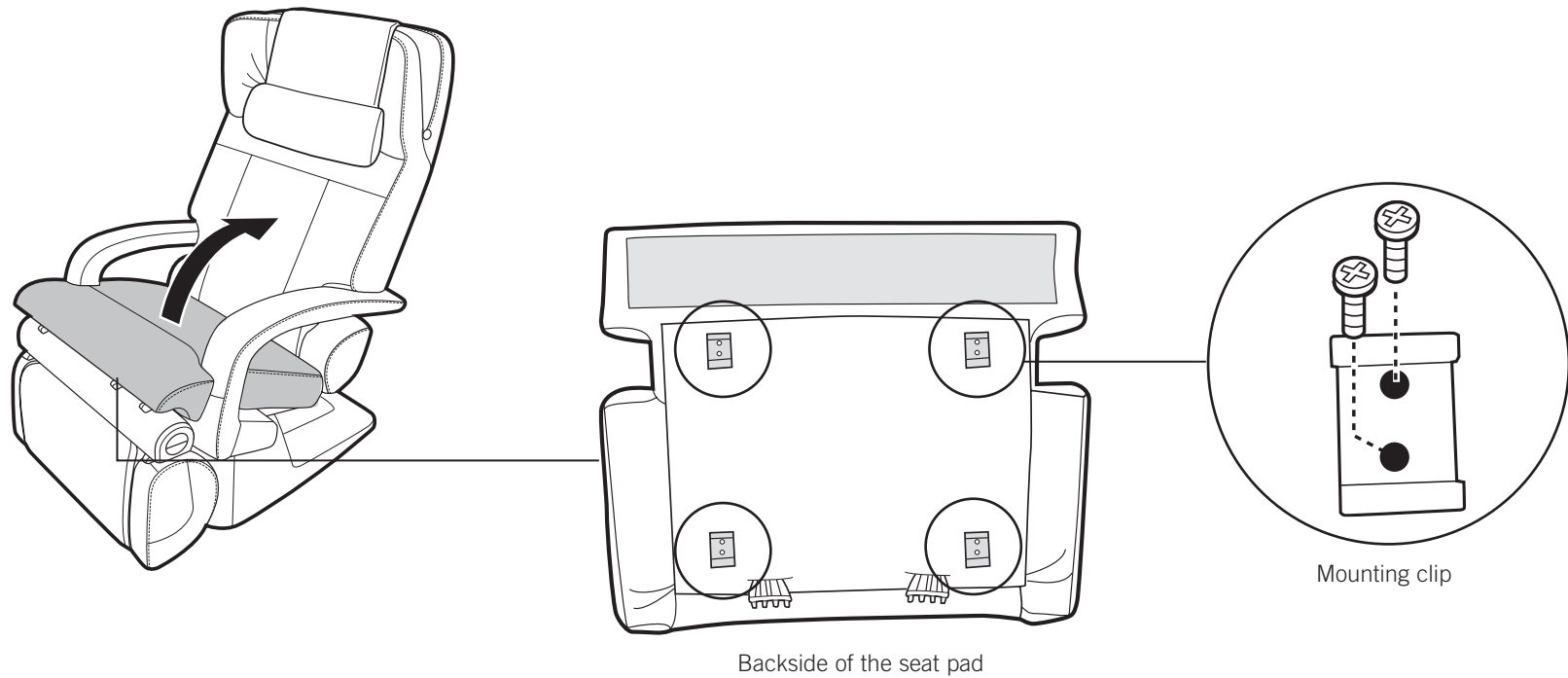

(Fig.2)