

# ***TC3700 Family Tire Changer***

***Easy-to-Use Center-Clamp Tire Changer***



**HUNTER**  
Engineering Company

# Key features at a glance

## Tilted Ergonomic Design

- ✓ Complete operation performed from one position
- ✓ Unobstructed access to the lower bead eases lubrication

## Bead Press Arm

- ✓ Assists mounting difficult assemblies

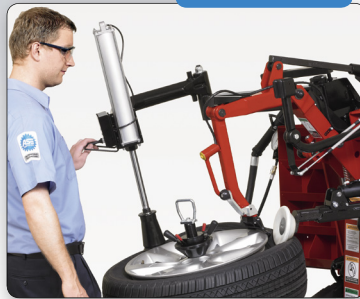

## Blast Inflation

- ✓ Directs bursts of compressed air to easily seat the bead



## Moveable Rear Column

- ✓ Adjustable to handle up to 50-inch diameter tires



## Motor and Drive

- ✓ 15- and 7-rpm clockwise speeds, 15 rpm counterclockwise speed
- ✓ 850 ft-lbs. of torque

## PowerOut™ Bead Loosener

- ✓ Ergonomic control handle makes large assembly service easy
- ✓ Familiar side shovel design with standard protector sleeve

OPTIONAL







### Mount/Demount Head

- ✓ Polymer mount/demount head resists marring rims
- ✓ Vertical locking head for wheel face protection



### EXCLUSIVE

### Bead Roller System

- ✓ Gently loosens beads
- ✓ Perform all bead loosening from an upright position



### PATENTED

### Intuitive Center Clamp and Adjustable Clamp Support

- ✓ Simple clamping technique for all designs
- ✓ Cam action multiplies clamping force
- ✓ Three height positions

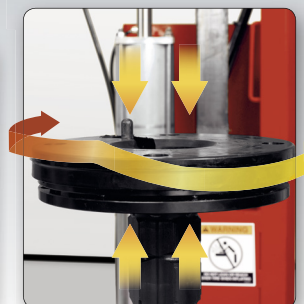
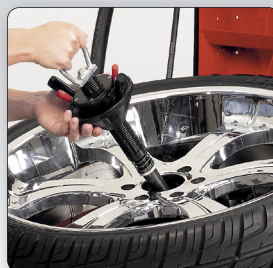

### Match-Mounting Made Easy

Hunter's TC3700 and Road Force Touch® GSP9700 wheel balancer eliminate vibration problems, reduce comebacks and increase customer satisfaction.

The bead rollers safely hold the tire stationary while the rim is rotated to complete match-mounting.



TC3700SS shown

## Clamping Adaptors

OPTIONAL

### Flange Plate for Chrome-Clad and Reverse Wheels

Useful for chrome-clad wheels and/or reverse wheels where maximum finish protection is needed. (RP6-G1000A87)



### Flange Plate for Chrome-Clad Wheels

Simplified flange plate for chrome-clad wheels only. (RP6-G1000A123)



### 19.5" Adaptor

Adapts large centerbore wheels to center-clamp tire changers. (20-2341-1)

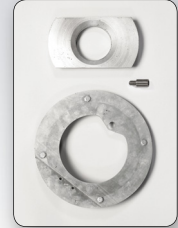

## Specifications

**Clamping system rotating speed:** 7 & 15 CW / 15 CCW

**Torque:** 850 ft-lbs.

**Electrical requirements:** 220V, 1 ph, 15 A

**Air pressure operating range:** 115-175 psi

**Tire diameter:** 50 in.

**Hydraulic bead loosening roller system:**

Max. bead roller opening width 21 in.  
Diameter range 12-28 in.  
Bead roller power; each roller 4,170 lbs. @ 140 psi

**(Optional) Side shovel:**

Max. bead loosening opening width 17 in.  
Shovel power 6,600 lbs. @ 140 psi

**Machine weight:** 560 lbs.

**Max. space dimensions:**

Width 43 in.  
Height 72 in.  
Depth 43 in.

*Wheel specifications are based on nominal wheel sizes. Some dimensions, capacities and specifications may vary depending on tire and wheel configurations and optional accessories used.*

## Wheel Lift Package

OPTIONAL

Optional wheel lift eases servicing of large assemblies. Allows for more careful handling of expensive wheels. (20-2944-1)



**Models:**

TC3700 – Traditional center-clamp tire changer

TC3700SS – TC3700 with side shovel

TC3715 – TC3700 with press arm

TC3715SS – TC3700 with press arm and side shovel

(W) Add W to the end of the model number to add Wheel lift

**Because of continuing technological advancements, specifications, models and options are subject to change without notice.**



For additional information on Hunter tire changer accessories, see Form 4042-T.

**HUNTER**  
Engineering Company

[www.hunter.com](http://www.hunter.com)

1014IAP4M.30