

Preface

Thanks for your favor in our product. To derive optimum performance from the product, please read this manual carefully before use.

This manual is applicable to the following product:

ADN-01E Wireless Audio Adapter (PD700 series)

ADN-02 Wireless Audio Adapter (X1e series)

ESW01 Wireless Earpiece

Disclaimer

Hytera Communications Co., Ltd. (the Company) endeavors to achieve the accuracy and completeness of this manual, but no warranty of accuracy or reliability is given. All the specifications and designs are subject to change without notice due to continuous technology development. No part of this manual may be copied, modified, translated, or distributed in any manner without the express written permission of us.

If you have any suggestions or would like to learn more details, please visit our website at:

<http://www.hytera.com>.

Instructions

- Ensure the distance between the wireless earpiece and the radio is within 10 meters during operation.
- Only use the wireless earpiece if traffic conditions permit safe use and check if local laws and regulations restrict the use of wireless earpiece while driving.
- Do not use the wireless earpiece during lightning storm to avoid malfunction.
- Exposure to loud noise from any source for extended periods of time may temporarily or permanently affect your hearing. Use as low a volume as possible and avoid prolonged wearing.

Items in the Package

Please unpack carefully and check that all items listed below are received. If any item is missing or damaged, please contact your dealer.

No.	Name	Qty.
1	Wireless Earpiece	1
2	Earhook	1
3	Rubber Ear Cushion	3
4	Wireless Audio Adapter	1
5	Owner's Manual	1

Function Overview

This exquisite, easy-wearing and low-powered wireless earpiece is applicable to Hytera portable radios with firmware version of 5.05 and above.

With Hands-free function, you can have convenient communication within a distance of 10 meters from the radio.

You can communicate with the wireless earpiece whether the radio supports Bluetooth feature or not.

Product Overview

Wireless Earpiece

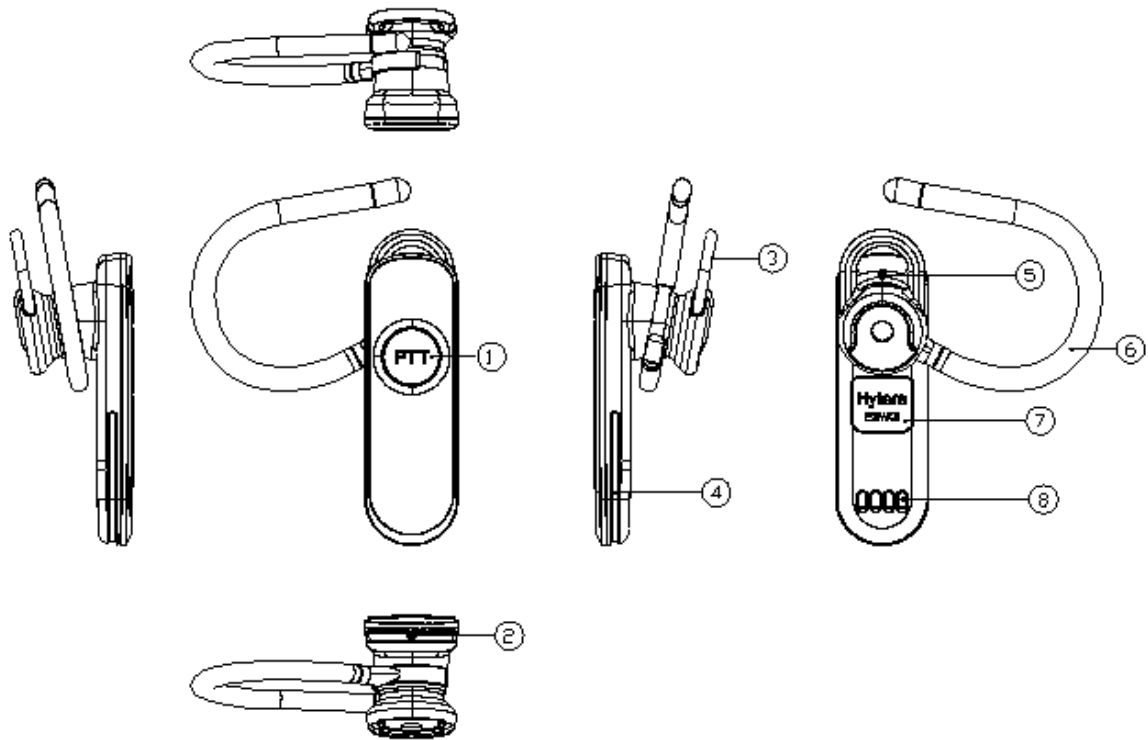

No.	Part Name	No.	Part Name
1	PTT (Push-to-talk)/Multi-functional Key	5	LED Indicator
2	MIC	6	Earhook
3	Rubber Ear Cushion	7	LOGO
4	Groove	8	Charging Piece

Wireless Audio Adapter

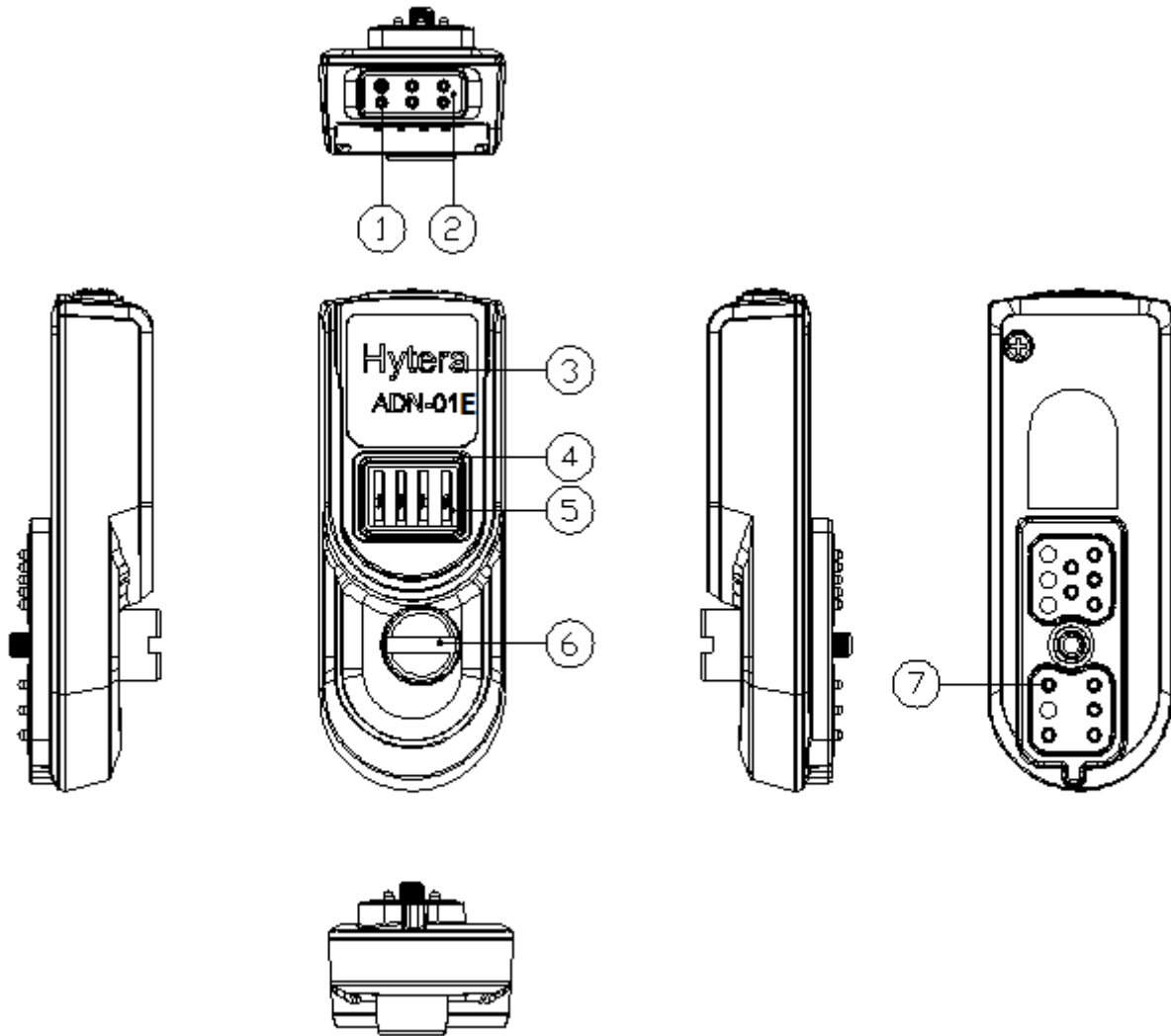

No.	Part Name	No.	Part Name
1	LED Indicator	5	Charging Piece
2	PTT (Push-to-talk) Key	6	Fixing Screw of the Adapter
3	LOGO	7	POGO Pin (10 pce.)
4	Waterproof Ring	/	/

Specification

Call Duration	>4 hours
Dust/Water Protection Class	IP54
Operation Temperature	Wireless earpiece: -20°C—+60°C Wireless Audio Adapter: -25°C—+65°C
Storage Temperature	Wireless earpiece: -40°C—+75°C Wireless Audio Adapter: -40°C—+75°C

Charging the Wireless Earpiece



Note

- To charge the wireless earpiece, simply connect it to the adapter on the radio. It is recommended to use the high-capacity battery specified by the Company to ensure the optimal operation duration of the radio.
- Charging the wireless earpiece will not affect the radio operation.
- If the earpiece is idle for a long time, charge it at least once within three months.
- If the LED indicator does not glow red while the wireless earpiece is being charged, charge the earpiece for 10 to 20 minutes.

Charge the wireless earpiece before use. The LED indicator of the wireless earpiece glows red during charging and glows blue when the wireless earpiece is fully charged. Also, the LED indicator indicates the pairing and connecting status. Please refer to LED Indication for details.

1. Connect the wireless audio adapter to the radio and secure the screw to fasten it.



2. Fix the wireless earpiece into the wireless audio adapter.
Make sure the wireless earpiece is fully fixed into the adapter.



3. Turn on the radio.

⚠ Caution:

The wireless earpiece can be charged only when the radio is powered on. Please ensure the radio is powered on when charge the radio (with battery attached) and the wireless earpiece at the same time.

Pairing with and Connecting to the Adapter

Before initial connection, the wireless earpiece needs to be paired with the adapter first. Afterwards, the wireless earpiece can connect to the adapter without pairing.

Step 1: Disconnect the wireless earpiece from other devices.

Step 2: Connect the wireless earpiece with the radio. (See Charging the Wireless Earpiece for details)

Step 3: Turn on the radio, and the wireless earpiece will be powered up.

Step 4: The wireless earpiece will be paired with and connected to the adapter automatically.

- Pairing mode: The LED indicator of the wireless earpiece/adapter flashes red and blue alternatively.
- Connecting status: The LED indicator flashes blue rapidly after the connection is complete.

Wearing the Wireless Earpiece

 **Tips:** There are three rubber ear cushions with different sizes provided with the wireless earpiece for your comfortable wearing.

Wear the wireless earpiece after the connecting is complete. Adjust the rubber ear cushion to position it into your ear canal, and adjust the earhook to secure the earpiece.



Transmitting

After detaching the wireless earpiece from the adapter, you can hold down the **PTT** key on the wireless earpiece or the **PTT** key on the adapter to make a call.

Powering On/Off

The wireless earpiece will give ring indication (you can hear it only when you are wearing the wireless earpiece) upon power-on/off.

Power On

- Automatic power-on: When attached to the radio via the adapter, the wireless earpiece will be powered on automatically when the radio is turned on.

- Manual power-on: When the wireless earpiece is not attached with the adapter, you can power on the wireless earpiece by long pressing the **PTT** key on it. The adapter can be powered on by turning on the radio only.

The LED indicator flashes after the wireless earpiece is powered on. Please refer to LED Indication for indication details.

Power Off

Turn off the radio to power off the adapter.

To power off the wireless earpiece, long press the **PTT** key when the LED indicator flashes blue slowly. Moreover, the wireless earpiece will be powered off with a ring indication automatically when it is not connected within 5 minutes.

The LED indicator goes out when the wireless earpiece is powered off.

LED Indication

Caution:

- When the wireless earpiece is being charged on the adapter, the LED indicator glows red when charging is in process; the LED indicator glows blue when the wireless earpiece is fully charged. In this case, the following indications are not applicable. You can identify the status of the wireless earpiece via the LED indication of the adapter. You can also detach the wireless earpiece from the adapter to identify the status of the wireless earpiece.
- The following indications do not include the charging indications.

LED Indication	Earpiece Status
The LED indicator flashes red and blue alternatively.	Pairing
The LED Indicator glows red.	Transmitting
The LED indicator flashes red.	Low battery power (applicable to wireless earpiece only)
The LED indicator flashes blue twice rapidly.	Connected with no voice
The LED indicator flashes blue	Connected with voice

LED Indication	Earpiece Status
once rapidly.	
The LED indicator flashes blue slowly.	Paired but not connected

Troubleshooting

Phenomena	Analysis	Solution
The LED indicator does not glow red while the wireless earpiece is being charged.	The battery power of the wireless earpiece may run out completely.	Charge the wireless earpiece for 10 to 20 minutes.
The wireless earpiece cannot pair with the adapter.	The wireless earpiece or the adapter may pair with other wireless devices.	Move away from other wireless devices and restart the radio to pair the wireless earpiece with the adapter.

FCC Notice:

This device complies with Part 15 of the FCC rules. Operation is subject to the following two conditions: (1) This device may not cause harmful interference. (2) This device must accept any interference received, including interference that may cause undesired operation.

NOTE: This equipment has been tested and found to comply with the limits for a Class B digital device, pursuant to Part 15 of the FCC rules. These limits are designed to provide reasonable protection against harmful interference in a residential installation. This equipment generates uses and can radiate radio frequency energy and, if not installed and used in accordance with the instructions, may cause harmful interference to radio communications. However, there is no guarantee that interference will not occur in a particular installation. If this equipment does cause harmful interference to radio or television reception, which can be determined by turning the equipment off and on, the user is encouraged to try to correct the interference by one or more of the following measures:

- Reorient or relocate the receiving antenna.
- Increase the separation between the equipment and receiver.
- Connect the equipment into an outlet on a circuit different from that to which the receiver is connected.
- Consult the dealer or an experienced radio/TV technician for help.

WARNING: Changes or modifications not expressly approved by the party responsible for compliance could void the user's authority to operate the equipment.

RF Exposure

The equipment complies with FCC radiation exposure limits set forth for an uncontrolled environment.

IC Notice:

This device complies with Canada Industry licence-exempt RSS standard(s). Operation is subject to the following two conditions:

- (1) this device may not cause interference; and
- (2) this device must accept any interference. Including interference that may cause undesired operation of the device.

Cet appareil est conforme aux CNR exemptes de licence d'Industrie Canada . Son fonctionnement est soumis aux deux conditions suivantes :

- (1) Ce dispositif ne peut causer d'interférences ; et
- (2) Ce dispositif doit accepter toute interférence , y compris les interférences qui peuvent causer un mauvais fonctionnement de l'appareil.

CAN ICES-3 (B)

Avis d'Industrie Canada

Le présent appareil est conforme aux CNR d'industrie Canada applicables aux appareils radio exem pts de licence L'exploitation est autorisée aux deux conditions suivantes:

- 1) l'appareil ne doit pas produire de brouillage; et
- 2) l'utillsateur de l'appareil doit accepter brouillage radioélectrique subi meme si le brouillage est susceptible d'encompromettre le fonctionnement. mauvais fonctionnement de l'appareil.

Cet appareil numérique de la classe B est conforme à la norme NMB-003 du Canada.

CAN NMB-3 (B)

Radiation Exposure Statement:

This equipment complies with IC radiation exposure limits set forth for an uncontrolled environment.

Déclaration d'exposition aux radiations:

Cet é quipement est conforme aux limites d'exposition aux rayonnements IC é tablies pour un environnement non contrôlé .

Caution

- 1.Risk of explosion if battery is replaced by an incorrect type. Dispose of used batteries according to the instructions.
- 2.The max operating of the EUT is 60°C. and shouldn't be lower than -20°C.
- 3.Declaration of Conformity

We, Hytera Communications Corporation Limited

hereby, declare that the essential requirements compliance with the Directive 2014/53/EU.

have been fully fulfilled on our product with indication below:

Product Name: Bluetooth adapter

Brand Name : Hytera

Model : ADN-01E

This product can be used across EU member states.