

RESETTING THE AP-95M

If you cannot access the AP-95M setting screen, you can reset the AP-95M.

- This resets all settings to the factory defaults.
- If you can access the setting screen, see the AP-95M instruction manual (PDF) to reset from the setting screen.

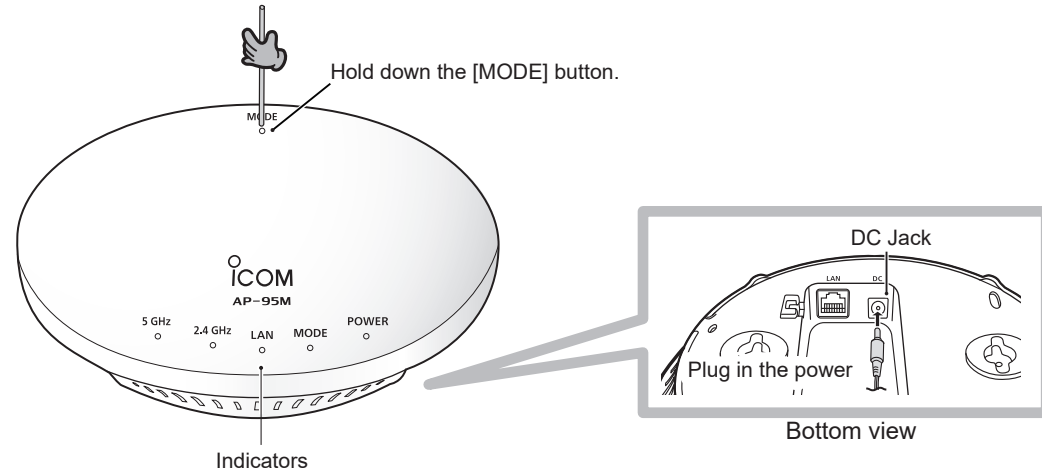

- 1 Disconnect all cables from the AP-95M, and then connect the power adapter.
 - Confirm that the [POWER] indicator is lit in green.
 - The other indicators status may differ, depending on the operation status.
- 2 Hold down [MODE] with a pin on the top panel until all indicators light green.
- 3 Confirm that all indicators are lit in green, and then release [MODE].
 - When the initialization has been completed, the [POWER] indicator lights green.

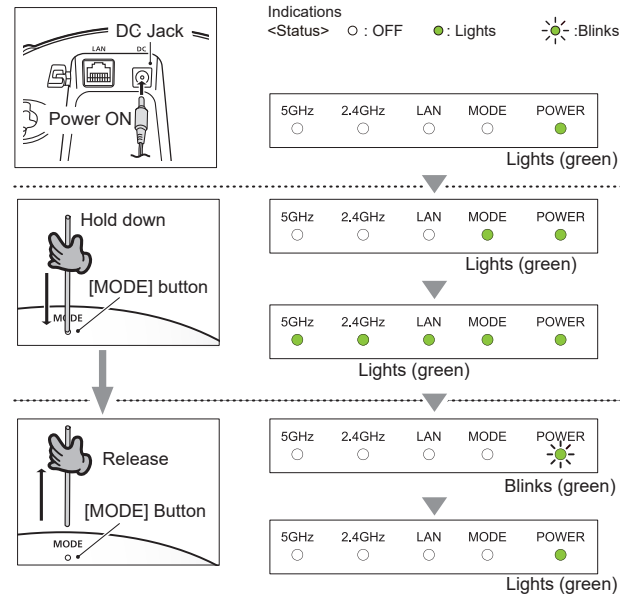

Icom, Icom Inc. and the Icom logo are registered trademarks of Icom Incorporated (Japan) in Japan, the United States, the United Kingdom, Germany, France, Spain, Russia, Australia, New Zealand, and/or other countries. All other products or brands are registered trademarks or trademarks of their respective holders.

IEEE802.11ac Wave 2 standard

Thank you for purchasing this Icom product. The AP-95M WIRELESS ACCESS POINT is designed and built with Icom's IP network technology. It complies with the "IEEE802.11ac Wave 2" standard, and is designed for dual band communications in the 5 GHz and 2.4 GHz bands.

IMPORTANT

READ ALL INSTRUCTIONS carefully and completely before using the AP-95M.

SAVE THESE INSTRUCTIONS — These instructions contain important safety and operating instructions for the AP-95M.

EXPLICIT DEFINITIONS

WORD	DEFINITION
WARNING!	Personal injury, fire hazard or electric shock may occur.
CAUTION	Equipment damage may occur.
NOTE	If disregarded, inconvenience only. No risk of personal injury, fire or electric shock.

PRECAUTIONS

■ For the AP-95M

WARNING! NEVER use other than the specified power adapter. This may result in an electrical shock, cause a fire or damage the AP-95M.

WARNING! NEVER use non-specified accessories. This may result in an electrical shock, cause a fire or damage the AP-95M.

WARNING! NEVER attempt to connect the power adapter to other than the [DC] jack on the AP-95M bottom panel. This may result in an electrical shock, cause a fire or damage the AP-95M.

WARNING! NEVER disassemble, modify or repair the AP-95M. This may result in an electrical shock, cause a fire or damage the AP-95M.

WARNING! NEVER install the AP-95M in a wet place or outside. This may result in an electrical shock, cause a fire or damage the AP-95M.

WARNING! NEVER operate or touch the AP-95M with wet hands. This may result in an electrical shock or damage the AP-95M.

WARNING! NEVER connect the ground terminal to a gas or electric pipe. This may result in an electrical shock or cause a fire.

WARNING! NEVER use the AP-95M during a thunder and lightning storm. Using it may result in an electrical shock, cause a fire or damage the AP-95M. Always disconnect the power adapter before a storm.

WARNING! NEVER immediately disconnect the power adapter if the AP-95M emits an abnormal odor, sound or smoke. Contact your Icom dealer or distributor for advice.

WARNING! NEVER put the AP-95M in any unstable place (such as on a slanted surface or vibrating place). This may cause injury and/or damage to the AP-95M.

CAUTION: NEVER install the AP-95M in a place without air vents. Heat dissipation may be reduced, and this could damage the AP-95M.

CAUTION: DO NOT use the AP-95M near a television or radio. This could cause harmful interferences.

CAUTION: DO NOT use or place the AP-95M in areas with temperatures below -10°C (+14°F) or above +55°C (+131°F).

CAUTION: DO NOT place the AP-95M in direct sunlight. This could damage the AP-95M.

CAUTION: DO NOT use the AP-95M in strong magnetic fields or in an area with high static electricity. This could damage the AP-95M.

CAUTION: Disconnect the power adapter when you will not use the AP-95M for a long period of time.

CAUTION: DO NOT use harsh solvents such as benzene or alcohol to clean the AP-95M, as they can damage the AP-95M's surfaces. If the AP-95M becomes dusty or dirty, wipe it clean with a dry, soft cloth.

Always place the AP-95M in a secure place to avoid inadvertent contact with children.

PRECAUTIONS (Continued)

■ For the power adapter

⚠ **WARNING! NEVER** use the power adapter with any device other than the AP-95M. This may result in an electrical shock, cause a fire or damage the power adapter.

⚠ **WARNING! NEVER** connect the adapter into an outlet that is not between 100 V and 240 V AC. Otherwise, this may result in an electrical shock, cause a fire or damage the power adapter.

⚠ **WARNING! NEVER** install the power adapter to wet place outside or near a humidifier. This may result in an electrical shock, cause a fire or damage the power adapter.

⚠ **WARNING! NEVER** put something heavy on the power adapter cable. This may result in an electrical shock, cause a fire or damage the power adapter.

⚠ **WARNING! NEVER** modify, bend by force, twist, pull or heat the power adapter's cable. This may result in an electrical shock, cause a fire or damage the power adapter.

⚠ **WARNING! NEVER** touch the power adapter with wet hands. This may result in an electrical shock or damage the power adapter.

⚠ **WARNING! NEVER** use or place the power adapter and connection cable where they could be inadvertently used by children. This may result in an electrical shock or cause injury.

■ Other precautions

- For information about operating the PC or external devices, refer to their instruction manuals for details.
- The optional power adapter may at some time need to be replaced, depending on its life expectancy. The life of a power adapter differs according to the environment or condition in which the adapter is used.

We recommend replacement when it has been used for approximately 5 years (When used under the ambient temperature of 25°C: 77°F). Contact your local dealer for details.

RF Exposure Warning

This equipment must be installed and operated in accordance with provided instructions and the antenna(s) used for this transmitter must be installed to provide a separation distance of at least 23 cm from all persons and must not be co-located or operated in conjunction with any other antenna or transmitter. End-users and installers must be provided with antenna installation instructions and transmitter operating conditions for satisfying RF exposure compliance.

FCC INFORMATION

This device complies with part 15 of the FCC Rules. Operation is subject to the following two conditions: (1) This device may not cause harmful interference, and (2) this device must accept any interference received, including interference that may cause undesired operation.

Changes or modifications to this device, not expressly approved by Icom Inc., could void your authority to operate this device under FCC regulations.

FOR CLASS B UNINTENTIONAL RADIATORS:

This equipment has been tested and found to comply with the limits for a Class B digital device, pursuant to part 15 of the FCC Rules. These limits are designed to provide reasonable protection against harmful interference in a residential installation. This equipment generates, uses and can radiate radio frequency energy and, if not installed and used in accordance with the instructions, may cause harmful interference to radio communications. However, there is no guarantee that interference will not occur in a particular installation. If this equipment does cause harmful interference to radio or television reception, which can be determined by turning the equipment off and on, the user is encouraged to try to correct the interference by one or more of the following measures:

- Reorient or relocate the receiving antenna.
- Increase the separation between the equipment and receiver.
- Connect the equipment into an outlet on a circuit different from that to which the receiver is connected.
- Consult the dealer or an experienced radio/TV technician for help.

Radiation Exposure Statement:

This equipment complies with FCC radiation exposure limits set forth for an uncontrolled environment. This equipment should be installed and operated with minimum distance 23 cm between the radiator & your body.

FCC Caution:

Any changes or modifications not expressly approved by the party responsible for compliance could void the user's authority to operate this equipment.

This transmitter must not be co-located or operating in conjunction with any other antenna or transmitter.

WIRELESS LAN INFORMATION

■ Precautions on using the wireless LAN

For the Canadian version

- Operation of this device in the 5150 ~ 5250 MHz frequency range is restricted to indoor operation only.
- Outdoor operation in the 5150 ~ 5250 MHz frequency range is prohibited.

For all versions

- This product has the frequency range approved only for indoor use. Follow the restrictions of the laws and regulations of each country.
- We recommend that users with pacemakers take precautions to be sure that this device does not cause them a problem because of electromagnetic interferences.
- Do not use this device near microwave ovens. A microwave oven may cause electromagnetic interference to the communications through this device.
- Do not modify the device. The device warranty does not cover any problems caused by unauthorized modification.

■ Communicating with the 40/80 MHz bandwidth

- When you are using the 40 MHz or 80 MHz bandwidth mode on the wireless LAN, first check the radio wave environment around in order to not to interfere other radio stations.
- In case you have harmfully interfered a radio station using this device, set the "Bandwidth" to "20 MHz (default)."
 - Refer to the instruction manual on the Icom website about the bandwidth details.

■ Wireless LAN installation location

Have the following installation conditions under consideration so that the communication range and speed are not affected.

- Data communication errors may occur if the wireless LAN terminal and this device are too close to each other. Keep them at least 1 meter (3.3 ft) away from each other.
- Install the device in as open a place as possible indoors.
- Install the device in a stable place where there is no danger of falling or vibration.
- Do not place anything on top of this device.
- The communication range expands in an open space. However, in such location as warehouses with metallic walls, the walls may cause the radio waves to reflect. Radio waves may pass through a wall or window, but not through metal. Some concrete walls are metal reinforcing structures, and may intercept the communication. Heat absorbing glass or IR reflecting glass may intercept the communication.
- Communication may not be able to be performed with a wireless LAN installed on a different floor.

SAFETY TRAINING INFORMATION

This device was tested and approved with original accessories to ensure FCC Compliance. The use of third-party accessories may not comply with FCC RF exposure compliance requirements, and should be avoided.