

Prüfbericht - Nr.:
Test Report No.

14009434 001

Seite 5 von 5
Page 5 of 5



WARNINGS Changes or modifications not expressly approved by the party responsible for compliance could void the user's authority to operate the equipment.

NOTE This equipment has been tested and found to comply with the limits for a Class B digital device, pursuant to Part 15 of the FCC Rules. These limits are designed to provide reasonable protection against harmful interference in a residential installation.

This equipment generates, uses and can radiate radio frequency energy and, if not installed and used properly, it may cause harmful interference to radio communications. However, there are no guarantees that interference will not occur in a particular installation. If this equipment does cause harmful interference to radio or television reception, which can be determined by turning the equipment off and on, the user is encouraged to try to correct the interference by one or more of the following measures:

- Reorient or relocate the receiving antenna.
- Increase the separation between the equipment and receiver.
- Connect the equipment into an outlet on a circuit different from that to which the receiver is connected.
- Consult the dealer or an experienced radio / TV technician for help.

DECLARATION OF CONFORMITY

The following information is not to be used as contact for support or sales. Please call our customer service number (listed on our website at www.oregonscientific.com) or on the warranty card for this product for all inquiries instead.

We
Name: Oregon Scientific, Inc.
Address: 19851 SW 95th Ave., Tualatin, Oregon 97062 USA
Telephone No.: 1-800-853-8883

declare that the product

Product No.: THR123N/THR123N
Remote Thermo Sensor / Remote Thermo-Hygrometer Sensor
Product Name: Remote Thermo Sensor
Address: Block C, 9F, Kaiser Estate,
Phase 1, 41 Man Yue St.,
Hong Kong, Kowloon.

is in conformity with Part 15 of the FCC Rules. Operation is subject to the following two conditions: 1) This device may not cause harmful interference. 2) This device must accept any interference received, including interference that may cause undesired operation.

EC-DECLARATION OF CONFORMITY

Hereby, Oregon Scientific, declares that this Remote Sensor (THR123N/THR123N) is in compliance with the essential requirements and other relevant provisions of Directive 1999/5/EC.

A copy of the signed and dated Declaration of Conformity is available on request via our Oregon Scientific Customer Service.



WARNINGS

This product is designed to give you years of service if handled properly. Oregon Scientific does not warrant the product against wear, tear, or damage caused by use of the product. Observe the following guidelines:

- Never immerse the product in water. This can cause electrical shock and damage the product.
- Do not subject the product to extreme force, shock, or fluctuations in temperature or humidity.
- Do not mix new and old batteries or batteries of different types.
- Do not use rechargeable batteries or batteries of different types.
- Remove the batteries if storing this product for a long period of time.

NOTE The technical specification of this product and contents of this user guide are subject to change without notice. Images not drawn to scale.

TROUBLESHOOTING

PROBLEM	SYMPTOM	REMEDY
Remote sensor	Cannot locate remote sensor	Check location
	Data does not match main unit	Initiate a manual sensor search

SPECIFICATIONS

DIMENSIONS

L x W x H
69 x 66 x 20 mm
(3.5 x 2.6 x 0.79 inches)
Weight
83 grams (2.22 ounces)
without battery

TEMPERATURE

Outdoor range
-32 F to 140 F
(-30 C to 60 C)
Resolution
0.2 F / 0.1 C

HUMIDITY - THRH23N ONLY

Range
25%-95%

TRANSMISSION

RF frequency
433 MHz
Transmission
Every 40 seconds
Channel No.
1 - 3

POWER

Sensor batteries
2 x UM-3 (AA) 1.5V

NOTE It is recommended that you use alkaline batteries with this product for longer performance. However, if you want to use the sensor in colder temperatures (i.e. 10°F (-12°C) to -40°F (-40°C)), it is recommended that you use lithium batteries.

ABOUT OREGON SCIENTIFIC

Visit our website (www.oregonscientific.com) to learn more about Oregon Scientific products such as digital cameras; MP3 players; children's electronic learning products and games; projection clocks; health and fitness gear; weather stations; and digital and analog watches. For more information, please contact our Customer Care department in case you need to reach us, as well as frequently asked questions and customer downloads.

We hope you will find all the information you need on our website, however if you're unable to find what you need, please contact our Customer Care department directly, please visit:

www2.oregonscientific.com/services/support

OR
Call 1-800-853-8883.

For international inquiries, please visit:

www2.oregonscientific.com/about/international

FCC STATEMENT

This device complies with Part 15 of the FCC Rules. Operation is subject to the following two conditions: (1) This device may not cause harmful interference, and (2) This device must accept any interference received, including interference that may cause undesired operation.

NOTE Do not use rechargeable batteries.

NOTE It is recommended that you use alkaline batteries with this product for longer performance. However, if you want to use the sensor in colder temperatures (i.e. 10°F (-12°C) to -40°F (-40°C)), it is recommended that you use lithium batteries.

Standard Alkaline batteries contain significant amounts of water. Because of this they will freeze in low temperatures of approximately 10°F (-12°C). Disposable Lithium batteries have a much lower threshold for temperature with an estimated freezing range of below -40°F (-40°C).

Wireless ranges can be impacted by a variety of factors such as extremely cold temperatures, high humidity, and physical obstructions. The effectiveness of the sensor and the base station, if the unit's performance falls due to low temperature, the unit will resume proper functioning as the temperature rises to within the normal temperature range (i.e. no permanent damage will occur to the unit due to low temperatures).

TABLE STAND OR WALL MOUNT

To use the remote sensor stand or wall mount:

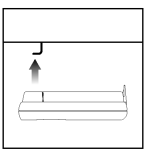

SET UP SENSOR

1. Slide open the battery compartment.
2. Insert the batteries, matching the polarity (+ and -) as shown in the battery compartment.

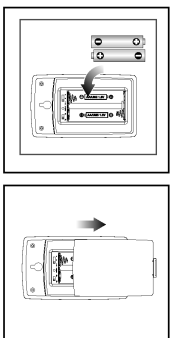

SWITCH

Channel 1-3. If you are using more than one sensor, select a different channel for each sensor.

3. Set the channel. The switch is located in the battery compartment.
4. Place the sensor near the main unit. Press **RESET** on the sensor. Then, press the appropriate main unit button (as specified in the main unit manual) to initiate signal transfer. The sensor will blink for approximately 3 minutes while it is transferring to the sensor.
5. Check the remote sensor battery compartment.
6. Secure the sensor in the desired location using the wall mount or table stand.

For best results:

- Insert the batteries and select the channel before you mount the sensor.
- Place the sensor out of direct sunlight and moisture.
- Make sure the distance between the sensor and the main unit is no further than the transmission range stated in the main unit user manual.
- Position the sensor so that it faces the main (indoor) unit, minimizing obstructions such as doors, walls, and furniture.
- Place the sensor in a location with a clear view to the sky, away from metallic or reflective surfaces.
- Position the sensor close to the main unit during cold winter months as below-freezing temperatures may affect battery performance and signal transmission.

You may need to experiment with various locations to get the best results.

SAFETY AND CARE

Observe the safety instructions, flame, elect, and related files, mild detergent. Avoid dropping the product or placing it in a high-traffic location.

Remote Thermo Sensor
Remote Thermo-Hygrometer Sensor
MODEL: THR123N
MODEL: THRH123N
USER MANUAL

INTRODUCTION

Thank you for selecting the Oregon Scientific™ Remote Sensor (THR123N/THR123N). This product is compatible with various wireless weather station products.

Keep this manual handy as you use your new product. It contains practical step-by-step instructions, as well as technical specifications and warnings you should know.

PRODUCT OVERVIEW

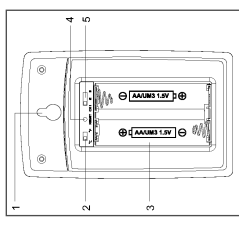
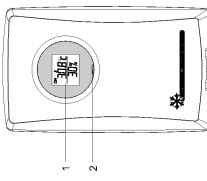

THR123N

1. CHANNEL number (1-3)
2. Temperature reading
3. Low battery icon

THRH123N

1. CHANNEL number (1-3)
2. Temperature reading
3. Humidity reading
4. Low battery icon

GETTING STARTED

BATTERIES

Remote unit
2 x UM-3 (AA) 1.5V batteries

Insert batteries before first use, matching the polarity (+ and -) as shown in the battery compartment. For best results, install batteries in the remote sensor before the main unit. Press **RESET** after each battery change.