

Quick Start Guide

1 Layout

A
Camera
Two Megapixels

B
Stylus

C
Micro SD Slot

D
Earphone Jack

E
Microphone

F
RESET

G
Keyboard

H
LED

I
HDMI Jack

J
USB/Charger
Jack

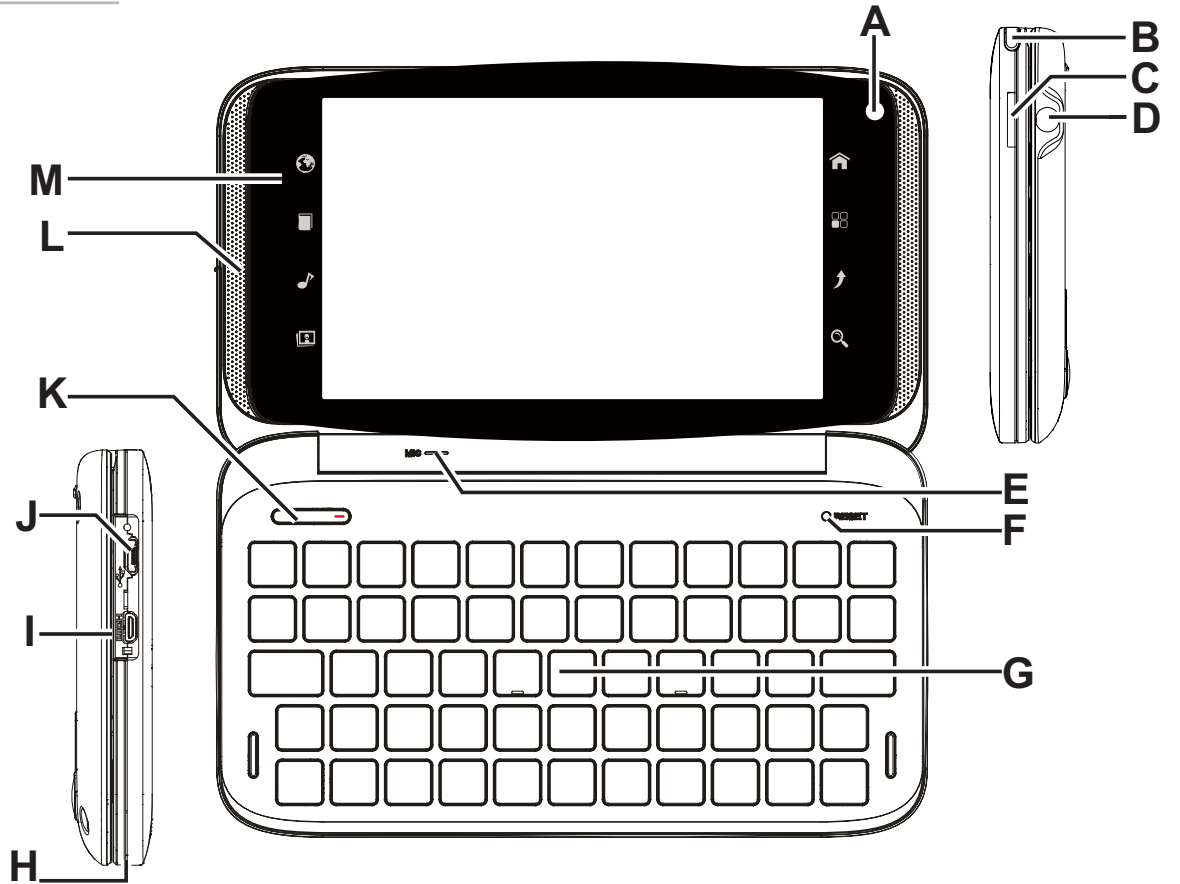

K
ON/OFF Key

L
Speaker
The left and right
channels are on the
either side of the device.

M
Touch Panel
Browser, EPUB, Music,
Gallery, Home Page,
Function Key, ESC,
Search Key

2 First Use & Preparation

Power Source & Charger

Rechargeable Li-batteries Inside: 2500mAh

Power Source: USB cable/USB+adaptor (It is good for the device to use the specified adaptor of the device. It is available to use 1A/2A adaptor of other brand. Such as Iphone, HTC etc.)

- Connect device with power source as shown on the right
- LED

b. LED

 will show the charging state

LED keep flashing: charging...

LED keep intermittently flashing: unusual charging

LED keep lighting: charging complete

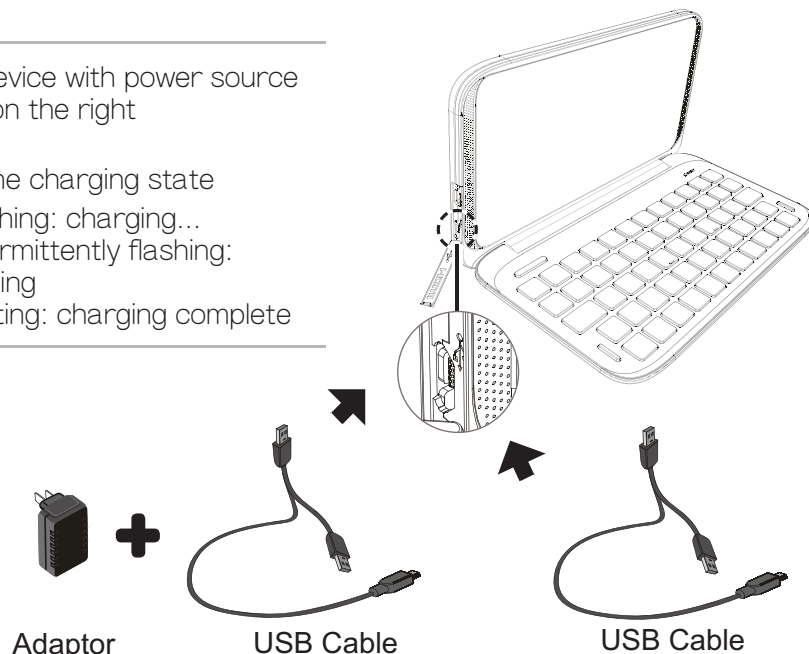

Micro SD Card

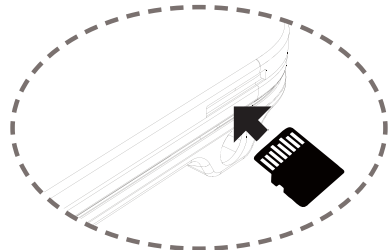

- Insert a card: switch off the device first. Gently push the card into the card jack until you hear a sound.

- Remove a card: switch off the device first. Gently press the card until you hear a sound.

- For avoiding flicking of the card, please gently press the card.
- When transfer or open files on Micro SD, in order to avoid data loss or abnormal of the data. Please make sure the power is off, before inserting and removing card.

Power On/Off

Power Off: Long press ON/OFF key and then choose "Power off"

Interval: When the device is unused, please press ON/OFF key gently. The screen enters power-saving mode.

Awakening: On power-saving mode, press ON/OFF key to awaken this mode.

Power On: Long press ON/OFF key till the start-up picture is shown.



Make sure the battery quantity is below 5% at the first three charge, so that the battery could achieve the best condition. We suggest you repeat this at each quarter.

3 Touch-control Screen

It is good for the device to use the provided stylus.

- Selection-tapping:

Choose the function on the screen and tap it gently with the stylus. Make sure the stylus leave the screen after tapping.

- Long-tapping:

Open a new menu option or activate a selected option.

- Dragging:

Drag the stylus without its tip leaving the screen. By that way, you could choose or move the selected option.

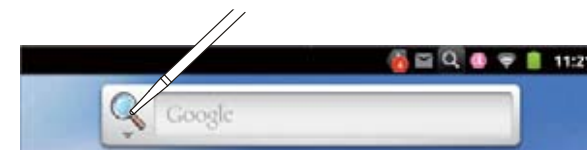

- Sliding:
Fast slide the screen and then browse the option.

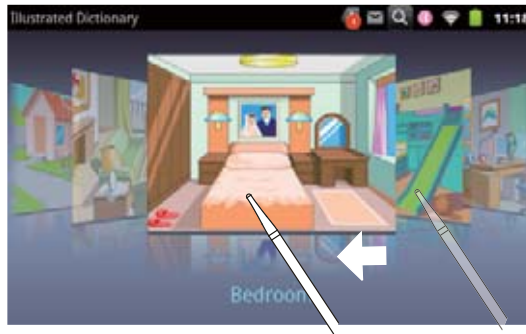

4 Keyboard

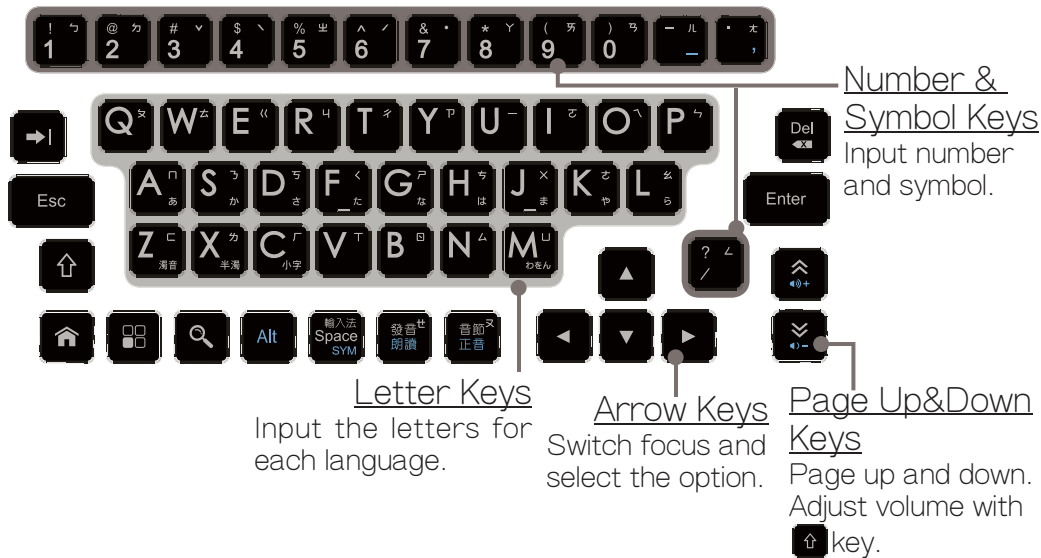

Description of Other Keys



Tab

The same as Tab key of PC.



Esc

Return to the previous operation.



Shift

Combine with other keys.
Switch between small and capital letters.



Home Page

Back to the home page.



Function Key

Open the function menu.



Search

Open the search function on the device's system.



Alt

The same as Alt key of PC.
Combine with other keys with blue sign.



Space

Input a space.
Press [Shift]+[Space], select the input method.
Press [Alt]+[Space] ,select the symbol method.



Pronunciation 1

Pronunciation.
[Alt]+[Pronunciation 1], read the whole passage.



Pronunciation 2

Pronounce syllable by syllable.
[Alt]+[Pronunciation 2], open the pronunciation correction.



Del

Delete the selected string or letter.



Enter

Confirm the current action.
Move the cursor to the next line to input the data.

5 Home Page & Function List

Home page provides applications, you could add new items for your home page.



Status Bar

Display the time, battery quantity and so on.

Mini Tools

Searchable items: Web, Apps, Contacts, Music, Search Engine, Super Knowledge Tank.

Transparent Tool Bar

Browser, Function List, Search Engine.

Page Shown

You could page up and down and long tap to edit the home page.

Icons



Tap to open the application.

Home Page

- View
You could slide page by page with the stylus on the home page.
- Add & Customize
Press  at the home page to open the function list.



Add	Add mini tools, files to the home page. And you could also customize your wallpaper of the home page.
Manage Apps	View the download status, storage position, implementation of state etc.
Wallpaper	You could customize your wallpaper of the home page.
Guide	View the operation guide of the device.
Setting	The shortcut to the device's settings.
Notifications	View the notifications of the device.

- Move & Delete
Long tap any applications on the home page, the icon of this application would be enlarged. In this state you could drag it to any position on the home page (each pages of the home page is available). At the same time,  will display on the home page. Drag the application to , this application will be deleted.

Status Bar

Display the time, battery quantity and notification sign (such as input method, new mail, warning) etc.

- Sign

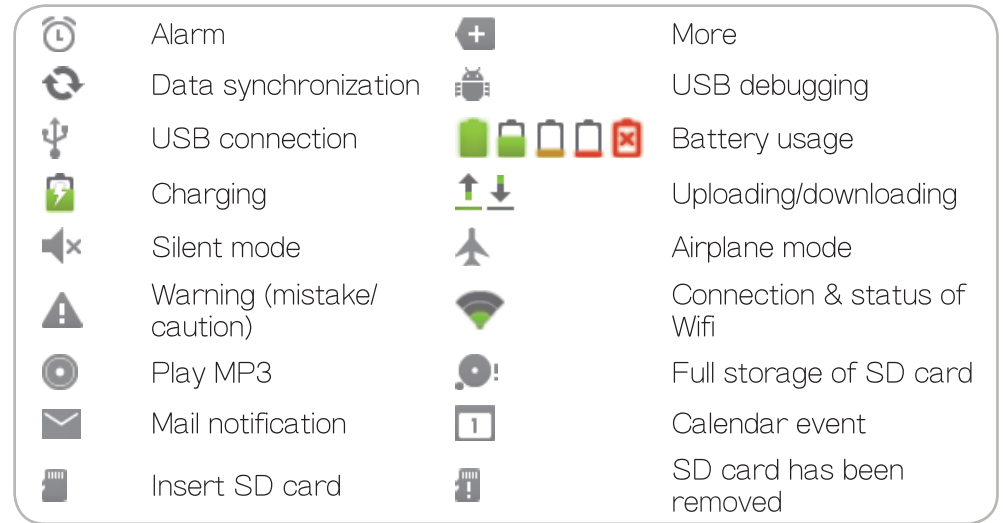

Page Shown



Delete Page

Add New Page

- Tap the page shown to view the content of each pages.
- Long tap it to open the page management. You could add or delete pages.

6 Input Method

The device provides many kinds of input methods including keyboard, soft keyboard and handwriting recognition input. By these methods, you could input symbol, number, and multi-languages.

Step

- Tap the input area, the input keyboard would open automatically.
- Tap  to open the list of the input method.



: The language of the input method.

: Handwriting input method.

Soft Keyboard: Soft keyboard input method.

• Keyboard

You could input multi-languages through the keyboard of the device.

For example: Smart Phonetic Symbols, Pinyin of Phrase Input ㄨㄛˊ ㄎㄜˋ ㄉㄜˊ ㄩˋ

◀ 無敵科技 無抵抗 舞蹈 屋頂 誤導 無敵 ▶

Input ba'x'gh

◀ 1.八仙過海 2.巴西果 3.八仙果 4.巴縣 ▶

- Input the first letter or phonetic symbol for recognition.
- Input the Pinyin of the phrase for recognition.

• Soft Keyboard (take English soft keyboard as an example)

: Handwriting

: Input method Setting

: Close soft keyboard



• Handwriting



: Handwriting box inputting

: Full-screen Inputting

123: Number Inputting

7 Networks & Downloading

Wi-Fi Setting

Tap  and then tap [Settings], choose [Wireless & networks] click Wi-Fi, it would be activated. The device begins to search available networks automatically.

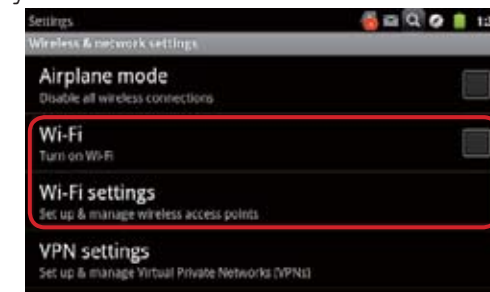
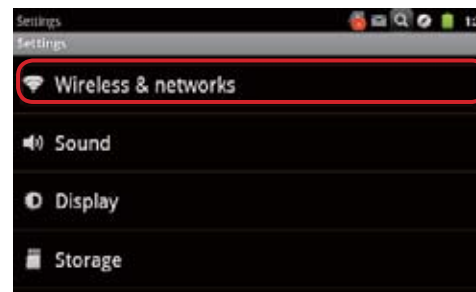

After finding available Wi-Fi networks, click to connect. If need password, input the password to connect.

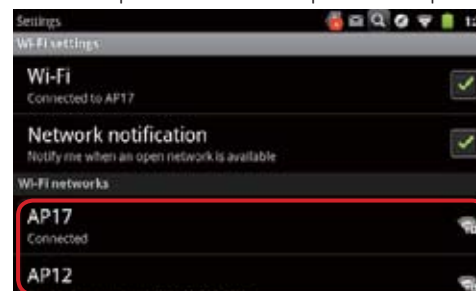

On-line Downloading

Tap 『安卓市场』 to download needed applications after networks connection.



⚠ If you want to input simplified Chinese when searching, you could choose handwriting. By this way, you could "input traditional to simplified Chinese". And the simplified Chinese would be shown on the screen.

- Application List
Tap 『首页』 and 『分类』 to look up on-line application lists.
- Search
You could search the on-line applications that you want to.
- Downloading Management
It shows the applications' installation, update, downloading.

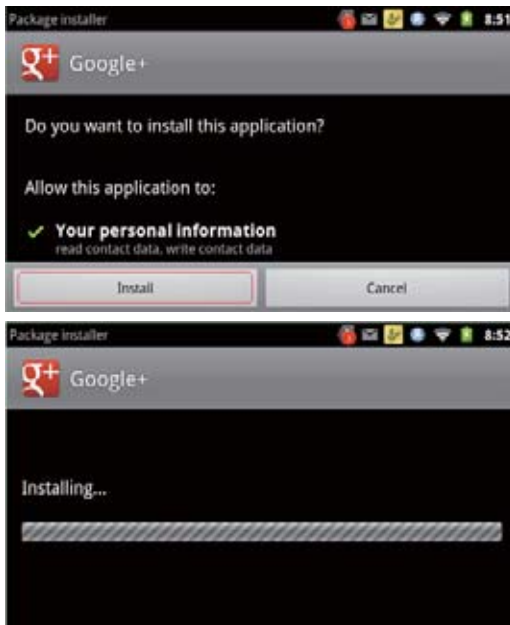

After downloading on the device, tap [install] to install applications.

⚠ If there is "Install blocked" when installing the applications, tap [Settings] and then click "Unknown source" to unblock. And then finish the installation.

8 PC Link

Please use specified USB cable (USB A type+Micro B type), to connect your device to PC.

- (1) Slide down the status bar to open the ongoing list.
- (2) Tap "USB connected" to open "USB Mass Storage".
- (3) Tap "turn on USB storage" to open PC link.
- (4) Tap "turn off USB storage" to close PC link.

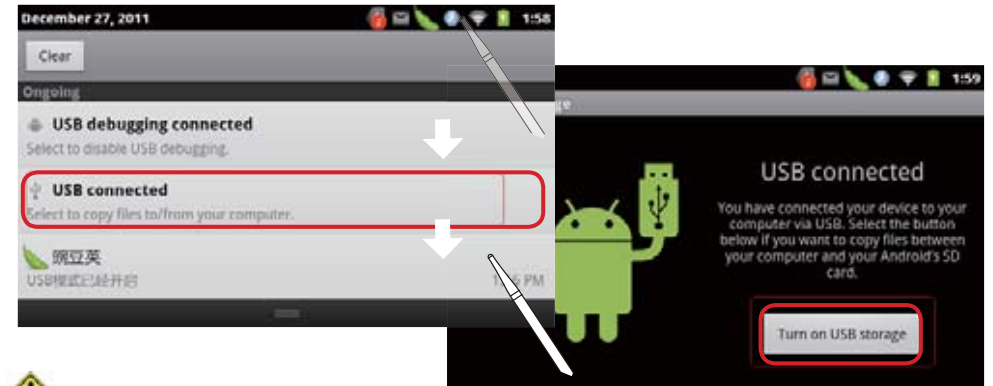

⚠ In order to avoid abnormal or missing data, please strictly operate the above instructions for PC link.

Data Transmission

When connect the device with PC, the interact data transmission would be realized.

- "Removable Disk" is shown on the screen of PC.
- Open the disk to copy and past data between PC and the device.
- The application needs installation after transmitting to the device. (please refer to the "On-line Downloading" for more information)

9 Guide

The device provides Guide for operating the device.



- Tap  to open the function list.
- And then tap [Guide] to look up more information.



Maintenance

- Keep it dry. Precipitation, humidity and liquid that contains minerals will corrode electronic circuits.
- Do not use or store it in dusty, dirty areas as its detachable parts may be damaged.
- Do not store it in hot areas. High temperatures can shorten the life of electronic devices, damage batteries, and melt certain plastics.
- Do not store it in cold areas. When the device warms up, moisture can form inside it, which may damage electronic circuit boards.
- Do not attempt to take the device apart. Improper handling may damage the device.
- Do not drop, knock or shake it. Improper handling may cause damage to the liquid crystal panel.
- Do not use harsh chemicals, cleaning solvents, or strong detergents to clean the device.
- Do not paint it. Paint can clog the device's detachable parts and cause it to malfunction.
- Do not operate the device below the temperature 0 or over 40 degrees. Excessive heat or cold will cause malfunction and incur damage to the device. To avoid such from happening, please do not use the device for two hours after it has been exposed to

excess heat or cold, because the humidity or moisture formed by the temperature changing will cause damage to the device.

Items

- This equipment has been tested and found to comply with the limits for a Class B digital device, pursuant to part 15 of the FCC Rules. These limits are designed to provide reasonable protection against harmful interference in a residential installation. This equipment generates, uses and can radiate radio frequency energy and, if not installed and used in accordance with the instructions, may cause harmful interference to radio communications. However, there is no guarantee that interference will not occur in a particular installation. If this equipment does cause harmful interference to radio or television reception, which can be determined by turning the equipment off and on, the user is encouraged to try to correct the interference by one or more of the following measures:
 - Reorient or relocate the receiving antenna.
 - Increase the separation between the equipment and receiver.
 - Connect the equipment into an outlet on a circuit different from that to which the receiver is connected.
 - Consult the dealer or an experienced radio/TV technician for help.
- Modification, adjustment, and replacement of parts : Besta is not responsible for unauthorized modification, adjustment, and replacement of parts on this product. Any such changes may void the warranty.
- This device complies with part 15 of the FCC Rules. Operation is subject to the following two conditions : (1) This device may not cause harmful interference, and (2) This device must accept any interference received, including interference that may cause undesired operation.
- SAR Exposure Statement
This EUT is compliance with SAR for general population/

uncontrolled exposure limits in and had been tested in accordance with the measurement methods and procedures specified in OET 65. This equipment should be installed and operated with minimum distance 0cm between the radiator & your body.

This device and its antenna(s) must not be co-located or operating in conjunction with any other antenna or transmitter. The County Code Selection feature is disabled for products marketed in the US.

For product available in the USA markets, only channel 1~11 can be operated. Selection of other channels is not possible.