

## Tubular Wireless Speakers

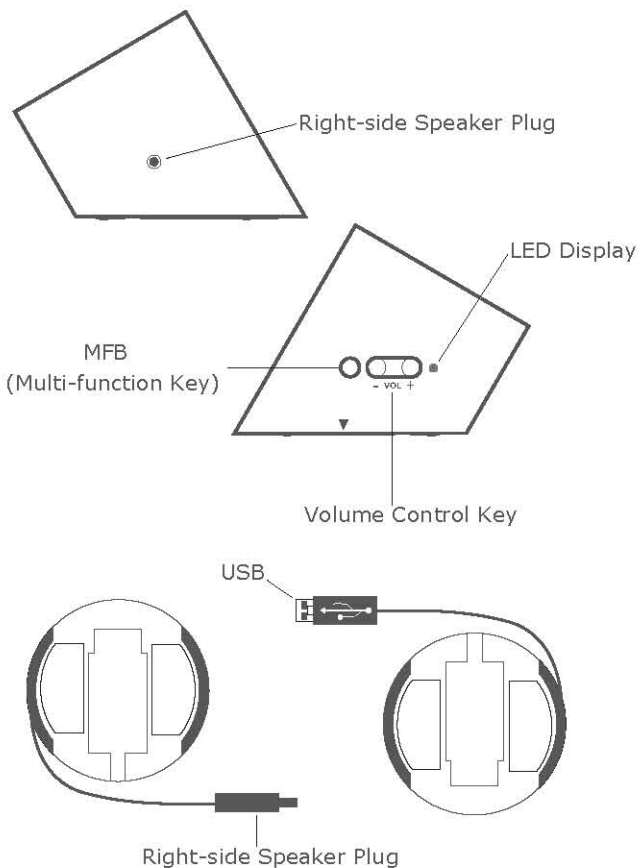

### CSSB-02IP Speaker Overview



## CSSB-02IP Bluetooth Wireless Stereo Speakers

With the Bluetooth stereo speaker CSSB-02IP you can enjoy wireless stereo audio from a phone or a Bluetooth device. When you receive or make a call, the music automatically pauses, and starts again when the call ends.

CSSB-02IP speaker system has an unique outlook of canned type. It consists of a primary speaker with Bluetooth functionality and a secondary speaker without Bluetooth functionality. You can use the speakers separately or together.

This user guide focuses on instructions that are valid for this speaker.

Note: Your phone, or other Bluetooth devices, must support the following Bluetooth profiles: A2DP & AVRCP.

### Specification

Bluetooth Specification: Version 2.0 EDR Class 2  
 Profiles Supported: A2DP & AVRCP  
 Range of Frequency: 2.4GHz Spectrum  
 Operation Distance: 10 meters  
 Dimension: 140(L) x 75(W) x 81.2(D) mm  
 Weight: 270 grams



### Caution !!

1. Please plug the right-side speaker to the main speaker unit before using turn on this device. If you connect the 2 speakers after power on that it will be in the protection mode and no sound from the speaker. Please restart the device.
2. Please ensure to charge the speaker at least 4 hours prior to use first time, in order to keep the lifecycle of battery and product.
3. Please don't play often the music in maximum volume otherwise it will damage the product's lifecycle and human's aural.

## How To Use

Rotate Ole 311.

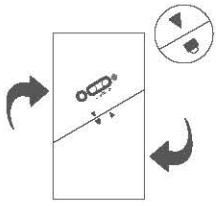

Separate up and down.

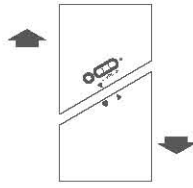

Connect with main device.



Charge it.

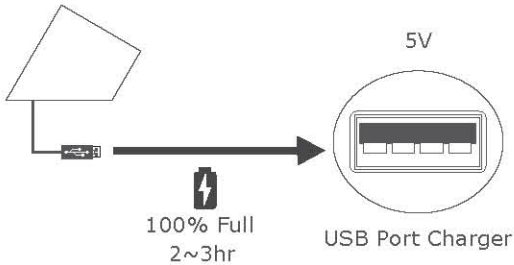

- Ole 311 is equipped with a lightweight and durable rechargeable Lithium Polymer battery and must be charged 4 hours prior to use.

4

Insert the USB.

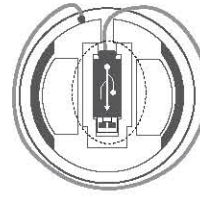

Place the wire in the ditch.

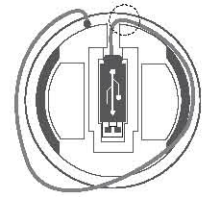

Rotate the plate anti-clockwise.

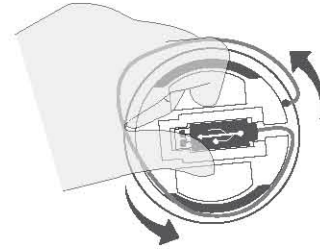

Assemble up and down.

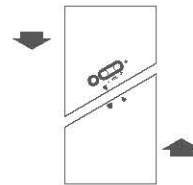

Rotate and lock it.

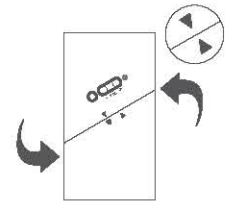

5

## Pair CSSB-O2IP with your Bluetooth devices.

Turn CSSB-O2IP off or keep it power off.  
Press multi-fuction key and hold until  
Blue & Red light flahes.

Pairing: Press and hold for 6 secs.

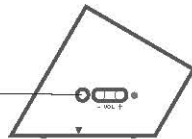

Activate Bluetooth on phone.



Search for the devices, and enter the PIN code " 0000. "

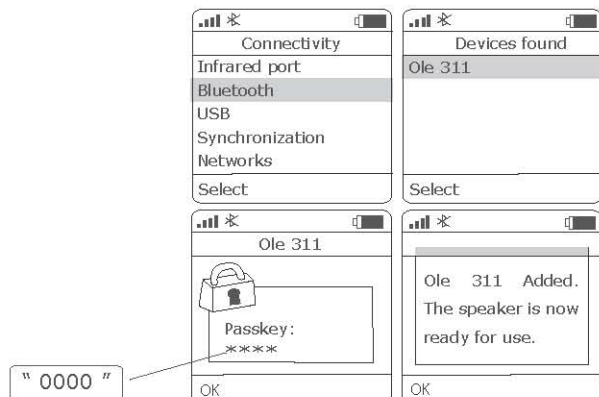

- After the pairing is successful, the red light indicator will go off and remain blue light indicator flashes.

6

## How to Turn on & off CSSB-O2IP

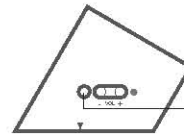

Power on: Long press for 3 seconds.  
Power off: Long press for 5 seconds.

- For saving electricity, the power will be off automatically after the Bluetooth disconnect for 30 minutes.

## How to Use Music function

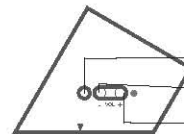

Play / Pause : Click to play, or pause music.  
Previous track: Press and hold for 3 secs.  
Next track: Press and hold for 3 secs.

Volume up: Short press the button.

Volume down: Short press the button.

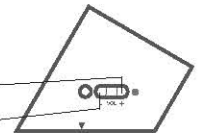

## LED Indicator

	Red Light	Blue Light
power on	-----	flash
standby	-----	flash
working mode	-----	flash
charging mode	on	-----
low battery alarm	flash	-----
pairing mode	flash alternately	

7

This transmitter must not be co-located or operating in conjunction with any other antenna or transmitter.

This equipment has been tested and found to comply with the limits for a class B digital device, pursuant to part 15 of the FCC rules. These limits are designed to provide to provide reasonable protection against harmful interference in a residential installation. This equipment generates, uses and can radiate radio frequency energy and, if not installed and used in accordance with the installation. , May cause harmful interference to radio communication. However, there is no guarantee that interference Will not occur in a particular installation. if this equipment does cause harmful interference to radio or television reception, which can be determined by turning the equipment off and on, the user is encouraged to try to correct the interference by one or more of the following measures:

- Reorient or relocate the receiving antenna
- Increase the separation between the equipment and receiver
- Connect the equipment into an outlet on a circuit different from that to which the receiver is connected
- Consult the dealer or an experienced radio / TV technician for help

You are cautioned that changes or modifications not expressly approved by the party responsible for compliance could void your authority to operate the equipment.

This device complies with part 15 of the FCC rules. Operation is subject to the following two conditions

- (1) This device may not cause harmful interference and
- (2) This device must accept any interference received, including interference that may cause undesired operation