

i-PORT M352 UHF Module

MANDATORY INTEGRATION INSTRUCTIONS

This document contains important information how to integrate the i-PORT M352 UHF module into the final product.

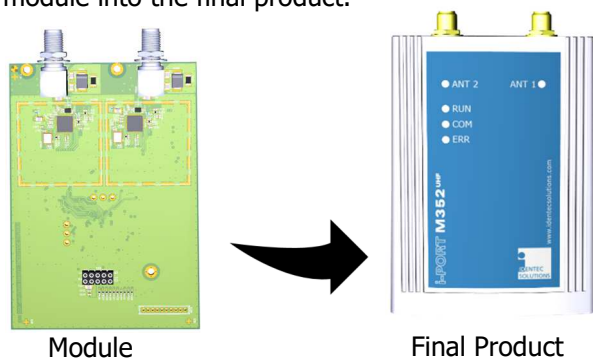

i-PORT M352 UHF Readers are only authorized with following antenna:

- Omnidirectional antenna: 289070 ILR – half-wave dipole antenna SMA i-CTA868 MH (2dBi) with Tx Reg value set at 36
- Directional antenna: RFI Model: YBS806-82 (11dBi) with Tx Reg value set at 8

FCC Part 15 compliance statement:

This device complies with part 15 of the FCC Rules. Operation is subject to the following two conditions: (1) This device may not cause harmful interference, and (2) this device must accept any interference received, including interference that may cause undesired operation.

Radio Frequency (RF) Exposure Compliance of Radiocommunication for mobile Apparatus:

To satisfy FCC RF Exposure requirements for mobile devices, a separation distance of 20 cm or more should be maintained between the antenna of this device and persons during operation. To ensure compliance, operation at closer than this distance is not recommended. This transmitter must not be co-located or operating in conjunction with any other antenna or transmitter.

Changes or modifications not expressly approved by IDENDEC SOLUTIONS could void the user's authority to operate the equipment.

End Product Labeling:

The final end product must be labelled in visible area with the following:

"Contains Transmitter Module FCC ID: 004-ILR-IPM352UH" or "Contains FCC ID: 004-ILR-IPM352UH"

"This device complies with part 15 of the FCC Rules. Operation is subject to the following two conditions: (1) This device may not cause harmful interference, and (2) this device must accept any interference received, including interference that may cause undesired operation."

End Product User's Manual:

The user manual for end users must include the following information in a prominent location

Radio Frequency (RF) Exposure Compliance of Radiocommunication for mobile Apparatus:

To satisfy FCC RF Exposure requirements for mobile devices, a separation distance of 20 cm or more should be maintained between the antenna of this device and persons during operation. To ensure compliance, operation at closer than this distance is not recommended. This transmitter must not be co-located or operating in conjunction with any other antenna or transmitter.