

USER MANUAL

Please read this manual carefully before use!

For this item wireless mobile phone monopod. We already use the best bluetooth chip now on the market(From Broadcom,USA),and integration of superhigh speed integrated circuit. The response times less than 1/60 of a second.

USAGE INSTRUCTION:

1/ Power on and Enter Pairing:

Pressing the <Press> button for 4 seconds to power on the monopod. The LED will flash 1 time once powering on, the monopod will connect the last connected Iphone or Android automatically. If they cannot connect within 6seconds,the monopod will enter pairing mode and the green LED will flash quickly.

2/ Power off the monopod:

Pressing the <Press> button more than 4 seconds, the LED will flash 3 times means the monopod is power off.

3/ Connect to Mobile phone:

Firstly, let the monopod enter pairing mode. Secondly, turn on Iphone or Android's Bluetooth, searching pairing device (Iphone will search it automatically) until <D18> device appears. In the mobile screen, press <D18> to connect it. Now the monopod is ready for taking photo and video .

4/ Device sleep mode:

To save battery power, the monopod will be in sleep mode if not using in 10 minutes. Pressing <Press> button 1 time, it will wake up and reconnect the phone. If exceed 5 minutes in sleep mode, the monopod will be powered off automatically.

5/ Low battery Indication:

The monopod LED will flash 1 time per 1.5seconds if the battery is low. Means you should change the battery at once.

size: 9x14cm

SET-UP

- 1st Step:** Place put the mobile phone into the phone clamp.
- 2nd Step:** Fix the mobile phone clamp on to the screw.
- 3rd Step:** Stretch the monopod.
- 4th Step:** Enter your phone into camera operations.
- 5th Step:** Focus on yourself and push the "press" button.

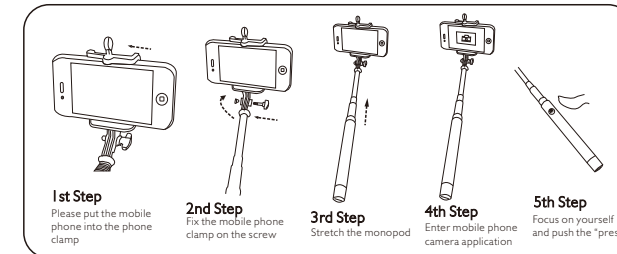

MATCH SIZE

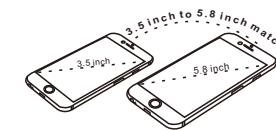

PHONE CLIP USE



PHONE SYSTEM SUPPORT

iPhone	Full Support
Android System Phone	Full Support
Windows Phone	Not Support
BlackBerry	Not Support

PARTS



TROUBLESHOOTING

- The monopod will not work with my phone.
- Ensure the device is compatible with your phone (Andriod 3.0 OS and or iOS 4.0 or newer)
 - Make sure the monopod is synced correctly. Power the monopod off and try again.
 - Make sure your phone is on, the Bluetooth setting is on and that everything is in good working order.

BATTERY PRECAUTIONS

- Do not leave device with young children or pets who could play with or swallow them. If swallowed, contact a physician immediately.
- Dispose of this unit properly as it has a built-in battery. Do not dispose in fires.
- Batteries may explode if mistreated. Do not attempt to recharge or disassemble the batteries.

FCC NOTE:

This device complies with Part 15 of the FCC Rules. Operation is subject to the following two conditions: (1) this device may not cause harmful interference, and (2) this device must accept any interference received, including interference that may cause undesired operation.

THE MANUFACTURER IS NOT RESPONSIBLE FOR ANY RADIO OR TV INTERFERENCE CAUSED BY UNAUTHORIZED MODIFICATIONS OR CHANGE TO THIS EQUIPMENT. SUCH MODIFICATIONS OR CHANGE COULD VOID THE USER'S AUTHORITY TO OPERATE THE EQUIPMENT.