

***i*NMOTION**



**INMOTION E-SCOOTER**

**Lively**

**USER MANUAL**

INMOTION TECHNOLOGIES CO.,LTD.  
[www.imscv.com](http://www.imscv.com)



***i*NMOTION**

<b>1</b>	<b>Document Overview</b>		
	1.1	About This Manual.....	- 3 -
	1.2	Related Documents and Materials.....	- 3 -
	1.3	Signs and Words of Caution.....	- 3 -
<b>2</b>	<b>Product Overview</b>		- 3 -
	2.1	Product Serial No.....	- 4 -
	2.2	Product Dimensions.....	- 4 -
	2.3	Product Parameters.....	- 5 -
	2.4	Product Structure.....	- 6 -
	2.5	Packing Carton Check.....	- 7 -
	2.6	Assembly of Lively.....	- 7 -
	2.7	Handlebar structure.....	- 9 -
	2.8	Display Screen.....	- 9 -
	2.9	Mobile Client.....	- 11 -
	2.10	Pairing with Mobile Client.....	- 11 -
	2.11	Scooter Working Modes.....	- 13 -
<b>3</b>	<b>Battery and Charger</b>		- 14 -
	3.1	Battery Specifications.....	- 14 -
	3.2	Speed and Range Estimates for Each Charge.....	- 14 -
	3.3	Charging Method.....	- 15 -
	3.4	Charging Indication.....	- 15 -
	3.5	Safety Tips for Charging.....	- 15 -
	3.6	Over-Discharge Protection.....	- 16 -
<b>4</b>	<b>Usage of Lively</b>		- 16 -
	4.1	Riding Lively.....	- 16 -
	4.2	Pre-Riding Precautions.....	- 16 -
	4.3	Operation Procedures for a Beginner.....	- 17 -
<b>5</b>	<b>Precautions for Safe Riding</b>		- 18 -

<b>6</b>	<b>Care and Maintenance</b> .....	- 19 -
	6.1 Storage.....	- 19 -
	6.2 Cleaning.....	- 19 -
	6.3 Disposition.....	- 19 -
	6.4 Inflation and Tube/ Tire Replacement.....	- 20 -
<b>7</b>	<b>Contact and Legal Information</b> .....	- 21 -
	7.1 Feedback to Us.....	- 21 -
	7.2 Contact Us.....	- 21 -
	7.3 Comply with Local Laws and Regulations.....	- 21 -
	7.4 Version No.....	- 21 -
<b>8</b>	<b>Legal Statement</b> .....	- 22 -
	8.1 Statement about the Product.....	- 22 -
	8.2 Personal Information Protection Statement.....	- 24 -
	8.3 Intellectual Property Statement.....	- 26 -
<b>9</b>	<b>Product Warranty</b> .....	- 27 -
	9.1 Scope of Warranty.....	- 27 -
	9.2 Product Repair Service Policies.....	- 29 -
	<b>Product Warranty Card</b> .....	- 30 -
	<b>Certificate of Quality</b> .....	- 32 -

# 1 Document Overview

## 1.1 About This Manual

For your own safety, before riding Lively the **INMOTION E-scooter Lively**(hereinafter referred to as "**Lively**"), read this manual (hereinafter referred to as "User Manual") carefully so as to ensure that you can ride **Lively** correctly and properly.

- Reading carefully and understanding fully the contents including all the safety warnings and precautions listed in this manual, will help you ride Lively in a safer and better way
- This manual applies to Lively, a product manufactured by INMOTION Technologies Co., Ltd. (hereinafter referred to as "INMOTION")
- If you have any questions or can't find the information you need in this manual, feel free to contact authorized agents or the after-sales department of INMOTION

## 1.2 Related Documents and Materials

The User Manual in PDF format, mobile client and other useful documents related to Lively, can be found and downloaded from the official website of INMOTION [www.imscv.com](http://www.imscv.com).

## 1.3 Signs and Words of Caution

**The following descriptions are applicable all through this manual, and the "Warnings" and "Notes" deserve your special attention.**

	<b>Warning: your operations or behaviors may cause product damage, bodily injuries and/ or other property loss</b>
	<b>Note: precautions, function tips or other similar information that requires users' attention.</b>

# 2 Product Overview

Lively is a compact, highly efficient and economical personal travel tool. With its stylish and futuristic appearance, superb shock mitigation design and powerful lithium battery, Lively is created to give you a wonderful riding experience.

## 2.1 Product Serial No.

A serial No. is a product's unique identity, used for quality tracking, after-sales service, insurance claiming, identification of a lost product, etc. Make sure to keep a record of the serial No. and take care not to lose it. You can find the serial No. of the product at the following positions: the outer packing, the warranty card, and the body of **Lively** (to be more specifically, it's located at the tail of the footboard, and can be seen when the rubber footboard is lifted).

## 2.2 Product Dimensions

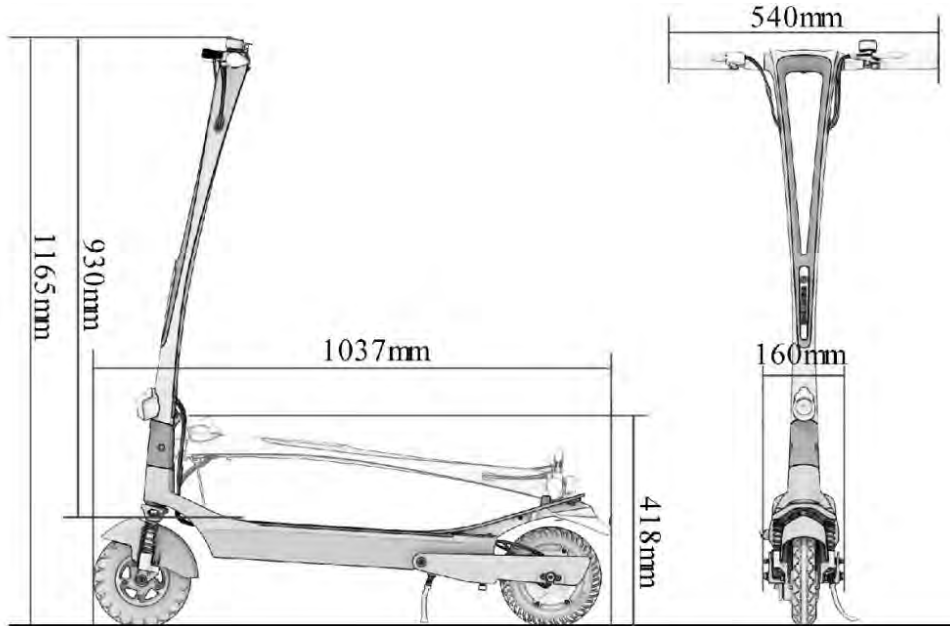

## 2.3 Product Parameters

Parameter	Value	Remarks
Product model	<b>INMOTION-Lively</b>	<p>① This speed is measured in the case of a rider weighted 70 kg, and the top cruising speed can be set via the mobile APP.</p> <p>② The average range per charge is measured in the case of a rider weighted 70 kg riding on a flat road under a temperature of 25 °C. Factors including the rider's riding habits, ambient temperature, road conditions and the rider's weight all have a bearing on the range per charge. And different product or battery models also lead to different performance on range per charge.</p> <p>③ Lively boasts a waterproof and dustproof level of IP65.</p>
Maximum cruising speed	<b>25 km/h</b> ①	
Average range per charge	<b>Approx. 30 km</b> ②	
Max. climbing angle	<b>15°</b>	
Net weight	<b>16.5 kg</b>	
Load capacity	<b>100 kg</b>	
Overall dimensions	<b>1037*540*1165 mm</b>	
Battery specifications	<b>48V 8Ah lithium battery</b>	
Charging requirements	Input: 100-240V/AC, 50/60Hz, 2.5A Output: DC 54.6V, 2.0A	
Charging time	<b>Approx. 5.5 hours</b>	
Tire types	<b>Pneumatic tire for the front wheel and solid tire for the rear</b>	
Brake type	<b>Drum brake for the rear wheel</b>	
Optimal operating temperature	<b>25 °C</b>	
Waterproof level	<b>IP65</b> ③	

## 2.4 Product Structure

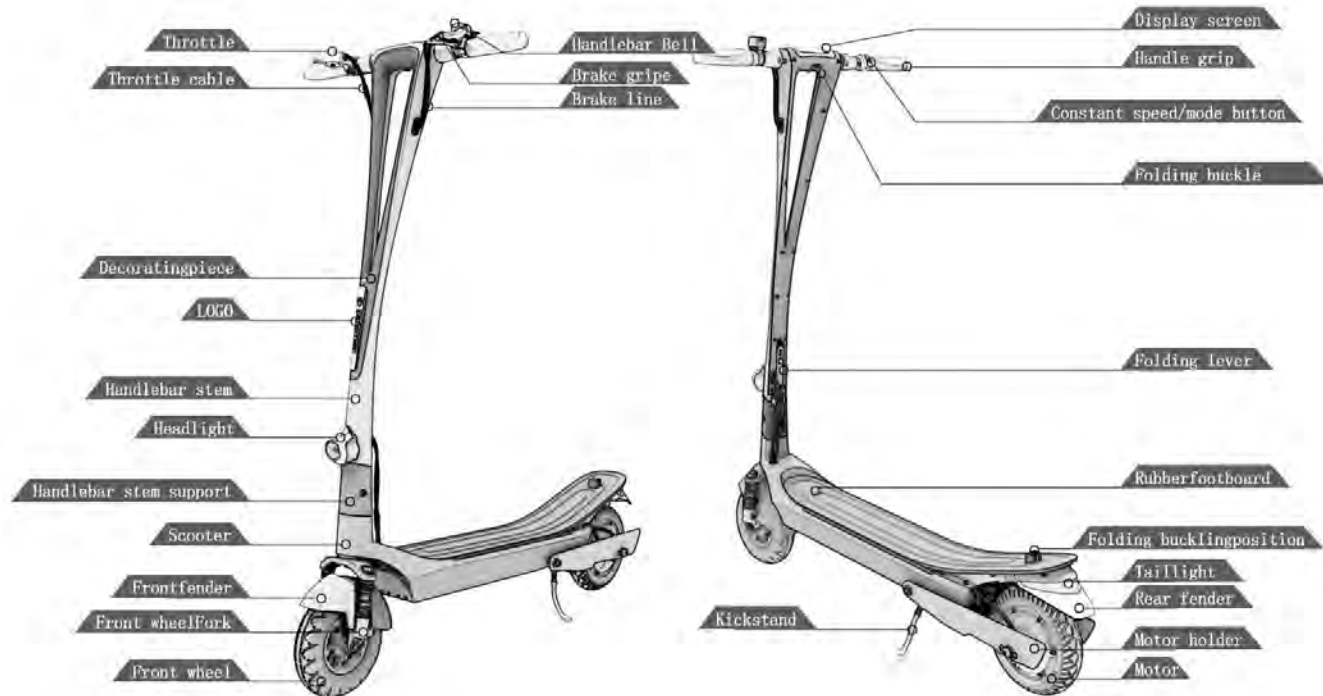



## 2.5 Packing Carton Check

Lively shipped from the factory contains the following items. Open the packing carton and take inventory of the items, and if any of them is found missing, contact the agent or the after-sales department of INMOTION.

Scooter main body × 1	Charger × 1
T3 socket head wrench × 1, T4 socket head wrench × 1	M4 socket head screw × 4
User Manual × 1	Folding mechanism guard × 1

- **Adoption of parts not approved by INMOTION or failure to assemble parts correctly may cause damage to Lively, or even lead to bodily injuries and/ or property loss. To ensure product quality and safety, all parts of Lively have had to be approved by INMOTION and correctly mounted on Lively.**
- **Do not try to stand on a Lively scooter which is not correctly or completely assembled.**
- **Do not disassemble or modify Lively without permission from INMOTION, or else irreversible damage may occur to Lively or even bodily injuries/ property loss may be incurred.**

## 2.6 Assembly of Lively

**Step 1:** plug the handle grip into the handlebar inner rods in the direction as shown in the right figure with one grip on each side, and use M4 screws to lock the joints tightly (screws and tightening tools are provided with the product, and take care not to muddle the left and right grips and also pay attention to their orientation).

Refer to enlarged views 1 and 2.

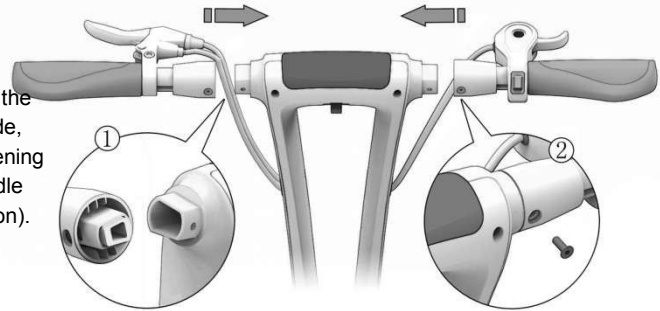

**Step 2:** as shown in the following figure, the scooter is in a folding state and the handlebar stem needs to be erected. On the reverse side of the scooter's display screen, there is a protruding round button as shown in enlarged view 3. Press the button to release the buckle that locks the handlebar stem, lift the handlebar to bring its stem in line with the steering column, as shown in enlarged views 4 and 5. (The screw shown in enlarged view 5 can be tightened as needed with the tools provided with the product)

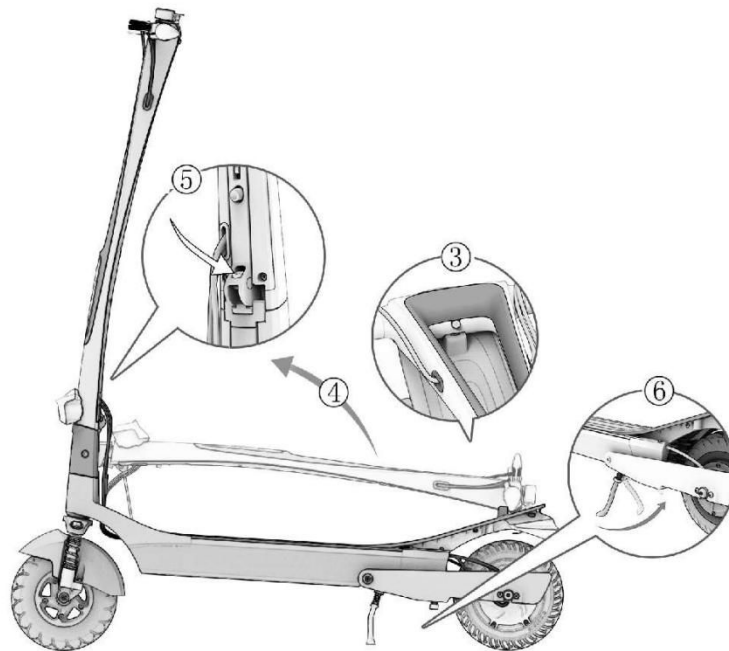

Step 3: as shown in enlarged view 6, flip up the side kickstand with your foot, hold the handlebar grips with two hands, and press the power button on the right side to switch the scooter on.

## 2.7 Handlebar structure

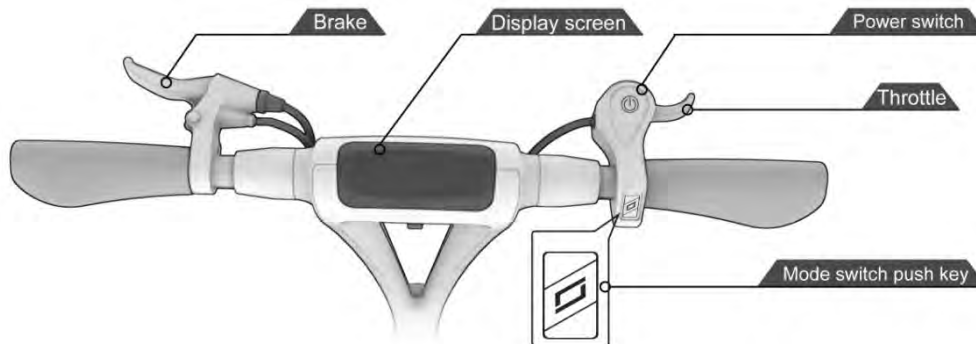

## 2.8 Display Screen

The LED display screen is an interface that shows the working status of the scooter:



The table below explains the meanings of each icon on the screen.

Icon	Explanation	Icon	Explanation
	Speed indicator		Locking indicator which lights up when the scooter is locked and dims when it's unlocked.
	Error indicator which indicates the scooter is experiencing some malfunction		Bluetooth status indicator
	Distance covered by a single riding		Headlight status indicator
	Beginner mode indicator which indicates the scooter is in the beginner mode when lit up and in normal mode when dimmed		Constant speed mode indicator
	Battery life indicator which consists of 5 bars: A state of more than 2 bars is colored white; 2 bars, yellow; 1 bar, red. A flashing icon indicates a need of charging.		

## 2.9 Mobile Client

The mobile client is a mobile software specially designed by INMOTION for its users, and can be used to control the scooter, make friends, publish messages, take part in INMOTION activities, purchase INMOTION accessories, etc. The Chinese title of the Lively mobile client is: Lexingtianxia.

The mobile client can be downloaded from the official website of INMOTION or related APP stores (for IOS, it's Apple App Store; for Android OS, Google Play)

The mobile client features the following functions:

- Scooter control: locking, unlocking and activation.
- Scooter status indication: providing information including speed, range, battery life, etc.
- Scooter parameters setting: top speed, drive mode, etc.
- Fault detection: conducting detection and estimation on the health state of the Lively scooter.
- After-sales service: exchanging with INMOTION's service personnel and working out solution to your problems in a timely manner.
- Firmware updating: checking the latest scooter firmware updates released and updating it via connection to network.
- For more details about the mobile client's functions, refer to tips and help information contained in the mobile client, or download and read the instruction manual of the latest mobile APP from INMOTION's official website. In addition, new functions will be added to the mobile client on an irregular basis.

## 2.10 Pairing with Mobile Client

Hold the brake lever tight, and press the mode switch button

The screen displays the last 5 digits of the scooter's SN code.

Open the APP and switch on Lively

Search for the scooter's SN code

Click connection and enter the initialpassword of 000000

Appearance of  on the scooter screen signifies a pairing success



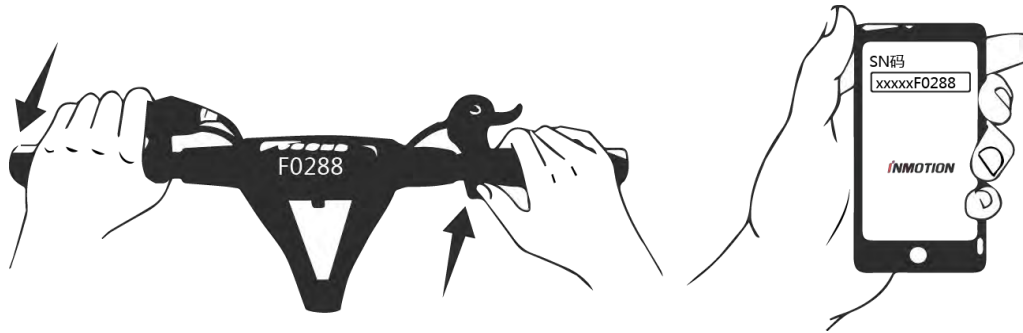

- Lively realizes interconnection with a mobile phone via wireless bluetooth 4.0 BLE, and is compatible with Android OS of version 4.3 or higher and Iphone 4s or later handsets with IOS 7.0 or higher.

## 2.11 Scooter Working Modes

Lively features 5 working modes and here are some brief introductions to some important ones:

Working mode	Description
Beginner mode	Acceleration of the drive motor is relatively slow, and the scooter's top speed is limited to 15 km/h. This mode can be entered by mode switching operation via the mobile APP. This mode is endowed with a power off memory function. Once set to this mode, the scooter will not automatically exit it when powering off, unless through mode switching operation.
Travel mode	The drive motor accelerates with speed and power, and the scooter can reach a speed of 25 km/h. This mode can be entered by mode switching operation via the mobile APP. This mode is endowed with a power off memory function. Once set to this mode, the scooter will not automatically exit it when powering off, unless through mode switching operation.
Constant speed mode	When riding the scooter, if you press the mode switch button, the constant speed cruising function will be activated. In this mode, the scooter will keep running at the current speed even if you release the throttle, until you decide to throttle up or brake, and then the scooter will exit the constant speed mode.
Locked mode	When Lively is parked normally and connected to your mobile phone, you can switch the scooter to the locked mode by operating on your phone. In this mode, the throttle will cease to function. Only by operation via the connected mobile phone, can the scooter be released from this mode.
Error handling mode	This mode will be activated automatically when the system detects some error or warning, and in this case the system will take control of the scooter and bring it to a stop. After that, the system will decide whether to lock the scooter based on the severity of the error. Once the scooter gets locked in this way, you may need to send it to the authorized agent or the after-sales department of INMOTION for troubleshooting and service.
State display	When the scooter is stopped and inactive, pressing the mode switch button will switch the item displayed among speed, range and subtotal range. If you press and hold the mode switch button when subtotal range is displayed, the data will be cleared to zero.

## 3 Battery and Charger

### 3.1 Battery Specifications

The following table lists the various parameters of the battery:

Parameter	Value	Remarks
Battery type	Lithium battery	① Charging time varies with the ambient temperature and the battery capacity that may change in the course of time. ② The voltage herein refers to that of the lithium battery in a sound state of charge. ③ INMOTION Lively is equipped with an 8Ah battery. ④ The scooter shall not be charged when temperature drops below 0 °C.
Charging time	Approx. 5.5 hours①	
Voltage	48 V②	
Capacity	8Ah③	
Battery weight	2.7 kg	
Dimensions	L*W*H: 362*64*69 mm	
Working temperature	-10 to 40 °C	
Charging temperature	5 to 45 °C	
Storage temperature	-20 to 45 °C	

### 3.2 Speed and Range Estimates for Each Charge

Status	Averagespeed	Range	Remarks
Roaming	15 km/h	35 km	The left is the test statistical data obtained under the condition of a rider weighted 70 kg riding on a flat road in a continuous manner, and the actual range depends on a variety of factors such as the actual rider's weight and riding habits, road conditions, weather and battery state, etc., therefore the data shown on the left is for reference purpose only. The actual range per charge may vary slightly each time.
Normal	25 km/h	25 km	



### 3.3 Charging Method

**Step 1:** as shown in the figure, the charging port is positioned on the right side of the scooter's tail. Flip out the cover, and make sure the port is dry.

**Step 2:** plug in the charger end that fits the scooter's charging port.

**Step 3:** when the indicator on the charger lights up in red, it indicates charging is in progress; when the indicator turns from red to green, it means the battery has been charged fully, and you need to stop charging as unduly long period of charging may affect the battery's service life and even result in battery-effected accidents.

### 3.4 Charging Indication

During charging, the battery interface on the screen will not only display correctly the bar indicating the currently remaining battery life but also flash the next bar that is being charged (e.g. when the battery currently has 3 bars of power, the 4th bar will flash during charging).

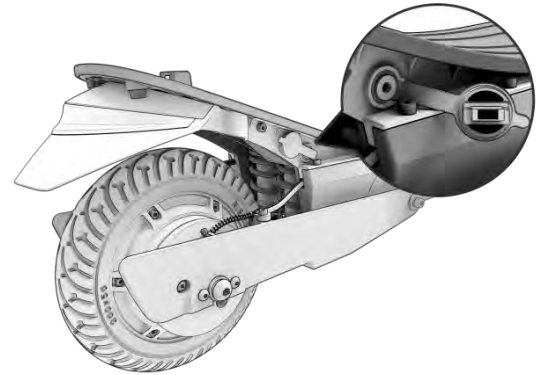

### 3.5 Safety Tips for Charging

- Charge the battery for at least 6 hours prior to first-time riding.
- For the purpose of maximumly extending the battery's service life, charge the scooter every 3 months or 2 days after each riding.
- Failure to charge the battery timely may cause damage to it. As time passes by, the battery will eventually run out and get over-discharged.
- Always use the battery, charger and cable provided by the original manufacturer, lest any danger should happen because of an overcharged battery.
- Make sure to connect the charger correctly with the specified cable.

- Make sure to charge the battery in an environment with sufficient ventilation and an appropriate temperature.
- Always carry out charging in a dry environment. Never allow the charger or cable to contact water, or touch them with wet hand, lest electric shock should happen.
- If any abnormality occurs during charging, unplug the charger from the power receptacle immediately.
- Make sure to hold the plug and pull it out, instead of by pulling the cable.
- Do not let the charger or cable contact sharp or hot objects.
- Perform visual inspection on the charger and cable regularly.
- If any damage to the charger or cable is spotted, stop using it immediately.
- Do not try to repair the battery, charger or cable by yourself.

### **3.6 Over-Discharge Protection**

With a built-in over-discharge protection system, when the E-scooter Lively is in the locked or power-off state and the battery is too low, the power connection will be automatically cut off to protect the battery. A scooter in the over-discharge protection state needs to be awakened by charging. If the scooter doesn't awaken after half an hour of charging, contact the authorized agent or the after-sales department of INMOTION.

## **4 Usage of Lively**

### **4.1 Riding Lively**

Lively is a high-tech travel tool. If you ride it without enough knowledge of the operating specifications, some unexpected harm may be incurred. The following contents are aimed for beginners, especially those for whom it's the first time to put their feet on lively. Here, you will learn in details how to ride Lively correctly and the various precautions in time of riding. Make sure to read these contents carefully and ride Lively in strict accordance with the requirements.

### **4.2 Pre-Riding Precautions**

Whether it's being ridden or parked, the INMOTION scooter's performance may get undermined by wearing or other unexpected reasons. Therefore before riding Lively, make sure to conduct inspections as listed below:

- Check and make sure that all components of Lively are assembled firmly and securely and free from any damage.

- The brake function has to be reliable and sound.
- The folding mechanism must be locked securely.
- The battery needs to have enough power.
- The tires have to be complete and sound and free from damage.
- Make certain the handle grips are firmly secured and tighten the bolt/ screw if necessary.
- Find an open and flat, either indoor or outdoor ground with an area of at least 4m \* 20m for practice.
- Get yourself adequately acquainted with the riding surroundings; make sure that no other cars, pedestrians, pets, bicycles or any other obstacles pose obstruction.
- You need a skilled assistant at your hand. · Your assistant needs to be able to operate Lively skillfully and be familiar with all the precautions and riding methods specified in this manual.
- Do not try to ride on a glossy or slippery ground.
- Always wear a safety helmet and protective pads so as to avoid possible injuries when riding.

### **4.3 Operation Procedures for a Beginner**

- Hold the handle grips with two hands.
- Press the start button of Lively to switch it on.
- Then the display screen on the handlebar will light up indicating Lively has started.
- Put one foot on the footboard, look ahead, plant the other foot on the ground and push off to give the scooter a starting speed. When the thresh speed lever in front of the throttle gets activated, you can pull the throttle to pick up speed.
- Retract your pushing foot and place it on the footboard. Keep a proper space between your feet and your upper body naturally upright, look ahead and keep your body in balance just like you are standing on a flat ground.
- Pull the throttle slightly to accelerate, and the acceleration depends on the force you applies on the throttle lever. It's recommended that you pull the throttle lever gently and speed up gradually.
- Turn the handlebar to steer the scooter around. As the body of Lively is of a certain length, do not swerve in narrow spaces.
- When the scooter needs to be decelerated or stopped, put fingers on the brake lever and pull it toward the handlebar until the scooter is decelerated or brought to a stop.
- Before the brake lever is pulled to its limit, the drum brake of the rear wheel will not function.
- When the brake is activated, the throttle lever will get its power supply cut off and thus be rendered ineffective.

- Dampness may slow response of the brake, thus after cleaning the INMOTION scooter, put it in a safe place to dry the brake.
- Do not use this product in bad weathers (e.g. raining, snowing or icy environments).
- Before using this product in whatever kind of environment, always make sure the brake function normally in the first place.

## 5 Precautions for Safe Riding

Lively is a personal travel tool of a certain speed, and its production process and the technologies employed have all gone through strict tests. However, failure to observe the instructions provided in this manual when using it, may put your safety at risk. In whatever time and place, accidents such as fall-off, loss of control, collision, etc., as well as failure to observe the requirements stated in the manual during riding, may cause bodily injuries or even death. To bring the risks to the lowest level, you must read this manual and watch related videos carefully, and strictly abide by the following precautions:

- Properly wear helmet and protective pads for riding.
- Do not ascend or descend slopes of over 15 degrees, and do not accelerate or decelerate hastily on slopes.
- Heed obstacles and slippery road surfaces, and do not ride on unfavorable road conditions such as lawns or gravel pavements, etc.
- Do not try to wade through water with a depth of over 30 mm.
- Never try to ride up or down stairs.
- Never ride on motor vehicle lanes.
- Never leave the scooter immersed in water.
- Lively is designed for only one rider, and never try to ride double or more.
- Children under 12, seniors over 60 and others considered not suitable for riding due to physical, intellectual or mental reasons, shall not be allowed to ride the scooter.

- Make sure that the battery has enough power and tire pressures (3.0 Mpa) are normal.
- Do not attempt to ride fast before getting yourself skilled enough in riding, and pick up speed gradually in the beginning.
- The special properties of the lithium battery require the user to charge the scooter at least once for every 3 months. Battery damage caused by failure to perform regular maintenance will not be covered by INMOTION's warranty.

## **6 Care and Maintenance**

### **6.1 Storage**

- Do not store the scooter in places exposed to direct sunlight (even if the place is the trunk of your car), or else high temperature may cause damage to the battery, or even lead to safety accidents.
- Do not store the INMOTION scooter in damp environments.
- When the INMOTION scooter is not in use, its battery still discharges itself, therefore you shall measure the battery's available capacity at least once for every 3 months, and charge the battery fully in time so as to avoid irreversible loss incurred by a long-stored dead battery (e.g. over-discharged battery or unexpected accidents).
- In winter, the battery life may get shorter due to low temperatures.
- Improper storage may compromise the battery's service life or cause other problems, thus the scooter shall be stored in an indoor environment with a favorable temperature and moisture.
- Prior to storing the scooter for a long period, charge its battery fully.

### **6.2 Cleaning**

- Before cleaning, make sure to power off the scooter, unplug the charger, cap the charging port. During cleaning, take care not to let water penetrate into the charging port.
- Use soapy or clean water together with soft cloth to wipe the shell of Lively, and do not flush Lively with a high-pressure water gun.
- Lively features a waterproof and dustproof level of IP65, i.e. it's dust tight and able to withstand moderate water jets. Therefore, do not immerse Lively in water, otherwise permanent damage may occur to the scooter.

### **6.3 Disposition**

The battery and power devices shall not be disposed as other general household wastes. You have already made your contribution for the environmental protection cause by riding the INMOTION scooter, so take one more step to avoid unnecessary pollution:

- Dispose your scooter and all related components (battery) through approved disposing facilities.
- Follow the latest applicable guidelines, and feel free to contact the authorized agent or the after-sales department of INMOTION should you have any questions.

## **6.4 Inflation and Tube/ Tire Replacement**

If the front tire is found deflated, inflate it in a timely manner. When shipped, Lively's default tire pressure is 3.0 Bar. If the scooter's tires need to be replaced for blowout or other reasons, contact the authorized agent or the after-sales department of INMOTION for fixing your scooter.

## **7 Contact and Legal Information**

### **7.1 Feedback to Us**

If you yourself or any other people you know have any questions or improvement advice when using Lively, please feel free to contact us, and we will heed each and every of your question and advice, and do all we can to provide you with the best service.

### **7.2 Contact Us**

- INMOTION Technologies Co., Ltd.
- Tel: 4000-1000-12 or 0755-26906865
- Email: info@imscv.com

### **7.3 Comply with Local Laws and Regulations**

Lively may serve as a smart and convenient travel tool, but it still can't replace other existing transportation means, thus do not try to ride Lively on public transportation roads. In some countries and regions, Lively is barred from public transportation roads. For detailed information, contact the related local authority, or you can also make contact with the authorized agent or the after-sales department of INMOTION.

### **7.4 Version No.**

Version 1.1

# 8 Legal Statement

## 8.1 Statement about the Product

To ensure your riding safety and good riding experience, we specially request you to comply with the following requirements when using the product.

- Before using Lively, make sure to carefully read and fully understand INMOTION Scooter Lively User Manual.
- Do not let people who haven't carefully read and fully understood INMOTION Scooter Lively User Manual use your Lively.
- Strictly comply with the age requirement stated in INMOTION Scooter Lively User Manual that only people between 12 and 60 may use the product, and do not let those out of that range ride your Lively.
- Pregnant women or people with psychological unfitness shall not use Lively.
- When feeling unwell physically or mentally due to illness or under the influence of medicine or alcohol, do not ride Lively.
- Lively is designed for only one rider, and never try to ride double or more, or ride the scooter holding a child or load.
- Before riding Lively, make certain that both your physical and mental conditions enable you to freely get on and off the scooter and control Lively well, even without the help of others.
- Assemble all components correctly and properly in strict accordance with the assembly instructions in INMOTION Scooter Lively User Manual. Improper assembly may bring about risks of loss of control, collision or fall-off. When assembling the scooter, take care to apply appropriate force, as either screwing too tight or too light may cause damage to the scooter or malfunctions. Special note: do not conduct assembly or service with the power turned on.
- Do not try to modify or service Lively by yourself or let personnel unauthorized by INMOTION do the work. Should any problem happen, feel free to contact INMOTION at any time, as this is your most reliable choice.
- Before riding, always make certain that no abnormalities such as loose parts, damage or malfunctions exist on Lively.
- The front wheel of Lively is a pneumatic one, and charge pressure or tire pressure not maintained properly may lead to travel instability or easy damage, or even traffic accidents in extreme cases. Measure the tire pressure at least once each month and measure again before starting a long-distance riding.
- Should you spot any loose part, damage, abnormality or malfunction during use of Lively, stop using it immediately, and carry out troubleshooting and repair timely to avoid dangers.
- Prior to charging the scooter, make certain that the charging port is dry and free from malfunctions and foreign objects. Only a correct receptacle (100V-240V/50HZ-60HZ) can be utilized for charging. When the scooter is being charged, keep children and



pets away and make sure there are no inflammable materials nearby.

- Lively's battery must be stored in environments with a temperature ranging from -20 to 45 °C. Do not place Lively where the temperature is over 45 °C. When the ambient temperature falls below -20 °C, the battery will enter into a self-locked state, and can't be charged or used. If that happens, first bring Lively to a warmer place to unlock the battery for charging and using.
- Should any leakage or other abnormalities (including breakage, emission of odd smell or smog, overheat, etc.), stop using the product immediately and prevent the battery from contacting other objects.
- Without permission, never try to open or disassemble the battery, or perform any irrational operations on it or use it in an irrational way.
- Depending on the battery state and environmental conditions, fully charged Lively (the display screen showing 5 bars of power) will have a standby time of approximately 180 days, and non-fully charged Lively (the display screen showing 1 bar of power) will have a standby time of about 90 days. Bear this in mind and avoid irreversible damage to the battery caused by failure to charge it timely.
- Do not wear high heels or other unsuitable shoes, too loose or other unfit clothes for riding Lively, and always wear specialized protective gears when riding it.
- When you are to ride Lively, it's strongly recommended that you wear a pair of safety goggles, lest dirt, dust or insects harm your eyes or undermine your riding safety.
- Never try to ride Lively in rainy weathers or on wet roads, as wet and slippery roads may reduce the tires' resistance and lengthen the scooter's braking distance, and may also lead to loss of control or other accidents incurred by tire skidding.
- Use soft cloth to wipe and clean the scooter body, and never try to flush it with powerful water jets or a high-pressure hose, nor shall you immerse Lively in water, or else dangers such as uncontrollable malfunctions, abnormalities or accidents may occur.
- Never try to ride Lively under adverse environmental conditions such as bad weathers, low visibility, poor illumination, etc., nor shall you ride it when feeling exhausted.
- Nights or other environments with poor light conditions make it hard for riders, drivers and pedestrians to notice each other in a timely manner, therefore it's strongly recommended that you do not ride the scooter under the above-mentioned conditions to avoid potentially serious dangers.
- When riding Lively, always pay close attention to the changes of the road and surroundings, and always ride cautiously, lest any harm be inflicted on yourself or others.
- Do not ride the scooter up/ down stairs, in an elevator, through a revolving door or in any other adverse road conditions or

environments.

- When riding Lively, always watch out for overhead obstacles.
- During riding, should you encounter an abrupt slope, an uneven road or any other terrain conditions you haven't met before, do not try to risk riding through.
- Do not try to turn abruptly at a high speed or brake suddenly on a slippery ground, as these kinds of actions may easily cause the scooter to skid and render it uncontrollable.
- Ride Lively on bike lanes, and never ride on motor vehicle lanes or any other inappropriate sites, and strictly abide by traffic rules and other related regulations. When approaching or passing a crossroad, a motor vehicle lane, a turn, the space in front of a gate, etc., slow down and take care to avoid the pedestrians, and meanwhile, you should also watch out for dangerous behaviors by passing vehicles and people that may pose a threat to your own safety.
- In riding, always pay close attention to nearby vehicles, pedestrians, potholes, sewer covers, railroads, expansion joints, construction areas on the road or sidewalk, debris or other obstacles that may pose a threat to your own and others' personal or property safety.
- Never try to make or answer phone calls or do any other things that may distract yourself, so that you can always concentrate on monitoring your surroundings.
- Ride on the designated bicycle lanes or close to the road edge along the direction of traffic as allowed by local laws and regulations, and never go against the direction of traffic.
- When you go out riding your Lively, do not cut in other vehicles' or pedestrians' way.
- When riding Lively, do not try to put your hand on another vehicle and get yourself dragged along. And avoid inappropriate behaviors like performing stunts or X-sports, etc.
- When you need to ride Lively to a remote area, do not go alone. Even if you have partners on your journey, you still have to prepare yourselves well for potential risks.
- Lively is a personal travel tool made for short journeys, and shall not be used for any other purposes such as goods delivery, etc.
- Data and Parameters of Lively may vary with different models, and they are subject to change without prior notice.

## **8.2 Personal Information Protection Statement**

Your personal information hereof is that you voluntarily input when you go through the registration and authentication process to pair your mobile phone with Lively to bind them via the INMOTION mobile client (hereinafter referred to as "the APP"), and that we collect during your using process, including but not limited to your name, gender, age, address, contact information, occupation, as well as the

time when and the place where you access our service, etc.

While you are using the APP, the personal information we collect in the processes of owner authentication, product serial No. activation, questionnaire survey, after-sales tracking and callback, opinion or advice seeking for products or services, activity participation, etc., are eventually used only for presenting you with even better products and services, and improving and enhancing your using experience.

You have every right not to offer your personal information, but without your personal information, we may not be able to provide you with better products or service, and even your experience of using our products and service may get compromised.

Your agreeing to provide any personal information will be taken for your consent to allowing INMOTION to use the information and disclose it to affiliated companies. Use by INMOTION and its affiliated companies includes but is not limited to that by employees, consultants, agents, suppliers, partners, etc.

Fulfillment of any of the following conditions will be taken for your consent to allowing INMOTION to share your personal information with related third parties:

- 1)Your special authorization;
- 2)Mandatory requirements put forward by related laws or regulations, or by government authorities (including judicial authorities);
- 3)Execution of applicable service terms (including investigation into irregularities that may exist);
- 4)Dealing with issues concerning fraud, security, technologies, etc.;
- 5)Protection of users' or public interests, property or safety from damage, within the range required or allowed by laws;
- 6)Necessities in special and/ or emergency conditions; The use, transmission and storage of your personal information can be carried out in an electronic way, and may happen either domestically or abroad.

To get better using experience and service, you fully consent to receiving push notifications about products, services or relevant activities from INMOTION and its affiliated companies on an irregular basis.

·We will take sound and secure measures to protect your personal information from unauthorized disclosure or use, and also urge other related parties who may obtain and use your personal information within the framework of this legal statement to stringently protect your information. You consent to the procedure that we will decide the time for storing and retaining your personal information based on the time as required by the intended purpose or stipulations of any applicable agreement, law or regulation.

·You agree to fully exempt the receivers and/ or users of your personal information from any claims for compensation, liability and loss investigations caused by disclosure and use of your personal information within the framework of this legal statement, unless the aforementioned claims for compensation, liability and loss investigations are caused by direct intentional behaviors or gross

negligence from the receivers and/ or users.

### **8.3 Intellectual Property Statement**

Unless otherwise provided by laws and regulations, or as otherwise agreed, all rights to the products and accessories, APP and all intellectual property rights pertinent to the websites (including but not limited to copyrights, trademark rights, patent rights and related application rights, implementation rights and licensing rights) are reserved by INMOTION. Without prior written consent by INMOTION, no illegal use or any other disposition are allowed.

This statement is governed by the Laws of the People's Republic of China. INMOTION will not assume compensation or any other responsibilities for any claims, liabilities and damages caused by or may result from violation of this legal statement by consumers or any other third parties.

This legal statement constitutes an indispensable part of our products (thus when reselling the product, make sure to transfer this statement to the buyer together with the product). You may accept all terms of this legal statement to use our products. Your option to use our product will be taken for your consent to accepting all terms of this legal statement and taking any possible risks and responsibilities involved. Should you not accept all terms of this legal statement after you purchase our product, you shall return the product to us and make sure the returned product and its packaging are free from any damage and will not affect its resale.

# 9 Product Warranty

## Dear customer:

Many thanks for your purchasing our product!

After purchasing our product, please provide your correct, complete and authentic personal information, write the serial No. of the purchased product into the warranty card, ask for a valid invoice and keep it properly so as to be able to use our warranty service should any issue occur in future.

To ensure high-quality service, INMOTION promises that it will provide repair, replacement and return services free of charge for products in accordance with our warranty policies (only products purchased on the Chinese mainland). Except for costs including insurance, delivery, transportation, etc., the warranty service is provided free of charge.

## 9.1 Scope of Warranty

- ◆ All products purchased from INMOTION's official online outlet, within 7 days from the date of sale (herein, the date of receipt by the customer is taken as the date of sale), are covered by the "7-day no-reason return" policy in line with the rules of the platform. The returned product must be the original one and its packaging shall be free from damage and will not affect its resale. Besides, the delivery cost shall be paid by the customer.

- ◆ With 7 days from the date of sale (herein, the date of receipt by the customer is taken as the date of sale), should any quality issue occur and later be confirmed by the manufacturer's inspection to be caused by the product itself, the product can be returned, replaced or repaired free of charge.

- ◆ With 15 days from the date of sale (herein, the date of receipt by the customer is taken as the date of sale), should any quality issue occur and later be confirmed by the manufacturer's inspection to be caused by the product itself, the product can be replaced or repaired free of charge.

- ◆ Should the customer make a return or exchange request, but fail to send the product back within the specified deadline, the customer's return and exchange rights will no longer be considered valid. Loss incurred by causes irrelevant to the product itself during the return and exchange process, shall be borne by the customer.

◆ Within the warranty period, should any quality issue be confirmed by the manufacturer to be caused by the product itself, the manufacturer will provide repair service free of charge. The starting date of the warranty period is the date specified in the legal, authentic and valid proof of purchase provided by the customer. Should the customer not be able to provide a proof of purchase, the day 90 days after the date of production shall be taken as the starting date of the warranty period.

①The warranty periods of different scooter parts are shown in the following table:

<b>Part</b>	<b>Warranty period</b>	<b>Remarks</b>
Body	1 year	Shell, handlebar, motor holder, motor, display screen, internal drive circuit board, brake lever
Battery and charger	6 months	Battery, external charger
Outer wearing parts	3 months	Front wheel tube, front fender, rear fender, throttle, handle grips, decorating pieces, rubber footboard, kickstand, headlight, taillight, bell, folding wrench, folding buckle

②The following circumstances will not be covered by the warranty, and the customer has to pay for the repair:

- The "three guarantees" validity period has expired
- Damage incurred by man-made causes
- The scooter has traveled over 2000km  
(For the vehicle which has accumulated more than 2000km of mileage, we propose to repair and maintenance and replace the tire according to the tire wear condition.)
- Any damage caused by failure to follow the requirements in the instruction manual to correctly assemble or use the scooter
- The serial No. has been deleted or modified
- The serial No. bar code or model on the product warranty card doesn't coincide with the product itself
- The product has been disassembled or repaired by personnel unauthorized by INMOTION

- Daily wear and tear (including wear and tear of the scooter shell, handle grips, gear box, tires, etc.) that does not affect the product's functionality
- Damage caused by accidents or improper use, such as physical damage, fall-and-break damage, collision damage, severe oxidation, etc.
- Damage caused by overload, forcing through obstacles (including but not limited to riding down stairs, hitting the ground, etc.), performing X-sports stunts, etc.
- Damage caused by disassembly, transportation, loading/ unloading, etc. in the process of return for repair
- Damage caused by fire, liquid immersion, freezing, earthquake, or other abnormal storage conditions or force majeure
- Depletion of wearing pieces such as the packing material, different types of technical documents, etc.
- Other malfunctions or damage incurred by causes other than design, technological, manufacture, quality or other issues of the product itself.
- Products used for commercial purposes will not be covered by the warranty

③For malfunctioned products whose warranty has expired, INMOTION provides paid repair service, and as to the charging standard and accessory prices, you can contact our after-sales personnel for more details

## 9.2 Product Repair Service Policies

- ① Customers can call our official technical support number 4000-1000-12 for after-sales help, or directly contact the dealers from whom they bought the products and ask them to facilitate the after-sales service process. For detailed after-sales service policies and procedures, visit our official website: [www.imscv.com](http://www.imscv.com).
- ②After receiving the malfunctioned product from the customer, we will initiate communication with the customer about the malfunction cause, liability, repair cost, estimated time needed to rectify the malfunction, etc. When no more dissent is left, the repair process will start.
- ③ For products that have been repaired by us, within one month after completion of the repair, the product will be covered by our free-of-charge warranty service.

- |  |
|--|
| <ul style="list-style-type: none"> <li>• For product warranty policies on Lively purchased in regions other than the Chinese mainland, consult with local agents and dealers.</li> </ul> |
|--|

# Product Warranty Card

Customer and purchase information registration

<b>Customer name</b>		<b>Serial No.</b>
<b>Purchase date</b>		
<b>Contact number</b>		
<b>Email</b>		
<b>Address</b>		

<b>Dealer name</b>		<b>Contact information/ number</b>	
<b>Dealer address</b>			



## Repair record

Serial No.	Troubleshooting and service record	Service station	Repair time
1			
2			
3			
4			
5			
6			

**Note:** should the product need repair, the warranty card, invoice, the scooter, its charger and battery pack, etc. shall all be sent back.

## **Certificate of Quality**

This product is proved to be qualified through quality inspection, and thus allowed to be shipped. This warranty card (valid only with the manufacturer's stamp and an affixed serial No.) and a formal invoice are valid warranty proofs, and keep this warranty card properly.

Date of production:

Quality inspection stamp:

Any Changes or modifications not expressly approved by the party responsible for compliance could void the user's authority to operate the equipment.

This device complies with part 15 of the FCC Rules. Operation is subject to the following two conditions: (1) This device may not cause harmful interference, and (2) this device must accept any interference received, including interference that may cause undesired operation.

This equipment complies with FCC radiation exposure limits set forth for an uncontrolled environment .

This transmitter must not be co-located or operating in conjunction with any other antenna or transmitter.

Note: This equipment has been tested and found to comply with the limits for a Class B digital device, pursuant to part 15 of the FCC Rules.

These limits are designed to provide reasonable protection against harmful interference in a residential installation.

This equipment generates, uses and can radiate radio frequency energy and, if not installed and used in accordance with the instructions, may cause harmful interference to radio communications. However, there is no guarantee that interference will not occur in a particular installation.

If this equipment does cause harmful interference to radio or television reception, which can be determined by turning the equipment off and on, the user is encouraged to try to correct the interference by one or more of the following measures:

—Reorient or relocate the receiving antenna.

—Increase the separation between the equipment and receiver.

—Connect the equipment into an outlet on a circuit different from that to which the receiver is connected.



Download App



Follow wechat account

Customer Service Center : 4000-1000-12 0755-2572-2469