



beyond  
payment

## iSMP for Ipod Touch 4th



USER GUIDE

# Contents

---

<b>1. Introduction</b>	<b>4</b>
<b>2. Unpacking</b>	<b>5</b>
<b>3. Recommendations</b>	<b>6</b>
3.1. Safety	6
3.2. Security of your terminal	6
3.3. EC standard compliance marking	7
3.4. FCC & IC Compliance.	7
3.5. Main Characteristics	9
<b>4. Installation and connection</b>	<b>10</b>
4.1. Functional description	10
4.2. Battery insertion	11
4.3. iPod touch insertion	12
4.4. Charging iSMP	13
4.5. Positioning the terminal	14
4.6. Power on / off	14
4.7. Connection	14
4.7.1. USB cable connection	14
4.7.2. Cable disconnection	14
4.7.3. Cradle insertion	15
<b>5. Daily use</b>	<b>16</b>
5.1. Getting started with iSMP	16
5.2. Keypad functions	16
5.2.1. iPod touch ON/OFF	16
5.2.2. iSMP keypad	17
5.3. Adjusting the contrast	17
5.4. Barcode reader	18
5.5. Card insertion	18
5.5.1. Swiping a card	18

5.5.2. Inserting a chip card _____	19
5.5.3. Reading Contactless (Optional) _____	19

## **6. Maintenance \_\_\_\_\_ 20**

6.1. Cleaning of the terminal _____	20
-------------------------------------	----

6.2. Transport and storage _____	20
----------------------------------	----

6.3. Troubleshooting _____	20
----------------------------	----

6.4. End of life _____	21
------------------------	----

## 1. Introduction

---

Thank you for choosing a payment terminal Ingenico.

We recommend you to read carefully this installation guide: It gives you the necessary information about safety precautions, unpacking, installation, and maintenance of your terminal.



---

### WARRANTY / SECURITY

To benefit from the guarantee-related product, and to respect the security, we ask you to use only accessories delivered in box with the product, entrusting maintenance operations only to an authorized person.

---

The iSMP is battery powered, use only Ingenico parts for replacement:

The iSMP can be powered by different sources please respect these recommendations:

iSMP can be USB powered; it must be connected to a full compatible USB link.

iSMP can be powered using the cradle accessory.

Failure to comply with these instructions will void the manufacturer's responsibility.



**This symbol indicates an important Warning.**

---



**This symbol indicates a piece of advice.**

---

## 2. Unpacking

---



### ADVICE

Carefully preserve the packaging of the iSMP. It must be re-used whenever the terminal is shipped.

---

Products of iSMP range are named: **IMP3xx**

According to the model, the following items are included in the iSMP box (including optional accessories):



The iSMP terminal



PSU for battery charging

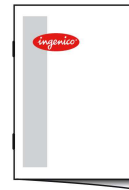

This User guide



A battery pack

- The IMP300 cradle (optional) with PSU
- The USB connection cable (optional)
- The application user guide (optional)



### WARNING

The power supply unit provided with your equipment is specially designed for Ingenico terminals. Do not use any other power supply. The use of a power supply with apparently similar voltage/current characteristics may damage your terminal.

---

## 3. Recommendations

---

### 3.1. Safety

---

#### Lithium battery

The iSMP is fitted with a lithium battery which is not accessible to the user. Only a qualified technician may be authorized to open the unit and change this component.

#### Battery

iSMP is fitted with battery specially designed for this terminal.

- Only use the appropriate chargers and batteries listed in the Ingenico's catalogue.
- Do not short-circuit the battery.
- Do not attempt to open the battery container.
- Used batteries must be disposed of at the appropriate sites.

#### Electrical power supply network

Provide an electrical outlet:

- Located near the equipment and easily accessible
- Which meets the standards and regulations in the country of use.
- The terminal iSMP can be connected to a power distribution system of the IT type for Norway.



#### Warning

**Risk of explosion if battery is replaced by an incorrect type, do not disassemble, use specified charger only, do not short-circuit, do not dispose of in fire, do not throw in water, dispose of used batteries according to the instructions.**

---

### 3.2. Security of your terminal

---

Upon receipt of your terminal you should check for signs of tampering of the equipment. It is strongly advised that these checks are performed regularly after receipt. You should check, for example: that the keypad is firmly in place; that there is no evidence of unusual wires that have been connected to any ports on your terminal or associated equipment, the chip card reader, or any other part of your terminal. Such checks would provide warning of any unauthorised modifications to your terminal, and other suspicious behaviour of individuals that have access to your terminal. Your terminal detects any "tampered state". In this state the terminal will repeatedly flash the message "Alert Irruption!" and further use of the terminal will not be possible. If you observe the "Alert Irruption!" message, you should contact the terminal helpdesk immediately.

You are strongly advised to ensure that privileged access to your terminal is only granted to staff that have been independently verified as being trustworthy.



#### CAUTION

**NEVER ask the customer to divulge their PIN Code. Customers should be advised to ensure that they are not being overlooked when entering their PIN Code.**

---

### 3.3. EC standard compliance marking

---

EC standard compliance marking certifies that the product stipulated below: **iSMP**.

- complies with the basic requirements of European Directive 1999/5/CE, known as the «**R&TE Directive**» concerning Radio Frequency equipment and telecommunications terminals with respect to:
  - Health and safety protection of the user and all other persons
  - EMC protection
- conforms to the following harmonized standards :
  - IEC/EN 60950-1 : Electrical safety of data processing equipment including electrical office equipment. Issue DEC 2001
  - EN 55022 : Data processing equipment – Radio electric disturbance characteristics - Limits and measurement methods. Issue 1998 / A1-2000/A2-2003
  - EN 55024: Data processing equipment – Immunity characteristics - Limits and measurement methods. Issue 1998 + A1- 2001 + A2- 2003
- complies with the following specification:
  - EN 301511 : Harmonized stand for mobile
  - EN 300328 : (BT + Wi-Fi) Electromagnetic compatibility and Radio Spectrum
  - EN 300330 : NFC Electromagnetic compatibility and Radio Spectrum

### 3.4. FCC & IC Compliance.

---

FCC & IC has a specific naming.

The references uses for FCC & IC certifications are:

For Ipod touch 4<sup>th</sup> version (FCC ID: BCG-E2407 and IC: 579C-E2407):

- IC: 2586D-IMP3YY
- FCC ID: XKB-IMP3YYW (for radio product)
- FCC ID: XKB-IMP3YY (for product with no radio)

For the cradle:

- FCC ID: XKB-IMP3XXCX (for cradle product)

#### **Federal Communications Commission (FCC) Statement**

##### **15.21**

You are cautioned that changes or modifications not expressly approved by the part responsible for compliance could void the user's authority to operate the equipment.

##### **15.105(b)**

This equipment has been tested and found to comply with the limits for a Class B digital device, pursuant to part 15 of the FCC rules. These limits are designed to provide reasonable protection against harmful interference in a residential installation. This equipment generates, uses and can radiate radio frequency energy and, if not installed and used in accordance with the instructions, may cause harmful interference to radio communications. However, there is no guarantee that interference will not occur in a particular installation. If this equipment does cause harmful interference to radio or television reception, which can be determined by turning the equipment off and on, the user is encouraged to try to correct the interference by one or more of the following measures:

- Reorient or relocate the receiving antenna.
- Increase the separation between the equipment and receiver.
- Connect the equipment into an outlet on a circuit different from that to which the receiver is connected.

- Consult the dealer or an experienced radio/TV technician for help.

**15.19 (a) (3)**

This device complies with Part 15 of the FCC Rules. Operation is subject to the following two conditions:

- 1) This device may not cause harmful interference and
- 2) This device must accept any interference received, including interference that may cause undesired operation of the device.

This device complies with FCC and Industry Canada RF radiation exposure limits set forth for general population (uncontrolled exposure). This device must not be collocated or operating in conjunction with any other antenna or transmitter.

**Industry Canada (IC) Statement.**

Under Industry Canada regulations, this radio transmitter may only operate using an antenna of a type and maximum (or lesser) gain approved for transmitter by Industry Canada. To reduce potential radio interference to other users, the antenna type and its gain should be so chosen that the equivalent isotropically radiated power (e.i.r.p) is not more than that necessary for successful communication.

This device complies with Industry Canada licence-exempt RSS standard(s). Operation is subject to the following two conditions:

- 1) this device may not cause interference, and
- 2) this device must accept any interference, including interference that may cause undesired operation of the device.

This device complies with Industry Canada radiation exposure limits set forth for general population. This device must be installed to provide a separation distance of at least 20cm from all persons and must not be co-located or operating in conjunction with any other antenna or transmitter.

For products with no radio (FCC ID: XKB-IMP3YY & FCC ID: XKB-IMP3XXCX):  
This Class (B) digital apparatus complies with Canadian ICES-003



**CAUTION**

The user is cautioned that any changes or modification not approved by INGENICO could void user's authority to operate the equipment.

---



### 3.5. Main Characteristics

---

The main technical characteristics of the terminal Ingenico iSMP are:

Mass	260 g
Dimensions	132x72x32 mm (l x w x h)
Battery	1150 mAh Li-ion
Electrical mains network	100-240VAC / 50-60 Hz - Class II equipment

#### Operating conditions

Ambient temperature	from +5°C to +40°C
Max relative humidity	85% at +40°C
Connections on terminal	Micro USB AB serial link

#### Cradle

Weight	About 120g
Dimensions (L x w x h)	100x122x43mm

#### Power supply unit

Weight	100g
	2 poles sockets 2000mA (base power supply) or 1 A (traveller power supply)

#### Storage conditions

Storage temperature	-20°C,+55°C
Max relative humidity	85% at +55°C

## 4. Installation and connection

### 4.1. Functional description

The iSMP is a secure EMV Chip & PIN mobile payment holster to be used with d iPod touch devices. The iSMP allows mobile merchants to convert their iPod touch into a powerful & secure POS solution. It is composed of 2 functional sides:

#### iPod touch Side



#### iSMP Module (Smartphone Mobility Payment)



- ① Graphic display
- ② Navigation keys in the menus
- ③ Magnetic stripe reader
- ④ Smart card reader
- ⑤ Charge pads
- ⑥ Micro USB connector

- ⑦ 2D bar code reader
- ⑧ iPhone / iPod Touch ON/OFF key
- ⑨ Bar code scanner activation buttons

## 4.2. Battery insertion

---

### CAUTION :

Before starting, switch off the terminal and the iPod touch and disconnect USB cable if fitted

---

- Pull up battery door

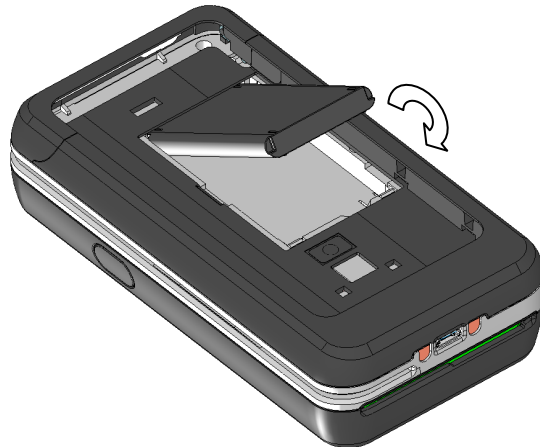
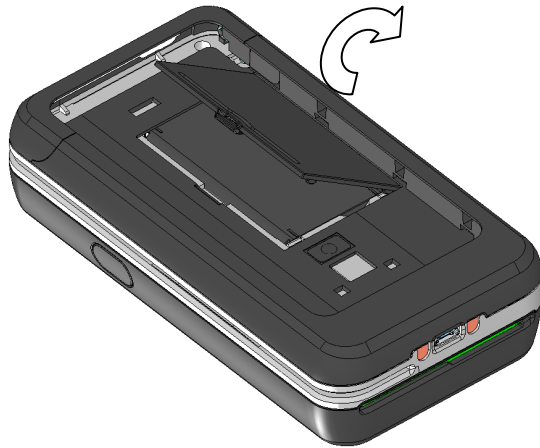

- Insert contact side first



### Warning

There is a risk of explosion if the battery is incorrectly replaced or is placed in a fire. Please dispose of used batteries following instructions in section 6.4.

---

### 4.3. iPod touch insertion

---

**CAUTION :**

Before starting, switch off the terminal and the iPod touch and disconnect USB cable

---

- Pull out the cradle on the bottom of the terminal and rotate
- Insert carefully iPod touch / iPod touch bottom side first.



- Rotate the handle back down and push it back in as shown on the following drawing



## 4.4. Charging iSMP

---

- Before using iSMP for the first time, you need to charge it for about 4 hours.
- After that, you can charge the iSMP 3 hours to recharge the battery to full capacity.
- Charge the iSMP using the power cable or the docking station (provided separately as an accessory).



### CAUTION

Operating the iSMP for the first time without the AC adapter, and without fully charging the backup battery may result in loss of data stored in RAM memory. When the main battery is removed, the backup battery retains date and time for at least 10 minutes.

---

A battery indicator is provided on the iSMP screen, indicating the charge of the module.



The iSMP has been designed to be able to charge the iPod touch while operating.

A charging dock is available as a separate accessory. It connects on the charging pads, and features guiding in the cradle to ensure connection.

The iSMP can also be charged using the charger provided in the package. The charger has to be plugged on the micro-USB connector.



## 4.5. Positioning the terminal

---

Install the terminal on a flat surface, with an easy access to an electrical outlet if needed. Place the terminal away from any heat source and protected from dust, vibrations and electromagnetic radiations (away from video terminals, PC, anti-shoplifting barriers, ...).

Positioning of the iSMP must be in such a way to make cardholder PIN (Personal Identification Number) spying infeasible.

## 4.6. Power on / off

---

To power on the iSMP connect the battery and press green key.  
To power off the iSMP, press dot key + yellow key.

## 4.7. Connection

---

### 4.7.1. USB cable connection

A USB connector is located on the front of the terminal.

- Present the device in front of the connector and plug it



---

### CAUTION

Use only Ingenico cable or accessory not to void warranty.

---

### 4.7.2. Cable disconnection

- Present the device in front of the connector and unplug it

### 4.7.3. Cradle insertion

- Present the device over the cradle , magnetic reader facing cradle guidance slot and plug it carefully.

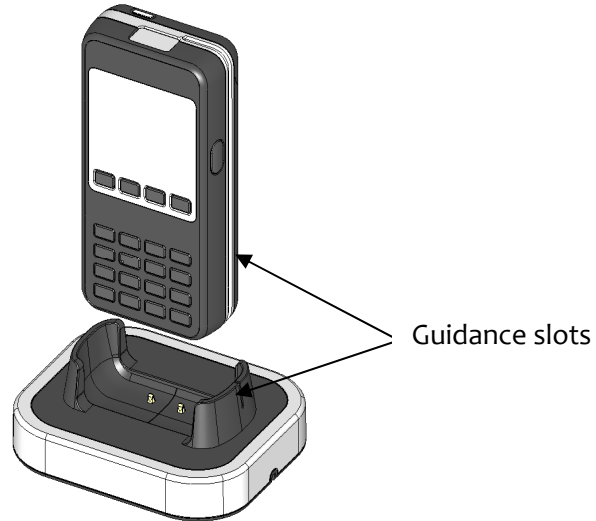

## 5. Daily use

---

### 5.1. Getting started with iSMP

---

- Install the iPod touch on the iSMP as described in section 4
- Switch the iSMP payment module by pressing the green key
- Follow the iSMP initialization procedure. This procedure differs from a customer to another. Please refer to your payment service provider.
- Business payment application running on the iPod touch will be customer specific. Please refer to you business application provider.

### 5.2. Keypad functions

---

#### 5.2.1. iPod touch ON/OFF



- Press and Hold: turns iPod touch touch OFF.
- Press and Hold when the device is in OFF mode: turns the iPod touch ON.



### 5.2.2. iSMP keypad



### 5.3. Adjusting the contrast

---

The screen of your payment module is 128 x 64 pixels, illuminated with white light.

If you wish to increase or to decrease the contrast of the characters displayed on screen, press simultaneously on the ‘-’ key and F2 key in order to decrease the contrast, or the ‘+’ key and F3 key in order to increase.

Keep pressing the keys as long as necessary.

## 5.4. Barcode reader

Barcode is activated with the 2 side keys as shown below.



List of bar codes supported:

Reader type	CMOS Imaging reader Reads 1D and 2D codes
1D	1D: Codabar, Code 3 of 9, Code 11, Code 32 Pharmaceutical (PARAF), Code 93, Code 128, EAN with Add-On and EAN with Extended Coupon Code, EAN-13, Interleaved 2 or 5, Matrix 2 of 5, Plessey, GS1DataBar, Straight 2 of 5 IATA, Straight 2 of 5 Industrial, Telepen, Trioptic Code, UCC/EAN-128, UPC and UPC-A
2D	2D: MicroPDF, Codeblock, Aztec, QRCode, MaxiCode, DataMatrix, PDF417

## 5.5. Card insertion

### 5.5.1. Swiping a card

- Insert the card manually in the driver, magstripe-facing right.



**Swipe the card with constant speed, not too slow not too fast, to maximize the reading and avoid annoying repetitions.**



### 5.5.2. Inserting a chip card

- Chip Cards should be inserted into your terminal as illustrated with the chip facing up and into the card reader



### 5.5.3. Reading Contactless (Optional)

- Bring the card firmly up to the active zone above the display (at about 1cm). Keep the card close to the display during the transaction



Your contactless terminal has a row of four status lights that are visible on display.

- When a contactless transaction is started the first (left hand) status light will be lit steadily; this indicates that the contactless display is in use but a card is not being read.
- When a contactless card is presented to the contactless active zone during a transaction the second, third and fourth status lights will be lit in turn. The card read is successful when all four status lights are lit and the confirmation tone is heard.

## 6. Maintenance

---



### ATTENTION

Before making any operations of maintenance in the terminal, make sure that power supply is disconnected.

---

### 6.1. Cleaning of the terminal

---

First of all, unplug all the wires from the terminal.

Good rules for proper cleaning of the terminal are:

- Use a soft cloth that is very slightly soaked with soapy water to clean the outside of the terminal.
- Do not clean the electrical connections.
- Do not use in any case, solvents, detergents or abrasive products: Those materials might damage the plastic or electrical contacts.
- Avoid exposing the terminal to the direct rays of the sun.
- Do not put anything into the slot of the smart card reader

### 6.2. Transport and storage

---

- Use the original packaging for any unit or stored.
- Disconnect all cables from the terminal during the transport.
- Disconnect battery from the terminal during the storage.

### 6.3. Troubleshooting

---

The terminal does not turn on:

- Battery level is too low
- Check the USB connection
- Check for iSMP positioning into the cradle
- Check for electrical power network

The terminal fails to establish iPod touch connection

- Check that the iPod touch is correctly inserted
- Check the configuration of the iPod touch
- Get support from technical

Cards are not read

- Check that the magnetic card is passed correctly (with magnetic band directed to the interior of the terminal)
- Swipe again the card with the magnetic stripe movement constant and rapid
- Verify that the magnetic strip is not damaged, grooved or cracked
- Make sure you have inserted correctly the smart card into the smart card reader and removed the card only after the transaction

## 6.4. End of life

---

The product belongs to the family of electrical and electronic equipment. Therefore, it is subjected to the WEEE directive which requires the collection and the recycling at the end of life product.

The Ingenico products present the symbol for the marking of electrical and electronic equipment as required by the WEEE Directive.



The crossed-out wheeled bin printed on the product gives the information about the requirement not to dispose of WEEE as unsorted municipal waste and to collect such WEEE separately.

To assure that the product is collected and recycled with respect to the environment, you must contact your supplier (in defect, contact the Ingenico local office or the commercial head office in charge of your country on [www.ingenico.com](http://www.ingenico.com), « contact us » page).

The abandonment or uncontrolled disposal of waste can cause harm to environment and to human health. So, by recycling your product in a responsible manner, you contribute to the preservation of natural resources and to the protection of human health.

“This Document is Copyright © 2011 by INGENICO Group. INGENICO retains full copyright ownership, rights and protection in all material contained in this document. The recipient can receive this document on the condition that he will keep the document confidential and will not use its contents in any form or by any means, except as agreed beforehand, without the prior written permission of INGENICO. Moreover, nobody is authorized to place this document at the disposal of any third party without the prior written permission of INGENICO. If such permission is granted, it will be subject to the condition that the recipient ensures that any other recipient of this document, or information contained therein, is held responsible to INGENICO for the confidentiality of that information.

Care has been taken to ensure that the content of this document is as accurate as possible. INGENICO however declines any responsibility for inaccurate, incomplete or outdated information. The contents of this document may change from time to time without prior notice, and do not create, specify, modify or replace any new or prior contractual obligations agreed upon in writing between INGENICO and the user.

INGENICO is not responsible for any use of this device, which would be non consistent with the present document.

All trademarks used in this document remain the property of their rightful owners.”

iPod touch is trademark of Apple Inc., registered in the U.S. and other countries.

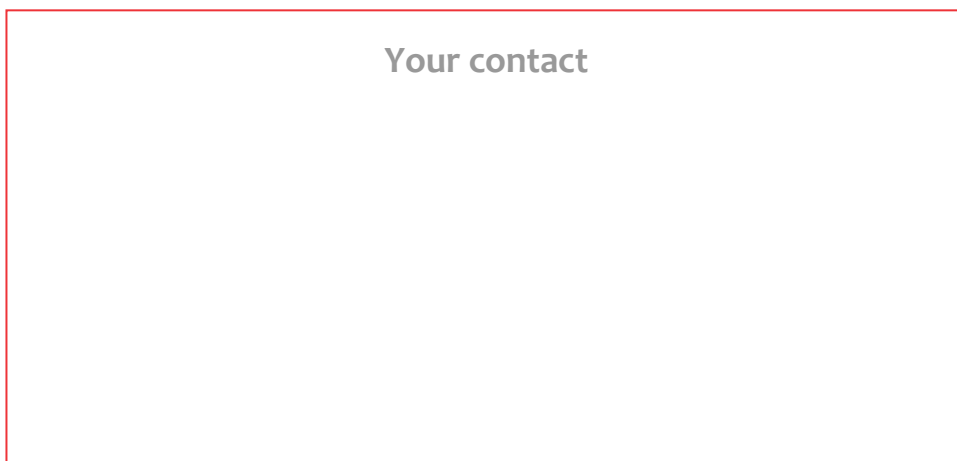

Ingenico  
192 avenue Charles de Gaulle  
92200 Neuilly sur Seine - France  
Tél.: + 33 1 46 25 82 00 - Fax: + 33 1 47 72 56 95  
[www.ingenico.com](http://www.ingenico.com)

\*2961224  
CC ^ Γ \*