

OPERATING INSTRUCTIONS

RF Remote Control
LRC-122RF

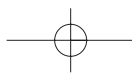

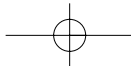

Introduction

ENGLISH

Information To The User

This equipment has been tested and found to comply with the limits for a Class B digital device, pursuant to Part 15 of the FCC Rules. These limits are designed to provide reasonable protection against harmful interference in a residential installation. This equipment generates, uses and can radiate radio frequency energy and, if not installed and used in accordance with the instructions, may cause harmful interference to radio communications. However, there is no guarantee that interference will not occur in a particular installation. If this equipment does cause harmful interference to radio or television reception, which can be determined by turning the equipment off and on, the user is encouraged to try to correct the interference by one or more of the following measures:

- Reorient or relocate the receiving antenna.
- Increase the separation between the equipment and receiver.
- Connect the equipment into an outlet on a circuit different from that to which the receiver is connected.
- Consult the dealer or an experienced radio/TV technician for help.

Caution : Any changes or modifications in construction of this device which are not expressly approved by the party responsible for compliance could void the user's authority to operate the equipment.

This Class B digital apparatus complies with Canadian ICES-003.

Cet appareil numérique de la Classe B est conforme à la norme NMB-003 du Canada.

CONTENTS

- **Specifications** **2**
- **RF Universal Remote Controls** **3**
 - OPERATING COMPONENTS WITH REMOTE CONTROL 5
 - REMOTE CONTROL OPERATION RANGE 5
 - LOADING BATTERIES 5
 - USING FUNCTIONS OF REMOTE CONTROL 6
- **Setup Code Table** **15**

Specifications

- Operating frequency | **2.433 GHz ± 100 kHz**
- RF range | **15 ~ 30 meters (50~100 feet), depending on the environment**
- Sensitivity | **Min. -90 dB**

Note: Design and specifications are subject to change without notice for improvements.

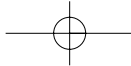

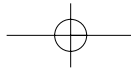

RF Remote Control

This universal remote control can operate not only this receiver but also most popular brands of audio and video components such as CD players, tape decks, TVs, cable boxes, VCRs, DVD players, satellite receivers, etc.

- To operate 7 components other than this receiver, you should enter the setup code for each component. (For details, refer to "USING FUNCTIONS OF REMOTE CONTROL" on page 6.)
- The numbered buttons on the remote control have different functions in different device modes. For details, refer to "FUNCTION TABLE of the NUMBERED BUTTONS" on the next page.

■ About the transmission signal

This remote control can emit not only the infrared beams which the conventional remote control(including the ROOM 2 remote control) uses but also the RF(Radio Frequency) beams which are stronger than those.

To operate this receiver and other components, this remote control should emit the infrared beams.

To operate this receiver only from longer distance even if there are obstacles such as walls, furniture, etc. in the way, this remote control should emit the RF beams.

Therefore, depending on how to use this remote control, you should set the transmission signal mode to "IR"(default value) or "RF". (For details, refer to "Changing the transmission signal" on page 14.)

■ Notes :

- To receive the RF beams, you should connect the RF remote antenna to this receiver. (For details, refer to "CONNECTING RF REMOTE ANTENNA" in the operating instructions of your receiver.)
- If the transmission signal mode is set to "RF", this remote control cannot control other audio and video components. However, if the IR emitter is connected to the IR OUT jack, you can control other component via it. (For details, refer to "CONNECTING MULTI-ROOM SYSTEM KIT" in the operating instructions of your receiver.)

ENGLISH

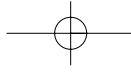
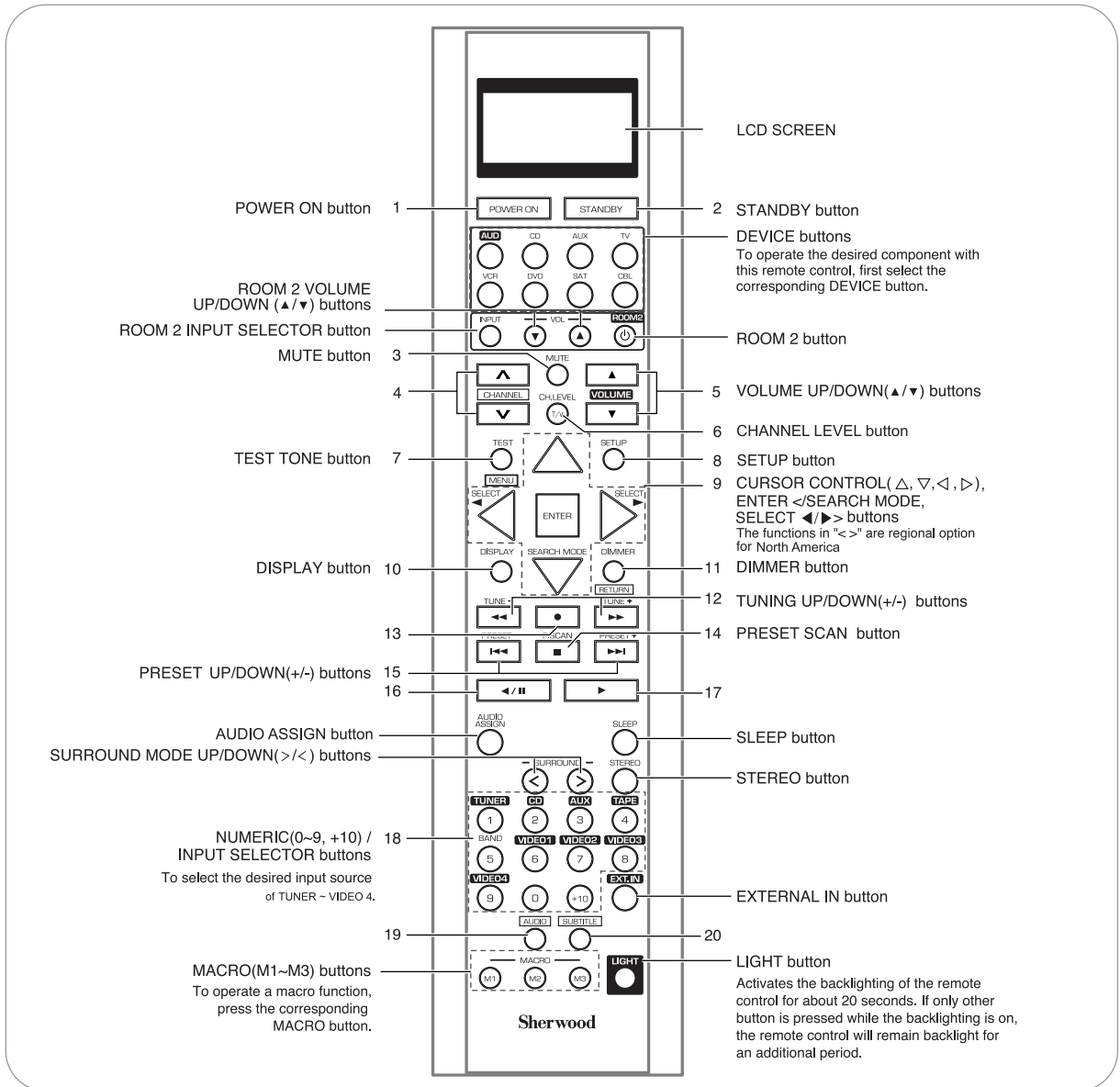

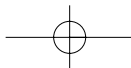

ENGLISH

■FUNCTION TABLE of the NUMBERED BUTTONS.

Device to be controlled	CD (for CD player)	AUX (for tape deck)	TV (for TV)	VCR (for VCR)	DVD (for DVD player)	SAT (for satellite receiver)	CBL (for cable box)
1	POWER ON	POWER ON	POWER ON	POWER ON	POWER ON	POWER ON	POWER ON
2	STANDBY (POWER OFF)	STANDBY (POWER OFF)	STANDBY (POWER OFF)	STANDBY (POWER OFF)	STANDBY (POWER OFF)	STANDBY (POWER OFF)	STANDBY (POWER OFF)
3	—	—	MUTE	MUTE	—	MUTE	MUTE
4	—	—	CHANNEL UP/DOWN(▲/▼)	CHANNEL UP/DOWN(▲/▼)	—	CHANNEL UP/DOWN(▲/▼)	CHANNEL UP/DOWN(▲/▼)
5	—	—	VOLUME UP/DOWN(▲/▼)	VOLUME UP/DOWN(▲/▼)	—	VOLUME UP/DOWN(▲/▼)	VOLUME UP/DOWN(▲/▼)
6	—	—	INPUT SELECTOR	INPUT SELECTOR	—	INPUT SELECTOR	INPUT SELECTOR
7	—	—	—	—	MENU	—	—
8	—	—	—	—	SETUP	—	—
9	—	—	—	—	CURSOR CONTROL	—	—
					ENTER		
10	—	—	—	—	DISPLAY	—	—
11	—	—	—	—	RETURN	—	—
12	REVERSE SEARCH(◀) / FORWARD SEARCH(▶)	REWIND(◀) / FAST FORWARD(▶)	—	REWIND(◀) / FAST FORWARD(▶)	REVERSE SEARCH(◀) / FORWARD SEARCH(▶)	—	—
13	—	RECORD	—	RECORD	—	—	—
14	STOP	STOP	—	STOP	STOP	—	—
15	REVERSE SKIP(◀) / FORWARD SKIP(▶)	—	—	—	REVERSE SKIP(◀) / FORWARD SKIP(▶)	—	—
16	PAUSE	REVERSE PLAY	—	PAUSE	PAUSE	—	—
17	PLAY	FORWARD PLAY	—	PLAY	PLAY	—	—
18	NUMERIC	—	NUMERIC	NUMERIC	NUMERIC	NUMERIC	NUMERIC
19	—	—	—	—	AUDIO	—	—
20	—	—	—	—	SUBTITLE	—	—

■Notes :

- Some functions for each component may not be available or may work differently.
- Depending on other kinds of components that are available for each DEVICE button, some functions may not be available or may work differently, too.
- For details about functions, refer to the operating instructions of each component.

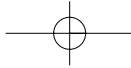

OPERATING COMPONENTS WITH REMOTE CONTROL

1. Enter the setup code for each component other than this receiver. For details, refer to "Entering a setup code" on page 6.
2. Turn on the component you want to operate.
3. Press the DEVICE button on the remote control corresponding to the component you wish to operate.
4. Aim the remote control at the REMOTE SENSOR of the component you wish to control and press the button corresponding to the operation you want.

■ Notes :

- When you cannot operate any component, check if the transmission signal mode is set to "RF". (For details, refer to "Changing the transmission signal" on page 14.)
- In this case, to operate the component, connect the IR emitter to the IR OUT jack and use the remote control toward this receiver. (For details, refer to "CONNECTING RF REMOTE ANTENNA" and "CONNECTING MULTI-ROOM SYSTEM KIT" in the operating instructions of your receiver.)

LOADING BATTERIES

- When the remote control does not operate, the old batteries should be replaced. In this case, load new batteries within several minutes after removing old batteries.
- If the batteries are removed or have been exhausted for a longer period of time, memorized contents will be cleared. Should this happen, you should memorize them again.

1. Remove the cover.

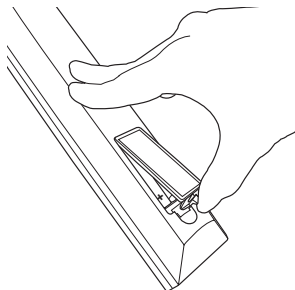

REMOTE CONTROL OPERATION RANGE

- In case that this remote control emits the infrared beams
- Use the remote control within a range of about 7 meters (23 feet) and angles of up to 30 degrees aiming at the remote sensor.

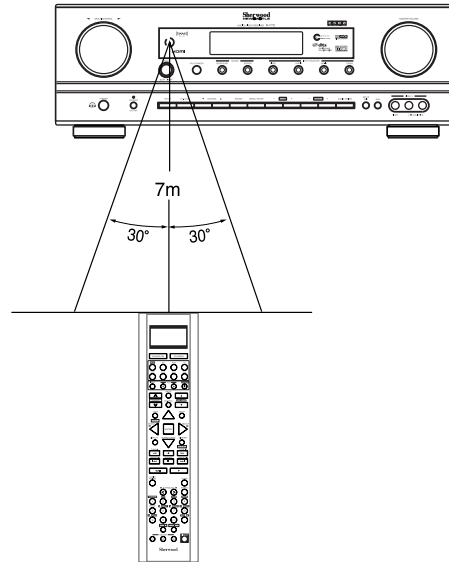

- In case that this remote control emits the RF beams
- Use the remote control within a distance of about 15 meters (50 feet) toward this receiver.

USING FUNCTIONS OF REMOTE CONTROL

- This remote control can control up to 8 different components.
- Before operating audio and video components other than this receiver with using this remote control, the setup code for each component should be entered.
- For system remote control operation, "000" was stored previously in the memory of the device button "CD" for Sherwood CD player, "DVD" for Sherwood DVD player, "AUX" for Sherwood tape deck and "TV" for Sherwood TV respectively as its factory setup code. So, you don't need to enter its code for each Sherwood component except in such a case that its code does not work.
- Note :
 - If the transmission signal which this remote control emits is changed into "RF"(Radio Frequency), this remote control cannot control other audio and video components. (For details, refer to "Changing the transmission signal" on page 14.)

Entering a setup code

- Setup code entry is the easiest way to program this remote control for operating audio and video components.

1. Turn on the component you want to operate.

2. Find the setup codes according to the type and the brand name of your component, referring to "Setup Code Table" on page 15.

3. Press and hold down both the ENTER button and the desired one of the DEVICE buttons for more than 2 seconds.

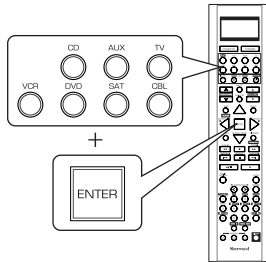

- Then "LEARN" is displayed on the LCD screen for several seconds.

■ Notes :

- The AUDIO button is unavailable for the audio components other than this receiver.
- During setting operation, to exit from the setting mode, press any of the DEVICE buttons.

4. While "LEARN" is displayed, press the CURSOR UP(▲)/DOWN(▼) buttons to select the setup code mode ("CODE"), then press the ENTER button.

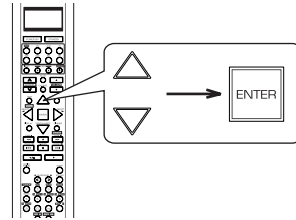

- Each time the CURSOR UP(▲)/DOWN(▼) buttons are pressed, the mode changes as follows :

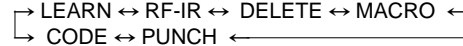

- Then "PRESET" and 3 digit number are displayed.
- If "PRESET", etc. go off, start again from the above step 3.

5. While "PRESET", etc. are displayed, enter a 3 digit code and press the ENTER button.

Example: When entering "001".

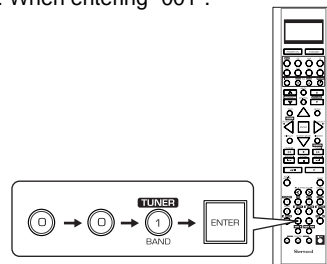

- Then "OK" is displayed on the LCD screen.
- To be sure that the setup code is correct, press the POWER ON (or STANDBY) button, aiming the remote sensor on the component.
- If the setup code is correct, your component will be turned off.
- When your component is not turned off, repeat the above steps 2 to 5, trying entering each code for your component until you find one that works.
- If "NG" is displayed, retry entering the correct setup code while "PRESET" and 3 digit number are displayed.

6. Operate the component using the corresponding function buttons.

- If any of buttons fails to operate as they should, start from the step 1 again to enter the correct setup code.

■ **Note :**

- Manufacturers may use different setup codes for the same product category. For that reason, it is important that you check to see if the code you have entered operates as many controls as possible. If only a few functions operate, check to see if another code will work with more buttons.

7. Repeat the above steps 1 to 6 for each of your other components.

Searching a setup code

- In addition to enter a setup code using "Setup Code Table" on page 15, it is also possible to search through all the codes that are stored in the library of this remote control.

1. Turn on the component you want to operate.

2. Perform the steps 3 and 4 in "Entering a setup code" procedure on page 6 to select the setup code mode ("CODE").

3. While "PRESET" is displayed, search a setup code, aiming the remote control at the remote sensor on the component.

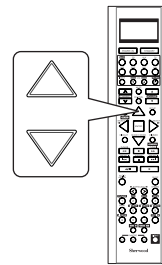

- Each time the CURSOR UP(▲)/DOWN(▼) buttons are pressed, the setup code is selected one by one.
- If the selected code is correct, your component will be turned off.
- When your component is not turned off, repeat this step until you find one that works.

4. While "PRESET" is displayed, press the ENTER button to store the setup code.

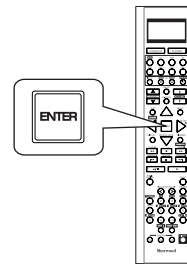

- Then "OK" is displayed on the LCD screen.

5. Operate the component using the corresponding function buttons.

- If any of buttons fails to operate as they should, start from the step 1 again to find the correct setup code.

6. Repeat the above steps 1 to 5 for each of your other components.

Programming the commands from other remote controls (LEARNING mode)

- If the setup codes are not available for your component or you want to program a missing or special function into one button of a device, the learning function enables this remote control to learn the commands from other remote controls.

1. Place this remote control and other remote control facing each other at a distance of 5 to 15 cm (2 to 6 inches) apart.

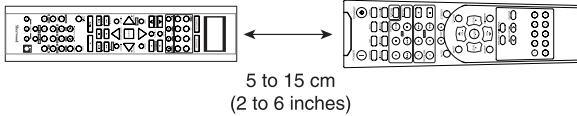

2. Press and hold down the ENTER button and the desired one of the DEVICE buttons for more than 2 seconds.

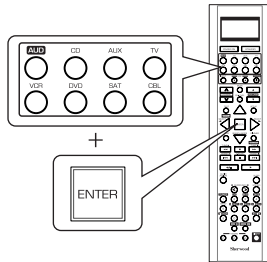

- Then "LEARN" is displayed on the LCD screen for several seconds
- Note :
 - During setting operation, to exit from the setting mode, press any of the DEVICE buttons.

3. While "LEARN" is displayed, press the ENTER button.

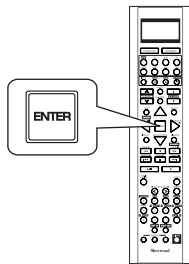

- Then "SEL" is flickering.
- If "SEL" goes off, start again from the above step 2.

4. While "SEL" is flickering, on this remote control, press the button corresponding to the function to be learned.

Example: If the function to be learned is playback, press the PLAY(▶) button.

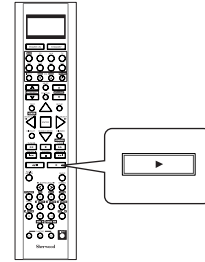

- Then "READY" is displayed.
- Note:
 - You cannot program a function into some buttons such as DEVICE, MACRO and LIGHT buttons.

5. While "READY" is displayed, on the other remote control, press the button of the function to be learned.

- If the command has been learned successfully, "OK" is displayed and then "SEL" is flickering.
- If "ERROR" is displayed and then "SEL" is flickering, it means that for some reason the command was not learned. In this case, repeat the above steps 4 and 5.

■ Notes :

- If an incorrect signal has been sent or, in some cases, the command from other remote control simply cannot be learned.
- In some "ERROR" cases, the remote controls just need to be moved closer together or farther apart.

6. While "SEL" is flickering, repeat the above steps 4 and 5 to program all the commands you want to the buttons on this remote control under the same device mode.

- To exit from the setting mode, press any of the DEVICE buttons.

7. Repeat the above steps 1 to 6 to program the commands from a different remote control.

8. Operate the newly programmed buttons to make sure the learning function was performed properly.

Erasing the programmed command from one button

1. Perform the steps 3 and 4 in "Entering a setup code" procedure on page 20 to select the deleting mode ("DELETE").
 - Then "BTTN" is displayed on the LCD screen for several seconds.
2. While "BTTN" is displayed, press the CURSOR UP(▲)/DOWN(▼) buttons to select the one command deleting mode (BTTN), then press the ENTER button.

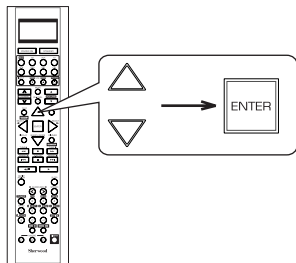

- Each time the CURSOR UP(▲)/DOWN(▼) buttons are pressed, "BTTN" or "LEARN"(all command deleting mode) is selected.
- Then "SEL" is flickering.
- If "SEL" goes off, start again from the above step 1.

3. While "SEL" is flickering, press the button for the command you want to erase.

Example: When the button for the command to be erased is PLAY button.

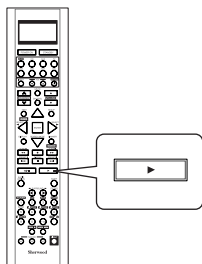

- "OK" is displayed and then "SEL" is flickering.
4. While "SEL" is flickering, repeat the above step 3 to erase other commands.

Erasing all the commands programmed under a device mode

1. Perform the steps 3 and 4 in "Entering a setup code" procedure on page 6 to select the deleting mode ("DELETE").
 - Then "BTTN" is displayed on the LCD screen for several seconds.
2. While "BTTN" is displayed, press the CURSOR UP(▲)/DOWN(▼) buttons to select the all command deleting mode ("LEARN"), then press the ENTER button.

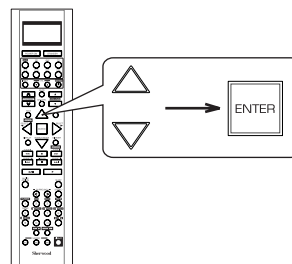

- Then "SURE?" is displayed .
- If "SURE?" goes off, start again from the above step 1.

3. While "SURE?" is displayed, press the ENTER button.

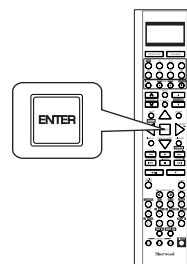

- Then all the commands programmed are erased.
4. To erase all the commands programmed under other device mode, repeat the above steps 1 to 3.

Programming a macro function

- The macro function enables you to program a series of button operations (up to 15) on this remote control into a single button.
- You can store up to three separate macro command sequences into "M1", "M2" and "M3" buttons.

1. Perform the steps 3 and 4 in "Entering a setup code" procedure on page 6 to select the macro mode ("MACRO").

- Then "M1" is displayed on the LCD screen for several seconds.
- During macro setting operation, pressing any of the DEVICE buttons cannot exit from the macro mode.

2. While "M1" is displayed, press the CURSOR UP(▲)/DOWN(▼) buttons to select the MACRO button to be programmed into, then press the ENTER button.

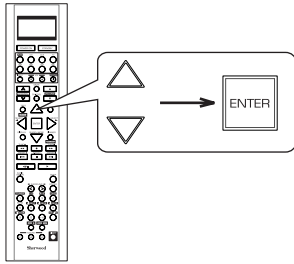

- Each time the CURSOR UP(▲)/DOWN(▼) buttons are pressed, "M1", "M2" or "M3" is selected.
- Then "SEL" is flickering.
- If "SEL" goes off, start again from the above step 1.

3. While "SEL" is flickering, press the operation buttons you want to program in order.

Example: When playing a DVD on the DVD player connected to VIDEO 2 jacks of this receiver.

- ①. Press "AUDIO" button to control this receiver.
- ②. Press "POWER ON" button to turn this receiver on.
- ③. Press "VIDEO 2(7)" button to select the desired input source.
- ④. Press "DVD" button to control the DVD player.
- ⑤. Press "POWER ON" button to turn the DVD player on.
- ⑥. Press "PLAY (▶)" button to start playback.



- Each time the operation buttons are pressed, the programmed order is displayed.

4. Press any of the MACRO buttons (M1~M3) to complete the programming.

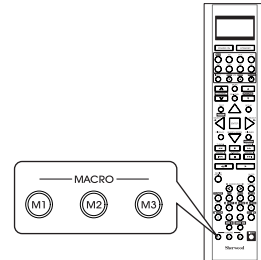

- Then "OK" is displayed.

■ To erase a macro program

- When erasing a macro program, perform the above steps 1, 2 and 4, but ignore the step 3.

■ To change a macro program

- When a new macro program is stored into a MACRO button with performing the above steps 1 to 4, the previous macro program is erased from the memory of the MACRO button.

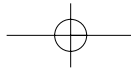

Operating a macro function

- Aim the remote control at the REMOTE SENSORS of the components to be controlled and press the MACRO button you want.
Example : When pressing "M1" button.

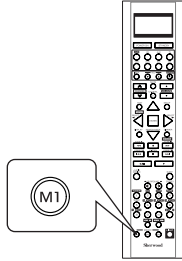

■ Notes:

- The codes programmed into a MACRO button will be transmitted at an interval of 0.5 seconds. However, some components may not be able to complete one operation in 0.5 seconds and may miss the next code. In this case, the macro function cannot control the corresponding components correctly.
- Be sure to use the remote control within the remote control operation range of the components.
- Depending on the operation status of the components, etc., the macro function cannot control the corresponding components correctly.

Programming a punch-through function

- The punch-through function allows the volume controls, channel controls or transport controls to link to a different device while a device is controlled with this remote control as a master device.
- For example, since this receiver will likely be used as the sound system while watching TV, you may want to use volume controls to operate this receiver although this remote control is set to control the TV.

1. Perform the steps 3 and 4 in "Entering a setup code" procedure on page 6 to select a master device and the punch-through mode ("PUNCH").

- Then "VOL" is displayed on the LCD screen for several seconds.

2. While "VOL" is displayed, press the CURSOR UP(▲)/DOWN(▼) buttons to select the desired punch-through mode, then press the ENTER button.

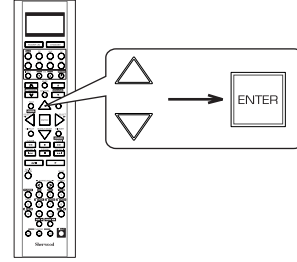

- Each time the CURSOR UP(▲)/DOWN(▼) buttons are pressed, the mode changes as follows:
 - VOL : The volume punch-through mode allows the "VOLUME ▲/▼" and "MUTE" buttons to operate a different device.
 - ↕
 - DELETE : All punch-through deleting mode.
 - ↕
 - PLAY : The transport punch-through mode allows the "◀◀", "●", "▶▶", "I◀◀", "■", "▶▶", "◀/||" and "▶" buttons to operate a different device.
 - ↕
 - CH : The channel punch-through mode allows the "CHANNEL ▲/▼" and "CH. LEVEL" buttons to operate a different device.
- Then the device to which you can link the selected punch-through mode is displayed.

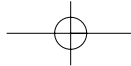

Continued

- 3.** While the device is displayed, press the CURSOR UP(▲)/DOWN(▼) buttons to select the desired punch-through device, then press the ENTER button.

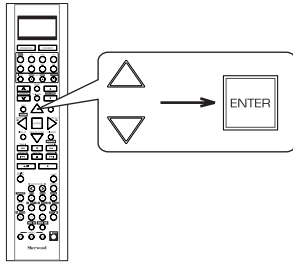

- Each time the CURSOR UP(▲)/DOWN(▼) buttons are pressed, depending on the selected punch-through mode, punch-through devices and the one punch-through deleting mode ("DELETE") are selected as follows :

- In case of the volume punch-through,
→ AUDIO ↔ DELETE ↔ TV ←
- In case of the transport punch-through,
→ CD ↔ DELETE ↔ DVD ↔ VCR ↔ AUX ←
- In case of the channel punch-through,
→ TV ↔ DELETE ↔ SAT ↔ CABLE ↔ VCR ←
- Then "OK" is displayed and the current punch-through mode is displayed.

- 4.** While the punch-through mode is displayed, repeat the above steps 2 and 3 to program other punch-through function under the same master device mode.

- 5.** To program punch-through functions under other master device mode, repeat the above steps 1 to 4.

Operating a punch-through function

- While this remote control is set to control a master device, aim the remote control at the REMOTE SENSOR of the punch-through device and press the desired button of the programmed punch-through controls.
Example: When pressing "PLAY (▶)" button.

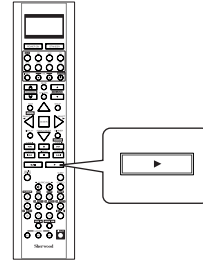

- Then the punch-through device is displayed on the LCD screen.

Erasing the programmed punch-through function

- 1.** Perform the steps 3 and 4 in "Entering a setup code" procedure on page 6 to select a master device and the punch-through mode ("PUNCH").

- Then "VOL" is displayed on the LCD screen for several seconds.

- 2.** While "VOL" is displayed, press the CURSOR UP(▲)/DOWN(▼) buttons to select the punch-through mode to be erased, then press the ENTER button.

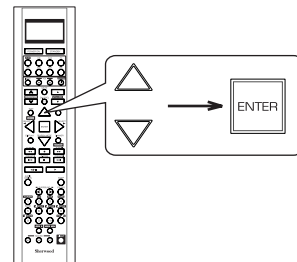

- Each time the CURSOR UP(▲)/DOWN(▼) buttons are pressed, the mode changes as follows:

→ VOL ↔ DELETE ↔ PLAY ↔ CH ←

- Then the device is displayed .

Continued

3. While the device is displayed, press the CURSOR UP(▲)/DOWN(▼) buttons to select the one punch-through deleting mode ("DELETE"), then press the ENTER button.

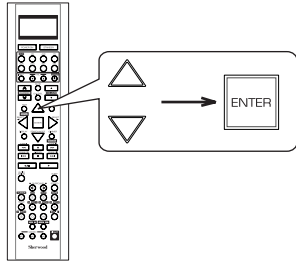

- Each time the CURSOR UP(▲)/DOWN(▼) buttons are pressed, depending on the selected punch-through mode, the punch-through devices and the deleting mode ("DELETE") are selected.
- Then "OK" is displayed and the current punch-through mode is displayed .

4. While the punch-through mode is displayed, repeat the above steps 2 and 3 to erase other punch-through function under the same master device mode.

5. To erase punch-through functions under other master device mode, repeat the above steps 1 to 4.

Erasing all the punch-through functions programmed under a master device mode

1. Perform the steps 3 and 4 in "Entering a setup code" procedure on page 6 to select a master device and the punch-through mode ("PUNCH").

- Then "VOL" is displayed on the LCD screen for several seconds.

2. While "VOL" is displayed, press the CURSOR UP(▲)/DOWN(▼) buttons to select the all punch-through deleting mode ("DELETE").

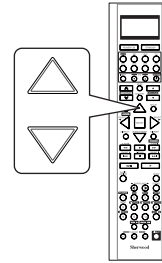

- Each time the CURSOR UP(▲)/DOWN(▼) buttons are pressed, the mode changes as follows:

→ VOL ↔ DELETE ↔ PLAY ↔ CH ←

- Then "DELETE" is displayed .

3. While "DELETE" is displayed, to erase all the punch-through functions programmed under the master device mode, press ENTER button.

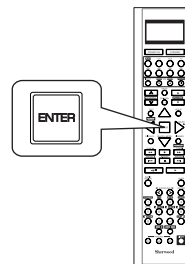

- Then "OK" is displayed and "DELETE" is displayed.
- To exit from the deleting mode, press any of the DEVICE buttons.

4. To erase all the punch-through functions programmed under other master device mode, repeat the above steps 1 to 3.

Changing the transmission signal

- This remote control can emit not only the infrared beams which the conventional remote control uses but also the RF(Radio Frequency) beams which are stronger than those.
- When you want to control this receiver from longer distance even if there are obstacles such as walls, furniture, etc. in the way, change the transmission signal into "RF"(Radio Frequency).

■ Notes:

- When the RF remote antenna is not connected, remote operation will become unreliable. (For details, refer to "CONNECTING RF REMOTE ANTENNA" in the operating instructions of your receiver.)
- If the transmission signal mode is set to "RF" (Radio Frequency), this remote control cannot control other audio and video components.
- In this case, to control the component, connect the IR emitter to the IR OUT jack. (For details, refer to "CONNECTING MULTI-ROOM SYSTEM KIT" in the operating instructions of your receiver.)

1. Press and hold down the ENTER button and any of the DEVICE buttons for more than 2 seconds.

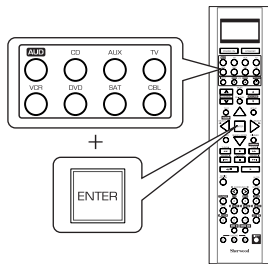

- Then "LEARN" is displayed on the LCD screen for several seconds.

■ Note:

- During setting operation, to exit from the setting mode, press any of the DEVICE buttons.

2. While "LEARN" is displayed, press the CURSOR UP(▲)/DOWN(▼) buttons to select the transmission signal mode("RF-IR"), then press the ENTER button.

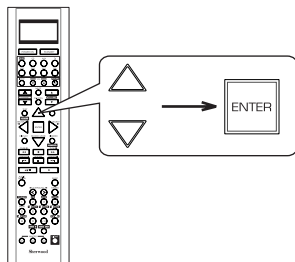

- Then "RF" (or "IR") is displayed.
- If "RF" (or "IR") goes off, start again from the above step 1.

3. While "RF" (or "IR") is displayed, press the CURSOR UP(▲)/DOWN(▼) buttons to select the desired transmission signal, then press the ENTER button.

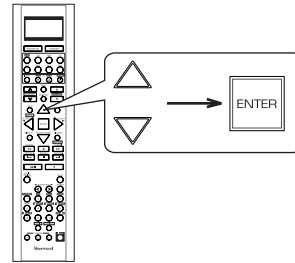

- Each time the CURSOR UP(▲)/DOWN(▼) buttons are pressed, the mode changes as follows :
 "RF" : This remote control emits the RF(Radio Frequency) beams which stronger than the infrared beams.
 ↑
 "IR" : This remote control emits the infrared beams which the conventional remote control uses.
 ↓
 • Then "OK" is displayed.

■ When "RF" is set to.

4. To pair up this remote control and the receiver, press the CONTROL DOWN(▼) button and the MEMORY/ENTER button simultaneously on the receiver.

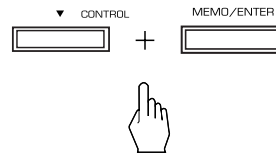

- "RF REMOCON PAIRING MODE" is displayed for several seconds on the display of the receiver.
- If "RF REMOCON PAIRING MODE" goes off, press these buttons again.

5. While "RF REMOCON PAIRING MODE" is displayed, press the ENTER button, aiming at the receiver.

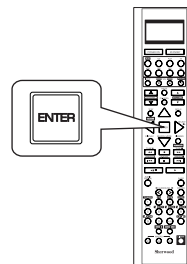

- Then "PAIRING SUCCESS" is displayed.

ENGLISH

Pilot	005	003	006			
Pioneer	022					
Portland	003	006	014			
Prism	008					
Proscan	007					
Proton	025	032				
Pulsar	002	003				
Quasar	008	042	021			
RCA	007	008	041	003	013	015
	037	038	039	040		
Radio Shack	007	019	021	027	005	025
	003	011	006			
Realistic	019	021	027	005	025	003
	011	006				
Runco	002	005	033			
SSS	027	003				
Sampo	005	006				
Samsung	012	005	025	003	011	045
Samsux	006					
Sansei	030					
Sansui	031					
Sanyo	019					
Scimitsu	003					
Scotch	025					
Scott	028	027	025	003	026	
Sears	007	010	019	020	025	026
	011	023				
Semivox	027					
Semp	020					
Sharp	041	021	006			
Sherwood	000					
Shogun	003					
Signature	001					
Sony	050					
Soundesign	027	025	026			
Squareview	023					
Starlite	027					
Supreme	050					
Sylvania	010	005				
Symphonic	023					
TMK	025	011	024			
Tandy	041					
Technics	008	042				
Technoi Ace	026					
Techwood	008	011				
Teknika	010	027	017	012	003	026
	011	001	006	014		
Telefunken	011					
Toshiba	019	020	012			
Totevision	006					
Vector Research	005					
Victor	009					
Vidikron	010					

Vidtech	025	003				
Wards	010	021	005	025	004	003
	026	011	001			
White Westinghouse	031	034	035			
Yamaha	005	003				
Zenith	002	031	001	014		

VCR

Admiral	027	021				
Adventura	000					
Aiko	025					
Aiwa	005	000				
Akai	026					
America Action	025					
America High	004					
Asha	023					
Audiovox	005					
Beaumarck	023					
Bell & Howell	017					
Brocksonic	021					
Broksonic	020	018	021	001		
CCE	015	025				
Calix	005					
Canon	004					
Carver	016					
Cineral	025					
Citizen	005	025				
Colt	015					
Craig	005	012	023	015	024	
Curtis Mathes	013	004	026	028		
Cybernex	023					
Daewoo	010	025				
Denon	008					
Dynatech	000					
Electrohome	005					
Electroponic	005					
Emerex	002					
Emerson	005	020	000	018	009	021
	001	025				
Fisher	012	017				
Fuji	004	003				
Funai	000					
GE	013	004	027	023		
Garrard	000					
GoldStar	005	006				
Gradiente	000					
HI-Q	012					
Harley Davidson	000					
Harman/Kardon	016	006				
Harwood	015					

Headquarter	011					
Hitachi	000	008	026			
JVC	014	026				
Jensen	026					
KEC	005	025				
KLH	015					
Kenwood	014	026	006			
Kodak	004	005				
LXI	005					
Lloyd's	000					
Logik	015					
MEI	004					
MGA	023	009				
MGN Technology	023					
MTC	023	000				
Magnasonic	025					
Magnavox	004	007	016	000	019	
Magnin	023					
Marantz	004	016				
Marta	005					
Matsushita	004	028	029			
Memorex	004	005	027	007	012	023
	000	017	021	011	031	032
Minolta	008					
Mitsubishi	027	014	009			
Motorola	004	016				
Multitech	000	015				
NEC	017	014	026	006		
Nikko	005					
Noblex	023					
Olympus	004					
Opimus	005	027	017	028	029	030
	031	032				
Orion	020	021	001			
Panasonic	004	028	022	029	031	
Penny	004	005	023	008	006	
Pentax	008					
Philco	004	021				
Philips	004	016				
Pilot	005					
Pioneer	014					
Profitronic	023					
Proscan	013					
Protec	015					
Pulsar	007					
Quarter	011					
Quartz	011					
Quasar	004	028	029	031		
RCA	013	004	027	023	008	019
Radio Shack	000					
Radix	005					
Randex	005					

Realistic	004	005	027	012	000	017
	011					
Runco	007					
STS	008					
Samsung	023	010	033			
Sanky	027	007				
Sansui	000	014	021	026	024	
Sanyo	012	023	017	011		
Scott	020	010	018	009		
Sears	004	005	012	000	008	017
	011					
Semp	010					
Sharp	027					
Shintom	015					
Shogun	023					
Singer	015					
Sony	004	002	000	003		
Sylvania	004	016	000	009		
Symphonic	000					
TMK	023					
Tatung	026					
Teac	000	026				
Technics	004	028				
Teknika	004	005	000			
Thomas	000					
Toshiba	010	009				
Totevision	005	023				
Unitech	023					
Vector	010					
Vector Research	006					
Video Concepts	010					
Videosonic	023					
Wards	013	004	027	012	016	023
	000	008	015	019		
White WestingHouse	021	025				
XR-100	004	000	015			
Yamaha	006					
Zenith	007	000	021	003		

ENGLISH

VCR - TV/VCR

Ameira High	004 (TV use 008)
Brocksonic	001
Colt	015
Cutis Mathes	004 (TV use 008)
Daewoo	025
Emerson	001
Funai	000
GE	004 (TV use 008) 013 (TV use 007)
	027 (TV use 041) 023
Hitachi	004 (TV use 008) 000

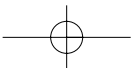

ENGLISH

HQ	000
Lloyds	000
MGA	023
Megavox	016 (TV use 010) 004 (TV use 008) 000
Magnin	023
Memorex	005 028 (TV use 042)
Mitsubishi	027 (TV use 041)
Orion	001
Panasonic	004 (TV use 008) 028 (TV use 042)
Penney	004 (TV use 008) 023 028 (TV use 042)
Quasar	004 (TV use 008) 028 (TV use 042)
RCA	013 (TV use 007) 004 (TV use 008) 027 (TV use 041)
Sansui	000
Sanyo	023
Sear	000 005
Sharp	027 (TV use 041)
Sony	002 (TV use 050)
Symphonic	000
Zenith	000

CBL

ABC	002	003	009	030	006	008
	037	107	036	059	062	066
	072					
Adelphia	063	085				
Allegro	018	021				
Altrio	063					
Americast	103					
Archer	018	026	038	040	047	
Armstrong	085					
AT&T Broadband	085					
Atlantic Broadband	063	085				
Bell South	103					
Bell&Howell	009					
Blue Ridge	063	085				
Bresnan	085					
Bright House	063	114				
Buckeye Comm	085					
Cablevision	063	085	112			
Centurion	096					
Century	018	040				
Charter	063	085				
Citizen	018	021	040			
Cogeco	085					
Combano	089	090				
Comcast	063	085	114			
Comsat	085					
Comtronics	014					
Contec	011					
Cox Digital	063	085				
Digicable	105					
Eagle	050	052	060			
Eastern	001	076	081			
Echostar	110					
Electriccord	054					
Emerson	026					
Everquest	010	014				
Focus	022					
Garrard	018					
Gemini	010	041	073			
General Electric	084					
General Instrument	033	032	006	034	085	107
	108					
GNC	103					
Golden Channel	052					
GoldStar	017	014				
Goodmind	026					
Hamlin	012	020	004	013	068	069
	074					

DVD

Apex	015
Harman/Kardon	009
JVC	008
Kenwood	005
Megavox	024
Mitsubishi	001
Onkyo	024
Panasonic	013
Philips	024 006
Pioneer	003 014 026
Proscan	002
RCA	002
Samsung	017
Sherwood	001 023 012 011 000 016 018 019 020 021 022
Sony	004
Technics	013
Theta Digital	014
Toshiba	024
Yamaha	013 007
Zenith	024 010

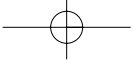

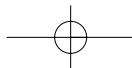

Hitachi	006	107	074			
Insight	085					
Jasco	010	018	021			
Jerrold	002	007	033	032	009	010
	006	034	035	036	037	041
	042	043	082	085	107	
Magnavox	043	045	080	088	099	098
Massillon	085					
Media One	111					
Medicom	074					
Memorex	000	071				
Mitsubishi	106					
Motorola	085	114	113	106		
Movie Time	015	028	054			
Moxi	106					
Nctc	085					
NSC	015	048	051	058	083	
Oak	011	053	057	072		
Optimus	031					
Pace	063	085				
Panasonic	000	016	031	064	067	
Paragon	000	071				
Philips	018	039	045	046	050	091
	099					
Pioneer	017	025	063	107	055	070
	079	086	109			
Popular Mechanics	022					
Prucer	077					
Pulsar	000	071				
Quasar	000					
RCA	031	067				
Radio Shack	010	021	026	028		
Recoton	022	102				
Regal	012	020	068	069		
Regency	001	076				
Rembrandt	006					
Rodgers	063					
Runco	000					
Samsung	017	014	052			
Scientific Atlanta	003	023	030	027	063	044
	036	061	062	065	066	
Seren	063					
Service Electric	085					
Shaw	085					
Sherwood	000					
Sigecom	063					
Signal	010	014				
Signature	006					
SL Marx	014					
Sony	100	112				
Sprucer	031	067	087			
Starcom	002	010	035	037	041	042

Stargate	010	014	026	041	052	101
	108					
Starquest	010					
Susquehanna	063	085				
Televue	014					
Time Warner	063	085				
Tocom	007	008	059	060	075	
Toshiba	000	071				
Tusa	010					
TV86	015					
Unika	018					
United Cable	037	072				
Universal	018	019	038	040	047	054
	056					
Videotron	063					
Viewstar	015	045	048	049	092	093
	094	095				
Wide Open West	063	103				
Zenith	000	024	071	078	097	104
Zentek	022					

ENGLISH

SAT

AlphaStar	008					
Cablevision/voom	031					
Chaparral	001					
Directv	053					
Echostar/dish	009	024	049	050		
Expreevu	009					
Expressvu	024					
General Electric	033	021	032			
General Instrument	016	015	018	031		
Goi	024					
Hitachi	011	028	029			
HTS	009	024				
Hughes	043	044	019	036	047	048
	022	023				
Hughes Net.Sys	007					
JVC	009	024				
Jerrold	016	015				
LG	052					
Magnavox	027					
Megavox	006	005				
Memorex	006					
Mitsubishi	019	036				
Motorola	031					
Next Level	018	031				
Panasonic	017	030	042			
Pansat	027					
Philips	006	005	034	035	038	019
	036	027	022	023		

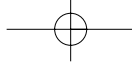

ENGLISH

Primestar	016	015			
Proscan	033	021	032		
Radio Shack	018	031			
RCA	003	000	002	012	
Realistic	014				
RSA	033	021	032		
Samsung	025	037	045	051	054
Sherwood	000				
SKY	046				
Sony	004	020			
Star Choice	018	031			
Toshiba	010	026	019	036	039 040
Uniden	006	005	014	027	
Zenith	013	041			

AUX-CD AMP

Aiwa	030
Carver	023
Curtis Mathes	027
Denon	037
Harman/Kardon	040
Linn	023
Megavox	023
Marantz	023
Panasonic	039
Philips	023 040
Pioneer	003 027
Sony	019 033
Technics	039
Wards	003
Yamaha	028

AUX-MD

Sherwood	035 (for Mini Disc)
----------	---------------------

AUX-HOME AUTOMATION

GE	043
Lutron	044
One For All	042
Radio Shack	043
Security System	042
Universal X10	042
X10	042

AUX-LD

Denon	007
Mitsubishi	007
NAD	007
Pioneer	007
Sony	017 018

AUX-DBS

Aiwa	045	029
Fisher	005	
Harman/Kardon	046	
JBL	046	
JVC	047	
Jerrold	031	
RCA	006	
Scientific Atlanta	032	
Sony	045	
Starcom	031	

AUX-TAPE

Aiwa	004	034
Carver	004	
Harman/Kardon	016	004
JVC	022	024
Kenwood	008	
Megavox	004	
Marantz	004	
Onkyo	012	025
Opimus	002	020
Panasonic	038	
Pioneer	002	019 011
Sansui	004	
Sherwood	000	
Sony	021	014 026
Technics	038	
Victor	024	
Wards	002	
Yamaha	010	009

AUX-VIDEO ACCESSORY

Archer	013
GC Electronics	013
Jebsee	013
Rabbit	036
Radio Shack	013
Telecaption	015

CD

Aiwa	010	030			
Burmester	019				
California Audio Lab	002				
Carver	010	012	020		
DKK	001				
Denon	028	034			
Emerson	035				
Fisher	012	033			
Garrard	019	018			
Genexxa	004	035			
Harman/Kardon	010	011			
Hitachi	004				
JVC	007				
Kenwood	003	029	016	024	025
Krell	010				
LXI	035				
Linn	010				
MCS	002				
MTC	019				
Megavox	010	035			
Marantz	002	010	013		
Mission	010				
NSM	010				
Nikko	033				
Onkyo	008	026			
Opimus	001	004	012	035	029
	019	009	021	020	
Panasonic	002	031			
Parasound	019				
Philips	010	023			
Pioneer	004	035	021	017	
Proton	010				
QED	010				
Quasar	002				
RCA	012	035	006	036	
Realistic	012	019	013		
Rotel	010	019			
SAE	010				
Sansui	010	035			
Sanyo	012				
Scott	035				
Sears	035				
Sharp	029	013	037		
Sherwood	013	027	038	039	040 041
	000				
Sony	001	014	022		
Soundesign	009				

Tascam

Tascam	019			
Teac	019	018	033	013
Technics	002	031		
Victor	007			
Wards	010	006		
Yamaha	005	015		
Yorx	032			

ENGLISH

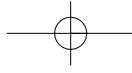

RF Remote Control

LRC-122RF

 **Sherwood**

