



S5/S3

SOUND PANORAMA

OPERATING INSTRUCTIONS

Safety Information

READ THIS BEFORE OPERATING YOUR UNIT



R&TTE Directive 1999/5/EC

CAUTION
RISK OF ELECTRIC SHOCK
DO NOT OPEN



CAUTION

TO REDUCE THE RISK OF ELECTRIC SHOCK,
DO NOT REMOVE FRONT OR BACK COVER.
NO USER-SERVICEABLE PARTS INSIDE.
REFER SERVICING TO QUALIFIED SERVICE
PERSONNEL.



This symbol indicates the presence of uninsulated “dangerous voltage” within the product’s enclosure that may be of sufficient magnitude to constitute a risk of electric shock.



This symbol indicates important operating and maintenance (servicing) instructions in the literature accompanying the appliance.

WARNING: TO REDUCE THE RISK OF FIRE OR ELECTRIC SHOCK, DO NOT EXPOSE THIS APPLIANCE TO RAIN OR MOISTURE.

CAUTION

- Leave space around the unit for sufficient ventilation.
- Avoid installation in extremely hot or cold locations, or in an area that is exposed to direct sunlight or heating equipment.
- Keep the unit free from moisture, water, and dust.
- Do not let foreign objects in the unit.
- Keep the ventilation openings clear of items, such as newspapers, linens, or curtains.
- Keep an open flame from candles or other sources away from the unit.
- Observe the local regulations regarding the disposal of packaging materials, exhausted batteries and old equipment.
- Do not expose the unit to dripping or splashing, or place objects filled with liquid such as vases.
- Do not let insecticides, benzene, or thinner come in contact with the unit.
- Never disassemble or modify the unit in any way.

Caution regarding installation

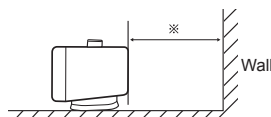
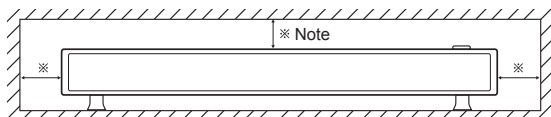

Do not block ventilation openings or stack other equipment on the top.

Note: For heat dispersal, do not install this unit in a confined space such as a bookcase or similar enclosure.

Notes on the AC power cord and the wall outlet

- The unit remains connected to AC power as long as it is plugged into the wall outlet, even if the unit has been turned off.
- To completely disconnect this product from AC power, disconnect the plug from the wall socket outlet.
- When setting up this product, make sure that the AC outlet you are using is easily accessible.
- Disconnect the plug from the wall outlet when not using the unit for long periods of time.

A NOTE ABOUT RECYCLING

This product's packaging materials are recyclable and can be reused. Please dispose of any materials in accordance with the local recycling regulations.

When discarding the unit, comply with local rules or regulations.

Batteries should never be thrown away or incinerated but disposed of in accordance with the local regulations concerning battery disposal.

This product and the supplied accessories, excluding the batteries, constitute the applicable product according to the WEEE directive.



Pb

FCC Notice

This equipment has been tested and found to comply with the limits for a Class B digital device, pursuant to Part 15 of the FCC Rules. These limits are designed to provide reasonable protection against harmful interference in a residential installation. This equipment generates, uses and can radiate radio frequency energy and, if not installed and used in accordance with the instructions, may cause harmful interference to radio communications. However, there is no guarantee that interference will not occur in a particular installation. If this equipment does cause harmful interference to radio or television reception, which can be determined by turning the equipment off and on, the user is encouraged to try to correct the interference by one or more of the following measures:

Reorient or relocate the receiving antenna.

Increase the separation between the equipment and the receiver.

Connect the equipment to an outlet on a circuit different from that to which the receiver is connected.

Consult the dealer or an experienced radio/TV technician for help.

This device complies with part 15 of the FCC Rules. Operation is subject to the following two conditions :

- (a) This device may not cause harmful interference, and
- (b) This device must accept any interference received, including interference that may cause undesired operation.

(FCC Part 15.21) Caution: changes or modifications not expressly approved by the party responsible for compliance could void the user's authority to operate the equipment.

Important Safety Instructions

- 1 Read these instructions.
- 2 Keep these instructions.
- 3 Heed all warnings.
- 4 Follow all instructions.
- 5 Do not use this apparatus near water.
- 6 Clean only with dry cloth.
- 7 Do not block any ventilation openings. Install in accordance with the manufacturer's instructions.
- 8 Do not install near any heat sources such as radiators, heat registers, stoves, or other apparatus (including amplifiers) that produce heat.
- 9 Do not defeat the safety purpose of the polarized or grounding-type plug. A polarized plug has two blades with one wider than the other. A grounding type plug has two blades and a third grounding prong. The wide blade or the third prong is provided for your safety. If the provided plug does not fit into your outlet, consult an electrician for replacement of the obsolete outlet.
- 10 Protect the power cord from being walked on or pinched particularly at plugs, convenience receptacles, and the point where they exit from the apparatus.
- 11 Only use attachments/accessories specified by the manufacturer.
- 12 Use only with the cart, stand, tripod, bracket, or table specified by the manufacturer, or sold with the apparatus. When a cart is used, use caution when moving the cart/apparatus combination to avoid injury from tip-over.
- 13 Unplug this apparatus during lightning storms or when unused for long periods of time.
- 14 Refer all servicing to qualified service personnel. Servicing is required when the apparatus has been damaged in any way, such as power-supply cord or plug is damaged, liquid has been spilled or objects have fallen into the apparatus, the apparatus has been exposed to rain or moisture, does not operate normally, or has been dropped.



Product Name: SOUND PANORAMA

Model Number: S5/S3

Responsible Party Name: Inkel Corporation

Address: Cheongcheon-Dong, Bupyeong-Gu, Incheon, Korea, 403-853

Phone: 82-32-650-6000

URL: <http://www.inkel.co.kr>

Table of Contents

2 SAFETY INFORMATION

6 GETTING STARTED

- 6 What's Included
- 7 Parts Description

10 INSTALLATION

- 10 Installing the System
- 11 Installing the Remote Control Battery
- 11 Operating the Range of the Remote Control

12 CONNECTIONS

- 12 AUX Connection
- 12 Coaxial Digital Audio Connection
- 13 Optical Connection
- 14 Power Connection

15 OPERATION

- 15 Basic Operation
- 17 Muting the Sound
- 18 Using Remote Repeater (IR Repeater)
- 19 Learning TV Remote Control Operations (IR Learning)
- 21 Removing All Learned TV Remote Control Operations
- 22 Listening to Music via Bluetooth (Only for S5)

24 SETTINGS

- 24 Setting the Surround Mode
- 25 Audio Detecting
- 26 Resetting the Main Unit
- 27 Adjusting the Subwoofer Volume
- 27 Adjusting the Delay Time (Audio Sync)
- 28 Setting Auto Power Control

29 TROUBLESHOOTING

31 SPECIFICATIONS

32 TRADEMARKS AND LICENSES

Getting Started

What's Included

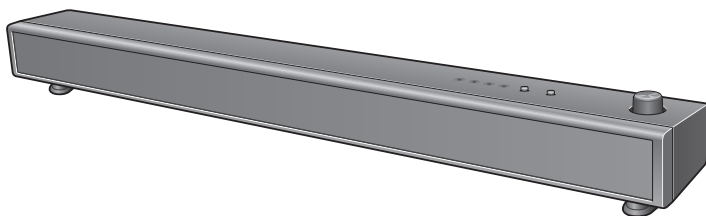

Main unit



Remote control (1 ea)



“AAA” size batteries, 1.5V (2 ea)

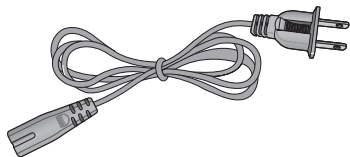

Power cable (1 ea)

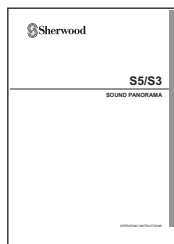

User manual (1 ea)

Parts Description

Front & Bottom Panels

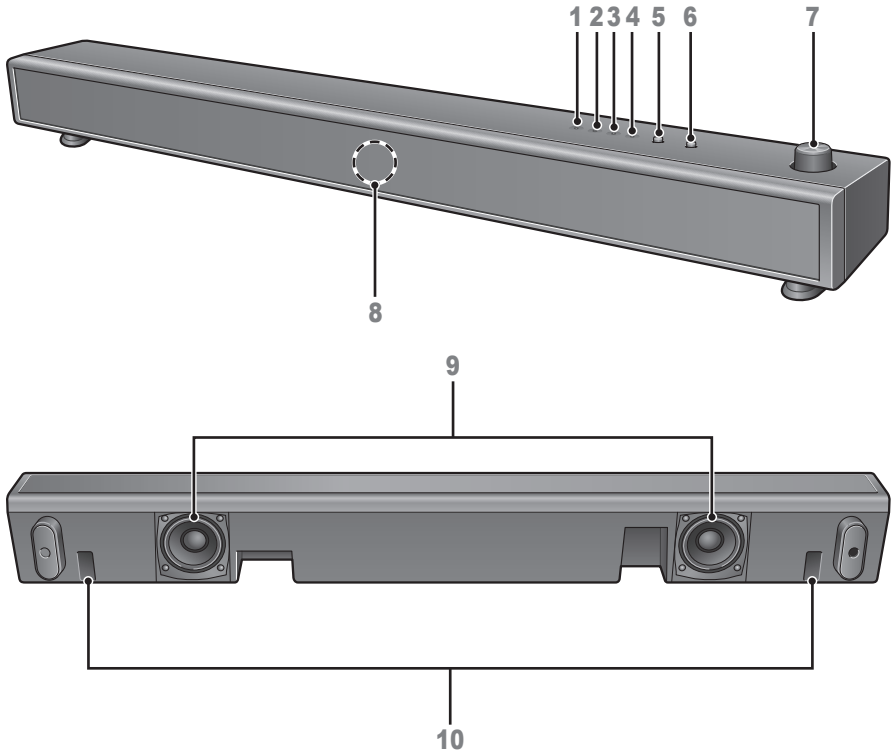

- | | |
|---|---|
| 1 Dolby Digital/DTS indicator(S5)
Dolby Digital indicator(S3) | 5 ON/STANDBY button |
| 2 SURROUND indicator | 6 INPUT SELECT button |
| 3 INPUT indicator | 7 Volume controller |
| 4 STANDBY/Bluetooth indicator(S5)
STANDBY indicator (S3) | 8 Remote IR & Learning IR sensor |
| | 9 Subwoofers |
| | 10 Duct holes |

Rear Panel

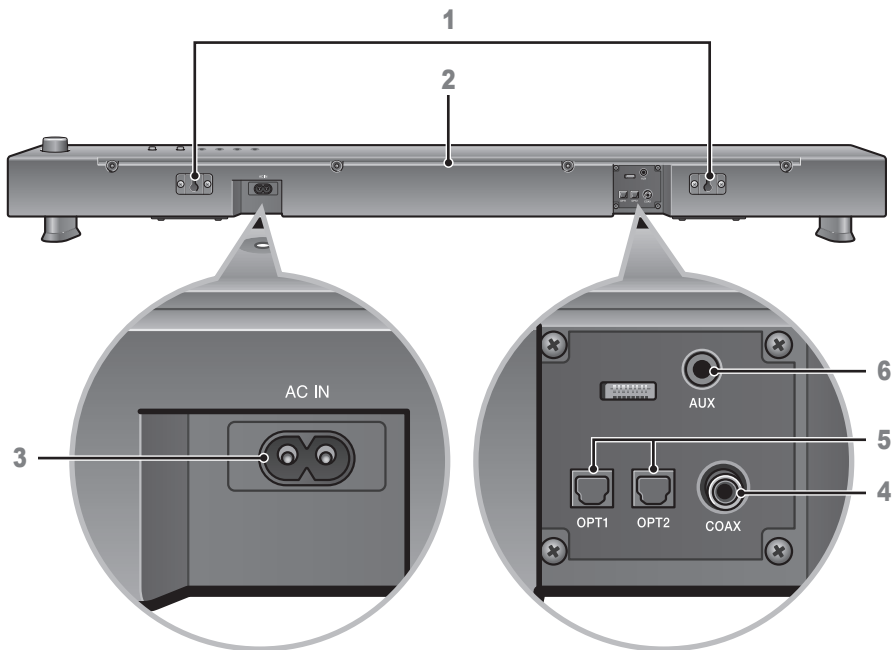

- 1 Wall mount bracket
- 2 IR repeater
- 3 AC power connector

- 4 Coaxial connector
- 5 Optical input connectors
- 6 AUX IN connector

Remote Control

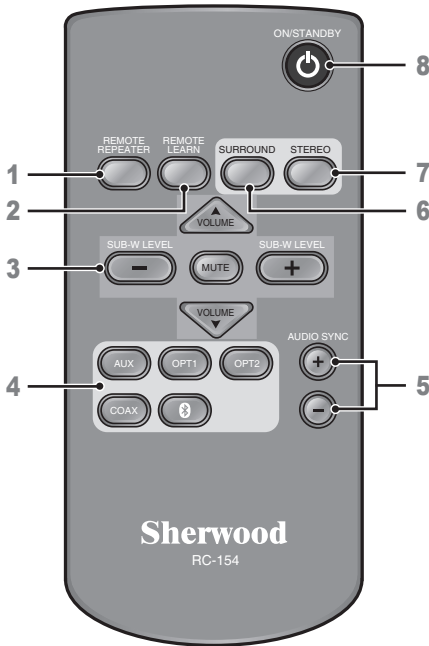

- 1 Remote repeater button**
Turns the remote repeat function on or off.
- 2 Remote learn button**
Sets or resets the remote learning function.
- 3 Volume buttons**
Adjusts the volume level.
Sub-woofer Level buttons
Adjusts the subwoofer volume level.
Mute button
Mutes the sound.
- 4 Input select buttons**
Selects an input function.
(Bluetooth is available only for S5.)
- 5 Audio sync buttons**
Adjusts the audio output delay times.
- 6 Surround button**
Sets the surround mode.
- 7 Stereo button**
Sets the stereo mode.
- 8 ON/STANDBY button**
Turns on the main unit or turns the main unit to the standby mode.

Installation

Installing the System

To Install on a Shelf

You can install the main unit on a shelf. Place the main unit at a height close to ear-level in the listening area.

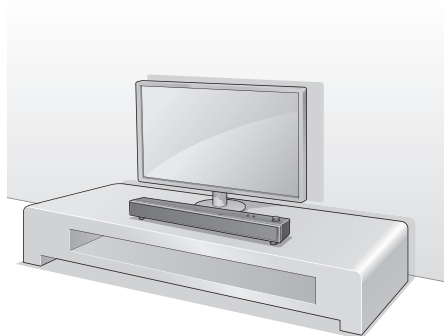

When installing the main unit, use a stable surface to avoid accidents or injury.

To Install on a Wall

You can install the main unit on the wall. Before installation, see "Connections" on page 12 and complete the wiring connections.

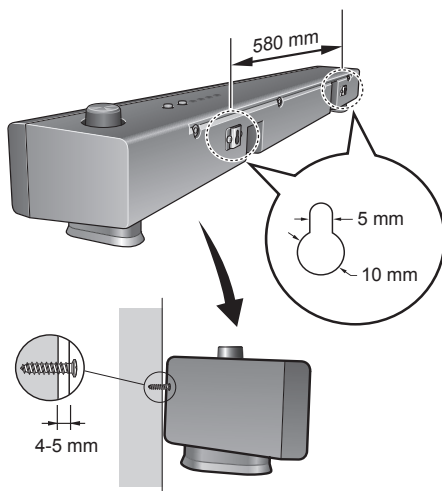

Caution

- When the main unit is installed on a wall, its weight could cause the screws to come loose over time, or it may not be adequately supported by the wall, resulting in the unit falling. Make sure that the wall you intend to mount the unit on is strong enough to support it. Do not mount the unit on plywood or soft surface walls. If you are uncertain of the wall quality, consult a professional for an advice.
- Sherwood is not responsible for any accidents or damage that result from improper installation, misuse or modification of the product, or from natural disasters.
- Mounting screws are not supplied. Use screws suitable for the wall material and that can support the weight of the unit. It is recommended to use 50 mm (2 inch) long screws.
- The main unit is magnetically shielded. However, depending on the installation location, color distortion may occur if the main unit is installed extremely close to the TV screen. If this happens, turn the main unit off, and turn it back on after 15 minutes. If the problem persists, move the main unit further from the TV.

Installing the Remote Control Battery

1 Remove the battery cover.

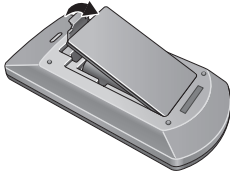

2 Insert two AAA size batteries with the polarity matched properly.

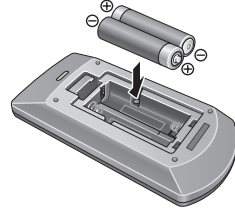

Caution

- Always use alkaline batteries, and do not use the rechargeable batteries (Ni-Cd type).
- If the batteries run out, remove the old batteries and replace them with new ones within several minutes.
- If the batteries are removed or have been exhausted for a longer period of time, saved settings will be cleared. In this case, you should set them again.
- If the battery is placed incorrectly, it can cause explosion.
- Remove the battery if the remote control is not used for a long period of time.
- Do not leave the product in a hot or humid place.
- Do not handle and store the battery with metallic tools.

Operating the Range of the Remote Control

Use the remote control within a range of about 7 meters (23 feet) and angles of up to 30 degrees aiming at the remote control sensor.

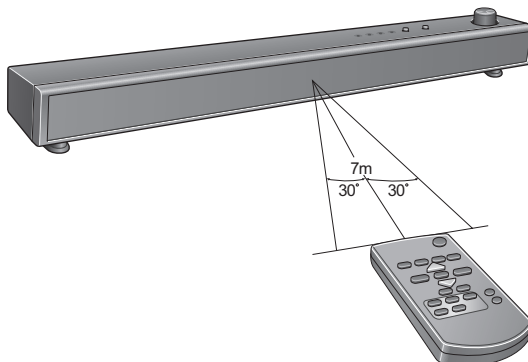

Connections

AUX Connection

You can use the AUX IN input jack to connect portable audio components such as an MP3 player, etc. Plug one end of the 3.5 mm stereo cable into AUX IN connector of the main unit and the other end to the portable audio components.

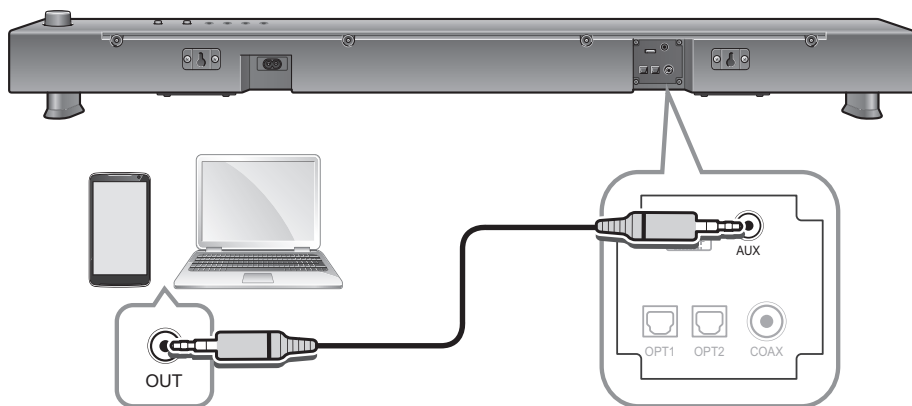

Coaxial Digital Audio Connection

If your source devices have a coaxial digital output, connect it to the main unit's coaxial digital audio connector.

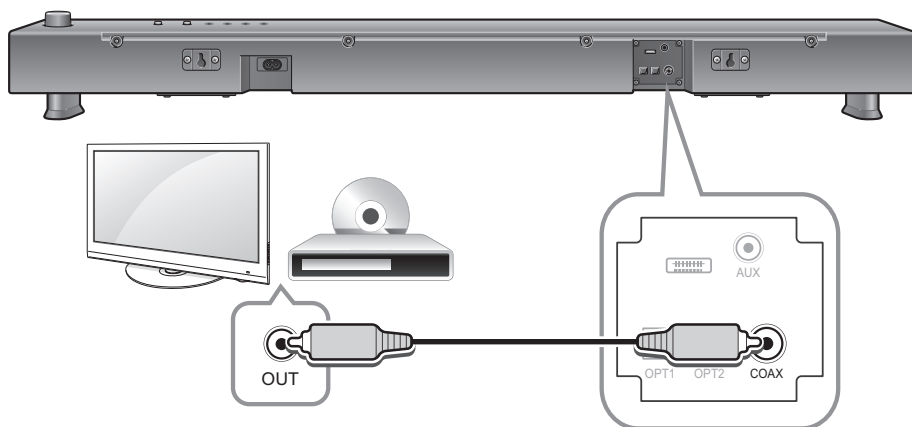

Optical Connection

You can connect components equipped with an optical output port. On the main unit, you can enjoy more plentifully the sound of components, such as DVD players, satellite receiver/cable boxes, BD (Blu-ray Disc™) players or TVs.

* "Blu-ray Disc" is a trademark of Blu-ray Disc Association.

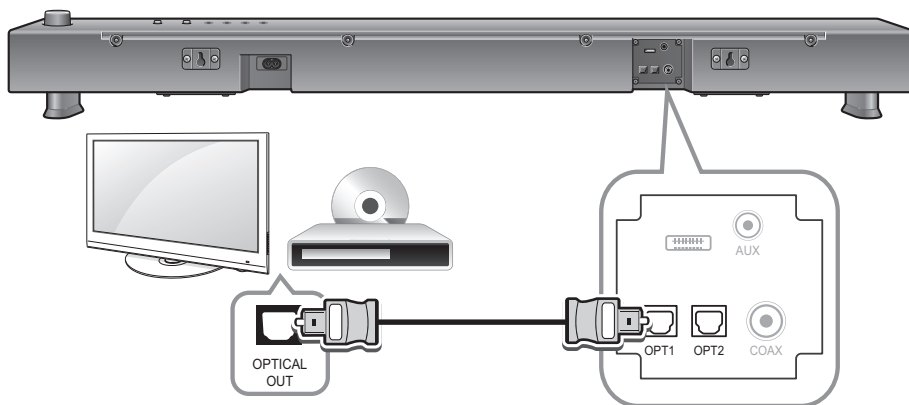

Caution

- TVs without an optical output jack cannot be connected to the unit.

Power Connection

Make sure to plug in after you have connected all your components to the main unit. Plug the supplied AC input cord into the AC inlet and then into the wall AC outlet.

Make sure to turn on the power button after plugging in. Otherwise, you cannot turn on the main unit even after plugging in completely and pressing the power button on the top panel.

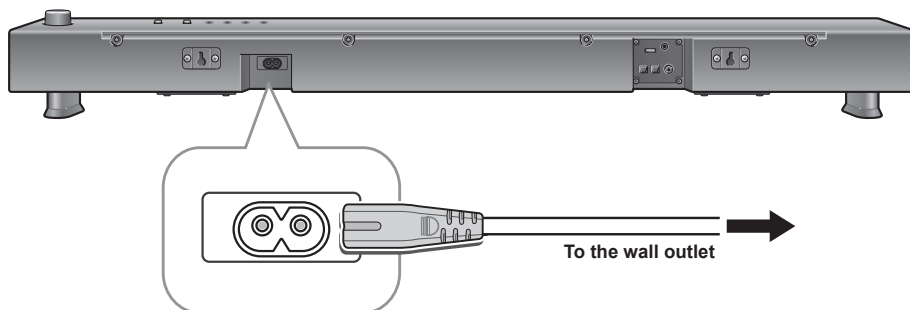

Caution

- The supplied AC adapter is designed exclusively for use with this unit. Do not attempt to use it with any device for which was not expressly designed, since fires or shocks may occur.
- Handle the power cord by the plug part. Do not pull out the plug by tugging the cord, and never touch the power cord when your hands are wet, as this could cause a short circuit or electric shock.
- The system should be disconnected by removing the main plug from the wall socket when not in regular use for a long period of time.

Operation

Basic Operation

You can play music by following the basic procedures below.

- 1 Turn on the connected component.
- 2 Turn on the main unit.
 - On the main unit, press **ON/STANDBY**.
 - On the remote control, press **ON/STANDBY**.

The STANDBY LED is displayed as follows.

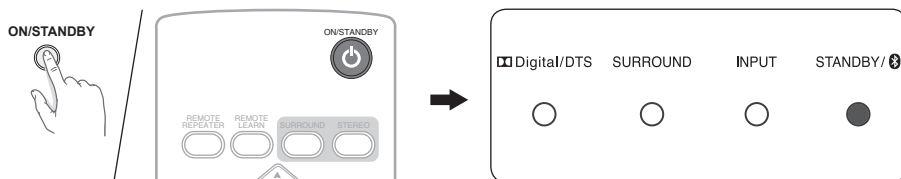

Display	Description
Off	The main unit is powered on.
Red	The main unit is on standby mode.



Note

- The STANDBY LED keeps flashing rapidly for about 7 seconds for loading and it turns off.

- 3 Select an input source you want to play back.
 - On the main unit, press **INPUT SELECT**.
 - On the remote control, press the input select button.
 - Each time the button is pressed, the INPUT LED changes as follows.

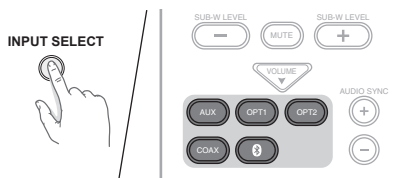

LED	Display	Description
INPUT	Off	AUX is selected.
	Red	OPTICAL 1 is selected.
	Green	OPTICAL 2 is selected.
	Yellow	COAXIAL is selected.
STANDBY/ 	Blinking	The main unit tries Bluetooth pairing.
	Blue	The main unit is paired via Bluetooth.
	Blue/Red Mix	When moving to other input function after Bluetooth pairing

- 4 During playback, you can adjust the volume level.
- On the main unit, rotate the volume controller.
 - On the remote control, press **VOLUME ▲/▼**.
 - As the volume level increases, the LEDs are lighting up as follows.

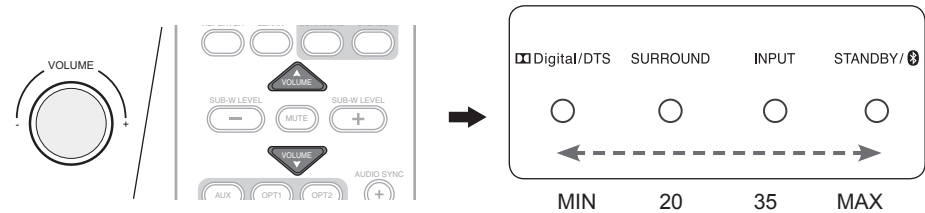

Muting the Sound

You can mute the sound temporarily by pressing **MUTE**.

- 1 Press **MUTE** to mute the sound.
The LEDs of DolbyDigital/DTS, SURROUND, INPUT blink yellow and the STANDBY/Bluetooth LED blinks blue/red mix.

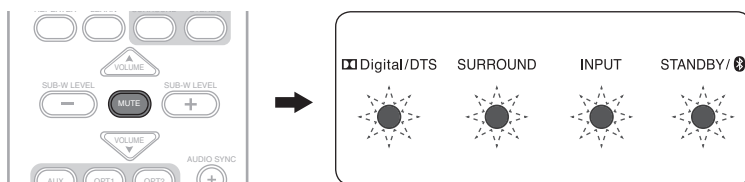

- 2 Press **MUTE** or **VOLUME ▲/▼** to turn on the sound.
Then, the current volume level is displayed on a LED for 3 seconds and the LEDs are displayed according to selected input and surround statuses.

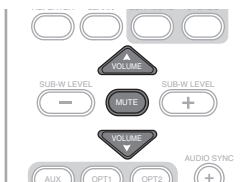

Using Remote Repeater (IR Repeater)

When the main unit blocks the sensor of your TV, TV remote control operation may be difficult. The Remote repeater allows other remote control commands to pass-through the front of the main unit to your TV behind it, eliminating this problem. That is, the function enables the main unit to forward the TV remote control signal received from the IR sensor of the front of the main unit to the remote control sensor of your TV through the IR repeater sensors at the rear of the main unit.

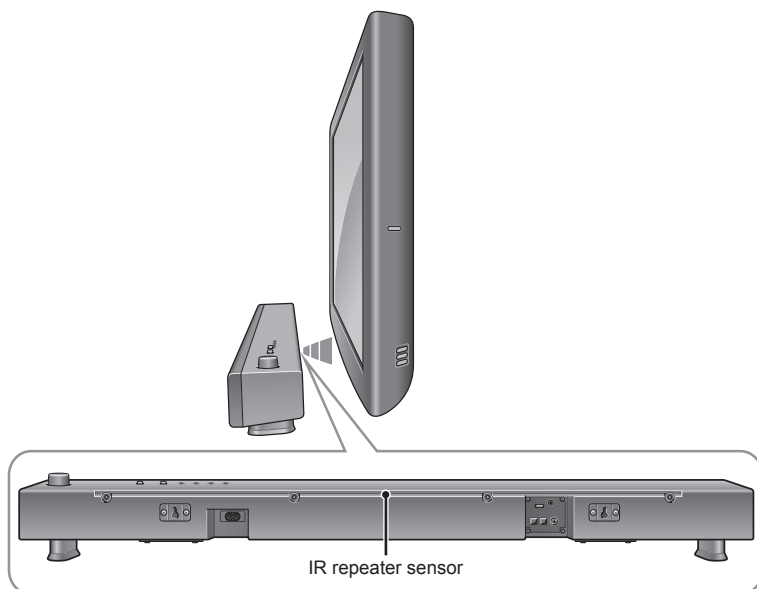

- 1 Turn on the main unit by pressing **ON/STANDBY**.

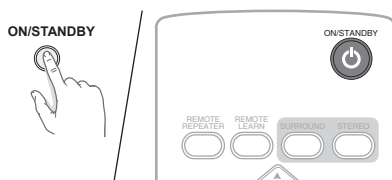

2 Turn on the remote repeater function by pressing and holding **REMOTE REPEATER**.

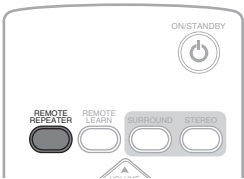

- When the remote repeater function is enabled and the main unit is turned on from the standby mode, you can check the remote repeater function status by the following LED statuses.

LED	Display	Description
SURROUND	Blinking twice and off	The remote repeater is enabled.
	No change	The remote repeater is disabled.

Learning TV Remote Control Operations (IR Learning)

The Remote Learning function enables you to operate the main unit with a TV remote control. You can operate the following functions by the TV remote control.

- Turning on the main unit or turns it to the standby mode.
- Volume down
- Volume up

1 Press **REMOTE LEARN**.
Then the LEDs of Dolby Digital/DTS, SURROUND, and INPUT blink yellow.

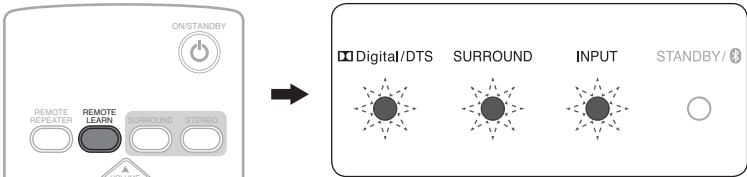

- 2** Press the **POWER** button of the TV remote control.
The Dolby Digital/DTS LED turns green for 2 seconds and then turns off.

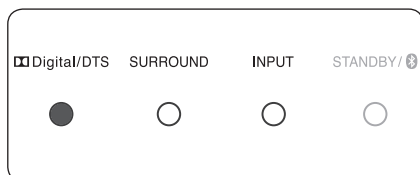

- 3** Press the **VOLUME DOWN** button of the TV remote control.
The SURROUND LED turns green for 2 seconds and then turns off.

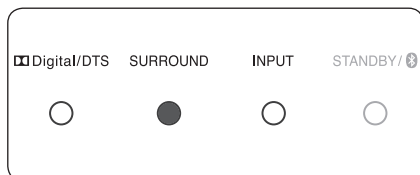

- 4** Press the **VOLUME UP** button of the TV remote control.
The INPUT LED turns green for 2 seconds and then turns off.
Then, the remote learning is completed and you can operate the main unit with the TV remote control.

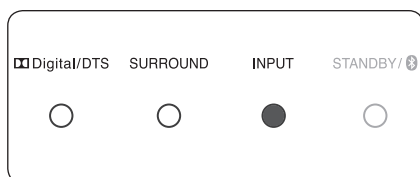

Note

- These functions may not be controlled depending on TV remote control types.
- Make sure to use the supplied remote control.

Removing All Learned TV Remote Control Operations

- 1 Press and hold **REMOTE LEARN** for 5 seconds. Then the LEDs of Dolby Digital/DTS, SURROUND, and INPUT blink red.

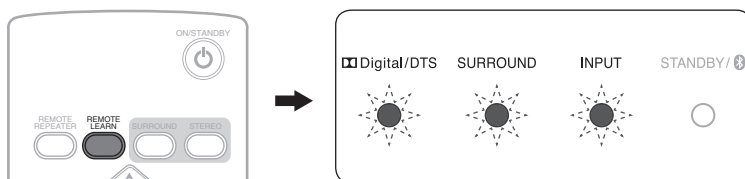

- 2 When all of the learned operations are removed, the LEDs of Dolby Digital/DTS, SURROUND, INPUT blink 3 times and turns off, and then a LED lights up according to a selected input function.

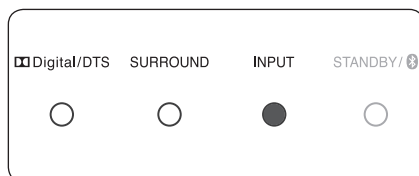

Listening to Music via Bluetooth (Only for S5)

The main unit uses Bluetooth wireless technology to stream music from your Bluetooth devices.

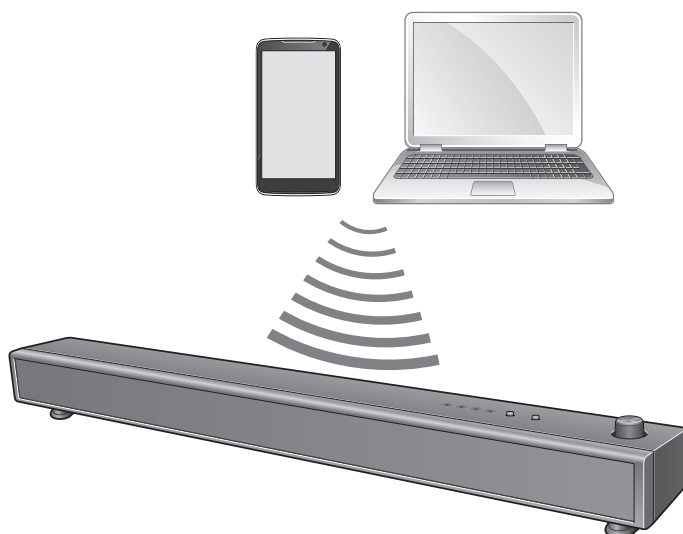

- 1 Turn on the main unit.
- 2 Select Bluetooth as an input source.
 - On the main unit, press **INPUT SELECT** repeatedly until the Bluetooth LED blinks blue.
 - On the remote control, press . The Bluetooth LED blinks blue.

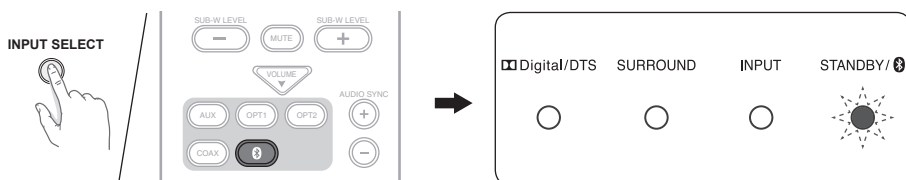

- 3 Search and pair **Sherwood S5** on the Bluetooth device.

- 4** When the pairing is completed, the Bluetooth LED stops blinking and turns on.

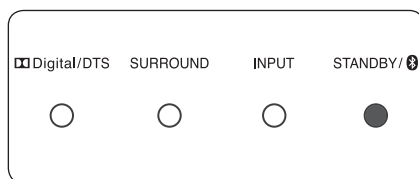
**Note**

- Before you connect a Bluetooth device to the main unit, familiarize yourself with the Bluetooth capabilities of the device.
- Keep the main unit away from other electronic devices that may cause interference.
- If the pairing is not completed, the Bluetooth LED keeps blinking. Then, try pairing again by repeating the step 1 to 4.

Settings

Setting the Surround Mode



Setting the surround mode that utilizes Inkel's Spectrum 3D Sound technology generates spatial sound, without having to use walls to reflect the sound. This creates the illusion of three-dimensional acoustics and enables you to experience the film soundtrack and music with a power and intensity not previously achieved. However, the options available will depend on the type of source you're listening to. The following modes provide basic surround sound for stereo and multichannel sources.

3D Movie

This mode corrects theatrical soundtracks for playback in a home theater environment and enhance talk sound clarity to reproduce high fidelity sound for movie playback. It also reproduces monaural video sources, such as classic movies in an atmosphere of a good movie theater. It creates a pleasant space with depth by adding breadth and the appropriate reverberation to the original audio.

3D Music

You can enjoy a virtual surround sound. **This mode reproduces high fidelity sound through the sound loss compensation.** This works by controlling how sounds reach the listener's ears, so the spatially extended sound gives the sound its three-dimensional aspect.

Natural

This mode reproduces high fidelity sound through the sound loss compensation and supplies the optimized sound with various volume levels of sound sources for the users.

Stereo

This mode reproduces realistic sound through the speaker. Dolby Digital and DTS(S5 only) multichannel sources are downmixed to stereo with the aid of digital sound processing.

- 1** Press **SURROUND** repeatedly to set the surround mode.
Each time the button is pressed, the SURROUND LED changes as the table below.

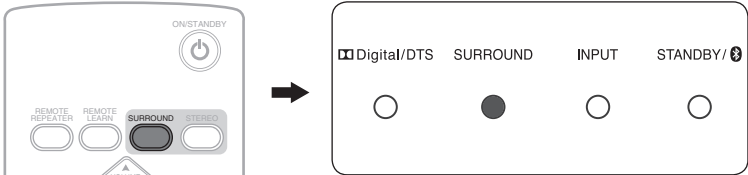

Or press **STEREO** to set the surround mode.

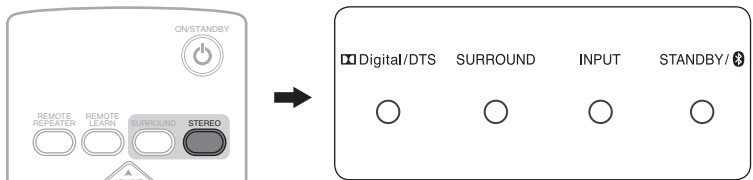

LED	Display	Description
SURROUND	Red	3D Movie mode is selected.
	Green	3D Virtual mode is selected.
	Yellow	Natural mode is selected.
	OFF	Stereo mode is selected.

Audio Detecting

If the source is Dolby Digital, DTS, PCM, or Dolby Surround encoded, the proper decoding format will automatically be selected and the Dolby Digital/DTS LED indicates as follows.

LED	Display	Description
Digital/DTS (DTS is available only in S5)	Red	Dolby Digital is selected.
	Green	PCM is selected.
	Yellow	DTS Digital is selected. (Only in S5)

Dolby Digital

Dolby Digital is the multi-channel digital signal format developed by Dolby Laboratories. Discs bearing the Dolby Digital logo include the recording of up to 5.1 channels of digital signals. This will put you right in the middle of the action, just like being in a movie theater or concert hall.

PCM

PCM is a signal format under which an analog audio signal is digitized, recorded and transmitted without using any compression. This is used as a method of recording CDs and DVD audio. The PCM system uses a technique for sampling the size of the analog signal per very small unit of time. Standing for “pulse code modulation”, the analog signal is encoded as pulses and then modulated for recording.

DTS Digital Surround (Only in S5)

DTS Digital Surround (also called simply DTS) supports up to 5.1 discrete channels and uses less compression for high fidelity reproduction. Use it with DVDs and CDs bearing the DTS logo.

Resetting the Main Unit

When the main unit does not work properly or is in faulty status for any reason, you can reset the main unit.

- 1 Turn on the main unit to standby mode by pressing **ON/STANDBY**.
The **STANDBY** LED turns red.

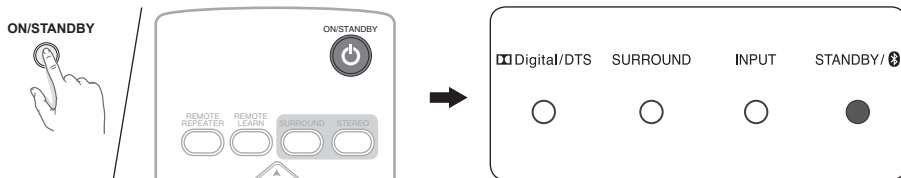

- 2 Press and hold **ON/STANDBY** and **INPUT SELECT** simultaneously for 5 seconds.
Then all of the LEDs blink red.

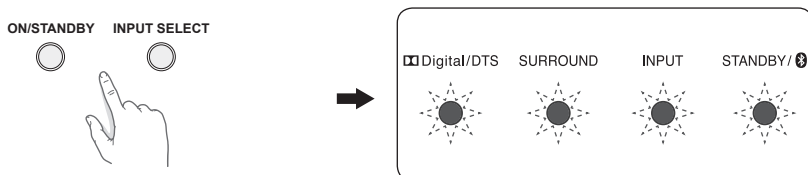

- 3 After the reset is completed, the main unit returns to standby mode.

Adjusting the Subwoofer Volume

- Press **SUB-W LEVEL -** or **SUB-W LEVEL +** to adjust the subwoofer volume level in 1 dB steps (21 steps in total). As the subwoofer volume level increases, the LEDs turn on as follows.

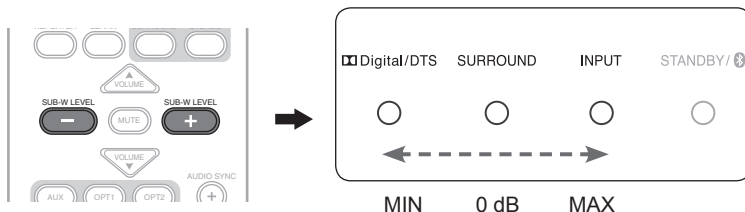

Adjusting the Delay Time (Audio Sync)

You can synchronize the sound to the video when the video image is slower than the sound. The delay can be adjusted within a range of 0 ms to 150 ms.

- Press **AUDIO SYNC +/-** to adjust delay times. The delay can be adjusted within the range of 0 ms - 150 ms and is displayed as the LED indicators. Each time the button is pressed, the INPUT LED indicator changes as follows.

LED	Display	Description
Digital/DTS	Green	lights up from 0 ms. 0 ms is default value.
SURROUND	Yellow	lights up from 75 ms.
INPUT	Red	lights up from 150 ms.

Setting Auto Power Control

You can set the time for the main unit to be automatically turned off when any other operation is not inputted. The setting time is 6 hours.

- 1 Press and hold **ON/STANDBY** on the main unit until the STANDBY/Bluetooth LED blinks red twice to turn on the auto power control function.

ON/STANDBY

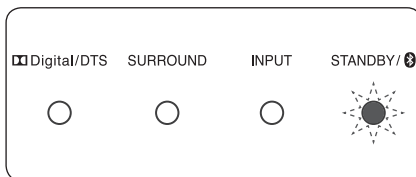

- 2 Press and hold **ON/STANDBY** on the main unit until the STANDBY/Bluetooth LED blinks red three times to turn off the auto power control function.

ON/STANDBY

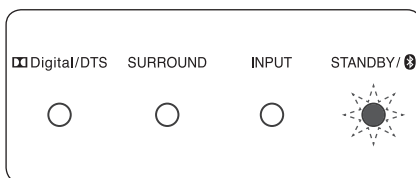

Troubleshooting

If you experience any of the following difficulties while using the system, use this troubleshooting guide to help remedy the problem before requesting servicing. Should any problem persists, consult your nearest authorized dealer or authorized independent company.

If the unit does not operate normally due to external influence such as static electricity, disconnect the power plug from the outlet and insert again to return to normal operating conditions.

GENERAL

Problem	Remedy
The power does not turn on.	<ul style="list-style-type: none"> • Disconnect the power plug from the outlet, and connect again.
The system suddenly turns off.	<ul style="list-style-type: none"> • After about a minute (you won't be able to turn the unit on during this time), turn the system back on. If this message appears, call an authorized independent service company.
No sound is heard after a function is selected.	<ul style="list-style-type: none"> • Make sure the component is connected correctly. (See "Connections" on page 12.) • Press MUTE to restore the sound. • Adjust the volume level.
Can't operate the remote control.	<ul style="list-style-type: none"> • Replace the batteries. (See page 11.) • Operate within 7 m, 30° of the remote sensor. • Remove any obstacles, or operate from another position. • Avoid exposing the remote sensor on the front panel to direct light.

SOUND

Problem	Remedy
There is no sound from the selected component.	<ul style="list-style-type: none"> • Check that the component is connected correctly to the audio input jacks of components. • Check that the cords are fully inserted into jacks on both the component and the main unit. • Ensure that the component is selected correctly.
Sound is interrupted or there is noise.	<ul style="list-style-type: none"> • Check the output audio formats support system.
No sound is heard or there is noise when a audio source with DTS is played back.	<ul style="list-style-type: none"> • Set the digital volume level of the system to the maximum, or to the neutral position. • Ensure the player's settings are correct and/or the DTS signal out is on. Refer to the instruction manual supplied with the DVD player.

REMOTE REPEATER/LEARNING

Problem	Remedy
The volume of the main unit and TV increases simultaneously.	<ul style="list-style-type: none"> Your TV received the signal from TV remote control, having learned the operation of the main unit. Adjust the volume by using the remote control of the main unit.
The main unit does not learn the operation of TV remote control.	<ul style="list-style-type: none"> Reposition the main unit. Disconnect the power cable and perform the remote control learning operation again. Use the remote control of the main unit. Operate the remote learning process again. (Refer to page 19.)
The TV remote control is not working even if you use TV remote control signal transmission function.	<ul style="list-style-type: none"> Try to use the TV remote control signal transmission function again after repositioning the IR repeater of the main unit and the remote control sensor of your TV. Remove the obstruction between the main unit and your TV. Restart the main unit and check the indicator status.

Specifications

Amplifier	
Rated Power Output	
Front	30 W + 30 W (6 Ω, 1 KHz, THD 10 %)
Subwoofer	30 W + 30 W (6 Ω, 100 Hz, THD 10 %)
Input	
Audio input	AUX (Analog), Optical x2, Coaxial x1 (Digital)
Speaker	
Front	
Type	Full range 2.5" Cone Type
Impedance	6 Ω
Subwoofer	
Type	3" Cone Type
Impedance	6 Ω
Bluetooth	
Model name	MD-5XR
Bluetooth system	v3.0 + EDR
Bluetooth Power Class	Class 2
Out power	-6 ~ 4 dBm
Frequency range	2402 ~ 2480 MHz
General	
Power Requirements	AC 120 V, 60 Hz
Power Consumption	30 W
In Standby	0.5 W
Dimensions	1000 mm (W) x 105 mm (H) x 110 mm (D)
Weight (without package)	4.5 kg

Trademarks and Licenses

This system incorporates a sophisticated Digital Signal Processor that allows you to create optimum sound quality and sound atmosphere in your personal home theater.

DTS Digital Surround



For DTS patents, see <http://patents.dts.com>. Manufactured under license from DTS Licensing Limited. DTS, the Symbol, & DTS and the Symbol together are registered trademarks, and DTS Digital Surround is a trademark of DTS, Inc. © DTS, Inc. All Rights Reserved.

Bluetooth



The Bluetooth® word mark and logos are registered trademarks owned by Bluetooth SIG, Inc. and any use of such marks by Inkel Corporation is under license. Other trademarks and trade names are those of their respective owners.

Dolby Digital



Dolby Digital is the multi-channel digital signal format developed by Dolby Laboratories. Discs bearing the Dolby Digital logo include the recording of up to 5.1 channels of digital signals. This will put you right in the middle of the action, just like being in a movie theater or concert hall.

Dolby and the double-D symbol are trademarks of Dolby Laboratories.

Spectrum 3D Sound



The Spectrum 3D Sound word mark and logos are registered trademarks owned by Inkel corporation.







S5/S3

SOUND PANORAMA