



# WD-1

---

NETWORK AV ADAPTER  
ADAPTATEUR AV RÉSEAU  
ADAPTADOR AV CON CONEXIÓN DE RED

OPERATING INSTRUCTIONS  
GUIDE D'UTILISATION  
INSTRUCCIONES DE FUNCIONAMIENTO

# Safety Information

## READ THIS BEFORE OPERATING YOUR UNIT



**CAUTION**  
RISK OF ELECTRIC SHOCK  
DO NOT OPEN



CE R&TTE Directive 1999/5/EC

**CAUTION**  
TO REDUCE THE RISK OF ELECTRIC SHOCK,  
DO NOT REMOVE FRONT OR BACK COVER.  
NO USER-SERVICEABLE PARTS INSIDE.  
REFER SERVICING TO QUALIFIED SERVICE  
PERSONNEL.



This symbol indicates the presence of uninsulated "dangerous voltage" within the product's enclosure that may be of sufficient magnitude to constitute a risk of electric shock.



This symbol indicates important operating and maintenance (servicing) instructions in the literature accompanying the appliance.

**WARNING:** TO REDUCE THE RISK OF FIRE OR ELECTRIC SHOCK, DO NOT EXPOSE THIS APPLIANCE TO RAIN OR MOISTURE.

### CAUTION

- Leave space around the unit for sufficient ventilation.
- Avoid installation in extremely hot or cold locations, or in an area that is exposed to direct sunlight or heating equipment.
- Keep the unit free from moisture, water, and dust.
- Do not let foreign objects in the unit.
- Keep the ventilation openings clear of items, such as newspapers, linens, or curtains.
- Keep open flame from candles or other sources away from the unit.
- Observe the local regulations regarding disposal of packaging materials, exhausted batteries and old equipment.
- Do not expose the unit to dripping or splashing, or place objects filled with liquids such as vases.
- Do not let insecticides, benzene, or thinner come in contact with the unit.
- Never disassemble or modify the unit in any way.

#### Notes on the AC power cord and the wall outlet

- The unit remains connected to AC power as long as it is plugged into the wall outlet, even if the unit has been turned off.

- To completely disconnect this product from AC power, disconnect the plug from the wall socket outlet.
- When setting up this product, make sure that the AC outlet you are using is easily accessible.
- Disconnect the plug from the wall outlet when not using the unit for long periods of time.

### FCC Notice

This equipment has been tested and found to comply with the limits for a Class B digital device, pursuant to Part 15 of the FCC Rules. These limits are designed to provide reasonable protection against harmful interference in a residential installation. This equipment generates, uses and can radiate radio frequency energy and, if not installed and used in accordance with the instructions, may cause harmful interference to radio communications. However, there is no guarantee that interference will not occur in a particular installation. If this equipment does cause harmful interference to radio or television reception, which can be determined by turning the equipment off and on, the user is encouraged to try to correct the interference by one or more of the following measures:

Reorient or relocate the receiving antenna.  
 Increase the separation between the equipment and the receiver.  
 Connect the equipment to an outlet on a circuit different from that to which the receiver is connected.  
 Consult the dealer or an experienced radio/TV technician for help.

This device complies with part 15 of the FCC Rules. Operation is subject to the following two conditions:  
 (a) This device may not cause harmful interference, and  
 (b) This device must accept any interference received, including interference that may cause undesired operation.

(FCC Part 15.21) Caution: changes or modifications not expressly approved by the party responsible for compliance could void the user's authority to operate the equipment.

**For Canadian customers:**

This Class B digital apparatus complies with Canadian ICES-003.

**FCC Radiation Exposure Statement:**

This equipment complies with FCC radiation exposure limits set forth for an uncontrolled environment. This equipment should be installed and operated with a minimum distance of 20 cm between the radiator and your body.

This transmitter must not be co-located or operated in conjunction with any other antenna or transmitter.

**Important Safety Instructions**

- 1 Read these instructions.
- 2 Keep these instructions.
- 3 Heed all warnings.
- 4 Follow all instructions.
- 5 Do not use this apparatus near water.
- 6 Clean only with dry cloth.

- 7 Do not block any ventilation openings. Install in accordance with the manufacturer's instructions.
- 8 Do not install near any heat sources such as radiators, heat registers, stoves, or other apparatus (including amplifiers) that produce heat.
- 9 Do not defeat the safety purpose of the polarized or grounding-type plug. A polarized plug has two blades with one wider than the other. A grounding type plug has two blades and a third grounding prong. The wide blade or the third prong is provided for your safety. If the provided plug does not fit into your outlet, consult an electrician for replacement of the obsolete outlet.
- 10 Protect the power cord from being walked on or pinched particularly at plugs, convenience receptacles, and the point where they exit from the apparatus.
- 11 Only use attachments/accessories specified by the manufacturer.
- 12 Use only with the cart, stand, tripod, bracket, or table specified by the manufacturer, or sold with the apparatus.  When a cart is used, use caution when moving the cart/apparatus combination to avoid injury from tip-over.
- 13 Unplug this apparatus during lightning storms or when unused for long periods of time.
- 14 Refer all servicing to qualified service personnel. Servicing is required when the apparatus has been damaged in any way, such as power-supply cord or plug is damaged, liquid has been spilled or objects have fallen into the apparatus, the apparatus has been exposed to rain or moisture, does not operate normally, or has been dropped.

**Product Name:** Network AV ADAPTER  
**Model Number:** WD-1  
**Responsible Party Name:**  
 ETRON CORPORATION  
**Address:**  
 6120 Valley View Buena Park, Ca. 90620  
**Phone:** 1-714-739-2000  
**URL:** <http://www.sherwoodamerica.com>

# Table of Contents

## **2 SAFETY INFORMATION**

---

## **5 GETTING STARTED**

---

- 5 What's Included
- 6 Installing the Remote Control Battery
- 6 Operating the range of the Remote Control
- 7 Parts Description

## **9 MAKING CONNECTIONS**

---

- 9 Connecting HDMI Components
- 10 Connecting Digital Audio Components
- 10 Connecting to a Network
- 11 Connecting Power

## **12 OPERATING YOUR DEVICE**

---

- 12 Turning on Your Unit
- 12 Setting the Network Standby Control
- 12 Setting the Network Setup
- 14 Listening to Internet Radio
- 15 Listening to Music from the Media Server
- 16 Using the Sherwood Remote Application
- 21 Updating the Firmware

## **23 TROUBLESHOOTING**

---

## **24 ADDITIONAL INFORMATION**

---

- 24 Specifications

## **25 TRADEMARKS AND LICENSES**

---

# Getting Started

## What's Included

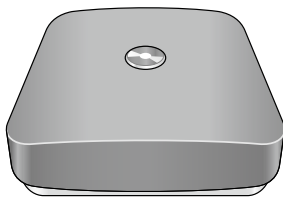

**Main unit**



**Remote control (1 ea)**



**Battery "AAA" size, 1.5V (2 ea)**

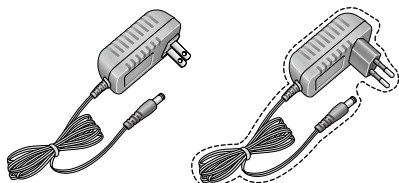

**Power adapter (1 ea)**



**User manual (1 ea)**



**Note**

- The items supplied with your unit are subject to change without prior notice.

## Installing the Remote Control Battery

- 1 Remove the battery cover.

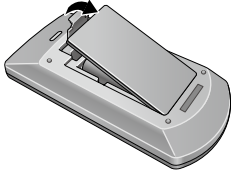

- 2 Insert two AAA size batteries with the polarity matched properly.

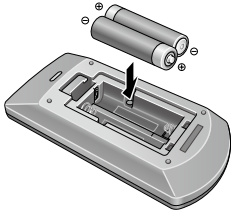

## Operating the range of the Remote Control

Use the remote control within a range of about 7 meters (23 feet) and angles of up to 30 degrees aiming at the remote control sensor.

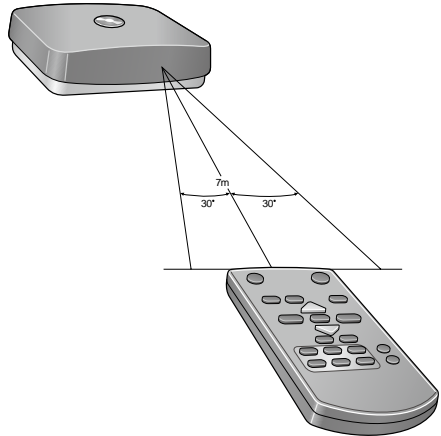

### Caution

- Always use alkaline batteries, and do not use the rechargeable batteries (Ni-Cd type).
- If the batteries run out, remove the old batteries and replace them with new ones within several minutes.
- If the batteries are removed or have been exhausted for a longer period of time, memorized contents will be cleared. In this case, you should memorize them again.
- If the battery is placed incorrectly, it can cause explosion.
- Remove the battery if the remote control is not used for a long period of time.
- Do not leave the product in a hot or humid place.
- Do not handle and store the battery with metallic tools.

# Parts Description

## Front and Rear Panel

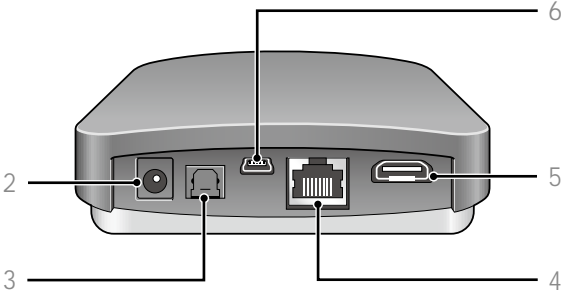

- 1 **Status LED**
- 2 **Power Connector**
- 3 **OPTICAL OUT Connector**
- 4 **LAN/ETHERNET Connector**
- 5 **HDMI Connector**
- 6 **USB Connector (For Upgrade only)**
- 7 **IR Sensor**

## Remote Control

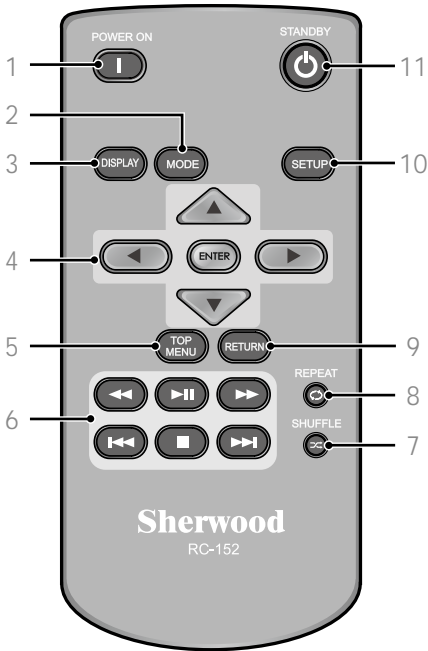

- 1 **POWER ON**  
Turn on the main unit.
- 2 **MODE**  
Adjust the screen resolution. (Original/Full)
- 3 **DISPLAY**
  - When playing audio or video files, turns on or off the progress bar.
  - When viewing photos, turns on or off the slideshow transition time display.
- 4 **▲ / ▼ / ◀ / ▶ / ENTER**
  - Navigate through the menus.
  - Confirm a setting option or menu.
- 5 **TOP MENU**  
Move to the top menu for each media or service.
- 6 **◀◀**  
Fast-reverse the current file.  
**▶▶**  
Fast-forward the current file.  
**⏮**  
Play or pause playback.  
**⏪**  
Select the previous file.  
**⏩**  
Select the next file.  
**■**  
Stop playback.
- 7 **SHUFFLE**  
Activate the random playback.
- 8 **REPEAT**  
Activate the repeat function.
- 9 **RETURN**  
Return to the previous menu.
- 10 **SETUP**  
Enter or exit the system setup menu.
- 11 **STANDBY**  
Turn off the main unit to the normal standby mode.



# Making Connections

## Connecting HDMI Components

With HDMI, you can easily enjoy high quality sounds and images. The main unit plays audio from HDMI compatible products while also passing on the video signal to a HDMI-connected TV.

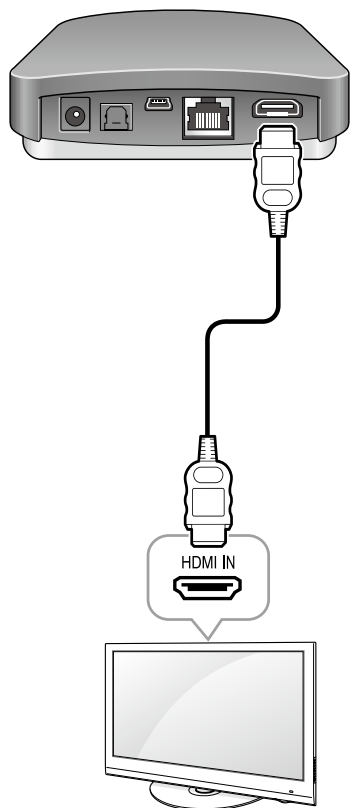

### About HDMI

HDMI (High Definition Multimedia Interface) supports both audio and video on a single digital connection for use with DVD players, DTV, set-top boxes, and other AV devices. HDMI was developed to provide the technologies of High Bandwidth Digital Content Protection (HDCP) as well as Digital Visual Interface (DVI) in one specification. HDCP is used to protect the digital content transmitted and received by DVI-compliant displays.

HDMI has the capability to support standard, enhanced, or high-definition video plus standard to multi-channel surround-sound audio. HDMI features include uncompressed digital video, a bandwidth of up to 2.2 gigabytes per second (with HDTV signals), one connector (instead of several cables and connectors), and communication between the AV source and AV devices such as DTVs.

This main unit is also compatible with the DeepColor and x.v.Color feature (x.v.Color is trademarks of Sony Corporation.).



#### Note

- Check the setup of the connected component if an image is poor or there is no sound from a component connected via the HDMI cable.
- Audio signals (sampling frequency, bit length, etc.) transmitted from an HDMI jack may be suppressed by the connected component.
- When the connected component is not compatible with copyright protection technology (HDCP), the image and the sound from the HDMI TV OUT jack may be distorted or may be not output. In this case, check the specification of the connected component.

## Connecting Digital Audio Components

You can connect components equipped with an optical input jack. Then, the main unit transmits the digital audio signal to the connected external device.

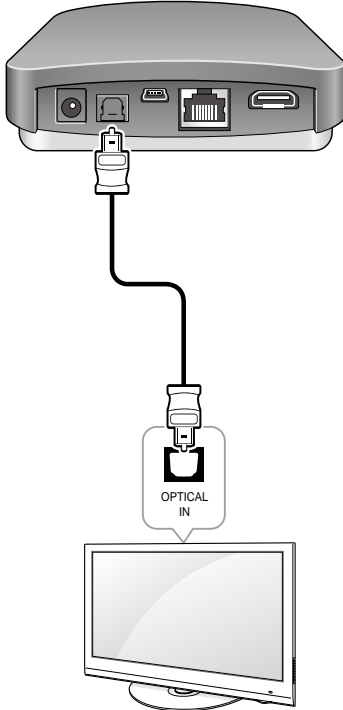

## Connecting to a Network

If you have an internet connection, you can connect the main unit to the internet as well as using a wireless or a wired LAN connection.

The following illustration is a configuration example of a home network with the main unit and a server. It is recommended to connect the server to the router with a wired connection.

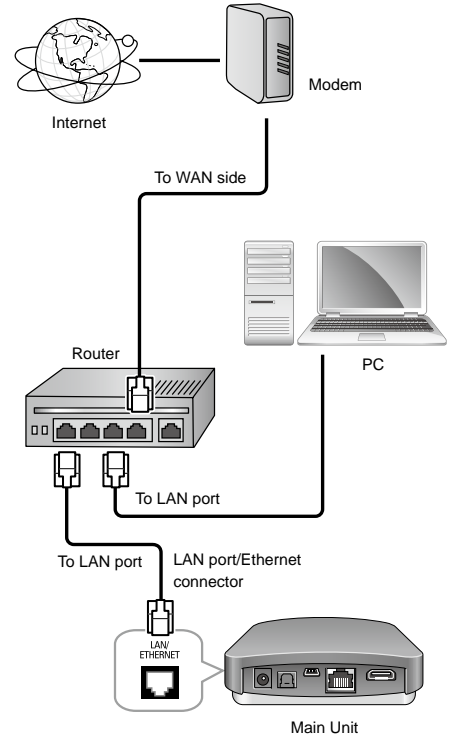

**Note**

- After making a broadband internet connection, you should set the communication settings. For details, see “**Setting the Network Setup**” on page 12.
- When using a broadband internet connection, a contract with an internet service provider is required. For more information, contact local internet service provider.
- Since the connected equipment and connection method may differ depending on your internet environment, refer to the operating instructions of the equipment.

**Connecting Power**

Make sure to plug in after you have connected all your components to the main unit. Plug the supplied AC input cord into the AC inlet and then into the wall AC outlet.

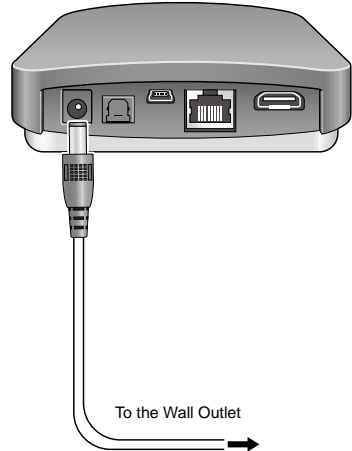
**Caution**

- The supplied AC adapter is designed exclusively for use with this unit. Do not attempt to use it with any device for which was not expressly designed, since fires or shocks may occur.
- Handle the power cord by the plug part. Do not pull out the plug by tugging the cord, and never touch the power cord when your hands are wet, as this could cause a short circuit or electric shock.
- The main unit should be disconnected by removing the main plug from the wall outlet when not in regular use for a long period of time.

# Operating Your Device

## Turning on Your Unit

- 1 Turn on the main unit by pressing **POWER ON**.
- 2 Turn off the standby mode by pressing **STANDBY**.

## Setting the Network Standby Control

- 1 Press and hold **SETUP** for more than 3 seconds.  
When the Network Standby Control is turned on, the status LED on the front panel flashes two times.
- 2 To turn off the Network Standby Control, press and hold **SETUP** for more than 3 seconds again.  
When the Network Standby Control is turned off, the status LED on the front panel flashes three times.



### Note

- When the Network Standby Control is turned on, the power consumption may increase.

## Setting the Network Setup

To listen to Internet radio stations or music files stored on your computer via a wired or wireless network, you should configure network settings first.

- 1 Press **SETUP**.
- 2 Press **▲** or **▼** to navigate up or down the menu.

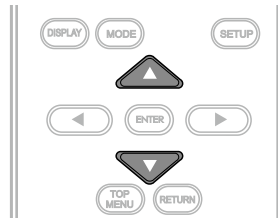

- 3 Press **ENTER** to confirm the desired menu. Press **RETURN** to move to the previous menu.

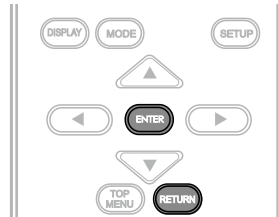

## Network Settings Overview

Main Menu	Sub Menu	Go to Page	
NETWORK CONNECT	Direct AV Set	Soft AP hotspot	13
		Wi-Fi direct	13
	Wired	Ethernet	13
		Ethernet Configuration	13
OTHER	AP Name	14	
	Resolution	14	
	Display size	14	
	Factory Setting	14	
INFORMATION	Network Information	14	
	Passcode Information	14	

## Setting the Direct Wireless Network Connection

You can connect the main unit with a mobile device wirelessly through Soft AP hotspot or Wi-Fi direct.

### Soft AP hotspot

When you enable Soft AP hotspot, you can use the main unit as a wireless access point. It provides internet access to network devices.

### Wi-Fi direct

Wi-Fi Direct is a standard that allows Wi-Fi devices to connect to the main unit without the need for a wireless access point. When you enable Wi-Fi Direct, you can directly transfer data between Wi-Fi direct devices and the main unit without the need for full setup.

## Setting the Wired Network Connection

Before you setup the connection, check that the LAN cable is connected to the LAN/ETHERNET connector properly and securely. For details, see “**Connecting to a Network**” on page 10.

### Ethernet

You can enable and set the Ethernet connection automatically on the main unit.

### Ethernet Configuration

You can set the Ethernet connection settings manually.

Menu item	Description
<b>Ethernet Device</b>	Inputs an Ethernet device name.
<b>Connection Type</b>	Sets the connection type as DHCP or Static IP.
<b>IP Address</b>	Inputs IP Address.
<b>Netmask</b>	Inputs subnet mask when the DHCP function is disabled.
<b>DNS address</b>	Inputs DNS address when the DHCP function is disabled.
<b>Default Router</b>	Inputs Default Router when the DHCP function is disabled.



### Note

- When you set DHCP as a connection type, you do not need to set the IP Address, Netmask, or DNS address etc.
- When you set Static IP as a connection type, you should set the network connection manually by entering the IP Address, etc. In this case, some knowledge of networks is required. If you do not understand internet connections, contact your internet service provider.

## Setting Other Network Options

Menu item	Description
<b>AP Name</b>	Views and changes the name of the unit displayed on the network.
<b>Resolution</b>	Sets the resolution of the video output.
<b>Display size</b>	Adjusts the screen display size manually.
<b>Factory Setting</b>	Resets all the settings to the factory default.

## Viewing the Network Information

### Network Information

You can view the detailed information of a connected network.

### Passcode Information

You can view and change the passcode of the main unit. When you use the main unit for the first time, you should input this passcode when you enable Soft AP hotspot and try to connect the mobile device to the main unit.

## Listening to Internet Radio

You can listen to Internet radio broadcasts provided by vTuner. You can control the internet radio with the menu displayed on the TV screen.



- 1 When the image is displayed as below, select **Internet Radio** on the screen, and then press **ENTER** on the remote control.



- 2 Select the desired category by pressing ▲ or ▼, and then press **ENTER** on the remote control.

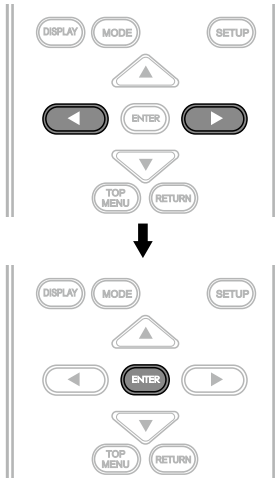

**Note**

- To use this function, the unit should be connected to the internet. Refer to **“Setting the Network Setup”** on page 12 for details.
- The service may be discontinued without notice.
- You may not be able to receive some internet radio stations.

## Listening to Music from the Media Server

You can play music files stored on a computer (media server) connected to this unit via a wired or wireless network. You can share the music files easily by using Windows Media Player 11 or later versions.

### Configuring the Windows Media Player

#### On Windows Media Player 11 version

- 1 Run the Windows Media Player 11 version on your computer.
- 2 Click the “Library” tab in the menu bar, and then select “Media Sharing”.
- 3 In the “Media Sharing” dialog box, select the “Share my media” check box, and then click “OK”.
- 4 Select this unit in the list of devices, and then click “Allow”.
- 5 Click “OK” to close the dialog box.

#### On Windows Media Player 12 version

- 1 Run the Windows Media Player 12 version on your computer.
- 2 Click “Stream” at the top of the player.
- 3 Click “Turn on media streaming” when it appears in the next window.
- 4 Select “Local Network” next to Show devices on if it is not already selected.
- 5 Click “OK” to close the dialog box.



**Note**

- Windows Media Player 11 and 12 versions can be downloaded for free from the Microsoft web site.
- If the firewall restricts access, Windows Media Player 11 and 12 cannot be configured.

## Listening to Music from the Media Server

- 1 Start your computer.
- 2 Select **Media Server** on the screen, and then press **ENTER** on the remote control.



- 3 Select the desired category by pressing **◀**, **▶**, and then press **ENTER** on the remote control.

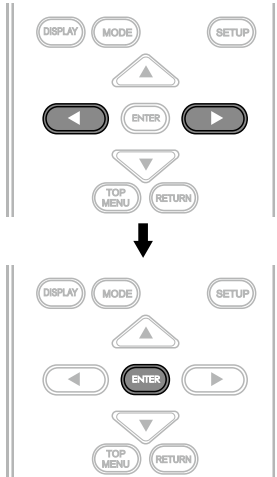

- 4 Repeat step 3 above until the desired music file is selected.

## Using the Sherwood Remote Application

### Preparing for the Application

#### Setting the Network on the Main Unit

- 1 Press **SETUP** on the remote control.

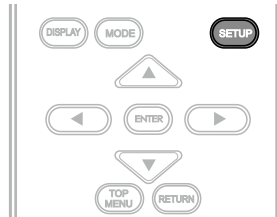

- 2 Tap **Hotspot & Wi-Fi Direct > Soft Wi-Fi hotspot** or **Wi-Fi direct**.

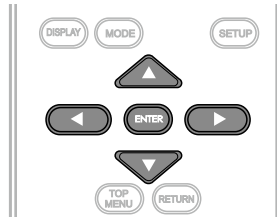

#### Note

- Wi-Fi hotspot is enabled as a default connection setting.



## Installing the Application on Your Phone

- 1 Visit **Play Store** on your Android Smartphone.  
Or visit **App Store** on your iPhone.
- 2 Search for **Sherwood Remote**.
- 3 Download and install the application on your phone.
- 4 Open the application.
- 5 Tap **Select Product** and **WD-1**.

## Connecting Your Phone with the Main Unit

### • On an Android phone

- 1 Go to Wireless & networks settings in your Android smartphone.
- 2 Enable Wi-Fi direct or Portable Wi-Fi hotspot.
  - When you connect your phone with the main unit using a Wi-Fi hotspot, you should enter the password (1234567890) for the main unit connection.
- 3 Go to Wi-Fi settings to select and tap **WD-1** and **Connect**.



### Note

- When Ethernet is not connected to the main unit, you cannot use Wi-Fi connection even though Wi-Fi hotspot is enabled on your phone.

### • On an iPhone

- 1 Go to Wi-Fi hotspot settings to select and tap **WD-1**.

## Using the Application

The Sherwood Remote application helps you to control the main unit remotely by allowing you to use Wiink.

- 1 Open the Sherwood Remote application.
- 2 When the product search window is activated, select and tap **WD-1**. Then, you can use your smartphone as a remote control for the main unit.



### Note

- When a network error occurs, the following screen will pop up.





- **Select Product:** Check your smartphone network connection, and select the main unit again.
- **Demo Mode:** Use the application in Demo Mode.
- **Retry:** Try to open the application again.

### Using Direct AV

On Direct AV, you can listen to songs, watch videos, and view photos stored on your Android phone or iPhone.

1 Tap **Direct AV**.



- : Adjust the settings.
- : Turn on or off the main unit. (To activate the function, you should turn on the Network Standby Control. Then, the power consumption may increase. Refer to “**Setting the Network Standby Control**” on page 12 for details.)

2 Tap **Audio** to listen to the songs stored on your phone.

Tap **Video** to watch video stored on your phone.

Tap **Photo** to view photos stored on your phone.

• iOS



• Android



### Listening to Songs on Your Smartphone

You can select a song on the song list and play it over the main unit.



### Watching Videos on Your Smartphone

You can select a video on the video file list and enjoy it on the main unit.



No.	Description
1	Move to the previous menu • This menu is not displayed on Android smartphone.
2	Play or pause a song
3	Play a previous song
4	Set shuffle function
5	Volume control bar
6	Set the repeat function (Repeat for all song or one song.)
7	Play the next song
8	Progress bar

No.	Description
1	Move to the previous menu • This menu is not displayed on the Android smartphone.
2	Play or pause a video
3	Move to a previous video
4	Volume control bar
5	Move to the next video
6	Control display size
7	Progress bar

### Viewing Photos on Your Smartphone

You can view photos as a slideshow and set the slideshow transition time at Off, 5s, 10s, 20s, 30s.



No.	Description
1	Move to the previous menu <ul style="list-style-type: none"><li>This menu is not displayed on the Android smartphone.</li></ul>
2	Start the photo slideshow
3	Set the slideshow transition time

### Using Internet Radio and Media Server

You can use your smartphone as a remote controller for Internet Radio and Media Server.

- 1 Tap **Internet Radio** or **Media Server**.



#### Note

- This function may not be available depending on types or functions of a smartphone or network connection.

### Overview of the Main Screen

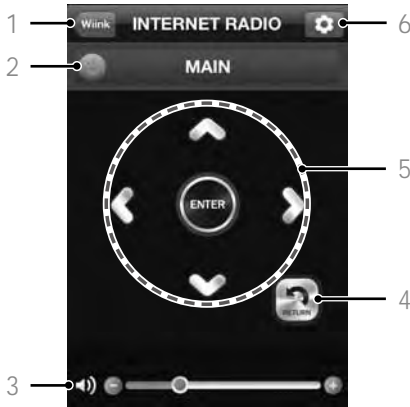

No.	Description
1	Move to the Wink main menu <ul style="list-style-type: none"> <li>This menu is not displayed on the Android smartphone.</li> </ul>
2	Turn off the main unit. (To activate the function, you should turn on the Network Standby Control. Then, the power consumption may increase. Refer to <b>"Setting the Network Standby Control"</b> on page 12 for details.)
3	Volume control bar
4	Return to the previous menu
5	Select or confirms a broadcast in Internet Radio and Media server
6	Move to the settings menu

### Updating the Firmware

New firmware that provides additional features or product improvements will be released as needed. Updates can be downloaded from our website: [www.sherwoodamerica.com](http://www.sherwoodamerica.com).

After downloading the firmware to a USB device, you can update the main unit by connecting the USB device with a USB OTG cable(faster than USB 2.0) and doing the following procedures.

For details, refer to the information supplied with updates. Do not perform this procedure unless firmware update is necessary. Also, make sure you read the information supplied with updates before updating the firmware.

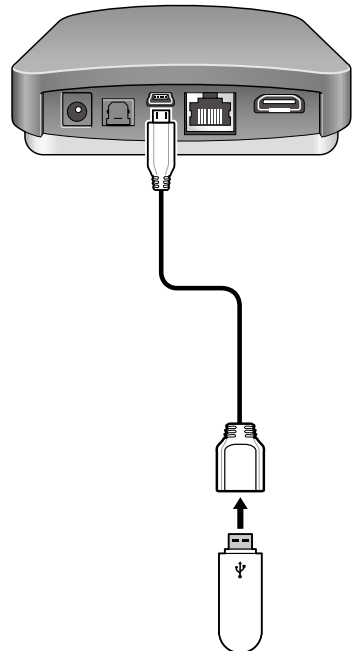

## WD-1 NETWORK AV ADAPTER

- 1 Connect the USB connector of the main unit to the device which stores the firmware.
- 2 Press the buttons in the following order.

MODE → ◀◀ → ▶▶ → ENTER

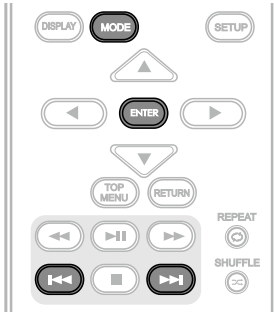

### Note

- When the main unit does not turn on automatically after updating, you should turn on the unit manually.
- Make sure not to turn off the main unit, disconnect the USB cable or perform any operation on the main unit while the updating operation is in progress.

# Troubleshooting

If you experience any of the following difficulties while using the main unit, use this troubleshooting guide to help remedy the problem before requesting servicing. Should any problem persist, consult your nearest authorized dealer or authorized independent company.

If the unit does not operate normally due to external influence such as static electricity, disconnect the power plug from the outlet and insert again to return to normal operating conditions.

## GENERAL

Problem	Remedy
The power does not turn on.	<ul style="list-style-type: none"> <li>• Disconnect the power plug from the outlet, and connect again.</li> </ul>
The main unit suddenly turns off.	<ul style="list-style-type: none"> <li>• After about a minute (you won't be able to turn the main unit on during this time), turn the main unit back on. If the message persists, call an authorized independent service company.</li> </ul>
No sound is heard after a function is selected.	<ul style="list-style-type: none"> <li>• Make sure the component is connected correctly. (See "<b>Making Connections</b>" on page 9.)</li> </ul>
Can't operate the remote control.	<ul style="list-style-type: none"> <li>• Replace the batteries. (See page 6.)</li> <li>• Operate within 7 m, and 30° of the remote sensor.</li> <li>• Remove any obstacles, or operate from another position.</li> <li>• Avoid exposing the remote sensor on the front panel to direct light.</li> </ul>

## NETWORK CONNECTION

Symptom	Remedy
The main unit cannot connect to the WPS via a wireless LAN connection.	<ul style="list-style-type: none"> <li>• You cannot connect to a network using WPS when your access point is set to WEP. Set up your network after searching the access point using the access point scan.</li> </ul>
The main unit cannot connect to the network.	<ul style="list-style-type: none"> <li>• Check the network status.</li> <li>• When the main unit is connected through a wireless network, move the main unit and the wireless LAN router/access point closer to each other and do the setup again.</li> <li>• Check the settings of the wireless LAN router/access point and do the setup again. For details on the settings of the devices, refer to the operating instructions of the devices.</li> <li>• Make sure that you use a wireless LAN router/access point.</li> <li>• Wireless networks are influenced by electromagnetic radiation emitted by microwave ovens and other devices. Move the main unit away from these devices.</li> </ul>
Cannot select the Network Settings menu.	<ul style="list-style-type: none"> <li>• Wait for a few moments after you have turned on the main unit, and then select the Network Settings menu again.</li> </ul>

# Additional Information

## Specifications

Input/Output						
HDMI	Output 1					
Audio Output	Optical x1 (Digital)					
Supported Codecs						
Audio	Codec	Type	Sampling rate (kHz)	Bitrate (max in Kbps)	Channel	Container
	MP3	MP3	up to 48 kHz	CBR/VBR from 8 kbps to 320 kbps	mono, stereo	*.mp3
	WMA	WMA, WMV	up to 48 kHz	up to 192 kbps	mono, stereo	*.wma, *.wmv
	WAVE	LPCM, m-law, a-law	at 8, 16 and 44.1 kHz	-	mono, stereo	*.wav
	AC3	Dolby Digital 5.1ch for video	Up to 48 kHz	32 kbps - 640 kbps	1 - 5.1 ch	-
Video	Codec	Frame rate (max)	Bitrate (max)	Resolution (max)	Container	
	H.264 (MPEG4 AVC)	up to 24 fps - 30 fps	up to 16 Mbps	up to Full-HD (1920 x 1080)	*.avi, *.mp4, *.mkv, *.mov	
Photo	Codec	Resolution (max)			Container	
	JPEG	up to 8192 x 8192			*.jpg, *.jpeg	
	PNG				*.png	
	GIF				*.gif	
	BMP				*.bmp	
General Specifications						
Power supply	AC100-240V, 50/60Hz (DC 5V)					
Power consumption	<0.5 W (standby), AC 5 W (DC 5 W)					
Dimensions (W x H x D)	4.33" X 4.33" X1.26" (110 mm X 110 mm X 32 mm)					
Weight	0.595 lb (270 g)					



### Note

- Design and specifications are subject to change without notice for improvements.
- The specifications for the supported codes are the maximum values and may differ depending on playback status or playback files.



## HDMI



HDMI, the HDMI Logo, and High-Definition Multimedia Interface are trademarks or registered trademarks of HDMI Licensing LLC in the United States and other countries.

## Dolby Digital



Dolby and the double-D symbol are trademarks of Dolby Laboratories.

## Wi-Fi

The Wi-Fi CERTIFIED Logo is a certification mark of the Wi-Fi Alliance.

# Informations de sécurité

## À LIRE AVANT D'UTILISER L'APPAREIL



**ATTENTION**  
RISQUES D'ELECTROCUTION  
NE PAS OUVRIR



CE R&TTE Directive 1999/5/EC



Ce symbole sert à avertir l'utilisateur de la présence dans le boîtier de l'appareil de tensions dangereuses non isolées d'une magnitude pouvant constituer un risque d'électrocution.



Ce symbole indique que la documentation fournie avec l'appareil contient des instructions d'utilisation et d'entretien importantes.

### ATTENTION

AFIN DE REDUIRE LES RISQUES DE CHOC ELECTRIQUE, N'ENLEVEZ PAS LE PANNEAU ARRIERE. AUCUNE PIÈCE À L'INTÉRIEUR NE PEUT ÊTRE RÉPARÉE PAR L'UTILISATEUR. EN CAS DE PROBLÈME, S'ADRESSER À UN PERSONNEL TECHNIQUE QUALIFIÉ.

**AVERTISSEMENT** : POUR REDUIRE TOUT RISQUE D'INCENDIE OU DE CHOC ELECTRIQUE, NE PAS EXPOSER CET APPAREIL A LA PLUIE OU A L'HUMIDITE.

### ATTENTION

- Laissez de l'espace autour de l'appareil pour en assurer une ventilation suffisante.
- Evitez d'installer l'appareil dans des endroits trop chauds ou trop froids ou dans une zone exposée directement au soleil ou à un dispositif de chauffage.
- Protégez l'appareil de l'humidité, de l'eau et de la poussière.
- Ne faites pas tomber de corps étrangers dans l'appareil.
- N'obstruez pas les ouvertures de ventilation par des journaux, rideaux, linge etc.
- Eloignez toute flamme nue, telle que bougie, ou autres sources de chaleur de l'appareil.
- Respectez les réglementations locales concernant la mise au rebut des emballages, piles/batteries usagées et anciens équipements.
- N'exposez pas l'appareil au ruissellement ou à la projection d'eau et évitez de poser dessus des objets remplis de liquides, tels que des vases.
- Ne pas mettre l'appareil en contact avec des insecticides, du benzène ou des diluants.
- Ne démontez pas et ne modifiez pas l'appareil de quelle que manière que ce soit.

### Remarques concernant le câble d'alimentation et la prise murale

- L'appareil reste sous tension tant qu'il est branché à une prise murale, même s'il a été éteint.

- Il faut le débrancher l'appareil de la prise secteur pour le déconnecter complètement du secteur.
- Lors de la mise en place de l'appareil, veillez à ce que la prise secteur soit facilement accessible.
- Débranchez la fiche de la prise murale si vous n'avez pas l'intention d'utiliser l'appareil pendant longtemps.

### Notice de la FCC

Cet équipement a été testé et déclaré conforme avec les limites des appareils numériques de classe B, conformément à la section 15 de la réglementation de la FCC. Ces limites sont définies pour fournir une protection raisonnable contre les interférences nuisibles dans une installation résidentielle. Cet équipement génère, utilise et émet de l'énergie de fréquences radio et peut, en cas d'installation ou d'utilisation non conforme aux instructions, engendrer des interférences nuisibles aux communications radio. Rien ne permet de garantir que ces interférences se produiront à un moment quelconque. Si cet équipement cause des interférences nuisibles à la réception radio ou télévisée, ce qui peut être déterminé en éteignant et rallumant l'équipement, l'utilisateur peut tenter d'éliminer ces interférences au moyen de l'une ou de plusieurs des mesures suivantes :

Réorienter ou déplacer l'antenne de réception.

Augmenter la distance séparant l'équipement et le récepteur.

Brancher l'équipement dans une prise de courant d'un circuit différent de celui sur lequel le récepteur est branché.

Consulter le revendeur ou un technicien radio/télévision qualifié pour toute assistance.

Cet appareil est conforme à la section 15 de la réglementation de la FCC. Le fonctionnement est soumis aux deux conditions suivantes :

- (a) Cet appareil ne doit pas causer des interférences nuisibles, et
- (b) Cet appareil doit accepter toute autre interférence reçue, y compris les interférences susceptibles d'entraîner un fonctionnement indésirable.

(FCC Part 15.21) Attention : Tout changement et toute modification non expressément approuvée par la partie responsable de la conformité pourrait annuler l'autorisation accordée à l'utilisateur d'utiliser cet appareil.

### Pour les clients canadiens :

Cet appareil numérique de classe B est conforme à la norme ICES-003 du Canada.

### Déclaration FCC relative à l'exposition aux radiations :

Cet équipement est conforme avec les limites d'exposition aux radiations prévues par la réglementation FCC pour un environnement non contrôlé. Cet équipement doit être installé et utilisé en respectant une distance minimale de 20 cm entre l'émetteur et votre corps.

Cet émetteur ne doit pas être situé à proximité ou fonctionner avec une autre antenne ou émetteur.

### Mesures de sécurité importantes

- 1 Veuillez lire les présentes instructions avant utilisation.
- 2 Conservez ces instructions.
- 3 Respectez tous les avertissements.
- 4 Suivez toutes les instructions.
- 5 N'utilisez pas cet appareil à proximité de l'eau.
- 6 Nettoyez uniquement avec un chiffon sec.

- 7 Ne bloquez aucune fente d'aération. Installez conformément aux consignes du fabricant.
- 8 Ne pas installer près de sources de chaleur telles que radiateurs, registres de chaleur, cuisinières ou tout autre appareil (y compris des amplificateurs) qui produit de la chaleur.
- 9 N'essayez pas de contourner la sécurité de la prise polarisée ou de terre. Une fiche de courant polarisée comporte deux lames dont l'une est plus large que l'autre. Une fiche de terre comporte deux lames et une troisième broche de mise à la terre. La lame large ou la broche de mise à la terre est prévue pour votre sécurité. Si vous ne parvenez pas à insérer entièrement la prise dans une prise de courant, contactez votre électricien afin qu'il remplace votre prise de courant obsolète.
- 10 Evitez que le cordon soit piétiné ou pincé, surtout au niveau des fiches, prises de courant et au point de sa sortie de l'appareil.
- 11 Utilisez uniquement des pièces/accessoires recommandés par le fabricant.
- 12 Utilisez seulement un chariot, socle, tripode, support ou table recommandé par le fabricant ou vendu avec l'appareil. Lorsque vous utilisez un chariot, soyez prudent lorsque vous déplacez l'ensemble chariot/appareil pour éviter les blessures en cas de chute.
- 13 Débranchez l'appareil durant les orages ou en cas d'inutilisation prolongée.
- 14 Confiez toute réparation à un personnel de réparation qualifié. Une réparation s'impose si l'appareil a subi d'une manière ou d'une autre un dommage tels que cordon ou fiche d'alimentation endommagée, liquide renversé ou objet tombé à l'intérieur de l'appareil, si cet appareil a été exposé à la pluie ou à l'humidité, ne fonctionne pas normalement ou s'il est tombé.



**Nom du produit :** ADAPTATEUR AV réseau

**Numéro de modèle :** WD-1

**Nom de la partie responsable :**

ETRON CORPORATION

**Adresse :**

6120 Valley View Buena Park, Ca. 90620

**Téléphone :** 1-714-739-2000

**URL :** <http://www.sherwoodamerica.com>

# Table des matières

## **26 INFORMATIONS DE SÉCURITÉ**

---

### **29 MISE EN ROUTE**

---

- 29 Contenu de l'emballage
- 30 Installation des piles de la télécommande
- 30 Portée de la télécommande
- 31 Description des composants

### **33 ETABLISSEMENT DES CONNEXIONS**

---

- 33 Connexion de sources HDMI
- 34 Raccordement d'appareils audio numérique
- 34 Connexion au réseau
- 35 Branchement au courant

### **36 UTILISATION DE L'APPAREIL**

---

- 36 Allumer l'appareil
- 36 Réglage de l'état de veille réseau
- 36 Configuration réseau
- 38 Ecouter la radio Internet
- 39 Ecouter de la musique à partir d'un Media Server (serveur multimédia)
- 40 Utilisation de l'application Sherwood Remote
- 45 Mise à jour du micrologiciel

### **47 DÉPANNAGE**

---

### **48 INFORMATIONS SUPPLÉMENTAIRES**

---

- 48 Spécifications
- 49 Marques et licences

# Mise en route

## Contenu de l'emballage

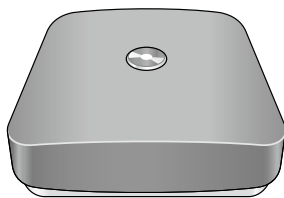

Unité principal



Télécommande (1 ea)



Piles « AAA » 1,5V (2 ea)

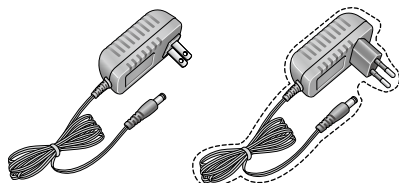

Adaptateur secteur (1 ea)

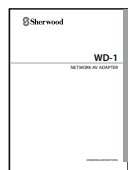

Guide d'utilisation (1 ea)



### Remarque

- Les articles livrés avec votre appareil sont susceptibles de modification sans préavis.

## Installation des piles de la télécommande

- 1 Enlevez le couvercle du compartiment des piles.

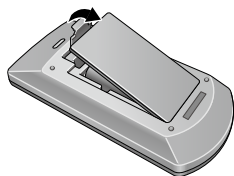

- 2 Insérez deux piles AAA en respectant les polarités.

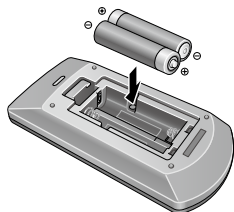

## Portée de la télécommande

Utilisez la télécommande dans un rayon d'environ 7 mètres et à un angle de 30 degrés maximum en la dirigeant vers le capteur de la télécommande.

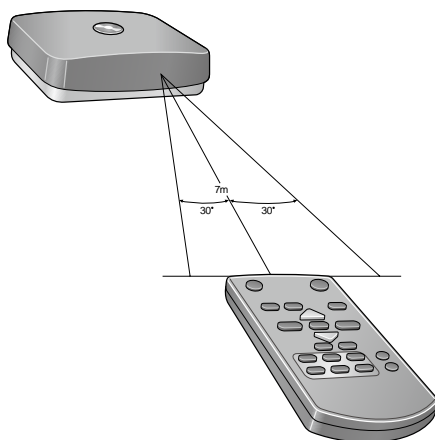

### Attention

- Utilisez toujours des piles alcalines. N'utilisez jamais de piles rechargeables (de type Ni-Cd).
- Lorsque les piles sont usées, les remplacer immédiatement par de nouvelles piles.
- Si les piles sont enlevées ou usées depuis longtemps, le contenu de la mémoire sera effacé. Dans ce cas, il vous faudra effectuer une nouvelle configuration.
- Des piles non installées correctement peuvent provoquer une explosion.
- Retirez les piles si vous n'allez pas utiliser la télécommande pendant une longue durée.
- Ne laissez pas l'appareil dans un endroit chaud ou humide.
- Ne pas manipuler et stocker les piles avec des objets métalliques.

## Description des composants

### Panneau avant et arrière

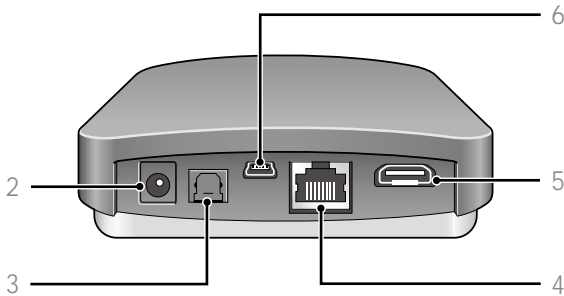

- |   |                                |   |  |
|---|--------------------------------|---|--|
| 1 | <b>Voyant d'état</b>           | 5 | <b>Prise HDMI</b>                                |
| 2 | <b>Prise d'alimentation</b>    | 6 | <b>Prise USB</b>                                 |
| 3 | <b>Prise de sortie optique</b> |   | <b>(pour mise à jour du logiciel uniquement)</b> |
| 4 | <b>Prise LAN/ETHERNET</b>      | 7 | <b>Capteur infrarouge</b>                        |

## Télécommande

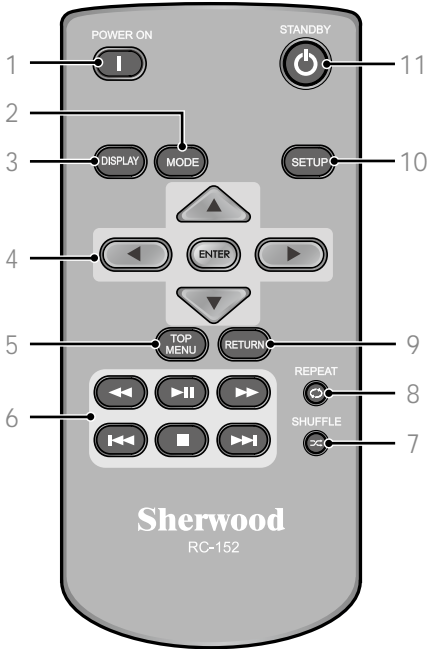

- 1 **MISE EN MARCHÉ**  
Allume l'unité principale.
- 2 **MODE**  
Réglage de la résolution de l'écran (Original/Total)
- 3 **AFFICHAGE**
  - Active/désactive la barre de progression lors de lecture de fichiers audio ou vidéo.
  - Active/désactive l'affichage de l'intervalle de transition diaporama lors de l'affichage photos.
- 4 **▲ / ▼ / ◀ / ▶ / ENTER**
  - Permet de naviguer dans les menus.
  - Permet de confirmer une option de réglage ou menu.
- 5 **Menu principal**  
Affiche le menu principal de chaque support ou service.
- 6 **◀◀**  
Retour rapide dans le fichier en cours.  
**▶▶**  
Avance rapide dans le fichier en cours  
**▶||**  
Permet de lancer ou suspendre la lecture.  
**◀◀**  
Permet de sélectionner le fichier précédent.  
**▶▶**  
Permet de sélectionner le fichier suivant.  
**■**  
Pour arrêter la lecture.
- 7 **SHUFFLE**  
Active la lecture aléatoire
- 8 **REPEAT**  
Pour activer la fonction de répétition
- 9 **RETOUR**  
Pour retourner au menu précédent.
- 10 **CONFIGURATION**  
Permet d'accéder ou de quitter le menu configuration.
- 11 **STANDBY**  
Eteindre l'unité principale et la faire passer en mode veille.



# Etablissement des connexions

## Connexion de sources HDMI

HDMI vous permet de bénéficier de sons et d'images de haute qualité. L'unité principale peut lire l'audio à partir d'appareils compatibles HDMI tout en passant le signal vidéo sur un téléviseur HDMI connecté.

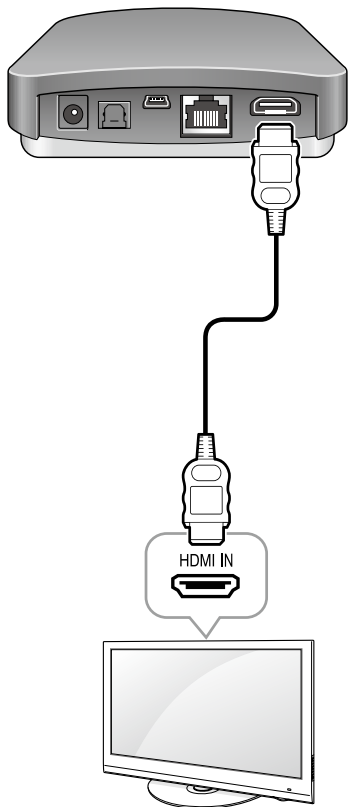

## À propos de HDMI

HDMI (High Definition Multimedia Interface) (Interface multimédia haute définition) est une interface prenant en charge les signaux audio et vidéo sur une seule connexion numérique, utilisable avec les lecteurs DVD, téléviseurs numériques, boîtiers décodeurs et autres appareils Audio/Vidéo. HDMI combine les technologies HDCP (High Bandwidth Digital Content Protection) et DVI (Digital Visual Interface). HDCP est utilisé pour protéger les contenus numériques transmis et reçus par des écrans compatibles DVI.

HDMI peut supporter la vidéo standard, améliorée ou haute définition et l'audio standard surround-sound multicanal. Les avantages de HDMI comptent entre autre la vidéo numérique non compressée, une large bande passante allant jusqu'à 2,2 gigaoctets par seconde (avec les signaux TVHD), un seul connecteur (au lieu de plusieurs câbles et connecteurs) et la communication entre une source et des appareils Audio/Vidéo tels que les téléviseurs numériques.

La présente unité principale est également compatible avec les fonctionnalités DeepColor et x.v.Color (x.v.Color est une marque de Sony Corporation).



### Remarque

- Vérifiez la configuration du composant connecté si l'image est mauvaise ou si l'audio n'est pas reproduite via un composant connecté par un câble HDMI.
- Les signaux audio (fréquence d'échantillonnage, longueur de bits, etc.) transmis par une prise HDMI peuvent être anéantis par le composant connecté.
- Lorsque le composant connecté n'est pas conforme à la technologie de protection du droit d'auteur (HDCP), l'image et le son provenant de la prise HDMI TV OUT peuvent être déformés ou inexistantes. Dans ce cas, vérifiez les caractéristiques du composant connecté.

## Raccordement d'appareils audio numérique

Vous pouvez raccorder des appareils équipés d'une prise de sortie optique. L'unité principale transmet le signal audio numérique aux appareils externes raccordés.

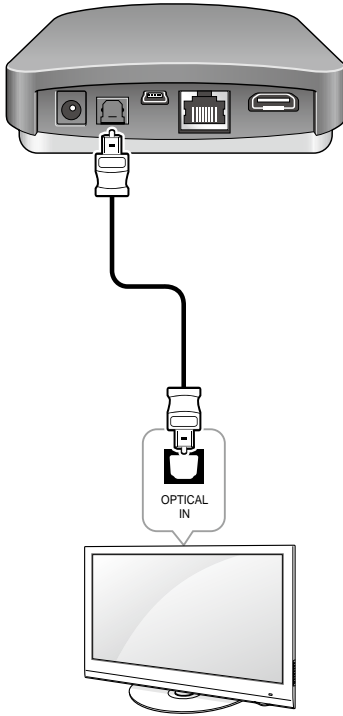

## Connexion au réseau

Si vous disposez d'une connexion Internet, vous pouvez connecter l'unité principale à Internet, sans fil ou de manière câblée.

L'illustration suivante donne un exemple de configuration d'un réseau local avec l'unité principale et un serveur. Il est recommandé de connecter le serveur au routeur via une connexion câblée.

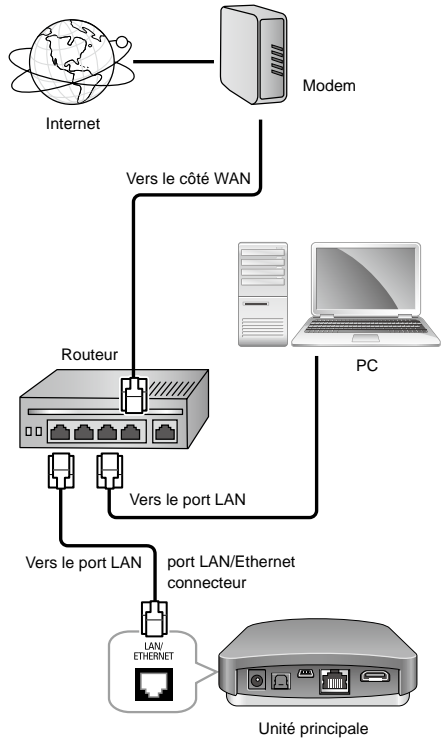



### Remarque

- Une fois une connexion Internet large bande est établie, vous devez régler les paramètres de communication. Pour plus de détails, voir « **Configuration réseau** » à la page 36.
- Lorsque vous utilisez une connexion Internet large bande, cela suppose que vous ayez souscrit à un abonnement auprès d'un fournisseur de services Internet. Pour plus d'informations, contactez le fournisseur de services Internet local.
- Reportez-vous à la notice d'utilisation de l'équipement car la méthode de connexion de l'équipement peut varier en fonction de l'environnement Internet.

## Branchement au courant

Ne branchez l'alimentation qu'après avoir connecté tous vos appareils à l'unité principale. Branchez le câble électrique fourni dans la prise d'alimentation de l'appareil et dans une prise secteur murale.

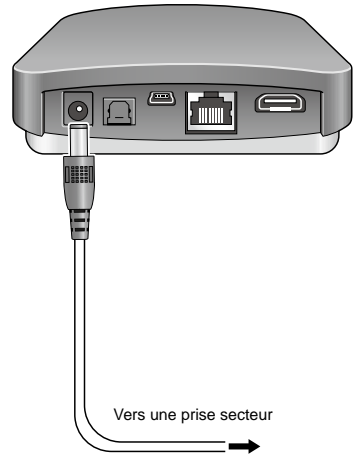

### Attention

- L'adaptateur secteur fourni est conçu exclusivement pour une utilisation avec cet appareil. Ne l'utilisez pas avec un autre appareil auquel il n'a pas été explicitement conçu ; des incendies ou des chocs électriques peuvent se produire.
- Manipulez le cordon d'alimentation par sa fiche. Ne retirez pas la fiche en tirant sur le câble d'alimentation et ne touchez jamais le câble avec les mains mouillées ; un court-circuit ou un choc électrique peuvent se produire.
- L'unité principale doit être débranchée du courant lorsqu'elle n'est pas utilisée régulièrement ou ne va pas être utilisée pendant une longue période.