

Dell Latitude 2120

Setup and Features Information

Front View

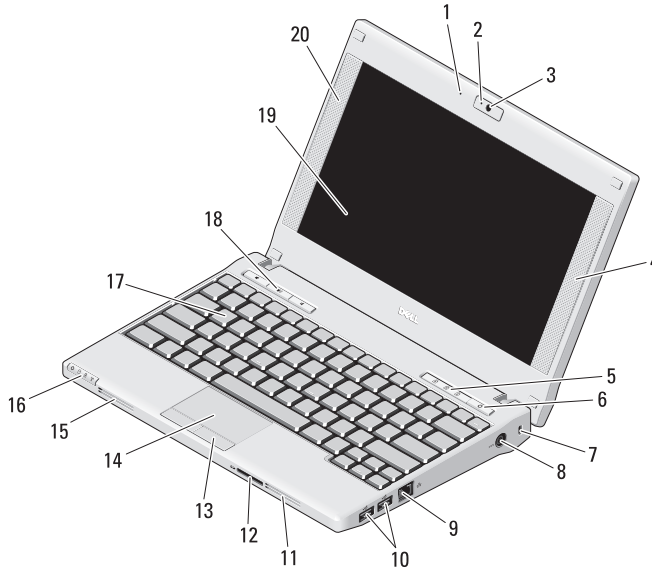

About Warnings



WARNING: A **WARNING** indicates a potential for property damage, personal injury, or death.

- 1 microphone
- 2 camera status light (optional)
- 3 camera (optional)
- 4 right speaker
- 5 keyboard status lights (3)
- 6 power button
- 7 security cable slot
- 8 power connector
- 9 network connector
- 10 USB 2.0 connectors (2)
- 11 cooling vent
- 12 Secure Digital (SD) memory-card reader
- 13 touchpad buttons (2)
- 14 touchpad
- 15 cooling vent
- 16 device status lights (4)
- 17 keyboard
- 18 volume control buttons (3)
- 19 display (multi touch-screen feature is optional)
- 20 left speaker



Regulatory Model: P02T

Regulatory Type: P02T002

September 2010



0HW7HDA00

Back View

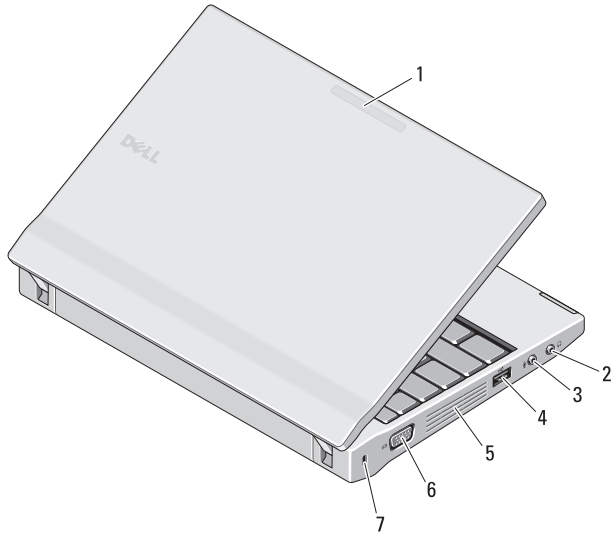

- 1 network activity indicator (optional)
- 2 line-out connector (headphone connector)
- 3 line-in connector (microphone connector)
- 4 USB 2.0 connector
- 5 cooling vent
- 6 video connector (VGA)
- 7 security cable slot



WARNING: Do not block, push objects into, or allow dust to accumulate in the air vents. Do not store your Dell computer in a low-airflow environment, such as a closed briefcase, while it is running. Restricting the airflow can damage the computer or cause a fire. The computer turns on the fan when the computer gets hot. Fan noise is normal and does not indicate a problem with the fan or the computer.

Quick Setup



WARNING: Before you begin any of the procedures in this section, read the safety information that shipped with your computer. For additional best practices information, see www.dell.com/regulatory_compliance.



WARNING: The AC adapter works with electrical outlets worldwide. However, power connectors and power strips vary among countries. Using an incompatible cable or improperly connecting the cable to the power strip or electrical outlet may cause fire or equipment damage.



CAUTION: When you disconnect the AC adapter cable from the computer, grasp the connector, not the cable itself, and pull firmly but gently to avoid damaging the cable. When you wrap the AC adapter cable, ensure that you follow the angle of the connector on the AC adapter to avoid damaging the cable.



NOTE: Some devices may not be included if you did not order them.

1

Connect the AC adapter to the AC adapter connector on the portable computer and to the electrical outlet.

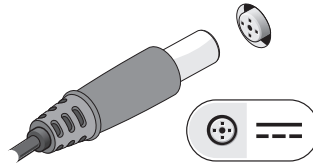

2

Connect the network cable (optional).

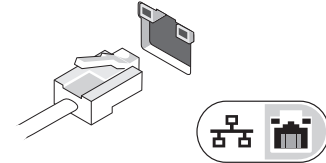

3

Connect USB devices, such as a mouse or a keyboard (optional).

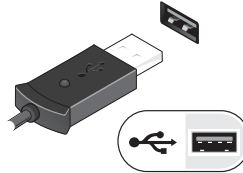

4

Open the computer display and press the power button to turn on the computer.



NOTE: It is recommended that you turn on and shut down your computer at least once before you install any cards or connect the computer to a docking device or other external device, such as a printer.

Specifications



NOTE: Offerings may vary by region. For more information regarding the configuration of your computer, click **Start** → **Help and Support** and select the option to view information about your computer.

System Information

Processor type	Intel Atom N455 Intel Atom N550
Chipset	Intel NM10 Express Chipset

Video

Video type:	Intel UMA graphics
Data bus	integrated video
Video controller	Intel Graphics Media Accelerator 3150 Broadcom Crystal HD media accelerator

Memory

Memory module connector	1 SODIMM slots
Memory module capacity	1 GB and 2 GB
Memory type	667 MHz DDR3
Minimum memory	1 GB
Maximum memory	2 GB

Battery

Type	6-cell "smart" lithium ion (56 WHr) 3-cell "smart" lithium ion (28 WHr)
------	--

Dimensions:

6-cell lithium-ion batteries	
Depth	48.13 mm (1.89 inches)
Height	42.46 mm (1.67 inches)
Width	204 mm (8.03 inches)
3-cell lithium-ion batteries	
Depth	40.50 mm (1.59 inches)
Height	23.24 mm (0.92 inch)
Width	204 mm (8.03 inches)

Weight:

6-cell lithium-ion batteries	minimum weight — 340 gms (0.74 lb) maximum weight — 350 gms (0.77 lb)
3-cell lithium-ion batteries	minimum weight — 185 gms (0.40 lb) maximum weight — 190 gms (0.41 lb)

Voltage	11.1 VDC (6-cell and 3-cell)
---------	------------------------------

Temperature range:

Operating	0 °C to 35°C (32 °F to 95 °F)
Non-operating	-40 °C to 65 °C (-40 °F to 149 °F)

Coin-cell battery	3 V CR2032 lithium coin cell
-------------------	------------------------------

AC Adapter

Input voltage	100 VAC – 240 VAC
Input current (maximum)	1.5A/1.6 A/1.7 A
Input frequency	50 Hz – 60 Hz
Output power	65 W/90 W
Output current:	
65 W	4.34 A (maximum at 4-second pulse) 3.34 A (continuous)
90 W	5.62 A (maximum at 4-second pulse) 4.62 A (continuous)
Rated output voltage	19.5 +/- 1.0 VDC
Dimensions:	
Height	27.20 mm (1.070 inches)
Width	137.20 mm (5.40 inches)
Depth	57.80 mm (2.27 inches)
Temperature range:	
Operating	0 °C to 35 °C (32 °F to 95 °F)
Non-operating	-40 °C to 65 °C (-40 °F to 149 °F)

Physical

Height	
without touchscreen	22.5 mm to 39.9 mm (0.89 inches to 1.57 inches)
with touchscreen	24.1 mm to 41.5 mm (0.95 inches to 1.63 inches)

Physical (continued)

Width	
with/without touchscreen	265 mm (10.43 inches)
Depth	
with/without touchscreen	187 mm (7.36 inches)
Weight	
(3-cell battery without touch screen)	1.30 kg (2.87 lb)
(6-cell battery without touch screen)	1.50 kg (3.31 lb)

Environmental

Temperature range:	
Operating	0 °C to 35 °C (32 °F to 95°F)
Non-operating	-40 °C to 65 °C (-40 °F to 149°F)
Relative humidity (maximum):	
Operating	10 % to 90 % (noncondensing)
Non-operating	5 % to 95 % (noncondensing)
Altitude (maximum):	
Operating	-15.2 m to 3048 m (-50 ft to 10,000 ft)
Non-operating	-15.2 m to 10,668 m (-50 ft to 35,000 ft)
Airborne contaminant level	G2 or lower as defined by ISA-S71.04-1985

Finding More Information and Resources

See the safety and regulatory publications that shipped with your computer and the regulatory compliance website at www.dell.com/regulatory_compliance for more information on:

- Safety best practices
- Warranty
- Terms and Conditions
- Regulatory certification
- Ergonomics
- End User License Agreement

**Information in this publication is subject to change without notice.
© 2010 Dell Inc. All rights reserved.**

Reproduction of these materials in any manner whatsoever without the written permission of Dell Inc. is strictly forbidden.

Trademarks used in this text: Dell™, the DELL logo, and Latitude™, are trademarks of Dell Inc. Intel®, is a registered trademarks and Atom™ is a trademark of Intel Corporation in the U.S. and other countries.

Other trademarks and trade names may be used in this publication to refer to either the entities claiming the marks and names or their products. Dell Inc. disclaims any proprietary interest in trademarks and trade names other than its own.