

QUICK SETUP GUIDE

Bluetooth Earbuds

NS-CAHBTEP02 / NS-CAHBTEP02-C

PACKAGE CONTENTS

- Bluetooth earbuds
- USB charging cable
- Quick Setup Guide
- Cable clip
- 2 pairs of eartips (small and medium)

FEATURES

- Bluetooth 4.1
- Up to six hours battery life for music playback
- In-line control with a built-in mic
- MicroUSB charging



#	DESCRIPTION	FUNCTION
1	+ Volume Up Next Track	Press + to increase the volume. Press + to skip to the next track.
2	Multi-function button (MFB) (Power/Talk/Play/Pause/Pairing)	Press to turn on your earbuds. If you receive a phone call, press to talk. Press to turn off your earbuds.
3	Indicator LED	Shows the current status of the earbuds.
4	- Volume Down Previous Track	Press - to decrease the volume. Press - to skip to the previous track.
5	Micro USB port	Plug the micro USB connector into this port to charge your earbuds.
6	Microphone	Allows you to talk on the telephone.

CHARGING YOUR EARBUDS

When the red indicator LED blinks three times every one minute, the battery is low. To charge the battery, plug the microUSB charging cable into your computer and into the microUSB port on your earbuds. The red LED turns on to indicate that the battery is charging and turns off when fully charged.

USING YOUR EARBUDS

- 1 Place the earbud cable around your neck.
- 2 Attach the cable clip to the earbud cable by pressing the cable into the groove in the cable clip.
- 3 Adjust the position, then clip the cable clip to your collar. The inline control falls naturally in front of your right shoulder.

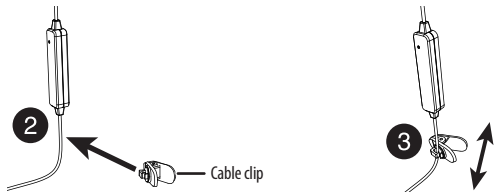

Turning your earbuds on and off

Press and hold the MFB (multi-function button) for three seconds. The LED blinks blue (when turned on) or red (when turned off) and the voice prompt says "Power on" or "Power off."

BLUETOOTH BASIC INDICATION

ACTION	OPERATION	LED INDICATION	SOUND
Power on	Press and hold MFB more than two seconds	Blue LED on 1.5 seconds	"power on"
Power off	Press and hold MFB more than three seconds	Red LED on 1.5 seconds	"power off"
Pairing mode	Press and hold MFB more than four seconds in power off mode	Blue and red LED blinking alternately	Two short beeps
Play/Pause	Press and release MFB button		
Volume Up/Down	Press and release + / - button		Two high beeps for maximum volume. Two low beeps for minimum volume
Next Track/ Previous Track	Press and hold + / - button		
Incoming call		Blue LED blinks three times every five seconds when a call is received	Ring tones
Answer call	Press and release MFB when a call is incoming		One short beep
Reject call	Press and hold MFB when a call is incoming		One long beep
Redial	Double press MFB		Two short beeps
Reset device list	Press and hold MFB more than 10 seconds in power off mode	All LEDs turn off	

PAIRING YOUR EARBUDS

Notes:

- Range is 33 feet (10 meters)
- Supports easy pairing
- Prompts you by saying "Device Connected," when connected
- Supports a battery indicator icon on an iOS device

Pairing with a cell phone or MP3 player

- 1 With your earbuds turned off, press and hold **MFB** for four seconds. The blue and red LEDs blink alternately.
- 2 On your phone or MP3 player, select **INSIGNIA NS-CAHBTEP02** from the list of discovered devices, then enter the password **0000** (four zeros) (if required) to pair your earbuds. For more information on pairing Bluetooth devices to your cell phone or MP3 player, see the device's documentation.

Note: After the earbuds have been successfully paired with the cell phone or MP3 player, the earbuds will automatically reconnect to the phone or MP3 player.

Pairing with a computer running Windows

Note: Before you pair the earbuds with the computer, make sure that the computer is equipped with Bluetooth. Refer to the computer's documentation or contact the computer manufacturer for more information. If your computer is not Bluetooth compatible, install a Bluetooth USB adapter (dongle).

- 1 Turn on Bluetooth on the computer. For instructions, see the computer's documentation or contact the computer manufacturer.
- 2 Double-click the **Bluetooth** icon in the system tray, then click **Add a device (Add Wireless Device)** using Windows Vista).
- 3 With the earbuds turned off, press and hold **MFB** for four seconds. The LED blinks blue and red alternately. Pairing mode is activated.
- 4 Double-click the **INSIGNIA NS-CAHBTEP02** icon on the computer or highlight the icon, then click **Next**.
Note: If you are unable to locate the **INSIGNIA NS-CAHBTEP02** icon, click the **Search Again** button.
- 5 If required, enter **0000** (four zeros) in the **Bluetooth security code** field, then click **Next**.
- 6 After the earbuds have been paired, click **Close**. If you are using Windows XP, continue with steps 7 through 9.
- 7 Select one of the Bluetooth hands-free types shown on the *Add a Bluetooth Device Wizard* screen, then click **Next**.
- 8 Select the services shown on the wizard screen to use with your Bluetooth earbuds, then click **Finish**.
- 9 To connect the device, double-click the **INSIGNIA NS-CAHBTEP02 Hands-Free Unit** icon or the **INSIGNIA NS-CAHBTEP02 Stereo Audio** icon.
Note: The earbuds should be automatically selected as the default playback device (Windows® 8, Windows® 7, or Windows Vista™) or the default recording and playback device (Windows XP). To make those settings manually, refer to the *User Guide*.

Pairing with a Mac computer

Note: Before you pair the headphones with the computer, make sure that the computer is Bluetooth compatible. Refer to the computer's documentation or contact the computer manufacturer for more information. If your computer is not Bluetooth compatible, install a Bluetooth USB adapter (dongle).

- 1 Turn on Bluetooth on the computer. For instructions, see the computer's documentation or contact the computer manufacturer.
- 2 Click the **Bluetooth status** menu.
- 3 Click **Set up Bluetooth Device**. The *Bluetooth Setup Assistant* opens.
- 4 Click **Continue**.
- 5 Select **Headset** as the device type, then click **Continue**.
- 6 With the earbuds turned off, press and hold **MFB** for four seconds. The LED blinks blue and red alternately. Pairing mode is activated.
- 7 Select **INSIGNIA NS-CAHBTEP02**, then click **Continue**. The computer gathers information.
- 8 Click **Continue**.
- 9 Enter **0000** (four zeros) into the **Passkey** field, then click **Continue**.
- 10 Click **Quit** to finish.
Note: To use the earbuds, they must be selected as the default input and output device on the computer.
- 11 Click **System Preferences**, then click **Sound**.
- 12 Under **Input**, select **INSIGNIA NS-CAHBTEP02**, then under **Output**, select **INSIGNIA NS-CAHBTEP02**.

For more information on using your headphones with Skype, refer to your *User Guide*.

CHANGING YOUR EARTIPS

- 1 Select the correct size eartip for your ears.
- 2 To remove the eartip, grip the ear bud in one hand and the eartip in the other, then twist and pull to remove the eartip from the ear bud. Repeat for the other ear bud.

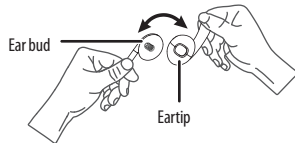

- 3 To attach the eartip, hold the ear bud in one hand, place the new eartip over the ear bud and press together until joined. Repeat for the other ear bud.

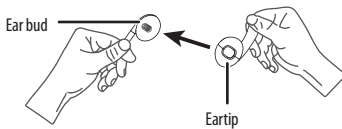

- 4 Place the assembled ear bud in your ear and turn clockwise until comfortable.



RESETTING YOUR EARBUDS

- To reset your earbuds, with your earbuds turned off, press and hold **MFB** for 10 seconds.

SPECIFICATIONS

Bluetooth version:	Bluetooth 4.1	Operating time:	Talk: 6 hours Music: 6 hours, playback music track
Supported profiles:	A2DP, AVRCP, HFP, HSP	Standby time:	100 hours
Frequency spectrum:	2.4 ~ 2.4835 GHz ISM Band	Weight:	0.388 oz (11g)
Working distance:	Up to 33 ft. (10 m)	Average charging time:	2 hours
Operating temperature:	23 ~ 122°F (-5 ~ 50°C)		

TROUBLESHOOTING

- Reset your BT headphone
- Plug microUSB cable for charging

LEGAL NOTICES

FCC statement:

This device complies with Part 15 of the FCC Rules. Operation is subject to the following two conditions: (1) this device may not cause harmful interference, and (2) this device must accept any interference received, including interference that may cause undesired operation.

FCC Caution:

Changes or modifications not expressly approved by the party responsible for compliance could void the user's authority to operate the equipment. **Note:** This equipment has been tested and found to comply with the limits for a Class B digital device, pursuant to Part 15 of the FCC Rules. These limits are designed to provide reasonable protection against harmful interference in a residential installation. This equipment generates, uses and can radiate radio frequency energy and, if not installed and used in accordance with the instructions, may cause harmful interference to radio communications. However, there is no guarantee that interference will not occur in a particular installation. If this equipment does cause harmful interference to radio or television reception, which can be determined by turning the equipment off and on, the user is encouraged to try to correct the interference by one or more of the following measures:

- Reorient or relocate the receiving antenna.
- Increase the separation between the equipment and receiver.
- Connect the equipment into an outlet on a circuit different from that to which the receiver is connected.
- Consult the dealer or an experienced radio/TV technician for help.

RSS-Gen & RSS-247 Statement:

This device complies with Industry Canada licence-exempt RSS standard(s).

Operation is subject to the following two conditions: (1) this device may not cause interference, and (2) this device must accept any interference, including interference that may cause undesired operation of the device.

Le présent appareil est conforme aux CNR d'Industrie Canada applicables aux appareils radio exempts de licence. L'exploitation est autorisée aux deux conditions suivantes: (1) l'appareil ne doit pas produire de brouillage, et (2) l'utilisateur de l'appareil doit accepter tout brouillage radioélectrique subi, même si le brouillage est susceptible d'en compromettre le fonctionnement.

RSS-102 Statement:

This equipment complies with Industry Canada radiation exposure limits set forth for an uncontrolled environment.

Cet équipement est conforme à l'exposition aux rayonnements Industry Canada limites établies pour un environnement non contrôlé.

ONE-YEAR LIMITED WARRANTY

Visit www.insigniaproducts.com for details.

CONTACT INSIGNIA:

1-877-467-4289 (U.S. and Canada)

01-800-926-3000 (Mexico)

www.insigniaproducts.com

INSIGNIA is a trademark of Best Buy and its affiliated companies. Distributed by Best Buy Purchasing, LLC

©2017 Best Buy. All rights reserved. **Made in China**

GUIDE D'INSTALLATION RAPIDE

Écouteurs Bluetooth

NS-CAHBTEP02 / NS-CAHBTEP02-C

CONTENU DE L'EMBALLAGE

- Écouteurs Bluetooth
- Câble de charge USB
- *Guide d'installation rapide*
- Agrafe de câble
- 2 paires d'embouts (petits et moyens)

CARACTÉRISTIQUES

- Bluetooth 4.1
- Jusqu'à six heures d'autonomie de la batterie pour la reproduction de musique
- Commande sur le câble avec microphone intégré
- Charge par micro USB



N°	DESCRIPTION	FONCTION
1	+ hausse du volume Piste suivante	Appuyer sur + pour augmenter le volume. Appuyer sur + pour passer à la piste suivante.
2	Touche multifonction (MFB) (Marche-arrêt/Communication/Lecture/Pause/Couplage)	Permet de mettre les écouteurs bouton en marche. Permet de communiquer lors d'un appel entrant. Permet d'arrêter les écouteurs bouton.
3	Témoin DEL	Indique l'état actuel des écouteurs-boutons.
4	- baisse du volume Piste précédente	Appuyer sur - pour diminuer le volume. Permet de revenir à la piste précédente.
5	Port micro USB	Brancher le connecteur micro USB sur ce port pour charger les écouteurs bouton.
6	Microphone	Permet d'avoir une conversation au téléphone.

CHARGE DES ÉCOUTEURS-BOUTONS

Quand le témoin DEL rouge clignote trois fois par minute, la batterie est faible. Pour charger la batterie, brancher une extrémité du câble de charge micro USB sur l'ordinateur et l'autre extrémité sur le port micro USB des écouteurs bouton. Le témoin DEL rouge s'allume pour indiquer que la batterie est en cours de charge et s'éteint quand elle est rechargée.

FONCTIONNEMENT DU ÉCOUTEURS-BOUTONS

- 1 Placer le câble des écouteurs-boutons autour du cou.
- 2 Fixer l'agrafe de câble au câble des écouteurs-boutons en insérant par pression le câble dans la rainure de l'agrafe de câble.
- 3 Régler la position, puis accrocher le l'agrafe au cou. La commande sur le câble tombe naturellement devant l'épaule droite.

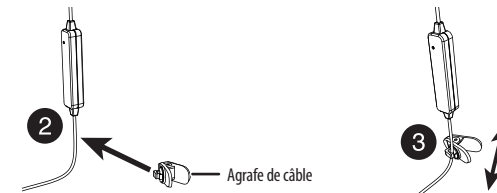

Mise en marche et arrêt des écouteurs-boutons

Appuyer de façon prolongée la touche multifonction pendant trois secondes. Le témoin DEL clignote en bleu (écouteurs en marche) ou rouge (écouteurs arrêtés) et la commande vocale dit « Power on » (sous tension) ou « Power off » (hors tension).

INDICATION DE BASE DES TÉMOINS BLUETOOTH

ACTION	FONCTIONNEMENT	TÉMOIN DEL	MESSAGE SONORE
Sous tension	Appuyer et maintenir enfoncée la touche MFB pendant plus de deux secondes	DEL bleue allumée pendant 1,5 seconde	« Power on »
Hors tension	Appuyer et maintenir enfoncée la touche MFB pendant plus de trois secondes	DEL rouge allumée pendant 1,5 seconde	« Power off »
Mode de couplage	Appuyer et maintenir enfoncée la touche MFB pendant plus de quatre secondes en mode hors tension	Les DEL bleue et rouge clignent alternativement	Deux bips courts
Lecture/Pause	Appuyer et relâcher la touche MFB		
Volume +/-	Appuyer et relâcher la touche + / -		Deux bips élevés pour un volume maximal. Deux bips bas pour un volume minimal
Piste suivante/ Piste précédente	Appuyer et maintenir enfoncée la touche + / -		
Appel entrant		La DEL bleue clignote trois fois toutes les cinq secondes lorsqu'un appel est reçu	Sonneries
Répondre à un appel	Appuyer et relâcher la touche MFB lors d'un appel entrant		Un bip court
Refuser un appel	Appuyer et maintenir enfoncée la touche MFB lors d'un appel entrant		Un bip prolongé
Recomposition	Appuyer deux fois sur MFB		Deux bips courts
Réinitialisation de la liste des périphériques	Appuyer et maintenir enfoncée la touche MFB pendant plus de dix secondes en mode hors tension	Toutes les DEL sont éteintes	

COUPLAGE DES ÉCOUTEURS

Remarques :

- La portée est de 10 m (33 pi).
- Prend en charge le couplage facile
- La commande vocale dit « **Device Connected** » (Périphérique connecté) quand la connexion est établie
- Prend en charge une icône de témoin des piles d'un appareil iOS

Couplage avec un téléphone cellulaire ou lecteur MP3

- 1 Avec les écouteurs arrêtés, appuyer et maintenir enfoncée la touche **MFB** pendant quatre secondes. Les DEL bleue et rouge clignent alternativement.
- 2 Sur le téléphone cellulaire ou le lecteur MP3, sélectionner **INSIGNIA NS-CAHBTEP02** dans la liste des périphériques détectés, puis saisir le mot de passe **0000** (quatre zéros) (si requis) pour coupler les écouteurs.
Pour plus d'information sur le couplage de périphériques Bluetooth au téléphone cellulaire ou au lecteur MP3, consulter la documentation de l'appareil.

Remarque : Une fois que les écouteurs ont été couplés avec succès au téléphone cellulaire ou au lecteur MP3, ils se reconnectent automatiquement à ces derniers.

