



# Bluetooth® Buzzer Pendant CS8056

## User Manual

<http://www.abe-hk.com>

### Table of Content

I. Profile and its function.....	1
1. Profile.....	1
2. Function.....	1
II. How to Use.....	2
1. Charging the battery.....	2
2. Turning on the Buzzer Pendant .....	3
3. Turning off the Buzzer Pendant .....	3
4. Pair the Buzzer Pendant with your mobile phone.....	3
5. Establishing <i>Bluetooth</i> Link.....	3
6. Clip the Buzzer Pendant onto your clothes.....	4
7. Answering incoming calls.....	4
8. Transferring calls.....	4
9. Muting the microphone.....	4
10. Ending calls.....	5
11. Make a new call in two ways.....	5
12. Adjusting the ear piece volume.....	5
13. Battery recharging.....	6
III. Maintenance and safe use.....	6
IV. Accessories table .....	7
FCC Interference statement.....	8
Declaration of conformity.....	9

### I. Profile and its function

#### 1. Profile

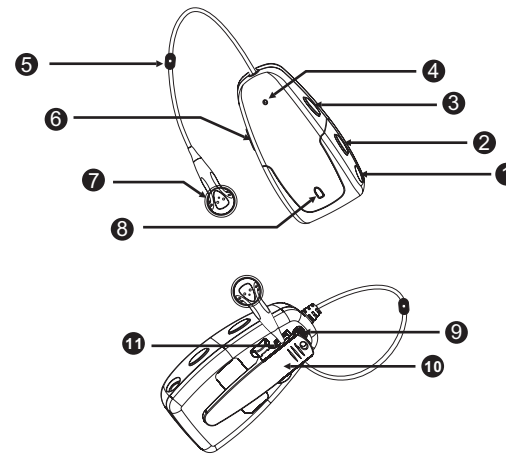

Fig. 1

- |                   |                     |                             |
|-------------------|---------------------|-----------------------------|
| 1. DC Socket      | 5. Microphone       | 9. Buzzer On/Off Switch     |
| 2. On/Off (S1)    | 6. Volume Down (S3) | 10. Clip                    |
| 3. Volume Up (S2) | 7. Ear Piece        | 11. Earpiece holder on clip |
| 4. Buzzer         | 8. LED              |                             |

#### 2. Function (Please refer to Fig. 1)

- 2.1 DC Socket  
Charge the battery with AC Adaptor
- 2.2 On /Off (S1)  
If you press S1, you can:  
Switch on and off  
Perform a *Bluetooth* pairing  
Answer a new call  
Reject a new call  
Make a new call using voice dialing

(1)

- 2.3 Volume Up (S2)  
Increase the volume of ear piece
- 2.4 Buzzer  
A long beep followed by a short beep to remind the user of an incoming call when the buzzer is turned on.
- 2.5 Microphone
- 2.6 Volume Down (S3)  
Redial the last dialed number  
Decrease the volume of ear piece  
Notice: To mute/un-mute the microphone, please press S2 and S3 simultaneously.
- 2.7 Ear Piece
- 2.8 LED  
There are two LED colors ( green and red) to indicate the state of this Buzzer Pendant.
- 2.9 Buzzer On/Off Switch  
You can turn on/off your buzzer when necessary.
- 2.10 Clip (Please refer to Fig. 1 and Fig. 3)  
Clip the Buzzer Pendant onto your clothes.
- 2.11 Earpiece holder on clip (Please refer to Fig. 1)

### II. How to use (e.g. Nokia 3650 or equivalent models)

#### 1. Charging the battery (Please refer to Fig. 2)

Thank you for buying the new *Bluetooth* Buzzer Pendant, Abe CS8056. Before first time use, it is important to charge the battery for 12 hours.

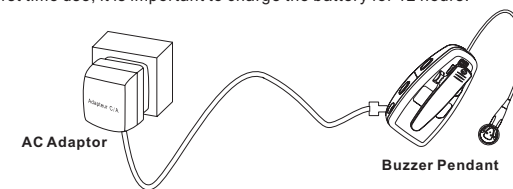

Fig. 2

(2)

#### 2. Turning on the Buzzer Pendant

While the Buzzer Pendant is powered off, press and hold S1 for 2 seconds. A high tone followed by a high tone will indicate that the Buzzer Pendant has powered on. Green LED will turn on for 1 second. Afterwards, green LED will flash every 3 seconds.

#### 3. Turning off the Buzzer Pendant

While the Buzzer Pendant is powered on, press and hold S1 for 5 seconds. A high tone followed by a low tone will indicate that the Buzzer Pendant is powered off. And the LED will keep on Red until S1 is released.

#### 4. Pairing the Buzzer Pendant with your mobile phone

##### 4.1 Put the Buzzer Pendant in pairing mode

While the Buzzer Pendant is powered off, press and hold S1 for 4 seconds. Red and Green LEDs flashing alternately will indicate that the Buzzer Pendant is in Pairing Mode.

Notice: Make sure the Buzzer Pendant is fully charged

##### 4.2 Put your mobile phone in pairing mode

Follow the operating instructions for your *Bluetooth* mobile phone to start the pairing process. Typically, this has to be done by going to a setup or connect menu and then selecting the options to discover *Bluetooth* devices. *Bluetooth* may take several seconds to establish a connection.

Your phone's display should indicate that it has found the "CS8056" and asks if you want to pair it. You should confirm this. The phone's display would prompt you for a passkey or PIN. Enter a sequence of "0000".

##### 4.3 Pair the Buzzer Pendant with your *Bluetooth* mobile phone

The Buzzer Pendant LED will flash Green every 3 seconds, indicating successful pairing. Usually the phone will also ask whether you want to change the Buzzer Pendant's name. We recommend you should approve the "CS8056" name and not change it. You can pair as many Buzzer Pendant and devices as you wish in your mobile phone.

Notice: If pairing does not occur as expected, Turn off the Buzzer Pendant and phone and wait for 10 seconds. Then, turn on the Buzzer Pendant and phone again. Then repeat all steps from beginning.

#### 5. Establishing *Bluetooth* Link

After Pairing, the mobile phone will show "connect", then please select "YES" to establish the link. Now you are ready to make and answer calls on the Buzzer Pendant.

Notice: For other phones, please follow their operation manuals to establish the link.

(3)

#### 6. Clip the Buzzer Pendant onto your clothes



Fig. 3

#### 7. Answering Incoming Calls

When an incoming call is present, you will hear the ring. Pressing S1 will answer the call. The green LED will continue to flash fast once every second while the call is in session.

##### --Turning on the buzzer

If you want to get a buzzer alert when calls are coming, you can turn on the Buzzer On/Off Switch at the back of the Buzzer Pendant. A long beep followed by a short beep will indicate an incoming call.

##### --Turning off the buzzer

If you don't want to get a buzzer alert when calls are coming, just turn off the Buzzer On/Off Switch.

Notice: If the Buzzer is on, then both of your Buzzer and ear piece will ring; If the Buzzer is off, only your ear piece will ring.

#### 8. Transferring Calls

When you are in session, calls can be transferred from the *Bluetooth* phone to the Buzzer Pendant and vice versa.

##### 8.1 From *Bluetooth* phone to the Buzzer Pendant

Press S1 once, the call will be transferred to the Buzzer Pendant.

##### 8.2 From the Buzzer Pendant to the *Bluetooth* phone

Please follow the operating instructions of your phone.

#### 9. Muting the microphone

##### 9.1 To mute the microphone during an active call

Pressing both S2 and S3 buttons simultaneously for about a second, the microphone will be muted. A periodic beep tone will be heard while the mute function is active.

(4)

9.2 To end the mute function  
When the microphone is muted, press on both S2 and S3 buttons simultaneously will end the mute function and the periodic beep tone will stop.

**10. Ending Calls**  
While a call is in session on the Buzzer Pendant, pressing S1 will disconnect the call. After the call is disconnected, the green LED will flash normally.

To reject a call  
When the Buzzer Pendant rings, press and hold S1 until you hear a long beep tone.

**11. Making a new call in two ways**  
11.1 Using voice dialing  
*When using a Bluetooth mobile phone:*  
Press S1 on the Buzzer Pendant shortly. After the beep tone on the Buzzer Pendant, voice dial as you normally would by saying the name of the person on the Buzzer Pendant. The call will be connected in a few seconds.  
Notice: Make sure the voice dialing function is probably set up in the mobile phone and it is within the range of the Buzzer Pendant.

*When using a mobile phone without Bluetooth built-in and requiring a Bluetooth dongle:*  
Press S1 on the Buzzer Pendant shortly. After the beep tone on the mobile phone, voice dial as you normally would and the call will be connected in a few seconds.  
Notice: Make sure the voice dialing function is probably set up in the mobile phone and it is within the range of the Buzzer Pendant.

11.2 Redialing last dialed number  
To redial the last dialed number, press and hold S3 for 2 seconds. Short low tones will indicate an attempt to redial.

**12. Adjusting the ear piece volume**  
While a call is in session, pressing and releasing S2 will increase the earpiece volume; pressing and releasing S3 will decrease the earpiece volume on the Buzzer Pendant. There is a key tone to indicate volume increase or decrease.  
Notice: A warning tone will be heard when the volume level reaches its maximum or minimum.

(5)

**13. Battery recharging**  
13.1 Low battery indication  
The Buzzer Pendant LED will flash red instead of green when the battery is low. There will also be a short beep every few minutes.  
Notice: When the battery level is too low, the Buzzer Pendant will automatically power off. It cannot be powered on again unless the battery is charged for 5 minutes.

13.2 Battery recharging  
To recharge the battery, connect the charger cable to the Buzzer Pendant. During recharging, the LED shows a steady red light if the Buzzer Pendant is turned off but the red light will dim once every 3 seconds while Buzzer Pendant is on.



13.3 Fully charge  
When the battery is fully charged, the indicators of red light will change into green. A steady green light represents the Buzzer Pendant is off and is fully charged. Green light dims once every 3 seconds represents the Buzzer Pendant is on and fully charged.

Buzzer Pendant	Under charging	Fully charged
Turn on	Red LED dim once every 3 sec	Green LED dim once every 3 sec
Turn off	Red LED on	Green LED on

**III. Maintenance and safe use**  
Use dry cloth to clean the Bluetooth Buzzer Pendant!  
Do not expose it to liquid or moisture!  
Do not expose it to fire or open flames!

(6)

**IV.**

Accessories Table	Description	Status
	A / C Adaptor	Provided
	Neck Strap	Provided

**Disclaimer:**  
Talk time and stand-by time of the Bluetooth Buzzer Pendant will vary depending on mobile phone model being used.

Note:  
BQB, CE and FCC approved

The Bluetooth word mark and logos are owned by the Bluetooth SIG, Inc. and any use of such marks by In-Tech Electronics Ltd. is under license. Other trademarks and trade names are those of their respective owners.

(7)

**Federal Communication Commission  
Interference Statement**

This equipment has been tested and found to comply with the limits for a Class B digital device, pursuant to Part 15 of the FCC Rules. These limits are designed to provide reasonable protection against harmful interference in a residential installation. This equipment generates, uses and can radiate radio frequency energy and, if not installed and used in accordance with the instructions, may cause harmful interference to radio communications. However, there is no guarantee that interference will not occur in a particular installation. If this equipment does cause harmful interference to radio or television reception, which can be determined by turning the equipment off and on, the user is encouraged to try to correct the interference by one of the following measures:

- Reorient or relocate the receiving antenna.
- Increase the separation between the equipment and receiver.
- Connect the equipment into an outlet on a circuit different from that to which the receiver is connected.
- Consult the dealer or an experienced radio/TV technician for help.

This device complies with Part 15 of the FCC Rules. Operation is subject to the following two conditions: (1) This device may not cause harmful interference, and (2) this device must accept any interference received, including interference that may cause undesired operation.

FCC Caution: Any changes or modifications not expressly approved by the party responsible for compliance could void the user's authority to operate this equipment.

**IMPORTANT NOTE:  
FCC Radiation Exposure Statement:**  
This equipment complies with FCC radiation exposure limits set forth for an uncontrolled environment. End users must follow the specific operating instructions for satisfying RF exposure compliance.

This transmitter must not be co-located or operating in conjunction with any other antenna or transmitter.

(8)

**Declaration of Conformity**

We,  
Company: IN-TECH ELECTRONICS LTD.  
with our,  
Product(s): BLUETOOTH HEADSET  
Model No.: BT33P / BT33N  
by using test report: 41026201-RE, 41026201-RT, 41026201-LV

herewith confirm to comply with the requirements set out in the Council Directive on the Approximation of the Laws of the Member States relating to the Electromagnetic Compatibility (89/336/EEC) and the amendments in the Council Directive 92/31/EEC, 93/68/EEC as well as to the Low Voltage Directive 73/23/EEC. For the evaluation of above mentioned Directives, the following standards were applied:

- EMC  
EN 301 489-17 v1,2,1:2002  
EN 301 489-1 v1,4,1:2002  
EN55022: 1998 Class B  
EN61000-3-2: 2000 EN61000-3-3: 1995+A1:2001  
EN61000-4-2: 1995+A2:2001 EN61000-4-3: 2002+A1:2002  
EN61000-4-4: 1995+A2:2001 EN61000-4-5: 1995+A1:2001  
EN61000-4-6: 1996+A1:2001 EN61000-4-11: 1994+A1:2001
- EN 300 328-2 v1,4,1: 2001  
LVD EN60950: 2000

The following manufacturer is responsible for this declaration:

IN-TECH ELECTRONICS LTD.  
207-210, 2/F., CENTURY CENTRE,  
44-46 HUNG TO ROAD, KWUN TONG  
HONG KONG



SHENZHEN, DECEMBER 2, 2004  
.....  
Place and Date

JACKY TSANG – A. R&D MANAGER  
.....  
Chop and Signature of responsible Person

(9)

Note

---

---

---

---

---

---

---

---

---

---

---

---

---

---

---

---

---

---

---

---

---

---

---

---

(10)