



CS8076 Bluetooth Stereo Headset and CS8082 Bluetooth Audio Adaptor User Manual



Environmental friendly

Http://www.abe-hk.com

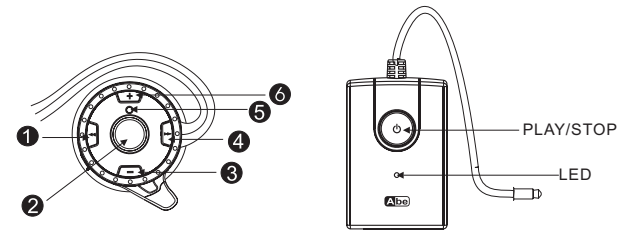

- Backward
 - Reject the call
 - Voice dialing
- Power On/ Off
 - Play
 - Stop
 - Pairing
- VOL -
 - Volume down
- Forward
 - Call transfer
 - Redial the last number
- LED
- VOL +
 - Volume up

How to open the folded headset and wear

1) Unfold the folded headset until they are fully extended to the opened position (see Figure.1 and Figure.2.)

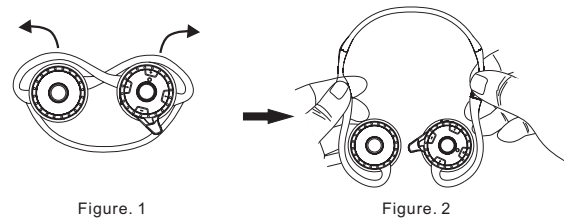

2) Rotate the earcups until they are in the locked position (see drawing Figure.3)

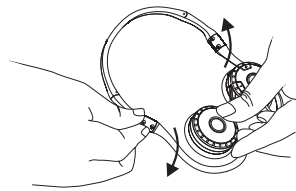

3) Wear the headset (see drawing Figure. 4) with the headband behind your head. Adjust the position until you feel the most comfort.

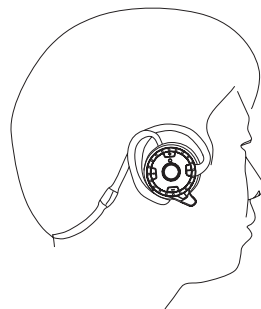

- Charging and recharging the battery
Thank you for buying the new CS8076 Bluetooth Stereo Headset and the new CS8082 Bluetooth Stereo Audio Adaptor pack. Before first time use, it is important to charge the battery of each of them for 6 hours. During recharging, the LED shows a steady red light. When the battery is fully charged, the Red LED is off.

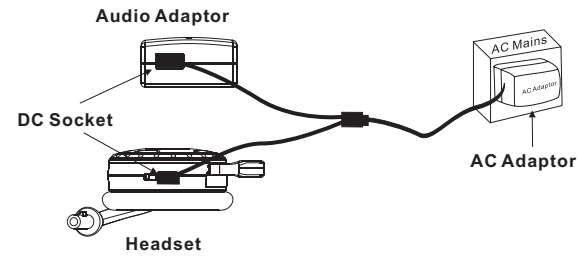

- Low-battery indication
When the battery is low, the LED of the Headset or that of the Audio Adaptor will flash red instead of green. When the battery level is too low, the Headset or the Audio Adaptor will automatically power off.
- Turning on / Turning off the Headset and the Audio Adaptor
When the Headset or the Audio Adaptor is powered off, press and hold the button till the LED flashes green, which indicates the Headset or the Audio Adaptor is powered up. When the Headset or the Audio Adaptor is powered up, press and hold the button, the LED will keep red for a while then off, which indicates it is powered down.

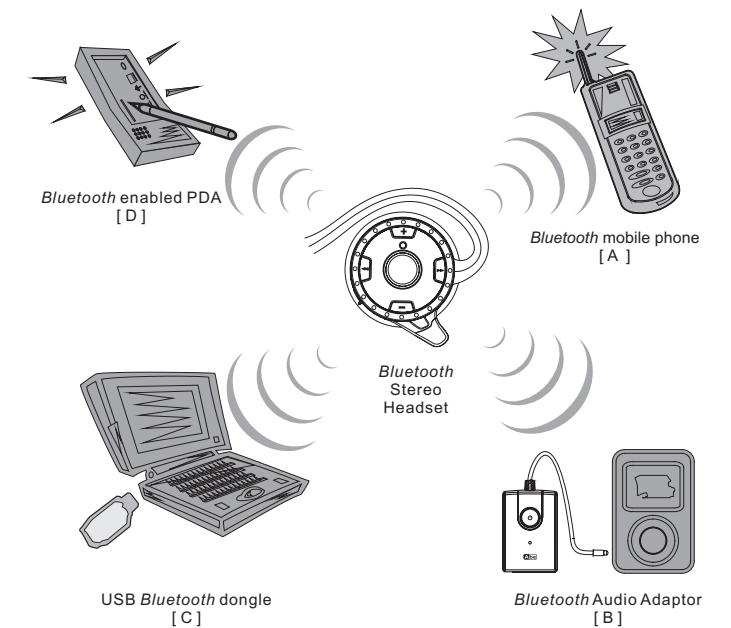

I. [A] Stereo Headset paired with Bluetooth mobile phone Guide

- Pairing
 - While the Headset is powered off, press and hold the button for 4 seconds. The LED will flash red and green alternatively, which indicates the Headset in Pairing Mode. The Pairing Mode will last for one minute.
 - Follow the operating instructions of your Bluetooth mobile phone to start the pairing process. Typically, this has to be done by going to a setup or connect menu and then selecting the options to discover Bluetooth devices. It may take several seconds to establish a Bluetooth connection. Your phone's display should indicate that it has found the model name "CS8076"; and prompt you for a passkey or PIN. Enter a sequence of "0000".

- If the pairing is successful, the LED will flash green, which indicates it is in Standby Mode and ready to answer and receive mobile phone calls from it. If pairing does not occur as expected, turn the Headset and the mobile phone off. Wait for 10 seconds and repeat the pairing process from the beginning.

- Answering incoming calls / Rejecting incoming calls
 - When an incoming call is present, a ring tone will be heard from the earpiece of the Headset. Press PLAY button will answer the call. Press the button will reject the call.
 - [Advance function]** If the Headset is connected with your mobile phone and another Bluetooth transmitter such as the Audio Adaptor simultaneously and you are listening to the music using the earpiece, a ring tone will prompt you. Press PLAY button will answer the call. Press the button will reject the call and you will continue listening to the music.

- Ending calls
 - While a call is in session, press the button will end the call.
 - [Advance function]** If the Headset is connected with your mobile phone and another Bluetooth transmitter such as the Audio Adaptor simultaneously, press STOP button will end the call and you will continue listening to the music.

- Last number redial
 - While the Headset and Bluetooth mobile are in Standby Mode, press and hold the button for 2 second to redial the last dialed number.
 - [Advance function]** If the Headset is connected with your mobile phone and another Bluetooth transmitter such as the Audio Adaptor, press and hold the button for 2 second to redial the last dialed number. Press STOP button to end the call as normal.

- Adjusting speaker volume
 - While a call is in session, pressing and releasing VOL + / VOL - buttons will adjust the speaker volume.
 - [Advance function]** While the Headset is playing music, pressing / releasing VOL + / VOL - buttons will adjust the speaker volume.

- Activating voice dialing
When the Headset is in standby mode, press and hold the button for 2 seconds until a long beep is heard. The Headset is connecting to your mobile phone for voice dialing function. If the connection is successfully made, the phone will ask for the name of the person you wish to call. The call will be executed in a few seconds. If the connection is failed, the Headset will beep and go back to standby mode. Before the Headset entering into voice dialing mode, make sure the voice dialing function of the phone is enabled.

(ADVANCE FUNCTION) While the Headset is playing the music, continuously pressing the button will stop the music playing and a long beep will be heard, indicating that the Headset is connecting with mobile phone for voice dialing function. If the connection is successfully made, the voice dialing can be executed according to the mobile phone's menu operations. (If the connection is failed, the Headset will beep and go back to music playing.)

Remarks: Voice dialing function is not supported in Sony Ericsson K750i

Index	
1. How to open the folded headset and wear	1
2. Charging and recharging the battery	2
3. Low-battery indication	3
4. Turning on / Turning off the Headset and the Audio Adaptor	3
Seven possible User Scenarios	4
I. Stereo Headset paired with Bluetooth mobile phone Guide [A]	5
1. Pairing	5
2. Answering incoming calls / Rejecting incoming calls	6
3. Ending calls	6
4. Last number redial	6
5. Adjusting speaker volume	6
6. Activating voice dialing	6
7. Transfer call	7
II. Stereo Headset paired with Stereo Audio Adaptor Guide [B]	7
1. Pairing	7
2. Listening to music	7
III. Stereo Headset paired with USB Bluetooth Dongle Guide [C]	8
1. Pairing	8
2. Listening to music	8
IV. Stereo Headset paired with Bluetooth enabled PDA Guide [D]	9
1. Pairing	9
2. Listening to music	9
V. Stereo Pendant paired with Audio Adaptor and Bluetooth mobile phone Guide [A & B]	10
1. Pairing	10
2. Listening to music	10
3. Monitoring mobile phone calls	10
VI. Stereo Headset paired with USB Bluetooth dongle and Bluetooth mobile phone Guide [A & C]	11
1. Pairing	11
2. Listening to music	11
3. Monitoring mobile phone calls	11
VII. Stereo Headset paired with Bluetooth enabled PDA and Bluetooth mobile phone Guide [A & D]	12
1. Pairing	12
2. Listening to music	12
3. Monitoring mobile phone calls	12
Accessories Table	12
FCC Interference Statement	13

Scenario	Headset paired with
I Mobile phone calls only.	[A] Bluetooth mobile phone (not supplied)
II Music only from the audio source (MP3, iPod, etc.) that the Audio Adaptor is connected to.	[B] Audio Adaptor (supplied)
III Music only from the audio source (Notebook PC, desktop PC, etc.) that the Bluetooth USB dongle is connected to.	[C] USB Bluetooth Dongle (not supplied)
IV Music only from the PDA / mobile phone.	[D] Bluetooth enabled PDA / mobile phone, with AV profile (not supplied)
V Mobile phone calls and audio source (MP3, iPod, etc.) that the Audio Adaptor is connected to.	Yes
VI Mobile phone calls and music from the audio source (Notebook/Desktop PC, etc.) that the BT USB dongle is connected to.	Yes
VII Mobile phone calls and music from the PDA / mobile phone.	Yes
	Yes

There are seven (7) user scenarios for you to enjoy the Bluetooth wireless convenience:

Seven possible User Scenarios:

7. Transfer call
 - a. To transfer a call from the Headset to your mobile phone
 - If the mobile phone is enabled with the Hands-free profile, press the ►► button while the call is in session and it will be transferred to your mobile phone.
 - If the mobile phone is enabled with the Headset profile, follow the instructions of your mobile phone manual to do call transfers.
 - b. To transfer a call from your mobile phone to the Headset
 - Follow the instructions of the mobile phone manual to do call transfers

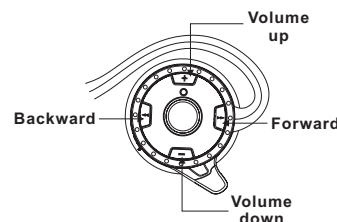

II. [B] Stereo Headset paired with Stereo Audio Adaptor Guide

1. Pairing
 - a. While the Headset is powered off, press and hold ● button for 4 seconds. The LED will flash red and green alternatively, which indicates the Headset in Pairing Mode. The Pairing Mode will last for one minute.
 - b. While the Stereo Audio Adaptor is powered off, press and hold ● button. The LED will flash red and green alternatively, which indicates the Audio Adaptor is in Pairing Mode. The Pairing Mode will last for one minute.
 - c. Put the Headset and the Audio Adaptor close to each other, 0.5 to 3 meters. After a few seconds, their LED's will turn into flashing green, which indicates successful pairing. Both units are in Standby Mode and ready to transmit audio signal, or music from the audio source.
2. Listening to music
 - a. After successful pairing, plug the jack of the Audio Adaptor to the 3.5 mm socket of any audio source such as iPod, MP3, CD player, Notebook PC, or others.
 - b. Put the earpiece on.
 - c. Play the music on the audio source as normal; you will listen to the stereo music from the earpiece.

7

IV. [D] Stereo Headset paired with Bluetooth enabled PDA Guide

1. Pairing
 - a. While the Headset is powered off, press and hold ● button for 4 seconds. The LED will flash red and green alternatively, which indicates the Headset in Pairing Mode. The Pairing Mode will last for one minute.
 - b. Put the Headset and the *Bluetooth* enabled PDA (with A/V profile) close to each other, 0.5 to 3 meters.
 - c. Follow the operation instructions of your *Bluetooth* enabled PDA (with A/V profile) to start the pairing process. Typically, this has to be done by going to a setup or connect menu to discover the Headset. It may take some time to search it depending on the number of *Bluetooth* devices nearby.
 - d. Your PDA will display the model name "CS8076" if it has found the Headset; and ask for a passkey. Enter a sequence of "0000". After successful pairing, follow the instructions to establish the *Bluetooth* connection with the Headset.
 - e. If the pairing is successful, the LED will flash green, which indicates it is in Standby Mode and ready to receive audio signals from the PDA. If pairing does not occur as expected, turn the Headset and the PDA off. Wait for 10 seconds and repeat the pairing process from the beginning.
2. Listening to music
 - a. Put the earpiece on.
 - b. Play the music on the PDA as normal; you will listen to the stereo music from the earpiece.
 - c. The speaker volume of the earpiece can be adjusted by pressing the VOL+/VOL- buttons.
 - d. While listening to music (for example, song 2), press the Headset's FORWARD >> button will skip to next song (for example, song 3); press the BACKWARD << button will replay the current song (for example, song 2). Double press the BACKWARD button will play the last song (for example, song 1). This remote control function is supported only by the AVRCP profile of your *Bluetooth* application program.
 - e. Turn the Headset off after use.

9

Advance functions: The following user scenarios provide you a true wireless freedom to monitor the mobile phone call status while you are enjoying stereo music at the same time. You don't even need to put down your earpiece.

*Advance functions are not supported in Sony Ericsson T610, T630

V. [A & B] Stereo Headset paired with Audio Adaptor and Bluetooth mobile phone Guide

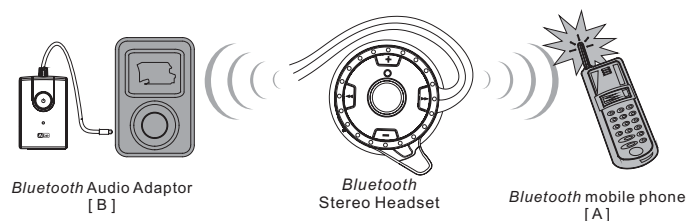

1. Pairing
 - a. Follow the Pairing process [B] to pair the Headset and the Audio Adaptor.
 - b. After successful pairing, turn the Headset off. The Audio Adaptor will turn off automatically.
 - c. Follow the pairing process [A] to pair the Headset and the *Bluetooth* mobile phone.
 - d. After successful pairing, turn on the Audio Adaptor.
 - e. All three devices are in Standby Mode and the LED's should flash green.
2. Listening to music
 - a. Follow the Listen to music process [B] to enjoy the music.
3. Monitoring mobile phone calls
 - a. Follow the [Advance function] in [A] to monitor phone calls.

10

VI. [A & C] Stereo Headset paired with USB Bluetooth dongle and Bluetooth mobile phone Guide

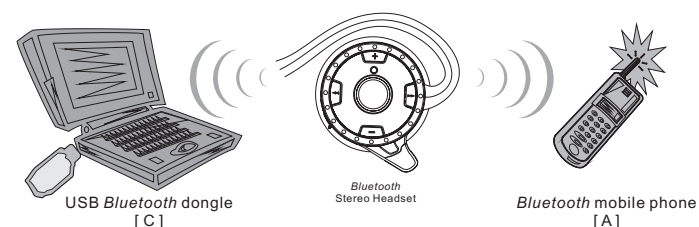

1. Pairing
 - a. Follow the Pairing process [C] to pair the Headset and the USB *Bluetooth* dongle.
 - b. After successful pairing, turn the Headset off.
 - c. Follow the pairing process [A] to pair the Headset and the *Bluetooth* mobile phone.
 - d. After successful pairing, please follow the PC *Bluetooth* application program instructions to re-establish the *Bluetooth* connection between the *Bluetooth* dongle and the Headset.
 - e. All three devices are in Standby Mode and the LED's should flash green.
2. Listening to music
 - a. Follow the Listen to music process [C] to enjoy the music.
3. Monitoring mobile phone calls
 - a. Follow the [Advance function] in [A] to monitor phone calls

11

VII. [A & D] Stereo Headset paired with Bluetooth enabled PDA and Bluetooth mobile phone Guide

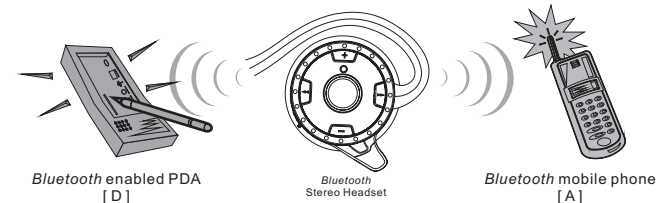

1. Pairing
 - a. Follow the Pairing process [D] to pair the Headset and the *Bluetooth* enabled PDA.
 - b. After successful pairing, turn the Headset off.
 - c. Follow the pairing process [A] to pair the Headset and the *Bluetooth* mobile phone.
 - d. After successful pairing, please follow the PDA *Bluetooth* application program instructions to re-establish *Bluetooth* connection between the PDA and the Headset.
 - e. All three devices are in Standby Mode and the LED's should flash green.
2. Listening to music
 - a. Follow the Listen to music process [D] to enjoy the music.
3. Monitoring mobile phone calls
 - a. Follow the [Advance function] in [A] to monitor phone calls.

Accessories Table	Description	Status
	A/C Switching Adaptor	Provided
	USB Charging cable	Optional

12

Federal Communication Commission Interference Statement

This equipment has been tested and found to comply with the limits for a Class B digital device, pursuant to Part 15 of the FCC Rules. These limits are designed to provide reasonable protection against harmful interference in a residential installation. This equipment generates, uses and can radiate radio frequency energy and, if not installed and used in accordance with the instructions, may cause harmful interference to radio communications. However, there is no guarantee that interference will not occur in a particular installation. If this equipment does cause harmful interference to radio or television reception, which can be determined by turning the equipment off and on, the user is encouraged to try to correct the interference by one of the following measures:

- Reorient or relocate the receiving antenna.
 - Increase the separation between the equipment and receiver.
 - Connect the equipment into an outlet on a circuit different from that to which the receiver is connected.
 - Consult the dealer or an experienced radio/TV technician for help.
- This device complies with Part 15 of the FCC Rules. Operation is subject to the following two conditions: (1) This device may not cause harmful interference, and (2) this device must accept any interference received, including interference that may cause undesired operation.

FCC Caution: Any changes or modifications not expressly approved by the party responsible for compliance could void the user's authority to operate this equipment.

IMPORTANT NOTE:

FCC Radiation Exposure Statement:

To maintain compliance with FCC RF exposure compliance requirements, please follow operation instruction as documented in this manual.

This transmitter must not be co-located or operating in conjunction with any other antenna or transmitter.

13

8