



# Bluetooth® Handsfree Car Kit with LCD Display CS8106(BT77AD)

## User Manual



### Table of Contents

1. BT77AD profile and its functions.....	3
1.1. Profile.....	3
2 How to set up the BT77AD.....	4
3. How to mount the BT77AD in the car.....	4
4. LCD Display status.....	6
4.1. On / Off and Pairing.....	6
4.2. Calling in.....	8
4.3. Calling out.....	9
4.4 On Line.....	10
4.5 Battery charging.....	12
5. Maintenance and Safe Use.....	14
6. Electrical.....	14
7. Package Contents.....	15
8. Federal Interference Statement.....	16

### 1.BT 77A profile and its functions 1.1. Profile(Fig.1)

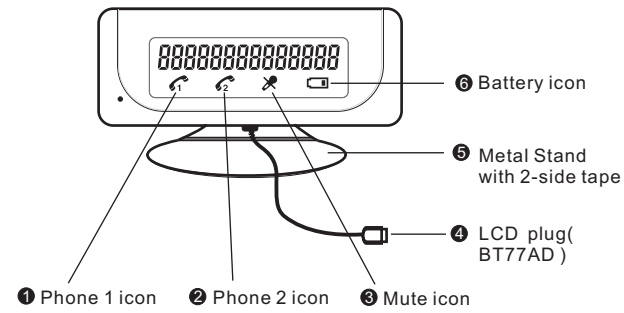

Fig. 1

The backlight will be on automatically for 10 seconds when there is an incoming call or when any key operations are performed directly from the car kit. Note that the backlight will not be turned on when key operations are performed from the mobile phones.

### 2 How to set up the BT 77AD Insert fully the LCD plug into the LCD socket of BT 77AD before the CarKit is turned on. (please refer to figure 2-3.)

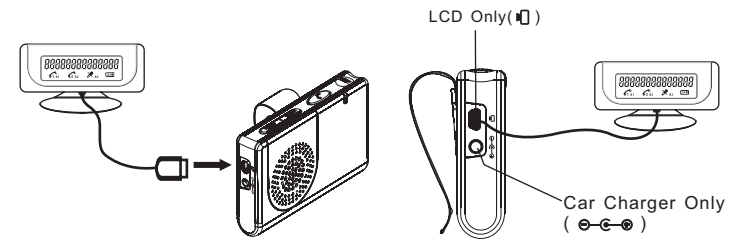
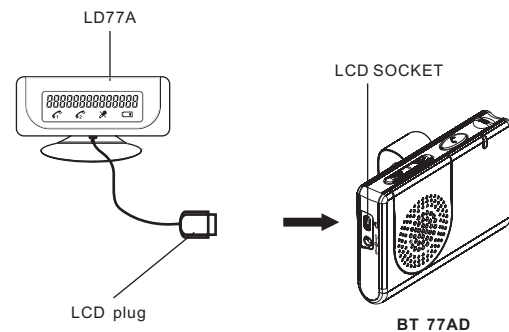

Fig. 2

Fig. 3

### 3.How to mount the BT77AD in the car

- Use the Alcohol Pad to clean the surface of a desired position on the top of the dashboard.
- Use the 2-side tape to attach the metal stand on the cleaned area.
- Put the BT77AD into an appropriate position(Refer to Fig.4)
- Slide the LCD to the metal stand.



Note: BT77AD is an optional feature .

Always avoid contact with humidity or heavy soiling. Any use other than the one described above will damage the product. Moreover, there is a danger, for example, short-circuits, fire, electric shock, etc. No part of the product must be modified or rebuilt and the housing must not be opened! Observe the safely instructions at all times!

All company names and product designations contained herein are trademarks of the respective owners. All rights reserved.

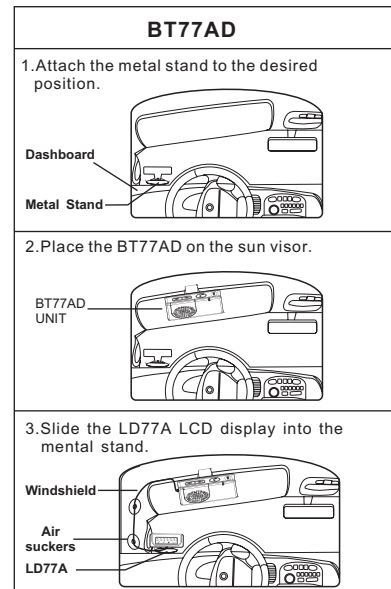

Fig. 4

### 4. LCD Display status When the LCD Display unit is properly connected to a Car Kit, it will provide you with the status of the Car Kit's operations. For detailed operations, please refer to the appropriate Car Kit user manuals.

#### 4.1. On / Off and Pairing

After the car kit has been powered on, it will stay on idle. Before it is connected to the mobile phone, the LCD screen displays "READY".	
When the Car Kit is in pairing mode, the LCD screen displays "PAIRING"	

While the car kit is connecting to the mobile phone, the LCD screen displays "CONNECTING".	
After the car kit has connected to the mobile phone successfully, the LCD screen displays "CONNECTED".	
If you press the ON / OFF key for about 5 seconds to turn off the car kit, the LCD screen displays "OFF" for a few seconds before it is completely off.	

#### 4.2. Calling in

When there is an incoming call, the LCD screen displays "RINGING", or its caller ID, if it is received.  Note: Some mobile phones may not display Caller ID via this LCD Display unit.	 Or Caller ID 
When the call is answered, the LCD screen displays "ON LINE".	
If the call is rejected, it will go back to idle state and the LCD screen displays "CONNECTED".	

4.3. Calling out

When there is an outgoing call from the mobile phone, the LCD screen displays "CALLING".	
When the call is made successfully, the LCD screen displays "ON LINE".	

9

4.4 On Line

When you are talking on line, the LCD screen displays "ON LINE".	
Whenever the Volume Up key or Volume Down key is pressed, the LCD screen displays "VOL" and the current volume setting for 2 seconds.	
If you mute the microphone, the mute icon will be turned on. And it stays on until you cancel it.	

10

When there is another call incoming while you are on line, the LCD screen will show "CALL WAITING" or its Caller ID, if it is received.	
Note: Some mobile phones may not display "CALL WAITING" or Caller ID via this LCD Display unit.	Or Caller ID 
When the call is ended, it will go back to the idle state. The LCD screen displays "CONNECTED".	

11

4.5 Battery charging

Battery Low: Battery icon appears.	
Recharging during Power On: Battery icon flashes.	
Fully Charged during Power On: Battery icon disappears.	

12

Recharging during Power Off: Battery icon flashes.	
Fully Charged during Power Off: Battery icon disappears.	

13

5. Maintenance and Safe Use

- ⊙ Use dry cloth to clean hands-free Car Kit!
- ⊙ Recycle the batteries after their life time!
- ⊙ Do not expose the Car Kit to liquid or moisture!
- ⊙ Do not expose the Car Kit to fire or open flames!

6. Electrical Power Specification of Car Charger / AC Power Adaptor for BT 77A

The electrical power specification of car charger / AC adaptor for BT 77A Bluetooth Car Kit is as follows:

Output: 5V 1.0A  
Output pin configuration:

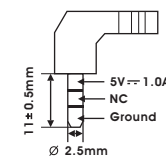

14

7. Package Contents

	Accessories	Status
	1 x Car Charger	Provided
	3 x AAA Rechargeable Batteries	Provided

Warning: Use only rechargeable batteries.

Disclaimer:

Talk time and stand-by time of the Bluetooth Car Kit will vary depending on mobile phone model being used.

Note:

BQB, CE and FCC approved

The Bluetooth word mark and logos are owned by the Bluetooth SIG, Inc. and any use of such marks by In-Tech Electronics Ltd. is under license. Other trademarks and trade names are those of their respective owners.

Bluetooth functions and operations may not be available or may vary depending on different mobile phones.

15

**Federal Communication Commission Interference Statement**

This equipment has been tested and found to comply with the limits for a Class B digital device, pursuant to Part 15 of the FCC Rules. These limits are designed to provide reasonable protection against harmful interference in a residential installation. This equipment generates, uses and can radiate radio frequency energy and, if not installed and used in accordance with the instructions, may cause harmful interference to radio communications. However, there is no guarantee that interference will not occur in a particular installation. If this equipment does cause harmful interference to radio or television reception, which can be determined by turning the equipment off and on, the user is encouraged to try to correct the interference by one of the following measures:

- Reorient or relocate the receiving antenna.
- Increase the separation between the equipment and receiver.
- Connect the equipment into an outlet on a circuit different from that to which the receiver is connected.
- Consult the dealer or an experienced radio/TV technician for help.

This device complies with Part 15 of the FCC Rules. Operation is subject to the following two conditions: (1) This device may not cause harmful interference, and (2) this device must accept any interference received, including interference that may cause undesired operation.

FCC Caution: Any changes or modifications not expressly approved by the party responsible for compliance could void the user's authority to operate this equipment.

16

IMPORTANT NOTE:

**FCC Radiation Exposure Statement:**

This equipment complies with FCC radiation exposure limits set forth for an uncontrolled environment. This equipment should be installed and operated with minimum distance 20cm between the radiator & your body.

This transmitter must not be co-located or operating in conjunction with any other antenna or transmitter.

17