

Bluetooth® Headset

BT 28VM



User Manual

Index

Headset pictures	2
Installation of battery	2
Turning on the Headset	2
Turning off the Headset	2
Putting Headset in Pairing Mode	3
Establishing Bluetooth Link	3
Answering incoming calls	4
Transferring calls	4
Muting the microphone	4
Ending calls	4
To make a new call using voice dialing	5
Redialing last dialed number	5
Rejecting incoming call	5
Adjusting speaker volume	5
Ear Hook orientation	6
Bend the ear hook to fit your ear	6
Putting way	7
Low-battery indication	7
Voice Over Internet Protocol (VOIP) Application	8
FCC Interference Statement	9
Declaration of Conformity	11

1

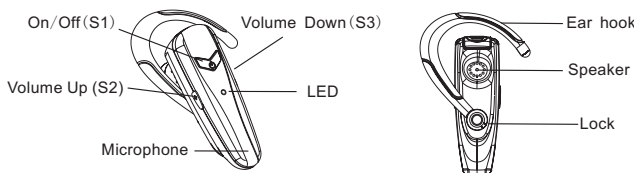

• Installation of battery

Thank you for buying new BT 28VM Bluetooth Headset.
Before use please open the battery door and install the battery (AAAx1) into the battery compartment according to the correct polarity. Close the battery door.

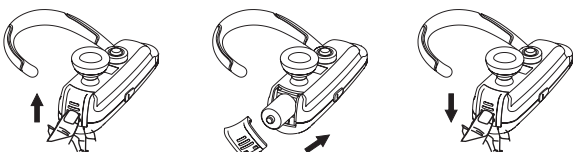

• Turning on the Headset

While the Headset (HS) is powered down, press and hold S1 for approx 10 seconds until you hear a low tone followed by a high tone. The orange LED will turn on for 1 second then flashes.

• Turning off the Headset

While the HS is powered up, press and hold S1 until you hear a high tone followed by a low tone indicating that the HS is powered down. And the LED will keep on Red until S1 is released.

2

• Putting Headset in Pairing Mode

Make sure the HS is fully powered before pairing starts. While the HS is powered off, press and hold S1 for 10 seconds. Red and Orange LED is flashing alternately indicating that the HS is in Pairing Mode.

Follow the operating instructions for your Bluetooth mobile phone to start the pairing process. Typically, this has to be done by going to a setup or connect menu and then selecting the options to discover Bluetooth devices. Bluetooth may take several seconds to establish a connection.

Your phone's display should indicate that it has found the "BT 28VM" headset and asks if you want to pair it. You should confirm this. The phone's display would prompt you for a passkey or PIN. Enter a sequence of "0000".

The headset LED will flash Orange every 3 seconds, indicating successful pairing. Usually the phone will also ask whether you want to change the headset's name. We recommend you should approve the BT 28VM name and not change it. You can pair as many headsets and devices as you wish in your mobile phone.

If pairing does not occur as expected. Turn the headset and phone off and wait for 10 seconds. Turn the headset and phone on again and repeat all steps from beginning.

• Establishing Bluetooth Link

After pairing, the mobile phone will show "connect", then please select "YES" to establish the link. Now you are ready to make and answer calls on the HS. For other phones, please follow the operation manual to establish the link.

3

• Answering Incoming Calls

When an incoming call is present, the HS will ring. Pressing S1 will answer the call. The orange LED will continue to flash quickly while the call is in session.

• Transferring Calls (For Nokia 3650 or equivalent models)

When you are in session, calls can be transferred from the Bluetooth phone to the HS and from the HS to the Bluetooth phone.

To transfer a call to or from the Bluetooth phone: double press S1, the call will be transferred to or from the Bluetooth phone, or follow the operating instructions of your phone.

• Muting the microphone

To mute the microphone during an active call

Pressing both S2 and S3 buttons simultaneously for about a second, the microphone will be muted. A periodic beep tone will be heard while the mute function is active.

To end the mute function

When the microphone is muted, press on both S2 and S3 buttons simultaneously will end the mute function and the periodic beep tone will stop.

• Ending Calls

While a call is in session on the Headset, pressing S1 will disconnect the call. After the call is disconnected, the orange LED will flash normally.

4

• To make a new call using voice dialing

When using a Bluetooth mobile phone:

1. Make sure the voice dialing function is probably set up in the Mobile phone and it is within the range of the HS. Press S1 on the HS shortly.
2. After the beep tone on the HS, make a voice dialing as you normally would by saying the name of the person on the HS. The call will be connected in a few seconds.

When using a mobile phone without Bluetooth built-in and requiring a Bluetooth dongle:

1. Make sure the voice dialing function is probably set up in the mobile phone and it is within the range of the HS. Press S1 on the HS shortly.
2. After the beep tone on the mobile phone, make a voice dial as you normally would and the call will be connected in a few seconds.

• Redialing last dialed number (Support handsfree profile mobile only. For Nokia 3650, Siemens S55, or equivalent models)

To redial the last dialed number, press and hold S3 for 2 seconds, a short low tones will indicate an attempt to redial.

• Rejecting incoming call (Support handsfree profile mobile only. For Nokia 3650, Siemens S55, or equivalent models)

When there is an incoming call and you want to reject it, press the buttons S1 and hold it until you hear a long beep tone, then release it.

• Adjusting Speaker Volume

While a call is in session, pressing and releasing S2 will increase the speaker volume; pressing and releasing S3 will decrease the speaker volume on the HS. There is a key tone to indicate volume increase or decrease. However, a warning tone will be heard when the volume level reaches its maximum or minimum.

5

• **Ear Hook orientation**

If you want to change the orientation of ear hook, please follow the following steps.

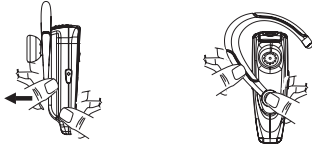

- 1) Detach the ear hook from the headset
- 2) Select the orientation you want (left or right), and attach the ear hook and lock it

• **Bend the ear hook to fit your ear**



6

• **Putting way**



1. Put on the headset with the ear hook behind your ear.
2. Bend the ear hook gently to fit your ear.

Notice: Make sure the microphone is pointing towards your mouth.

• **Low-battery indication**

The HS LED will flash red instead of orange when the battery is low. There will also be a short beep every few minutes. When the battery level is too low, the HS will automatically power off.

DISCLAIMER: Talk time and stand-by time of the BT 28VM *Bluetooth* Headset will vary depending on mobile phone model being used

7

**UB 22S USB *Bluetooth* Dongle and BT 28VM *Bluetooth* Headset
Voice Over Internet Protocol (VOIP) Application**

1. Plug the UB 22S USB *Bluetooth* Dongle (purchased separately) into the USB socket of a PC.
2. Install IVT BlueSoleil *Bluetooth* application from the CD-ROM provided in the UB 22S package. Note that the CD-ROM is not available in the BT 28VM package.
3. Download from the corresponding websites and install MSN messenger, Netmeeting, Yahoo messenger, or ICQ application software in the PC.
Pairing: Put the BT 28VM *Bluetooth* Headset into "pairing" mode by following the steps in the BT 28VM User Manual, start the BlueSoleil application and pair the UB 22S Dongle with the BT 28VM Headset. The Headset passkey is "0000".
4. Connecting and Disconnecting: The UB 22S Dongle will ring the BT 28VM Headset. Please press the S1 key on the headset to confirm the connection request. To disconnect the *Bluetooth* link, press the S1 key again. You can now pair and reconnect your BT 28VM Headset to your *Bluetooth* mobile phone, if you desire.
5. Testing the *Bluetooth* Link: After the UB 22S Dongle is paired with the BT 28VM Headset, the PC audio will be automatically routed to the "*Bluetooth* Audio" driver. Play some music on the PC by Windows Media Player or other music applications; you should be able to hear the music on the Headset. If you can't hear it, then go the "control Panel"-> "Sound and Audio Device Properties"-> "Audio"-> "Sound playback" select the "*Bluetooth* Audio" to activate the link.
6. Now you can start using the VOIP application and talk to your friend through your headset wirelessly and freely.

Connecting BT 28VM *Bluetooth* Headset back to your *Bluetooth* mobile phone. Please follow the steps from 'Putting Headset in Pairing Mode' to 'Establishing *Bluetooth* Link' on page 7.

8

Federal Communication Commission Interference Statement

This equipment has been tested and found to comply with the limits for a Class B digital device, pursuant to Part 15 of the FCC Rules. These limits are designed to provide reasonable protection against harmful interference in a residential installation. This equipment generates, uses and can radiate radio frequency energy and, if not installed and used in accordance with the instructions, may cause harmful interference to radio communications. However, there is no guarantee that interference will not occur in a particular installation. If this equipment does cause harmful interference to radio or television reception, which can be determined by turning the equipment off and on, the user is encouraged to try to correct the interference by one of the following measures:

- Reorient or relocate the receiving antenna.
- Increase the separation between the equipment and receiver.
- Connect the equipment into an outlet on a circuit different from that to which the receiver is connected.
- Consult the dealer or an experienced radio/TV technician for help.

This device complies with Part 15 of the FCC Rules. Operation is subject to the following two conditions: (1) This device may not cause harmful interference, and (2) this device must accept any interference received, including interference that may cause undesired operation.

FCC Caution: Any changes or modifications not expressly approved by the party responsible for compliance could void the user's authority to operate this equipment.

9

FCC Caution: Any changes or modifications not expressly approved by the party responsible for compliance could void the user's authority to operate this equipment.

**IMPORTANT NOTE:
FCC Radiation Exposure Statement:**

This equipment complies with FCC radiation exposure limits set forth for an uncontrolled environment. End users must follow the specific operating instructions for satisfying RF exposure compliance.

This transmitter must not be co-located or operating in conjunction with any other antenna or transmitter.

10

11