

# PLEASE! DO NOT RETURN THIS PRODUCT TO ANY RETAIL STORE!

For any questions or problems with this product please contact us at:

Email: [info@interactivetoy.com](mailto:info@interactivetoy.com)

Phone: Inside North America: 1-866-214-2220

Outside North America: +1-905-760-0971

Address: Interactive Toy Concepts

55 Administration Road Unit 6, Vaughan, Ontario, Canada L4K-4G9

Web site: [www.interactivetoy.com](http://www.interactivetoy.com)



AGE 8+



## INSTRUCTION MANUAL

Congratulations on the purchase of your Polaris RUSH RC Snowmobile.

This snowmobile is made for **INDOOR** or

**OUTDOOR** use – even on snow! For best performance, operate on flat packed snow or switch to the skis with wheels for great performance on carpet and other hard surfaces.

**PLEASE READ THIS INSTRUCTION MANUAL BEFORE OPERATING YOUR RADIO CONTROL SNOWMOBILE!**

### IMPORTANT SAFETY INFORMATION

The Polaris RUSH is a sophisticated model and should be treated as such. Improper use could cause damage to you, bystanders, and/or property. Please follow all safety precautions and assembly instructions listed in this manual. While the snowmobile is snow-resistant, it is not waterproof. Keep it out of wet snow, rain and away from puddles. Otherwise you may seriously damage your machine.

**Safety Notes:** Do not modify the snowmobile or radio; this will void your warranty • Test your snowmobile before every use and clean any packed snow out of the drive track area • The Polaris RUSH is designed to be used on packed, flat snow only. Do not attempt to use the sled in powder or on rough or broken snow as it may fall into ruts and holes or hit snow-boulders - damage to your sled may result. • Always use your sled in large open areas only. Do not operate your model near people, cars, buildings, trees or other obstructions. • Ensure the snowmobile and transmitter have fresh batteries before operating your model. • Always range-check your transmitter prior to every session.

### BATTERIES RECOMMENDED

For optimal performance, use only rechargeable batteries for the snowmobile and an alkaline battery for the transmitter. Do not use a rechargeable battery for the transmitter.

### FCC NOTE: U.S. ONLY

This device complies with Part 15 of the FCC Rules. Operation is subject to the following two conditions:

1) This device may not cause harmful interference.

2) This device must accept any interference received, including interference that may cause undesired operation.

**Warning:** Changes or modifications to this unit not expressly approved by the party responsible for compliance could void the user's authority to operate the equipment. The manufacturer is not responsible for any radio or TV interference caused by unauthorized modifications to this equipment. Such modifications could void the user's authority to operate the equipment. Note: This equipment has been tested and found to comply with the limits for a class B digital device, pursuant to Part 15 of the FCC Rules. These limits are designed to provide reasonable protection against harmful interference in a residential installation. This equipment generates, uses and can radiate radio frequency energy and, if not installed and used in accordance with the instructions, may cause harmful interference to radio communications. However, there is no guarantee that interference will not occur in a particular installation. If this equipment does cause harmful interference to radio or television reception, which can be determined by turning the equipment off and on, the user is encouraged to try and correct the interference by one or more of the following measures: • Reorient or relocate the receiving antenna • Increase the separation between the equipment and receiver • Connect the equipment into an outlet on a circuit different from that to which the receiver is connected • Consult the dealer or an experienced radio/TV technician for help.

### Industry Canada Notice: Canada only.

#### Industry Canada Notice

This device complies with Industry Canada licence-exempt RSS standard(s). 1. Operation is subject to the following two conditions: (1) this device may not cause interference, and (2) this device must accept any interference, including interference that may cause undesired operation of the device." 2. Changes or modifications not expressly approved by the party responsible for compliance could void the user's authority to operate the equipment.

#### Avis d'Industrie Canada

Le présent appareil est conforme aux CNR d'Industrie Canada applicables aux appareils radio exempts de licence. L'exploitation est autorisée aux deux conditions suivantes : (1) l'appareil ne doit pas produire de brouillage, et (2) l'utilisateur de l'appareil doit accepter tout brouillage radioélectrique subi, même si le brouillage est susceptible d'en compromettre le fonctionnement. Cet appareil numérique ne dépasse pas les Rèlements sur l'interférence radio par un appareil numérique de classe B stipulés dans les Rèlements sur l'interférence radio d'industrie Canada.

#### Limited 30-day warranty

Product is warranted by Interactive Toy Concepts Limited against manufacturing defects in material and workmanship under normal use for thirty (30) days from the date of purchase.

**Warranty is validated upon receipt of proof of purchase and confirmation of UPC code.**

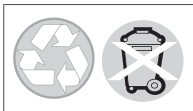

Polaris and its vehicle body designs and names are registered trademarks of Polaris Industries Inc. used under license. Polaris designs, engineers, manufactures and markets snowmobiles, all-terrain vehicles (ATVs), Victory motorcycles and the Polaris RANGER for recreational and utility use. Information about the complete line of Polaris products, apparel and vehicle accessories is available from authorized Polaris dealers or anytime from the Polaris homepage at [www.polarisindustries.com](http://www.polarisindustries.com). Products and colors may vary. MADE IN CHINA.

INS-42500-140415-US

### UNPACKING AND CONTENTS

To prevent damage during shipping the Polaris RUSH Snowmobile is securely fastened in the package. Remove and discard all fasteners from the snowmobile and packaging.

**REQUIRED BATTERIES:** The Polaris RUSH Snowmobile uses 7 AA batteries (not included).

Transmitter requires one 9 Volt Alkaline battery (not included).

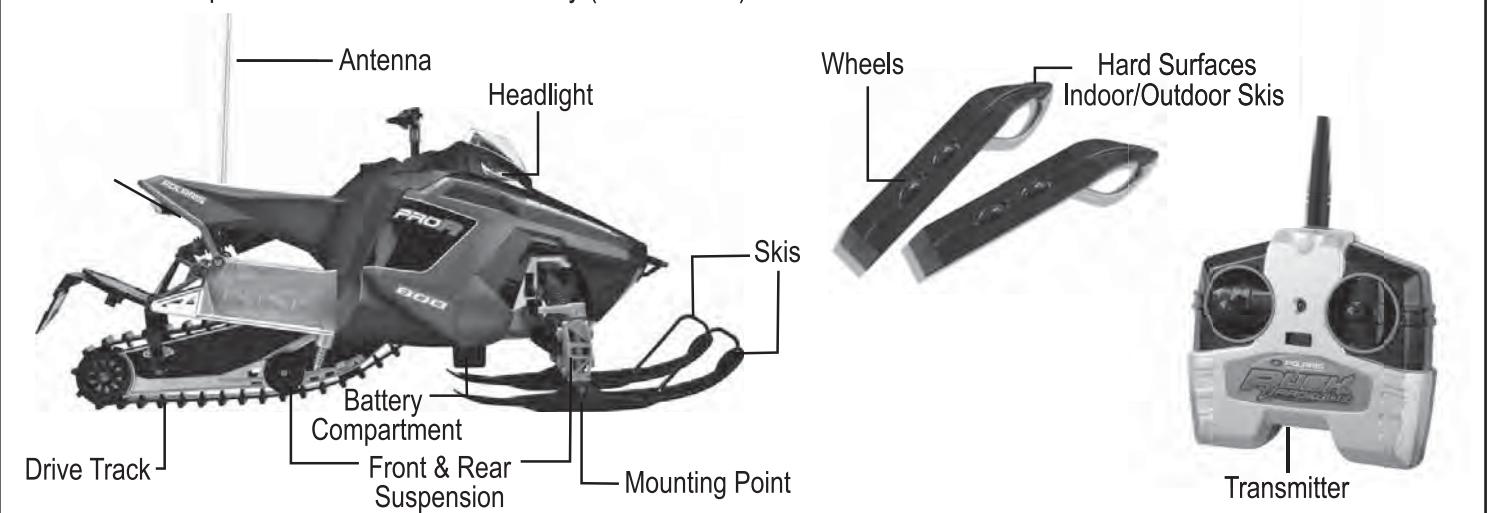

### IMPORTANT BATTERY INFORMATION

- Use only batteries recommended in the instruction manual.
- Battery installation should be performed by an adult.
- Be careful to install the batteries in the correct polarity as indicated.
- Do not mix old and new batteries.
- Do not mix alkaline, standard, lithium, rechargeable, or different types of batteries.
- Never leave the batteries unattended while they are being charged.
- Rechargeable batteries are only to be charged under adult supervision.
- Rechargeable batteries are to be removed from the toy before being charged.
- Non-rechargeable batteries are not to be recharged.
- Never allow the batteries to become hot during charging – this will cause permanent damage.
- Never recharge a warm or hot battery.
- Always allow the battery to cool to ambient temperature.
- Do not attempt to over-charge the battery by allowing it to charge for too long or performing more than one charge before using the battery.
- Battery should be replaced by adults.
- Do not throw batteries into the fire. Exhausted batteries are to be removed from the toy.
- The supply terminals are not to be short-circuited.



## BASIC ASSEMBLY

The Polaris RUSH RC Snowmobile is factory assembled.



Ensure that the correct skis are installed on the snowmobile for the surface you intend to run on. Note: Skis without wheels are for snow and skis with wheels are for hard surfaces indoors or outdoors.



The steering trim is located on the bottom of the snowmobile. The snowmobile should be able to drive in a straight line. If it tends to turn right then move the trim dial to the left; if it tends to turn left then move the trim dial to the right.

## CHANGING SKIS



1. Remove the snow ski by unscrewing the mounting screw using a Phillips head screwdriver.



2. Keep the detached snow skis in a safe place, and install the hard surfaces runner skis.



3. Replace the screw and tighten securely.

## SNOWMOBILE BATTERY INSTALLATION



1. Using a Phillips head screwdriver (not included) unscrew the two screws on the battery cover located under the snowmobile near the suspension.



2. Remove the battery holder and insert 7 AA batteries (not included). Be careful to install the batteries in the correct polarity as indicated in the battery holder.

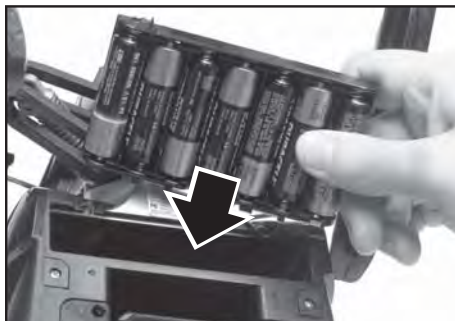

3. Insert the battery holder as shown into the battery compartment. Replace the battery compartment cover and tighten the two screws.

## TRANSMITTER BATTERY INSTALLATION

- Slide the battery compartment door on the back of the transmitter.
- Install one 9 Volt alkaline battery (not included), as shown, into the battery compartment.
- Replace the battery compartment door.
- Turn the transmitter ON to check and ensure the power LED illuminates.



## OPERATING INSTRUCTIONS

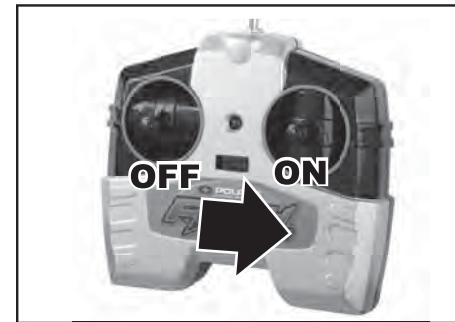

1. Turn the Radio Transmitter ON.

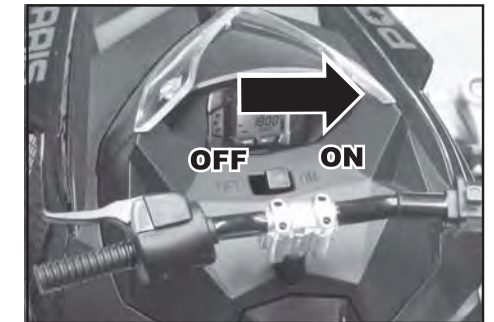

2. Turn the Polaris RUSH Snowmobile ON.

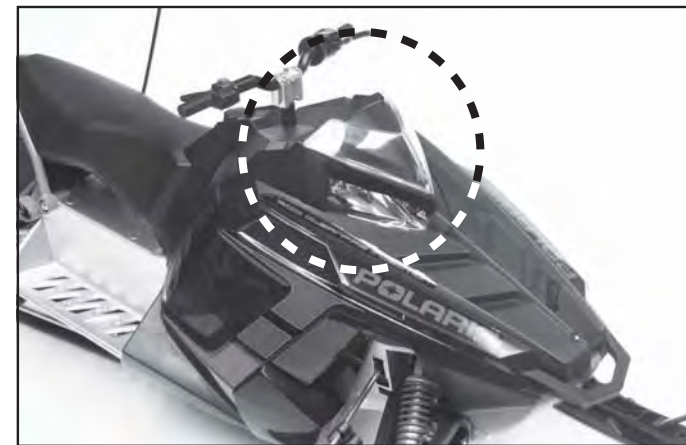

The headlight lights up when the Polaris RUSH Snowmobile is on.

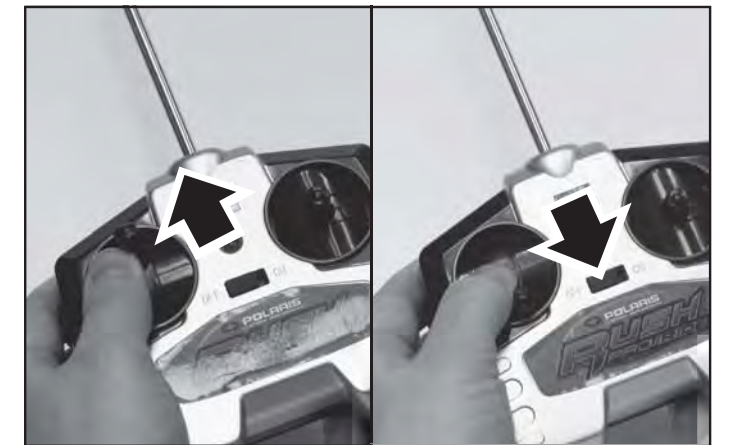

### Driving Forward /Backward

Move the throttle control (left stick) away from you to drive forward. Move the throttle control toward you to drive backward.

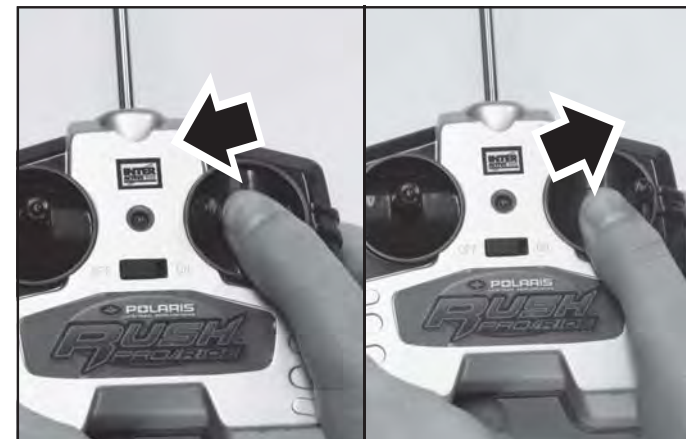

### Steering

To turn left, move the right control stick to the left. To turn right, move the right control stick to the right. NOTE: The snowmobile will only turn when it is moving forward or backward.



### Control Reversal

When the snowmobile is moving towards you, the controls react as if they are reversed. For example, to make the snowmobile move left requires you to steer right – just imagine that you are in the driver's seat!

### About the Built-in Overheat Protection Circuit

If you continuously play for over 10 minutes, the temperature of the snowmobile and batteries may increase. The protection will activate and the snowmobile stops running. Allow the snowmobile and batteries to cool down for 3 – 6 minutes to ambient temperature, then it can run again.