

Mazda J78 SERIES

Rear Seat Entertainment System

Owner's Manual



Contents

Welcome	3
Control Description – Monitor A.....	5
Control Description – Monitor B with DVD Player	6
Control Description	7
Remote Control Operation	8
General Operating Instructions.....	10
Playing a DVD	12
Playing a USB Device	13
Playing a SD Card.....	15
Playing a Data Disc.....	17
Screen Sharing.....	19
Charging a USB Device.....	19
Settings.....	20
Media Streaming	24
Miracast	24
Using the IP Remote.....	25
Multicast.....	25
Troubleshooting	26
Functional Verification.....	27
Compliance Information	28
Warranty	29

© 2015 INVISION Automotive Systems, Inc. All rights reserved.
This manual, or any portion thereof, may not be reproduced without the express written permission of INVISION Automotive Systems, Inc.

Design and specifications subject to change without notice.

Welcome

Thank you for purchasing this Rear Seat Entertainment System with built-in DVD player. Before operating this system, read this manual thoroughly and retain it for future reference.

Important Notice

It is unlawful in most jurisdictions for a person to drive a motor vehicle which is equipped with a television viewer or screen that is located in the motor vehicle at any point forward of the back of the driver's seat, or that is visible, directly or indirectly, to the driver while operating the vehicle. In the interest of safety, the monitors should never be installed where they will be visible, directly or indirectly, by the operator of the motor vehicle. If your vehicle is equipped with a wireless rear seat audio system or any other wireless infrared device, make sure it is powered off when operating the Rear Seat Entertainment System. If both systems are powered on at the same time, the two systems may obstruct each other, possibly creating undesirable audio interference through the wireless headphones.

Safety Precaution

For safety reasons, when changing video discs it is recommended that the vehicle is not in motion, and that you do not allow children to unfasten safety belts to change discs or make any adjustments to the system. System adjustments can be accomplished using the remote control unit, while safety belts remain fastened. Enjoy your entertainment system but remember that safety of all passengers remains the number one priority.

Caution:

Be sure to run the vehicle engine while using the system. Using this system without running the engine can result in battery drain. Please remember to turn off the system when the vehicle is not in use to avoid the risk of the battery draining.

Product Features

Monitor A

- 8-inch Color TFT-LCD Panel (1024x600) with 16:9 aspect ratio
- Infrared Transmitter for IR Wireless Headphones
- USB 2.0 Input with Charging Capability*
- SD Card Input
- MHL 2.0 with HDMI 1.4
- 3.5mm Stereo Headphone Output
- Remote Sensor on the Front Panel
- 11 Function Remote Control
- 2 Control Buttons on the Top Panel: Power and Wi-Fi
- OSD (On Screen Display)
- IP remote control capability
- Miracast/Multicast wireless display capability
- Media streaming
- Monitor screen sharing

Monitor B

- 8-inch Color TFT-LCD Panel (1024x600) with 16:9 aspect ratio
- Built-in Top-Loading DVD Player
- Infrared Transmitter for IR Wireless Headphones
- USB 2.0 Input with Charging Capability*
- SD Card Input
- MHL 2.0 with HDMI 1.4
- 3.5mm Stereo Headphone Output
- Remote Sensor on the Front Panel
- 11 Function Remote Control
- 2 Control Buttons on the Top Panel: Power and Eject
- OSD (On Screen Display)
- IP remote control capability
- Monitor screen sharing

* **Note:** Depending on the USB device, it may or may not charge when connected to the USB port. Not all devices are able to charge when connected to the USB port. Refer to the documentation that came with your USB device for more information.

Wireless Headphones

Each monitor includes a built-in dual channel infrared transmitter for use with wireless headphones. The wireless headphones must be used within a line of sight from the transmitter as infrared transmission, like visible light, travels only in a straight line.

How to use the Wireless Headphones

When placing the headphones on your head, make sure to observe the Left and Right orientation. The headphones must be oriented correctly (facing forward) in order to receive the audio signal. Press the power button on the headphones, then select channel "A" to listen to monitor A, or channel "B" listen to monitor B. Adjust the audio level using the volume control on each headphone.

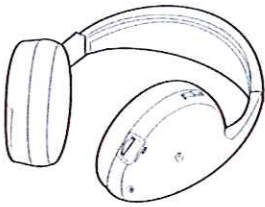

Wired Headphones

There is a 3.5mm stereo headphone output jack on each monitor which can be used with any standard stereo headphones. Headphones with inline volume control can be used to adjust the monitor volume level.*

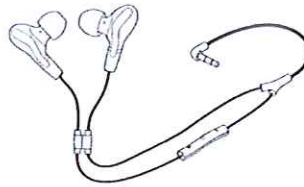

*Note: Some headphone brands that include inline volume control may not be compatible with the monitors.

Control Description – Monitor A

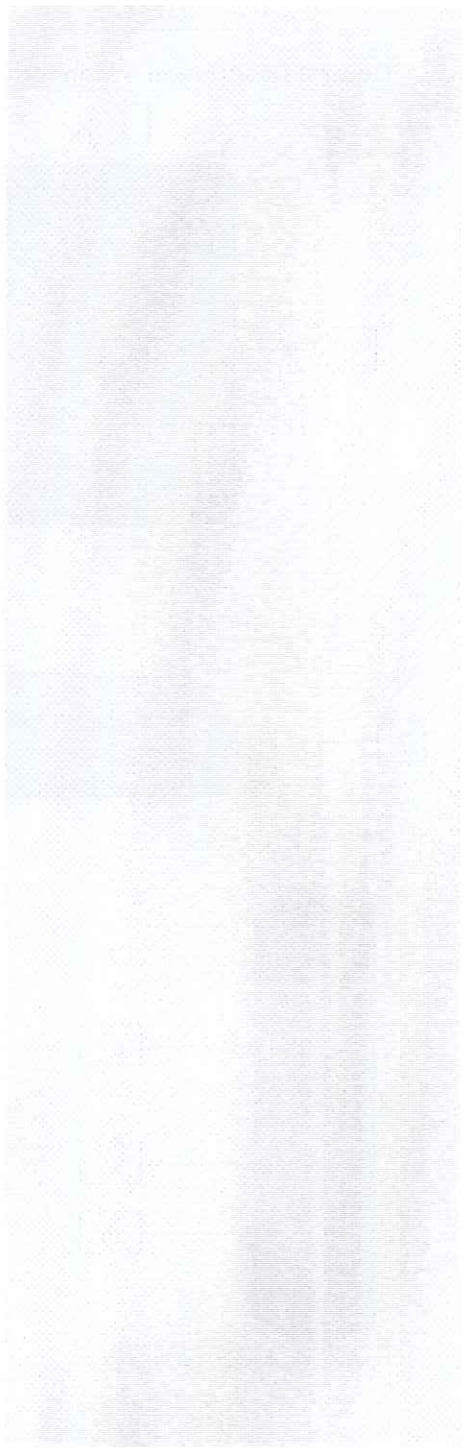
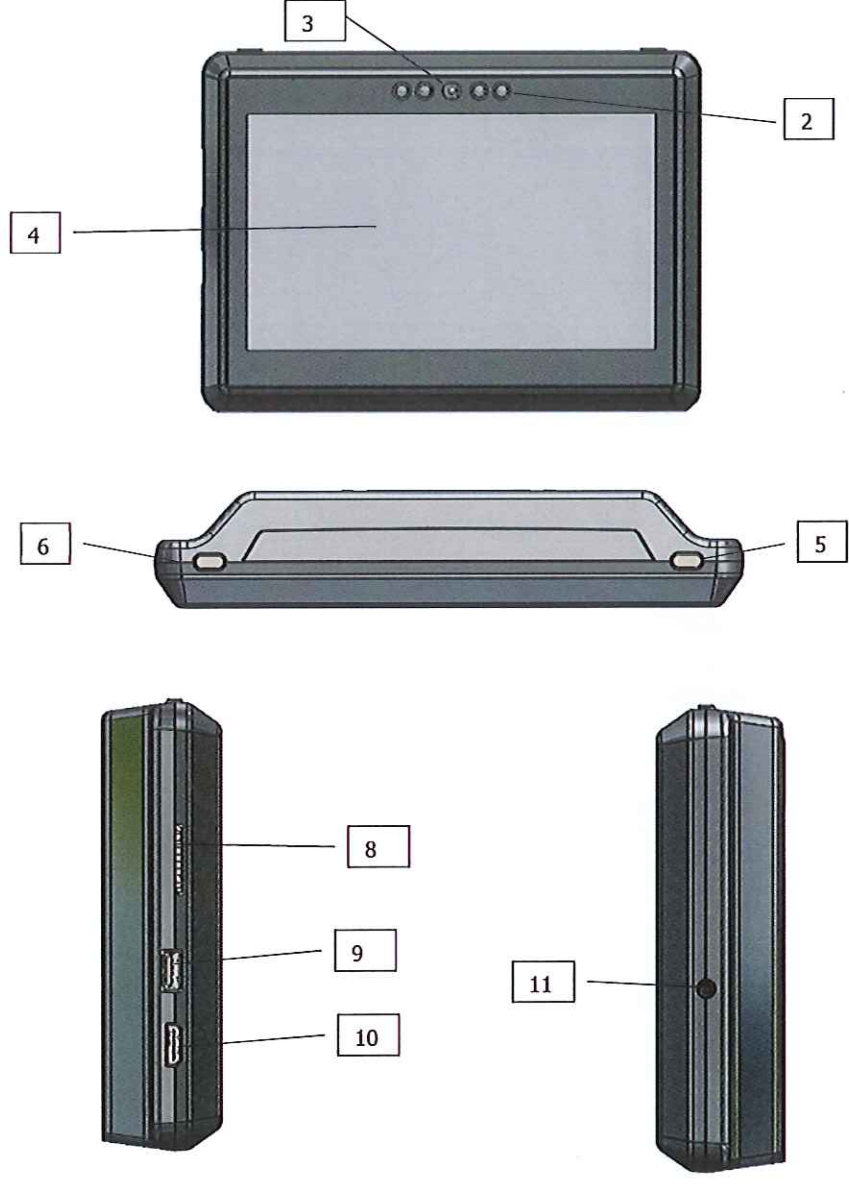

Control Description – Monitor B with DVD Player

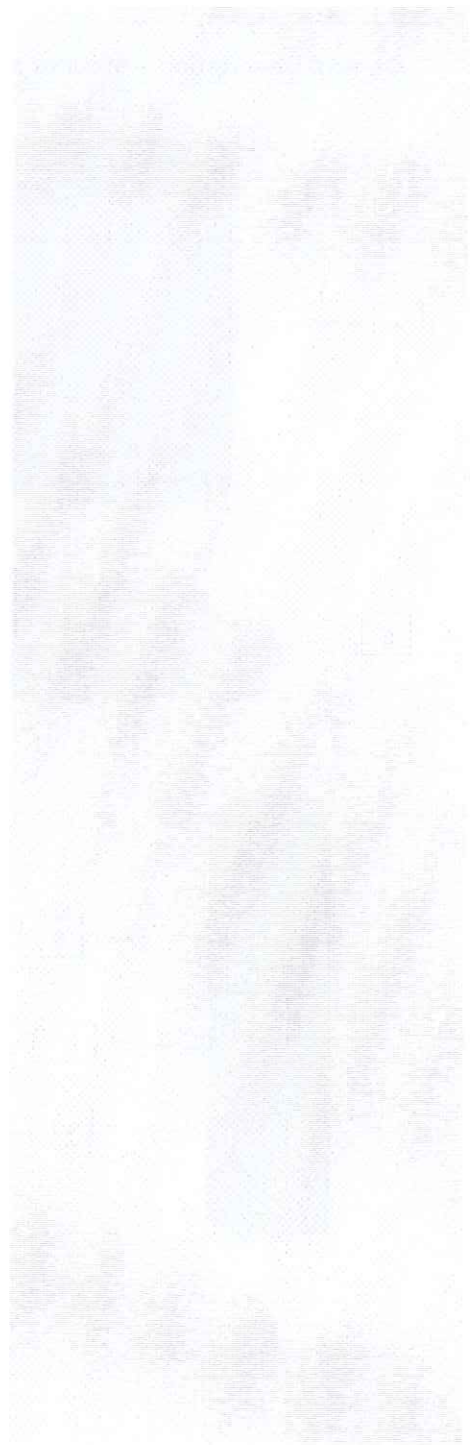
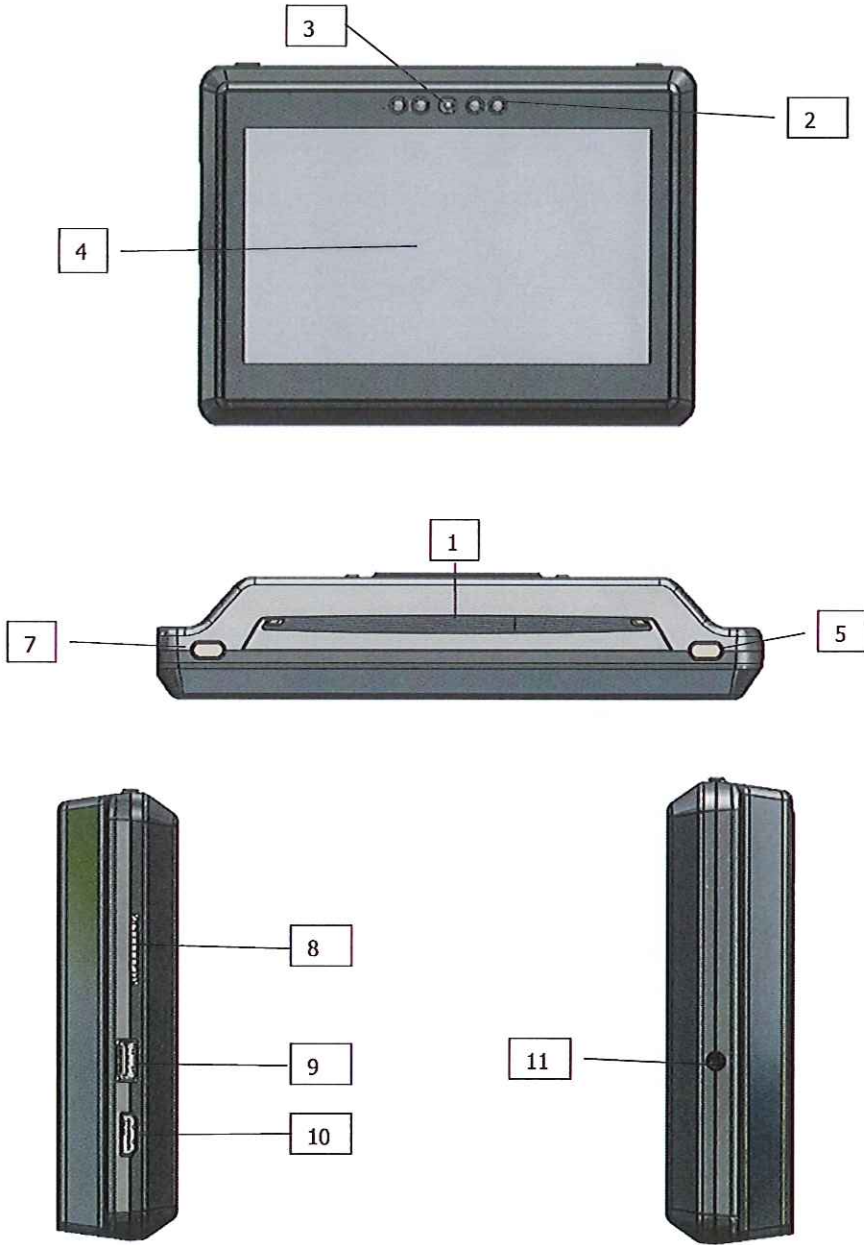

Control Description

1. **Disc Compartment Slot (Monitor B)**
2. **Infrared Transmitters** These transmit audio to the wireless headphones.
3. **IR Sensor** Allows the remote control to operate the monitor.
4. **TFT LCD Panel** 8-inch TFT LCD Panel
5. **POWER Button** Press this button to turn the monitor on or off.
6. **WI-FI** Press this button to toggle WI-FI On/Off
7. **EJECT Button (Monitor A)** Press this button to eject the disc.
8. **SD Card Input** You can play music, images and videos stored on most SD cards.
9. **USB Port** You can play music, images, and videos stored on most USB devices.
10. **MHL 2.0 with HDMI Input** Connect an external audio/video source using a HDMI connector (sold separately).
11. **Headphone Output Jack** Connect wired headphones using a 3.5mm stereo connector.

Warnings

- Do not use any harsh solvents or chemicals when cleaning the unit.
- Do not use any abrasive cleaners that may scratch the screen. Use only a lightly dampened lint free cloth to wipe the screen if it is dirty.
- Do not put pressure on the screen.
- Caution children to avoid touching or scratching the screen, as it may become dirty or damaged.

Remote Control Operation

Installing the Batteries

Before attempting to operate your remote control, install the batteries as described below.

1. Turn the remote control face down. Using a coin, turn the battery cover slightly counterclockwise
2. Install one "CR2032" battery as shown. Make sure that proper polarity (+ or -) is observed.
3. Place the cover back and turn it clockwise until it locks into place.

The remote control will only operate this device. It is not a universal remote control and will not control other equipment.

Warning/Caution on using batteries

- Always ensure that the battery is inserted with the positive and negative terminals in the correct direction as shown in the battery compartment.
- When batteries fail to function, replace them immediately.
- Keep the batteries out of the reach of children. Should the batteries be swallowed, immediately consult a doctor. Also, when disposing of used batteries, please comply with governmental regulations or environmental public institution rules that apply in your country/area.
- Remove the batteries if the remote control is not used for a month or longer.

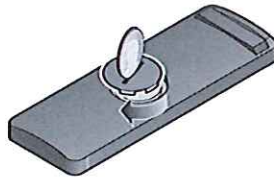
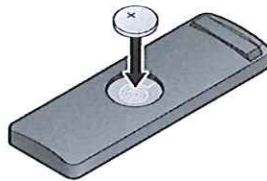
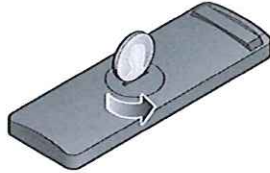

Button Function Descriptions

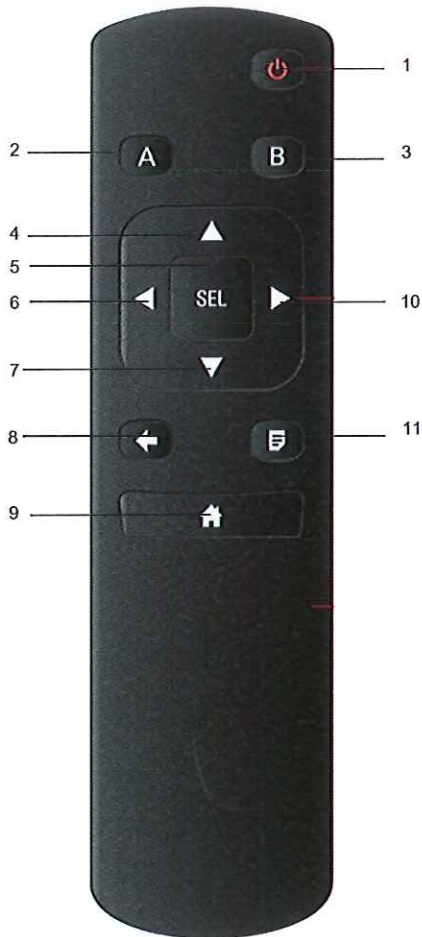

1. **POWER** Press this button to turn the monitor on. Press this button again to turn the monitor off.
2. **A** Press this button to transmit the remote control codes and functions for monitor A.
3. **B** Press this button to transmit the remote control codes and functions for monitor B.
4. **UP** Press this button to navigate up when displaying a menu or file list.
5. **SELECT** Press this button to make a selection or begin playback of the media.
6. **LEFT** Press this button to navigate left when displaying a menu or file list.
7. **DOWN** Press this button to navigate down when displaying a menu or file list.
8. **HOME** Press this button to return to the home screen.
9. **BACK** Press this button to go back to the previous screen.
10. **RIGHT** Press this button to navigate right when displaying a menu or file list.
11. **MENU** Press the button to go to the root menu included on the disc.

General Operating Instructions

Turning the monitor ON or OFF

1. If necessary, pivot the screen downward until a comfortable viewing angle is reached.
2. Press the POWER button on the top panel or the remote control to turn the monitor on or off. When powered on, the top panel buttons will illuminate.
3. After the monitor has been turned on and is displaying a picture, adjust the viewing angle by pivoting the screen to optimize the picture quality.
4. Remember to turn the monitor off when not in use.

DVD - Basic Overview

To get the most use out of each DVD, make sure you read this section completely.

Regional Coding

Both the DVD player and discs are coded by region. These regional codes must match in order for the disc to play. The system is preset to the region code designated for your area by the DVD Copy Control Association. Other regions may not be played in this system.

Type of Discs your monitor will play:

DVD-Video: DVD contains video.

DVD +/- R: DVD contains video.

CD-DA: CD contains audio.

Loading and Playing Discs

Before you load a disc, make sure that it is compatible with the player. Note that the following discs **CANNOT** be used with this system: Optical disc- CD-1, CD-ROM, and DVD-ROM Mini disc- CDG (audio only, not graphics) (List is not all inclusive).

To Load and Play a Disc

Press the **POWER** button on monitor B to turn the system on. Place the disc about halfway into the disc compartment slot, with the disc's label facing the rear of the vehicle. Do NOT insert the disc at an angle. The disc must be inserted straight into the player. Select DVD on monitor B. To mirror DVD content see the section titled "Screen Sharing"

Some discs may start at the root menu, where playback must be selected to start a movie. Depending on the disc and playback location on the disc, the icon may be displayed in the upper-left corner of the screen indicating that playback is not possible during certain times.

Notes on Discs

- To keep a disc clean, do not touch its surface. Handle the disc by its edge.
- Keep your discs in their cases or sleeves when not in use. Also, do not subject disc to heat/high temperature. Avoid leaving them in a parked vehicle or on a dashboard/rear tray.
- Do not attach labels, or use discs with sticky ink/residue. Such discs may stop spinning when used, causing a malfunction, or may ruin the disc.

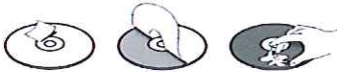

- Do not use any discs with labels or stickers attached. The following malfunctions may result from using such discs:
 - Inability to eject a disc (due to a label or sticker peeling off and jamming the disc mechanism).
 - Inability to read audio data correctly (i.e., playback skipping, or no playback) due to heat shrinking of a sticker or label causing a disc to warp.
- Before playing, clean the discs with a commercially available cleaning cloth. Wipe each disc from the center out. Do not use solvents such as benzene, thinner, commercially available cleaners, or antistatic spray intended for analog discs.



- Use only normal, circular discs. If you insert irregular, non-round, shaped discs they may jam in the DVD player or not play properly.

Notes on Media Compatibility

This system is compatible with the following media formats:

	Format	Extension
Audio	MP3	.mp3
	WMA	.wma
Video	AVI	.avi
	FLV	.flv
	MPEG-1	.mpg
	MPEG-2	.mpg
Image	MPEG-4	.mp4
	JPEG	.jpg
	BMP	.bmp
	PNG	.png[cw1]

Due to ongoing technological advancements, some USB flash drives and SD cards may be incompatible with this system.

- The text information of some audio and video files may not be correctly displayed.
- There may be a slight delay before playback of files using an SD card or USB flash drive with complex folder hierarchies.
- Some audio, video, and image files may be incompatible with this system due to file characteristics, file format, recording software used, directory structure, and/or the type of audio/video encoding used.

Playing a DVD

Insert a disc into the unit with label facing the rear of vehicle and select DISC mode from the source menu using the front panel controls or the remote control.

OSD Menu

Pressing the **SEL** on the remote will bring up the On Screen Display (OSD) menu. The OSD menu can be used to access the following functions: Play/Pause, Fast Rewind, Fast Forward, Previous, Next, Stop, Repeat Once/Repeat All, Root Menu, Audio, Subtitle.

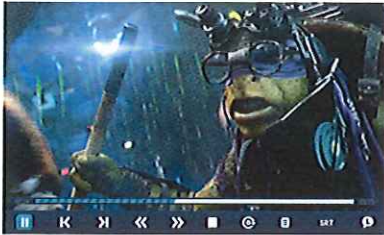

Root Menu

When loading a DVD, the monitor will bring up the root menu (if DVD has root menu) where the DVD functions can be found, Play, Select Scene, etc. Pressing **BACK** on the remote while watching a DVD will bring the user back to the root menu (if DVD has root menu). Pressing **BACK** on the remote at the root menu will bring the user back to the home page.

Skipping Tracks

Select the **NEXT** icon on the **OSD Menu** to select to the next track. Select the **PREV** icon one time to select the beginning of the current track. Select the **PREV** icon twice to select the previous track.

Repeat Modes

The default mode for the repeat function is repeat entire disc. Press the **REPEAT** icon on the remote control to select between the following options:



[cw2]

Repeat the current track.



Repeat the entire disc.

Repeat off (no icon is displayed).

As you press **REPEAT** icon, the repeat option changes. The selected repeat option remains in effect until you turn it off.

Playing a USB Device

Insert a USB device into the left side of the unit with bottom of the device facing the rear of the vehicle and select the **USB** icon from the home page using the remote control.

Using the ◀▶ buttons on the remote, scroll through to select the file type desired.



Movie Files

Select a movie file by using the ▲▼◀▶ buttons on the remote to locate the desired file. Press **SEL** on the remote to play the video file.



OSD Menu

Pressing the **SEL** on the remote will bring up the On Screen Display (OSD) menu. The OSD menu can be used to access the following functions: Play/Pause, Fast Rewind, Fast Forward, Previous, Next, Stop, Repeat Once/Repeat All



Skipping Tracks

Select the **NEXT** icon on the **OSD Menu** to select to the next track. Select the **PREV** icon one time to select the beginning of the current track. Select the **PREV** icon twice to select the previous track.

Repeat Modes

The default mode for the repeat function is repeat entire disc. Press the **REPEAT** icon on the remote control to select between the following options:



[cw3]

Repeat the current track.



Repeat the entire disc.

Repeat off (no icon is displayed).

As you press **REPEAT** icon, the repeat option changes. The selected repeat option remains in effect until you turn it off.

Audio Files

Select an audio file by using the ▲▼◀▶ buttons on the remote to locate the desired file. Press SEL on the remote to play the audio file.



OSD Menu[cw4]

Pressing the SEL on the remote will bring up the On Screen Display (OSD) menu. The OSD menu can be used to access the following functions: Play/Pause, Previous, Next, Stop, Repeat Once/Repeat All, Audio

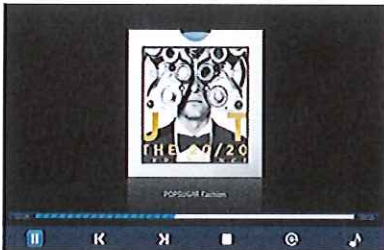

Photos

Select a photo by using the ▲▼◀▶ buttons on the remote to locate the desired file. Press SEL on the remote to select the photo. If there is more than one photo on the device, the unit will play the files in a slideshow. To stop on a certain photo, press the OSD button on the remote and select the pause icon.



OSD Menu[cw5]

Pressing the SEL on the remote will bring up the On Screen Display (OSD) menu. The OSD menu can be used to access the following functions: Play/Pause, Previous, Next, Rotate Counterclockwise 90°, Rotate Clockwise 90°, Zoom In, Zoom Out.



Playing a SD Card

Insert a SD card into the left side of the unit with bottom of the device facing the rear of the vehicle and select the **SD** icon from the home page using the remote control.

Using the ◀▶ buttons on the remote, scroll through to select the file type desired.



Movie Files

Select a movie file by using the ▲▼◀▶ buttons on the remote to locate the desired file. Press **SEL** on the remote to play the video file.



OSD Menu

Pressing the **SEL** on the remote will bring up the On Screen Display (OSD) menu. The OSD menu can be used to access the following functions: Play/Pause, Fast Rewind, Fast Forward, Previous, Next, Stop, Repeat Once/Repeat All

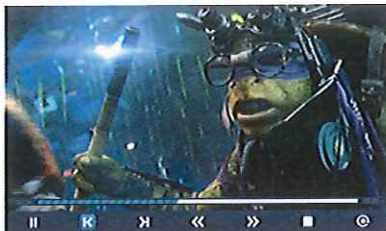

Skipping Tracks

Select the **NEXT** icon on the **OSD Menu** to select to the next track. Select the **PREV** icon one time to select the beginning of the current track. Select the **PREV** icon twice to select the previous track.

Repeat Modes

The default mode for the repeat function is repeat entire disc. Press the **REPEAT** icon on the remote control to select between the following options:



[cw6]

Repeat the current track.



Repeat the entire disc.

Repeat off (no icon is displayed).

As you press **REPEAT** icon, the repeat option changes. The selected repeat option remains in effect until you turn it off.

Audio Files

Select an audio file by using the ▲▼◀▶ buttons on the remote to locate the desired file. Press SEL on the remote to play the audio file.



OSD Menu[cw7]

Pressing the SEL on the remote will bring up the On Screen Display (OSD) menu. The OSD menu can be used to access the following functions: Play/Pause, Previous, Next, Stop, Repeat Once/Repeat All, Audio

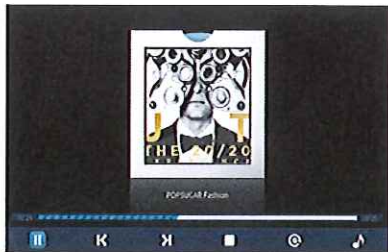

Photos

Select a photo by using the ▲▼◀▶ buttons on the remote to locate the desired file. Press SEL on the remote to select the photo. If there is more than one photo on the device, the unit will play the files in a slideshow. To stop on a certain photo, press the OSD button on the remote and select the pause icon.



OSD Menu[cw8]

Pressing the SEL on the remote will bring up the On Screen Display (OSD) menu. The OSD menu can be used to access the following functions: Play/Pause, Previous, Next, Rotate Counterclockwise 90°, Rotate Clockwise 90°, Zoom In, Zoom Out.



Playing a Data Disc

Insert a disc into the unit with label facing the rear of vehicle and select the **DVD** icon from the home page using the remote control.

Using the ◀▶ buttons on the remote, scroll through to select the file type desired.



Movie Files

Select a movie file by using the ▲▼◀▶ buttons on the remote to locate the desired file. Press **SEL** on the remote to play the video file.



OSD Menu

Pressing the **SEL** on the remote will bring up the On Screen Display (OSD) menu. The OSD menu can be used to access the following functions: Play/Pause, Fast Rewind, Fast Forward, Previous, Next, Stop, Previous, Repeat Once/Repeat All, Root Menu, Audio, Subtitle.



Skipping Tracks

Select the **NEXT** icon on the **OSD Menu** to select to the next track. Select the **PREV** icon one time to select the beginning of the current track. Select the **PREV** icon twice to select the previous track.

Repeat Modes

The default mode for the repeat function is repeat entire disc. Press the **REPEAT** icon on the remote control to select between the following options:



Repeat the current track.



Repeat the entire disc.

Repeat off (no icon is displayed).

As you press **REPEAT** icon, the repeat option changes. The selected repeat option remains in effect until you turn it off.

Audio Files

Select an audio file by using the ▲▼◀▶ buttons on the remote to locate the desired file. Press SEL on the remote to play the audio file.



OSD Menu

Pressing the SEL on the remote will bring up the On Screen Display (OSD) menu. The OSD menu can be used to access the following functions: Play/Pause, Previous, Next, Stop, Repeat Once/Repeat All, Audio

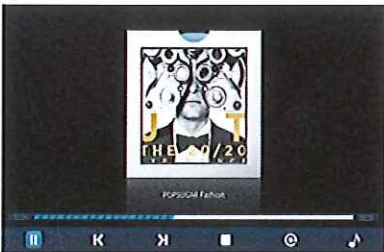

Photos

Select a photo by using the ▲▼◀▶ buttons on the remote to locate the desired file. Press SEL on the remote to select the photo. If there is more than one photo on the device, the unit will play the files in a slideshow. To stop on a certain photo, press the OSD button on the remote and select the pause icon.



OSD Menu

Pressing the SEL on the remote will bring up the On Screen Display (OSD) menu. The OSD menu can be used to access the following functions: Play/Pause, Previous, Next, Rotate Counterclockwise 90°, Rotate Clockwise 90°, Zoom In, Zoom Out.



Screen Sharing



To access screen sharing and view the contents of a second monitor, scroll through the icon wheel and select the **Monitor** icon. If screen sharing is available the **Monitor** icon will be visible, if it is not available the icon will become grey and not selectable as it will be skipped over while scrolling through the icons. Selecting the screen sharing icon on monitor A will display the contents of monitor B and vice versa. Note that both monitors cannot be screen sharing at the same time. To exit from screen sharing, select the monitor that is displaying shared content and press the back button on the remote

Connecting an External A/V Source MHL 2.0 with HDMI

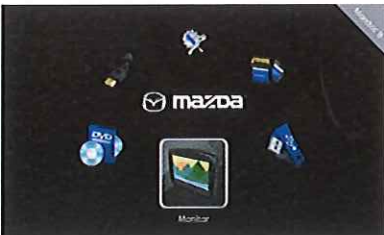

Using an HDMI cable, connect an external A/V source by using the MHL 2.0 port on the left side of the monitor. Select the **HDMI** icon from the home page to view the external source.

Charging a USB Device

Plug the USB cable (not supplied) into the USB port on the left side of the monitor and then connect the other end to the USB device.

Note: Depending on the device, it may or may not charge when connected to the USB port. Not all devices are able to charge when connected to the USB port.

Refer to the documentation that came with your USB device for more information.

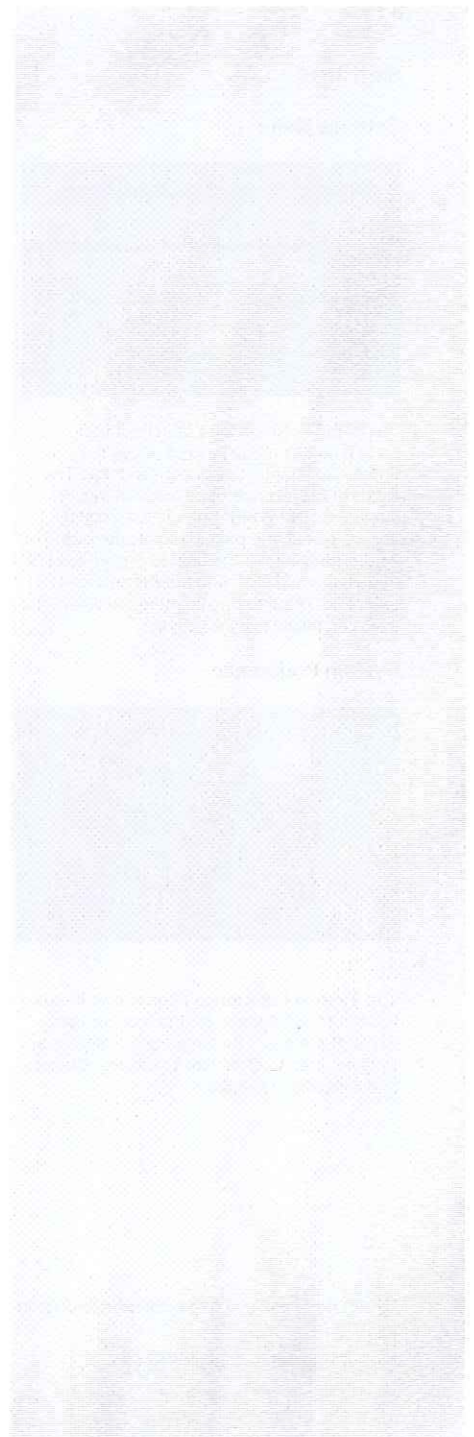

Settings

Settings Menu



Select the **Settings** icon from the home screen. In this menu several pages may be entered to change the system settings. The **System Preference** page is for changing language. The **Wi-Fi*** page is for creating access points and pairing mobile devices. The **Audio** page allows the user to enable the FM transmitter and selecting the **Picture** icon enters the picture adjustment menu where the user can adjust picture settings.

System Preference



The **System Preference** page allows the user to select the language for the monitor using the ▲ ▼ buttons. The languages available are English, French, Spanish, Traditional Chinese, and Simplified Chinese.

Picture



Selecting the **Picture** icon displays the picture settings page where the user can select from **Adjustment**, **Backlight**, **Color Mode**, and **Reset**. The three picture settings menus allow the user to adjust the monitor picture while the **Reset** icon puts all settings back to the original factory presets.

***Note:** Wi-Fi settings page is available only on monitor A

MazdaJ78_manual_rough_draft_V1.7.docx