

Uniden®



WDVR42HDD Quick Start Guide

Uniden surveillance products are not manufactured and/or sold with the intent to be used for illegal purposes. Uniden expects consumer's use of these products to be in compliance with all local, state and federal law. For further information on video surveillance and audio recording legal requirements, consult your local, state and federal law.

This Quick Start Guide provides basic instructions on setting up and connecting your Uniden WDVR. Refer to the Uniden WDVR Detailed Owner's Manual at www.uniden.com for details.

IN THE BOX

Digital Wireless Outdoor Camera (2)	Digital Wireless Receiver Console (1)	Camera/Receiver Antenna (3)	Camera Stand (2)
SCREW PACKS For Cameras (2) Bracket Screws (1)	Camera Power Adapter - 5V/1A (2) WDVR Power Adapter - 12V/3A (1)	1 TB HDD (1)	Ethernet Cable (1)
HDMI Cable (1)	Quick Start Guide (1)		

If any items are missing or damaged, contact our Customer Care Line immediately at 1-800-658-8068.
Never use damaged products!

CONNECT WIRELESS DVR TO ETHERNET (TV OR MONITOR OPTIONAL)

1. Connect antenna to the back of WDVR.
2. Connect Ethernet cable from WDVR to router.
3. Connect HDMI cable from WDVR to TV/Monitor HDMI connector (optional).
4. Connect WDVR to power source.
5. Turn on TV/Monitor and switch to proper HDMI in/out source (if applicable).
6. Turn on WDVR.
7. Attach antennas to cameras and connect to power.

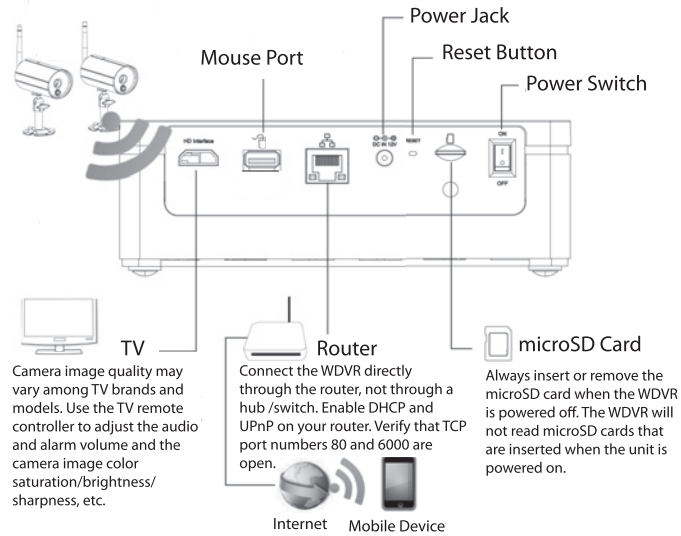

REMOTE SURVEILLANCE SETUP

1.	Download Uniden WDVR app from Apple App Store. Launch the app.	
2.	Tap to add your WDVR. The Device List screen displays.	
3.	Tap in the upper right corner of the screen. The Device Setup screen displays.	
4.	Enter a name for your system. Tap <i>Scan QR</i> . Scan the QR code on the bottom of the WDVR.	
5.	Enter the default password (123456) and tap <i>Save</i> . The Device List displays again with your WDVR listed.	

6	Select your device. Connection screen displays.	
7	Press and Live video displays. It may take a few seconds to access the remote video depending on your network environment.	

WDVR allows a maximum of 3 remote viewers on the system. The fourth connection will be rejected. When a local user is operating in the Setup menu, remote users will be temporarily denied WDVR access until the local user leaves the Setup menu.

WDVR requires a minimum 1.5Mbps connection bandwidth per connection for best streaming viewing quality. If bandwidth is below 1.5Mbps, set camera resolution and quality to Low to improve streaming remote image quality.

LIVE SCREEN ICONS

When live video displays, an icon bar displays across the bottom of the app screen.



ICON	WHAT IT IS	WHAT IT DOES
	Device List	Displays a list of devices on this app.
	Tools	Sets up the camera, recorder, system, and storage.
	Enable Push Notification	When enabled, this will send you an email notification when the system detects motion.
	Storage	Access recorded files on your storage device(s).
	Record	Begins recording. If already recording, then "X" displays. Tap this to stop recording.
	Play	Plays recorded files. If already playing, then "X" displays. Tap "X" to stop playing..
	Snapshot	Takes a snapshot of your video image.

BASIC OPERATIONS

Tap the Live View screen (or right click on the monitor screen) and the Quick Select icon bar displays in the center of the screen. These icons help you set up your system.

QUICK SELECT ICONS

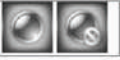
ICON	WHAT IT IS	WHAT IT DOES
	Channel number	Selects a specific channel to view.
	Main Menu selection	Accesses the Main Menu.
	Quad Channel display	Displays the channels in Quad mode with all 4 screen display sizes equal.

ICON	WHAT IT IS	WHAT IT DOES
	Smart-Quad display	Displays the channels in Smart-Quad mode, with one main screen and the other active screens smaller.
	Single Channel Recording	Indicates when Single Channel recording is on or off.
	All Channel Recording	Indicates when multiple channel recording is on or off.

SCREEN DISPLAY STYLES (IF USING HDMI CABLE TO TV/MONITOR)

Tap  for Quad style display or  for Smart-Quad style display.

Quad Style

In Quad style display, all 4 channels display at the same time in equal size displays. Tap on a quadrant of the screen and that channel becomes full screen. Tap on the image and all 4 video channels display. If channels are not turned on, they will not display but a blank image displays in its place.



Smart-Quad

In Smart-Quad style, the screens display in a 2/3 - 1/3 ratio: one channel displays in 2/3 of the screen and the other channels display, stacked, in the remaining 1/3 of the screen.

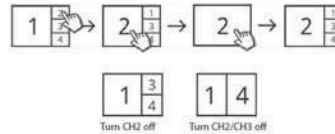

If channels are not turned on, the remaining channels adjust to fill the 1/3 screen section.

For complete operation instructions, refer to the online Detailed User Manual at www.uniden.com

CAMERA INSTALLATION

Mount the Camera Base

1. Hold the base of the camera stand where you want to mount it and mark the location of the screw holes.
2. Use the included screws and anchors to attach the base to the wall or ceiling. You can also screw the base into a flat surface such as a tabletop if needed.
3. Before attaching the camera, tug gently on the stand to make sure it is securely in place.

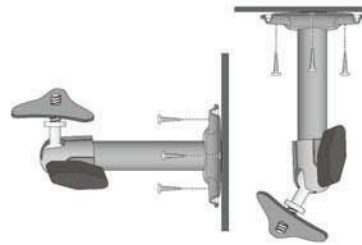

Attach the Camera

1. Attach the camera bracket to the mounting screw. You can attach the stand to the top or the bottom of the AppCam Outdoor HD as needed. Tighten it a few turns, then turn the AppCam Outdoor HD to face the direction you want.
2. Tighten the camera brace up against the AppCam Outdoor HD to secure it into place.
3. Unlock the mounting post by turning the wingnut to the left a few turns.
4. Set the mounting post to the correct angle, then tighten the wingnut until the post is locked into place.
5. After the camera is installed, reconnect power.

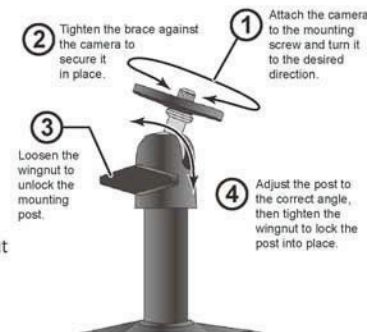

FCC Compliance Statement: This device complies with Part 15 of the FCC rules. Operation is subjected to the following two conditions: (1) this device may not cause harmful interference, and (2) this device must accept any interference received, including interference that may cause undesired operation.

This device complies with Industry Canada's licence-exempt RSSs. Operation is subject to the following two conditions: (1) this device may not cause interference, and (2) this device must accept any interference, including interference that may cause undesired operation of the device.

Le présent appareil est conforme aux CNR d'Industrie Canada applicables aux appareils radio exempts de licence. L'exploitation est autorisée aux deux conditions suivantes :

- (1) l'appareil ne doit pas produire de brouillage;
- (2) l'utilisateur de l'appareil doit accepter tout brouillage radioélectrique subi, même si le brouillage est susceptible d'en compromettre le fonctionnement.

The distance between user and products should be no less than 20cm
La distance entre l'utilisateur et de produits ne devrait pas être inférieure à 20cm

Changes or modifications not expressly approved by the party responsible for compliance could void your authority to operate the equipment.