

*jumper*

# User manual





## Introduction

Thank you for your choosing this device.

The device brings you much convenience for your business (supports Word\*, Excel\*, send & receive e-mails\*) and entertainment. Running on Microsoft Windows 10 Home operating system, Intel Atom Quad-Core processor, it brings you wonderful user experience. This guide serves to enable users to get to know and familiar with the product as soon as possible. Here we have made a brief introduction to the key layout and definitions in figures and words. Before beginning, please refer to this user manual carefully.

\*Software not included

## Contents

<b>I .</b>	<b>Precautions before Use</b>	2
<b>II .</b>	<b>Layout and Definitions</b>	3
<b>III .</b>	<b>Introduction to Desktop</b>	4
1.	Windows 10 Home start image.....	4
2.	Images about select & slide applications.....	5
3.	Introduction about APP Management.....	7
4.	Dual-Screen Application.....	9
<b>IV .</b>	<b>Basic Operations</b> .....	10
1.	Dormancy, restart and power off.....	10
2.	Security Management.....	10,11
3.	Wi-Fi, Bluetooth, Flight mode .....	12
4.	Cortana.....	12
<b>V .</b>	<b>Battery charging</b> .....	13
<b>VI .</b>	<b>Specifications</b> .....	14
<b>VII .</b>	<b>Package Content</b> .....	14
<b>VIII .</b>	<b>Troubleshooting</b> .....	14

## I. Precautions before Use

1. This product is suitable for use in non-tropic areas below 2,000 meters
2. Prevent this product from falling to the ground it could be strongly damaged.
3. Keep the device away from rain, moisture, direct sunlight and heat source.
4. Avoid using it in the strong magnetic and strong static environment as much as possible.
5. Once any water or other liquid splashes onto this product, close it immediately and do not use it until it dries out.
6. Do not clean this product with any detergent containing chemical element or other liquid to avoid causing damage due to corrosion and becoming damp. If cleaning is really necessary, clean it with dry soft cloth tissue paper.
7. Handle the screen gently. To clear fingerprints or dust on the screen, use soft cloth dedicated for camera lens instead of gauze.
8. Please back up your important files at any time to avoid loss.
9. Please do not disassemble this product by yourself; otherwise you will lose the right to warranty.
10. Do not disconnect the device from power suddenly, when formatting or uploading and downloading, which can lead to program errors.
11. Please use the original AC adapter for charging. Nonconforming chargers may cause harms.
12. Protect the power cord. When connect the power cord, do not step onto it or place any object on it, which may cause extrusion. Protect the connector of the power cord connected devices specially.

### 13. Batteries

The batteries in this product cannot be easily replaced by users themselves.

Replacement with incorrect type batteries may cause explosion.

14. While using the earphone, if the volume is excessively high it may cause hearing damage.

So please adjust the volume of the player to a moderate level and balance the time of using.



15. Pictures in this manual are for demonstration purpose only and may differ from the real product.

### 16. Caution!

This unit contains battery. If the battery is defective, it should not be disposed of with household waste. Batteries can possibly contain harmful substances that can harm the environment and people's health. Please dispose of the battery commercially or at a municipal recycling plants. Return is free of charge and is prescribed by law. Please only dispose of Empty batteries in the containers provided and tape the terminals.



## II. Layout and Definitions

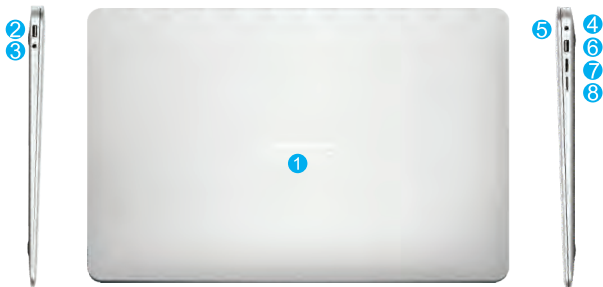

- 1 Back light Logo
- 2 2.0 Data Transfer Port
- 3 Headphone connector&MIC
- 4 Power Light
- 5 Power DC Port: recharge the battery
- 6 3.0 Data Transfer Port
- 7 HD Signal Output,Connect this port with your TV
- 8 Micro SD card slot: The built-in storage card reader slot supports micro SD
- 9 Speaker outlet
- 10 Power button:Turn on /Off
- 11 Touch area: use your finger to touch and control the device

### III. Introduction to Desktop

#### 1. Windows 10 Home start image

On the start screen, you can see many programs fixed in the image. These application programs are displayed in the form of "magnet". As long as you click them, you can easily visit them. You need to log on your account before the application program completely runs.





## 2. Images about select & slide applications

(A) Under Tablet Mode - Touch APP icon at button of left-hand side corner,

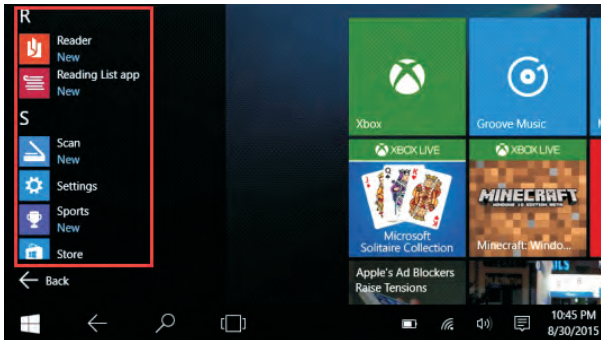

than call out APP list and select APP you need.

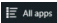

(A) Under Desktop Mode -Same experience as you use Desktop PC. Touch  first at button of left-hand side corner, then touch  All apps

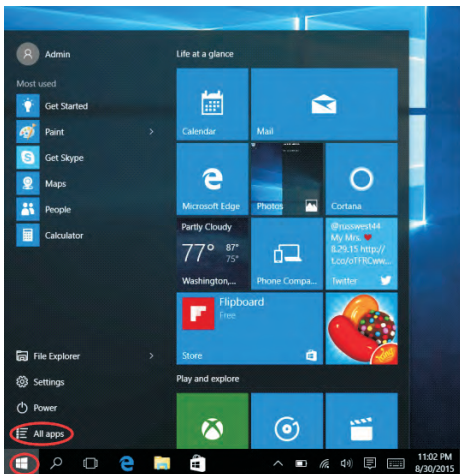

Finally call out APP list, and select APP you need.





### 3. Introduction about App Management

If you want to fix more application programs on the start interface, see the operation in the figure below,

A. Lightly touch, press and hold the application program magnet for about one second and then let go, and select to fix to the start screen.

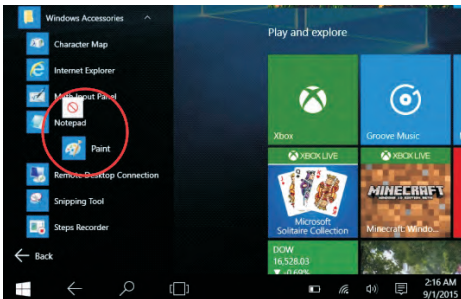



- B. lightly touch the application program for about one second then release, and select mission from sub menu



Conversely, if you want to cancel or delete a certain application in the start screen, (1) lightly touch, press and hold the application program magnet for about one second and (2) pin icon will appear, then touch it to delete application from start menu.



Or

Lightly touch, press and hold the application program for about one second about one second then release, and select mission from sub menu.

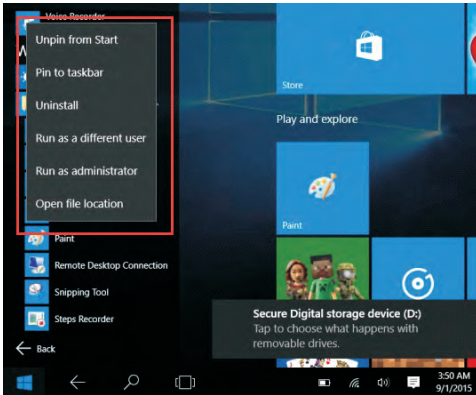

#### 4. Dual-Screen Application

Resize the window as shown in Figure 1. Slide drag and hold the minimized window in the center of the screen. Let go when you see double screen.

In (Figure 2), press the partition button on the middle partition line and drag right or left to partition the display proportion of the double screens.

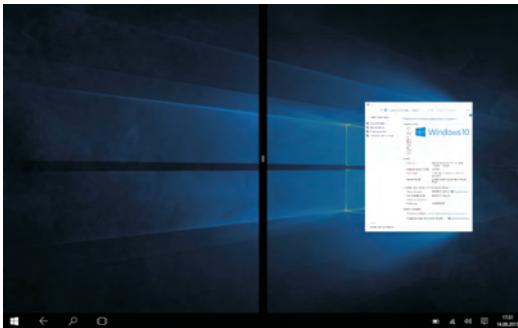

(Figure 1)

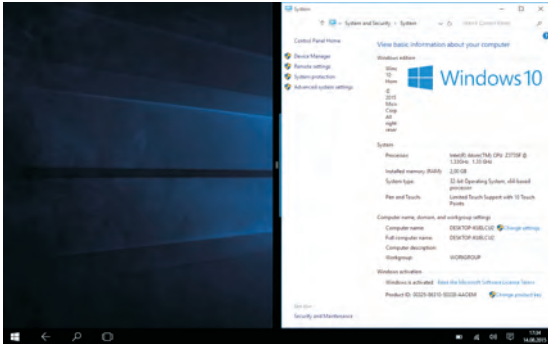

(Figure 2)

## IV. Basic Operations

### 1. Dormancy, restart and power off



### 2. Security Management

User and password setup - Get in Settings→Accounts→Sign-in options to set up password.

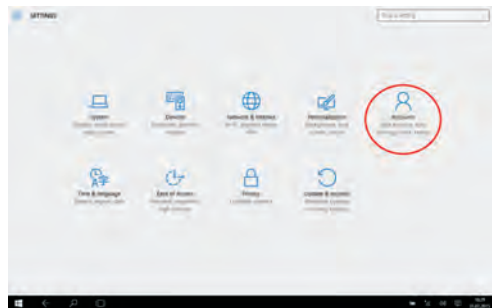
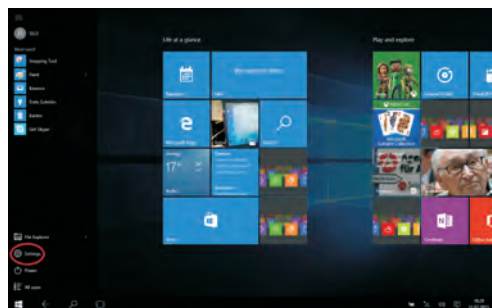

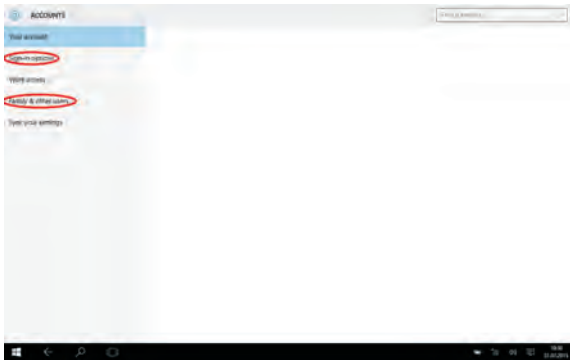

### 3. Wi-Fi , Bluetooth, Flight mode

Touch to Open Setting Tablet to set up Airplane mode / Wi-Fi / & Bluetooth

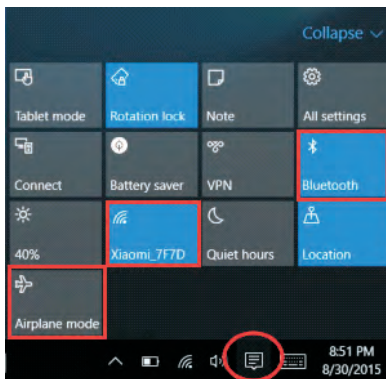

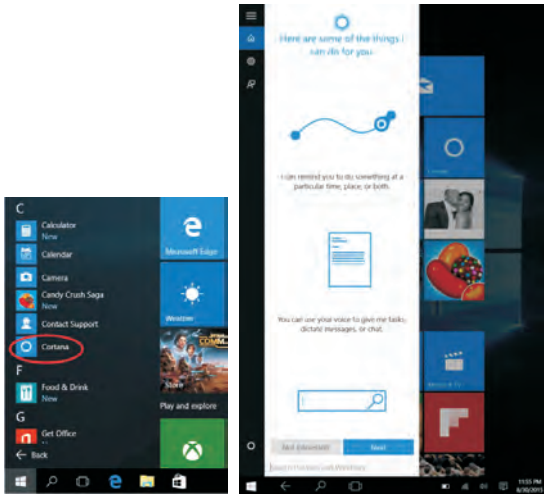

### 4. Cortana

You can use Cortana (voice control) to set reminders, write emails, search, and chat with friends and family on messengers.



## V. Battery charging

Connect DC plug of power adapter to the power DC port of the device. Plug the power adapter into a power outlet for charging the battery. Please only use the provided power adapter.

During charging, the icon of battery will be , and when charging completes, the icon will be .

- You can still use the device while charging, but this will prolong the charging time.
- Use the device at least once every week.
- Fully charge the battery regularly.
- Don't keep the battery empty for a long time.

## VI. Specifications

Display:	14.1" Full HD Panel 1920 x 1080 Pixel
CPU:	Intel® Atom X5 Z8300 Quad-Core 1.34-1.84GHz
Graphic:	Intel® Gen8 HD Graphics
Operating System:	Microsoft® Windows 10 Home
RAM:	4 GB DDR3L
Internal Memory:	64GB Flash eMMC
Connectors:	2.0/3.0 Data Transfer Port, HD Signal Output, earphone jack, DC In, built-in speaker
Slots:	micro SD card reader upto 128G
Camera:	2.0MP
Communication:	Bluetooth 4.0, WLAN 802.11 b/g/n
Battery:	10000 mAh Li Polymer
<i>Note: The battery cannot be easily replaced by users themselves.</i>	
Dimension:	device approx. 346.5 x 229.5 x 5.5~17.5mm
Weight:	approx. 1.4kg
Environmental conditions:	
Operation:	5°C till 30°C at 20% till 80% (non-condensing)
Storage:	0°C till 55°C

## VII. Package content

EZbook2, Power Adapter, manual

## VIII. Troubleshooting

1. Cannot turn on the device  
Check the device's power level; please charge it before starting.
2. No sound from earphone  
Check if volume is set to "0". Or earphone may be broken, please change for another one.
3. Big noise  
Check if there is dust in the earphone or speaker. Check if the file is broken.
4. Screen drift or unresponsive screen  
Switch off the device by a long press (approx. 30 sec.) of the power button.  
Do not use this way to switch off the device unless it is necessary.



**FCC Caution:**

This device complies with part 15 of the FCC Rules. Operation is subject to the following two conditions: (1) This device may not cause harmful interference, and (2) this device must accept any interference received, including interference that may cause undesired operation.

Any Changes or modifications not expressly approved by the party responsible for compliance could void the user's authority to operate the equipment.

**Note:** This equipment has been tested and found to comply with the limits for a Class B digital device, pursuant to part 15 of the FCC Rules. These limits are designed to provide reasonable protection against harmful interference in a residential installation. This equipment generates uses and can radiate radio frequency energy and, if not installed and used in accordance with the instructions, may cause harmful interference to radio communications. However, there is no guarantee that interference will not occur in a particular installation. If this equipment does cause harmful interference to radio or television reception, which can be determined by turning the equipment off and on, the user is encouraged to try to correct the interference by one or more of the following measures:

- Reorient or relocate the receiving antenna.
- Increase the separation between the equipment and receiver.
- Connect the equipment into an outlet on a circuit different from that to which the receiver is connected.
- Consult the dealer or an experienced radio/TV technician for help.

The device has been evaluated to meet general RF exposure requirement. The device can be used in portable exposure condition without restriction.