

JVC



LYT1679-001A

DIGITAL VIDEO CAMERA

GR-D720EK GR-D740EK

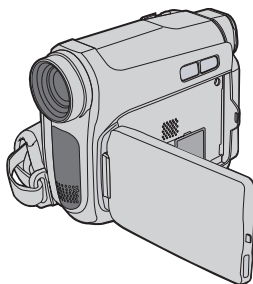

Mini **DV** PAL

Dear Customer,

Thank you for purchasing this digital video camera. Before use, please read the safety information and precautions contained in the pages, 3 – 6 to ensure safe use of this product.

ENGLISH

GETTING STARTED 8

**VIDEO RECORDING &
PLAYBACK 18**

ADVANCED FEATURES 24

REFERENCES 35

TERMS Back cover

INSTRUCTIONS

EN

To deactivate the demonstration,
set "DEMO MODE" to "OFF".
(☞ pg. 24, 27)

Major Features of this Camcorder

Wipe/Fader Effects

You can use the Wipe/Fader Effects to make pro-style scene transitions. (☞ pg. 31)

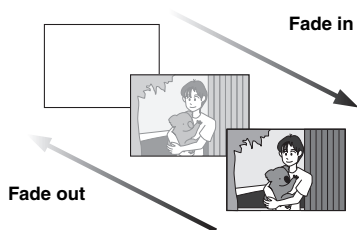

Program AE, Effects and Shutter Effects

For example, "SPORTS" mode allows fast-moving images to be captured one frame at a time, for vivid, stable slow-motion. (☞ pg. 32)

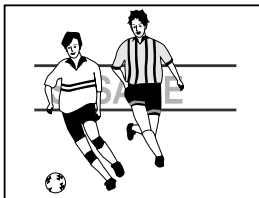

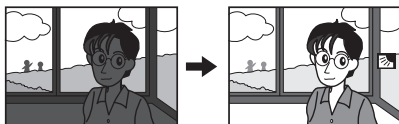

Backlight Compensation

Simply pressing the  button brightens the image darkened by backlight. (☞ pg. 30)

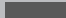

Data Battery

You can check the battery status by simply pressing the **DATA** button. (☞ pg. 14)

BATTERY CONDITION	
LEVEL	MAX TIME
100% 	LCD 110min
50 	FINDER 135min
0 	

Auto Button

You can change the recording mode between manual setting to the standard mode setting of the camcorder by pressing the **AUTO** button. (☞ pg. 20)

READ THIS FIRST !

- **Before recording important video, be sure to make a trial recording.**

Play back your trial recording to make sure the video and audio have been recorded properly.

- **We recommend cleaning your video heads before use.**

If you haven't used your camcorder for awhile, the heads may be dirty. We recommend periodically cleaning the video heads with a cleaning cassette (optional).



- **Be sure to store your cassette tapes and camcorder in the proper environment.**

Video heads can become dirty more easily if your cassette tapes and camcorder are stored in a dusty area. Cassette tapes should be removed from the camcorder and stored in cassette cases. Store the camcorder in a bag or other container.

- **Use SP (Standard) mode for important video recordings.**

LP (Long Play) mode lets you record 50% more video than SP (Standard) mode, but you may experience mosaic-like noise during playback depending on the tape characteristics and the usage environment.

So, for important recordings, we recommend using SP mode.

- **For safety and reliability.**

It is recommended only genuine JVC batteries and accessories are used in this camcorder.

- **This product includes patented and other proprietary technology and will operate only with JVC Data Battery. Use the JVC BN-VF808U/BN-VF815U/BN-VF823U battery packs. Using generic non-JVC batteries can cause damage to the internal charging circuitry.**

- **Make sure you only use cassettes with the Mini DV mark Mini DV.**

- **Remember that this camcorder is not compatible with other digital video formats.**
- **It is recommended that you use JVC brand cassette tapes.**

Your camcorder is compatible with all brands of commercially available cassette tapes complying with the MiniDV standard, but JVC brand cassette tapes are designed and optimised to maximised the performance of your camcorder.

- **Remember that this camcorder is intended for private consumer use only.**

Any commercial use without proper permission is prohibited. (Even if you record an event such as a show, performance or exhibition for personal enjoyment, it is strongly recommended that you obtain permission beforehand).

- **DO NOT** leave the unit
 - in place of over 50°C.
 - in place where humidity is extremely low (below 35%) or extremely high (80%).
 - in direct sunlight.
 - in a closed car in summer.
 - near a heater.
- **The LCD monitor is made with high-precision technology.** However, black spots or bright spots of light (red, green or blue) may appear constantly on the LCD monitor. These spots are not recorded on the tape. This is not due to any defect of the unit. (Effective dots: more than 99.99%).
- **Do not leave the battery pack attached when the camcorder is not in use and check the unit regularly whether it is working or not.**

Also read "CAUTIONS" on pages 36 - 38.

SAFETY PRECAUTIONS

IMPORTANT (for owners in the U.K.)
Connection to the mains supply in the United Kingdom.

DO NOT cut off the mains plug from this equipment.

If the plug fitted is not suitable for the power points in your home or the cable is too short to reach a power point, then obtain an appropriate safety approved extension lead or consult your dealer.

BE SURE to replace the fuse only with an identical approved type, as originally fitted, and to replace the fuse cover.

If nonetheless the mains plug is cut off be sure to remove the fuse and dispose of the plug immediately, to avoid possible shock hazard by inadvertent connection to the mains supply.

If this product is not supplied fitted with a mains plug then follow the instructions given below:

DO NOT make any connection to the Larger Terminal coded E or Green.

The wires in the mains lead are coloured in accordance with the following code:

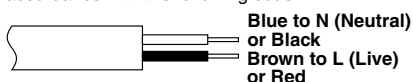

If these colours do not correspond with the terminal identifications of your plug, connect as follows:

Blue wire to terminal coded N (Neutral) or coloured black.

Brown wire to terminal coded L (Live) or coloured Red.

If in doubt - consult a competent electrician.

WARNING: TO PREVENT FIRE OR SHOCK HAZARD, DO NOT EXPOSE THIS UNIT TO RAIN OR MOISTURE.

CAUTIONS:

- To prevent shock, do not open the cabinet. No user serviceable parts inside. Refer servicing to qualified personnel.
- When you are not using the AC Adapter for a long period of time, it is recommended that you disconnect the power cord from AC outlet.

CAUTION:

To avoid electric shock or damage to the unit, first firmly insert the small end of the power cord into the AC Adapter until it is no longer wobbly, and then plug the larger end of the power cord into an AC outlet.

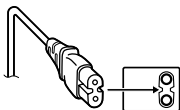

CAUTIONS:

- This camcorder is designed to be used with PAL-type colour television signals. It cannot be used for playback with a television of a different standard. However, live recording and LCD monitor/viewfinder playback are possible anywhere.
- This product includes patented and other proprietary technology and will operate only with JVC Data Battery. Use the JVC BN-VF808U/BN-VF815U/BN-VF823U battery packs and, to recharge them or to supply power to the camcorder from an AC outlet, use the provided multi-voltage AC Adapter. (An appropriate conversion adapter may be necessary to accommodate different designs of AC outlets in different countries.)

NOTES:

- The rating plate (serial number plate) and safety caution are on the bottom and/or the back of the main unit.
- The rating information and safety caution of the AC Adapter are on its upper and lower sides.

WARNING:

Batteries shall not be exposed to excessive heat such as sunshine, fire or the like.

CAUTION:

The mains plug shall remain readily operable.

When the equipment is installed in a cabinet or on a shelf, make sure that it has sufficient space on all sides to allow for ventilation (10 cm or more on both sides, on top and at the rear).

Do not block the ventilation holes.

(If the ventilation holes are blocked by a newspaper, or cloth etc. the heat may not be able to get out.)

No naked flame sources, such as lighted candles, should be placed on the apparatus.

When discarding batteries, environmental problems must be considered and the local rules or laws governing the disposal of these batteries must be followed strictly.

The apparatus shall not be exposed to dripping or splashing.

Do not use this equipment in a bathroom or places with water.

Also do not place any containers filled with water or liquids (such as cosmetics or medicines, flower vases, potted plants, cups etc.) on top of this unit. (If water or liquid is allowed to enter this equipment, fire or electric shock may be caused.)

Do not point the lens or the viewfinder directly into the sun. This can cause eye injuries, as well as lead to the malfunctioning of internal circuitry. There is also a risk of fire or electric shock.

CAUTION!

The following notes concern possible physical damage to the camcorder and to the user.

When carrying, be sure to always securely attach and use the provided strap. Carrying or holding the camcorder by the viewfinder and/or the LCD monitor can result in dropping the unit, or in a malfunction.

Take care not to get your finger caught in the cassette holder cover. Do not let children operate the camcorder, as they are particularly susceptible to this type of injury.

Do not use a tripod on unsteady or unlevel surfaces. It could tip over, causing serious damage to the camcorder.

CAUTION!

Connecting cables (Audio/Video, S-Video, etc.) to the camcorder and leaving it on top of the TV is not recommended, as tripping on the cables will cause the camcorder to fall, resulting in damage.

Information for Users on Disposal of Old Equipment



[European Union]

This symbol indicates that the electrical and electronic equipment should not be disposed as general household waste at its end-of-life. Instead, the product should be handed over to the applicable collection point for the recycling of electrical and electronic equipment for proper treatment, recovery and recycling in accordance with your national legislation.

By disposing of this product correctly, you will help to conserve natural resources and will help prevent potential negative effects on the environment and human health which could otherwise be caused by inappropriate waste handling of this product. For more information about collection point and recycling of this product, please contact your local municipal office, your household waste disposal service or the shop where you purchased the product.

Penalties may be applicable for incorrect disposal of this waste, in accordance with national legislation.

(Business users)

If you wish to dispose of this product, please visit our web page www.jvc-europe.com to obtain information about the take-back of the product.

[Other Countries outside the European Union]

If you wish to dispose of this product, please do so in accordance with applicable national legislation or other rules in your country for the treatment of old electrical and electronic equipment.

Attention:

This symbol is only valid in the European Union.

Dear Customer,

[European Union]

This apparatus is in conformance with the valid European directives and standards regarding electromagnetic compatibility and electrical safety.

European representative of Victor Company of Japan Limited is:
JVC Technology Centre Europe GmbH
Postfach 10 05 52
61145 Friedberg
Germany

SOME DO'S AND DON'TS ON THE SAFE USE OF EQUIPMENT

This equipment has been designed and manufactured to meet international safety standards but, like any electrical equipment, care must be taken if you are to obtain the best results and safety is to be assured.

DO read the operating instructions before you attempt to use the equipment.

DO ensure that all electrical connections (including the mains plug, extension leads and interconnections between pieces of equipment) are properly made and in accordance with the manufacturer's instructions. Switch off and withdraw the mains plug when making or changing connections.

DO consult your dealer if you are ever in doubt about the installation, operation or safety of your equipment.

DO be careful with glass panels or doors on equipment.

DON'T continue to operate the equipment if you are in any doubt about it working normally, or if it is damaged in any way - switch off, withdraw the mains plug and consult your dealer.

DON'T remove any fixed cover as this may expose dangerous voltages.

DON'T leave equipment switched on when it is unattended unless it is specifically stated that it is designed for unattended operation or has a standby mode. Switch off using the switch on the equipment and make sure that your family knows how to do this. Special arrangements may need to be made for infirm or handicapped people.

DON'T use equipment such as personal stereos or radios so that you are distracted from the requirements of road safety. It is illegal to watch television whilst driving.

DON'T listen to headphones at high volume, as such use can permanently damage your hearing.

DON'T obstruct the ventilation of the equipment, for example with curtains or soft furnishings.

Overheating will cause damage and shorten the life of the equipment.

DON'T use makeshift stands and **NEVER** fix legs with wood screws - to ensure complete safety always fit the manufacturer's approved stand or legs with the fixings provided according to the instructions.

DON'T allow electrical equipment to be exposed to rain or moisture.

ABOVE ALL

- **NEVER** let anyone especially children push anything into holes, slots or any other opening in the case - this could result in a fatal electrical shock;
- **NEVER** guess or take chances with electrical equipment of any kind — it is better to be safe than sorry!

Cleaning The Camcorder

Before cleaning, turn off the camcorder and remove the battery pack and AC Adapter.

To clean the exterior

Wipe gently with a soft cloth. Put the cloth in diluted mild soap and wring it well to wipe off heavy dirt. Then wipe again with a dry cloth.

To clean the LCD monitor

Wipe gently with a soft cloth. Be careful not to damage the monitor. Close the LCD monitor.

To clean the lens

Blow it with a blower brush, then wipe gently with lens cleaning paper.

To clean the viewfinder lens

Remove dust from the viewfinder using a blower brush.

NOTES:

- Avoid using strong cleaning agents such as benzene or alcohol.
- Cleaning should be done only after the battery pack has been removed or other power units have been disconnected.
- Mould may form if the lens is left dirty.
- When using a cleaner or chemically treated cloth refer to the cautions of each product.
- To clean the viewfinder, please consult your nearest JVC dealer.

USE CLEANING CASSETTE

Appears if dirt is detected on the heads during recording. Use an optional cleaning cassette.

( pg. 3)

GETTING STARTED	8	ADVANCED FEATURES	24
Index	8	MENUS FOR DETAILED ADJUSTMENT	24
Regarding This Manual	11	Changing The Menu Settings	24
Provided Accessories	11	Recording Menus	25
Grip Adjustment	12	Playback Menus	27
Power	13	FEATURES FOR RECORDING	29
Language Settings	15	Snapshot (Record Still Image On Tape)	29
Date/Time Settings	15	Manual Focus	29
Viewfinder Adjustment	15	Exposure Control	29
Brightness Adjustment Of The Display	15	Iris Lock	30
Tripod Mounting	16	Backlight Compensation	30
Loading/Unloading A Cassette	16	Spot Exposure Control	30
16:9 Wide Mode	17	White Balance Adjustment	31
		Manual White Balance Adjustment	31
		Wipe Or Fader Effects	31
		Program AE, Effects and Shutter Effects	32
VIDEO RECORDING & PLAYBACK	18	EDITING	33
VIDEO RECORDING	18	Dubbing To A VCR	33
Basic Recording	18	Dubbing To Or From A Video Unit Equipped With A DV Connector (Digital Dubbing)	33
Tape Remaining Time	18	Connection To A Personal Computer	34
Quick Review	18		
Zooming	19	REFERENCES	35
Journalistic Shooting	19		
Interface Shooting	19	TROUBLESHOOTING	35
Time Code	20	CAUTIONS	36
Recording From The Middle Of A Tape	20	SPECIFICATIONS	39
Auto/Manual Mode	20		
VIDEO PLAYBACK	21	TERMS	Back cover
Normal Playback	21		
Still Playback	21		
Variable Shuttle Search	21		
Blank Search	22		
Playback Snapshot	22		
Connections To A TV Or VCR	22		

Index

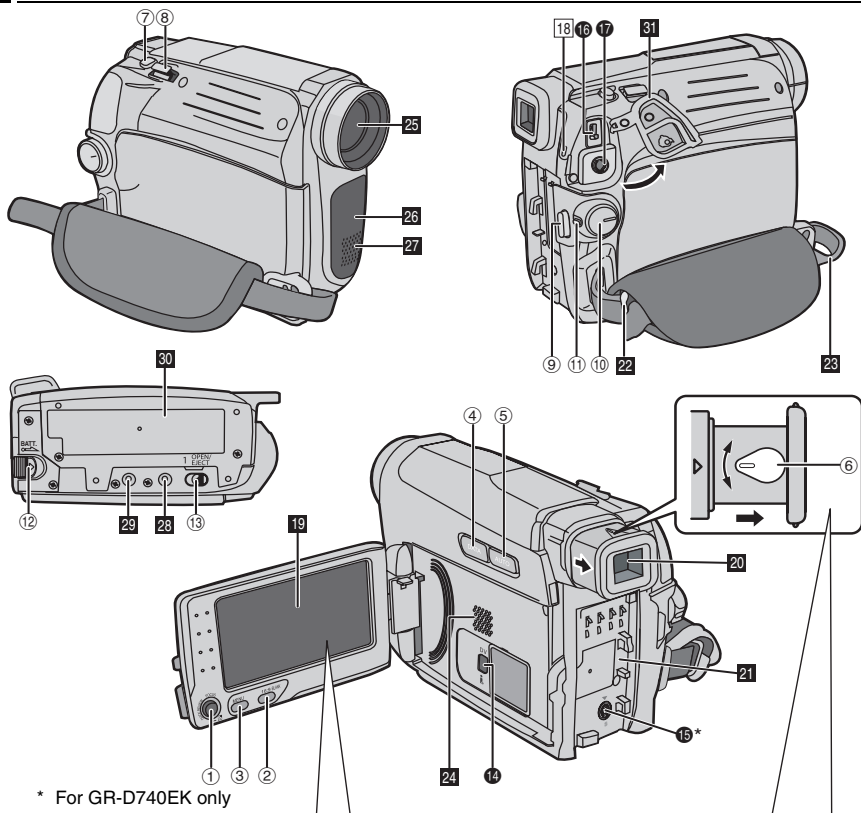

* For GR-D740EK only

How to open the LCD monitor

Pull on the end **A** of the LCD monitor.

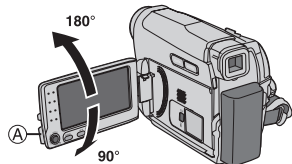

The LCD monitor can rotate 270°.

Power-linked operation

When the power switch is set to "REC", you can also turn the camcorder on/off by opening/closing the LCD monitor or pulling out/pushing in the viewfinder.

NOTES:

- The image will not appear simultaneously on the LCD monitor and the viewfinder. When the viewfinder is pulled out while the LCD monitor is opened, you can select which one to use. Set "PRIORITY" to the desired mode in SYSTEM Menu. (▶ pg. 27)
- Coloured bright spots may appear all over the LCD monitor or the viewfinder. However, this is not a malfunction.

Controls

- ① <: Left / Rewind [◀◀] (☞ pg. 21) / Quick Review [QUICK REVIEW] (☞ pg. 18)
- >: Right / Fast-Forward [▶▶] (☞ pg. 21)
- ⤴: Up/Play/Pause [▶/⏸] (☞ pg. 21) / Manual Focus [FOCUS] (☞ pg. 29)
- ⤵: Down / Stop [■] (☞ pg. 21) / Backlight Compensation [☒] (☞ pg. 30) / Spot Exposure (☞ pg. 30)
Press down: SET
- ② 16:9 Wide Screen Button [16:9] (☞ pg. 17)
Blank Search [BLANK] (☞ pg. 22)
- ③ Menu Button [MENU] (☞ pg. 24)
- ④ Data Battery Button [DATA] (☞ pg. 14)
- ⑤ Auto Button [AUTO] (☞ pg. 20)
- ⑥ Dioptre Adjustment Control (☞ pg. 15)
- ⑦ Snapshot Button [SNAPSHOT] (☞ pg. 29)
- ⑧ Power Zoom Lever [T/W] (☞ pg. 19)
Speaker Volume Control [VOL. +, -] (☞ pg. 21)
- ⑨ Recording Start/Stop Button [START/STOP] (☞ pg. 18)
- ⑩ Power Switch [REC, PLAY, OFF]
- ⑪ Lock Button
- ⑫ Battery Release Button [BATT.] (☞ pg. 13)
- ⑬ Cassette Open/Eject Switch [OPEN/EJECT] (☞ pg. 16)

Connectors

- ⑭ Digital Video Connector [DV OUT] (i.LINK*) (☞ pg. 33, 34)
- * i.LINK refers to the IEEE1394-1995 industry specification and extensions thereof. The  logo is used for products compliant with the i.LINK standard.
- ⑮ S-Video Output Connector [S] (☞ pg. 22)
(For GR-D740EK only)
The connectors are located beneath the covers.
- ⑯ DC Input Connector [DC] (☞ pg. 13)
- ⑰ Audio/Video Output Connector [AV] (☞ pg. 22, 33)

Indicators

- ⑱ POWER/CHARGE Lamp (☞ pg. 13)

Other Parts

- ⑲ LCD Monitor (☞ pg. 8)
- ⑳ Viewfinder (☞ pg. 15)
- ㉑ Battery Pack Mount (☞ pg. 13)
- ㉒ Shoulder Strap Eyelet (☞ pg. 12)
- ㉓ Grip Strap (☞ pg. 12)
- ㉔ Speaker (☞ pg. 21)
- ㉕ Lens
- ㉖ Camera Sensor
(Be careful not to cover this area, a sensor necessary for shooting is built-in here.)
- ㉗ Stereo Microphone
- ㉘ Stud Hole (☞ pg. 16)
- ㉙ Tripod Mounting Socket (☞ pg. 16)
- ㉚ Cassette Holder Cover (☞ pg. 16)
- ㉛ Connector Cover

Power Switch Position

REC:

To perform recording on the tape.

OFF:

To switch off the camcorder.

PLAY:

To play back a recording on the tape.

LCD Monitor/Viewfinder Indications

During Video Recording

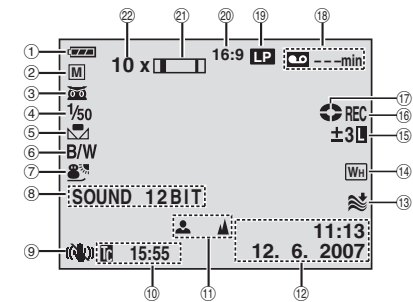

- ① Battery Remaining Power Indicator (☞ pg. 36)
- ② Operation Mode
A : Auto Mode
M : Manual Mode
- ③ Night Indicator (☞ pg. 32)
GA : Gain Up Mode (☞ pg. 25)
- ④ Shutter Speed (☞ pg. 32)
- ⑤ White Balance Indicator (☞ pg. 31)
- ⑥ Selected Effect Indicator (☞ pg. 32)
- ⑦ Selected Program AE Indicator (☞ pg. 32)
- ⑧ **SOUND 12BIT/16BIT**: Sound Mode Indicator (☞ pg. 26) (Appears for approx. 5 seconds after turning on the camcorder.)
- ⑨ Digital Image Stabiliser ("DIS") (☞ pg. 25) (only **DIS** indicator is displayed)
- ⑩ Time Code (☞ pg. 26)
- ⑪ Manual Focus Adjustment Indicator (☞ pg. 29)
- ⑫ Date/Time (☞ pg. 26)
- ⑬ Wind Cut Indicator (☞ pg. 25)
- ⑭ Selected Wipe/Fader Effect Indicator (☞ pg. 31)
- ⑮ **SP**: Spot Exposure Control Indicator (☞ pg. 30)
BC: Backlight Compensation Indicator (☞ pg. 30)
±: Exposure Adjustment Indicator (☞ pg. 29)
IL: Iris Lock Indicator (☞ pg. 30)
- ⑯ **PHOTO**: (Appears when taking Snapshot.)
REC: (Appears during recording.)
- ⑰ Tape Running Indicator (Rotates while tape is running.)
- ⑱ Tape Remaining Time (☞ pg. 18)
- ⑲ Recording Speed Mode (SP/LP) (☞ pg. 25) (only LP indicator is displayed)
- ⑳ Selected Wide Mode Indicator (☞ pg. 18) (only 16:9 indicator is displayed)

- ㉑ Zoom Indicator (☞ pg. 19)
- ㉒ Approximate Zoom Ratio (☞ pg. 19)

During Video Playback

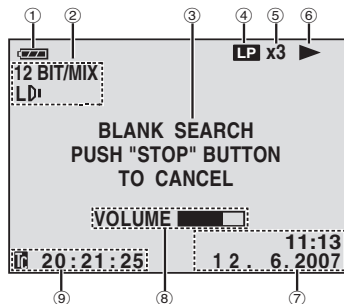

- ① Battery Remaining Power Indicator (☞ pg. 36)
- ② Sound L/R Indicator (☞ pg. 27)
- ③ Blank Search Indicator (☞ pg. 22)
- ④ Tape Speed (SP/LP) (only LP indicator is displayed)
- ⑤ Variable Search Speed Indicator: x-10, x-3, x3 and x10 (☞ pg. 21)
- ⑥ **▶▶**: Fast-Forward/Shuttle Search
◀◀: Rewind/Shuttle Search
||: Pause
- ⑦ Date/Time (☞ pg. 28)
- ⑧ **VOLUME**: Volume Level Indicator (☞ pg. 21)
- ⑨ Time Code (☞ pg. 28)

Regarding This Manual

Control Lever

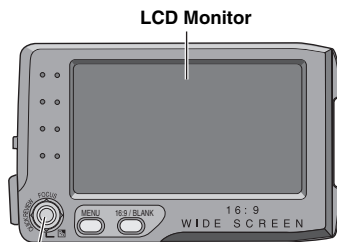

Control lever

There are two kinds of operation using the control lever: moving the lever towards up/down/left/right, or pressing down the lever.

They are described and illustrated as shown below.

1. Move the control lever up/down/left/right (▲/▼/◀/▶) to select.



Operation			To select
▲	▶/III	FOCUS	Move the control lever up.
▼	■		Move the control lever down.
>	▶▶		Move the control lever right.
<	◀◀	QUICK REVIEW	Move the control lever left.

2. Press down the control lever to select **SET**.



Provided Accessories

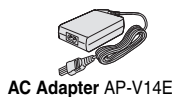

AC Adapter AP-V14E



Power Cord



Audio/Video Cable
(Ø3.5 mini-plug to RCA plug)



Battery Pack
BN-VF808U



Shoulder Strap
(☞ pg. 12)



Lens Cap
(☞ pg. 12)

NOTES:

- In order to maintain optimum performance of the camcorder, provided cables may be equipped with one or more core filter. If a cable has only one core filter, the end that is closest to the filter should be connected to the camcorder.
- Make sure to use the provided cables for connections. Do not use any other cables.

How To Attach The Lens Cap

To protect the lens, attach the provided lens cap to the camcorder as shown in the illustration.

NOTE:

To confirm the lens cap is on correctly make sure the cap is flush to the camcorder.

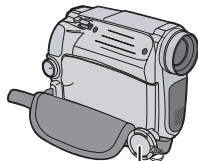

Place here
during shooting

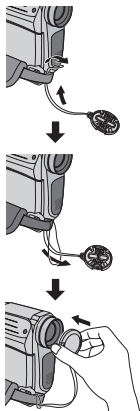

Grip Adjustment

Open the pad and make grip adjustments.

- Before making the adjustment, remove any security tags that may be attached to the velcro.

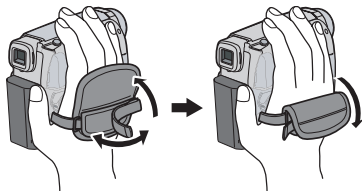

How To Attach The Shoulder Strap

1 Peel off the pad and thread the end of the strap through the eyelet.

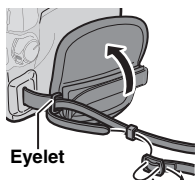

Eyelet

2 Thread the strap through the buckle, adjust its length, and use the strap guide to fix it in place.

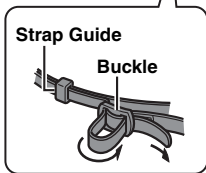

Strap Guide

Buckle

3 Position the buckle near the eyelet and reattach the pad.

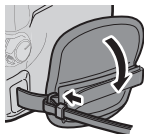

Power

Charging The Battery Pack

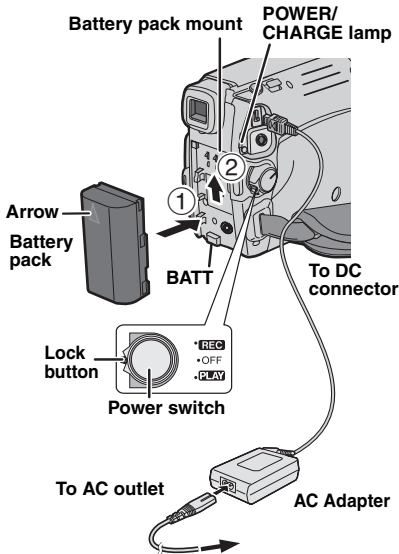

- 1** Set the Power Switch to "OFF".
- 2** With the arrow on the battery pack pointing upward, push the battery pack slightly against the battery pack mount ①.
- 3** Slide up the battery pack until it locks in place ②.
- 4** Connect the Power Cord to the AC Adapter.
- 5** Plug the AC Adapter into an AC outlet.
- 6** Connect the AC Adapter to the camcorder.
 - The POWER/CHARGE lamp on the camcorder blinks to indicate charging has started.
 - When the POWER/CHARGE lamp goes out, charging is finished. Unplug the AC Adapter from the AC outlet. Disconnect the AC Adapter from the camcorder.

To detach the battery pack

Slide the battery pack upward while pressing BATT. to detach it.

Battery pack	Charging time
BN-VF808U*	Approx. 1 hr. 30 min.
BN-VF815U	Approx. 2 hrs. 40 min.
BN-VF823U	Approx. 3 hrs. 50 min.

* Provided

NOTES:

- If the protective cap is attached to the battery pack, remove it first.
- During charging, the camcorder cannot be operated.
- Charging is not possible if the wrong type of battery is used.
- When charging the battery pack for the first time or after a long storage period, the POWER/CHARGE lamp may not light. In this case, remove the battery pack from the camcorder, then try charging again.
- If a fully charged battery pack is attached to the unit, POWER/CHARGE lamp will blink for approx. 10 seconds before it turns off.
- If the battery operation time remains extremely short even after having been fully charged, the battery is worn out and needs to be replaced. Please purchase a new one.
- Since the AC Adapter processes electricity internally, it becomes warm during use. Be sure to use it only in well-ventilated areas.
- After 5 minutes have elapsed in Record-Standby mode with the cassette inserted, and no operation is performed, the camcorder will automatically turn off its power supplied from the AC Adapter. In this case, the battery charge starts if the battery is attached to the camcorder.
- Please do not pull or bend the AC Adapter plug and cable. This may damage the AC Adapter.

About Batteries

DANGER! Do not attempt to take the batteries apart, or expose them to flame or excessive heat, as it may cause a fire or explosion.

WARNING! Do not allow the battery or its terminals to come in contact with metals, as this can result in a short circuit and possibly start a fire.

To restore the accuracy of the battery power indicator

If the battery power indication differs from the actual operating time, fully charge the battery, and then run it down.

However this method may not work if the battery was used for a long period of time under extremely high/low temperature condition or charged too many times.

Using The Battery Pack

Perform steps **2 – 3** in “Charging The Battery Pack”. (☞ pg. 13)

Maximum continuous recording time

Battery pack	LCD monitor on	Viewfinder on
BN-VF808U*	1 hr. 50 min.	2 hrs. 15 min.
BN-VF815U	3 hrs. 40 min.	4 hrs. 30 min.
BN-VF823U	5 hrs. 30 min.	6 hrs. 45 min.

* Provided

NOTES:

- Recording time is reduced significantly under the following conditions:
 - Zoom or Record-Standby mode is engaged repeatedly.
 - The LCD monitor is used repeatedly.
 - The playback mode is engaged repeatedly.
- Before extended use, it is recommended that you prepare enough battery packs to cover 3 times the planned shooting time.



ATTENTION:

Before detaching the power source, make sure that the camcorder's power is turned off. Failure to do so can result in a camcorder malfunction.

Data Battery System

You can check the remaining battery power and the recordable time.

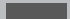
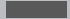
When the battery is attached, press **DATA**.

BATTERY CONDITION		
LEVEL		MAX TIME
100%		LCD 110min
50		
0		FINDER 135min

- When the Power Switch is set to “**OFF**”, it is displayed. for approx 3 seconds if the button is pressed and released quickly, and for approx. 15 seconds if the button is pressed and hold for approx several seconds.
- When the Power Switch is set to “**PLAY**” or “**REC**”, press **DATA** again to return to the normal screen.
- Data battery status cannot be displayed during playback or while recording is in progress.
- If “**COMMUNICATION ERROR**” appears instead of the battery status even though you tried to press **DATA** several times, there may be a problem on the battery. In such a case, consult your nearest JVC dealer.

Using AC Power

Perform steps **4 – 6** in “Charging The Battery Pack”. (☞ pg. 13)

NOTE:

The provided AC Adapter features automatic voltage selection in the AC range from 110 V to 240 V.

INFORMATION:

The following explanations in this manual supposes the use of LCD monitor in your operation. If you want to use the viewfinder, close the LCD monitor and pull out the viewfinder fully.

Language Settings

The language on the display can be changed. (☞ pg. 24, 27)

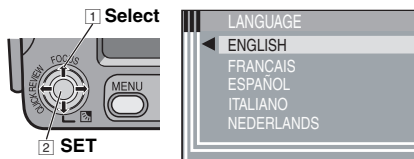

- 1 Open the LCD monitor fully.
- 2 Set the Power Switch to "REC" or "PLAY" while pressing down the Lock Button located on the switch.
 - If set to "REC", the recording mode should be set to "M". (☞ pg. 20)
- 3 Press **MENU**.
- 4 Select "SYSTEM", press **SET** or **>**.
- 5 Select "LANGUAGE", press **SET** or **>**.
- 6 Select the desired language, press **SET** or **>**.
- 7 Press **MENU**.

Press **<** whenever you want to return to the previous menu screen.

Date/Time Settings

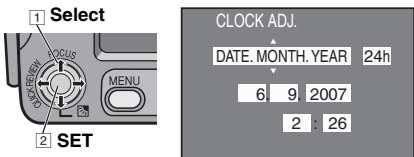

- The date/time is recorded onto the tape at all times, but its display can be turned on or off. (☞ pg. 26, 28)
- Perform steps **1 – 3** in "Language Settings". (☞ pg. 15)
- 1 Select "DISPLAY", press **SET** or **>**.
 - 2 Select "CLOCK ADJ." press **SET** or **>**.
 - 3 Select the desired date display format, press **SET** or **>**.
 - Repeat this step to input time display format (Select from "24h" or "12h"), month, date, year, hour and minutes.
 - 4 Press **MENU**.

Press **<** whenever you want to return to the previous menu screen/setting.

Viewfinder Adjustment

- 1 Set the Power Switch to "REC" while pressing down the Lock Button located on the switch.
- 2 Make sure the LCD monitor is closed and locked. Pull out the viewfinder fully.
- 3 Turn the Dioptre Adjustment Control until the indications in the viewfinder are clearly focused.

Example:

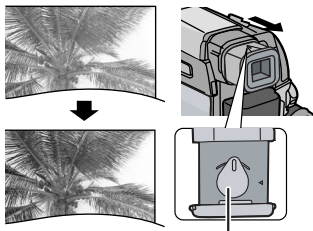

Dioptre Adjustment Control

CAUTION:

When retracting the viewfinder, take care not to pinch your fingers.

Brightness Adjustment Of The Display

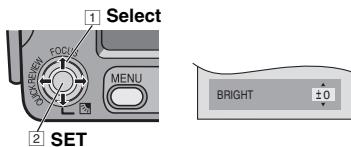

- Perform steps **1 – 3** in "Language Settings". (☞ pg. 15)
- To adjust the brightness of the viewfinder, pull out the viewfinder fully and set "PRIORITY" to "FINDER". (☞ pg. 27)
- 1 Select "DISPLAY", press **SET** or **>**.
 - 2 Select "BRIGHT", press **SET** or **>**.
 - 3 Select the appropriate brightness, press **SET** or **>**.
 - 4 Press **MENU**.

Press **<** whenever you want to return to the previous menu screen/setting.

Tripod Mounting

To attach the camcorder to a tripod, align the direction stud and screw to the mounting socket and stud hole on the camcorder. Then tighten the screw clockwise.

- Some tripods are not equipped with studs.

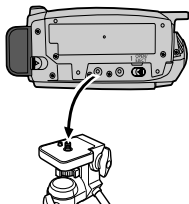

Loading/Unloading A Cassette

The camcorder needs to be powered up to load or eject a cassette.

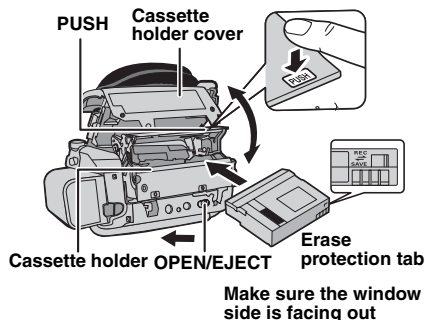

NOTES:

- If you wait a few seconds and the cassette holder does not open, close the cassette holder cover and try again. If the cassette holder still does not open, turn the camcorder off then on again.
- If the tape does not load properly, open the cassette holder cover fully and remove the cassette. A few minutes later, insert it again.
- When the camcorder is suddenly moved from a cold place to a warm environment, wait a short time before opening the cassette holder cover.



- Appears if a tape is loaded while the Power Switch is set to "REC".
- Blinks when no tape is loaded.

TAPE!

Appears if a tape is not loaded when the Recording Start/Stop Button or **SNAPSHOT** Button is pressed while the Power Switch is set to "REC".

CHECK TAPE'S ERASE PROTECTION TAB

Appears when the erase protection tab is set to "SAVE" while the Power Switch is set to "REC".
(pg. 9)

1 Slide and hold **OPEN/EJECT** in the direction of the arrow, then pull the cassette holder cover open until it locks. The cassette holder opens automatically.

- Do not touch internal components.

2 Insert or remove a tape and press "PUSH" to close the cassette holder.

- Be sure to press only the section labelled "PUSH" to close the cassette holder; touching other parts may cause your finger to get caught in the cassette holder, resulting in injury or product damage.

- Once the cassette holder is closed, it recedes automatically. Wait until it recedes completely before closing the cassette holder cover.
- When the battery pack's charge is low, you may not be able to close the cassette holder cover. Do not apply force. Replace the battery pack with a fully charged one or use AC power before continuing.

3 Close the cassette holder cover firmly until it locks into place.

16:9 Wide Mode

You can record videos at 4:3 size and 16:9 size. By default, the camera is set to record videos at the 16:9 size.

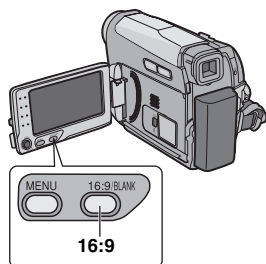

- 1** Set the Power Switch to "REC".
- 2** Each press **16:9** switches the screen size.
On the LCD monitor:

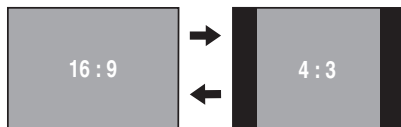

On the viewfinder :

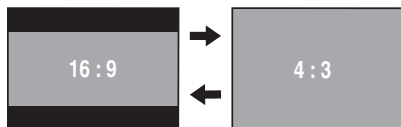

NOTE:

If you record videos in 16:9 size, the image may appear to be slightly vertically stretched when playing back on TV with the 4:3 screen.

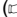
( pg. 26, 28)

Basic Recording

NOTE:

Before continuing, perform the procedures listed below:

- Power. (☞ pg. 13)
- Loading A Cassette. (☞ pg. 16)
- Remove the lens cap. (☞ pg. 12)
- Open the LCD monitor fully. (☞ pg. 8)
- Select videos at 4:3 size of 16:9 (wide) size. (☞ pg. 17)

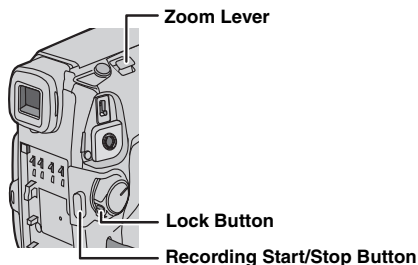

1 Set the Power Switch to “REC” while pressing down the Lock Button located on the switch.

2 Press **START/STOP** button to start recording. “REC” appears on the display while recording is in progress. To stop recording press **START/STOP** again.

Approximate recording time

Tape	Recording mode	
	SP	LP
30 min.	30 min.	45 min.
60 min.	60 min.	90 min.
80 min.	80 min.	120 min.

NOTES:

- If the Record-Standby mode continues for 5 minutes and no operation is performed, the camcorder’s power shuts off automatically. To turn the camcorder on again, push back and pull out the viewfinder again or close and re-open the LCD monitor.
- When a blank portion is left between recorded scenes on the tape, the time code is interrupted and errors may occur when editing the tape. To avoid this, refer to “Recording From The Middle Of A Tape”. (☞ pg. 20)
- To record in LP (Long Play) mode. (☞ pg. 26)

Tape Remaining Time

Approximate tape remaining time appears on the display.

“---min” means the camcorder is calculating the remaining time. When the remaining time reaches 2 minutes, the indication starts blinking.

- The time required to calculate and display the remaining tape length, and the accuracy of the calculation, may vary according to the type of tape used.

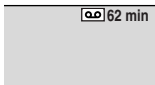

Quick Review

Enables to check the end of the last recording.

1) Press **QUICK REVIEW** during the Recording-Standby mode.

2) Tape is rewound for about several seconds and played back automatically, then pauses in the Recording-Standby mode for the next shot.

- Distortion may occur at start of playback. This is normal.
- Slide the Power Zoom lever repeatedly to change the sound setting to on/off.



Zooming

While recording

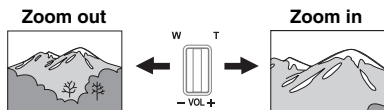

W: Wide angle

T: Telephoto

- You can zoom in up to 28X* / 34X by using the optical zoom.
- Zoom magnification over 28X* / 34X is done through digital image. Digital zooming is possible up to 800X. Set (ZOOM) to [56X]* / [68X] or [800X]. (⇨ pg. 25)

Optical zoom (up to 28X* / 34X)

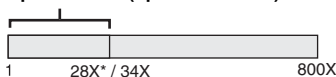

Digital zoom (up to 800X)

* For GR-D720EK only

NOTES:

- Macro shooting is possible as close as approx. 5 cm to the subject when the zoom lever is set all the way to W.
- When you zoom into a subject close to the lens, the camera may automatically zoom out depending on the distance to the subject. In this case, set "TELE MACRO" to "ON". (⇨ pg. 25)

Journalistic Shooting

In some situations, different shooting angles may provide more dramatic results. Hold the camcorder in the desired position and tilt the LCD monitor in the most convenient direction. It can rotate 270° (90° downward, 180° upward).

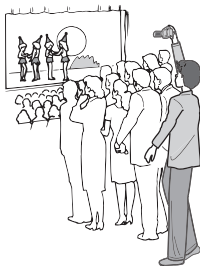

Interface Shooting

The person you shoot can view himself/herself in the LCD monitor, and you can even shoot yourself while viewing your own image in the LCD monitor.



1) Open the LCD monitor and tilt it upward to 180° so that it faces forward. Then, pull out the viewfinder fully.



2) Point the lens toward the subject (yourself when self-recording) and start recording.

- During Interface Shooting, the monitor image appears inverted as it would when viewing a mirror. However, the actual recorded image does not appear inverted.
- If the Quick Review (⇨ pg. 18) is executed during the interface-shooting, the LCD monitor will be turned off. In such a case, check the playback picture in the viewfinder.
- To check the playback picture in the LCD monitor, close the viewfinder.

Time Code

During recording, a time code is recorded on the tape. This code is to confirm the location of the recorded scene on the tape during playback.

Display

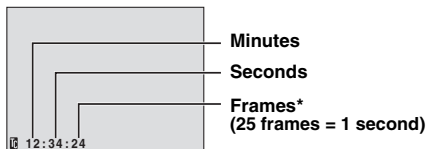

* Frames are not displayed during recording.

If recording starts from a blank portion, the time code begins counting from "00:00:00" (minute:second:frame). If recording starts from the end of a previously recorded scene, the time code continues from the last time code number. If during recording a blank portion is left partway through the tape, the time code is interrupted. When recording is resumed, the time code starts counting up again from "00:00:00". This means the camcorder may record the same time codes as those existing in a previously recorded scene. To prevent this, perform Recording From The Middle Of A Tape (pg. 20) in the following cases;

- When shooting again after playing back a recorded tape.
- When power shuts off during shooting.
- When a tape is removed and re-inserted during shooting.
- When shooting using a partially recorded tape.
- When shooting on a blank portion located partway through the tape.
- When shooting again after shooting a scene then opening/closing the cassette holder cover.

NOTES:

- The time code cannot be reset.
- During fast-forwarding and rewinding, the time code indication does not move smoothly.
- The time code is displayed only when "TIME CODE" is set to "ON". (pg. 20, 26)

Recording From The Middle Of A Tape

1) Play back a tape or use Blank Search (pg. 22) to find the spot at which you want to start recording, then engage the Still Playback mode. (pg. 21)

2) Set the Power Switch to "REC" while pressing down the Lock Button located on the switch, then start recording.

Auto/Manual Mode

Press **AUTO** button repeatedly to switch to auto/manual recording mode. When manual mode is selected, the indicator "M" appears on the LCD monitor.

Auto Mode: A

You can record using no special effects or manual adjustments.

Manual Mode: M

Manual recording is possible by setting various functions.

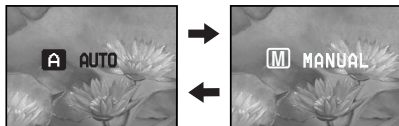

Normal Playback

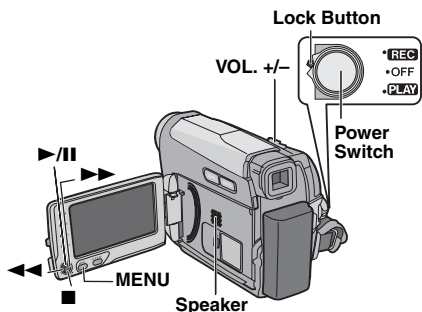

- 1 Load a cassette. (pg. 16)
- 2 Set the Power Switch to "PLAY" while pressing down the Lock Button located on the switch.

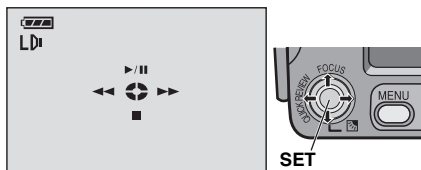

- The above screen (referring to the control lever (pg. 11)) will be displayed for approx. 3 seconds on the LCD Monitor.

Operation	To select
▶/	Move the control lever up
■	Move the control lever down
▶▶	Move the control lever right
◀◀	Move the control lever left

- 3 To start playback, press ▶/||.
- 4 To stop playback, press ■.
 - During Stop mode, press ◀◀ to rewind, or ▶▶ to fast-forward the tape.
 - Press SET to display the guide operation screen.

To control the speaker volume

Slide the Power Zoom Lever (VOL. +/-) towards "+" to turn up the volume, or towards "-" to turn down the volume.

NOTES:

- The playback picture can be viewed in the LCD monitor, viewfinder or on a connected TV. (pg. 23)
- If Stop mode continues for 5 minutes when power is supplied from a battery, the camcorder shuts off automatically. To turn the camcorder on again, push back and pull out the viewfinder again or close and re-open the LCD monitor.
- When a cable is connected to the AV connector, the sound is not heard from the speaker.

HDV

Appears when pictures recorded in the HDV format are detected. The pictures in the HDV format cannot be played back with this camcorder.

Still Playback

Pauses during video playback.

- 1) Press ▶/|| during playback.
 - 2) To resume normal playback, press ▶/|| again.
- If still playback continues for more than about 3 minutes, the camcorder's Stop mode is automatically engaged.

Variable Shuttle Search

Allows to variable-speed search in either direction during video playback.

- 1) During playback, press ▶▶ once or twice for forward search, or ◀◀ once or twice for reverse search.

◀◀		▶▶	
x-10	x-3	x3	x10

- 2) To resume normal playback, press ▶/||.
- During playback, press and hold ▶▶ or ◀◀. The search continues as long as you hold the button. Once you release the button, normal playback resumes.
 - A slight mosaic effect appears on the display during Shuttle Search. This is not a malfunction.

ATTENTION:

During Shuttle Search, parts of the picture may not be clearly visible, particularly on the left side of the screen.



During Shuttle Search, parts of the picture may not be clearly visible across the screen.



Blank Search

Helps you find where you should start recording in the middle of a tape to avoid time code interruption. (☞ pg. 20)

1 Perform steps **1 – 2** in “Normal Playback”.
(☞ pg. 21)

2 Press **BLANK**.

- The “BLANK SEARCH” indication appears and the camcorder automatically starts reverse or forward search, then stops at the spot which is about 3 seconds of tape before the beginning of the detected blank portion.
- To cancel Blank Search midway, press **■** or **BLANK**.

NOTES:

- Before starting Blank Search, if the current position is at a blank portion, the camcorder searches in the reverse direction. If the current position is at a recorded portion, the camcorder searches in the forward direction.
- If the beginning or end of the tape is reached during Blank Search, the camcorder stops automatically.
- A blank portion which is shorter than 5 seconds of tape may not be detected.
- The detected blank portion may be located between recorded scenes. Before you start recording, make sure there is no recorded scene after the blank portion.

Playback Snapshot

This camcorder allows you to take snapshots during video playback.

Press **SNAPSHOT**.

Connections To A TV Or VCR

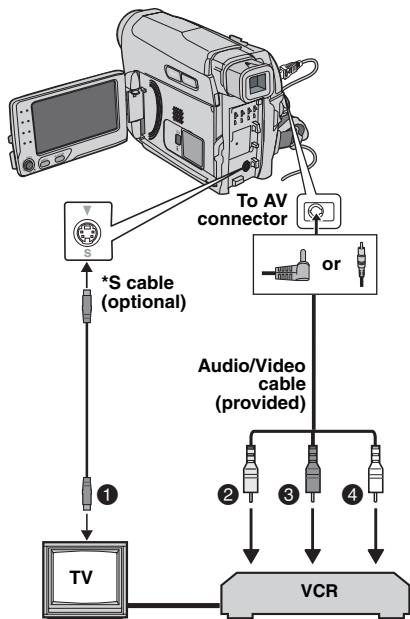

- ❶ Black to S-VIDEO IN* (Connect when your TV/VCR has S-VIDEO in and A/V input connectors. In this case, it is not necessary to connect the yellow video cable).
- ❷ Yellow to VIDEO IN (Connect when your TV/VCR has only A/V input connectors).
- ❸ Red to AUDIO R IN
- ❹ White to AUDIO L IN

* For GR-D740EK only

NOTE:

The S-Video cable is optional. Be sure to use the YTU94146A S-Video cable. Consult the JVC Service Centre described on the sheet included in the package for details on its availability. Make sure to connect the end with a core filter to the camera. The core filter reduces interference.

- ❶ Make sure all units are turned off.
 - ❷ Connect the camcorder to a TV or VCR as shown in the illustration.
- If using a VCR, go to step 3.**
If not, go to step 4.
- ❸ Connect the VCR output to the TV input, referring to your VCR's instruction manual.
 - ❹ Turn on the camcorder, the VCR and the TV.
 - ❺ Set the VCR to its AUX input mode, and set the TV to its VIDEO mode.
 - ❻ Start playback on the camcorder. (⇨ pg. 21)
- Please set "16:9 OUTPUT" of Playback Menus so that the image may suit your TV (16:9 TV or 4:3 TV). (⇨ pg. 17, 28)

To choose whether or not the following displays appear on the connected TV

- Date/Time
Set "DATE/TIME" to "ON" or "OFF". (⇨ pg. 28)
- Time Code
Set "TIME CODE" to "ON" or "OFF". (⇨ pg. 28)
- Indications other than date/time and time code
Set "ON SCREEN" to "OFF", "LCD" or "LCD/TV". (⇨ pg. 28)

NOTES:

- It is recommended to use the AC Adapter as the power supply instead of the battery pack. (⇨ pg. 14)
- To monitor the picture and sound from the camcorder without inserting a tape, set the camcorder's Power Switch to "REC", then set your TV to the appropriate input mode.
- Make sure you adjust the TV sound volume to its minimum level to avoid a sudden burst of sound when the camcorder is turned on.

Changing The Menu Settings

This camcorder is equipped with an easy-to-use, on-screen menu system that simplifies many of the more detailed camcorder settings.

(☞ pg. 24 – 28)

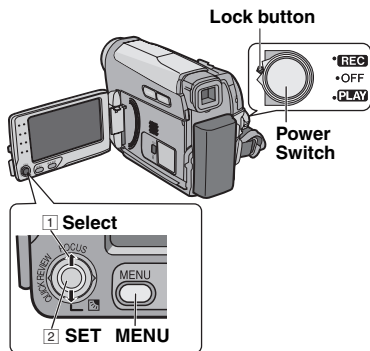

1 For Video Recording Menus:

- Set the Power Switch to “REC” while pressing down the Lock Button located on the switch.
- Set the recording mode to “**M**”. (☞ pg. 20)

For Video Playback Menus:

- Set the Power Switch to “PLAY” while pressing down the Lock Button located on the switch.

2 Open the LCD monitor fully. (☞ pg. 8)

3 Press **MENU**. The Menu Screen appears.

Screen for Video Recording Menu

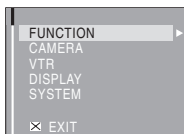

Screen for Video Playback Menu

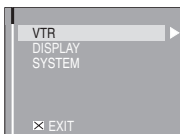

4 Select the desired function, press **SET** or **>**. The selected function menu appears.

Example: FUNCTION menu.

Selected menu icon

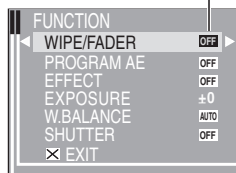

5 Select the desired selection, press **SET** or **>**.

Example: WIPE/FADER menu.

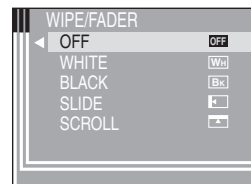

6 Select the desired setting, press **SET** or **>**. Selection is completed.

7 Press **MENU**. The Menu Screen closes.

- Press **<** whenever you want to cancel or return to the previous menu screen.
- Repeat the procedure if you wish to set other function menus.

In the following pages, [] refers to Factory preset settings.

Recording Menus

FUNCTION

The following menu settings can be changed only when the Power Switch is set to "REC".

WIPE/FADER

(Pg. 31), "Wipe or Fader Effects"

PROGRAM AE

(Pg. 32), "Program AE, Effects and Shutter Effects"

EFFECT

(Pg. 32), "Program AE, Effects and Shutter Effects"

EXPOSURE

(Pg. 29), "Exposure Control"

W. BALANCE

(Pg. 31), "White Balance Adjustment"

SHUTTER

(Pg. 32), "Program AE, Effects and Shutter Effects"

CAMERA

The following menu settings can be changed only when the Power Switch is set to "REC".

ZOOM

[28X]* / [34X]: When set to "28X* / 34X" while using Digital Zoom, the zoom magnification will reset to 28X* / 34X since Digital Zoom will be disengaged.

56X* / 68X: Allows you to use the Digital Zoom. By digitally processing and magnifying images, zooming is possible from 28X* / 34X (the optical zoom limit), to a maximum of 56X* / 68X digital magnification.

800X: Allows you to use the Digital Zoom. By digitally processing and magnifying images, zooming is possible from 28X* / 34X (the optical zoom limit), to a maximum of 800X digital magnification.

* For GR-D720EK only

TELE MACRO

[OFF]: Disables the function.

[ON]: When the distance to the subject is less than 1 m, set "TELE MACRO" to "ON". You can shoot a subject as large as possible at a distance of approx. 40 cm. Depending on the zoom position, the lens may go out of focus.

DIS

OFF (OFF): Disables the function.

[ON]: To compensate for unstable images caused by camera-shake, particularly at high magnification.

NOTES:

- Accurate stabilisation may not be possible if hand shake is excessive, or depending on the shooting condition.
- Switch off this mode when recording with the camcorder on a tripod.
- DIS cannot be activated when "NIGHT" in "PROGRAM AE", or "STROBE" in "EFFECT" is selected or when SNAPSHOT is pressed.

GAIN UP

OFF: Allows you to shoot dark scenes with no picture brightness adjustment.

[AGC]: The overall appearance may be grainy, but the image is bright.

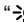
AUTO  A: The shutter speed is automatically adjusted. Shooting a subject in low or poor lighting at slow shutter speed provides a brighter image than in the AGC mode, but the subject's movements are not smooth or natural. The overall appearance may be grainy. While the shutter speed is being automatically adjusted, " A" is displayed.

WIND CUT

[OFF]: Disengages the function.

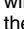
ON  : Helps cut down on noise created by wind. The " " indicator appears. The quality of the sound will change. This is normal.

VTR**REC MODE**

[SP]*: To record in the SP (Standard Play) mode

LP: Long Play - more economical, providing 1.5 times the recording time.

* SP indicator does not appear on the screen.

NOTES:

- If the recording mode is switched, the playback picture will be blurred at the switching point.
- It is recommended that tapes recorded in the LP mode on this camcorder be played back on this camcorder.
- During playback of a tape recorded on another camcorder, blocks of noise may appear or there may be momentary pauses in the sound.

SOUND MODE

[12BIT]: Enables video recording of stereo sound on four separate channels, (equivalent to the 32 kHz mode of previous models)

16BIT: Enables video recording of stereo sound on two separate channels. (Equivalent to the 48 kHz mode of previous models)

DISPLAY

The "DISPLAY" settings except ("CLOCK ADJ.", "16:9 OUTPUT" and "BRIGHT") are effective only for shooting.

ON SCREEN

LCD: Keeps the camcorder's display (except the date, time and time code) from appearing on the connected TV screen.

[LCD/TV]: Makes the camcorder's display appear on screen when the camcorder is connected to a TV.

DATE/TIME

[OFF]: The date/time does not appear.

ON: The date/time is always displayed.

CLOCK ADJ.

☞ pg. 15, "Date/Time Settings"

TIME CODE

[OFF]: Time code is not displayed.

ON: Time code is displayed on the camcorder and on the connected TV. Frame numbers are not displayed during recording. (☞ pg. 20)

16:9 OUTPUT

To enable your tv to display images in 16:9 wide mode, set the tv screen size correctly.

4:3TV: For TV with an aspect ratio of 4:3.

[16:9TV]: For TV with an aspect ratio of 16:9.

BRIGHT

☞ pg. 15, "Brightness Adjustment Of The Display"

SYSTEM

The "SYSTEM" functions which are set when the Power Switch is set to "REC" are also applied when the Power switch is set to "PLAY".

LANGUAGE

[ENGLISH] / FRANCAIS / ESPAÑOL / ITALIANO / NEDERLANDS

The language setting can be changed. (☞ pg. 15)

MELODY

OFF: Even though not heard while shooting, shutter sound is recorded on the tape.

[ON]: A melody sounds when any operation is performed. It also activates the shutter sound effect. (☞ pg. 24, 29)

PRIORITY

[LCD]: The image is displayed on the LCD monitor when the viewfinder is pulled out while the LCD monitor is opened.

FINDER: The image is displayed in the viewfinder when the viewfinder is pulled out while the LCD monitor is opened.

DEMO MODE

OFF: Automatic demonstration will not take place.

[ON]: Demonstrates certain functions such as Wipe/Fader and Effect, etc., and can be used to confirm how these functions operate.

Demonstration starts in the following cases:

- When the Menu Screen is closed after "DEMO MODE" is turned "ON".
- With "DEMO MODE" set to "ON", if there is no operation for about 3 minutes after the Power Switch is set to "REC".
- Performing any operation during the demonstration stops the demonstration temporarily. If no operation is performed for more than 3 minutes after that, the demonstration will resume.

NOTES:

- If a cassette is in the camcorder, the demonstration cannot be turned on.
- "DEMO MODE" remains "ON" even if the camcorder power is turned off.

CAM RESET

[CANCEL]: Does not reset all settings to the factory-preset.

EXECUTE: Resets all settings to the factory-preset.

Playback Menus

VTR

The settings below are effective only for video playback.

SOUND L/R and NARRATION

During tape playback, the camcorder detects the sound mode in which the recording was made, and plays the sound back. Select the type of sound to accompany your playback picture.

NARRATION

[OFF]: Original sound is output on both "L" and "R" channels in stereo.

ON: Dubbed sound is output on both "L" and "R" channels in stereo.

MIX: Original and dubbed sounds are combined and output in stereo on both "L" and "R" channels.

SOUND L/R

[STEREO ]: Sound is output on both "L" and "R" channels in stereo.

SOUND L ]: Sound from the "L" channel is output.

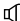
SOUND R ]: Sound from the "R" channel is output.

DISPLAY

Each setting (except "OFF" in "ON SCREEN", "DATE/TIME", and "TIME CODE") is linked with "DISPLAY", which appears when the Power Switch is set to "REC".

The parameters (except "OFF" in "ON SCREEN" setting) are the same as in the description on.

(☞ pg. 26)

ON SCREEN OFF / [LCD] / LCD/TV

When set to "OFF", the camcorder's display disappears.

DATE/TIME

[OFF]: The date/time does not appear.

ON: The date/time is always displayed.

CLOCK ADJ.

☞ pg. 15, "Date/Time Settings"

TIME CODE [OFF] / ON

☞ pg. 20, "Time Code"

16:9 OUTPUT 4:3TV / [16:9 TV]

☞ pg. 27, "16:9 OUTPUT"

BRIGHT

☞ pg. 15, "Brightness Adjustment Of The Display"

SYSTEM

Each setting (except "DEMO MODE") is linked with "SYSTEM", which appears when the Power Switch is set to "REC".

The parameters are the same as in the description on page. (☞ pg. 27)

Snapshot (Record Still Image On Tape)

This feature lets you record still images that look like photographs onto a tape.

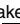
- 1 Set the Power Switch to "REC".
- 2 Press **SNAPSHOT**.
 - The "PHOTO" indication appears and a still image will be recorded for approx. 5 seconds, then the camcorder re-enters the Record-Standby mode.
 - You can perform Snapshot also during recording. A still image will be recorded for approx. 5 seconds, then the normal recording resumes.
 - If the image taken by snapshot is too dark or too bright, select  (☞ pg. 30) or "SPOTLIGHT". (☞ pg. 32)

Motor Drive Mode

Keeping **SNAPSHOT** pressed in step 2 provides an effect similar to serial photography. (Interval between still images: approx. 1 second)

Manual Focus

The camcorder's Full Range AF system offers continuous shooting ability from close-up (as close as approx. 5 cm to the subject) to infinity. However, correct focus may not be obtained depending on the shooting condition. In this case, use the manual focus mode.

- 1 Set the Power Switch to "REC".

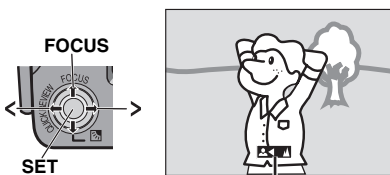

Manual focus indicator

- 2 Set the recording mode to "M". (☞ pg. 20)
- 3 Press **FOCUS**. The manual focus indicator appears.
- 4 Press > or < to focus on a subject.
 - When the focus level cannot be adjusted any further or closer, "▲" or "●" will blink.
- 5 Press **SET**. Focus adjustment is complete.

To reset to Auto Focus

Press **FOCUS** twice.

Manual focus is recommended in situations listed below.

- When two subjects overlap in the same scene.
 - When illumination is low.*
 - When the subject has no contrast (difference in brightness and darkness), such as a flat, one-colour wall, or a clear, blue sky.*
 - When a dark object is barely visible in the LCD monitor or the viewfinder.*
 - When the scene contains minute patterns or identical patterns that are regularly repeated.
 - When the scene is affected by sunbeams or light reflecting off the surface of a body of water.
 - When shooting a scene with a high-contrast background.
- * The following low-contrast warnings appear blinking: ▲, ◀, ▶ and ●.

Exposure Control

Manual exposure control is recommended in the following situations:

- When shooting using reverse lighting or when the background is too bright.
- When shooting on a reflective natural background such as at the beach or when skiing.
- When the background is overly dark or the subject is bright.

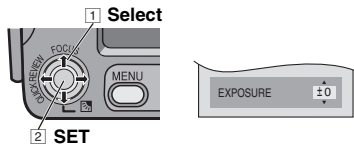

- 1 Open the LCD monitor fully.
- 2 Set the Power Switch to "REC"
- 3 Set the recording mode to "M". (☞ pg. 20)
- 4 Press **MENU**.
- 5 Select "FUNCTION", press **SET** or >.
- 6 Select "EXPOSURE", press **SET** or >.
- 7 Select the appropriate exposure, press **SET** or >.
 - To brighten the image, press ▲. To darken the image, press ▼, maximum +/-6.
- 8 Press **MENU**.

NOTES:

- If the adjustment does not cause any visible change in brightness, set "GAIN UP" to "AUTO". (☞ pg. 25)

- You cannot use the manual exposure control at the same time when "PROGRAM AE" is set to "SPOTLIGHT" or "SNOW" (☞ pg. 32), or with the backlight compensation.

Iris Lock

Like the pupil of the human eye, the iris contracts in well-lit environments to keep too much light from entering, and dilates in dim environments to allow in more light.

Use this function in the following situations:

- When shooting a moving subject.
- When the distance to the subject changes (so its size in the LCD monitor or the viewfinder changes), such as when the subject is backing away.
- When shooting on a reflective natural background such as at the beach or when skiing.
- When shooting objects under a spotlight.
- When zooming.

1 Perform steps **1 – 6** in "Exposure Control".

(☞ pg. 29)

2 Adjust zoom so that the subject fills the LCD monitor or the viewfinder, then press and hold **SET** or **>** for over 2 seconds. The "L" indication appear.

3 Press **SET** or **>**. The iris is locked.

4 Press **MENU**.

Backlight Compensation

Backlight compensation brightens the subject quickly.

With simple operation, backlight compensation feature brightens the dark subject portion by increasing the exposure.

1 Set the Power Switch to "REC".

2 Set the recording mode to "M". (☞ pg. 20)

3 Press **☒** so that the Backlight Compensation indicator "☒" appears.

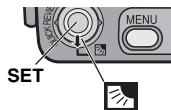

To cancel Backlight Compensation

Press **☒** twice so that the "☒" indicator disappears.

NOTE:

Using Backlight Compensation may cause the light around the subject to become too bright and the subject to become white.

Spot Exposure Control

Selection of a spot metering area enables more precise exposure compensation.

1 Set the Power Switch to "REC".

2 Set the recording mode to "M". (☞ pg. 20)

3 Press **☒** twice so that the Spot Exposure Control indicator "☒" appears.

- A spot metering area frame appears at the centre of the LCD monitor/viewfinder.

4 Press **SET**.

- Spot Exposure Control is engaged.
- Exposure is adjusted to make the brightness of the selected area most appropriate.

To lock the iris

After step **3**, press and hold **SET** over 2 seconds. The "L" indication appears and the iris is locked.

To cancel Spot Exposure Control

Press **☒** once so that the "☒" indicator disappears.

NOTES:

- Depending on the shooting location and condition, optimum result may not be attained.
- "STROBE" in "EFFECT" cannot be used with Spot Exposure Control.

White Balance Adjustment

The white balance refers to the correctness of colour reproduction under various lighting. If the white balance is correct, all other colours will be accurately reproduced.

The white balance is usually adjusted automatically. However, more advanced camcorder operators control this function manually to achieve a more professional colour/tint reproduction.

To change the setting

Set "W.BALANCE" to the desired mode.

- The selected mode indicator except "AUTO" appears.

[AUTO]: White balance is adjusted automatically.

 **MWB:** Adjust the white balance manually when shooting under various types of lighting. "Manual White Balance Adjustment" (⇨ pg. 31).

 **FINE:** Outdoors on a sunny day.

 **CLOUD:** Outdoors on a cloudy day.



 **HALOGEN:** A video light or similar type of lighting is used.

Manual White Balance Adjustment

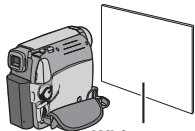
Adjust the white balance manually when shooting under various types of lighting.



White paper

- 1 Set the Power Switch to "REC".
- 2 Set the recording mode to "M". (⇨ pg. 20)
- 3 Hold a sheet of plain white paper in front of the subject. Adjust zoom or position yourself so that the white paper fills the screen.
- 4 Select "MWB" in "W.BALANCE" menu. (⇨ pg. 25), then press and hold **SET** or **>** until  begins blinking.
 - When the setting is completed,  stops blinking.
- 5 Press **SET** or **>** to engage the setting.
- 6 Press **MENU**. The Menu Screen closes and the Manual White Balance indicator  is displayed.

NOTES:

- In step 3, it may be difficult to focus on the white paper. In such a case, adjust focus manually. (⇨ pg. 29)

- Because the colour temperature is different depending on the light source, use this function for a more natural result.
- Once you adjust white balance manually, the setting is retained even if the power is turned off or the battery removed.
- White Balance cannot be activated simultaneously with "TWILIGHT" in "PROGRAM AE" (⇨ pg. 32).
- White Balance cannot be activated if the "SEPIA" or "MONOTONE" mode is activated.

Wipe Or Fader Effects

These effects let you make pro-style scene transitions. Use them to spice up the transition from one scene to the next.

Wipe or Fader works when video recording is started or stopped.

- 1 Set the Power Switch to "REC".
- 2 Set the recording mode to "M". (⇨ pg. 20)
- 3 Set "WIPE/FADER" in FUNCTION Menu. (⇨ pg. 25)
- 4 Press the Recording Start/Stop Button to activate the Fade-in/out or Wipe-in/out.

NOTE:

You can extend the length of a Wipe or Fader by pressing and holding the Recording Start/Stop Button.

WIPE/FADER

OFF: Disables the function. (Factory-preset)

WHITE : Fade in or out with a white screen.

BLACK : Fade in or out with a black screen.

SLIDE : Wipe in from right to left, or wipe out from left to right.

SCROLL : The scene wipes in from the bottom to the top of a black screen, or wipes out from top to bottom, leaving a black screen.

Program AE, Effects and Shutter Effects

- 1 Set the Power Switch to "REC".
- 2 Set the recording mode to "M". (➡ pg. 20)
- 3 Set "EFFECT", "PROGRAM AE" or "SHUTTER" in "FUNCTION" Menu. (➡ pg. 25)
 - The selected effect will be shown for approx. 2 seconds before the camcorder returns to the menu screen.

NOTES:

- Shutter Effects cannot be used during "NIGHT".
- When a subject is too bright or reflective, a vertical streak may appear (smear phenomenon). Smear phenomenon tends to occur when "SPORTS" or mode of "SHUTTER 1/500 and 1/4000" is selected.

PROGRAM AE

OFF: Disables the function. (Factory-preset)

SPORTS

(Variable Shutter Speed: 1/250 – 1/4000):

This setting allows fast-moving images to be captured one frame at a time, for vivid, stable slow-motion playback. The faster the shutter speed, the darker the picture becomes. Use the shutter function under good lighting conditions.

SNOW : Compensates for subjects that may otherwise appear too dark when shooting in extremely bright surroundings such as in the snow.

SPOTLIGHT : Compensates for subjects that may otherwise appear too bright when shooting under extremely strong direct lighting such as spotlights.

TWILIGHT : Makes evening scenes look more natural. White Balance (➡ pg. 31) is automatically set to "AUTO". When Twilight is chosen, the camcorder automatically adjusts the focus from approx. 10 m to infinity. From less than 10 m, adjust the focus manually.

NIGHT : Makes dark subjects or areas even brighter than they would be under good natural lighting. Although the recorded image is not grainy, it may look as if it is strobing due to the slow shutter speed.

During Night-Scope, it may be difficult to bring the camcorder into focus. To prevent this, use of a tripod is recommended.

EFFECT

OFF: Disables the function. (Factory-preset)

SEPIA : Recorded scenes have a brownish tint like old photos.

MONOTONE B/W: Like classic black and white films, your footage is shot in B/W.

CLASSIC : Gives recorded scenes a strobe effect.

STROBE : Your recording looks like a series of consecutive snapshots.

MIRROR : Creates a mirror image on the left half of the screen, juxtaposed to the normal image on the other half.

SHUTTER

OFF: Disables the function. (Factory-preset)

1/50 SHUTTER 1/50: The shutter speed is fixed at 1/50th of a second. Black bands that usually appear when shooting a TV screen become narrower.

1/120 SHUTTER 1/120: The shutter speed is fixed at 1/120th of a second. The flickering that occurs when shooting under a fluorescent light or mercury-vapour lamp is reduced.

SHUTTER 1/500 / SHUTTER 1/4000: (Refer to PROGRAM AE- SPORTS  mode).

Dubbing To A VCR

To use this camcorder as a player

- 1 Following the illustration, (⇨ pg. 23) "Connections To A TV Or VCR", connect the camcorder and the VCR's input connectors.
- 2 Perform steps 1 – 6. (⇨ pg. 23)
- 3 At the point you want to start dubbing, start recording on the VCR. (Refer to the VCR's instruction manual).
- 4 To stop dubbing, stop recording on the VCR, then stop playback on the camcorder.

NOTES:

- It is recommended to use the AC Adapter as the power supply instead of the battery pack. (⇨ pg. 14)
- To choose whether or not the following displays appear on the connected TV
 - Date/time
Set "DATE/TIME" to "ON" or "OFF". (⇨ pg. 24, 28)
 - Time code
Set "TIME CODE" to "OFF" or "ON". (⇨ pg. 24, 28)
 - Indications other than date/time and time code
Set "ON SCREEN" to "OFF", "LCD" or "LCD/TV". (⇨ pg. 24, 28)

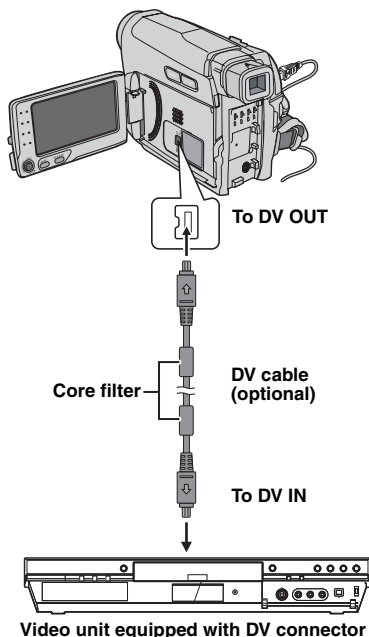

Dubbing To Or From A Video Unit Equipped With A DV Connector (Digital Dubbing)

It is also possible to copy recorded scenes from the camcorder onto another video unit equipped with a DV connector. Since a digital signal is sent, there is little, if any, image or sound deterioration.

To use this camcorder as a player

- 1 Make sure all units are turned off.
- 2 Connect this camcorder to a video unit equipped with a DV input connector using a DV cable as shown in the illustration.
- 3 Start playback on the camcorder. (⇨ pg. 21)
- 4 At the point you want to start dubbing, start recording on the video unit. (Refer to the video unit's instruction manual.)
- 5 To stop dubbing, stop recording on the video unit, then stop playback on this camcorder.

NOTES:

- It is recommended to use the AC Adapter as the power supply instead of the battery pack. (⇨ pg. 14)
- If a blank portion or disturbed image is played back on the player during dubbing, the dubbing may stop so that an unusual image is not dubbed.
- Even though the DV cable is connected correctly, sometimes the image may not appear in step 4. If this occurs, turn off the power and make connections again.
- When using a DV cable, be sure to use the optional JVC VC-VDV204U or VC-VDV206U DV cable.

Connection To A Personal Computer

It is also possible to transfer still/moving images to a PC with a DV connector by using the provided software, software equipped with the PC or commercially available software.

If you are using a Windows® XP, you can use Windows® Messenger to conduct video conferences over the Internet, using a camcorder. For details, refer to the help for the Windows® Messenger.

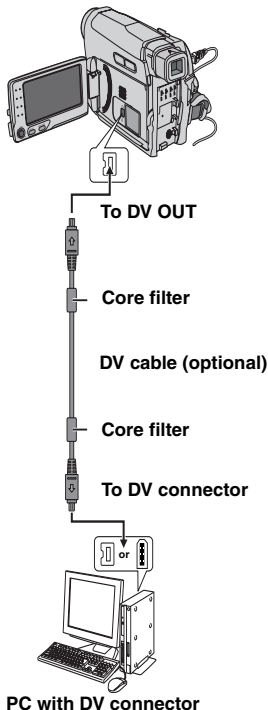

NOTES:

- It is recommended to use the AC Adapter as the power supply instead of the battery pack. (→ pg. 14)
- When using a DV cable, be sure to use the optional JVC VC-VDV206U or VC-VDV204U DV cable depending on the type of DV connector (4 or 6 pins) on the PC.
- The date/time information cannot be captured into the PC.
- Refer to the instruction manuals of the PC and Software.
- The still images can also be transferred to a PC with a DV connector-equipped capture board.
- The system may not work properly depending on the PC or capture board you are using.
- If, after connecting a DV cable to the camcorder and it doesn't work, restart the camcorder.

When connecting the camcorder to a PC using a DV cable, make sure to follow the procedure below. Connecting the cable incorrectly may cause malfunctions to the camcorder and/or the PC.

- Connect the DV cable first to the PC, and then to the camcorder.
- Connect the DV cable (plugs) correctly according to the shape of the DV connector.

If, after following the steps in the chart below, the problem still exists, please consult your nearest JVC dealer.

No power is supplied.

- The power is not connected properly.
- Connect the AC Adapter securely. (☞ pg. 14)
- The battery pack is not attached firmly.
- Detach the battery pack once again and re-attach it firmly. (☞ pg. 13)
- The battery is dead.
- Replace the dead battery with a fully charged one. (☞ pg. 13)

Recording cannot be performed.

- The tape's erase protection tab is set to "SAVE".
- Set the tape's erase protection tab to "REC". (☞ pg. 16)
- "TAPE END" appears.
- Replace with new cassette. (☞ pg. 16)
- The cassette holder cover is open.
- Close the cassette holder cover.

When shooting a subject illuminated by bright light, vertical lines appear.

This is not a malfunction.

When the screen is under direct sunlight during shooting, the screen becomes red or black for an instant.

This is not a malfunction.

The LCD monitor or viewfinder indications blink.

- Effects functions that cannot be used together are selected at the same time.
- Re-read the sections covering Effects. (☞ pg. 32)

The tape is moving, but there is no picture.

- Your TV has AV input terminals, but is not set to its VIDEO mode.
- Set the TV to the mode or channel appropriate for video playback. (☞ pg. 23)
- The cassette holder cover is open.
- Close the cassette holder cover. (☞ pg. 16)

Blocks of noise appear during playback, or there is no playback picture and the screen becomes blue.

Clean the video heads with an optional cleaning cassette. (☞ pg. 6)

The focus does not adjust automatically.

- Focus is set to the Manual mode.
- Set Focus to the Auto mode. (☞ pg. 29)
- The lens is dirty or covered with condensation.
- Clean the lens and check the focus again. (☞ pg. 6, 29)

The colour of Snapshot looks strange.

- The light source or the subject does not include white. Or there are various different light sources behind the subject.
- Find a white subject and compose your shot so that it also appears in the frame. (☞ pg. 29, 31)

The POWER/CHARGE lamp on the camcorder does not light during charging.

- Charging is difficult in places subject to extremely high/low temperatures.
- To protect the battery, it is recommended to charge it in places with a temperature of 10°C to 35°C. (☞ pg. 37)
- The battery pack is not attached firmly.
- Detach the battery pack once again and re-attach it firmly. (☞ pg. 13)

The image looks like the shutter speed is too slow.

- When shooting in the dark, the unit becomes highly sensitive to light when "GAIN UP" is set to "AUTO".
- If you want the lighting to look more natural, set "GAIN UP" to "AGC" or "OFF". (☞ pg. 25)

Images on the LCD monitor appear dark or whitish.

- In places subject to low temperature, images become dark due to the characteristics of the LCD monitor. This is not a malfunction.
- Adjust the brightness and angle of the LCD monitor. (☞ pg. 8, 15)
- When the LCD monitor's fluorescent light reaches the end of its service life, images on the LCD monitor become dark.
- Consult your nearest JVC dealer.

Picture does not appear on the LCD monitor.

- The viewfinder is pulled out and "PRIORITY" is set to "FINDER".
- Push the viewfinder back in or set "PRIORITY" to "LCD". (☞ pg. 8, 24, 27)
- The LCD monitor's brightness setting is too dark.
- Adjust the brightness of the LCD monitor. (☞ pg. 15)
- If the monitor is tilted upward 180 degrees, open the monitor fully. (☞ pg. 8)

Aspect ratio is strange.

If the aspect ratio of the video you are playing is strange, change the setting in "16:9 OUTPUT". (☞ pg. 26, 28)





Displays the battery remaining power.

Remaining power level



High

Exhausted

As the battery power comes close to nil, the battery remaining power indicator blinks.

When the battery power is exhausted, power turns off automatically.

TAPE END

Appears when the tape ends during recording or playback.

LENS CAP

Appears for 5 seconds after power is turned on if the lens cap is attached or when it is dark.

SET DATE/TIME!

- Appears when the date/time is not set. (☞ pg. 15)
 - The built-in clock battery has run out and the previously set date/time has been erased.
- Consult your nearest JVC dealer for replacement.

UNIT IN SAFEGUARD MODE REMOVE AND REATTACH BATTERY OR DC PLUG

Error indications (01, 02 or 06).

Remedy: Remove and reattach the power supply or battery.

UNIT IN SAFEGUARD MODE EJECT AND REINSERT TAPE

Error indications 03 or 04.

Remedy: Eject the cassette and re-insert.

In the above 2 error indications, the camcorder turns off automatically. Eject the cassette once and re-insert it, then check if the indication clears. When it does, you can resume using the camcorder. If the indication remains, consult your nearest JVC dealer.

Battery Packs

The supplied battery pack is a lithium-ion battery. Before using the supplied battery pack or an optional battery pack, be sure to read the following cautions:

Terminals

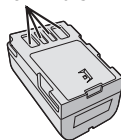

● To avoid hazards

- ...do not burn.
- ...do not short-circuit the terminals. When transporting, make sure the provided battery cap is attached to the battery. If the battery cap is misplaced, carry the battery in a plastic bag.
- ...do not modify or disassemble.
- ...do not expose the battery to temperatures exceeding 60°C, as this may cause the battery to overheat, explode or catch fire.
- ...use only specified chargers.

● To prevent damage and prolong service life

- ...do not subject to unnecessary shock.
- ...charge in an environment where temperatures are within the tolerances shown in the chart below. This is a chemical reaction type battery - cooler temperatures impede chemical reaction, while warmer temperatures can prevent complete charging.
- ...store in a cool, dry place. Extended exposure to high temperatures will increase natural discharge and shorten service life.
- ...fully charge and then fully discharge the battery every 6 months when storing the battery pack over a long period time.
- ...remove from charger or powered unit when not in use, as some machines use current even when switched off.

The Benefits Of Lithium-Ion Batteries

Lithium-ion battery packs are small but have a large power capacity. However, when one is exposed to cold temperatures (below 10°C), its usage time becomes shorter and it may cease to function. If this happens, place the battery pack in your pocket or other warm, protected place for a short time, then re-attach it to the camcorder.

NOTES:

- It is normal for the battery pack to be warm after charging, or after use.

Temperature Range Specifications

Charging: 10°C to 35°C

Operation: 0°C to 40°C

Storage: -20°C to 50°C

- The lower the temperature, the longer recharging takes.
- Charging times are for a fully discharged battery pack.

Cassettes

To properly use and store your cassettes, be sure to read the following cautions:

● During use

- ... make sure the cassette bears the Mini DV mark.
- ... be aware that recording onto prerecorded tapes automatically erases the previously recorded video and audio signals.
- ... make sure the cassette is positioned properly when inserting.
- ... do not load and unload the cassette repeatedly without allowing the tape to run at all. This slackens the tape and can result in damage.
- ... do not open the front tape cover. This exposes the tape to fingerprints and dust.

● Store cassettes

- ... away from heaters or other heat sources.
- ... out of direct sunlight.
- ... where they won't be subject to unnecessary shock or vibration.
- ... where they won't be exposed to strong magnetic fields (such as those generated by motors, transformers or magnets).
- ... vertically, in their original cases.

LCD Monitor**● To prevent damage to the LCD monitor, DO NOT**

- ... push it strongly or apply any shocks.
- ... place the camcorder with the LCD monitor on the bottom.

● To prolong service life

- ... avoid rubbing it with coarse cloth.

● Be aware of the following phenomena for LCD monitor use. These are not malfunctions

- ... While using the camcorder, the surface around the LCD monitor and/or the back of the LCD monitor may heat up.
- ... If you leave power on for a long time, the surface around the LCD monitor becomes hot.

Main Unit**● For safety, DO NOT**

- ... open the camcorder's chassis.
- ... disassemble or modify the unit.
- ... short-circuit the terminals of the battery pack. Keep it away from metallic objects when not in use.
- ... allow inflammables, water or metallic objects to enter the unit.
- ... remove the battery pack or disconnect the power supply while the power is on.
- ... leave the battery pack attached when the camcorder is not in use.

● Avoid using the unit

- ... in places subject to excessive humidity or dust.
- ... in places subject to soot or steam such as near a cooking stove.
- ... in places subject to excessive shock or vibration.
- ... near a television set.
- ... near appliances generating strong magnetic or electric fields (speakers, broadcasting antennas, etc.).
- ... in places subject to extremely high (over 40°C) or extremely low (under 0°C) temperatures.

● DO NOT leave the unit

- ... in places of over 50°C.
- ... in places where humidity is extremely low (below 35%) or extremely high (above 80%).
- ... in direct sunlight.
- ... in a closed car in summer.
- ... near a heater.

● To protect the unit, DO NOT

- ... allow it to become wet.
- ... drop the unit or strike it against hard objects.
- ... subject it to shock or excessive vibration during transportation.
- ... keep the lens directed at extremely bright objects for long periods.
- ... expose the lens and viewfinder's lens to direct sunlight.
- ... carry it by holding the LCD monitor or the viewfinder.
- ... swing it excessively when using the hand strap or the grip.
- ... swing the soft camera case excessively when the camcorder is inside it.

- **Dirty heads can cause the following problems:**



- ... No picture during playback.
 - ... Blocks of noise appear during playback.
 - ... During recording or playback, the Head Clog Warning indicator "X" appears.
 - ... Recording cannot be performed properly.
- In such cases, use an optional cleaning cassette. Insert it and play back. If the cassette is used more than once consecutively, damage to the video heads may result. After the camcorder plays back for about 20 seconds, it stops automatically. Also refer to the cleaning cassette's instructions.

If, after using the cleaning cassette, the problems still exist, consult your nearest JVC dealer.

Mechanical moving parts used to move the video heads and video tape tend to become dirty and worn out over time. In order to maintain a clear picture at all times, periodic check-ups are recommended after using the unit for about 1,000 hours. For periodic check-ups please consult your nearest JVC dealer.

About moisture condensation

- You have observed that pouring a cold liquid into a glass will cause drops of water to form on the glass' outer surface. This same phenomenon occurs on the head drum of a camcorder when it is moved from a cool place to a warm place, after heating a cold room, under extremely humid conditions or in a place directly subjected to the cool air from an air conditioner.
- Moisture on the head drum can cause severe damage to the video tape, and can lead to internal damage to the camcorder itself.

CONDENSATION, OPERATION PAUSED PLEASE WAIT

Appears if condensation occurs. When this indication is displayed, wait more than 1 hour until condensation disappears.

Serious malfunctioning

If malfunctioning occurs, stop using the unit immediately and consult your local JVC dealer.

The camcorder is a microcomputer-controlled device. External noise and interference (from a TV, a radio, etc.) might prevent it from functioning properly. In such cases, first disconnect its power supply unit (battery pack, AC Adapter, etc.) and wait a few minutes and then re-connect it and proceed as usual from the beginning.

Camcorder

For General

Power supply

DC 11 V (Using AC Adapter)
DC 7.2 V (Using battery pack)

Power consumption

Approx. 2.2 W (LCD monitor off, viewfinder on)
Approx. 2.7 W (LCD monitor on, viewfinder off)

Dimensions (W x H x D)

61 mm x 94 mm x 114 mm (with the LCD monitor closed and the viewfinder pushed back in)

Weight

Approx. 410 g (without battery, cassette and lens cap)
Approx. 480 g (incl. battery, cassette and lens cap)

Operating temperature

0°C to 40°C

Operating humidity

35% to 80%

Storage temperature

-20°C to 50°C

Pickup

1/6" CCD

Lens

GR-D740EK
F 2.0, $f = 2.3$ mm to 78.2 mm, 34:1 power zoom lens
GR-D720EK
F 2.0, $f = 2.3$ mm to 64.4 mm, 28:1 power zoom lens

Filter diameter

ø27 mm

LCD monitor

2.7" diagonally measured, LCD panel/TFT active matrix system

Viewfinder

GR-D740EK
Electronic viewfinder with 0.33" colour LCD
GR-D720EK
Electrical viewfinder with 0.33" black/white LCD

Speaker

Monaural

For Digital Video Camera

Format

DV format (SD mode)

Signal format

PAL standard

Recording/Playback format

Video: Digital component recording
Audio: PCM digital recording, 32 kHz 4-channel (12-BIT), 48 kHz 2-channel (16-BIT)

Cassette

Mini DV cassette

Tape speed

SP: 18.8 mm/s, LP: 12.5 mm/s

Maximum recording time (using 80 min. cassette)

SP: 80 min., LP: 120 min.

For Connectors

S*

S-Video output:

Y: 1.0 V (p-p), 75 Ω , analogue
C: 0.30 V (p-p), 75 Ω , analogue

AV

Video output: 1.0 V (p-p), 75 Ω , analogue

Audio output: 300 mV (rms), 1 k Ω , analogue, stereo

DV

Output: 4-pin, IEEE 1394 compliant

* For GR-D740EK only

AC Adapter

Power requirement

AC 110 V to 240 V \sim , 50 Hz/60 Hz

Output

DC 11 V --- , 1 A

Specifications shown are for SP mode unless otherwise indicated. E & O.E. Design and specifications subject to change without notice.

A		N	
AC Adapter	14	Narration	27
Auto/Manual Mode	20	Night-Scope	32
B		P	
Backlight Compensation	30	Playback Sound	27
Battery Pack	13, 14, 36	Power-linked operation	8
Blank Search	22	Priority	27
Bright	15, 26, 28	Program AE	32
C		Q	
Cam Reset	27	Quick Review	20
Changing The Menu Settings	24 – 28	R	
Charging The Battery Pack	13	Rec Mode	26
Connection To A Personal Computer	34	Recording Capacity	
Connections To A TV Or VCR	22	Tape	18
Control Lever	11	S	
D		Shutter Effect	32
Data Battery	14	Sound L/R	27
Date/Time Settings	15	Sound Mode	26, 27
Demonstration Mode	27	Speaker Volume	21
Digital Image Stabilisation (DIS)	25	Specifications	39
Dubbing	33	Spot Exposure Control	30
E		T	
Effect	32	Tape Speed (REC MODE)	26
Exposure Control	29	Tele Macro	25
G		Telephoto Shooting	19
Gain Up	25	Time Code	20, 26, 28
I		Tripod Mounting	16
Interface Shooting	19	Troubleshooting	35 – 36
Iris Lock	30	W	
J		White Balance	31
Journalistic Shooting	19	Wind Cut	25
L		Wipe Or Fader Effects	31
Language	15, 27	Z	
LCD Monitor and Viewfinder	8, 15	Zooming	19, 25
Loading A Cassette	16	16:9 Wide Mode	17, 26, 28
M			
Manual Focus	29		
Melody	27		
Motor Drive Mode	29		

JVC