

# JVC

LYT2147-001B-M

CAMCORDER

**GZ-HM330SEK/BEK**

**GZ-HM310BEK**

**GZ-HM300SEK**

## ***Basic User Guide***

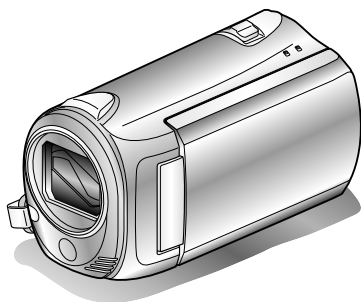

# Everio

### **Dear Customers**

Thank you for purchasing this JVC product.

Before use, please read the Safety Precautions and Cautions on P.2 and P.25 to ensure safe use of this product.

Some features explained in this manual only apply to the specific camera model identified.

This product comes with a "Basic User Guide" (this manual) and a "Detailed User Guide".

Detailed User Guide



Explains the ways of shooting in various situations and the useful features.

■ **Access the following website on your PC**

<http://manual.jvc.co.jp/index.html/>

Getting Started

Recording

Playback

Copying

Others



**DOLBY**  
DIGITAL  
STEREO CREATOR

**HDMI**<sup>TM</sup>  
HIGH-DEFINITION MULTIMEDIA INTERFACE

**AVCHD** <sup>TM</sup>

ENGLISH

# Safety Precautions

## **IMPORTANT (for owners in the U.K.) Connection to the mains supply in the United Kingdom.**

**DO NOT cut off the mains plug from this equipment.**

If the plug fitted is not suitable for the power points in your home or the cable is too short to reach a power point, then obtain an appropriate safety approved extension lead or consult your dealer.

**BE SURE to replace the fuse only with an identical approved type, as originally fitted, and to replace the fuse cover.**

If nonetheless the mains plug is cut off be sure to remove the fuse and dispose of the plug immediately, to avoid possible shock hazard by inadvertent connection to the mains supply.

If this product is not supplied fitted with a mains plug then follow the instructions given below: **DO NOT** make any connection to the Larger Terminal coded E or Green.

The wires in the mains lead are coloured in accordance with the following code:

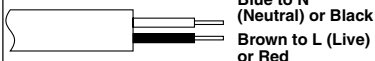

If these colours do not correspond with the terminal identifications of your plug, connect as follows:

Blue wire to terminal coded N (Neutral) or coloured black. Brown wire to terminal coded L (Live) or coloured Red. If in doubt — consult a competent electrician.

## **WARNING: TO PREVENT FIRE OR SHOCK HAZARD, DO NOT EXPOSE THIS UNIT TO RAIN OR MOISTURE.**

### **CAUTIONS:**

- To prevent shock, do not open the cabinet. No user serviceable parts inside. Refer servicing to qualified personnel.
- When you are not using the AC adapter for a long period of time, it is recommended that you disconnect the power cord from AC outlet.

### **NOTES:**

- The rating plate and safety caution are on the bottom and/or the back of the main unit.
- The serial number plate is on the battery pack mount.
- The rating information and safety caution of the AC adapter are on its upper and lower sides.

### **WARNING:**

The battery pack and this unit with battery installed should not be exposed to excessive heat such as direct sunlight, fire or the like.

When the equipment is installed in a cabinet or on a shelf, make sure that it has sufficient space on all sides to allow for ventilation (10 cm or more on both sides, on top and at the rear). Do not block the ventilation holes.

(If the ventilation holes are blocked by a newspaper, or cloth etc. the heat may not be able to get out.) No naked flame sources, such as lighted candles, should be placed on the apparatus.

When discarding batteries, environmental problems must be considered and the local rules or laws governing the disposal of these batteries must be followed strictly.

The apparatus shall not be exposed to dripping or splashing.

Do not use this equipment in a bathroom or places with water.

Also do not place any containers filled with water or liquids (such as cosmetics or medicines, flower vases, potted plants, cups etc.) on top of this unit. (If water or liquid is allowed to enter this equipment, fire or electric shock may be caused.)

Do not point the lens directly into the sun. This can cause eye injuries, as well as lead to the malfunctioning of internal circuitry. There is also a risk of fire or electric shock.

### **CAUTION!**

The following notes concern possible physical damage to this unit and to the user.

Carrying or holding this unit by the LCD monitor can result in dropping the unit, or in a malfunction.

Do not use a tripod on unsteady or uneven surfaces. It could tip over, causing serious damage to the unit.

### **CAUTION!**

Connecting cables (Audio/Video, S-Video, etc.) to this unit and leaving it on top of the TV is not recommended, as tripping on the cables will cause the unit to fall, resulting in damage.

### **CAUTION:**

To avoid electric shock or damage to the unit, first firmly insert the small end of the power cord into the AC Adapter until it is no longer wobbly, and then plug the larger end of the power cord into an AC outlet.

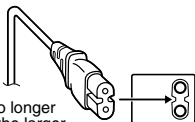

### **CAUTION:**

The mains plug shall remain readily operable.

- Remove the mains plug immediately if this unit functions abnormally.

## SOME DO'S AND DON'TS ON THE SAFE USE OF EQUIPMENT

This equipment has been designed and manufactured to meet international safety standards but, like any electrical equipment, care must be taken if you are to obtain the best results and safety is to be assured.

**DO** read the operating instructions before you attempt to use the equipment.

**DO** ensure that all electrical connections (including the mains plug, extension leads and interconnections between pieces of equipment) are properly made and in accordance with the manufacturer's instructions. Switch off and withdraw the mains plug when making or changing connections.

**DO** consult your dealer if you are ever in doubt about the installation, operation or safety of your equipment.

**DO** be careful with glass panels or doors on equipment.

**DON'T** continue to operate the equipment if you are in any doubt about it working normally, or if it is damaged in any way — switch off, withdraw the mains plug and consult your dealer.

**DON'T** remove any fixed cover as this may expose dangerous voltages.

**DON'T** leave equipment switched on when it is unattended unless it is specifically stated that it is designed for unattended operation or has a standby mode. Switch off using the switch on the equipment and make sure that your family knows how to do this. Special arrangements may need to be made for infirm or handicapped people.

**DON'T** use equipment such as personal stereos or radios so that you are distracted from the requirements of road safety. It is illegal to watch television whilst driving.

**DON'T** listen to headphones at high volume, as such use can permanently damage your hearing.

**DON'T** obstruct the ventilation of the equipment, for example with curtains or soft furnishings. Overheating will cause damage and shorten the life of the equipment.

**DON'T** use makeshift stands and NEVER fix legs with wood screws — to ensure complete safety always fit the manufacturer's approved stand or legs with the fixings provided according to the instructions.

**DON'T** allow electrical equipment to be exposed to rain or moisture.

### ABOVE ALL

- NEVER let anyone especially children push anything into holes, slots or any other opening in the case — this could result in a fatal electrical shock;
- NEVER guess or take chances with electrical equipment of any kind — it is better to be safe than sorry!

**Remember that this unit is intended for private consumer use only.**

Any commercial use without proper permission is prohibited. (Even if you record an event such as a show, performance or exhibition for personal enjoyment, it is strongly recommended that you obtain permission beforehand.)

### Trademarks

- AVCHD and AVCHD logotype are trademarks of Panasonic Corporation and Sony Corporation.
- x.v.Colour™ is a trademark of Sony Corporation.
- HDMI is a trademark of HDMI Licensing, LLC.
- Manufactured under license from Dolby Laboratories. Dolby and the double-D symbol are trademarks of Dolby Laboratories.
- Windows® is either registered trademark or trademark of Microsoft Corporation in the United States and/or other countries.
- Macintosh is a registered trademark of Apple Inc.
- iTunes, iMovie, iPhoto are trademarks of Apple Inc., registered in the U.S. and other countries.
- YouTube™ and the YouTube logo are trademarks and/or registered trademarks of YouTube LLC.
- Other product and company names included in this instruction manual are trademarks and/or registered trademarks of their respective holders.

### CAUTION:

- Fire or injury may result if batteries NOT approved by JVC are used. Only use the batteries specified on page 20.
- Please do not pull or bend the AC adapter plug and cable. This may damage the AC adapter.

### Make a backup of important recorded data

JVC will not be responsible for any lost data. It is recommended to copy your important recorded data to a disc or other recording media for storage.

# Contents

Safety Precautions .....	2	▶ Playback .....	15
Contents .....	4	Playing Back/Deleting Files on this Unit .....	15
Verifying the Accessories .....	4	Playing Back on TV .....	16
Names of Parts and Functions .....	5	▶ Copying .....	18
▶ Getting Started .....	6	Dubbing Files by Connecting to a DVD Recorder or VCR .....	18
Charging the Battery Pack .....	6	▶ Others .....	19
Grip Adjustment .....	7	Using the Menu .....	19
Attaching the Lens Cap (GZ-HM300/GZ-HM310) .....	7	Recordable Time/Number of Images .....	20
Inserting an SD card .....	8	Troubleshooting .....	21
Clock Setting .....	11	Cautions .....	25
▶ Recording .....	13	Specifications .....	27
Video Recording .....	13		
Still Image Recording .....	14		
▶ Learning About Advanced Operations			
Use the "Detailed User Guide" on your PC to find out more about the advanced operations.			

■ Access the following address on your PC  
<http://manual.jvc.co.jp/index.html/>

## Verifying the Accessories

AC Adapter  
AP-V30M \*1

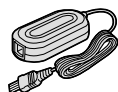

Power Cord \*1



Battery Pack  
BN-VG114E



USB Cable  
(Type A - Mini Type B)



AV Cable

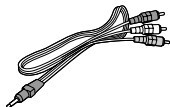

Basic User Guide  
(this manual)

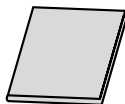

- CD-ROM \*2
- Component Cable (GZ-HM330)
- Lens Cap (GZ-HM300/GZ-HM310)

- SD cards are sold separately.  
For details on the types of cards that can be used on this unit, refer to P.9.

- \*1 When using the AC adapter overseas, please prepare a commercially available converter plug for the country or region of visit.
- \*2 To use the CD-ROM, refer to the "Installing the Provided Software" section in the "Detailed User Guide".

# Names of Parts and Functions

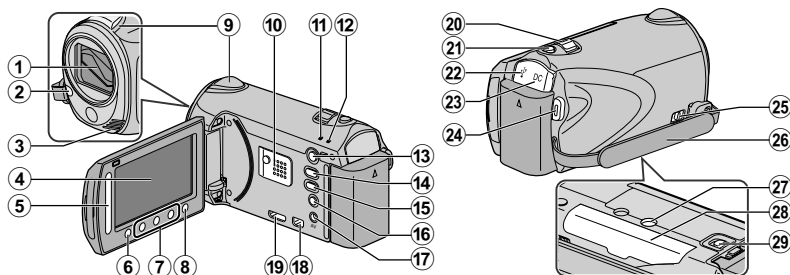

- ① Lens/Lens Cover \*
- ② Light \*
- ③ Stereo Microphone
- ④ LCD Monitor  
Turns the power on/off by opening and closing.
- ⑤ Slider  
Selects an image or item.
- ⑥ **OK** Button  
Confirms the selected image or item.
- ⑦ Operation Buttons  
Functions differently according to the operation.
- ⑧ **Menu** (menu) Button ( P.19)
- ⑨ Camera Sensor
- ⑩ Speaker
- ⑪ ACCESS (Access) Lamp  
Lights up/blinks during recording or playback.
- ⑫ POWER/CHARGE (Power/Charge) Lamp ( P.6)
- ⑬ **Play/Record Mode** Button  
Switches between recording and playback modes.
- ⑭ **Video/Still Image** Button  
Switches between video and still image modes.
- ⑮ **UPLOAD/EXPORT\*** (Upload/Export to iTunes\*) Button  
Recording : Takes videos in YouTube™ or iTunes\* format.

Playback : Changes the video to YouTube™ or iTunes\* format.

- ⑯ **Power/Information** Button  
Recording : Displays the remaining time as well as the battery power during continuous recording.  
Playback : Displays file information. Press and hold to turn the power on/off while the LCD monitor is opened.

- ⑰ AV Terminal ( P.16, P.18)
- ⑱ COMPONENT (Component) Connector ( P.16)
- ⑲ HDMI Mini Connector ( P.16)
- ⑳ Zoom/Volume Lever ( P.13, P.15)
- ㉑ **SNAPSHOT** (Still Image Recording) Button ( P.14)
- ㉒ USB Terminal
- ㉓ DC Terminal ( P.6)
- ㉔ **START/STOP** (Video Recording) Button ( P.13)
- ㉕ Grip Belt Release Lever
- ㉖ Grip Belt ( P.7)
- ㉗ Tripod Mounting Hole
- ㉘ SD Card Slot ( P.8)
- ㉙ Battery Release Lever ( P.6)

\* For GZ-HM330 only.

## Charging the Battery Pack

### 1 Attach the battery pack.

\* The battery pack is not charged at the time of purchase.

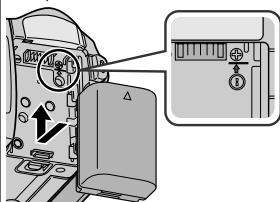

- Align the top of the battery with the mark on this unit, and slide in until the battery clicks into place.

### ■ To detach the battery pack

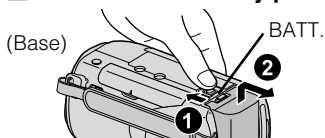

### 2 Connect the DC terminal.

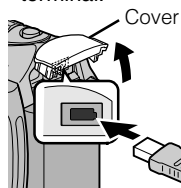

Charging Lamp

AC Adapter  
To AC Outlet  
(110V to 240V)

### 3 Plug in the power.

Charging Lamp



Charging in progress:  
Blinks  
Charging finished:  
Goes out

### CAUTION

Be sure to use JVC battery packs.

- If you use any other battery packs besides JVC battery packs, safety and performance cannot be guaranteed.
- Charging time: Approx. 2 h 30 m (using supplied battery pack)
- \* The charging time is when the unit is used at 25°C. If the battery pack is charged outside the room temperature range of 10°C - 35°C, charging may take a longer time or it may not start. The recordable and playable time may also be shortened under some usage conditions such as at low temperature.

# Grip Adjustment

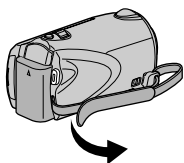

① Pull back the belt

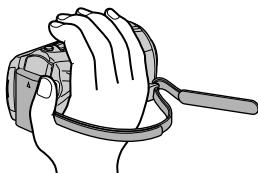

② Adjust the length



③ Attach the belt

## Using as a Hand Strap

Remove the strap and loop it around your wrist. While pressing ①, pull ② and remove the strap.

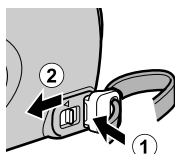

① Press and hold

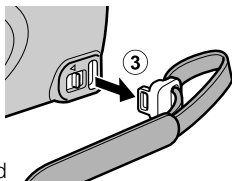

③

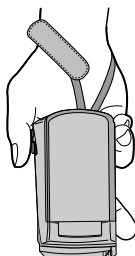

- When attaching the hand strap, insert ③ until it clicks into place.

## Attaching the Lens Cap (GZ-HM300/GZ-HM310)

Damage may occur to the lens if this unit is stored without the lens cap attached.

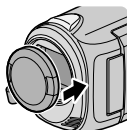

### CAUTION

- Please be careful not to lose the lens cap.

# Inserting an SD card

## ■ GZ-HM330 (Models with Internal Memory)

When a commercially available SD card is inserted, recordings can still be made to the card without stopping when the remaining recording time on the internal memory runs out.

1 Close the LCD monitor.

(Base)

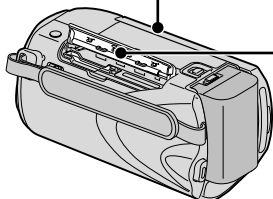

\*Turn off the power of the unit before inserting or removing a card.

2 Open the cover.

3 Insert an SD card.

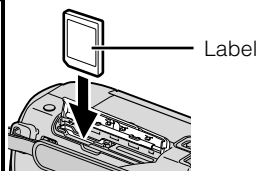

## ■ GZ-HM300/GZ-HM310 (Models with Dual Slot)

Insert a commercially available SD card before recording.

This unit comes with two SD card slots. When two SD cards are inserted, recordings can be continued on the other card even if one card is full.

1 Close the LCD monitor.

(Base)

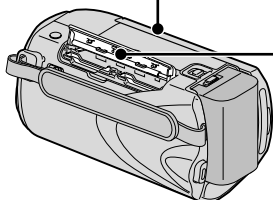

\*Turn off the power of this unit before inserting or removing a card.

2 Open the cover.

3 Insert an SD card into slot A.

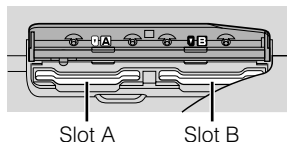
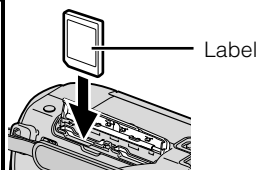



## ■ To remove the card

Push the card inward once, then pull it out straight.

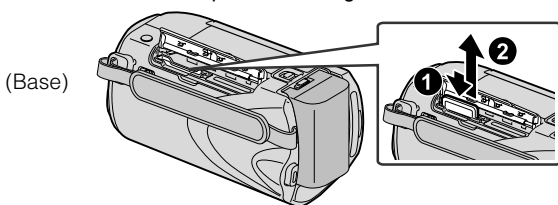

### NOTE

Operations are confirmed on the following SD cards.

Manufacturer	Panasonic, TOSHIBA, SanDisk, ATP
Video	Class 4 or higher compatible SDHC card (4 GB to 32 GB)
Still Image	SD card (256 MB to 2 GB), SDHC card (4 GB to 32 GB)

- Using cards other than those specified above may result in recording failure or data loss.

## ■ To use an SD card

Recording and playback can be performed on a card when “REC MEDIA FOR VIDEO” or “REC MEDIA FOR IMAGE” of media settings is set to “SD CARD”. (GZ-HM330 only)

- For GZ-HM300/GZ-HM310, set “VIDEO SLOT SELECTION” to “SLOT A” or “SLOT B”.

- ① Display the menu.

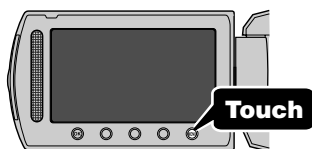

- ② Select “MEDIA SETTINGS” and touch **OK**.



- ③ Select “REC MEDIA FOR VIDEO” or “REC MEDIA FOR IMAGE”, and touch **OK**.



- ④ Select “SD CARD” and touch **OK**.

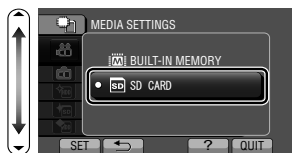

## ■ To use SD cards that have been used on other devices

Format (initialize) the card using “FORMAT SD CARD” from media settings.

**All data on the card will be deleted when it is formatted. Copy all files on the card to a PC before formatting.**

- ① Touch **MENU** to display the menu.
- ② Select “MEDIA SETTINGS” with the slider and touch **OK**.
- ③ Select “FORMAT SD CARD” and touch **OK**.



- ④ (GZ-HM300/GZ-HM310 only) Select the slot inserted with the card to be formatted, and touch **OK**.

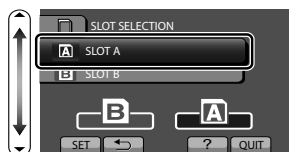

- ⑤ Select “FILE” and touch **OK**.



- ⑥ Select “YES” and touch **OK**.
- ⑦ After formatting, touch **OK**.

# Clock Setting

- 1** Open the LCD monitor.

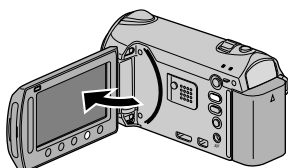

- The unit turns on. When the LCD monitor is closed, the unit turns off.

- 2** Select "YES" and touch **OK** when "SET DATE/TIME!" is displayed.

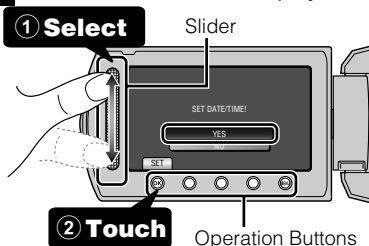

- Slide along the slider to select, then touch the operation buttons to set.

- 3** Set the date and time.

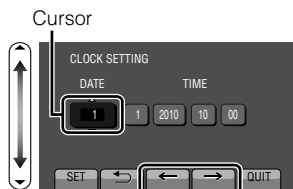

- Use the slider to adjust the year, month, day, hour and minute.
- Touch the operation buttons "←" / "→" to move the cursor.

- 4** After setting the date and time, touch **OK**.

- 5** Select the region where you live and touch **OK**.

- The city name and time difference is displayed.



## NOTE

- Touch the slider and buttons around the screen with your fingers.
- The slider and buttons do not function if you touch them with your fingernails or with gloves on.
- The displays on the screen do not work even if you touch them.
- "SET DATE/TIME!" is displayed when you turn on this unit after it has not been used for a prolonged period. Charge this unit for more than 24 hours before setting the clock. ( P.6)

## ■ To reset the clock

Set the clock with "CLOCK ADJUST" from the menu.

- ① Display the menu.

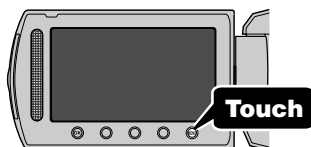

- ② Select "CLOCK ADJUST" and touch **OK**.



- ③ Select "CLOCK SETTING" and touch **OK**.

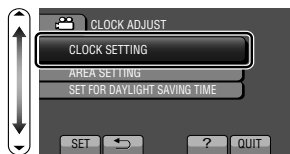

- The subsequent setting operations are the same as steps 3 - 5 on the previous page.

## ■ To change the display language

The language on the display can be changed.

- ① Display the menu.

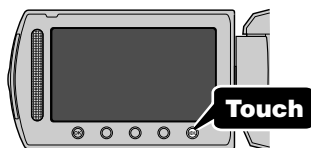

- ② Select "DISPLAY SETTINGS" and touch **OK**.



- ③ Select "LANGUAGE" and touch **OK**.



- ④ Select the desired language and touch **OK**.
- ⑤ Touch **MENU** to exit.

## Video Recording

You can record without worrying about the setting details by using the auto mode.  
**Before recording an important scene, it is recommended to conduct a trial recording.**

**1** Open the LCD monitor.

- For GZ-HM300/GZ-HM310, remove the lens cap.

**2** Select video mode.



**3** Check if the recording mode is **A** Auto.

- If the mode is **M** Manual, touch the **A/M** button to switch.
- The mode changes between auto and manual with every touch.

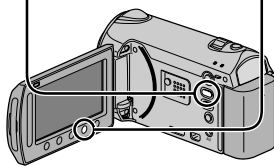
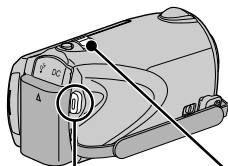
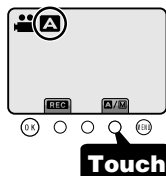

Zooming

**4** Start recording.

START/STOP

- Press again to stop.



(Wide angle)

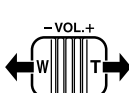

(Telephoto)

### ■ Indications during video recording

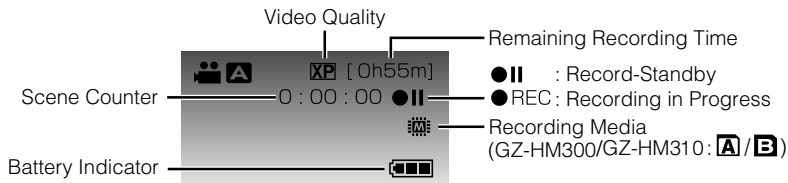

#### NOTE

- The estimated recording time of the supplied battery pack is approximately 55 minutes (GZ-HM300/GZ-HM310 : 1 hour). ( P.20)

## Reducing Camera Shake (Video Recording)

When the image stabilizer is set, camera shake during recording can be effectively reduced.

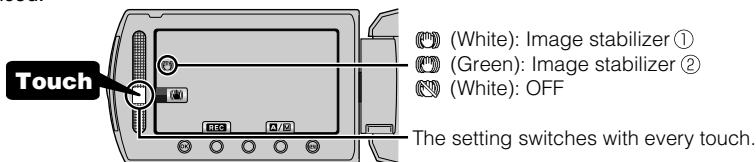

- ① : Reduces camera shake under normal shooting conditions.
- ② : Reduces camera shake more effectively when shooting bright scenes on the wide angle end. Only on the wide angle end (approx. 5x).

### NOTE

- It is recommended to set the image stabilizer to off when shooting a subject of little movement with the unit on a tripod.
- Complete stabilization may not be possible if camera shake is excessive.

## Still Image Recording

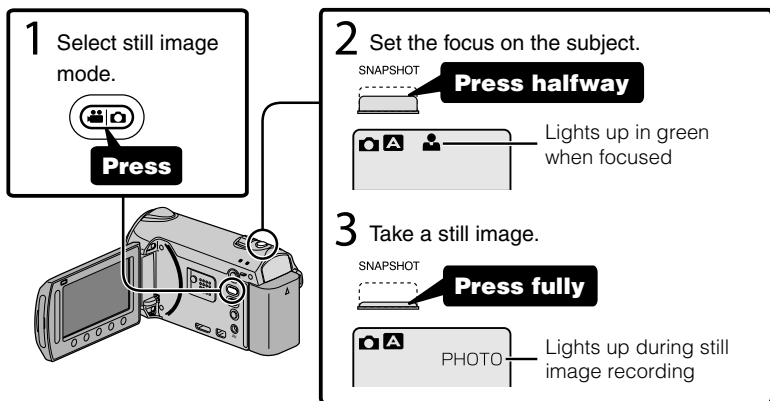

### ■ Indications during still image recording

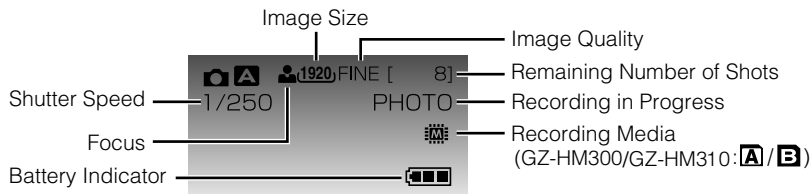

## Playing Back/Deleting Files on this Unit

Select and play back the recorded videos or still images from an index screen (thumbnail display). The contents of the media selected in media settings ( P.10) are displayed on the index screen.

- 1 Select the playback mode.



**Press**

- 2 Select video or still image mode.



**Press**

- 3 Play back a file.

Media being played back

- 1 **Select**



- 2 **Touch**

- Touch to stop.

Volume adjustment during video playback

Turn down the volume



Turn up the volume

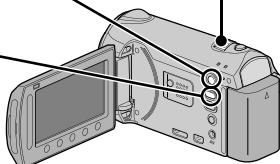

### ■ To delete unwanted files

- 1 **Select**



- 2 **Touch**

- Select "YES" when the confirmation message appears and touch .

### ■ To capture a still image during playback

Pause the playback and press the SNAPSHOT button.

### ■ Usable operation buttons during playback

Display	During video playback	During still image playback
	Playback/pause	Start/pause slideshow
	Stop (returns to thumbnail display)	Stop (returns to thumbnail display)
	Advances to the next video	Advances to the next still image
	Returns to the beginning of the scene	Returns to the previous still image
	Forward search	-
	Reverse search	-
	Forward slow-motion	-
	Reverse slow-motion	-

# Playing Back on TV

## 1 Connect to a TV.

Refer also to the instruction manual of the TV.

\*\* The component cable recommended is QAM1266-001.

- Press the Power button (⏻) for more than 2 seconds to turn off this unit.

### To connect using the HDMI mini connector

If you are using an HDTV, you can play back in HD quality by connecting to the HDMI terminal.

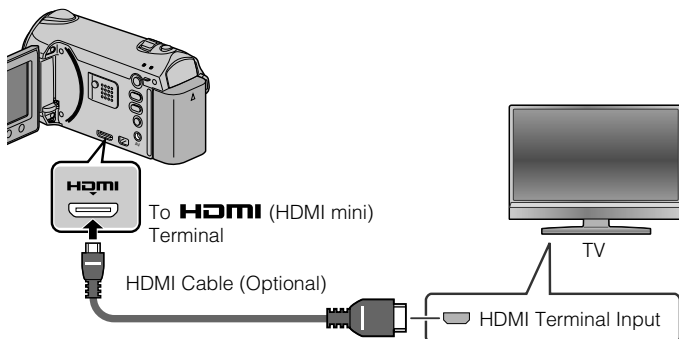

### To connect using the COMPONENT/AV connector

If you are using an HDTV, you can play back in HD quality by connecting to the COMPONENT terminal.

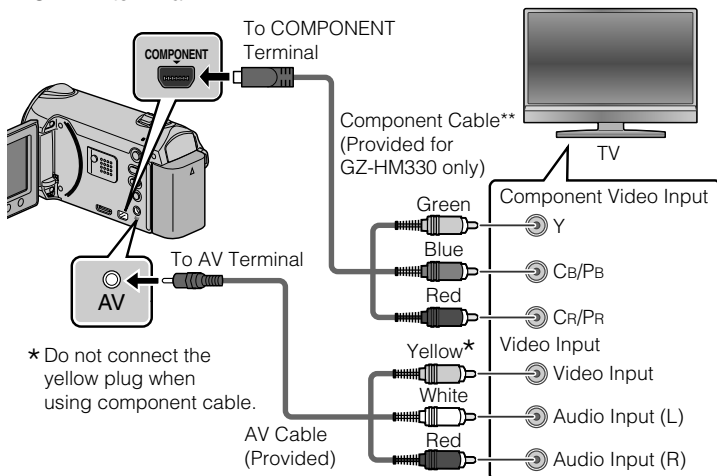



**2** Connect the AC adapter. ( P.6)

- This unit powers on automatically when the AC adapter is connected.

**3** Select the TV input switch.**4** Play back a file. ( P.15)**■ To play back with date/time display**

Set "DISPLAY ON TV" in the "CONNECTION SETTINGS" menu to "ON".

Set "ON-SCREEN DISPLAY" in the playback menu to "DISPLAY DATE ONLY".

**■ When images look unnatural on the TV**

Images do not appear on the TV properly.	<ul style="list-style-type: none"><li>• Disconnect the cable and connect again.</li><li>• Restart this unit by turning off and on.</li></ul>
The colour of images looks strange.	<ul style="list-style-type: none"><li>• When the video was recorded with "x.v.Color" set to "ON", set the x.v.Colour setting of the TV to on.</li><li>• Adjust the TV's screen accordingly.</li></ul>

**NOTE**

- Please contact the TV manufacturer on questions or problems with setting the TV to the correct mode.
- We recommend using the Category 2 HDMI cable (High Speed cable) for viewing in higher picture quality.

## Dubbing Files by Connecting to a DVD Recorder or VCR

You can dub videos in standard quality by connecting to a DVD recorder or VCR. Refer also to the instruction manual of the TV, DVD recorder, VCR, etc.

### 1 Connect to a VCR/DVD recorder.

- Press the Power button (⏻) for more than 2 seconds to turn off this unit.

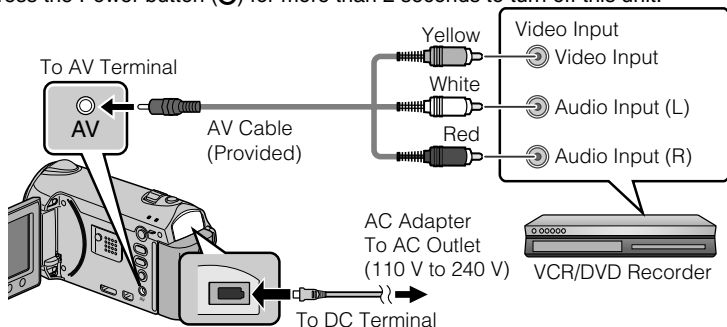

- This unit powers on automatically when the AC adapter is connected.

### 2 Select the playback mode.

- Turn on this unit.

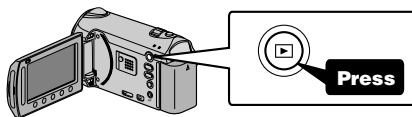

### 3 Prepare to record.

#### Preparation on TV and VCR/DVD recorder

- Switch to a compatible external input.
- Insert compatible blank DVD or VHS to dub.

#### Preparation on this unit

- Set "VIDEO OUTPUT" in the connection settings menu to the aspect ratio ("4:3" or "16:9") of the connecting TV.
- To include the date during dubbing, set "DISPLAY ON TV" in the "CONNECTION SETTINGS" menu to "ON". Set "ON-SCREEN DISPLAY" in the playback menu to "DISPLAY DATE ONLY".

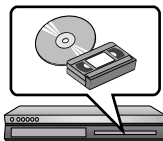

### 4 Start recording.

- Start playback on this unit ( P.15) and press the record button on the recorder.
- After playback is complete, stop the recording.

# Using the Menu

You can configure various settings using the menu.

## 1 Display the menu.

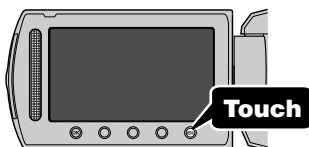

- The menu differs according to the mode in use.

## 2 Select the desired menu and touch **OK**.



## 3 Select the desired setting and touch **OK**.



### To exit the screen

Touch **MENU** (quit).

### To return to the previous screen

Touch **←**.

### To display the help file

Touch **?**.

- For more information on the settings, refer to the Detailed User Guide.

## Customer Support Information

Use of this software is authorized according to the terms of the software license.

### JVC (for inquiries regarding this unit)

When contacting the nearest JVC office or agency in your country (refer to the JVC Worldwide Service Network at <http://www.jvc-victor.co.jp/english/worldmap/index-e.html>) about this software, please have the following information ready.

- Product Name, Model, Serial Number, Problem, Error Message
- PC (Manufacturer, Model (Desktop/Laptop), CPU, OS, Memory (MB/GB), Available Hard Disk Space (GB))

Please note that it may take some time to respond to your questions, depending on their subject matter. JVC cannot answer questions regarding basic operation of your PC, or questions regarding specifications or performance of the OS, other applications or drivers.

### Pixela (for inquiries regarding the provided software)

Region	Language	Phone #
USA and Canada	English	+1-800-458-4029 (toll-free)
Europe (UK, Germany, France, and Spain)	English/German/French/Spanish	+800-1532-4865 (toll-free)
Other Countries in Europe	English/German/French/Spanish	+44-1489-564-764
Asia (Philippines)	English	+63-2-438-0090
China	Chinese	10800-163-0014 (toll-free)

**Homepage:** <http://www.pixela.co.jp/oem/jvc/mediabrowser/e/>

Please check our website for latest information and downloading.

# Recordable Time/Number of Images

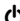
You can check the video recording time by pressing the  (Power/Information) button.

## Approximate Video Recording Time

Quality	Built-in Memory	SD Card/SDHC Card			
		4 GB	8 GB	16 GB	32 GB
UXP	40 m	20 m	40 m	1 h 20 m	2 h 40 m
XP	1 h	30 m	1 h	2 h	4 h
SP	1 h 25 m	44 m	1 h 28 m	2 h 56 m	5 h 52 m
EP	3 h 35 m	1 h 50 m	3 h 40 m	7 h 20 m	14 h 40 m

- Built-in memory applies to GZ-HM330 only.
- The approximate recording time is only a guide. The actual recording time may shorten depending on the shooting environment.

## Approximate Number of Still Images (Unit: Number of Shots)

Image size / Quality		Built-in Memory	SD Card / SDHC Card							
			256 MB	512 MB	1 GB	2 GB	4 GB	8 GB	16 GB	32 GB
16:9	1920 × 1080 / FINE	8260	260	510	1030	2100	4140	8330	9999	9999
	1920 × 1080 / STANDARD	9999	410	810	1620	3210	6310	9999	9999	9999
4:3	1440 × 1080 / FINE	9999	340	680	1360	2770	5450	9999	9999	9999
	1440 × 1080 / STANDARD	9999	540	1070	2140	4360	8570	9999	9999	9999
	640 × 480 / FINE	9999	1690	3330	6670	9999	9999	9999	9999	9999
	640 × 480 / STANDARD	9999	3050	5990	9999	9999	9999	9999	9999	9999

- Up to 9999 still images may be recorded on the SD cards with at least 16 GB capacity (regardless of image size and quality).

## Approximate Recording Time (Using Battery)

Battery Pack	Approximate Charging Time	Actual Recording Time	Continuous Recording Time
BN-VG114E	2 h 30 m	55 m (1 h*)	1 h 40 m (1 h 45 m*)
BN-VG121E	3 h 30 m	1 h 25 m (1 h 30 m*)	2 h 30 m (2 h 40 m*)

\* For GZ-HM300/GZ-HM310 only.

- The above are values when "LIGHT" is set to "OFF" and "LCD BACKLIGHT" is set to "STANDARD".
- The actual recording time may be shorter if zooming is used or if recording is stopped repeatedly. (It is recommended to prepare battery packs ready for three times the expected recording time.)
- When the battery life is reached, the recording time becomes shorter even if the battery pack is fully charged. (Replace the battery pack with a new one.)

# Troubleshooting

Before requesting service, consult the following chart or the “Troubleshooting” section in the Detailed User Guide.

If the solutions indicated in the chart do not solve the problem, consult your nearest JVC dealer or JVC service center for instructions. Refer also to the FAQ of new products on JVC’s website.

Refer also to the Q&A information of new products on JVC’s website (<http://www.jvc.com>).

This unit is a microcomputer-controlled device. Electrostatic discharge, external noise and interference (from a TV, a radio, etc.) might prevent it from functioning properly. In such a case, reset this unit.

## ■ Reset this unit when it does not function properly or when “... Error” appears on the screen.

- ① Turn off the power. (Close the LCD monitor.)
- ② Remove the AC adapter and battery pack from this unit, reattach them, and turn on the power again.

## Troubleshooting

Trouble		Action	Page
Power	POWER/CHARGE lamp starts blinking when the monitor is closed.	<ul style="list-style-type: none"> <li>The battery pack is being charged.</li> </ul>	6
	Recording/snapshot cannot be performed.	<ul style="list-style-type: none"> <li>Check the  /  mode.</li> <li>Set to the recording mode with the  button.</li> </ul>	13 15
Recording	Recording stops by itself.	<ul style="list-style-type: none"> <li>Insert a commercially available SD card.</li> <li>Recording stops automatically after 12 hours of non-stop recording.</li> <li>The media used for recording is out of space. To ensure continuous recording, set “SEAMLESS RECORDING” to “ON” before you start recording. The unit switches to another media and records continuously without frame loss.</li> </ul>	8 - -

Getting Started

Recording

Playback

Copying

Others

Playback	No date/time display.	<ul style="list-style-type: none"> <li>Set "ON-SCREEN DISPLAY" in the playback menu accordingly.</li> </ul>	-
	Sound or video is interrupted.	<ul style="list-style-type: none"> <li>Sometimes playback is interrupted at the connecting section between two scenes. This is not a malfunction.</li> </ul>	-
	Cannot find a recorded video.	<ul style="list-style-type: none"> <li>Select "PLAYBACK OTHER FILE" then search the video on the index screen. (Video files that have damaged management information can be played back.)</li> <li>Cancel group display and date search functions.</li> <li>Change the setting in "REC MEDIA FOR VIDEO" or "REC MEDIA FOR IMAGE". (Files on other media are not displayed.)</li> </ul>	- - -
	The colour of images looks strange.	<ul style="list-style-type: none"> <li>When recording the white balance was not correctly adjusted.</li> <li>When the video was recorded with "x.v.Color" set to "ON", change the setting as desired on TV.</li> <li>Set "EFFECT" to "OFF".</li> </ul>	- - -
	The lamp does not flash during battery pack charging.	<ul style="list-style-type: none"> <li>Check the remaining battery power. (When the battery pack is fully charged, the lamp does not flash.)</li> <li>When charging in either a hot or cold environment, ensure that battery is being charged within the permitted temperature range. (Otherwise, charging may stop to protect the battery pack.)</li> </ul>	13 6
Other problems	The slider and operation buttons do not work.	<ul style="list-style-type: none"> <li>Remove any gloves.</li> <li>Touch the slider and buttons with your fingers to operate. (They do not function if you touch them with your fingernails or pen tips.)</li> </ul>	- -
	This unit heats up.	<ul style="list-style-type: none"> <li>This is not a malfunction. (This unit may become warm when used for a long time.)</li> </ul>	-
	Some functions cannot be used when playing a backup BD/DVD through a BD/DVD burner connected to this unit. (GZ-HM330 only)	<ul style="list-style-type: none"> <li>The following functions cannot be used for a backup BD/DVD. When playing back video: - Search index by date - Playback effects When playing back still image: - Playback effects</li> </ul>	-

When connecting to the HDMI cable, the image or sound does not appear on the TV properly.

- The image or sound may not appear on the TV properly depending on the TV connected. In such cases, perform the following operations.
  - ① Disconnect and reconnect the HDMI cable.
  - ② Turn off and on this unit again.

-

HDMI-CEC functions do not work properly and the TV does not work in conjunction with this unit.

- Some TVs may operate differently depending on the specifications even if they are HDMI-CEC compliant. Therefore, the HDMI-CEC function of this unit cannot be guaranteed to operate in combination with all TVs. In such cases, set "HDMI CONTROL" to "OFF".

-

## Warning Indications

Warning Indications	Action	Page
RECORDING FAILURE	<ul style="list-style-type: none"> <li>• Turn off and on this unit again.</li> </ul>	-
UNSUPPORTED SCENE! (Video)/ UNSUPPORTED FILE! (Still image)	<ul style="list-style-type: none"> <li>• Make use of a file recorded with this unit. (Files recorded with other devices may not be playable. If the file was recorded with this unit, then it is corrupted.)</li> </ul>	-
BACK UP RECORDED DATA ON PC OR DISC PERIODICALLY	<ul style="list-style-type: none"> <li>• Connect and copy your data to a PC.</li> </ul>	-
DATA RECORDED IS TOO LITTLE UNABLE TO SAVE	<ul style="list-style-type: none"> <li>• If a video recording is stopped with the actual recording time displayed at "0:00:00:17" and below, the video cannot be saved.</li> </ul>	-
MEMORY CARD ERROR!	<ul style="list-style-type: none"> <li>• Turn off and on this unit again.</li> <li>• Remove the AC adapter and battery pack, then remove and re-insert the SD card.</li> <li>• Remove any dirt from the SD card terminals.</li> <li>• Format the SD card by executing "FORMAT SD CARD" in the media settings menu. (All data is deleted.)</li> </ul>	- - - -
CHECK LENS COVER	<ul style="list-style-type: none"> <li>• Appears for 5 seconds after power is turned on if the lens cap is attached or when it is dark.</li> </ul>	-



# Cautions

## Battery Pack

The supplied battery pack is a lithium-ion battery. Before using the supplied battery pack or an optional battery pack, be sure to read the following cautions:

Terminals

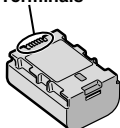

- **To avoid hazards**

- ... **do not** burn.
- ... **do not** short-circuit the terminals. Keep it away from metallic objects when not in use. When transporting, carry the battery in a plastic bag.
- ... **do not** modify or disassemble.
- ... **do not** expose the battery to temperatures exceeding 60°C, as this may cause the battery to overheat, explode or catch fire.
- ... use only specified chargers.

- **To prevent damage and prolong service life**

- ... do not subject to unnecessary shock.
- ... charge within the temperature range of 10°C to 35°C. Cooler temperatures require longer charging time, or in some cases stop charging at all.
- Warmer temperatures prevent complete charging, or in some cases stop charging at all.
- ... store in a cool, dry place. Extended exposure to high temperatures will increase natural discharge and shorten service life.
- ... fully charge and then fully discharge the battery every 6 months when storing the battery pack over a long period of time.
- ... remove from charger or powered unit when not in use, as some machines use current even when switched off.

## Recording Medium

- **Be sure to follow the guidelines below to prevent corruption or damage to your recorded data.**
  - Do not bend or drop the recording medium, or subject it to strong pressure, jolts or vibrations.
  - Do not splash the recording medium with water.
  - Do not use, replace, or store the recording medium in locations that are exposed to strong static electricity or electrical noise.
  - Do not turn off this unit's power or remove the battery or AC adapter during shooting, playback, or when otherwise accessing the recording medium.
  - Do not bring the recording medium near objects that have a strong magnetic field or that emit strong electromagnetic waves.
  - Do not store the recording medium in locations with high temperature or high humidity.
  - Do not touch the metal parts.

## LCD Monitor

- **To prevent damage to the LCD monitor, DO NOT**
  - ... push it strongly or apply any shocks.
  - ... place this unit with LCD monitor on the bottom.
- **To prolong service life**
  - ... avoid rubbing it with coarse cloth.

## Main Unit

- **For safety, DO NOT**
  - ... open the unit's chassis.
  - ... disassemble or modify the unit.
  - ... allow inflammables, water or metallic objects to enter the unit.
  - ... remove the battery pack or disconnect the power supply while the power is on.
  - ... leave the battery pack attached when the unit is not in use.
  - ... place naked flame sources, such as lighted candles, on the apparatus.
  - ... expose the apparatus to dripping or splashing.
  - ... leave dust or metal objects adhered to the power plug or an AC wall outlet.
  - ... insert any objects in the unit.
- **Avoid using the unit**
  - ... in places subject to excessive humidity or dust.
  - ... in places subject to soot or steam such as near a cooking stove.
  - ... near a television set.
  - ... near appliances generating strong magnetic or electric fields (speakers, broadcasting antennas, etc.).
  - ... in places subject to extremely high (over 40°C) or extremely low (under 0°C) temperatures.
- **DO NOT leave the unit**
  - ... in places of over 50°C.
  - ... in places where humidity is extremely low (below 35%) or extremely high (above 80%).
  - ... in direct sunlight.
  - ... in a closed car in summer.
  - ... near a heater.
  - ... in high places such as on a TV. Leaving the unit in high places while a cable is connected may result in a malfunction if the cable is caught and the unit falls onto the floor.
- **To protect the unit, DO NOT**
  - ... allow it to become wet.
  - ... drop the unit or strike it against hard objects.
  - ... subject it to shock or excessive vibration during transportation.
  - ... keep the lens directed at extremely bright objects for long periods.
  - ... expose the lens to direct sunlight.
  - ... swing it excessively when using the hand strap.
  - ... swing the soft camcorder case excessively when the unit is inside it.
  - ... place the unit in dusty or sandy areas, such as on a beach.
- **To prevent the unit from dropping,**
  - Fasten the grip belt securely.
  - When using the unit with a tripod, attach the unit to the tripod securely.

If the unit drops, you may be injured and the unit may be damaged.  
When a child uses the unit, there must be parental guidance.

Dear Customer,

[European Union]

This apparatus is in conformance with the valid European directives and standards regarding electromagnetic compatibility and electrical safety.

European representative of Victor Company of Japan, Limited is:  
JVC Technical Services Europe GmbH  
Postfach 10 05 04  
61145 Friedberg  
Germany

## Information for Users on Disposal of Old Equipment and Batteries



**Products**



**Battery**

### Notice:

The sign Pb below the symbol for batteries indicates that this battery contains lead.

### [European Union]

These symbols indicate that the electrical and electronic equipment and the battery with this symbol should not be disposed of as general household waste at its end-of-life. Instead, the products should be handed over to the applicable collection points for the recycling of electrical and electronic equipment as well as batteries for proper treatment, recovery and recycling in accordance with your national legislation and the Directive 2002/96/EC and 2006/66/EC.

By disposing of these products correctly, you will help to conserve natural resources and will help to prevent potential negative effects on the environment and human health which could otherwise be caused by inappropriate waste handling of these products. For more information about collection points and recycling of these products, please contact your local municipal office, your household waste disposal service or the shop where you purchased the product. Penalties may be applicable for incorrect disposal of this waste, in accordance with national legislation.

### [Business users]

If you wish to dispose of this product, please visit our web page <http://www.jvc.eu> to obtain information about the take-back of the product.

### [Other Countries outside the European Union]

These symbols are only valid in the European Union. If you wish to dispose of these items, please do so in accordance with applicable national legislation or other rules in your country for the treatment of old electrical and electronic equipment and batteries.

# Specifications

Camera		
Model name	GZ-HM330	GZ-HM300/GZ-HM310
Power supply	Using AC adapter: DC 5.2 V Using battery pack: DC 3.6 V	
Power consumption	2.7 W (when "LIGHT" is set to "OFF" and "LCD BACKLIGHT" is set to "STANDARD")	2.6 W (when "LCD BACKLIGHT" is set to "STANDARD")
Dimensions (W x H x D)	52 mm x 62 mm x 110 mm (excluding grip belt)	
Mass	Approx. 220 g (camera only), Approx. 260 g (including supplied battery pack)	Approx. 215 g (camera only), Approx. 255 g (including supplied battery pack)
Operating environment	Allowable operating temperature: 0°C to 40°C Allowable storage temperature: -20°C to 50°C Allowable operating humidity: 35 % to 80 %	
Image pickup device	1/4" 3,320,000 pixels (progressive CMOS)	1/5.8" 1,370,000 pixels (progressive CMOS)
Recording area (Video)	(16:9) 1,160,000 to 1,380,000 pixels (optical zoom)	(16:9) 750,000 to 1,090,000 pixels (optical zoom)
Recording area (Still image)	(4:3) 870,000 to 1,040,000 pixels (16:9) 1,160,000 to 1,380,000 pixels	(4:3) 560,000 to 820,000 pixels (16:9) 750,000 to 1,090,000 pixels
Lens	F1.8 - 4.7, f= 3.0 mm to 90.0 mm (35 mm conversion: 43.7 mm to 1311 mm)	F1.8 - 3.5, f= 3.0 mm to 60.0 mm (35 mm conversion: 46.4 mm to 928 mm)
Zoom (Video)	Optical zoom: Up to 30x Digital zoom: Up to 200x	Optical zoom: Up to 20x Digital zoom: Up to 200x
Zoom (Still image)	Optical zoom: Up to 30x	Optical zoom: Up to 20x
Video recording format	AVCHD standard, Video: AVC/H.264, Audio: Dolby Digital (2ch)	
Still image recording format	JPEG standard	
Recording media	Built-in Memory (8 GB), SD/SDHC card (commercially available)	SD/SDHC card (commercially available)
Clock battery	Rechargeable battery	
Connectors	HDMI	HDMI™ Mini Connector (V.1.3 with x.v.Colour™)
	Component output	Y, Pb, Pr component output Y: 1.0 V (p-p), 75 Ω Pb/Pr: 0.7 V (p-p), 75 Ω
	AV output	Video output: 1.0 V (p-p), 75 Ω Audio output: 300 mV (rms), 1 kΩ
	USB	Mini USB type AB, USB 2.0 compliant Mini USB type B, USB 2.0 compliant

Getting Started

Recording

Playback

Copying

Others

**AC Adapter (AP-V30M)\***

Power supply	AC 110 V to 240 V, 50 Hz/60 Hz
Output	DC 5.2 V, 1.8 A
Allowable operating temperature	0°C to 40°C (10°C to 35°C during charging)
Dimensions (W x H x D)	50 mm x 29 mm x 100 mm (excluding cord and AC plug)
Mass	Approx. 112 g

- \* When using the AC adapter overseas, please prepare a commercially available converter plug for the country or region of visit.
- The specifications and appearance of this product are subject to changes for further improvement without prior notice.

## Index

<b>A</b>	AC Adapter .....	6	<b>M</b>	Menu Settings .....	19
	AV Connection .....	16, 18	<b>N</b>	Number of Images .....	20
<b>B</b>	Battery Pack .....	6, 25	<b>R</b>	Recordable Time .....	20
<b>C</b>	Clock Adjust .....	12		Recording Media for Image .....	10
	Copy (Back Up) .....	18	<b>S</b>	SD Card .....	8, 20
<b>D</b>	Date/Time Setting .....	11	<b>V</b>	Viewing Files on TV .....	16
	Deleting Files .....	15	<b>Z</b>	Zoom .....	13
<b>F</b>	Format SD Card .....	10			
<b>L</b>	Language Setting .....	12			
	LCD Monitor .....	25			

# JVC