

# JVC KD-DV5606/KD-DV5605/ KD-DV5604

## Installation/Connection Manual

GET0654-004A  
[U/UH/UI]

0110DTSMDTJEIN  
EN

© 2010 Victor Company of Japan, Limited

This unit is designed to operate on **12 V DC, NEGATIVE ground electrical systems**. If your vehicle does not have this system, a voltage inverter is required, which can be purchased at JVC car audio dealers.

### WARNINGS

- **DO NOT install any unit or wire any cable in a location where;**
  - it may obstruct the steering wheel and gearshift lever operations.
  - it may obstruct the operation of safety devices such as air bags.
  - it may obstruct visibility.
- **DO NOT operate the unit while driving.**
- **If you need to operate the unit while driving, be sure to look around carefully.**
- **The driver must not watch the monitor while driving.**
- **If the parking brake is not engaged, "DRIVER MUST NOT WATCH THE MONITOR WHILE DRIVING." appears on the monitor, and no playback picture will be shown.**
  - This warning appears only when the parking brake lead is connected to the parking brake system built in the car.

### PRECAUTIONS on power supply and speaker connections:

- **DO NOT connect the speaker leads of the power cord to the car battery; otherwise, the unit will be seriously damaged.**
- **BEFORE connecting the speaker leads of the power cord to the speakers, check the speaker wiring in your car.**

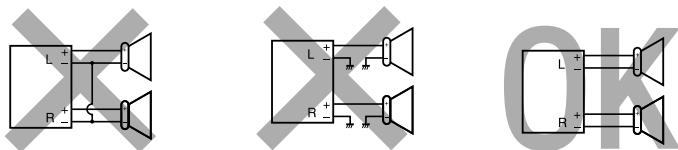

To prevent short circuits, we recommend that you disconnect the battery's negative terminal and make all electrical connections before installing the unit.

- **Be sure to ground this unit to the car's chassis again after installation.**

### Notes:

- Replace the fuse with one of the specified rating. If the fuse blows frequently, consult your JVC car audio dealer.
- It is recommended to connect speakers with a maximum power of more than 50 W (both at the rear and at the front, with an impedance of **4 Ω to 8 Ω**). If the maximum power is less than 50 W, change <AMP GAIN> setting to prevent the speakers from being damaged (see page 27 of the INSTRUCTIONS).
- To prevent short circuits, cover the terminals of the UNUSED leads with insulating tape.
- The heat sink becomes very hot after use. Be careful not to touch it when removing this unit.

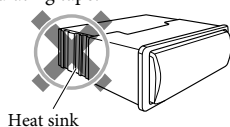

### Parts list for installation and connection

If any item is missing, consult your JVC car audio dealer immediately.

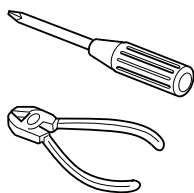
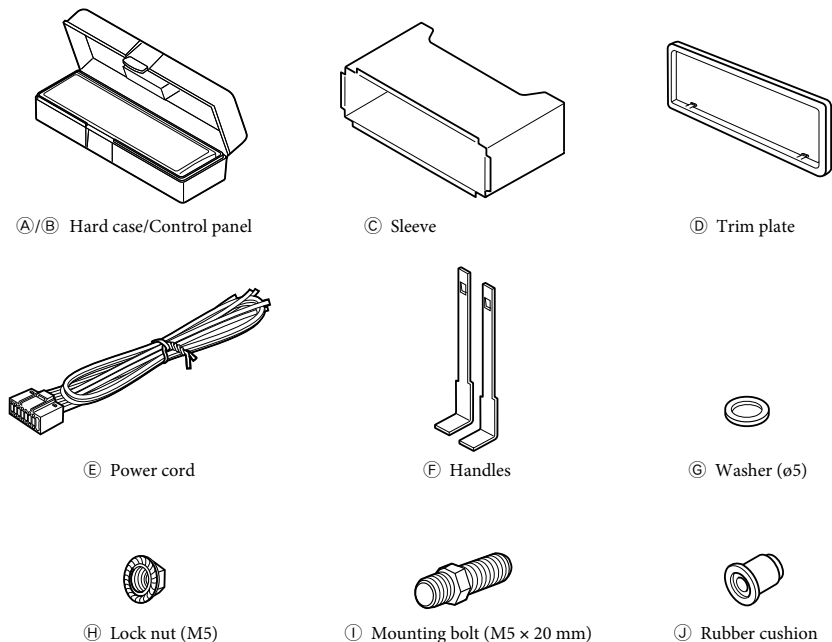

### INSTALLATION (IN-DASH MOUNTING)

The following illustration shows a typical installation. If you have any questions or require information regarding installation kits, consult your JVC car audio dealer or a company supplying kits.

- If you are not sure how to install this unit correctly, have it installed by a qualified technician.

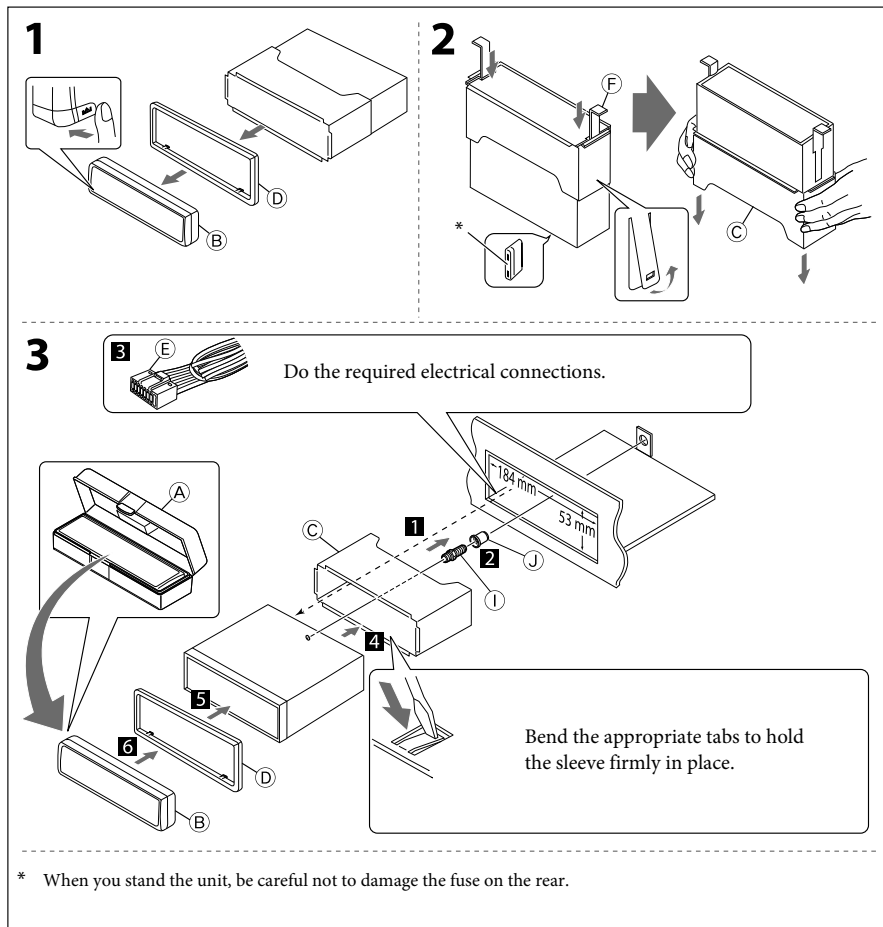

### When using the optional stay

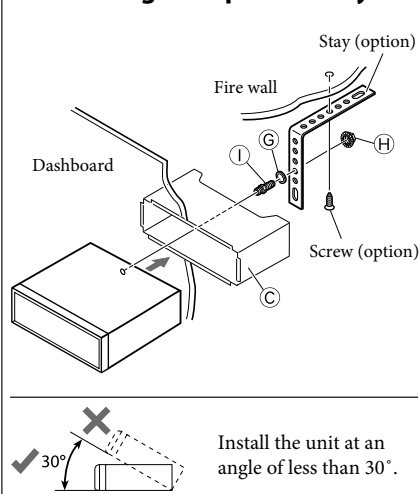

### When installing the unit without using the sleeve

In a Toyota car for example, first remove the car radio and install the unit in its place.

Flat head screws—M5 x 8 mm (not supplied)

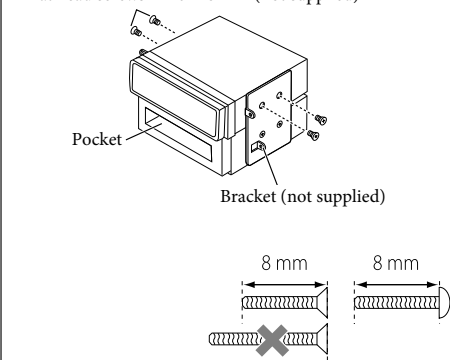

### Removing the unit

Before removing the unit, release the rear section.

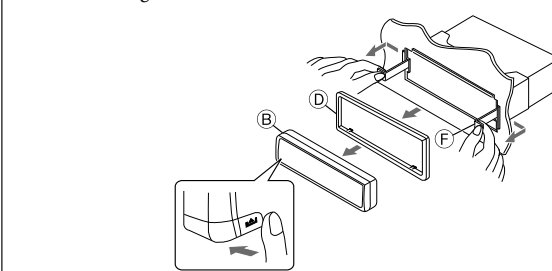

### TROUBLESHOOTING

- **The fuse blows.**
  - \* Are the red and black leads connected correctly?
- **Power cannot be turned on.**
  - \* Is the yellow lead connected?
- **No sound from the speakers.**
  - \* Is the speaker output lead short-circuited?
- **Sound is distorted.**
  - \* Is the speaker output lead grounded? ; Are the "–" terminals of L and R speakers grounded in common?
- **Noise interfere with sounds.**
  - \* Is the rear ground terminal connected to the car's chassis using shorter and thicker cords?
- **This unit becomes hot.**
  - \* Is the speaker output lead grounded? ; Are the "–" terminals of L and R speakers grounded in common?
- **This unit does not work at all.**
  - \* Have you reset your unit?

# ELECTRICAL CONNECTIONS

## A Typical connections

**IMPORTANT:** A custom wiring harness (separately purchased) which is suitable for your car is recommended for connection between the unit and your car.  
 • Consult your JVC car audio dealer or a company supplying kits for details.

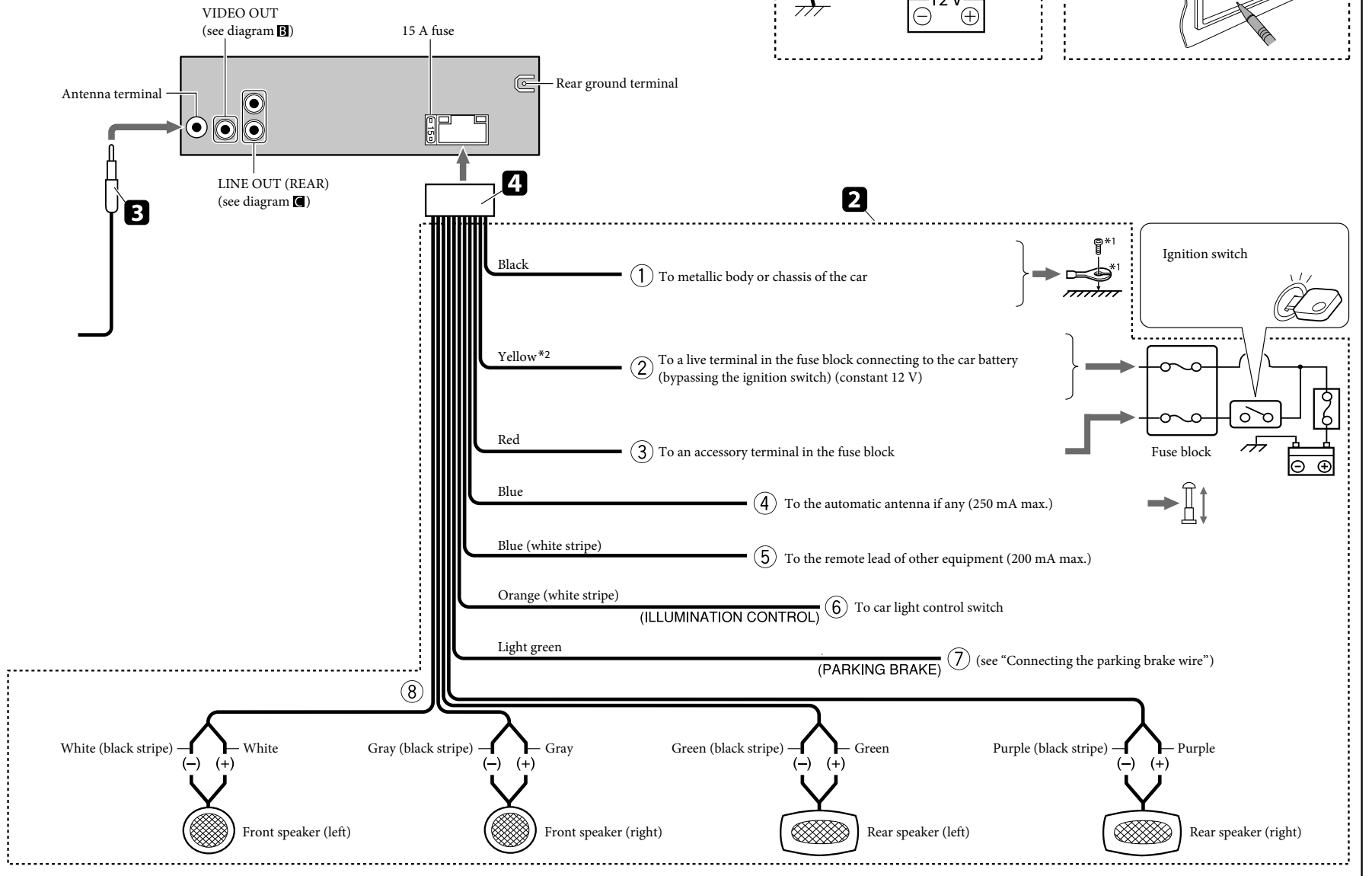

## B Required connections for video playback

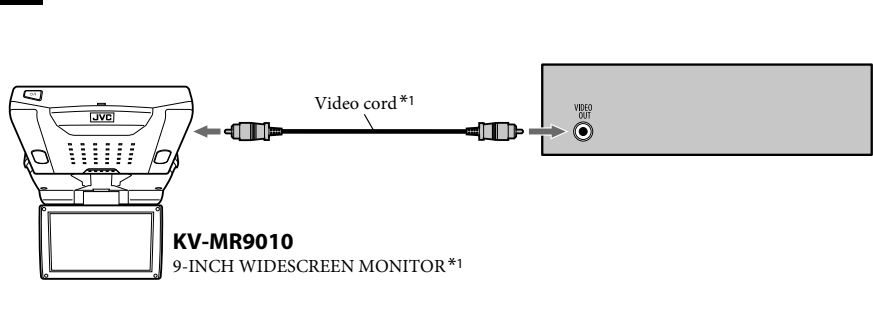

## C Connecting the external amplifier

Disconnect the speakers from this unit, connect them to the amplifier. Leave the speaker leads of this unit unused.

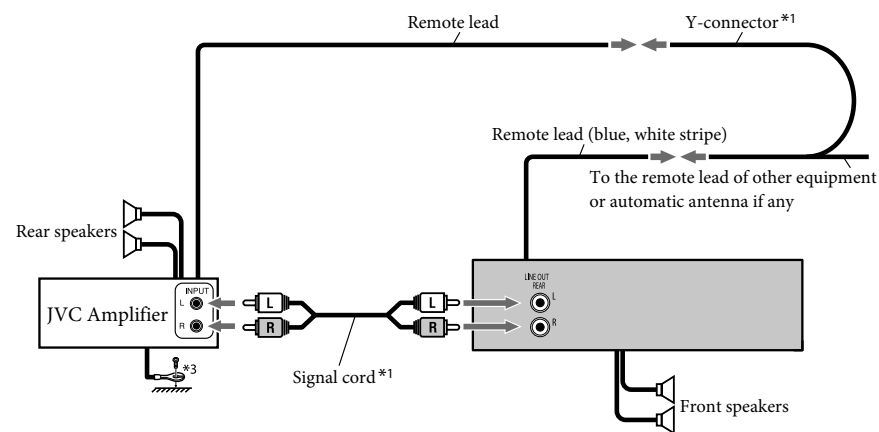

## Connecting the parking brake wire

**(A) When installing the monitor in a location where it CAN be seen by the driver**  
 Connect the parking brake wire to the parking brake system built in the car.

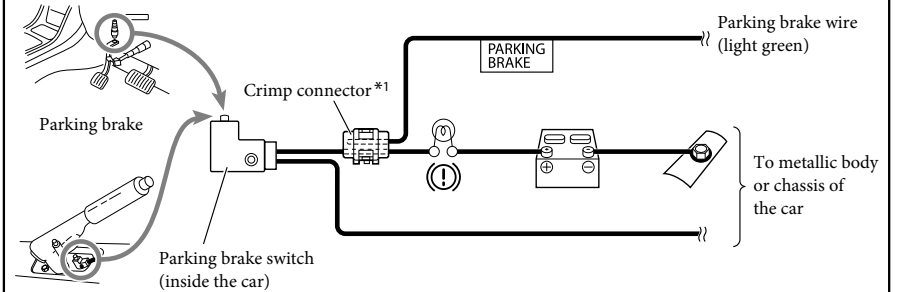

**(B) When installing the monitor in a location where it CANNOT be seen by the driver**  
 Connect the parking brake wire to metallic body or chassis of the car.

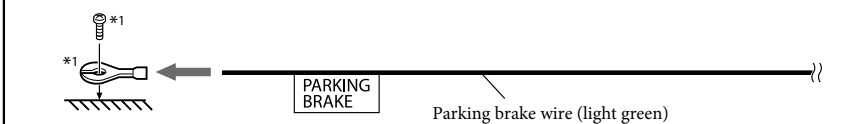

\*1 Not supplied for this unit.

\*2 Before checking the operation of this unit prior to installation, this lead must be connected, otherwise power cannot be turned on.

\*3 Firmly attach the ground wire to the metallic body or to the chassis of the car—to the place uncoated with paint.