	Final Output Approval (Hong Kong Office use only)	
	Signature	Date of approval
	Art Dept Approved	
	Engineer Approved	
	QA Engineer Approved	
Remarks:		
Date: 21 Apr 2016		
Prepared By: Stone		

FF7 - 1:16 RC
Size: 297mm x 210mm
Front 1C + Back 1C



KEEP THESE INSTRUCTIONS FOR FUTURE REFERENCE.

These operating, installation, and safety instructions are integral parts of the product.

IMPORTANT: Please read all "CONSUMER INFORMATION" before operating this toy vehicle. **ADULT SUPERVISION REQUIRED.**

Note to Adults: to ensure that the child's play is both safe and fun, please review all operating instructions and safety tips in the CONSUMER INFORMATION section with your child.

--- CONSUMER INFORMATION ---

CONTENTS:
 1 x Vehicle
 1 x Transmitter Controller

SAFETY TIPS:

- Toy surface may become hot and cause burns if the electronics get wet. DO NOT OPERATE this vehicle near/in/through water, snow, sand, grass or any wet or muddy surfaces.
- Never play this vehicle on streets! The streets are for real cars!
- Do not pick up vehicle while in motion.
- Always place the car gently on the floor by hand. Never throw the car onto the floor.
- Avoid collisions with walls, any hard objects, or human/animal bodies.
- Keep fingers, hair and loose clothing away from tires and wheel hubs.
- To avoid accidental operation, remove all batteries from controller when not in use.
- Do not connect this toy with other power supplies.
- Do not insert any wire into electrical outlets.
- Be sure to rest your vehicle for at least 5 minutes after every 15 minutes of operations.
- Stay clear of obstructions and hazards to avoid injury and damage.

THIS VEHICLE IS DESIGNED TO WORK WITH 4 (FOUR) STANDARD "AA" ALKALINE BATTERIES (INCLUDED).

CONTROLLER IS DESIGNED TO WORK WITH 2 (TWO) STANDARD "AA" BATTERIES (INCLUDED).

INSTALLING BATTERIES IN THE VEHICLE (See Diagram 1) Requires 4 (Four) "AA" alkaline batteries (included)

1. Push the ON/OFF switch to "OFF" position on underneath the vehicle.
2. Press down the secure button and push the door open at the same time.
3. Remove and properly dispose of the used batteries (if any).
4. Insert the 4 "AA" batteries, with polarity (+/-) as shown inside battery compartment.
5. Replace the battery compartment door.

INSTALLING BATTERIES INTO CONTROLLER (See Diagram 2) Requires 2 (two) "AA" batteries (included)

1. Using a screwdriver (not included), remove the battery compartment door.
2. Remove and properly dispose of the used batteries (if any).
3. Insert the 2 "AA" batteries, with polarity (+/-) as shown inside battery compartment.
4. Replace the battery compartment door and use a screwdriver to lock the compartment door.

BATTERY SAFETY INFORMATION

- It is recommended to use only Alkaline type batteries.
- Do not mix alkaline, standard (carbon-zinc), or rechargeable (nickel-cadmium) batteries.
- Remove batteries if vehicle will not be used for a long period of time to prevent possible battery leakage.
- Dispose of batteries safely. Do not dispose of batteries (or products containing non-replaceable batteries) in fire, as batteries may explode or leak.
- Rechargeable batteries are to be removed from the toy before being charged.
- Rechargeable batteries are to be charged by adult only.
- Non-rechargeable batteries are not to be recharged.
- Different types of batteries or new and used batteries are not to be mixed.
- Batteries are to be inserted with the correct polarity.
- Exhausted batteries are to be removed from the toy.
- The supply terminals are not to be short-circuited.

QUICK TIPS

- When your vehicle starts to lose power, it may lose function or performance. It's time for fresh batteries. Your vehicle's running time may change depending on your driving style.
- Radio interference can make your vehicle run abnormally. Interference can be caused by other R/C vehicles running on the same frequency; electrical wires, large buildings; or CB radios. Try to stay away from these!
- Point your transmitter controller antenna up – not down toward your vehicle. If your vehicle gets too far away, it won't work properly.
- Don't store your vehicle near heat or in direct sunlight. Always turn switches OFF and remove all batteries for storage.
- If the vehicle resets automatically, that means the batteries are weak and need to be changed.

CLEANING INSTRUCTION

To clean, wipe excess dirt from toy. Remove batteries first. Wipe toy clean with damp cloth. Wipe dry. DO NOT IMMERSE IN WATER and DO NOT CLEAN VEHICLE WITH ANY CHEMICALS. Let the toy completely dry before putting batteries back into clean, dry battery compartment.

INSTRUCTION FOR DISPOSAL OF WASTE

- Your batteries and electronic toys should be recycled or disposed per your local waste management guidelines.
- Contact your local waste management officials for information regarding the environmentally sound recycling and disposal of batteries and electronic toys.

F84228-TRBO-ISH-EN01A

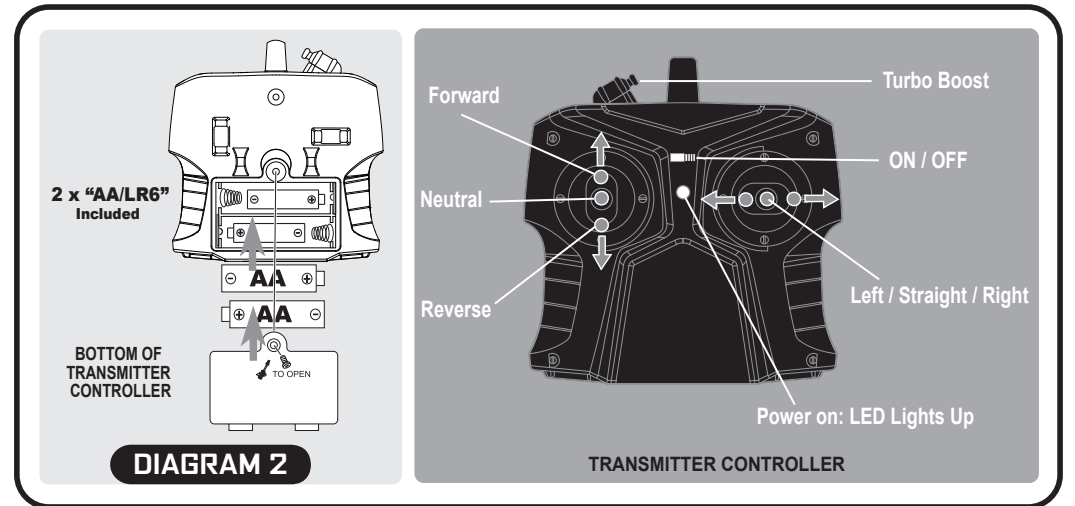
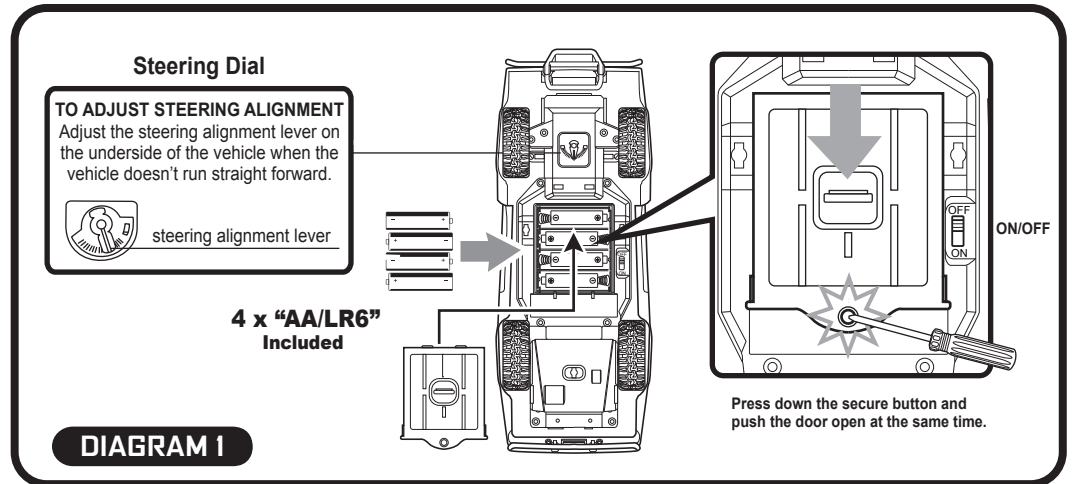

HOW TO PLAY:

1. Turn the vehicle ON, then turn the transmitter controller ON within 30 seconds.
 - * Do not press any buttons or switches on the controller while pairing, this may cause interference.
2. The LED on controller will start blinking.
3. Once the pairing is successful, the LED on controller will stop blinking and stay on.
4. If pairing is unsuccessful, turn the vehicle and controller OFF and try again.

* If your controller LED is blinking or losing brightness, please replace the battery.
 * When playing with multiple vehicles, only pair one controller to one vehicle at a time in order to avoid interference.

The product uses 2.4GHz remote control technology.



We reserve the right to improve or amend product specifications. Colors may vary. Jada oval mark is a registered trademark of Jada Toys, Inc. ©2016 JADA TOYS, INC. CITY OF INDUSTRY, CA 91748, USA **MADE IN CHINA**



A COMCAST COMPANY
FASTANDFURIOUSMOVIE.NET
UNIVERSALSTUDIOS.COM
 Fast & Furious is a trademark and copyright of Universal Studios. Licensed by Universal Studios Licensing LLC. All Rights Reserved.

TROUBLE SHOOTING

PROBLEM	SOLUTION
Vehicle will not START	<ol style="list-style-type: none"> 1. Power switch is off. Make sure to turn it on. 2. Batteries are installed with incorrect polarities. Check the + and - markings to make sure the batteries are properly aligned. 3. Batteries are drained. Charge batteries and/or install new batteries.
Vehicle does not respond to controls.	<ol style="list-style-type: none"> 1. Transmitter controller battery is drained. Replace the controller battery. 2. Vehicle is out of range. Bring controller closer to the vehicle. 3. Interference from surrounding electrical machinery. Bring to a wide open space.
Vehicle does not drive straight.	<ol style="list-style-type: none"> 1. Adjust the steering dial underneath the front axle, left or right, until the wheels point straight forward.
Vehicle does not move	<ol style="list-style-type: none"> 1. Stop operation, switch off the power and rest your vehicle a few minutes. 2. Check the position of the batteries in the vehicle, they may have been knocked loose during play. 3. Check the channels match on the vehicle and controller.
Vehicle does respond properly	Major reason is out of range. Bring controller closer to the vehicle. If problem still happen, remove the controller batteries and replace with new batteries and restart (ON/OFF) the vehicle.

WWW.JADATOYS.COM

Industry Canada Warning:

This device complies with Industry Canada licence-exempt RSS standard(s). Operation is subject to the following two conditions:

- (1) this device may not cause interference, and
 - (2) this device must accept any interference, including interference that may cause undesired operation of the device.
- Under Industry Canada regulations, this radio transmitter may only operate using an antenna of a type and maximum (or lesser) gain approved for the transmitter by Industry Canada. To reduce potential radio interference to other users, the antenna type and its gain should be so chosen that the equivalent isotropically radiated power (e.i.r.p.) is not more than that necessary for successful communication.

COMPLIANCE WITH FCC REGULATIONS (VALID IN U.S. ONLY) THIS DEVICE COMPLIES WITH PART 15 OF THE FCC RULES. OPERATION IS SUBJECT TO THE FOLLOWING TWO CONDITIONS:

1. THIS DEVICE MAY NOT CAUSE HARMFUL INTERFERENCE, AND
 2. THIS DEVICE MUST ACCEPT ANY INTERFERENCE RECEIVED, INCLUDING INTERFERENCE THAT MAY CAUSE UNDESIRE OPERATION.
- This device generates and uses radio frequency energy and if not used properly may cause interference to radio and television reception. It has been tested and found to comply with the limits set by the FCC which are designed to provide reasonable protection against such interference.

FCC Warning:

CAUTION: The manufacturer is not responsible for any radio or TV interference caused by unauthorized modifications to this equipment. Changes or modifications not expressly approved by the party responsible for compliance could void the user's authority to operate the equipment.

Warning: Any changes or modifications not expressly approved by the party responsible for compliance could void the user's authority to operate this equipment.

NOTE: This equipment has been tested and found to comply with the limits for a Class B digital device, pursuant to Part 15 of the FCC Rules. These limits are designed to provide reasonable protection against harmful interference in a residential installation. This equipment generates, uses and can radiate radio frequency energy and, if not installed and used in accordance with the instructions, may cause harmful interference to radio communications. However, there is no guarantee that interference will not occur in a particular installation. If this equipment does cause harmful interference to radio or television reception, which can be determined by turning the equipment off and on, the user is encouraged to try to correct the interference by one or more of the following measures:

- Reorient or relocate the receiving antenna.
- Increase the separation between the equipment and receiver.
- Connect the equipment into an outlet on a circuit different from that to which the receiver is connected.
- Consult an experienced radio/TV technician for help.

Important! Problems?

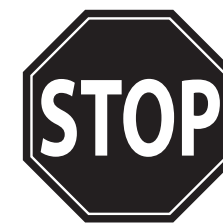

DO NOT RETURN IT TO THE STORE!

First, call our friendly technicians at:

1-800-679-5232
1-626-810-8910

between the hours of 9 am to 6 pm Pacific Time; Monday - Friday.
 or check our website at:

WWW.JADATOYS.COM

U.S.A. & Canada
30-Day Limited Warranty
Jada Toys Products

Jada Toys, Inc. warrants to the original consumer purchaser that this product will be free of defects in material and workmanship for thirty (30) days from the date of purchase. Jada Toys will repair or replace the product, at our sole discretion, in the event of such a defect within the warranty period.

In the event of a defect covered under this warranty, first call the phone numbers listed below. Many problems can be solved in this manner. If necessary, you will be instructed to return the product (postage pre-paid and insured by the consumer) to the address below. Include your name, address, telephone number, copy of dated sales receipt, and a brief explanation of the defect. Repair / replacement and return shipment will be free of charge. Please return the defective part or unit, packed securely. This warranty does not cover damage resulting from unauthorized modification, accident, misuse or abuse. If the product is returned without a dated sales receipt, the product may be excluded from coverage under this warranty.

Jada Toy's liability for defects in material and workmanship under this warranty shall be limited to repair or replacement, at our sole discretion, and in no event shall we be responsible for incidental, consequential, or contingent damages (except in those states that do not allow this exclusion or limitation). This warranty is exclusive, and is made in lieu of any express or implied warranty. **Valid only in U.S.A. and Canada.** This warranty gives you specific legal rights and you may have other rights, which may vary from state to state. Some states do not allow the exclusion of incidental or consequential damages, so the above exclusions or limitations may not apply to you.

TOLL-FREE NUMBER: 1-800-679-JADA (5232) (valid only in U.S.A. and Canada)
 Hours: 9:00 A.M. – 6:00 P.M. Pacific Time; Monday – Friday. Expect some delay in January following the holiday season. Please be patient and keep trying the toll-free number.

Address for Returns:
Consumer Relations, Jada Toys, Inc.
938 Hatcher Ave.
City of Industry, CA 91748, USA