



WELCOME TO THE NEIGHBORHOOD...

RADIO CONTROL

Keep these instructions for future reference: they contain important information.

IMPORTANT: Please read all "Consumer Information" before operating your vehicle.

CAUTION: ELECTRICALLY OPERATED PRODUCT

Not recommended for children under 8 years of age. As with all electric products, precautions should be observed during handling and use to prevent electric shock.

ADULT SUPERVISION REQUIRED.

Surfaces may become hot and cause burns if electronics get wet. Do not operate vehicle through water or snow.

Consumer Information:

Note to Adults: to ensure that the child's play is both safe and fun, please review all operating instructions and safety rules with your child.

CONTENTS

Vehicle
Transmitter Controller
Antenna for Transmitter Controller

Safety Tips

- NEVER drive your vehicle on streets! They're for real cars!
- DO NOT pick up vehicle while in motion.
- Avoid collisions with wall or hard surfaces.
- Keep fingers, hair and loose clothing away from tires and the wheel hubs while the vehicle is switched ON.
- Adult supervision is recommended when this vehicle is being operated.
- To avoid accidental operation, remove all batteries when not in use.
- Be sure to rest your vehicle for at least 5 minutes after every 15 minutes of operation.

BEFORE BATTERY INSTALLATION

Your new R/C is designed to work with standard 6 (six) "AA" alkaline batteries, sold separately. Controller is designed to work with a 9-volt alkaline battery, sold separately.

INSTALLING BATTERIES IN THE R/C

- 6 (six) "AA" Alkaline batteries (Not included)
1. Push the ON/OFF to "OFF" position on vehicle.
 2. Using a Phillips screwdriver (not included), to remove the battery compartment door underneath the vehicle. (See diagram 1)
 3. Take out the battery cartridge from the battery compartment.
 4. Insert the 6 "AA" batteries, with polarity (+/-) as shown inside battery cartridge.
 5. Insert the battery cartridge with correct polarity (+/-) into the battery compartment.
 6. Replace the battery compartment door and use Phillips screwdriver to lock the compartment door.

INSTALLING CONTROLLER – 9 VOLT BATTERY

- 1 (one) 9V Alkaline battery (not included)
1. Open the battery cover as shown (See Diagram 2)
 2. Install one 9V battery with polarity (+/-) as shown inside battery compartment.
 3. Replace battery cover.

Battery Safety Information

- Insure that battery polarity is correct.
- Use only batteries of the type recommended (or equivalent).
- Do not mix old and new batteries.
- Do not mix alkaline, standard (carbon-zinc), or rechargeable (nickel-cadmium) batteries.
- Remove used-up batteries immediately. Remove batteries if vehicle will not be used for a long period of time to prevent possible leakage.
- Do not recharge non-rechargeable batteries.
- Do not short-circuit terminals.
- Dispose of batteries safely. Do not dispose of batteries (or products containing non-replaceable batteries) in fire, as batteries may explode or leak.

QUICK TIPS

- When your vehicle starts to lose power, it may lose functions or performance. It's time for fresh batteries (or a recharge). Your vehicle's running time may vary depending on your driving style.
- Radio interference can make your vehicle run badly. Interference can be caused by other R/C vehicles running on the same frequency; electrical wires, large buildings; or CB radios. Try to stay away from these!
- Point your transmitter controller antenna up – not down toward your vehicle. If your vehicle gets too far away, it won't work properly.
- Don't drive your vehicle in sand or through water or snow.
- Don't store your vehicle near heat or in direct sunlight. Always turn switches OFF and remove all batteries for storage.

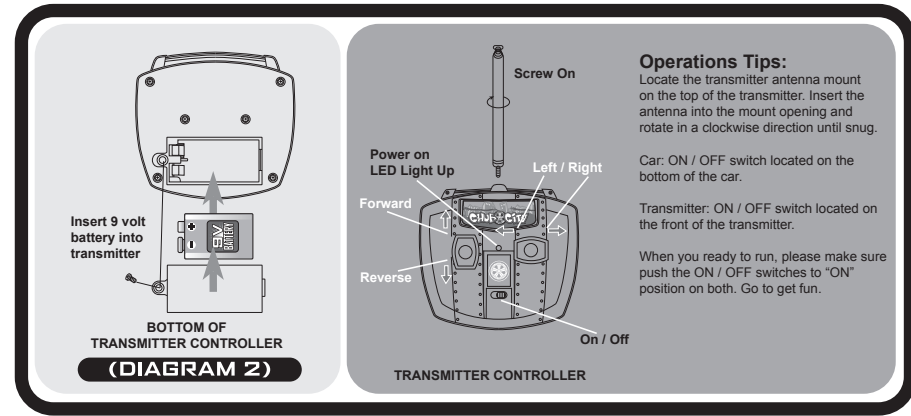
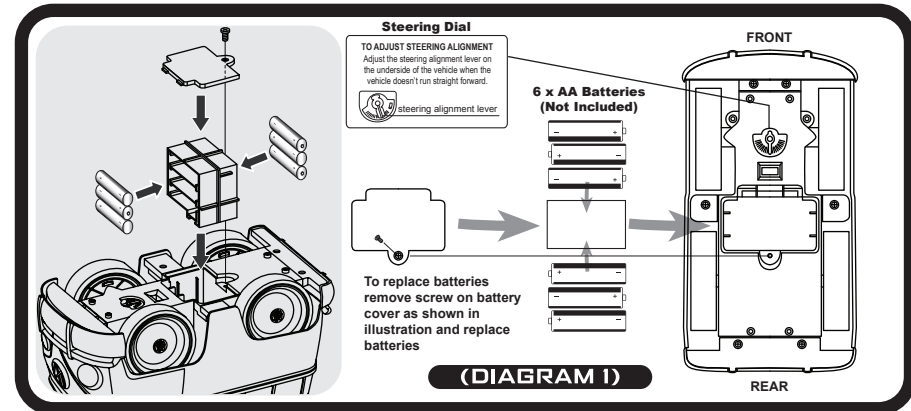

Cleaning instruction:

To clean, wipe excess dirt from toy. Remove batteries first. Wipe toy clean with wet cloth using plain water. Wipe dry. DO NOT IMMERSE IN WATER and DO NOT CLEAN VEHICLE WITH ANY CHEMICALS. Let the toy completely dry up before putting batteries back into clean, dry battery compartment.



©2006 Jada Toys, Inc.
City of Industry, CA 91748 USA
CHUB CITY® is a registered trademarks of Jada Toys, Inc.
All Rights Reserved.