

Product Line: FLY WHEELS		Minimum Packaging Spec:
Customer:	Studio: HK In-House	
Item No.: 56812	Version: US	Revision: 01
Description: FW_Remote Control - Instruction Sheet		
Color(s): IC + 1 C - Black only	Coating:	
Dimension (Width x Height x Depth):	8.25" (W) x 11.625" (H)	
Primary Display Panel (PDP) Size:	15" (W) x 11" (H)	



RADIO CONTROL

8+
ITEM # 56812

WARNING: ADULT SUPERVISION REQUIRED
RECOMMENDED FOR OUTDOOR USE ONLY

Contents

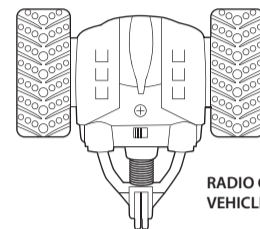

RADIO CONTROL VEHICLE

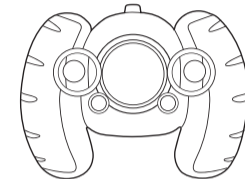

CONTROLLER



ANTENNA

Battery Installation

ADULT INSTALLATION REQUIRED
REQUIRES 4 AA-SIZE (LR06) AND
1 9V (6LR61) ALKALINE BATTERIES. (NOT INCLUDED)

1. RADIO CONTROL VEHICLE

- LOCATE BATTERY COMPARTMENT DOORS ON BOTH SIDES OF VEHICLE.
- USING A PHILLIPS SCREWDRIVER, REMOVE SCREW AND LIFT AWAY BATTERY COVER.
- INSTALL 2 AA (LR06) ALKALINE BATTERIES, AS SHOWN.
- REPLACE BATTERY COVER AND SCREW.
- FLIP RADIO CONTROL VEHICLE OVER AND REPEAT STEPS. THE VEHICLE REQUIRES BATTERIES ON BOTH SIDES TO OPERATE.**

ON/OFF SWITCH

CAUTION: ALWAYS HAVE THE ON/OFF SWITCH IN THE "OFF" POSITION WHEN INSTALLING BATTERIES.

2. CONTROLLER

- LOCATE BATTERY COMPARTMENT ON BOTTOM RIGHT SIDE OF CONTROLLER.
- USING A PHILLIPS SCREWDRIVER, REMOVE SCREW AND LIFT AWAY BATTERY COVER.
- INSTALL 9V (6LR61) ALKALINE BATTERY, AS SHOWN.
- REPLACE BATTERY COVER AND SCREW.

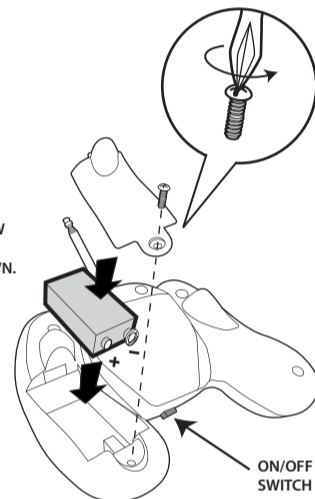

ON/OFF SWITCH

Battery Safety Information

WARNING!

Battery acid leakage can cause personal injury and cause damage to the product and surrounding property. If battery leakage occurs, thoroughly wash any affected skin, making sure to keep battery acid away from eyes, ears, nose and mouth. Immediately wash any clothing or other surface that comes in contact with leaked battery acid. Leaking batteries may make "popping" sounds. Dispose according to Local, State or Federal Laws.

ALWAYS have an adult install and change the batteries.

ALWAYS remove exhausted batteries from toy.

ALWAYS have an adult install batteries consistent with installation instructions.

ALWAYS use batteries according to the instructions.

NEVER attempt to recharge non-rechargeable batteries.

NEVER mix old and new batteries or different brands of batteries.

NEVER mix alkaline, standard (carbon-zinc), or rechargeable (nickel-cadmium) batteries.

NEVER use rechargeable batteries with this product.

NEVER dispose of batteries in fire, as they may leak and explode.

NEVER disassemble, modify, or attempt to short circuit the battery compartment.

NEVER leave batteries in the product for long periods (a week or more) of non-use.

NEVER leave the product on after the batteries have lost their charge.

NEVER put batteries in backwards by placing the negative (-) battery pole into the positive (+) receptor slot.

ONLY use batteries specified by manufacturer.

This device complies with Part 15 of the FCC Rules. Operation is subject to the following two conditions: (1) this device may not cause harmful interference, and (2) this device must accept any interference received, including interference that may cause undesired operation.

Warning: Changes or modifications to this unit not expressly approved by the party responsible for compliance could void the user's authority to operate the equipment.

NOTE: This equipment has been tested and found to comply with the limits for a Class B digital device, pursuant to Part 15 of the FCC Rules. These limits are designed to provide reasonable protection against harmful interference in a residential installation. This equipment generates, uses, and can radiate radio frequency energy and, if not installed and used in accordance with the instructions, may cause harmful interference to radio communications. However, there is no guarantee that interference will not occur in a particular installation.

If this equipment does cause harmful interference to radio or television reception, which can be determined by turning the equipment off and on, the user is encouraged to try to correct the interference by one or more of the following measures:

- Reorient or relocate the receiving antenna
- Increase the separation between the equipment and receiver
- Connect the equipment into an outlet on a circuit different from that to which the receiver is connected
- Consult the dealer or an experienced radio / TV Technician for help

JAKKS Pacific® Battery, Solar or Electrically-Operated Toy 90 DAY LIMITED WARRANTY

Thanks for purchasing a great JAKKS Pacific® product! Please immediately register your product online at www.jakks.com/warranty. Registration is not required for the effectiveness of this limited warranty.

IMPORTANT NOTICE TO CONSUMER:

This 90 DAY LIMITED WARRANTY applies to the original product purchaser, provided the product:

1) was purchased from an authorized JAKKS™ distributor/dealer/retailer, and 2) is returned at your expense, postage pre-paid and insured, along with the original dated sales receipt to the address noted below. Please save a copy of your original sales receipt, as the original receipt will not be returned to you.

If you return the product to us without the original dated sales receipt, this warranty coverage will not apply. If the product is determined by JAKKS to be defective and returned to JAKKS within the 90 day warranty period, we will (at our option) repair or replace it. Return shipment to you may take up to 6 weeks, depending upon your location. If your product is repaired or replaced, it will be warranted for the longer of the original warranty or for 30 days after warranty service.

SCOPE OF LIMITED WARRANTY: The product is warranted to be: a) tested and inspected before shipment, and b) free of defects in material and workmanship for 90 days from date of purchase. If a covered defect occurs within the warranty period, then at our sole option, we will repair or replace the product or provide you with another product of equal value.

WHAT IS NOT COVERED BY LIMITED WARRANTY:

THIS WARRANTY IS VOID IF THE PRODUCT HAS BEEN MODIFIED OR REPAIRED BY USER OR OTHERS OR IF IT HAS BEEN DAMAGED AS A RESULT OF ACCIDENT, IMMERSION IN WATER, NEGLIGENCE, ABUSE, MISUSE, BATTERY LEAKAGE, IMPROPER BATTERY INSTALLATION, UNAUTHORIZED SERVICE, LOSS OF PARTS, WEATHER, ACTS OF GOD, ANY ACTION OR OMISSION WHICH CONSTITUTES A DEVIATION FROM THE

OPERATING INSTRUCTIONS, OR ANY OTHER CAUSES NOT ARISING OUT OF DEFECTS IN WORKMANSHIP OR MATERIALS.

EXCLUSIONS FROM LIMITED WARRANTY: THIS WARRANTY IS EXCLUSIVE OF AND IN LIEU OF ALL OTHER EXPRESS OR IMPLIED WARRANTIES RELATED TO THIS PRODUCT, INCLUDING ANY IMPLIED WARRANTIES OF MERCHANTABILITY OR FITNESS FOR A PARTICULAR PURPOSE. SPECIAL, INCIDENTAL AND CONSEQUENTIAL DAMAGES ARISING FROM POSSESSION, USE, OR MALFUNCTION OF THIS PRODUCT ARE EXCLUDED BOTH FOR PROPERTY DAMAGE AND PERSONAL INJURY TO THE EXTENT LEGALLY PERMITTED.

ADDITIONAL LEGAL RIGHTS: This warranty provides specific legal rights. You may have other or different rights in your state or country.

QUESTIONS OR COMMENTS: If you experience product difficulties or have questions or comments, you may contact our Consumer Relations department as follows:

Phone: 877-875-2557 (toll-free, North America only) or 909-594-7771 x560 (Monday-Friday, 7:30AM-4:30PM Pacific/ GMT -8).

Mail: JAKKS Consumer Relations, 21749 Baker Parkway, Walnut, California USA 91789.
Email: consumers@jakks.com

WHEN WRITING TO US: Please include: 1) product name; 2) item number; 3) purchase date; 4) description of the problem being experienced; and 5) your name, address and phone number. Additionally, if eligible under the warranty and so advised by JAKKS Consumer Relations, also include the defective product and the ORIGINAL dated sales receipt evidencing product purchase. Please retain a copy of your receipt.

Wheel Installation

1.

- ALIGN TABS ON RADIO CONTROL VEHICLE'S RIGHT SIDE TO GROOVES ON WHEEL'S INNER HUB.
- SLIDE WHEEL ONTO THE VEHICLE.

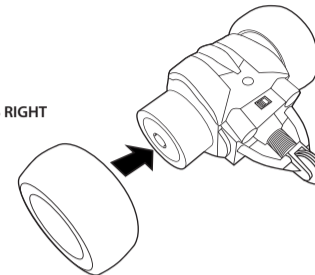

2.

- GENTLY INSERT AND TWIST WHEEL COUNTERCLOCKWISE UNTIL IT LOCKS INTO PLACE.
- REPEAT WITH ANOTHER WHEEL ON THE LEFT SIDE.

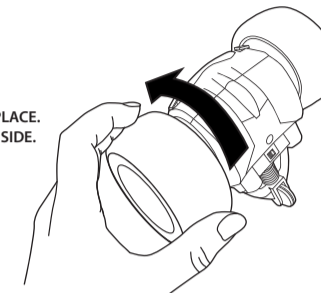

NOTE: ONLY FLY WHEELS™ WHEELS SIZED 18" OR LARGER WILL WORK WITH THE VEHICLE. WHEELS OF DIFFERENT SIZES WILL AFFECT PERFORMANCE.

Antenna Installation

- INSERT ANTENNA INTO ANTENNA SOCKET ON THE CONTROLLER.
- ROTATE ANTENNA CLOCKWISE UNTIL IT LOCKS INTO PLACE.

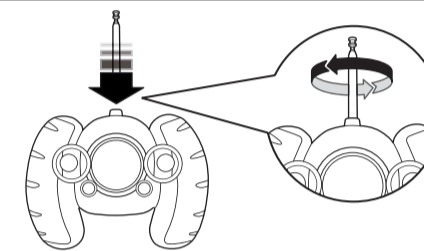

Operation

- THE RADIO CONTROL VEHICLE IS POWERED BY TWO SEPARATE MOTORS, WHICH CAUSE THE VEHICLE TO MOVE, TURN, AND FLIP OVER.
- WHEN VEHICLE FLIPS, THE CONTROLS WILL OPERATE IN THE OPPOSITE FUNCTION, AS SHOWN BELOW.

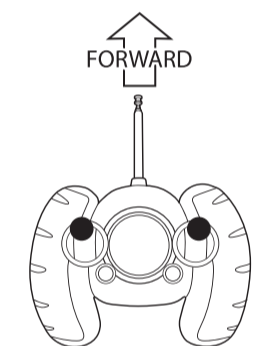

FORWARD

PUSH BOTH CONTROLS UP

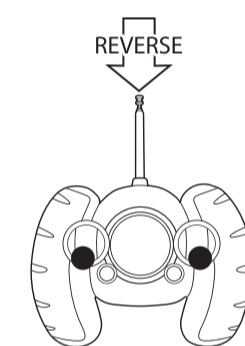

REVERSE

PUSH BOTH CONTROLS DOWN

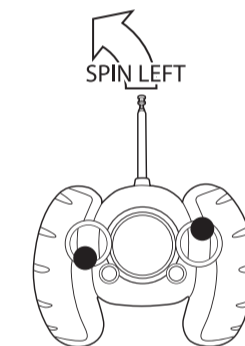

SPIN LEFT

PUSH LEFT CONTROL DOWN
PUSH RIGHT CONTROL UP

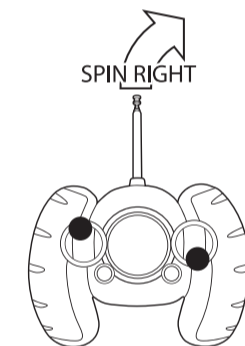

SPIN RIGHT

PUSH LEFT CONTROL UP
PUSH RIGHT CONTROL DOWN

Wheel Removal

1.

- PUSH AND HOLD TAB LOCATED ON FRONT OF VEHICLE TO UNLOCK WHEEL.

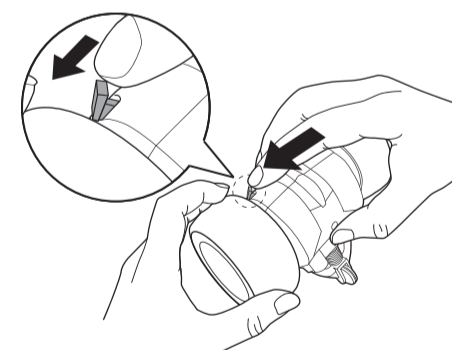

2.

- GENTLY TWIST CLOCKWISE.

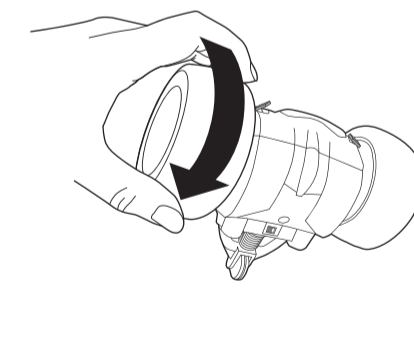

3.

- REMOVE WHEEL FROM VEHICLE. REPEAT FOR OPPOSITE SIDE.

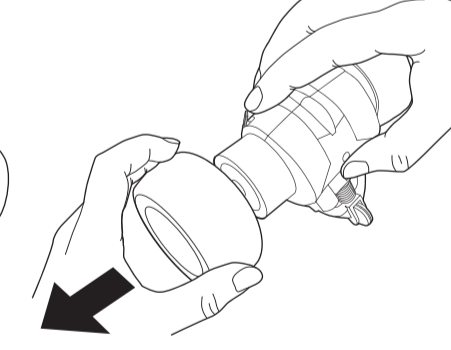

Safety Information

- NEVER** drive vehicle in parking lots, near roads, pets, or cars.
- NEVER** touch the rear wheels or pick up the vehicle while it is in motion.
- NEVER** operate the vehicle with anything other than Fly Wheels™ Rims and Tires.
- NEVER** operate the vehicle without a Tire attached.
- NEVER** operate vehicle with mismatched Rim and Tire sizes.
- NEVER** steer into other objects. Impact may damage vehicle.
- NEVER** drive through water or mud as vehicle is not waterproof.
- NEVER** store near heat or direct sunlight.
- ALWAYS** keep fingers, hair, and eyes away from the wheels while the vehicle is in the "ON" position.
- ALWAYS** play in safe surroundings, away from streets or moving vehicles.
- ALWAYS** remove furniture and other objects from area before playing.
- ALWAYS** use only Fly Wheels™ Rims and Tires size 18" or larger with the vehicle.
- ALWAYS** secure the Tire on the Rim before operating vehicle.
- ALWAYS** be aware of radio frequencies. Avoid operating within range of another unit using the same frequency. Radio frequency is indicated on the package and Controller.
- ALWAYS** keep ON/OFF switch in "OFF" position when toy is not in use.
- ALWAYS** operate the Controller within 45 feet of the vehicle.
- ALWAYS** store Fly Wheels™ in a cool, dry place.



TM & © 2012 MANUFACTURED BY JAKKS PACIFIC, INC., 22619 PCH, MALIBU, CA 90265 U.S.A.
Pat. US D562,916; Pat. US 7,500,898
MADE IN CHINA.

Contents may vary in style, color, shape and decoration from images shown on package or in advertising. Questions or comments? www.jakks.com, consumers@jakks.com, or 1-877-875-2557 in North America. ATTENTION! Remove and discard packaging ties and fasteners before giving toy to child.

R-1