



# MINI R.A.D.™

## ROBOTIC AIR DEFENSE

8+

**WARNING: ADULT SUPERVISION REQUIRED. SEE SAFETY INSTRUCTIONS BELOW.**

### FLYING ENVIRONMENT - RECOMMENDATIONS

1. Confirm sufficient space to fly XPV MINI R.A.D.™ Flying Robot. Minimum 30 feet/10m of open space in all directions is recommended.
2. Avoid flying near buildings, trees, power lines, roadways, people, animals, and obstacles.
3. Fly on mild, sunny days with little or no breeze and do not fly if raining, snowing, excessively windy or temperature is below 32°F/0°C or above 122°F/50°C.
4. For ideal safety operate your XPV MINI R.A.D.™ Flying Robot on a grassy surface.

### TIPS AND TROUBLE SHOOTING

1. Check area for possible radio interference. Large buildings, electrical wires, CB radios, and/or other R/C vehicles may cause radio interference and affect flight of the XPV MINI R.A.D.™ Flying Robot. Avoid these objects for maximum performance.
2. Tape on the vehicle is for added structural strength. DO NOT REMOVE.
3. Check weather conditions. The XPV R.A.D.™ Flying Robot performs best on mild, sunny days with little or no breeze. If raining, snowing, excessively windy, or temperature is below 32°F/0°C or above 122°F/50°C, XPV MINI R.A.D.™ Flying Robot vehicle will not perform properly.
4. Check flying area for large obstacles causing air currents such as buildings and trees. Relocate as necessary.
5. Check batteries. If the XPV MINI R.A.D.™ Flying Robot exhibits diminished or erratic performance, replace controller batteries or recharge the XPV MINI R.A.D.™ Flying Robot as necessary.
6. Check that the XPV MINI R.A.D.™ Flying Robot controller antenna is extended and affixed upward.
7. Check that the XPV MINI R.A.D.™ Flying Robot vehicle antenna is positioned straight and behind tail wing.
8. Check that the XPV MINI R.A.D.™ Flying Robot is able to fly straight and level, and if not, it may require adjustment.
9. Check the XPV MINI R.A.D.™ Flying Robot for debris, dirt, or water damage, and clean as necessary with dry cloth.
10. After a hard landing, the ON/OFF switch may switch to the OFF position. Just switch back ON to start again.
11. The XPV MINI R.A.D.™ Flying Robot comes in 2 frequencies: 27 MHZ and 49 MHZ.  
Do not operate while other XPV MINI R.A.D.™ vehicles with the same radio frequency are in operation nearby.

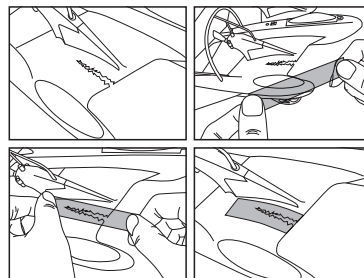

### CARING FOR YOUR XPV MINI R.A.D.™ FLYING ROBOT

1. Before becoming an expert pilot some mishaps in flying and landing may cause some damage to the body of the XPV MINI R.A.D.™ Flying Robot.
2. It is recommended that the user attempt small flights to adjust to the feel of the controller before flying the XPV MINI R.A.D.™ Flying Robot.
3. Use clear tape or cello tape to repair cracks or rips that may happen during a crash.
4. Using clear tape on any cracks or rips on the XPV MINI R.A.D.™ Flying Robot body should allow for extended use.
5. Use the tape sparingly as it adds weight to the XPV MINI R.A.D.™ Flying Robot.

### IMPORTANT SAFETY INFORMATION – ALKALINE BATTERY WARNINGS AND PROPER USE

**WARNING: ONLY ADULTS SHOULD INSTALL OR CHANGE BATTERIES!**

**WARNING: READ BEFORE INSTALLING OR USING BATTERIES.** Failure to read and follow these instructions may result in fire, chemical burns, personal injury and/or property damage if batteries are improperly charged or used. Battery acid leakage can cause personal injury and cause damage to the XPV MINI R.A.D.™ Flying Robot and surrounding property. If battery leakage occurs, thoroughly wash any affected skin, making sure to keep battery acid away from eyes, ears, nose and mouth. Immediately wash any clothing or other surface that comes into contact with leaked battery acid. Leaking batteries may make "popping" sounds."

#### REQUIRED BATTERIES:

- Vehicle includes one (1) **Built In** XPV® Battery Pack and one (1) XPV® Battery Charger built into the controller.
- Controller requires six (6) "AA" Alkaline Batteries (not included).

#### TO AVOID BATTERY PROBLEMS:

- NEVER mix old and new batteries or different brands of batteries.
- NEVER mix alkaline, standard (carbon-zinc) and rechargeable (nickel-cadmium) batteries.
- NEVER use rechargeable batteries as product performance may be diminished. For longer life, only use alkaline batteries.
- NEVER charge non-rechargeable batteries.
- NEVER dispose of batteries in fire as they may leak and explode.
- NEVER disassemble, modify, or attempt to short circuit the battery compartment.
- NEVER leave batteries in the controller for long periods (a week or more) of non-use.
- NEVER leave the XPV MINI R.A.D.™ Flying Robot and controller on when the batteries have lost their charge.
- NEVER put batteries in backwards by placing the negative (-) battery pole into the positive (+) receptor slot.
- ALWAYS have an adult install and change the batteries.
- ALWAYS insert batteries according to the instructions.
- ALWAYS turn off the product when not in use.
- ALWAYS replace all batteries at the same time.

### LITHIUM-ION POLYMER (LIPO) BATTERY SAFETY INFORMATION

**WARNING: The LiPo battery is permanently installed in your XPV MINI R.A.D.™ Flying Robot. Any attempt to remove the LiPo battery will result in permanent damage to the battery and XPV MINI R.A.D.™ Flying Robot.**

**WARNING! LiPo battery is potentially volatile.**

**WARNING! ONLY ADULTS SHOULD CHARGE BATTERY PACK AFTER READING ALL INSTRUCTIONS AND WARNINGS.**

The user assumes all risks associated with use and charging of Lithium-ion Polymer batteries. If you do not agree with these conditions, return the XPV MINI RAD™ Flying Robot vehicle and charger prior to use.

#### Technical Specifications

Type: Lithium-ion Polymer (LiPo or Li-Poly)  
Capacity: 90 mAh  
Voltage: 3.7V (one cell)  
Charge time: 20 - 25 minutes  
Recommended Flight time: 4 minutes

#### Warnings and Cautions

- NEVER remove the LiPo battery from the XPV MINI R.A.D.™ Flying Robot!
- **WARNING: Handle LiPo battery and charger with extreme care!**
- **ONLY charge LiPo battery with the compatible controller.**
- NEVER cut or remove LiPo battery wires!
- NEVER disassemble, modify, or solder LiPo battery!
- NEVER leave LiPo battery unattended at any time while being charged!
- NEVER handle LiPo battery while wearing metallic objects such as a ring, watch, or bracelet!
- NEVER allow LiPo battery internal electrolyte contents to get in eyes or skin!
- NEVER immerse LiPo battery in water, seawater or other liquids.
- NEVER handle or recharge LiPo battery until it has cooled to surrounding temperature.
- NEVER charge LiPo battery on or near combustible materials including paper, plastic, wood, carpet, vinyl, leather, wood, or automobiles.
- NEVER overcharge LiPo battery.
- NEVER leave LiPo battery near heat source such as fire or oven.
- NEVER connect LiPo battery to an electrical outlet.
- NEVER use or recharge LiPo battery if it appears damaged, cracked, becomes discolored or deformed, gives off an odor, or otherwise appears abnormal.
- NEVER strike or throw LiPo battery against a hard surface.
- NEVER puncture or cut LiPo battery.

#### Storage and Transportation

- ALWAYS store LiPo battery in a secure, dry, ventilated location.
- ALWAYS store LiPo battery where it cannot be handled by children.
- NEVER allow LiPo battery to come into contact with water or other liquid.
- NEVER leave LiPo battery near flames, stoves, fire places, or other high-temperature locations.
- NEVER expose LiPo battery to direct sunlight for extended periods.
- NEVER transport or store LiPo battery where it can come into contact with metal objects.

#### Recommended Temperature Ranges for Battery

- Storage: 40°F / 4°C and 80°F / 27°C.
- Charging: 50°F / 10°C to 113°F / 45°C.
- Usage: Recommended temperature range during use: 32°F / 0°C to 122°F / 50°C.
- Transporting in a vehicle: 20°F / -7°C and 150°F / 65°C.
- Charging and/or operating of LiPo battery outside of its specified range can reduce battery performance and cause the battery to leak, overheat, or explode.

#### LiPo Battery Disposal

LiPo battery should be properly disposed of or recycled according to local, state, and federal regulations and only after being cooled to surrounding temperatures. To dispose or recycle, insulate the output wires with tape, puncture a plastic garbage bag, insert LiPo battery into the garbage bag, immerse garbage bag containing LiPo battery into salt water for several hours, and dispose or recycle accordingly. **Wear rubber gloves during procedure.**

**JAKKS Pacific, Inc. is not responsible in any way for any bodily injury(s) and/or property damage that may occur from any contrary use in any way of LiPo battery and/or charger offered and/or distributed by JAKKS Pacific, Inc.**

### ADDITIONAL INFORMATION FOR ALL BATTERY PRODUCTS

This device complies with Part 15 of the FCC Rules. Operation is subject to the following two conditions:

- 1) This device may not cause harmful interference.
- 2) This device must accept any interference received, including interference that may cause undesired operation.

**Warning: Changes or modifications to this unit not expressly approved by the party responsible for compliance could void the user's authority to operate the equipment.**

NOTE: This equipment has been tested and found to comply with the limits for a Class B digital device, pursuant to Part 15 of the FCC Rules. These limits are designed to provide reasonable protection against harmful interference in a residential installation. This equipment generates, uses and can radiate radio frequency energy, and if not installed and used in accordance with the instructions, may cause harmful interference to radio communications. However, there is no guarantee that interference will not occur in a particular installation. If this equipment does cause harmful interference to radio or television reception, which can be determined by turning the equipment off and on, the user is encouraged to try to correct the interference by one or more of the following measures:

- Reorient or relocate the receiving antenna.
- Increase the separation between the equipment and receiver.
- Connect the equipment into an outlet on a circuit different from that to which the receiver is needed.
- Consult the dealer or an experienced radio/TV technician for help.

TM & ©2007 JAKKS Pacific Inc., Malibu, CA 90265 U.S.A. All rights reserved.

Pat. Pending  
MADE IN CHINA

Contents may vary in style, color, shape and decoration from images shown on package or in advertising.  
Questions or comments? [www.jakkspace.com](http://www.jakkspace.com), [consumers@jakks.net](mailto:consumers@jakks.net), or 1-877-875-2557 in North America.

**Visit [www.XPV.com](http://www.XPV.com) for additional information, instructions, and cool videos!**