

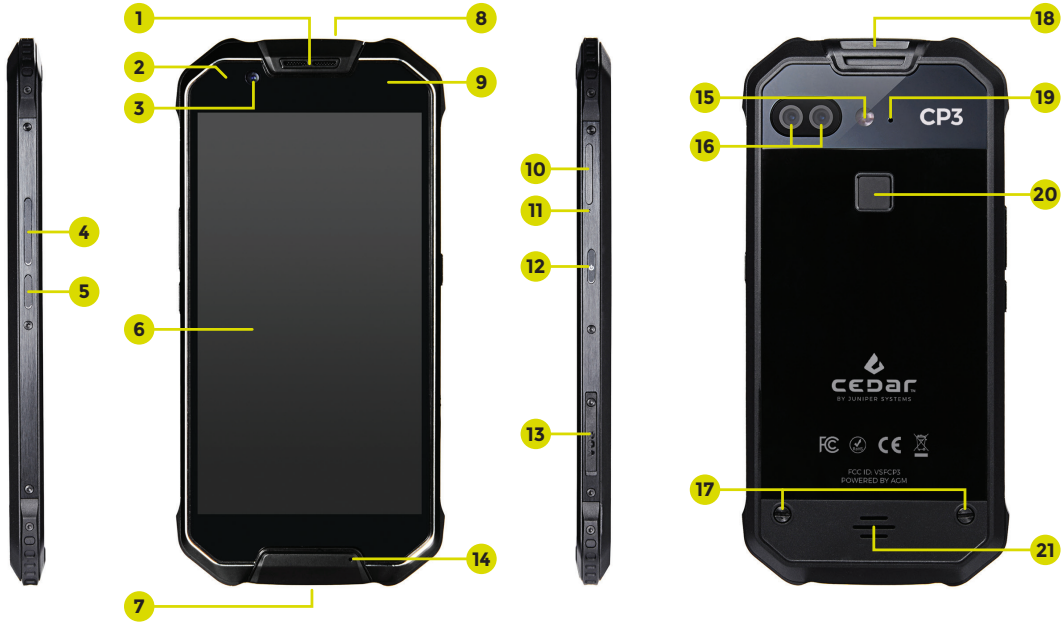

# CP3

User's Manual

## CP3 PRODUCT FEATURES



- 1 Speaker
- 2 LED Notification
- 3 Front Camera
- 4 Volume Up/Down
- 5 Camera Key
- 6 AMOLED Display
- 7 USB Type-C

- 8 3.5 mm Earphone Jack
- 9 Light/Distance Sensor
- 10 SIM/SD Socket
- 11 SIM Ejector Slot
- 12 Power On/Off
- 13 VOC Detector
- 14 Receiver/Microphone

- 15 LED Flashlight
- 16 Dual Camera
- 17 Decorative Screws
- 18 Lanyard Hole
- 19 Sub MIC
- 20 Fingerprint Sensor
- 21 Speaker

## WARNINGS AND NOTES

- WARNING:** Ensure the SIM/SD card slot is securely seated, and the VOC cover is closed before exposing the unit to water. Failure to perform this step could lead to water damage of the unit. We recommend the dust covers over the USB port and headphone port remain seated to keep out dirt.

## INSTALLING A SIM CARD

The CP3 only accepts Nano-SIM cards and a MICRO SD card.

- 1 Use the provided pin tool to eject the SIM card tray.
- 2 Carefully seat the Nano-SIM into the inside position for primary SIM usage.
- 3 The outside position may be used for either another Nano-SIM or a Micro SD card.
- 4 Use the graphic below to see proper orientation.

- CAUTION:** Do not force the card in or out of the slot as this may damage the device. Take care to keep the SIM card in the tray while sliding in the slot. If the card does not seat properly or does not function correctly, check the card orientation and try again.

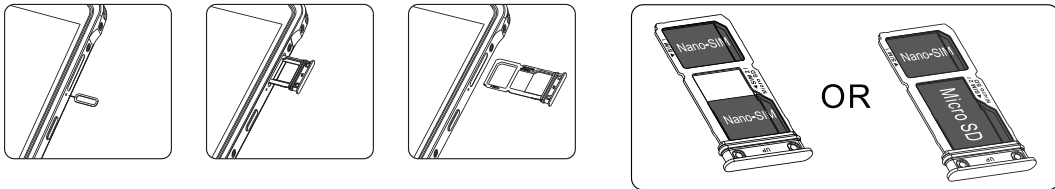

## INITIAL POWER UP

- 1 Press the power button for 3 seconds and wait for the device to boot.
- 2 Swipe the screen from bottom to top to unlock the device.
- 3 If a new SIM card is detected, the SIM management app will automatically launch. Follow the onscreen prompts.
- 4 To turn off the display, quickly press and release the power button. To fully power down the device, press and hold the power button for 3 seconds and tap the "power off" option on the screen.

## INDICATORS



Bluetooth



Battery



Network Cell



Network Wi-Fi

### **CONNECT TO Wi-Fi (WIRELESS LAN)**

- 1 Swipe down from the top to open Settings.
- 2 Tap Wi-Fi.
- 3 Tap the On/Off control to turn on the Wi-Fi radio.
- 4 Tap on the desired wireless network.
- 5 Enter the key or password (if needed).
- 6 Tap CONNECT.

### **CONNECT A BLUETOOTH DEVICE**

- 1 Swipe down from the top twice to access Bluetooth Settings.
- 2 Tap Bluetooth.
- 3 Tap the On/Off control to turn on the Bluetooth radio.
- 4 The device discovers and shows a list of nearby Bluetooth devices.
- 5 Tap More Settings to Pair/Unpair.

### **ACCESSING WALLPAPERS, WIDGETS, and SETTINGS**

- 1 Tap and hold on the background (where an icon is not present) to find wallpapers, widgets, and settings.

### **OPERATING THE CAMERA**

- 1 Press and hold the camera button (the lower most button on the left side of the device) for 3 seconds to launch the camera application – or launch from the camera icon.
- 2 Compose the photo by touching the screen with two fingers and sliding them apart to zoom. Pinch fingers together to zoom out.
- 3 Tap the gear symbol in the upper right corner to access the various advanced menu options including Flash, GPS Location, Picture Size and others.
- 4 Note the bottom menu option is Watermark. This is set on by default. You may wish to disable this feature as it will add a non-customizable watermark on each photo taken.
- 5 Tap the camera rotate icon in the lower right-center part of the screen to use the front-facing camera.
- 6 Tap the camera icon in the bottom right to change between portrait, panorama, and video modes.
- 7 Press the camera button or the circular shutter icon to take a photo.
- 8 Tap the moon and star icon to change color balance from day to night mode.
- 9 Tap the circle icon to create a portrait blurring effect.
- 10 Tap HDR to increase the dynamic range of the photo. Note: It is important to remain still while using this mode.
- 11 Tap Auto on the bottom left corner to change from Automatic to Portrait, Flowers, or Candlelight Color Balance modes.

## HOW TO INSTALL FLOATING CASE

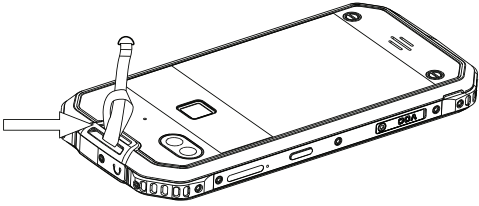

**1** Fasten the lanyard with the phone from the lanyard hole.

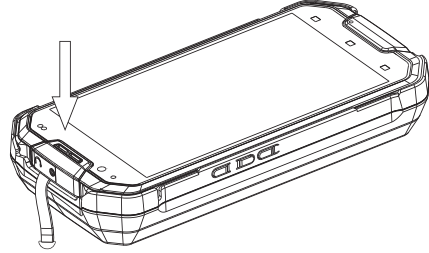

**3** Press to fully fix the phone with the case.

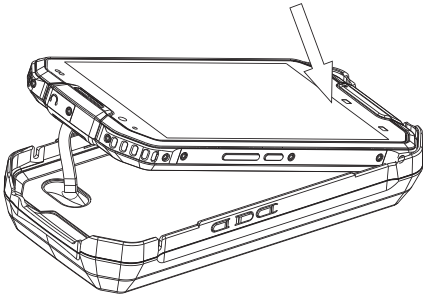

**2** Install the phone with the case from bottom.

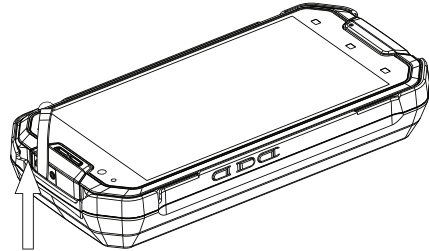

**4** Pull the lanyard to take out the phone from the case.

## REGULATORY INFORMATION

This equipment has been tested and found to comply with the limits for a Class B digital device, pursuant to part 15 of the FCC Rules. Operation is subject to the following two conditions: (1) This device may not cause harmful interference, and (2) this device must accept any interference received, including interference that may cause undesired operation.

These limits are designed to provide reasonable protection against harmful interference in a residential installation. This equipment generates, uses, and can radiate radio frequency energy and, if not installed and used in accordance with the instructions, may cause harmful interference to radio communications. However, there is no guarantee that interference will not occur in a particular installation. If this equipment does cause harmful interference to radio or television reception, which can be determined by turning the equipment off and on, the user is encouraged to try to correct the interference by one or more of the following measures:

- Reorient or relocate the receiving antenna.
- Increase the separation between the equipment and receiver.
- Connect the equipment to an outlet on a circuit different from that to which the receiver is connected.
- Consult the dealer or an experienced radio/TV technician for help.

 **IMPORTANT:** Changes or modifications to this product not authorized by the manufacturer could void the radio frequency compatibility and wireless compliance and negate your authority to operate the product. The use of noncompliant peripheral devices could cause the emission of radiation not within the limits set by part 15 of the FCC rules. Only use peripheral devices tested to provide electromagnetic compatibility when connected to this unit.

## EXPOSURE TO RADIO FREQUENCY (RF) SIGNALS

Your device contains a radio transmitter and receiver. The radiated output power is far below the international radio frequency exposure limits. These limits are part of comprehensive guidelines and establish permitted levels of RF energy for the general population. The guidelines are based on the safety standards previously set by international standards bodies:

- American National Standards Institute (ANSI) IEEE. C95.1-1992.
- National Council on Radiation Protection and Measurement (NCRP). Report 86. 1986.
- International Commission on Non-Ionizing Radiation Protection (ICNIRP) 1996.
- Ministry of Health (Canada), Safety Code 6.

The standards include a substantial safety margin designed to assure the safety of all persons, regardless of age and health. The exposure standard for wireless mobile phones employs a unit of measurement known as the Specific Absorption Rate, or SAR. The standard incorporates a substantial margin of safety to give additional protection for the public and to account for any variations in usage. As with other mobile radio transmitting equipment, users are advised that for satisfactory operation of the equipment and for the safety of personnel, it is recommended that no part of the human body be allowed to come too close to the antenna during operation of the equipment.

Your device has an internal antenna. Use only the supplied integral antenna. Use of unauthorized or modified antennas may impair call quality and damage the phone, causing loss of performance and SAR levels exceeding the recommended limits as well as result in non-compliance with local regulatory requirements in your country.

For body worn operation, this model phone has been tested and meets the FCC RF exposure Guidelines when used with an accessory designated for this product or when used with an accessory that contains no metal and that positions the handset a minimum of 10mm from the body.

To assure optimal phone performance and ensure human exposure to RF energy is within the guidelines set forth in the relevant standards; always use your device only in its normal-use position. Do not touch or hold the antenna area unnecessarily when placing or receiving a phone call. Contact with the antenna area may impair call quality and cause your device to operate at a higher power level than needed. Avoiding contact with the antenna area when the phone is IN USE optimizes the antenna performance and the battery life.

---

## **Cedar 1-Year Warranty**

Juniper Systems, Inc. ("Juniper") warrants that the Cedar brand products shall be free from defects in materials and workmanship, under normal intended use, for a period of ONE YEAR from date of final customer purchase, excepting that this warranty shall not apply to battery packs, media containing software, or any accessories. Juniper warrants that the following shall be free from defects in materials and workmanship, under normal intended use, for a period of ninety (90) days from the date of shipment: battery packs, media containing the handheld and desktop PC programs and owner's manual, and any accessories.

### **Warranty Exclusions**

This warranty shall not apply if: (I) the product has been set up improperly or has been improperly installed or calibrated, (II) the product is operated in a manner that is not in accordance with the instruction manual(s) and/or user guide, (III) the product is used for a purpose other than for which it was designed, (IV) the product has been used in environmental conditions outside of those specified for the product, (V) the product has been subject to any modification, alteration, or change by or on behalf of customer (except and unless modified, changed or altered by Juniper or under Juniper's direct supervision), (VI) the defect or malfunction results from misuse or accident, (VII) the unique device identification number on the product has been tampered with or removed, or (VIII) the product has been opened or tampered with in any way. Parts that are excessively worn are not covered under warranty. These may include, but are not limited to, the keyboard elastomer and switch matrix, hand straps, and the touchscreen (if applicable).

This warranty is exclusive and Juniper will not assume and hereby expressly disclaims any further warranties, whether expressed or implied, including, without limitation, any warranties as to merchantability, fitness for a particular purpose, noninfringement or any warranties arising from the course of performance, dealing, or usage of trade. Juniper specifically makes no warranties as to the suitability of its products for any particular application. Juniper makes no warranties that its products will meet your requirements or will work in combination with any hardware or applications software products provided by third parties, that the operation of its products will be uninterrupted or error free, or that all defects in the product will be corrected. Juniper shall not be responsible for software, firmware, information, or memory data contained in, stored on, or integrated with any products returned to Juniper for repair, under warranty or not.

### **Remedy**

In the event a defect in materials or workmanship is discovered and reported to Juniper within the specified warranty period, after evaluation by a technician at a certified repair center, Juniper will, at its option, repair the defect or replace the defective product. Replacement products may be new or reconditioned. Juniper warrants any replaced or repaired product or a period of ninety (90) days from the date of return shipment, or through the end of the original warranty period, whichever is longer.

Limitation of Liability: To the fullest extent allowed by law, Juniper's obligation shall be limited to the repair or replacement of the product. Juniper shall in no event be liable for special, incidental, or consequential, indirect, special, or punitive damages of any kind, or for loss of revenue or profits, loss of business, loss of information or data, or other financial loss arising out of or in connection with the sale, installation, maintenance, use performance, failure, or interruption of any product. Any responsibility and/or liability of Juniper shall, in connection with a warranted product, be limited in maximum amount to the original purchase price.

Warranty Service: In order to obtain a warranty product repair, replacement, or other servicing, contact our Customer Service Department or fill out the Repair Order Form within the applicable warranty period. The customer must prepay all shipping costs for delivery of the product to the repair center. Please visit our Repair Policies webpage for further details.

Governing Law: This warranty will be governed by the laws of Utah, and excluding the United Nations Convention on Contracts for the International Sale of Goods. The courts of Utah shall have exclusive personal jurisdiction in case of any disputes arising out of or in connection with this warranty.

Warranty Service and Materials include these items: analysis of problem by service personnel, labor and materials required to fix defective parts or replace the unit entirely; functional analysis performed after repair; repair turn-around within 5 to 10 working days of receipt unless special circumstances exist; shipping costs to return unit to the customer.

WARR-STD-HW WARR-STD-HW



# cedar™

BY JUNIPER SYSTEMS

Juniper Systems, Inc.  
1132 West 1700 North  
Logan, UT 84321  
435.753.1881  
junipersys.com

Juniper Systems, EMEA  
4 The Courtyard  
Bromsgrove, B60 3DJ, UK  
+44 (0) 1527 870773  
junipersys.com



Android™ OS



Front 16 MP / Rear Dual 12 MP



IP68 Certified Dust/Water Proof



Qualcomm Snapdragon Octa-core



GPS/GLONASS/BDS



5.5" 1920x1080 AMOLED Screen



6 GB RAM / 64 GB ROM



6000 mAh Battery



Fingerprint Reader

© 2018 Juniper Systems, Inc. All rights reserved. Juniper Systems, Cedar, and CP3 are trademarks and/or registered trademarks of Juniper Systems, Inc. Android is a trademark of Google LLC.

POWERED BY AGM

JSPN: 28120