

# JVC

## DIGITAL VIDEO CAMERA

# GR-X5EK/E

Please visit our Homepage on the World Wide Web for Digital Video Camera:

<http://www.jvc.co.jp/english/cyber/>

For Accessories:

<http://www.jvc.co.jp/english/accessory/>

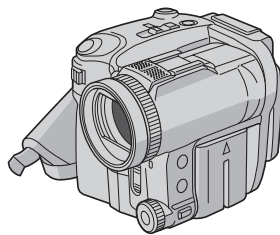

Mini DV PAL



MultiMediaCard

**Dear Customer,**  
Thank you for purchasing this digital video camera. Before use, please read the safety information and precautions contained in the pages 3 – 4 and 10 to ensure safe use of this product.

**ENGLISH**

**GETTING STARTED 6**

**VIDEO RECORDING & PLAYBACK 18**

**DIGITAL STILL CAMERA (D.S.C.) RECORDING & PLAYBACK 25**

**ADVANCED FEATURES 33**

**REFERENCES 51**

**TERMS 62**

To deactivate the demonstration, set "DEMO MODE" to "OFF".  
( pg. 33, 36)

## INSTRUCTIONS

LYT1436-001A

**EN**

## Major Features of this Camcorder

### Wipe/Fader Effects

You can use the wipe/fader effects to make pro-style scene transitions. (☞ pg. 44)

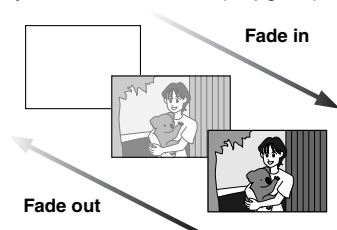

### Program AE and Special Effects

For example, "SPORTS" mode allows fast-moving images to be captured one frame at a time, for vivid, stable slow-motion. (☞ pg. 44, 45)

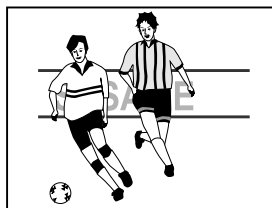

### Flash

The flash fires automatically when shooting still images. (☞ pg. 39)

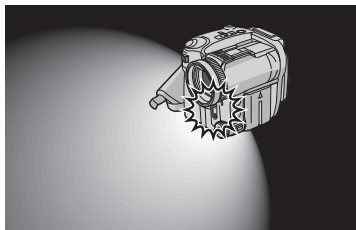

### Backlight Compensation

Simply pressing the **BACKLIGHT** button brightens the image darkened by backlight. (☞ pg. 42)

- You can also select a spot metering area so that more precise exposure compensation is available. (☞ pg. 42, Spot Exposure Control)

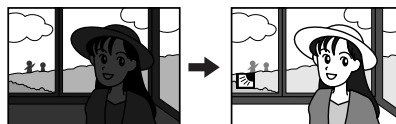

### Data Battery

You can check the battery status by simply pressing the **DATA** button. (☞ pg. 14)

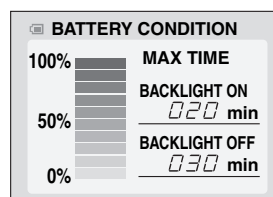

### Direct Printing

If your printer is compatible with PictBridge, still images can be printed easily by connecting the camcorder with USB cable directly to the printer. (☞ pg. 31)

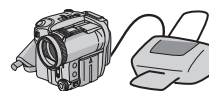

## SAFETY PRECAUTIONS

### IMPORTANT (for owners in the U.K.) Connection to the mains supply in the United Kingdom.

#### DO NOT cut off the mains plug from this equipment.

If the plug fitted is not suitable for the power points in your home or the cable is too short to reach a power point, then obtain an appropriate safety approved extension lead or consult your dealer.

#### BE SURE to replace the fuse only with an identical approved type, as originally fitted, and to replace the fuse cover.

If nonetheless the mains plug is cut off be sure to remove the fuse and dispose of the plug immediately, to avoid possible shock hazard by inadvertent connection to the mains supply.

If this product is not supplied fitted with a mains plug then follow the instructions given below: **DO NOT** make any connection to the Larger Terminal coded E or Green.

The wires in the mains lead are coloured in accordance with the following code:

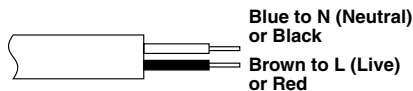

If these colours do not correspond with the terminal identifications of your plug, connect as follows:

Blue wire to terminal coded N (Neutral) or coloured black.

Brown wire to terminal coded L (Live) or coloured Red.

If in doubt — consult a competent electrician.

### WARNING: TO PREVENT FIRE OR SHOCK HAZARD, DO NOT EXPOSE THIS UNIT TO RAIN OR MOISTURE.

#### CAUTIONS:

- To prevent shock, do not open the cabinet. No user serviceable parts inside. Refer servicing to qualified personnel.
- When you are not using the AC Adapter for a long period of time, it is recommended that you disconnect the power cord from AC outlet.

#### CAUTION:

To avoid electric shock or damage to the unit, first firmly insert the small end of the power cord into the AC Adapter until it is no longer wobbly, and then plug the larger end of the power cord into an AC outlet.

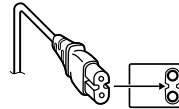

#### CAUTIONS:

- This camcorder is designed to be used with PAL-type colour television signals. It cannot be used for playback with a television of a different standard. However, live recording and LCD monitor playback are possible anywhere.
- This product includes patented and other proprietary technology and will operate only with JVC Data Battery. Use the JVC BN-VF707U/VF714U/VF733U battery packs and, to recharge them or to supply power to the camcorder from an AC outlet, use the provided multi-voltage AC Adapter. (An appropriate conversion adapter may be necessary to accommodate different designs of AC outlets in different countries.)

#### Caution on Replaceable lithium battery

The battery used in this device may present a fire or chemical burn hazard if mistreated.

Do not recharge, disassemble, heat above 100°C or incinerate.

Replace battery with Panasonic (Matsushita Electric), Sanyo, Sony or Maxell CR2025.

Danger of explosion or Risk of fire if the battery is incorrectly replaced.

- Dispose of used battery promptly.
- Keep away from children.
- Do not disassemble and do not dispose of in fire.

#### NOTES:

- The rating plate (serial number plate) and safety caution are on the bottom and/or the back of the main unit.
- The rating information and safety caution of the AC Adapter are on its upper and lower sides.

**4 EN**

When the equipment is installed in a cabinet or on a shelf, make sure that it has sufficient space on all sides to allow for ventilation (10 cm or more on both sides, on top and at the rear).

Do not block the ventilation holes.  
(If the ventilation holes are blocked by a newspaper, or cloth etc. the heat may not be able to get out.)

No naked flame sources, such as lighted candles, should be placed on the apparatus.

When discarding batteries, environmental problems must be considered and the local rules or laws governing the disposal of these batteries must be followed strictly.

The apparatus shall not be exposed to dripping or splashing.

Do not use this equipment in a bathroom or places with water.

Also do not place any containers filled with water or liquids (such as cosmetics or medicines, flower vases, potted plants, cups etc.) on top of this unit.  
(If water or liquid is allowed to enter this equipment, fire or electric shock may be caused.)

Do not point the lens directly into the sun. This can cause eye injuries, as well as lead to the malfunctioning of internal circuitry. There is also a risk of fire or electric shock.

**CAUTION!**

The following notes concern possible physical damage to the camcorder and to the user.

When carrying, be sure to always securely attach and use the provided strap. Carrying or holding the camcorder by the LCD monitor can result in dropping the unit, or in a malfunction.

Take care not to get your finger caught in the cassette holder cover. Do not let children operate the camcorder, as they are particularly susceptible to this type of injury.

Do not use a tripod on unsteady or uneven surfaces. It could tip over, causing serious damage to the camcorder.

**CAUTION!**

Connecting cables (Audio/Video, S-Video, etc.) to the camcorder and leaving it on top of the TV is not recommended, as tripping on the cables will cause the camcorder to fall, resulting in damage.

**SOME DO'S AND DON'TS ON THE SAFE USE OF EQUIPMENT**

**This equipment has been designed and manufactured to meet international safety standards but, like any electrical equipment, care must be taken if you are to obtain the best results and safety is to be assured.**

**DO** read the operating instructions before you attempt to use the equipment.

**DO** ensure that all electrical connections (including the mains plug, extension leads and interconnections between pieces of equipment) are properly made and in accordance with the manufacturer's instructions. Switch off and withdraw the mains plug when making or changing connections.

**DO** consult your dealer if you are ever in doubt about the installation, operation or safety of your equipment.

**DO** be careful with glass panels or doors on equipment.

**DON'T** continue to operate the equipment if you are in any doubt about it working normally, or if it is damaged in any way — switch off, withdraw the mains plug and consult your dealer.

**DON'T** remove any fixed cover as this may expose dangerous voltages.

**DON'T** leave equipment switched on when it is unattended unless it is specifically stated that it is designed for unattended operation or has a standby mode. Switch off using the switch on the equipment and make sure that your family knows how to do this. Special arrangements may need to be made for infirm or handicapped people.

**DON'T** use equipment such as personal stereos or radios so that you are distracted from the requirements of road safety. It is illegal to watch television whilst driving.

**DON'T** listen to headphones at high volume, as such use can permanently damage your hearing.

**DON'T** obstruct the ventilation of the equipment, for example with curtains or soft furnishings. Overheating will cause damage and shorten the life of the equipment.

**DON'T** use makeshift stands and NEVER fix legs with wood screws — to ensure complete safety always fit the manufacturer's approved stand or legs with the fixings provided according to the instructions.

**DON'T** allow electrical equipment to be exposed to rain or moisture.

**ABOVE ALL**

- NEVER let anyone especially children push anything into holes, slots or any other opening in the case — this could result in a fatal electrical shock;
- NEVER guess or take chances with electrical equipment of any kind — it is better to be safe than sorry!

**CONTENTS EN 5**

<b>GETTING STARTED</b>	<b>6</b>	Setting Print Information (DPOF Setting).....	30
Index.....	6	Direct Printing with a PictBridge Printer.....	31
Provided Accessories.....	10	Initialising a Memory Card.....	32
LCD Monitor.....	12		
Power.....	13	<b>ADVANCED FEATURES</b>	<b>33</b>
Operation Mode.....	14	<b>MENUS FOR DETAILED ADJUSTMENT.....</b>	<b>33</b>
Language Setting.....	15	Changing the Menu Settings.....	33
Date/Time Settings.....	15	Recording Menus.....	34
Grip Adjustment.....	15	Playback Menus.....	37
Brightness Adjustment of the Display.....	16	<b>FEATURES FOR RECORDING.....</b>	<b>39</b>
Tripod Mounting.....	16	Snapshot Flash.....	39
Loading/Unloading a Cassette.....	16	Flash Brightness Adjustment.....	39
Loading/Unloading a Memory Card.....	17	Snapshot (For Video Recording).....	39
		Night-Scope.....	40
		Self-Timer.....	40
		5-Second Recording.....	40
		Manual Focus.....	41
<b>VIDEO RECORDING &amp; PLAYBACK</b>	<b>18</b>	Exposure Control.....	41
<b>VIDEO RECORDING.....</b>	<b>18</b>	Iris Lock.....	42
Basic Recording.....	18	Backlight Compensation.....	42
Tape Remaining Time.....	18	Spot Exposure Control.....	42
Zooming.....	19	White Balance Adjustment.....	43
Journalistic Shooting.....	19	Manual White Balance Adjustment.....	43
Time Code.....	19	Wipe or Fader Effects.....	44
Quick Review.....	20	Program AE.....	44
Recording from the Middle of a Tape.....	20	Special Effects.....	45
<b>VIDEO PLAYBACK.....</b>	<b>20</b>	<b>EDITING.....</b>	<b>46</b>
Normal Playback.....	20	Dubbing to or from a VCR.....	46
Still Playback (Pause).....	20	Dubbing to or from a Video Unit equipped with a DV Connector (Digital Dubbing).....	47
Shuttle Search.....	21	Connection to a Personal Computer.....	48
Blank Search.....	21	Insert Editing.....	49
Connections to a TV or VCR.....	22	Audio Dubbing.....	50
Playback Using the Remote Control.....	23		
		<b>REFERENCES</b>	<b>51</b>
<b>DIGITAL STILL CAMERA (D.S.C.) RECORDING &amp; PLAYBACK</b>	<b>25</b>	<b>TROUBLESHOOTING.....</b>	<b>51</b>
<b>D.S.C. RECORDING.....</b>	<b>25</b>	<b>USER MAINTENANCE.....</b>	<b>56</b>
Basic Shooting (D.S.C. Snapshot).....	25	<b>CAUTIONS.....</b>	<b>57</b>
Continuous Shooting.....	25	<b>SPECIFICATIONS.....</b>	<b>60</b>
Bracket Shooting.....	25		
Interval Shooting.....	26	<b>TERMS</b>	<b>62</b>
<b>D.S.C. PLAYBACK.....</b>	<b>26</b>		
Normal Playback of Images.....	26		
Auto Playback of Images.....	26		
Index Playback of Files.....	27		
Viewing File Information.....	27		
Histogram (for Still Image Files).....	27		
Removing On-Screen Display.....	27		
<b>ADDITIONAL FEATURES FOR D.S.C. ....</b>	<b>28</b>		
Dubbing Still Images Recorded on a Tape to a Memory Card.....	28		
Resetting The File Name.....	28		
Protecting Files.....	28		
Deleting Files.....	29		

**6 EN GETTING STARTED**

**Index**

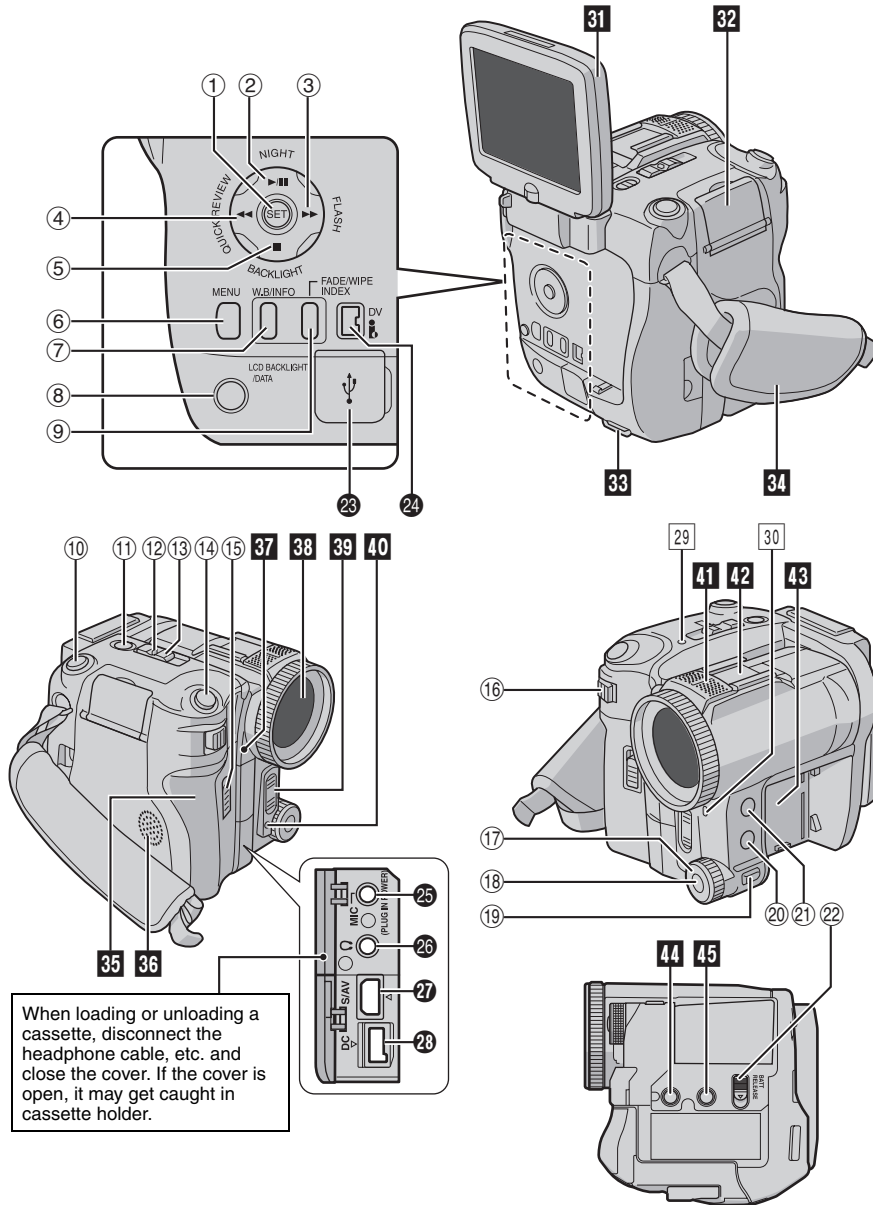

**GETTING STARTED EN 7****Controls**

- ① Set Button [SET] (⇨ pg. 33)
- ② Play/Pause Button [▶/⏸] (⇨ pg. 20)
- ③ Night-Scope Button [NIGHT] (⇨ pg. 40)
- ④ Up Button
- ⑤ Fast-Forward Button [▶▶] (⇨ pg. 20)
- Flash Button [FLASH] (⇨ pg. 39)
- ④ Rewind Button [◀◀] (⇨ pg. 20)
- Quick Review Button [QUICK REVIEW] (⇨ pg. 20)
- ⑤ Stop Button [■] (⇨ pg. 20)
- Backlight Compensation Button [BACKLIGHT] (⇨ pg. 42)
- Down Button
- ⑥ Menu Button [MENU] (⇨ pg. 33)
- ⑦ White Balance Button [W.B] (⇨ pg. 43)
- Information Button [INFO] (⇨ pg. 27)
- ⑧ LCD Backlight Button [LCD BACKLIGHT] (⇨ pg. 16)
- Data Battery Button [DATA] (⇨ pg. 14)
- ⑨ Fade/Wipe Button [FADE/WIPE] (⇨ pg. 44)
- Index Button [INDEX] (⇨ pg. 27)
- ⑩ Recording Start/Stop Button (⇨ pg. 18)
- ⑪ VIDEO/MEMORY Switch (⇨ pg. 14)
- ⑫ Lock Button (⇨ pg. 14)
- ⑬ Power Switch [A, M, PLAY, OFF] (⇨ pg. 14)
- ⑭ Snapshot Button [SNAPSHOT] (⇨ pg. 25, 39)
- ⑮ Cassette Open/Eject Switch [OPEN/EJECT] (⇨ pg. 16)
- ⑯ Power Zoom Lever [T/W] (⇨ pg. 19)
- Speaker/Headphone Volume Control [VOL. +, -] (⇨ pg. 20)
- ⑰ Manual Focus Dial (⇨ pg. 41)
- ⑱ Focus Set Button [SET] (⇨ pg. 41)
- ⑲ Manual Focus Button [FOCUS] (⇨ pg. 41)
- ⑳ Program AE Button [PROGRAM AE] (⇨ pg. 44)
- ㉑ Exposure Button [EXPOSURE] (⇨ pg. 41)
- ㉒ Battery Release Switch [BATT. RELEASE] (⇨ pg. 13)

**Connectors**

The connectors are located beneath the covers.

- ㉓ USB (Universal Serial Bus) Connector (⇨ pg. 48)
- ㉔ Digital Video Connector [DV IN/OUT] (i.Link\*) (⇨ pg. 47, 48)

\* i.Link refers to the IEEE1394-1995 industry specification and extensions thereof. The  logo is used for products compliant with the i.Link standard.

- ㉕ Microphone connector [MIC] (⇨ pg. 12, 50)  
(An optional microphone can be used during video recording and audio dubbing. To stabilise the microphone, use of an optional shoe adapter is recommended.)
- ㉖ Headphone connector [⏸] (⇨ pg. 12, 50)  
(No sound is output from the speaker when headphones are connected to this connector.)
- ㉗ S-Video/Audio/Video Input/Output Connector [S/AV] (⇨ pg. 22, 46)
- ㉘ DC Input Connector [DC] (⇨ pg. 13)

**Indicators**

- ㉙ POWER/CHARGE Lamp (⇨ pg. 13, 18)
- ㉚ Tally Lamp (⇨ pg. 18)

**Other Parts**

- ㉛ LCD Monitor (⇨ pg. 12)
- ㉜ Card Cover [MEMORY CARD] (⇨ pg. 17)
- ㉝ Shoulder Strap Eyelet (⇨ pg. 11)
- ㉞ Grip Strap (⇨ pg. 15)
- ㉟ Cassette Holder Cover (⇨ pg. 16)
- ㊱ Speaker (⇨ pg. 20)
- ㊲ Remote Sensor (⇨ pg. 23)
- Camera Sensor  
(Be careful not to cover this area, a sensor necessary for shooting is built-in here.)
- ㊳ Lens
- ㊴ Flash (⇨ pg. 39)  
(Be careful not to cover this area in order to obtain proper flash brightness.)
- ㊵ Flash Sensor  
(Be careful not to cover this area, as it contains a sensor required by the flash.)
- ㊶ Stereo Microphone (⇨ pg. 50)
- ㊷ Shoe
  - Attach the optional stereo microphone or video light. Make sure to turn off the power of the camcorder and the microphone before attaching and removing them.
  - The attached microphone may be shot in the image depending on its size.
- ㊸ Battery Pack Mount (⇨ pg. 13)
- ㊹ Stud Hole (⇨ pg. 16)
- ㊺ Tripod Mounting Socket (⇨ pg. 16)

## 8 EN GETTING STARTED

### Indications on LCD Monitor

#### During Video Recording Only

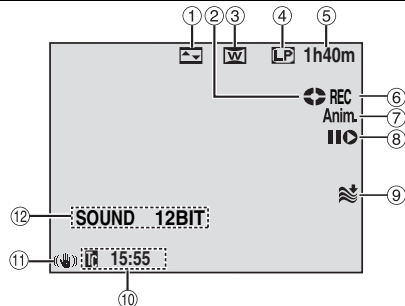

- ① Selected Wipe/Fader Effect Indicator ( pg. 44)
- ② Tape Running Indicator ( pg. 18)  
(Rotates while tape is running.)
- ③ Selected Wide Mode Indicator ( pg. 35)
- ④ Recording Speed Mode (SP/LP) ( pg. 34)
- ⑤ Tape Remaining Time ( pg. 18)
- ⑥ REC: (Appears during recording.) ( pg. 18)  
PAUSE: (Appears during record-standby mode.) ( pg. 18)
- ⑦ 5S/Anim.: Displays the 5-second recording mode or animation recording mode. ( pg. 35, 40)
- ⑧ Insert Editing/Insert Editing Pause Mode ( pg. 49)
- ⑨ Wind Cut Indicator ( pg. 35)
- ⑩ Time Code ( pg. 19, 36)
- ⑪ Digital Image Stabiliser ("DIS") ( pg. 34)
- ⑫ SOUND 12BIT/16BIT: Sound Mode Indicator ( pg. 34) (Appears for approx. 5 seconds after turning on the camcorder.)  
L ■■■■■■ : Auxiliary Microphone Level  
R ■■■■■■ Indicator  
(Appears when an optional microphone is connected. pg. 36, "AUX MIC")

#### During D.S.C. Recording Only

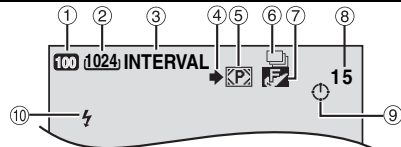

- ① Gain Mode Indicator ( pg. 34)
- ② Image Size: 2560 (2560 x 1920), 2048 (2048 x 1536), 1600 (1600 x 1200), 1280 (1280 x 960), 640 (640 x 480) ( pg. 37)
- ③ Interval Shooting Indicator ( pg. 26)
- ④ Shooting Icon ( pg. 25)  
(Appears and blinks during shooting.)
- ⑤ Card Icon ( pg. 25)  
[P]: Appears during shooting.  
[M]: Blinks in white when a memory card is not loaded.  
[M]: Blinks in yellow while the camcorder is reading the data in the memory card.
- ⑥ [C]: Continuous Shooting Mode Indicator ( pg. 25, 37, 39)  
[B]: Bracket Shooting Mode Indicator ( pg. 25, 37)
- ⑦ Picture Quality: [FINE] / [STANDARD] (in order of quality) ( pg. 36)
- ⑧ Remaining Number Of Shots ( pg. 61)  
(Displays the approximate remaining number of shots that can be stored during D.S.C. recording.)
- ⑨ Clock Icon ( pg. 26)
- ⑩ Flash Indicator ( pg. 39)

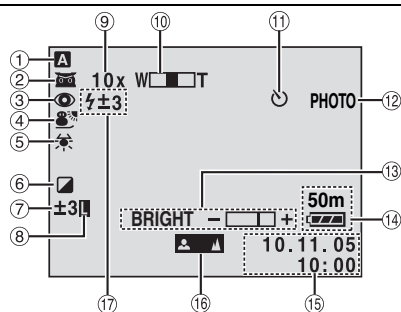

#### During Both Video And D.S.C. Recording



- ① Operation Mode Indicator ( pg. 14)
- ② [N]: Night-Scope Indicator ( pg. 40)  
[A]: Gain Up Mode ( pg. 34)
- ③ Red Eye Reduction Indicator ( pg. 39)
- ④ Program AE Indicator ( pg. 44)
- ⑤ White Balance Indicator ( pg. 43)



**GETTING STARTED EN 9**

- ⑥ Special Effect Indicator (☞ pg. 45)
- ⑦ : Spot Exposure Control Indicator (☞ pg. 42)
- : Backlight Compensation Indicator (☞ pg. 42)
- ±: Exposure Adjustment Indicator (☞ pg. 41)
- ⑧ Iris Lock Indicator (☞ pg. 42)
- ⑨ Approximate Zoom Ratio (☞ pg. 19)
- ⑩ Zoom Indicator (☞ pg. 19)
- ⑪ Self-Timer Recording Indicator (☞ pg. 40)
- ⑫ PHOTO: (Appears when taking snapshot.) (☞ pg. 25, 39)
- ⑬ Brightness Control Indicator (☞ pg. 16)
- ⑭ Battery Remaining Power Indicator (☞ pg. 54)
- ⑮ Date/Time (☞ pg. 15, 36)
- ⑯ Manual Focus Adjustment Indicator (☞ pg. 41)
- ⑰ Flash Indicator (☞ pg. 39)

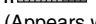
- ⑧ VOLUME: Volume Level Indicator (speaker or headphone) (☞ pg. 20)
- BRIGHT: Brightness Control Indicator (☞ pg. 16)
- ⑨ Time Code (☞ pg. 19, 36)
- ⑩ L  : Auxiliary Microphone Level
- R  Indicator (Appears when an optional microphone is connected during audio dubbing. ☞ pg. 50)



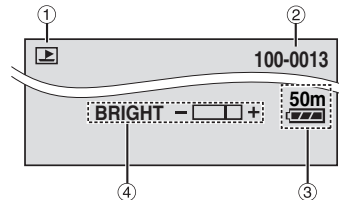



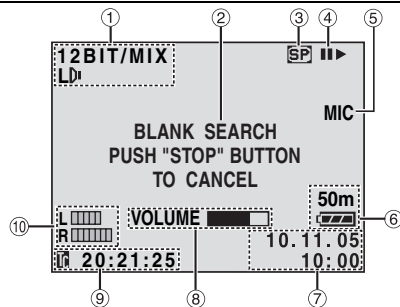

**During D.S.C. Playback**



- ① Operation Mode Indicator (☞ pg. 27)
- ② Folder/File Number (☞ pg. 27)
- ③ Battery Remaining Power Indicator (☞ pg. 54)
- ④ Brightness Control Indicator (☞ pg. 16)

**During Video Playback**



- ① Sound Mode Indicator (☞ pg. 37)
- ② Blank Search Indicator (☞ pg. 21)
- ③ Tape Speed (☞ pg. 34)
- ④ : Playback
- : Fast-Forward/Shuttle Search
- : Rewind/Shuttle Search
- : Pause
- : Forward Frame-By-Frame Playback/Slow-Motion
- : Reverse Frame-By-Frame Playback/Slow-Motion
- : Audio Dubbing
- : Audio Dubbing Pause (Appear while a tape is running.)
- ⑤ Sound Input for Audio Dubbing (☞ pg. 50)
- ⑥ Battery Remaining Power Indicator (☞ pg. 54)
- ⑦ Date/Time (☞ pg. 38)

GETTING STARTED

## 10 EN GETTING STARTED

### Before Using This Camcorder

**Make sure you only use cassettes with the Mini DV mark <sup>Mini</sup>DV.**

**Make sure you only use memory cards with the mark <sup>SD</sup> or MultiMediaCard.**

This camcorder is designed exclusively for the digital video cassette, SD Memory Card and MultiMediaCard. Only cassettes marked "<sup>Mini</sup>DV" and memory cards marked "<sup>SD</sup>" or "MultiMediaCard" can be used with this unit.

**Remember that this camcorder is not compatible with other digital video formats.**

**Remember that this camcorder is intended for private consumer use only.**

Any commercial use without proper permission is prohibited. (Even if you record an event such as a show, performance or exhibition for personal enjoyment, it is strongly recommended that you obtain permission beforehand.)

**Before recording important video, be sure to make a trial recording.**

Play back your trial recording to make sure the video and audio have been recorded properly.

**We recommend cleaning your video heads before use.**

If you haven't used your camcorder for a while, the heads may be dirty. We recommend periodically cleaning the video heads with a cleaning cassette (optional).

**Be sure to store your cassette tapes and camcorder in the proper environment.**

Video heads can become dirty more easily if your cassette tapes and camcorder are stored in a dusty area. Cassette tapes should be removed from the camcorder and stored in cassette cases. Store the camcorder in a bag or other container.

**Use SP (Standard) mode for important video recordings.**

LP (Long Play) mode lets you record 50% more video than SP (Standard) mode, but you may experience mosaic-like noise during playback depending on the tape characteristics and the usage environment.

So, for important recordings, we recommend using SP mode.

**It is recommended that you use JVC brand cassette tapes.**

Your camcorder is compatible with all brands of commercially available cassette tapes complying with the MiniDV standard, but JVC brand cassette tapes are designed and optimized to maximize the performance of your camcorder.

Also read "CAUTIONS" on pages 57 – 59.

- Microsoft® and Windows® are either registered trademarks or trademarks of Microsoft Corporation in the United States and/or other countries.
- Macintosh is a registered trademark of Apple Computer, Inc.
- QuickTime is a registered trademark of Apple Computer, Inc.

### Provided Accessories

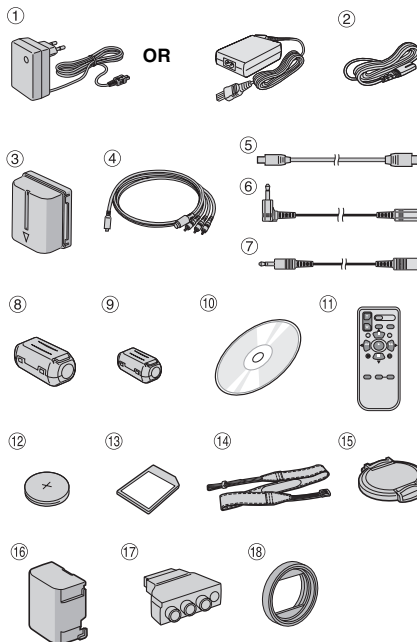

**GETTING STARTED EN 11**

- ① AC Adapter AP-V17E or AP-V14E
- ② Power Cord (only for AP-V14E)
- ③ Battery Pack BN-VF707U
- ④ S-Video/Audio/Video Cable
- ⑤ USB Cable
- ⑥ Audio Extension Cable (for optional microphone, see page 12 for connection)
- ⑦ Audio Extension Cable (for optional headphone, see page 12 for connection)
- ⑧ Core Filter [large] (for USB cable, see page 12 for attachment)  
Core Filter [large] (for power cord, only for AP-V14E, see page 12 for attachment)
- ⑨ Core Filter [small] x5 (for S-Video/Audio/Video cable, audio extension cable and AC adapter's cord, see page 12 for attachment)
- ⑩ CD-ROM
- ⑪ Remote Control Unit RM-V720U
- ⑫ Lithium Battery CR2025\* (for remote control unit)
- ⑬ Memory Card 32 MB (already inserted in the camcorder)
- ⑭ Shoulder Strap (see the right column for attachment)
- ⑮ Lens Cap and its string (see the right column for attachment)
- ⑯ Battery Mount Cover\*\* (already attached on the camcorder)
- ⑰ Cable Adapter
- ⑱ Lens Hood (see below for attachment)

\* A lithium battery is pre-installed in the remote control unit at time of shipment (with insulation sheet). To use the remote control unit, remove the insulation sheet.

\*\* Attach the battery mount cover to protect the battery connector when the battery pack is removed. For the attachment/detachment, refer to "Charging the Battery Pack" (→ pg. 13).

**NOTES:**

- In order to maintain optimum performance of the camcorder, provided cables may be equipped with one or more core filter. If a cable has only one core filter, the end that is closest to the filter should be connected to the camcorder.
- Make sure to use the provided cables for connections. Do not use any other cables.

**Attaching the Lens Hood**

When shooting outside or in bright locations, light can sometimes reflect within the lens and cause a whitish haze to appear over the subject (flare). To prevent flare and provide extra protection for the lens, attach the lens hood to the camcorder.

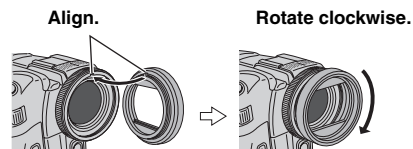

**Rotate counterclockwise to remove it.**

- Remove the lens hood when attaching a conversion lens or lens filter. If this type of lens is attached over the lens hood, the corners of the image may be darkened (vignetting).

**How to Attach the Lens Cap**

To protect the lens, attach the provided lens cap to the camcorder as shown in the illustration.

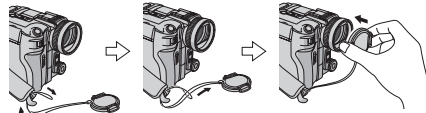
**NOTE:**

To confirm the lens cap is on correctly make sure the cap is flush to the camcorder.



Place here during shooting.

**How to Attach the Shoulder Strap**

Follow the illustration.

- 1** Thread the strap through the eyelet.
- 2** Fold it back and thread it through the strap guide and the buckle.
- To adjust the length of the strap, loosen and then tighten the strap in the buckle.
- 3** Slide the strap guide fully towards the eyelet.

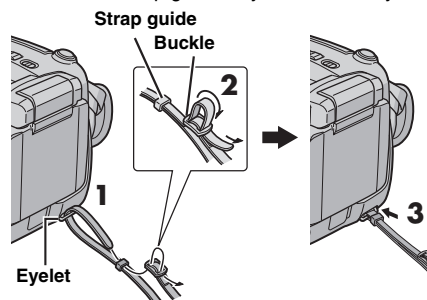

## 12 EN GETTING STARTED

### Attaching the Core Filter

Attach the core filters to the cables. The core filter reduces interference.

**1** Release the stoppers on both ends of the core filter.

**2** Run the cable through the core filter, leaving approx. 3 cm of cable between the cable plug and the core filter.

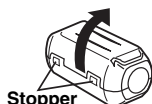

#### S-Video/Audio/Video cable

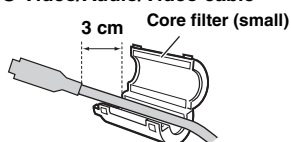

**USB cable, power cord (only for AP-V14E), audio extension cable and AC adapter's cord**  
Wind the cable once around the outside of the core filter as shown in the illustration.

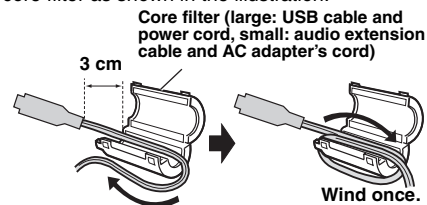

- When attaching to the power cord, attach the core filter near the end which is connected to the AC adapter.
- Wind the cable so that it is not slack.

**3** Close the core filter until it clicks shut.

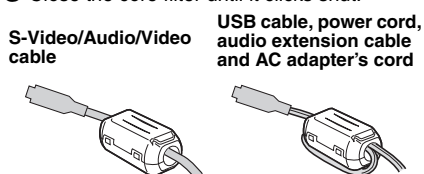

#### NOTES:

- Take care not to damage the cable.
- When connecting a cable, attach the end with the core filter to the camcorder.

### How to Use the Audio Extension Cable

When using optional headphones or external microphone, connect to the provided audio extension cable (with a core filter attached), then connect the audio extension cable to the camcorder. The core filter reduces interference.

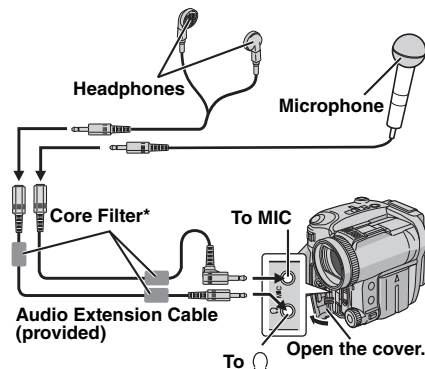

\* Attach two core filters to the audio extension cable for headphones.

### LCD Monitor

Pull on the end (A) of the LCD monitor and open the LCD monitor fully. It can rotate 270°.

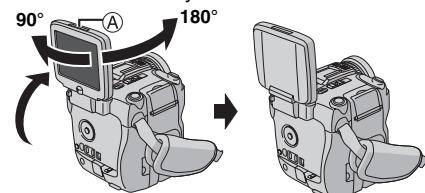

You can also turn the LCD monitor over and move it back to the camcorder body with its monitor facing out.

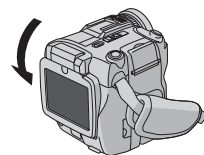

**GETTING STARTED** EN 13**Power**

This camcorder's 2-way power supply system lets you choose the most appropriate source of power. Do not use provided power supply units with other equipment.

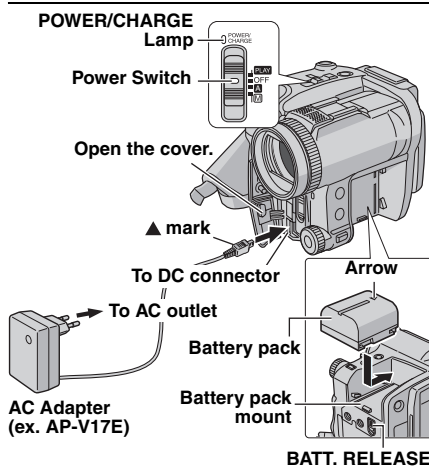
**Charging the Battery Pack**

- 1** Set the power switch to "OFF".
- 2** With the arrow on the battery pack pointing upward, push the battery pack slightly against the battery pack mount.
  - If the battery mount cover is attached, remove it by sliding **BATT. RELEASE**.
- 3** Slide up the battery pack until it locks in place.
- 4** Connect the AC adapter to the camcorder.
- 5** Connect the power cord to the AC adapter. (AP-V14E only)
- 6** Plug the AC adapter into an AC outlet. The POWER/CHARGE lamp on the camcorder blinks to indicate charging has started.
- 7** When the POWER/CHARGE lamp goes out, charging is finished. Unplug the AC adapter from the AC outlet. Disconnect the AC adapter from the camcorder.

**To detach the battery pack**

While sliding **BATT. RELEASE**, remove the battery pack.

Battery pack	Charging time
BN-VF707U*	Approx. 1 hr. 30 min.
BN-VF714U	Approx. 2 hr. 40 min.
BN-VF733U	Approx. 5 hr. 40 min.

\* Provided

**NOTES:**

- **This product includes patented and other proprietary technology and will operate only with JVC Data Battery. Use the JVC BN-VF707U/VF714U/VF733U battery packs. Using generic non-JVC batteries can cause damage to the internal charging circuitry.**
- If the protective cap is attached to the battery pack, remove it first.
- Make sure to use the battery pack with the arrow (Δ) mark. The camcorder does not turn on with the battery mount cover without the arrow (Δ) mark.
- When charging the battery pack for the first time or after a long storage period, the POWER/CHARGE lamp may not light. In this case, remove the battery pack from the camcorder, then try charging again.
- If the battery operation time remains extremely short even after having been fully charged, the battery is worn out and needs to be replaced. Please purchase a new one.
- Since the AC adapter processes electricity internally, it becomes warm during use. Be sure to use it only in well-ventilated areas.
- Using the optional AA-VF7 battery charger, you can charge the BN-VF707U/VF714U/VF733U battery pack without the camcorder.
- After 5 minutes has elapsed in record-standby mode with the cassette inserted, the camcorder will automatically turn off its power supplied from the AC adapter. In this case, the battery charge starts if the battery is attached to the camcorder.

**Using the Battery Pack**

Perform steps **2 – 3** in "Charging the Battery Pack".

**Maximum continuous recording time**

Battery pack	Recording time
BN-VF707U*	45 min. (55 min.)
BN-VF714U	1 hr. 35 min. (1 hr. 55 min.)
BN-VF733U	3 hr. 45 min. (4 hr. 35 min.)

\* Provided

( ): When LCD backlight is off.

## 14 EN GETTING STARTED

### NOTES:

- Recording time is reduced significantly under the following conditions:
  - Zoom or record-standby mode is engaged repeatedly.
  - The LCD monitor is used repeatedly.
  - The playback mode is engaged repeatedly.
- Before extended use, it is recommended that you prepare enough battery packs to cover 3 times the planned shooting time.

### ATTENTION:

Before detaching the power source, make sure that the camcorder's power is turned off. Failure to do so can result in a camcorder malfunction.

### Data Battery System

You can check the remaining battery power and the recordable time.

- Make sure the battery is attached and the power switch is set to "OFF".
- Open the LCD monitor fully.
- Press **DATA**, and the battery status screen appears.

- It is displayed for approx. 3 seconds if the button is pressed and released quickly, and for approx. 15 seconds if the button is pressed and held for several seconds.
- If "COMMUNICATION ERROR" appears instead of the battery status even though you tried to press **DATA** several times, there may be a problem with your battery. In such a case, consult your nearest JVC dealer.
- The recordable time display should only be used as a guide. It is displayed in 10 minute units.

### Using AC Power

Perform step **4** in "Charging the Battery Pack".

### NOTE:

The provided AC adapter features automatic voltage selection in the AC range from 110 V to 240 V.

### About Batteries

**DANGER!** Do not attempt to take the batteries apart, or expose them to flame or excessive heat, as it may cause a fire or explosion.

**WARNING!** Do not allow the battery or its terminals to come in contact with metals, as this can result in a short circuit and possibly start a fire.

### To resume the original function of the accurate battery power indication

If the battery power indication differs from the actual operating time, fully charge the battery, and then run it down. However this function may not turn back if the battery was used for a long period of time under extremely high/low temperature condition or charged too many times.

## Operation Mode

To turn on the camcorder, set the power switch to any operation mode except "OFF" while pressing down the lock button located on the switch. The POWER/CHARGE lamp lights.

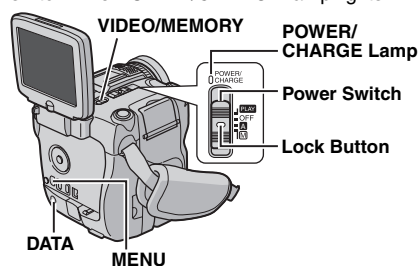

Choose the appropriate operation mode according to your preference using the power switch and **VIDEO/MEMORY** switch.

### Power Switch Position

#### **A** (Full Auto Recording):

Allows you to record using **NO** special effects or manual adjustments. Suitable for standard recording.

The "A" indicator appears on the display.

#### **M** (Manual Recording):

Allows you to set various recording functions using the menus. (pg. 33)

If you want more creative capabilities than full auto recording, try this mode.

#### **OFF:**

Allows you to switch off the camcorder.

#### **PLAY:**

- Allows you to play back a recording on the tape.
- Allows you to display a still image stored in the memory card or to transfer a still image stored in the memory card to a PC.
- Allows you to set various playback functions using the menus. (pg. 33)

## GETTING STARTED EN 15

### VIDEO/MEMORY Switch Position

#### VIDEO:

Allows you to record on a tape or play back a tape. If "REC SELECT" is set to "▶▶ [V] /▶▶ [M]" (▶▶ pg. 37), still images are recorded both on the tape and the memory card.

#### MEMORY:

- Allows you to record in a memory card or access data stored in a memory card.
- When the power switch is set to "[A]" or "[M]", the currently selected image size appears.

### Power-Linked Operation

When the power switch is set to "[A]" or "[M]", you can also turn on/off the camcorder by opening/closing the LCD monitor.

### Language Setting

The language on the display can be changed. (▶▶ pg. 33, 36, 38)

- 1** Set the power switch to "[M]" while pressing down the lock button located on the switch.
- 2** Open the LCD monitor fully. (▶▶ pg. 12)
- 3** Press **MENU**. The menu screen appears.
- 4** Press Up (▶/II) or Down (■) to select "CAMERA DISPLAY", and press **SET**. The CAMERA DISPLAY menu appears.
- 5** Press Up (▶/II) or Down (■) to select "LANGUAGE", and press **SET**.
- 6** Press Up (▶/II) or Down (■) to select the desired language, and press **SET**.
- 7** Press Up (▶/II) or Down (■) to select "URETURN", and press **SET** twice. The menu screen closes.

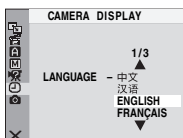
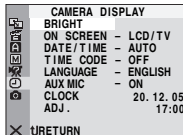

### Date/Time Settings

The date/time is recorded onto the tape at all times, but its display can be turned on or off during playback. (▶▶ pg. 33, 38)

- 1** Perform steps **1** – **4** in "Language Setting" on the left column.
- 2** Press Up (▶/II) or Down (■) to select "CLOCK ADJ.", and press **SET**. The day is highlighted.
- 3** Press Up (▶/II) or Down (■) to input the day, and press **SET**. Repeat to input the month, year, hour and minute.
- 4** Press Up (▶/II) or Down (■) to select "URETURN", and press **SET** twice. The menu screen closes.

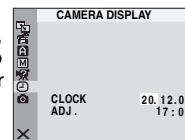

### Grip Adjustment

- 1** Adjust the velcro strip.
- 2** Pass your right hand through the loop and grasp the grip.
- 3** Adjust your thumb and fingers through the grip to easily operate the recording start/stop button, power switch and power zoom lever. Be sure to fasten the velcro strip to your preference.

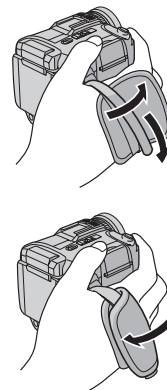

## 16 EN GETTING STARTED

### Brightness Adjustment of the Display

- 1 Set the power switch to "CAM" or "PLAY" while pressing down the lock button located on the switch.
- 2 Open the LCD monitor fully. (See pg. 12)
- 3 Press **MENU**. The menu screen appears.
- 4 Press Up (▲) or Down (▼) to select "CAMERA DISPLAY" or "VIDEO DISPLAY" menu appears.
- 5 Press Up (▲) or Down (▼) to select "BRIGHT", and press **SET**. The menu screen closes and the brightness control indicator appears.
- 6 Press ◀ or ▶ until the appropriate brightness is reached.
- 7 Press **SET** to clear the brightness control indicator from the display.

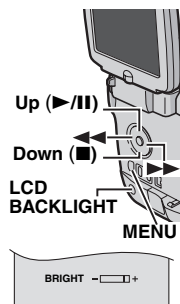

#### LCD monitor's backlight

For normal use, turn the backlight on (bright). If you are shooting in a bright location, turning the LCD backlight off makes the display darker and easier to see. It also reduces battery consumption.

To turn off the LCD backlight, press **LCD BACKLIGHT**.

- To turn on the LCD backlight, press **LCD BACKLIGHT** again.

### Tripod Mounting

To attach the camcorder to a tripod, align the direction stud and screw to the mounting socket and stud hole on the camcorder. Then tighten the screw clockwise.

- Some tripods are not equipped with studs.

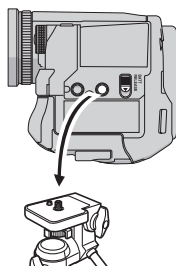

### Loading/Unloading a Cassette

The camcorder needs to be powered up to load or eject a cassette.

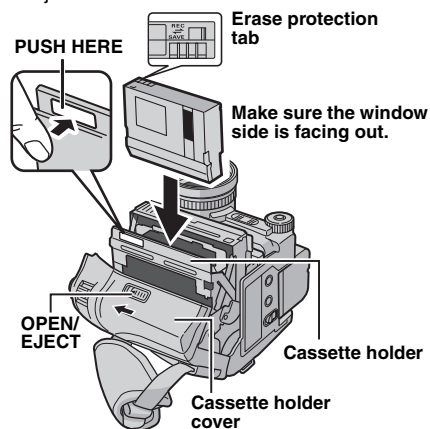

- 1 Slide and hold **OPEN/EJECT** in the direction of the arrow, then pull the cassette holder cover open until it locks. The cassette holder opens automatically.

- Do not touch internal components.

- 2 Insert or remove a tape and press "PUSH HERE" to close the cassette holder.
  - Be sure to press only the section labeled "PUSH HERE" to close the cassette holder; touching other parts may cause your finger to get caught in the cassette holder, resulting in injury or product damage.
  - Once the cassette holder is closed, it recedes automatically. Wait until it recedes completely before closing the cassette holder cover.
  - When the battery pack's charge is low, you may not be able to close the cassette holder cover. Do not apply force. Replace the battery pack with a fully charged one or use AC power before continuing.

- 3 Close the cassette holder cover firmly until it locks into place.

- Be careful not to pinch your fingers by the cassette holder cover.



**GETTING STARTED EN 17****To protect valuable recordings**

Slide the erase protection tab on the back of the tape in the direction of "SAVE". This prevents the tape from being recorded over. To record on this tape, slide the tab back to "REC" before loading it.

**NOTES:**

- If you wait a few seconds and the cassette holder does not open, close the cassette holder cover and try again. If the cassette holder still does not open, turn the camcorder off then on again.
- If the tape does not load properly, open the cassette holder cover fully and remove the cassette. A few minutes later, insert it again.
- When the camcorder is suddenly moved from a cold place to a warm environment, wait a short time before opening the cassette holder cover.

**Loading/Unloading a Memory Card**

The provided memory card is already inserted in the camcorder at the time of purchase.

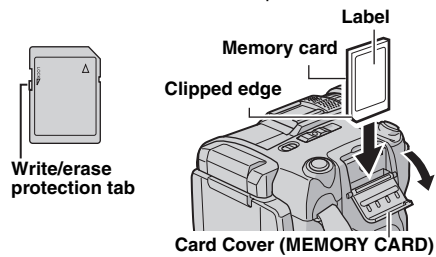

- 1 Make sure the camcorder's power is off.
- 2 Open the card cover (MEMORY CARD).
- 3 **To load a memory card**, firmly insert it with its clipped edge first.  
**To unload a memory card**, push it once. After the memory card comes out of the camcorder, pull it out.
  - Do not touch the terminal on the reverse side of the label.
- 4 Close the card cover.

**To protect valuable files (available only for SD Memory Card)**

Slide the write/erase protection tab on the side of the memory card in the direction of "LOCK". This prevents the memory card from being recorded over. To record on this memory card, slide the tab back to the position opposite to "LOCK" before loading it.

**NOTES:**

- Some brands of memory cards are not compatible with this camcorder. Before purchasing a memory card, consult its manufacturer or dealer.
- Before using a new memory card, it is necessary to format the card. (→ pg. 32)

**ATTENTION:**

Do not insert or remove the memory card while the camcorder is turned on, as this may cause the memory card to be corrupted or cause the camcorder to become unable to recognise whether or not the card is installed.

## 18 EN VIDEO RECORDING

### Basic Recording

**NOTE:**

Before continuing, perform the procedures listed below:

- Power (☞ pg. 13)
- Loading A Cassette (☞ pg. 16)

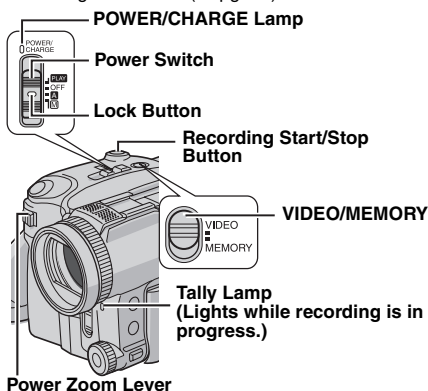

Power Zoom Lever

- 1 Remove the lens cap. (☞ pg. 11)
- 2 Open the LCD monitor fully. (☞ pg. 12)
- 3 Set the VIDEO/MEMORY switch to "VIDEO".
- 4 Set the power switch to "A" or "M" while pressing down the lock button located on the switch.
  - The POWER/CHARGE lamp lights and the camcorder enters the record-standby mode. "PAUSE" is displayed.
  - To record in LP (Long Play) mode, ☞ pg. 34.
- 5 To start recording, press the recording start/stop button. The tally lamp lights and "REC" appears on the display while recording is in progress.
- 6 To stop recording, press the recording start/stop button again. The camcorder re-enters the record-standby mode.

**Approximate recording time**

Tape	Recording mode	
	SP	LP
30 min.	30 min.	45 min.
60 min.	60 min.	90 min.
80 min.	80 min.	120 min.

**NOTES:**

- If the record-standby mode continues for 5 minutes, the camcorder's power shuts off automatically. To turn the camcorder on again, close and re-open the LCD monitor.
- When a blank portion is left between recorded scenes on the tape, the time code is interrupted and errors may occur when editing the tape. To avoid this, refer to "Recording from the Middle of a Tape" (☞ pg. 20).
- To turn the tally lamp or beep sounds off, ☞ pg. 33, 35.
- During recording, sound is not heard from the speaker. To hear the sound, connect optional headphone to the headphone connector.

**Tape Remaining Time**

Approximate tape remaining time appears on the display. "h - m" means the camcorder is calculating the remaining time. When the remaining time reaches 2 minutes, the indication starts blinking.

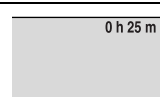

- The time required to calculate and display the remaining tape length, and the accuracy of the calculation, may vary according to the type of tape used.

## VIDEO RECORDING EN 19

### Zooming

Produces the zoom in/out effect, or an instantaneous change in image magnification.

#### To zoom in

Slide the power zoom lever towards "T".

#### To zoom out

Slide the power zoom lever towards "W".

#### Zoom in (T: Telephoto)

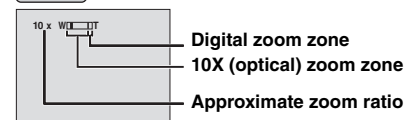
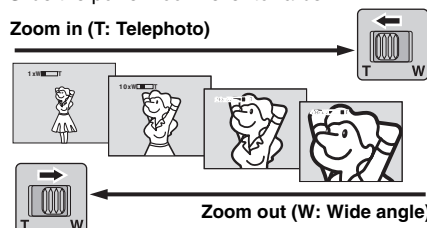

- The further you slide the power zoom lever, the quicker the zoom action.
- Zoom magnification over 10X is done through digital image processing, and is therefore called digital zoom. Digital zooming is possible up to 300X. Set "ZOOM" to "40X" or "300X". (☞ pg. 34)
- Zooming is available up to 8X when the **VIDEO/MEMORY** switch is set to "MEMORY".

#### NOTES:

- Focusing may become unstable during Zooming. In this case, set the zoom while in record-standby, lock the focus by using the manual focus (☞ pg. 41), then zoom in or out in record mode.
- During digital zoom, the quality of image may suffer.
- Macro shooting (as close as approx. 5 cm to the subject) is possible when the power zoom lever is set all the way to "W". Also see "TELE MACRO" in MANUAL menu on page 35.
- When shooting a subject close to the lens, zoom out first. If zoomed-in in the auto focus mode, the camcorder may automatically zoom out depending on the distance between the camcorder and the subject. This will not occur when "TELE MACRO" is set to "ON". (☞ pg. 35)

### Journalistic Shooting

In some situations, different shooting angles may provide more dramatic results. Hold the camcorder in the desired position and tilt the LCD monitor in the most convenient direction.



### Time Code

During recording, a time code is recorded on the tape. This code is to confirm the location of the recorded scene on the tape during playback.

#### Display

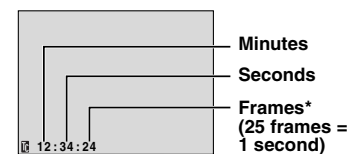

\* Frames are not displayed during recording.

If recording starts from a blank portion, the time code begins counting from "00:00:00" (minute:second:frame). If recording starts from the end of a previously recorded scene, the time code continues from the last time code number. If during recording a blank portion is left partway through the tape, the time code is interrupted. When recording is resumed, the time code starts counting up again from "00:00:00". This means the camcorder may record the same time codes as those existing in a previously recorded scene. To prevent this, perform "Recording from the Middle of a Tape" (☞ pg. 20) in the following cases;

- When shooting again after playing back a recorded tape.
- When power shuts off during shooting.
- When a tape is removed and re-inserted during shooting.
- When shooting using a partially recorded tape.
- When shooting on a blank portion located partway through the tape.
- When shooting again after shooting a scene then opening/closing the cassette holder cover.

CONTINUED ON NEXT PAGE

**20 EN****NOTES:**

- The time code cannot be reset.
- During fast-forwarding and rewinding, the time code indication does not move smoothly.
- The time code is displayed only when "TIME CODE" is set to "ON". (☞ pg. 36)

**Quick Review**

Enables to check the end of the last recording.

- 1) Press **QUICK REVIEW** (◀◀) during the record-standby mode.
  - 2) Tape is rewound for about several seconds and played back automatically, then pauses in the record-standby mode for the next shot.
- Distortion may occur at start of playback. This is not a malfunction.

**Recording from the Middle of a Tape**

- 1) Play back a tape or use blank search (☞ pg. 21) to find the spot at which you want to start recording, then engage the still playback (pause) mode. (See the right column.)
- 2) Set the power switch to "A" or "M" while pressing down the lock button located on the switch, then start recording.

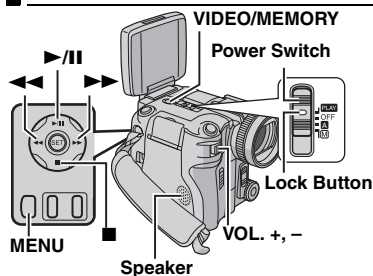
**VIDEO PLAYBACK****Normal Playback**

- 1 Load a cassette. (☞ pg. 16)
  - 2 Set the **VIDEO/MEMORY** switch to "VIDEO".
  - 3 Set the power switch to "PLAY" while pressing down the lock button located on the switch.
  - 4 To start playback, press ▶/II.
  - 5 To stop playback, press ■.
- During stop mode, press ◀◀ to rewind, or ▶▶ to fast-forward the tape.

**To control the speaker volume**

Slide the power zoom lever (**VOL. +, -**) towards "+" to turn up the volume, or towards "-" to turn down the volume.

**NOTES:**

- The playback picture can be viewed in the LCD monitor or on a connected TV. (☞ pg. 22)
- If Stop mode continues for 5 minutes when power is supplied from a battery, the camcorder shuts off automatically. To turn on again, set the power switch to "OFF", then to "PLAY".
- When a cable is connected to the S/AV connector, the sound is not heard from the speaker.

**Still Playback (Pause)**

Pauses during video playback.

- 1) Press ▶/II during playback.
  - 2) To resume normal playback, press ▶/II again.
- If still playback continues for more than about 3 minutes, the camcorder's Stop mode is automatically engaged.

**VIDEO PLAYBACK EN 21****Shuttle Search**

Allows high-speed search in either direction during video playback.

- 1) During playback, press ►► for forward search, or ◀◀ for reverse search.
  - 2) To resume normal playback, press ►/||.
- During playback, press and hold ►► or ◀◀. The search continues as long as you hold the button. Once you release the button, normal playback resumes.
  - A slight mosaic effect appears on the display during shuttle search. This is not a malfunction.

**ATTENTION:**

During shuttle search, parts of the picture may not be clearly visible, particularly on the left side of the screen.

**NOTES:**

- Before starting blank search, if the current position is at a blank portion, the camcorder searches in the reverse direction. If the current position is at a recorded portion, the camcorder searches in the forward direction.
- If the beginning or end of the tape is reached during blank search, the camcorder stops automatically.
- A blank portion which is shorter than 5 seconds of tape may not be detected.
- The detected blank portion may be located between recorded scenes. Before you start recording, make sure there is no recorded scene after the blank portion.

**Blank Search**

Helps you find where you should start recording in the middle of a tape to avoid time code interruption. (☞ pg. 19)

- 1 Load a cassette. (☞ pg. 16)
- 2 Set the **VIDEO/MEMORY** switch to "VIDEO".
- 3 Set the power switch to "PLAY" while pressing down the lock button located on the switch.
- 4 Press **MENU**. The menu screen appears.
- 5 Press **SET** to select "☞". The VIDEO menu appears.
- 6 Press Up (►/||) or Down (■) to select "BLANK SRCH", and press **SET**. The sub menu appears.
- 7 Press Up (►/||) or Down (■) to select "EXECUTE", and press **SET**.
  - The "BLANK SEARCH" indication appears and the camcorder automatically starts reverse or forward search, then stops at the spot which is about 3 seconds of tape before the beginning of the detected blank portion.
  - To cancel blank search, press ■.

## 22 EN VIDEO PLAYBACK

### Connections to a TV or VCR

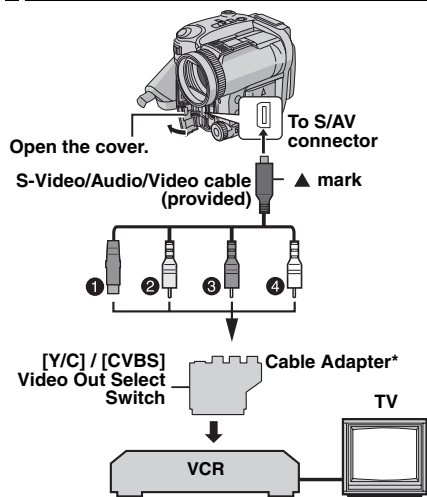

- ❶ Black to S-VIDEO IN (Connect when your TV/VCR has S-VIDEO IN and A/V input connectors. In this case, it is not necessary to connect the yellow video cable.)
- ❷ Yellow to VIDEO IN (Connect when your TV/VCR has only A/V input connectors.)
- ❸ Red to AUDIO R IN\*\*
- ❹ White to AUDIO L IN\*\*

\* If your TV/VCR has a SCART connector, use the provided cable adapter.

\*\* Not required for watching still images only.

#### NOTE:

Set the video out select switch of the cable adapter as required:

**Y/C:** When connecting to a TV or VCR which accepts Y/C signals and uses an S-Video cable.

**CVBS:** When connecting to a TV or VCR which does not accept Y/C signals and uses a video cable.

- ❶ Make sure all units are turned off.
- ❷ Connect the camcorder to a TV or VCR as shown in the illustration.  
**If using a VCR, go to step 3.**  
**If not, go to step 4.**
- ❸ Connect the VCR output to the TV input, referring to your VCR's instruction manual.
- ❹ Turn on the camcorder, the VCR and the TV.
- ❺ Set the VCR to its AUX (auxiliary) input mode, and set the TV to its VIDEO mode.
- ❻ Start playback on the camcorder. (☞ pg. 20)

#### To choose whether or not the following displays appear on the connected TV

- Date/Time  
Set "DATE/TIME" to "AUTO", "ON" or "OFF".  
(☞ pg. 33, 38)  
Or, press **DISPLAY** on the remote control to turn on/off the date indication.
- Time code  
Set "TIME CODE" to "ON" or "OFF".  
(☞ pg. 33, 38)
- Indications other than date/time and time code  
Set "ON SCREEN" to "OFF", "LCD" or "LCD/TV".  
(☞ pg. 33, 38)

#### NOTES:

- **It is recommended to use the AC adapter as the power supply instead of the battery pack.** (☞ pg. 14)
- To monitor the picture and sound from the camcorder without inserting a tape or memory card, set the camcorder's power switch to "A" or "TV", then set your TV to the appropriate input mode.
- Make sure you adjust the TV sound volume to its minimum level to avoid a sudden burst of sound when the camcorder is turned on.

## VIDEO PLAYBACK EN 23

### Playback Using the Remote Control

The full-function remote control unit can operate this camcorder from a distance as well as the basic operations (playback, stop, pause, fast-forward and rewind) of your VCR. It also makes additional playback functions possible. (☞ pg. 24)

#### Installing the Battery

The remote control uses one lithium battery (CR2025).

**1** Pull out the battery holder by pushing the lock tab.

**2** Insert the battery in the holder, and be sure to have the "+" mark visible.

**3** Slide the holder back in until you hear a click.

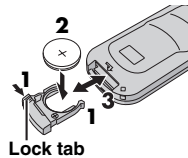

#### Beam Effective Area (indoor use)

When using the remote control, be sure to point it at the remote sensor. The transmitted beam's approximate effective distance for indoor use is 5 m. Use the remote control in front of the camcorder facing toward the lens.

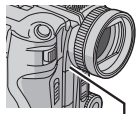

Remote sensor

#### NOTE:

The transmitted beam may not be effective or may cause incorrect operation when the remote sensor is directly exposed to sunlight or powerful lighting.

#### Buttons And Functions

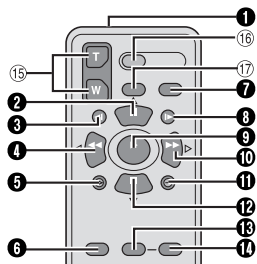

- 1** Infrared beam transmitting window
- Transmits the beam signal.

The following buttons are available only when the camcorder's power switch is set to "PLAY".

- 2** PAUSE Button
- Pauses the tape (☞ pg. 24)
  - Up Button (☞ pg. 24)
- 3** SLOW Rewind Button (☞ pg. 24)
- 4** REW Button
- Rewind/Reverse shuttle search on a tape (☞ pg. 21)
  - Displays previous file in a memory card (☞ pg. 26)
  - Left Button (☞ pg. 24)
- 5** INSERT Button (☞ pg. 49)
- 6** SHIFT Button (☞ pg. 24)
- 7** DISPLAY Button (☞ pg. 22, 46)
- 8** SLOW Forward Button (☞ pg. 24)
- 9** PLAY Button
- Starts playback of a tape (☞ pg. 20)
  - Starts auto playback of images in a memory card (☞ pg. 26)
- 10** FF Button
- Forward/Forward shuttle search on a tape (☞ pg. 21)
  - Displays next file in a memory card (☞ pg. 26)
  - Right Button (☞ pg. 24)
- 11** A. DUB Button (☞ pg. 50)
- 12** STOP Button
- Stops the tape (☞ pg. 20)
  - Stops auto playback (☞ pg. 26)
  - Down Button (☞ pg. 24)
- 13** EFFECT Button (☞ pg. 24)
- 14** EFFECT ON/OFF Button (☞ pg. 24)

The following buttons are available when the camcorder's power switch is set to "A" or "M".

- 15** Zoom (T/W) Buttons
- Zoom in/out (☞ pg. 19, 24)
  - (Also available with the power switch set to "PLAY")
- 16** START/STOP Button
- Functions the same as the recording start/stop button on the camcorder.
- 17** S.SHOT Button
- Functions the same as **SNAPSHOT** on the camcorder.
  - (Also available with the power switch set to "PLAY")

## 24 EN VIDEO PLAYBACK

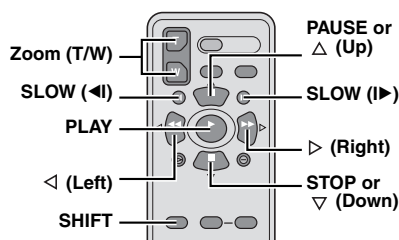

### Slow-Motion Playback

During normal video playback, press **SLOW** (◀| or |▶) more than approx. 2 seconds.

- After approx. 10 minutes, normal playback resumes.
- To pause slow-motion playback, press **PAUSE** (II).
- To stop slow-motion playback, press **PLAY** (▶).

#### NOTES:

- You can also engage slow-motion playback from Still Playback by pressing **SLOW** (◀| or |▶) more than approx. 2 seconds.
- During slow-motion playback, due to digital image processing, the picture may take on a mosaic effect.
- After **SLOW** (◀| or |▶) is pressed and held, the still image may be displayed for a few seconds, followed by a blue screen for a few seconds. This is not a malfunction.
- During slow-motion playback, there will be disturbances in video and the picture may seem unstable, especially with steady images. This is not a malfunction.

### Frame-By-Frame Playback

During normal or still playback, press **SLOW** (|▶) repeatedly for forward or **SLOW** (◀|) repeatedly for reverse. Each time **SLOW** (◀| or |▶) is pressed, the frame is played back.

### Playback Zoom

Magnifies the recorded image up to 30X at any time during video playback and D.S.C. playback.

- 1) Press **PLAY** (▶) to start video playback. Or perform normal playback of images.



- 2) At the point you want to zoom in, press the zoom button (**T**).

- To zoom out, press the zoom button (**W**).



- 3) You can move the image on the screen around to find a particular portion of the picture. While holding down **SHIFT**, press ◀ (Left), ▶ (Right), Δ (Up) and ∇ (Down).



- To end zoom, press and hold **W** until magnification returns to normal. Or, press **STOP** (■) and then press **PLAY** (▶) during video playback.

#### NOTES:

- Zoom can also be used during slow-motion and still playback.
- Due to digital image processing, the quality of the image may suffer.

### Playback Special Effects

Allows you to add creative effects to the video playback image.

- **CLASSIC FILM**: Gives recorded scenes a strobe effect.

**B/W MONOTONE**: Like classic black and white films, your footage is shot in B/W. Used together with the cinema mode (pg. 35, "WIDE MODE"), it enhances the "classic film" effect.

**SEPIA**: Recorded scenes have a brownish tint like old photos. Combine this with the cinema mode (pg. 35, "WIDE MODE") for a classic look.

**STROBE**: Your recording looks like a series of consecutive snapshots.

- 1) To start playback, press **PLAY** (▶).
- 2) Press **EFFECT**.

The **PLAYBACK EFFECT** select menu appears.

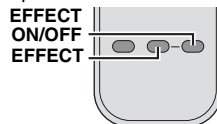

- 3) Press **EFFECT** repeatedly to move the highlight bar to the desired effect.

- The selected function is activated and after 2 seconds the menu disappears.

- To deactivate the selected effect, press **EFFECT ON/OFF**. To reactivate the selected effect press **EFFECT ON/OFF** again.

- To change the selected effect, repeat from step 2 above.



## Basic Shooting (D.S.C. Snapshot)

You can use your camcorder as a Digital Still Camera for taking snapshots. Still images are stored in the memory card.

### NOTE:

Before continuing, perform the procedures listed below:

- Power (⇨ pg. 13)
- Loading a Memory Card (⇨ pg. 17)

### VIDEO/MEMORY

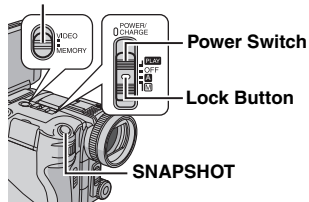

- 1 Remove the lens cap.
- 2 Open the LCD monitor fully. (⇨ pg. 12)
- 3 Set the **VIDEO/MEMORY** switch to "MEMORY".
- 4 Set the power switch to "A" or "M" while pressing down the lock button located on the switch.
  - To change the image size and/or picture quality, ⇨ pg. 33, 36, 37.
- 5 Press **SNAPSHOT**. The "PHOTO" indication appears while the snapshot is being taken.
  - Still images are recorded in the snapshot mode with no frame.
  - To delete unwanted still images, refer to "Deleting Files" (⇨ pg. 29).
  - When you do not want to hear the shutter sound, set "BEEP" to "OFF". (⇨ pg. 33, 35)

### NOTES:

- If shooting is not performed for approx. 5 minutes when the power switch is set to "A" or "M" and power is supplied from the battery pack, the camcorder shuts off automatically to save power. To perform shooting again, close and re-open the LCD monitor.
- For approximate number of storable images, see page 61.

## Continuous Shooting

Keeping **SNAPSHOT** pressed in step 5 provides an effect similar to serial photography.

To use this function, set "C SHOOTING" to "ON". (⇨ pg. 33, 37) The  indicator appears.

## Bracket Shooting

In addition to an image with the exposure automatically set by the camcorder, two other images are recorded with exposure values shifted to the +0.3EV and -0.3EV sides. You can select the image that has a suitable exposure after shooting.



- 1 Set "C SHOOTING" to "BRACKET". (⇨ pg. 33, 37) The  indicator appears.
  - 2 Set the **VIDEO/MEMORY** switch to "MEMORY".
  - 3 Set the power switch to "A" or "M" while pressing down the lock button located on the switch.
  - 4 Press **SNAPSHOT** for bracket shooting.
    - Three images are recorded.
- To cancel bracket shooting mode**  
Set "C SHOOTING" to "OFF" in step 1.

### NOTE:

The shutter speed cannot be fixed in the bracket shooting, even if the shutter priority (⇨ pg. 45) is set.

**26 EN****Interval Shooting**

During interval shooting mode, the camcorder continues to take snapshots automatically with an interval of your desired setting.

- 1** Set "INT.SHOT" to "ON". (☞ pg. 33, 37)
  - "INTERVAL" and "⌚" appear.
- 2** Set "INT.TIME" to the desired shooting interval. (☞ pg. 33, 37)
- 3** Set the power switch to "A" or "M" while pressing down the lock button located on the switch.
- 4** Press **SNAPSHOT**.
  - First shot is taken after 2 seconds.
  - The "PHOTO" indicator appears while the snapshot is being taken.
  - The clock icon "⌚" turns while waiting for the next shot is being taken.
  - The next shot is being taken automatically when the shooting interval set in step **2** has passed.
- 5** Press **SNAPSHOT** to stop interval shooting.

**To cancel interval shooting mode**

Set "INT.SHOT" to "OFF" in step **1**.

**NOTES:**

- It is recommended to use the AC adapter as the power supply instead of the battery pack. (☞ pg. 13, 14)
- To distinguish between still images taken in interval shooting mode and other still images, it is recommended that you reset the file names before shooting. (☞ pg. 28)
- Interval shooting will stop if the battery runs out of power or the memory card becomes full.
- The function "Animation" in the provided software "Digital Photo Navigator" can be used to create movie files from the captured still images (Windows® only). To create movie files with the Macintosh, it is recommended that you use the function "Creating a Slideshow From Still Images" in the commercial software "QuickTime Pro".

**D.S.C. PLAYBACK****Normal Playback of Images**

Images shot with the camcorder are automatically numbered, then stored in numerical order in the memory card. You can view the stored images, one at a time, much like flipping through a photo album.

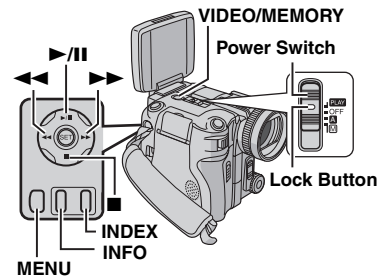

- 1** Load a memory card. (☞ pg. 17)
- 2** Set the VIDEO/MEMORY switch to "MEMORY".
- 3** Set the power switch to "PLAY" while pressing down the lock button located on the switch.
  - A stored image is displayed.
- 4** Press ◀◀ to display the previous file. Press ▶▶ to display the next file.

**NOTE:**

Images shot and stored in the memory card with another device with resolutions other than "640 x 480", "1280 x 960", "1600 x 1200", "2048 x 1536" and "2560 x 1920" will be displayed as thumbnails only. These thumbnail images cannot be transferred to a PC.

**Playback Zoom**

Available only with the remote control. (☞ pg. 24)

**Auto Playback of Images**

You can run through all the images stored in the memory card automatically.

- 1** Perform steps **1** – **3** in "Normal Playback of Images" (☞ pg. 26).
- 2** Press ▶/II to start auto playback.
  - If you press ◀◀ during auto playback, files are displayed in descending order.
  - If you press ▶▶ during auto playback, files are displayed in ascending order.
- 3** To end auto playback, press ■.

**D.S.C. PLAYBACK EN 27****Index Playback of Files**

You can view several different files stored in the memory card at a time. This browsing capability makes it easy to locate a particular file you want.

**1** Perform steps **1 – 3** in “Normal Playback of Images” (☞ pg. 26).

**2** Press **INDEX**. The index screen appears.

**3** Press Up (▶/II)/Down (■)/◀◀/▶▶ to move the frame to the desired file.

**4** Press **SET**. The selected file is displayed.

Selected file



Index number

**Viewing File Information**

You can get the relevant file information by pressing the **INFO** button during normal playback or index playback.

**FOLDER:** Folder name (☞ pg. 28)

**FILE:** File name (☞ pg. 28)

**DATE:** Date the file was made

**SIZE:** Image size

**QUALITY:** Picture quality

**PROTECT:** When set to “ON”, the file is protected from accidental erasure. (☞ pg. 28)

• Press the **INFO** button twice to close the information screen.

FOLDER	: 100JVCGR
FILE	: DVC00010
DATE	: 27. 10. 05
SIZE	: 2560X1920
QUALITY	: FINE
PROTECT	: OFF

**NOTE:**

With images shot with other devices or processed on a PC, “QUALITY: ---” will be displayed.

**Histogram (for Still Image Files)**

A histogram is a graph indicating the image's brightness. The horizontal axis indicates the brightness level (darker on the left and brighter on the right), while the vertical axis indicates how many pixels exist for each brightness level.



The more pixels there are in centre position, the exposure is proper and the brightness is well-balanced.

The more pixels there are toward the left, the darker the image.

The more pixels there are toward the right, the brighter the image.

By checking the image and its histogram, you can see the exposure level pattern and the overall tone reproduction condition.

**To display the histogram**

Press **INFO** twice while a still image is displayed.

**To turn off the histogram**

Press **INFO** once.

**NOTE:**

The shutter speed, F-number and ISO sensitivity (GAIN) are also displayed as recording information with histogram. The shutter speed displayed during shooting is an approximation. It may not match the one displayed with histogram.

**Removing On-Screen Display**

**1** Perform steps **1 – 3** in “Normal Playback of Images” (☞ pg. 26).

**2** Press **MENU**. The menu screen appears.

**3** Press Up (▶/II) or Down (■) to select “DISPLAY”, and press **SET**. The sub menu appears.

**4** Press Up (▶/II) or Down (■) to select “OFF”, and press **SET**. The operation mode indicator, folder/file number and battery remaining power indicator disappear.

• To display the indicators again, select “ON”.

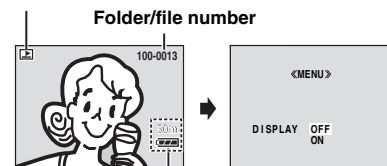
**Operation mode indicator**

Battery remaining power indicator

## 28 EN *ADDITIONAL FEATURES FOR D.S.C.*

### Dubbing Still Images Recorded on a Tape to a Memory Card

Still images can be dubbed from a tape to a memory card.

- 1 Load a cassette. (☞ pg. 16)
- 2 Load a memory card. (☞ pg. 17)
- 3 Set the **VIDEO/MEMORY** switch to "VIDEO".
- 4 Set the power switch to "PLAY" while pressing down the lock button located on the switch.
- 5 Set " COPY" to "ON". (☞ pg. 33, 38)
- 6 Press **▶/II** to start playback.
- 7 At the point you want to dub, press **▶/II** again to engage Still Playback.
- 8 To dub the image, press **SNAPSHOT**.
  - The "

#### NOTES:

- To use playback special effects with a video image you wish to dub, perform up to step 8 using the remote control. (☞ pg. 24)
- Images are dubbed in 640 x 480 pixels.

### Resetting The File Name

By resetting the file name, a new folder will be made. The new files you are going to make will be stored in the new folder. It is convenient to separate the new files from previously made files.

- 1 Perform steps 1 – 3 in "Normal Playback of Images" (☞ pg. 26).
- 2 Press **MENU**. The menu screen appears.
- 3 Press Up (**▶/II**) or Down (**■**) to select "NO. RESET", and press **SET**. The NO. RESET screen appears.
- 4 Press Up (**▶/II**) or Down (**■**) to select "EXECUTE", and press **SET**. The new folder (such as "101JVCGR") will be made and the file name of the next shot starts from DVC00001.

#### NOTE:

If the file name reaches DVC09999, a new folder (such as "101JVCGR") will be made and the file name will start again from DVC00001.

### Protecting Files

The protect mode helps prevent the accidental erasure of files.

- 1 Perform steps 1 – 3 in "Normal Playback of Images" (☞ pg. 26).
- 2 Press **MENU**. The menu screen appears.
- 3 Press Up (**▶/II**) or Down (**■**) to select "PROTECT", and press **SET**. The sub menu appears.

#### To protect the currently displayed file

- 4 Press Up (**▶/II**) or Down (**■**) to select "CURRENT", and press **SET**. The PROTECT screen appears.

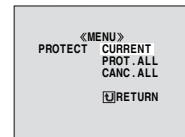

- 5 Press **◀◀** or **▶▶** to select the desired file.

- 6 Press Up (**▶/II**) or Down (**■**) to select "EXECUTE", and press **SET**.



- To cancel protection, select "RETURN".
- Repeat steps 5 and 6 for all files you want to protect.

#### To protect all files stored in the memory card

- 4 Press Up (**▶/II**) or Down (**■**) to select "PROT.ALL", and press **SET**. The PROTECT screen appears.

- 5 Press Up (**▶/II**) or Down (**■**) to select "EXECUTE", and press **SET**.

- To cancel protection, select "RETURN".

#### NOTES:

- If the "
- When the memory card is initialised or corrupted, even protected files are deleted. If you do not want to lose important files, transfer them to a PC and save them.

**ADDITIONAL FEATURES FOR D.S.C. EN 29****To Remove Protection**

Before doing the following, perform steps **1 – 3** in "Protecting Files".

**To remove protection from the currently displayed file**

**4** Press Up (▶/II) or Down (■) to select "CURRENT", and press **SET**. The PROTECT screen appears.

**5** Press ◀◀ or ▶▶ to select the desired file.

**6** Press Up (▶/II) or Down (■) to select "EXECUTE", and press **SET**.

- To cancel selection, select "RETURN".
- Repeat steps **5** and **6** for all files you want to remove protection.

**To remove protection from all files stored in the memory card**

**4** Press Up (▶/II) or Down (■) to select "CANC.ALL", and press **SET**. The PROTECT screen appears.

**5** Press Up (▶/II) or Down (■) to select "EXECUTE", and press **SET**.

- To cancel selection, select "RETURN".

**Deleting Files**

Previously stored files can be deleted either one at a time or all at once.

**1** Perform steps **1 – 3** in "Normal Playback of Images" (☞ pg. 26).

**2** Press **MENU**. The menu screen appears.

**3** Press Up (▶/II) or Down (■) to select "DELETE", and press **SET**. The sub menu appears.

**To delete the currently displayed file**

**4** Press Up (▶/II) or Down (■) to select "CURRENT", and press **SET**. The DELETE screen appears.

**5** Press ◀◀ or ▶▶ to select the desired file.

**6** Press Up (▶/II) or Down (■) to select "EXECUTE", and press **SET**.

- To cancel deletion, select "RETURN".
- Repeat steps **5** and **6** for all files you want to delete.

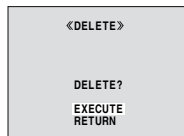
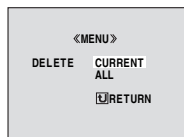
**NOTE:**

If the "Ⓞ" mark appears, the selected file is protected and cannot be deleted.

**To delete all files stored in the memory card**

**4** Press Up (▶/II) or Down (■) to select "ALL", and press **SET**. The DELETE screen appears.

**5** Press Up (▶/II) or Down (■) to select "EXECUTE", and press **SET**.

- To cancel deletion, select "RETURN".

**NOTES:**

- Protected files (☞ pg. 28) cannot be deleted. To delete them, remove protection first.
- Once files are deleted, they cannot be restored. Check files before deleting.

**CAUTION:**

Do not remove the memory card or perform any other operation (such as turning off the camcorder) during deletion. Also, be sure to use the provided AC adapter, as the memory card may be corrupted if the battery becomes exhausted during deletion. If the memory card becomes corrupted, initialise it. (☞ pg. 32)

## 30 EN **ADDITIONAL FEATURES FOR D.S.C.**

### **Setting Print Information (DPOF Setting)**

This camcorder is compatible with the DPOF (Digital Print Order Format) standard in order to support future systems such as automatic printing. You can select one of the 2 print information settings for images stored in the memory card: "To Print All Still Images (One Print For Each)" or "To Print by Selecting Still Images and Number of Prints".

#### **NOTES:**

- If you load a memory card already set as shown below in a printer compatible with DPOF, it will make prints of the selected still images automatically.
- To print images recorded on a tape, first dub them to a memory card. (➔ pg. 28)

#### **To Print All Still Images (One Print For Each)**

**1** Perform steps **1 – 3** in "Normal Playback of Images" (➔ pg. 26).

**2** Press **MENU**. The menu screen appears.

**3** Press Up (▶/II) or Down (■) to select "DPOF", and press **SET**. The sub menu appears.

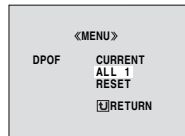

**4** Press Up (▶/II) or Down (■) to select "ALL 1", and press **SET**. The DPOF screen appears.

**5** Press Up (▶/II) or Down (■) to select "EXECUTE", and press **SET**. The normal playback screen appears.

- To cancel the setting, select "RETURN".



### **To Print by Selecting Still Images and Number of Prints**

**1** Perform steps **1 – 3** in "To Print All Still Images (One Print For Each)".

**2** Press Up (▶/II) or Down (■) to select "CURRENT", and press **SET**. The DPOF screen appears.

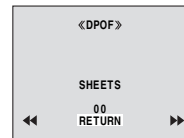

**3** Press ◀◀ or ▶▶ to select the desired file.

**4** Press Up (▶/II) or Down (■) to select the number indication (00), and press **SET**.

**5** Select the number of prints by pressing Up (▶/II) to increase the number, or Down (■) to decrease the number, and press **SET**. The "SAVE?" appears.

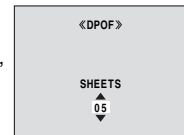

**6** Press Up (▶/II) or Down (■) to select "EXECUTE" to save the setting you have just made, and press **SET**.

- To cancel the setting, select "CANCEL".
- Repeat steps **3** through **6** for the desired number of prints.
- The number of prints can be set up to 15.
- To correct the number of prints, select the image again and change the number.
- If you did not change any settings in step **3** through **5**, the menu screen reappears.

**7** Press **SET** three times to close the menu screen.

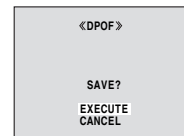

**ADDITIONAL FEATURES FOR D.S.C. EN 31****To Reset the Number of Prints**

- 1** Perform steps **1 – 3** in “To Print All Still Images (One Print For Each)”.
- 2** Press Up (▲/II) or Down (▼) to select “RESET”, and press **SET**. The DPOF screen appears.
- 3** Press Up (▲/II) or Down (▼) to select “EXECUTE”, and press **SET**.
  - To cancel the setting, select “RETURN”.
  - The number of prints is reset to 0 for all still images.
- 4** Press **SET** three times to close the menu screen.

**CAUTION:**

While performing the above, never disconnect power, as this may cause the memory card to be corrupted.

**Direct Printing with a PictBridge Printer**

If your printer is compatible with PictBridge, still images can be printed easily by connecting the camcorder with USB cable directly to the printer. DPOF setting can also be used. (☞ pg. 30)

**NOTE:**

After selecting “DIRECT PRINT” in the menu, connect the USB cable.

**To print by selecting a still image**

- 1** Perform steps **1 – 3** in “Normal Playback of Images” (☞ pg. 26).
- 2** Press **MENU**. The menu screen appears.
- 3** Press Up (▲/II) or Down (▼) to select “DIRECT PRINT”, and press **SET**. A message “PLEASE CONNECT PRINTER” appears.
- 4** Connect the camcorder to the printer with USB cable.
  - After a while, the print menu appears.
- 5** Press Up (▲/II) or Down (▼) to select “SELECTED PRINT” and press **SET**.
- 6** Press ◀◀ or ▶▶ to select the desired file, and press **SET**.
- 7** Press ◀◀ or ▶▶ to select the number of prints.
  - The number of prints can be set from 1 to 99.
- 8** Press Up (▲/II) or Down (▼) to select “DATE”, then press ◀◀ or ▶▶ to select “ON” or “OFF”.
  - Select “ON” to print the date and “OFF” not to print.
- 9** Press Up (▲/II) or Down (▼) to select “PRINT”, and press **SET**. The image is printed.

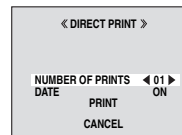
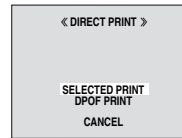
**To cancel the print setting**

Press Up (▲/II) or Down (▼) to select “CANCEL”, and press **SET**.

**To stop printing after printing starts**

- 1** Press **SET**. The confirmation screen appears.
- 2** Press Up (▲/II) or Down (▼) to select “EXECUTE”, and press **SET**.

CONTINUED ON NEXT PAGE

## 32 EN ADDITIONAL FEATURES FOR D.S.C.

### To print using the DPOF setting

If the printer is compatible with DPOF, you can use the DPOF setting. (➤ pg. 30)

**1** Perform steps **1** – **3** in “Normal Playback of Images” (➤ pg. 26).

**2** Press **MENU**. The menu screen appears.

**3** Press Up (▶/II) or Down (■) to select “DIRECT PRINT”, and press **SET**. A message “PLEASE CONNECT PRINTER” appears.

**4** Connect the camcorder to the printer with USB cable.

• After a while, the print menu appears.

**5** Press Up (▶/II) or Down (■) to select “DPOF PRINT”, and press **SET**.

**6** Press Up (▶/II) or Down (■) to select “PRINT”, and press **SET**.

The image is printed.

• To confirm the DPOF setting, select “CHECK SETTINGS”, and press **SET**. You can check images and number of prints by pressing ◀◀ or ▶▶. To return to the previous menu, press Up (▶/II) or Down (■) to select “RETURN”, and press **SET**.

### NOTE:

If the printer is not recognised, or to print again after direct printing with a PictBridge Printer, remove the USB cable, select “DIRECT PRINT” in the menu again, and then reconnect the cable.

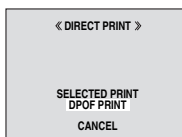

## Initialising a Memory Card

You can initialise a memory card any time.

After initialising, all files and data stored in the memory card, including those which have been protected, are cleared.

**1** Set the **VIDEO/MEMORY** switch to “MEMORY”.

**2** Set the power switch to “PLAY” while pressing down the lock button located on the switch.

**3** Press **MENU**. The menu screen appears.

**4** Press Up (▶/II) or Down (■) to select “FORMAT”, and press **SET**. The **FORMAT** screen appears.

**5** Press Up (▶/II) or Down (■) to select “EXECUTE”, and press **SET**. The memory card is initialised.

• When initialization is finished, “NO IMAGES STORED” appears.

• To cancel initialization, select “RETURN”.

### CAUTION:

Do not perform any other operation (such as turning off the camcorder) during initialization. Also, be sure to use the provided AC adapter, as the memory card may be corrupted if the battery becomes exhausted during initialization. If the memory card becomes corrupted, initialise it.

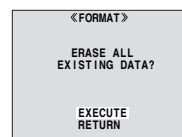



**MENUS FOR DETAILED ADJUSTMENT EN 33**

**Changing the Menu Settings**

This camcorder is equipped with an easy-to-use, on-screen menu system that simplifies many of the more detailed camcorder settings. (pg. 34 – 38)

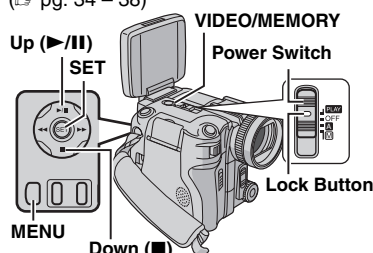

**1 For Video and D.S.C. Recording Menus:**

- Set the VIDEO/MEMORY switch to "VIDEO" or "MEMORY".
- Set the power switch to "V" while pressing down the lock button located on the switch.

**For Video Playback Menus:**

- Set the VIDEO/MEMORY switch to "VIDEO".
- Set the power switch to "PLAY" while pressing down the lock button located on the switch.
- For D.S.C. playback menus, refer to "D.S.C. PLAYBACK" (pg. 26 – 32).

**2** Open the LCD monitor fully. (pg. 12)

**3** Press MENU. The menu screen appears.

**4** Press Up (▶/II) or Down (■) to select the desired function, and press SET. The selected function menu appears.

**Screen for Video and D.S.C. Recording Menu**

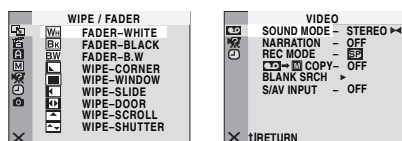

**5** Setting procedure hereafter depends on the selected function.

**Menus without Sub Menus**

- WIPE/FADER (pg. 44)
- EFFECT (pg. 45)

- 1) Press Up (▶/II) or Down (■) to select the desired parameter.
  - Example: EFFECT menu
- 2) Press SET. Selection is complete. The menu screen returns.
  - Repeat the procedure if you wish to set other function menus.
- 3) Press SET. The menu screen closes.

Selected menu icon blinks.

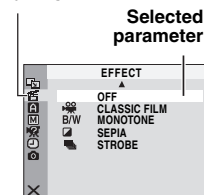

**Menus with Sub Menus**

- CAMERA (pg. 34)
- MANUAL (pg. 34)
- SYSTEM (pg. 35)
- CAMERA DISPLAY (pg. 36)
- DSC (pg. 36)
- VIDEO (pg. 37)
- VIDEO DISPLAY (pg. 38)

- 1) Press Up (▶/II) or Down (■) to select the desired function, and press SET. The sub menu appears.
  - Example: CAMERA menu
- 2) Press Up (▶/II) or Down (■) to select the desired parameter.
- 3) Press SET. Selection is complete.
  - Repeat the procedure if you wish to set other function menus.
- 4) Press SET. The menu screen returns.
- 5) Press SET. The menu screen closes.

Selected menu icon blinks.

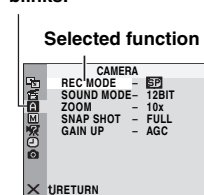

Sub Menu

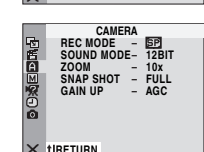
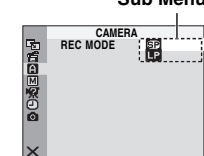

ADVANCED FEATURES

## 34 EN MENUS FOR DETAILED ADJUSTMENT

### Recording Menus

#### CAMERA

The **CAMERA** settings are effective when the power switch is set to both **A** and **M**. However, the menu settings can be changed only when the power switch is set to **M**.

[ ] = Factory-preset

#### REC MODE

**[SP]**: To record in the SP (Standard Play) mode  
**LP**: Long Play—more economical, providing 1.5 times the recording time.

#### NOTES:

- Audio dubbing (pg. 50) and insert editing (pg. 49) are possible on tapes recorded in the SP mode.
- If the recording mode is switched, the playback picture will be blurred at the switching point.
- It is recommended that tapes recorded in the LP mode on this camcorder be played back on this camcorder.
- During playback of a tape recorded on another camcorder, blocks of noise may appear or there may be momentary pauses in the sound.

#### SOUND MODE

**[12BIT]**: Enables video recording of stereo sound on four separate channels. Select "12BIT" mode if you want to perform audio dubbing afterward. (pg. 50) (Equivalent to the 32 kHz mode of previous models)

**16BIT**: Enables video recording of stereo sound on two separate channels. (Equivalent to the 48 kHz mode of previous models)

#### ZOOM

**10X**: Only optical zoom is available up to 10X for video recording and 8X for still image recording.

**[40X]\***: Digital zoom is available up to 40X.

**300X\***: Digital zoom is available up to 300X.

\* Available only when the **VIDEO/MEMORY** switch is set to "VIDEO".

#### SNAP SHOT

**[FULL]**: Snapshot mode with no frame

**NEGA**: Nega mode

**FRAME**: Snapshot mode with frame



[FULL]

NEGA

FRAME

For details on the procedure, refer to "Snapshot (For Video Recording)" (pg. 39).

#### GAIN UP

(Available when the **VIDEO/MEMORY** switch is set to "VIDEO")

**OFF**: Allows you to shoot dark scenes with no picture brightness adjustment.

**[AGC]**: The overall appearance may be grainy, but the image is bright.

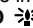
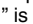
**AUTO**  **A**: The shutter speed is automatically adjusted. Shooting a subject in low or poor lighting at slow shutter speed provides a brighter image than in the AGC mode, but the subject's movements are not smooth or natural. The overall appearance may be grainy. While the shutter speed is being automatically adjusted, " **A**" is displayed.

#### GAIN

(Available when the **VIDEO/MEMORY** switch is set to "MEMORY")

**[AUTO] / ISO 100 / ISO 200 / ISO 400**

Select the ISO sensitivity to the desired setting.

#### MANUAL

The **MANUAL** settings are effective only when the power switch is set to **M**.

[ ] = Factory-preset

#### DIS

(Available when the **VIDEO/MEMORY** switch is set to "VIDEO")

**OFF**: Disables the function.

**[ON]** : To compensate for unstable images caused by camera-shake, particularly at high magnification.

#### NOTES:

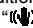
- Accurate stabilization may not be possible if hand shake is excessive, or depending on the shooting condition.
- The " **DIS**" indicator blinks or goes out if the Stabiliser cannot be used.
- Switch off this mode when recording with the camcorder on a tripod.

**MENUS FOR DETAILED ADJUSTMENT EN 35****SELF-TIMER** [OFF] / ON 

 pg. 40, "Self-Timer"

**5S**

[OFF]: Disables 5-second recording.

**5S:** Enables 5-second recording. ( pg. 40)

**Anim.:** Allows you to record a few frames only. By using an inanimate object and changing its position between shots, you can record the subject as though it is moving.

**TELE MACRO**

[OFF]: Disables the function.

**ON:** When the distance to the subject is less than 1 m, set "TELE MACRO" to "ON". You can shoot a subject as large as possible at a distance of approx. 70 cm.

**NOTE:**

Depending on the zoom position, the lens may go out of focus.

**WIDE MODE**

[OFF]: Records with no change in the screen ratio. For playback on a TV with a normal screen ratio.

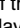
**CINEMA\*** : Inserts black bands at the top and bottom of the screen. The  indicator appears. During playback on wide-screen TVs, the black bands at the top and bottom of the screen are cut and the screen ratio becomes 16:9. When using this mode, refer to your wide-screen TV's instruction manual.

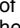
**16:9 WIDE\*** : For playback on TVs with an aspect ratio of 16:9. Naturally expands the image to fit the screen without distortion. The  indicator appears. When using this mode, refer to your wide-screen TV's instruction manual.

\* Available only when the **VIDEO/MEMORY** switch is set to "VIDEO".

**NOTE:**

During playback/recording on 4:3 TVs/LCD monitor, black bands are inserted at the top and bottom of the screen and the image appears like a letter boxed 16:9 movie. (CINEMA and 16:9 WIDE mode)

**WIND CUT**

[OFF]: Disengages the function.

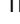
**ON** : Helps cut down on noise created by wind. The "" indicator appears. The quality of the sound will change. This is normal.

**FLASH ADJ.**

 pg. 39, "Flash Brightness Adjustment"

** SYSTEM**

The " SYSTEM" functions which are set when the power switch is set to "M" are also applied when the power switch is set to "PLAY".

[ ] = Factory-preset

**BEEP**

**OFF:** Even though not heard while shooting, shutter sound is recorded on the tape.

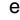
**BEEP:** The beep sounds when the power is turned on or off, and at the beginning and end of recording. It also activates the shutter sound effect. ( pg. 25, 39)

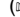
**[MELODY]:** Instead of a beep, a melody sounds when any operation is performed. It also activates the shutter sound effect. ( pg. 25, 39)

**TALLY**

**OFF:** The tally lamp remains off at all times.

**[ON]:** The tally lamp comes on to signal the start of recording.

**REMOTE**

**OFF:** Disables the remote control operations.

**[ON]:** Enables the remote control operations.

## 36 EN MENUS FOR DETAILED ADJUSTMENT

### DEMO MODE

**OFF:** Automatic demonstration will not take place.

**[ON]:** Demonstrates certain functions such as program AE or special effects, etc., and can be used to confirm how these functions operate. Demonstration starts in the following cases:

- When the menu screen is closed after "DEMO MODE" is turned "ON".
- With "DEMO MODE" set to "ON", if there is no operation for about 3 minutes after the power switch is set to "A" or "M".
- Performing any operation during the demonstration stops the demonstration temporarily. If no operation is performed for more than 3 minutes after that, the demonstration will resume.

### NOTES:



- If a cassette is in the camcorder, the demonstration cannot be turned on.
- "DEMO MODE" remains "ON" even if the camcorder power is turned off.
- If "DEMO MODE" remains "ON", some functions will not be available. After viewing demo, set to "OFF".

### CAM RESET

**EXECUTE:** Resets all settings to the factory-preset.

**[RETURN]:** Does not reset all settings to the factory-preset.

### CAMERA DISPLAY

- The  (CAMERA DISPLAY) settings are effective even when the power switch is set to "A". However, the menu settings can be changed only when the power switch is set to "M".
- The  (CAMERA DISPLAY) settings except "BRIGHT", "LANGUAGE" and "AUX MIC" are effective only for shooting.

[ ] = Factory-preset

### BRIGHT

 pg. 16, "Brightness Adjustment of the Display"

### ON SCREEN

**LCD:** Keeps the camcorder's display (except the date, time and time code) from appearing on the connected TV screen.

**[LCD/TV]:** Makes the camcorder's display appear on screen when the camcorder is connected to a TV.

### DATE/TIME

**OFF:** The date/time does not appear.

**[AUTO]:** Displays the date/time for approx. 5 seconds when the power switch is set from "OFF" to "A" or "M".

**ON:** The date/time is always displayed.

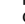
- The date indication can also be turned on/off by pressing the **DISPLAY** button on the remote control. ( pg. 22, 46)

### TIME CODE

**[OFF]:** Time code is not displayed.

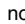
**ON:** Time code is displayed on the camcorder and on the connected TV. Frame numbers are not displayed during recording. ( pg. 19)

### LANGUAGE

中文 / 汉语 / [ENGLISH] / FRANÇAIS / DEUTSCH / ESPAÑOL / ITALIANO / NEDERLANDS / PORTUGUÊS / РУССКИЙ / عربي / فارسي

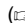
The language setting can be changed. ( pg. 15)

### AUX MIC

**OFF:** Auxiliary microphone level indicator does not appear.

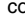
**[ON]:** Displays auxiliary microphone level indicator when optional microphone is connected. ( pg. 12)

### CLOCK ADJ.



 pg. 15, "Date/Time Settings"

### DSC

[ ] = Factory-preset

### QUALITY

**[FINE] / STANDARD**

The picture quality mode can be selected to best match your needs. Two picture quality modes are available: FINE () / STANDARD () (in order of quality).

### NOTE:

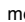
The number of storable images depends on the selected picture quality as well as the composition of the subjects in the images and the type of memory card being used. ( pg. 61)

**MENUS FOR DETAILED ADJUSTMENT EN 37****IMAGE SIZE**

**640 x 480 / 1280 x 960 / 1600 x 1200 / 2048 x 1536 / [2560 x 1920]**

The image size mode can be selected to best match your needs. (⇨ pg. 61)

**NOTE:**

The setting can be changed only when the **VIDEO/MEMORY** switch is set to "MEMORY".

**C SHOOTING**

**[OFF]:** Disables the function.

**ON:** Keeping **SNAPSHOT** pressed provides an effect similar to serial photography. (⇨ pg. 25)

**BRACKET:** Two more images are automatically recorded with exposure values shifted to the +0.3EV and -0.3EV sides. (⇨ pg. 25)

**REC SELECT**

**[ ] (TAPE):** When snapshots are taken with the **VIDEO/MEMORY** switch set to "VIDEO", still images are recorded only onto the tape.

**[ ] (TAPE/CARD):** When snapshots are taken with the **VIDEO/MEMORY** switch set to "VIDEO", still images are recorded not only onto the tape but also in the memory card (640 x 480 pixels). In this mode, the "SNAPSHOT" selection in **CAMERA** menu is also applicable to memory card recording.

**INT.SHOT**

**[OFF]:** Disables the function.

**ON:** Enables interval shooting. (⇨ pg. 26)

**INT.TIME**

**15SEC / 30SEC / [1MIN] / 2MIN / 5MIN / 10MIN / 30MIN / 60MIN**

Allows you to select the shooting interval for interval shooting. (⇨ pg. 26)

**Playback Menus****VIDEO**

[ ] = Factory-preset

**SOUND MODE and NARRATION**

During tape playback, the camcorder detects the sound mode in which the recording was made, and plays the sound back. Select the type of sound to accompany your playback picture.

According to the menu access explanation on page 33, select "SOUND MODE" or "NARRATION" from the menu screen and set it to the desired parameter.

**SOUND MODE**

**[STEREO ]:** Sound is output on both "L" and "R" channels in stereo.

**SOUND L ]:** Sound from the "L" channel is output.

**SOUND R ]:** Sound from the "R" channel is output.

**NARRATION**

**[OFF]:** Original sound is output on both "L" and "R" channels in stereo.

**ON:** Dubbed sound is output on both "L" and "R" channels in stereo. (⇨ pg. 50)

**MIX:** Original and dubbed sounds are combined and output in stereo on both "L" and "R" channels.

## 38 EN MENUS FOR DETAILED ADJUSTMENT

### [SP] / LP

Allows you to set the video recording mode (SP or LP) depending on your preference. It is recommended you use "REC MODE" in VIDEO menu when using this camcorder as a recorder during dubbing. (☞ pg. 46, 47)

### COPY

[OFF]: When the **SNAPSHOT** button is pressed during tape playback, the playback image pauses and normal playback will resume after approximately 6 seconds. (The still image is not recorded.)

**ON**: Enables dubbing of images recorded on a tape to a memory card. (☞ pg. 28)

### BLANK SRCH

☞ pg. 21, "Blank Search"

### S/AV INPUT

[OFF]: Disables audio/video signal input from the S/AV connector. (☞ pg. 46)

**A/V IN**: Enables audio/video signal input from the S/AV connector. (☞ pg. 46)

**S IN**: Enables audio/S-video signal input from the S/AV connector. (☞ pg. 46)

### SYSTEM

Each setting is linked with **SYSTEM**, which appears when the power switch is set to "ON". (☞ pg. 33)

- The parameters are the same as in the description on page 35.

### VIDEO DISPLAY

The **"VIDEO DISPLAY"** (VIDEO DISPLAY) settings are effective only for video playback except "BRIGHT", "LANGUAGE" and "AUX MIC".

- The parameters (except "OFF" in ON SCREEN settings) are the same as in the description (CAMERA DISPLAY) on page 36.

[ ] = Factory-preset

### BRIGHT

☞ pg. 16, "Brightness Adjustment of the Display"

### ON SCREEN OFF / [LCD] / LCD/TV

When set to "OFF", the camcorder's display disappears.

### DATE/TIME [OFF] / AUTO / ON

When set to "AUTO", the date/time are displayed in the following cases:

- When playback starts. The camcorder displays the date/time when scenes are recorded.
- When the date is changed during playback.

### TIME CODE [OFF] / ON

☞ pg. 19, "Time Code"

### LANGUAGE

中文 / 汉语 / [ENGLISH] / FRANÇAIS / DEUTSCH / ESPAÑOL / ITALIANO / NEDERLANDS / PORTUGUÊS / РУССКИЙ / عربي / فارسي

The language setting can be changed. (☞ pg. 15)

### AUX MIC OFF / [ON]

☞ pg. 36, "AUX MIC"

## FEATURES FOR RECORDING EN 39

### Snapshot Flash

The flash can be used when a snapshot is taken in Record-Standby mode. (☞ pg. 25, 39)

- You can select the flash setting. Press **FLASH** (▶▶) repeatedly to select the desired mode.

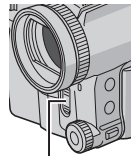

Flash

[  $\zeta$ ±0A ]: Fires automatically if it is dark.

☉  $\zeta$ ±0A: Fires automatically if it is dark and reduces the red-eye effect in the subject's eyes.

$\zeta$ ±0: Always fires.

$\zeta$ ±0S: The flash fires regardless of the shooting condition. The shutter speed becomes slower in this mode, so the background can be also brightened.

**OFF** (No indicator): Will not fire.

[ ] = Factory-preset

If "☉  $\zeta$ ±0A" is selected

The ☉ red-eye reduction indicator lights. Press **SNAPSHOT**. The flash fires twice. The first flash is for reduction of the human eye's red reflection and the second flash is for the actual recording.

#### NOTES:

- Do not fire the flash at a person at short range.
- The flash does not fire when the flash is set to "OFF" or when Night-Scope mode (☞ pg. 40) is engaged, and also when the battery remaining power is low.
- The flash does not fire even if the flash is set to "ON" when continuous shooting or bracket shooting (☞ pg. 25, 39) is performed, or "A" is set to "SPORTS" or "SNOW" (☞ pg. 44).
- When shooting a subject at a distance where the flash light cannot reach (over approx. 2 m), set the flash to "OFF" to prevent the picture from becoming too dark or becoming too tinted.
- While charging the flash,  $\zeta$  blinks and the flash will not fire.

### Flash Brightness Adjustment

When a snapshot is taken (☞ pg. 25) in the dark the camcorder fires the flash and adjusts the brightness automatically. You can also adjust the flash brightness manually. When you find that the snapshots you took look too bright or too dark, adjust it manually.

**1** Select "FLASH ADJ." in MANUAL menu, and press **SET**.

- The parameter appears.

**2** To intensify the flash, press Up (▶/II). To weaken the flash, press Down (■).

- Adjustment range: -3 to +3. (Factory-preset: ±0)

**3** Press **SET** three times to close the menu screen.

#### NOTE:

When you change the subject you are shooting or the shooting location, set it back to ±0 as described in step **2** and take a snapshot to check the flash brightness. After doing this adjust to your desired brightness.

### Snapshot (For Video Recording)

This feature lets you record still images that look like photographs onto a tape.

**1** Set the **VIDEO/MEMORY** switch to "VIDEO".

**2** Set the power switch to "M".

**3** Set "SNAP SHOT" to the desired mode. (☞ pg. 33, 34)

**4** Press **SNAPSHOT**.

- There is the sound effect of a shutter closing.
- The "PHOTO" indication appears and a still image will be recorded for approx. 6 seconds, then the camcorder re-enters the record-standby mode.
- You can take snapshots also during video recording. A still image will be recorded for approx. 6 seconds, then the normal recording resumes.
- Regardless of the power switch position ("A" or "M"), snapshots are taken with the selected snapshot mode.
- The flash does not fire during recording.

### Continuous Shooting

Keeping **SNAPSHOT** pressed in step **4** provides an effect similar to serial photography. (Interval between still images: approx. 1 second)

- The continuous shooting mode is disabled when "REC SELECT" is set to "▶ [ ] ▶ [M]". (☞ pg. 37)

## 40 EN FEATURES FOR RECORDING

### Night-Scope

Makes dark subjects or areas even brighter than they would be under good natural lighting. Although the recorded image is not grainy, it may look as if it is strobing due to the slow shutter speed.

**1** Set the power switch to "M".

**2** Press **NIGHT** (▶/II) so that the Night-Scope indicator "NS" appears.

- The shutter speed is automatically adjusted to provide up to 25 times sensitivity.
- "A" appears beside "0.0" while the shutter speed is being automatically adjusted.

#### To deactivate Night-Scope

Press **NIGHT** (▶/II) again so that the Night-Scope indicator disappears.

#### NOTES:

- During Night-Scope, the following functions or settings cannot be activated and its indicator blinks or goes out:
  - Some modes of "Program AE" or "Special Effects" (⇨ pg. 44, 45)
  - "Snapshot Flash" (⇨ pg. 39)
  - "GAIN UP" in CAMERA menu (⇨ pg. 34)
  - "DIS" in MANUAL menu (⇨ pg. 34)
- During Night-Scope, it may be difficult to bring the camcorder into focus. To prevent this, use of a tripod is recommended.

### Self-Timer

Once the camcorder is set, the camcorder operator can become part of the scene in a more natural way, adding the final touch to a memorable picture.

**1** Set the power switch to "M".

**2** Set "SELF-TIMER" to "ON ☺". (⇨ pg. 33, 35)

- The "☺" indicator appears.

**3** For video recording, press the recording start/stop button.

- The tally lamp starts blinking.
- After 15 seconds, the beep sounds and video recording starts. The tally lamp stays on.

To stop self-timer recording, press the recording start/stop button again.

- The camcorder re-enters record-standby mode.

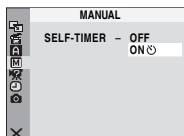

OR

**3** For snapshot, press **SNAPSHOT**.

- The tally lamp starts blinking.
- After 15 seconds, the beep sounds and a snapshot is taken. The tally lamp turns off. After that, the camcorder re-enters record-standby mode.

**4** To end self-timer recording, select "OFF" in step **2**.

#### NOTE:

If "BEEP" and "TALLY" are set to "OFF" (⇨ pg. 35), the beep does not sound and the tally lamp does not light.

### 5-Second Recording

Record a vacation or an important event in 5-second clips to keep the action moving. This function is available only for video recording.

**1** Set "5S" to "5S". (⇨ pg. 33, 35)

- The "5S" indicator appears.

**2** Press the recording start/stop button to start recording, and after 5 seconds the camcorder enters record-standby mode automatically.

- Even if you press the recording start/stop button again within 5 seconds after recording starts, record-standby mode is not engaged.

**3** To exit the 5S mode, select "OFF" in step **1**.

#### To take a snapshot in the 5-second recording mode

Instead of pressing the recording start/stop button in step **2**, select the desired snapshot mode in CAMERA menu (⇨ pg. 34), then press **SNAPSHOT**. The camcorder records a 5-second still. When "5S" is set to "Anim.", this function is not available.

#### NOTE:

When "5S" is set to "Anim.", the 5-second recording mode is not available. Animation recording of a few frames only is taken instead.



---

**FEATURES FOR RECORDING EN 41**

---

## Manual Focus

The camcorder's full range AF system offers continuous shooting ability from close-up (as close as approx. 5 cm to the subject) to infinity. However, correct focus may not be obtained depending on the shooting condition. In this case, use the manual focus mode.

**1** Set the power switch to "M".

**2** Press **FOCUS**. The manual focus indicator appears.

**3** Rotate the manual focus dial to focus on a subject.

- When the focus level cannot be adjusted any further or closer, "▲" or "▶" will blink.

**4** Press **SET** on the manual focus dial. Focus adjustment is complete.

### To reset to Auto Focus

Press **FOCUS** twice or set the power switch to "A".

### Manual focus is recommended in situations listed below.

- When two subjects overlap in the same scene.
- When illumination is low.\*
- When the subject has no contrast (difference in brightness and darkness), such as a flat, one-colour wall, or a clear, blue sky.\*
- When a dark object is barely visible in the LCD monitor.\*
- When the scene contains minute patterns or identical patterns that are regularly repeated.
- When the scene is affected by sunbeams or light reflecting off the surface of a body of water.
- When shooting a scene with a high-contrast background.

\* The following low-contrast warnings appear blinking: ▲, ◀, ▶ and 👤.

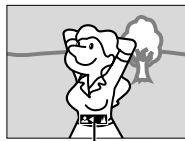

Manual focus indicator

## Exposure Control

Manual exposure control is recommended in the following situations:

- When shooting using reverse lighting or when the background is too bright.
- When shooting on a reflective natural background such as at the beach or when skiing.
- When the background is overly dark or the subject is bright.

**1** Set the power switch to "M".

**2** Press **EXPOSURE**.

- The exposure control indicator appears.

**3** Rotate the manual focus dial to adjust the exposure.

### • Adjustment range

For video recording: -6 to +6

For still image recording: -2.0 to +2.0 (EV)

- +3 exposure has the same effect as the backlight compensation. (☞ pg. 42)

**4** Press **SET** on the manual focus dial. Exposure adjustment is complete.

### To return to automatic exposure control

Press **EXPOSURE** twice. Or, set the power switch to "A".

### NOTES:

- You cannot use the manual exposure control at the same time when program AE is set to "SNOW" (☞ pg. 44), or with the backlight compensation.
- If the adjustment does not cause any visible change in brightness, set "GAIN UP" to "AUTO". (☞ pg. 33, 34)

## 42 EN FEATURES FOR RECORDING

### Iris Lock

Like the pupil of the human eye, the iris contracts in well-lit environments to keep too much light from entering, and dilates in dim environments to allow in more light.

Use this function in the following situations:

- When shooting a moving subject.
- When the distance to the subject changes (so its size in the LCD monitor changes), such as when the subject is backing away.
- When shooting on a reflective natural background such as at the beach or when skiing.
- When shooting objects under a spotlight.
- When zooming.

- 1** Set the power switch to "M".
- 2** Press **EXPOSURE**.
  - The exposure control indicator appears.
- 3** Adjust zoom so that the subject fills the LCD monitor, then press and hold **SET** on the manual focus dial for over 2 seconds. The exposure control indicator and the "L" indication appear.
- 4** Press **SET** on the manual focus dial. The "L" indication changes to "I" and the iris is locked.

#### To return to automatic iris control

Press **EXPOSURE** twice. Or, set the power switch to "A".

- The exposure control indicator and "L" disappear.

#### To lock the exposure control and the iris

After step **2**, adjust the exposure by rotating the manual focus dial. Then lock the iris in steps **3** and **4**. For automatic locking, Press **EXPOSURE** twice in step **2**. The exposure control and the iris become automatic.

### Backlight Compensation

Backlight compensation brightens the subject quickly.

With simple operation, backlight compensation feature brightens the dark subject portion by increasing the exposure.

- 1** Set the power switch to "M".
- 2** Press **BACKLIGHT** (■) so that the backlight compensation indicator "B" appears.

#### To cancel backlight compensation

Press **BACKLIGHT** (■) twice so that the "B" indicator disappears.

#### NOTE:

Using backlight compensation may cause the light around the subject to become too bright and the subject to become white.

### Spot Exposure Control

Selection of a spot metering area enables more precise exposure compensation. You can select one of the three metering areas on the LCD monitor.

- 1** Set the power switch to "M".
- 2** Press **BACKLIGHT** (■) twice so that the Spot Exposure Control indicator "S" appears.
  - A spot metering area frame appears at the centre of the LCD monitor.
- 3** Press ◀ or ▶ to select the desired spot metering area.
- 4** Press **SET**.
  - Spot exposure control is engaged.
  - Exposure is adjusted to make the brightness of the selected area most appropriate.

#### To lock the iris

After step **3**, press and hold **SET** over 2 seconds. The "I" indication appears and the iris is locked.

#### To cancel spot exposure control

Press **BACKLIGHT** (■) once so that the "S" indicator disappears.

#### NOTES:

- You cannot use the spot exposure control at the same time with following functions.
  - "STROBE" in "EFFECT" (⇄ pg. 45)
  - Digital zoom (⇄ pg. 19)
  - Manual exposure control
- Depending on the shooting location and condition, optimum result may not be attained.

---

**FEATURES FOR RECORDING EN 43**

---

## White Balance Adjustment

The white balance refers to the correctness of colour reproduction under various lighting. If the white balance is correct, all other colours will be accurately reproduced.

The white balance is usually adjusted automatically. However, more advanced camcorder operators control this function manually to achieve a more professional colour/tint reproduction.

- 1** Set the power switch to "M".
- 2** Press **W.B** repeatedly to select the desired mode.

**[AUTO]** (No indicator): White balance is adjusted automatically.

 : For adjusting the white balance manually depending on the light source. (→ "Manual White Balance Adjustment")

 : When shooting outdoors on a sunny day.

 : When shooting outdoors on a cloudy day.

 : When a video light or similar type of lighting is used.

[ ] = Factory-preset

- The selected mode indicator except "AUTO" appears.

### To return to automatic white balance



Select "AUTO" in step **2**.

Or, set the power switch to "A".

## Manual White Balance Adjustment

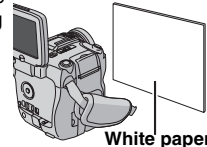
Adjust the white balance manually when shooting under various types of lighting.

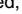

- 1** Set the power switch to "M".
- 2** Hold a sheet of plain white paper in front of the subject. Adjust zoom or position yourself so that the white paper fills the screen.
- 3** Press **W.B** repeatedly to select "".
- 4** Press and hold **W.B** until  begins blinking.
  - When the setting is completed,  stops blinking.

### NOTES:

- In step **2**, it may be difficult to focus on the white paper. In such a case, adjust focus manually. (→ pg. 41)
- A subject can be shot under various types of lighting conditions indoors (natural, fluorescent, candlelight, etc.). Because the colour temperature is different depending on the light source, the subject tint will differ depending on the white balance settings. Use this function for a more natural result.
- Once you adjust white balance manually, the setting is retained even if the power is turned off or the battery removed.

## 44 EN FEATURES FOR RECORDING

### Wipe or Fader Effects

These effects let you make pro-style scene transitions. Use them to spice up the transition from one scene to the next.

Wipe or fader works when video recording is started or stopped.

- 1 Set the **VIDEO/MEMORY** switch to "VIDEO".
- 2 Set the power switch to "M".
- 3 Set "E" to the desired mode. (☞ pg. 33)
- 4 Press **FADE/WIPE**.
  - The selected effect indicator appears.
- 5 Press the recording start/stop button to activate the fade-in/out or wipe-in/out.

#### To deactivate the selected effect

Press **FADE/WIPE** twice in step 4. The effect indicator disappears.

#### NOTES:

- You can extend the length of a wipe or fader by pressing and holding the recording start/stop button.
- Some wipe/fader effects cannot be used with certain modes of program AE and special effects. (☞ pg. 44, 45) In this case, the selected indicator blinks or goes out.

### WIPE/FADER

**W** **FADER-WHITE**: Fade in or out with a white screen.

**B** **FADER-BLACK**: Fade in or out with a black screen.

**BW** **FADER-B.W.**: Fade in to a colour screen from a black and white screen, or fade out from colour to black and white.

**◻** **WIPE-CORNER**: Wipe in on a black screen from the upper right to the lower left corner, or wipe out from lower left to upper right, leaving a black screen.

**◻** **WIPE-WINDOW**: The scene starts in the centre of a black screen and wipes in toward the corners, or comes in from the corners, gradually wiping out to the centre.

**◻** **WIPE-SLIDE**: Wipe in from right to left, or wipe out from left to right.

**◻** **WIPE-DOOR**: Wipe in as the two halves of a black screen open to the left and right, revealing the scene, or wipe out and the black screen reappears from left and right to cover the scene.

**◻** **WIPE-SCROLL**: The scene wipes in from the bottom to the top of a black screen, or wipes out from top to bottom, leaving a black screen.

**◻** **WIPE-SHUTTER**: Wipe in from the centre of a black screen toward the top and bottom, or wipe out from the top and bottom toward the centre leaving a black screen.

### Program AE

You can use the program AE settings for specific shooting situations.

- 1 Set the power switch to "M".
- 2 Press **PROGRAM AE**.
  - The program AE menu appears.
- 3 Rotate the manual focus dial to select the desired mode.
- 4 Press **SET** on the manual focus dial. The setting is completed.
  - The selected program AE indicator appears.

**☼** **TWILIGHT**: Makes evening scenes look more natural. White balance (☞ pg. 43) is automatically set to "☼", but can be changed to your desired setting. When Twilight is chosen, the camcorder automatically adjusts the focus from approx. 10 m to infinity. From less than 10 m, adjust the focus manually. The flash does not fire in this mode.

**◻** **PORTRAIT**: The subject in the front is accentuated by blurring the background.

**⚡** **SPORTS**  
(Variable Shutter Speed: 1/250 – 1/4000): This setting allows fast-moving images to be captured one frame at a time, for vivid, stable slow-motion playback. The faster the shutter speed, the darker the picture becomes. Use the shutter function under good lighting conditions.

**☁** **SNOW**: Compensates for subjects that may otherwise appear too dark when shooting in extremely bright surroundings such as in the snow.

**FEATURES FOR RECORDING EN 45****A PRIORITY (F1.8 – F8.0):**

After selecting "A PRIORITY" (Aperture Priority) in step **3**, rotate the manual focus dial to select the desired value, and press **SET**. You can set the aperture value (F-number) manually. The larger the aperture value (lower F-number), the more blurred the background will become. The smaller the aperture value (higher F-number), the clearer the focus will be both near and far object.

You can select the F-number from F1.8\*/F1.9\*\*/F2.0/F2.8/F4.0/F5.6/F8.0\*.

\* Not available when the **VIDEO/MEMORY** switch is set to "MEMORY".

\*\* Not available when the **VIDEO/MEMORY** switch is set to "VIDEO".

- If it is too bright, set to the larger F-number. If it is too dark, set to the smaller.

**S PRIORITY (1/50 – 1/4000):**

After selecting "S PRIORITY" (Shutter Priority) in step **3**, rotate the manual focus dial to select the desired value, and press **SET**. You can set the shutter speed manually.

**1/50:** The shutter speed is fixed at 1/50 second. Black bands that usually appear when shooting a TV screen become narrower.

**1/120:** The shutter speed is fixed at 1/120 second. The flickering that occurs when shooting under a fluorescent light or mercury-vapor lamp is reduced.

**1/250, 1/500, 1/1000\*, 1/2000\*, 1/4000\*:** Fast shutter speed allows fast-moving subject to be captured one frame at a time vividly. Use these settings when an automatic adjustment does not work well by **SPORTS** mode

\* Available only when the **VIDEO/MEMORY** switch is set to "VIDEO".

**To turn off the program AE**

Select "OFF" in step **3**. The program AE indicator disappears.

**NOTES:**

- Some modes of program AE cannot be used during Night-Scope.
- When a subject is too bright or reflective, a vertical streak may appear (smear phenomenon). Smear phenomenon tends to occur when "SPORTS" is selected.
- Some modes of program AE cannot be used with certain wipe/fader effects (pg. 44). In this case, the selected indicator blinks or goes out.

**Special Effects**

You can add special effects to your recording images.

**1** Set the power switch to "M".

**2** Set "SE" to the desired mode. (pg. 33)

- The selected special effect indicator appears.

**CLASSIC FILM\***: Gives recorded scenes a strobe effect.

**B/W MONOTONE:** Like classic black and white films, your footage is shot in B/W. Used together with the cinema mode (pg. 35, "WIDE MODE"), it enhances the "classic film" effect.

**SEPIA:** Recorded scenes have a brownish tint like old photos. Combine this with the cinema mode (pg. 35, "WIDE MODE") for a classic look.

**STROBE\***: Your recording looks like a series of consecutive snapshots.

\* Available only when the **VIDEO/MEMORY** switch is set to "VIDEO".

**To turn off the special effect**

Select "OFF" in step **2**. The special effect indicator disappears.

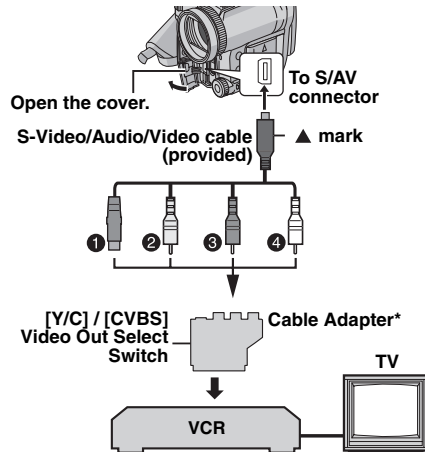
46 EN **EDITING****Dubbing to or from a VCR**

- 1 To S-VIDEO IN or OUT\*\*
- 2 Yellow to VIDEO IN or OUT
- 3 Red to AUDIO R IN or OUT
- 4 White to AUDIO L IN or OUT

\* If your VCR has a SCART connector, use the provided cable adapter. (The provided cable adapter accepts only output signals from this camcorder. To use this camcorder as a recorder, use a commercially available cable adapter.)

\*\* Connect when your TV/VCR has an S-VIDEO IN/OUT connector. In this case, it is not necessary to connect the yellow video cable.

**NOTE:**

Set the video out select switch of the cable adapter as required:

**Y/C:** When connecting to a TV or VCR which accepts Y/C signals and uses an S-Video cable.

**CVBS:** When connecting to a TV or VCR which does not accept Y/C signals and uses a video cable.

**To use this camcorder as a player**

- 1 Following the illustrations, connect the camcorder and the VCR's input connectors.
- 2 Start playback on the camcorder. (☞ pg. 20)
- 3 At the point you want to start dubbing, start recording on the VCR. (Refer to the VCR's instruction manual.)
- 4 To stop dubbing, stop recording on the VCR, then stop playback on the camcorder.

**NOTES:**

- It is recommended to use the AC adapter as the power supply instead of the battery pack. (☞ pg. 14)
- To choose whether or not the following displays appear on the connected TV
  - Date/time
    - Set "DATE/TIME" to "AUTO", "ON" or "OFF". (☞ pg. 33, 38) Or, press **DISPLAY** on the remote control to turn on/off the date indication.
  - Time code
    - Set "TIME CODE" to "OFF" or "ON". (☞ pg. 33, 38)
  - Indications other than date/time and time code
    - Set "ON SCREEN" to "OFF", "LCD" or "LCD/TV". (☞ pg. 33, 38)

**To use this camcorder as a recorder**

- 1 Following the illustrations, connect the camcorder and the VCR's output connectors.
  - 2 Set the camcorder's power switch to "PLAY".
  - 3 Set "REC MODE" to "SP" or "LP". (☞ pg. 33, 38)
  - 4 Set "S/AV INPUT" to "A/V IN" or "S IN"\*. (☞ pg. 33, 38)
- \* Select "S IN" when using S-VIDEO OUT connector on your TV/VCR.
- 5 Press the recording start/stop button to engage the record-pause mode.
    - The "AV IN" or "S IN" indication appears on the screen.
  - 6 Start playback on the player.
  - 7 At the point you want to start dubbing, press the recording start/stop button to start dubbing. The ⏪ indication rotates.
  - 8 Press the recording start/stop button again to stop dubbing. The ⏪ indication stops rotating.
  - 9 Press ■ to return to the normal playback mode.

**NOTES:**

- After dubbing, set "S/AV INPUT" back to "OFF".
- Analogue signals can be converted to digital signals with this procedure.
- It is also possible to dub from another camcorder.

## Dubbing to or from a Video Unit equipped with a DV Connector (Digital Dubbing)

It is also possible to copy recorded scenes from the camcorder onto another video unit equipped with a DV connector. Since a digital signal is sent, there is little if any image or sound deterioration.

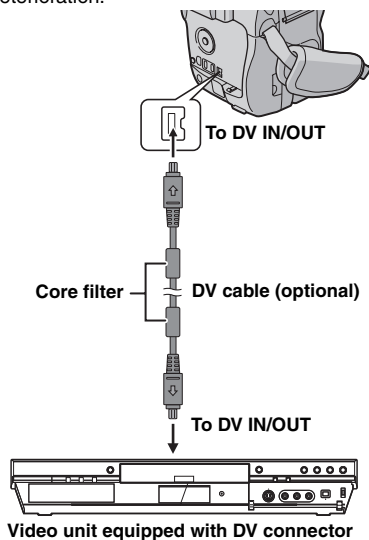

### To use this camcorder as a recorder

- Even though the DV cable is connected correctly, sometimes the image may not appear in step 4. If this occurs, turn off the power and make connections again.
- If "Playback Zoom" (⇨ pg. 24) or "Playback Special Effects" (⇨ pg. 24) is attempted or **SNAPSHOT** is pressed during playback, only the original playback image recorded on the tape is output from the DV IN/OUT connector.
- **When using a DV cable, be sure to use the optional JVC VC-VDV204U DV cable.**

### To use this camcorder as a player

- 1 Make sure all units are turned off.
- 2 Connect this camcorder to a video unit equipped with a DV output connector using a DV cable as shown in the illustration.
- 3 Set the camcorder's power switch to "PLAY".
- 4 Set "REC MODE" to "SP" or "LP". (⇨ pg. 33, 38)
- 5 Press the recording start/stop button to engage the record-pause mode.
  - The "DV IN" indication appears on the screen.
- 6 Start playback on the player.
- 7 At the point you want to start dubbing, press the recording start/stop button to start dubbing. The ⏻ indication rotates.
- 8 Press the recording start/stop button again to stop dubbing. The ⏻ indication stops rotating.
- 9 Press ■ to return to the normal playback mode.

### NOTES:

- If no image is displayed on the LCD monitor, set "S/AV INPUT" to "OFF". (⇨ pg. 33, 38)
- Digital Dubbing is performed in the sound mode recorded on the original tape, regardless of the current "SOUND MODE" setting. (⇨ pg. 34)

### To use this camcorder as a recorder

- 1 Make sure all units are turned off.
- 2 Connect this camcorder to a video unit equipped with a DV input connector using a DV cable as shown in the illustration.
- 3 Start playback on the camcorder. (⇨ pg. 20)
- 4 At the point you want to start dubbing, start recording on the video unit. (Refer to the video unit's instruction manual.)
- 5 To stop dubbing, stop recording on the video unit, then stop playback on this camcorder.

### NOTES:

- It is recommended to use the AC adapter as the power supply instead of the battery pack. (⇨ pg. 14)
- If a blank portion or disturbed image is played back on the player during dubbing, the dubbing may stop so that an unusual image is not dubbed.

48 EN **EDITING****Connection to a Personal Computer**

[A] Using USB cable [B] Using DV cable

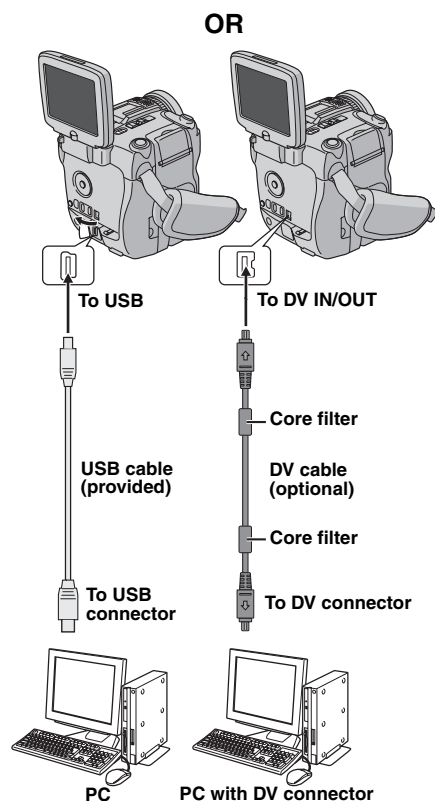

When connecting the camcorder to a PC using a DV cable, make sure to follow the procedure below. Connecting the cable incorrectly may cause malfunctions to the camcorder and/or the PC.

- Connect the DV cable first to the PC, and then to the camcorder.
- Connect the DV cable (plugs) correctly according to the shape of the DV connector.

**[A] Using USB cable**

You can transfer still images stored on a memory card to a PC.

**[B] Using DV cable**

You can also transfer still or moving images recorded on a tape to a PC with a DV connector by using the provided software, software equipped with the PC or commercially available software.

If you are using a Windows® XP, you can use Windows® Messenger to conduct video conferences over the Internet, using a camcorder. For details, refer to the help for the Windows® Messenger.

“USB” and/or “▶▶▶▶▶” appears on the LCD monitor while the PC is accessing data in the camcorder or the camcorder is transferring a file to the PC.

**NEVER disconnect the USB cable while “▶▶▶▶▶” is displayed on the LCD monitor since this can result in product damage.**

**NOTES:**

- If the icon for the recording medium is not displayed on the PC when the camcorder is connected to the PC with a USB cable, either reconnect the cable, or use another USB port.
- When the camcorder is connected to the PC with a DV cable, set the **VIDEO/MEMORY** switch to “VIDEO”.
- Refer to “SOFTWARE INSTALLATION AND PC CONNECTION GUIDE” for the bundled software and drivers.
- **It is recommended to use the AC adapter as the power supply instead of the battery pack.** (☞ pg. 14)



- Never connect the USB cable and the DV cable simultaneously to the camcorder. Connect only the cable you wish to use to the camcorder.
- When using a DV cable, be sure to use the optional JVC VC-VDV206U or VC-VDV204U DV cable depending on the type of DV connector (4 or 6 pins) on the PC.
- If the PC connected to the camcorder via the USB cable is not powered, the camcorder does not enter the USB mode.
- The date/time information cannot be captured into the PC.
- Refer to the instruction manuals of the PC and Software.
- The still images can also be transferred to a PC with a DV connector-equipped capture board.
- The system may not work properly depending on the PC or capture board you are using.

## Insert Editing

You can record a new scene into a previously recorded tape, replacing a section of the original recording with minimal picture distortion at the in and outpoints. The original audio remains unchanged.

- Use the provided remote control.

### NOTES:

- Before performing the following steps, make sure that "TIME CODE" is set to "ON" in CAMERA DISPLAY and VIDEO DISPLAY menus. (→ pg. 33, 36, 38)
- Insert editing is not possible on a tape recorded in the LP mode or on a blank portion of a tape.

**1** Play back the tape, locate the edit-out point and press **PAUSE (II)**. Confirm the time code at this point. (→ pg. 19)

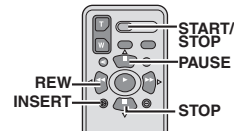

**2** Press **REW (◀◀)** until the edit-in point is located, then press **PAUSE (II)**.

**3** Press and hold **INSERT (▶)** on the remote control, then press **PAUSE (II)**. The "II▶" indicator and the time code (min.:sec.) appear and the camcorder enters insert-pause mode.

**4** Press **START/STOP** to begin editing.

- Confirm the insert at the time code you checked in step 1.
- To pause editing, press **START/STOP**. Press it again to resume editing.

**5** To end insert editing, press **START/STOP**, then **STOP (■)**.

### NOTES:

- Program AE and special effects (→ pg. 44, 45) can be used to spice up the scenes being edited during insert editing.
- During insert editing, the date and time information changes.
- If you perform insert editing onto a blank space on the tape, the audio and video may be disrupted. Make sure you only edit recorded areas.
- During insert editing, when the tape moves to scenes recorded in the LP mode or a blank portion, insert editing stops. (→ pg. 55)

**50 EN EDITING****Audio Dubbing**

The audio track can be customized only when recorded in the 12-BIT and SP modes.

([☞](#) pg. 34)

- Use the provided remote control.

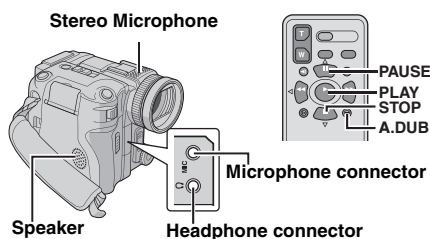

**1** Play back the tape to locate the point where editing will start, then press **PAUSE (II)**.

**2** While holding **A. DUB (⊖)** on the remote control, press **PAUSE (II)**. The **II ⊖** and **"MIC"** indicators appear.

**3** Press **PLAY (▶)**, then begin "narrating". Speak into the microphone on the camcorder.

- To pause dubbing, press **PAUSE (II)**.

**4** To end audio dubbing, press **PAUSE (II)**, then **STOP (■)**.

**To hear the sound during audio dubbing**

Connect optional headphones to the headphone connector or use the S/AV connector, and set the "NARRATION" to the desired mode

([☞](#) pg. 33, 37);

- "OFF" for the playback sound.
- "ON" for the dubbed sound.
- "MIX" for the playback and dubbed sound.

**To hear the dubbed sound during playback**

Set "NARRATION" to "ON" or "MIX".

([☞](#) pg. 33, 37)

**NOTES:**

- When editing onto a tape that was recorded at 12-BIT, the old and new soundtracks are recorded separately.
- If you dub onto a blank space on the tape, the sound may be disrupted. Make sure you only edit recorded areas.
- If feedback or howling occurs during TV playback, move the camcorder's microphone away from the TV, or turn down the TV's volume.
- If you change from 12-BIT to 16-BIT in mid-recording and then use the tape for audio dubbing, it is not effective from the point where 16-BIT recording began.
- During audio dubbing, when the tape moves to scenes recorded in the LP mode, scenes recorded in 16-BIT audio or a blank portion, audio dubbing stops.
- Audio dubbing is also possible using an optional microphone connected to the microphone connector.
- While an optional microphone is connected, the built-in microphone is disabled.
- To perform audio dubbing with a video unit connected to the camcorder's S/AV connector, first set "S/AV INPUT" to "A/V IN" or "S IN" in VIDEO menu. ([☞](#) pg. 33, 38)  
The "AUX" indication appears instead of "MIC".

**TROUBLESHOOTING EN 51**

If, after following the steps in the chart below, the problem still exists, please consult your nearest JVC dealer.

The camcorder is a microcomputer-controlled device. External noise and interference (from a TV, a radio, etc.) might prevent it from functioning properly. In such cases, first disconnect its power supply unit (battery pack, AC adapter, etc.) and wait a few minutes; and then re-connect it and proceed as usual from the beginning.

**Power****No power is supplied.**

- The power is not connected properly.
- Connect the AC adapter securely. (⇨ pg. 14)
- The battery pack is not attached firmly.
- Detach the battery pack once again and re-attach it firmly. (⇨ pg. 13)
- The battery is dead.
- Replace the dead battery with a fully charged one. (⇨ pg. 13)

**Video and D.S.C. Recording****Recording cannot be performed.**

- The tape's erase protection tab is set to "SAVE".
- Set the tape's erase protection tab to "REC". (⇨ pg. 16)
- "TAPE END" appears.
- Replace with new cassette. (⇨ pg. 16)
- The cassette holder cover is open.
- Close the cassette holder cover. (⇨ pg. 16)

**When shooting a subject illuminated by bright light, vertical lines appear.**

- This is not a malfunction.

**When the screen is under direct sunlight during shooting, the screen becomes red or black for an instant.**

- This is not a malfunction.

**During recording, the date/time does not appear.**

- "DATE/TIME" is set to "OFF".
- Set "DATE/TIME" to "ON". (⇨ pg. 33, 36)

**The LCD monitor indications blink.**

- Certain wipe/fader effects, certain modes of program AE and special effects, "DIS" and other functions that cannot be used together are selected at the same time.
- Re-read the sections covering wipe/fader effects, program AE, special effects and "DIS". (⇨ pg. 33, 34, 44, 45)

**Digital zoom does not work.**

- 10X optical zoom is selected.
- Set "ZOOM" to "40X" or "300X". (⇨ pg. 34)
- The VIDEO/MEMORY switch is set to "MEMORY".
- Set the VIDEO/MEMORY switch to "VIDEO".

**Video and D.S.C. Playback****The tape is moving, but there is no picture.**

- Your TV has AV input terminals, but is not set to its VIDEO mode.
- Set the TV to the mode or channel appropriate for video playback. (⇨ pg. 22)
- The cassette holder cover is open.
- Close the cassette holder cover. (⇨ pg. 16)

**Blocks of noise appear during playback, or there is no playback picture and the screen becomes blue.**

- Clean the video heads with an optional cleaning cassette. (⇨ pg. 59)

## 52 EN TROUBLESHOOTING

### Advanced features

#### The focus does not adjust automatically.

- Focus is set to the manual mode.
- Set focus to the auto mode. (☞ pg. 41)
- The lens is dirty or covered with condensation.
- Clean the lens and check the focus again. (☞ pg. 56)

#### In the 5-second mode, recording ends before 5 seconds have elapsed.

- The 5-second mode is set to "Anim.".
- Set "5S" to "5S". (☞ pg. 33, 40)

#### Snapshot mode cannot be used.

- The wide mode (16:9 WIDE) is selected.
- Set "WIDE MODE" to "OFF". (☞ pg. 33, 35)

#### The colour of snapshot looks strange.

- The light source or the subject does not include white. Or there are various different light sources behind the subject.
- Find a white subject and compose your shot so that it also appears in the frame. (☞ pg. 25, 39)

#### The image taken using snapshot is too dark.

- Shooting was performed under backlight conditions.
- Press **BACKLIGHT**. (☞ pg. 42)

#### The image taken using snapshot is too bright.

- The subject is too bright.
- Set exposure to "-3" manually. (☞ pg. 41)

#### White balance cannot be activated.

- The sepia (SEPIA) or monotone (MONOTONE) mode is activated.
- Disengage the sepia (SEPIA) or monotone (MONOTONE) mode before setting white balance. (☞ pg. 45)

#### The black & white fader does not work.

- The sepia (SEPIA) or monotone (MONOTONE) mode is activated.
- Disengage the sepia (SEPIA) and monotone (MONOTONE). (☞ pg. 45)

#### The image looks like the shutter speed is too slow.

- When shooting in the dark, the unit becomes highly sensitive to light when "GAIN UP" is set to "AUTO".
- If you want the lighting to look more natural, set "GAIN UP" to "AGC" or "OFF". (☞ pg. 33, 34)

#### Although snapshot is attempted, flash does not take place.

- The subject is too bright with the flash set to " $f\pm 0A$ " or " $\odot f\pm 0A$ ".
- Set the flash mode to " $f\pm 0$ ". (☞ pg. 39)
- If  $f$  blinks, the flash is being charged.
- It can take up to 10 seconds to charge the flash.
- The camcorder is in the record mode.
- Set the camcorder in the record-standby mode. (☞ pg. 39)

#### Although a snapshot is taken with the flash, red-eye reduction does not take place.

- The subject does not look straight toward the flash.
- The subject does not look at the first flash, which is an important part of red-eye reduction.
- The subject should look straight toward the flash, especially the first flash. If the subject does not see the first flash, it will be difficult for red-eye reduction to take place. (☞ pg. 39)
- The camcorder is too far from the subject.
- The flash is effective for subjects at a distance of approx. 0.7 m to 2 m from the camcorder. (☞ pg. 39)

**TROUBLESHOOTING EN 53****Other problems****The POWER/CHARGE lamp on the camcorder does not light during charging.**

- Charging is difficult in places subject to extremely high/low temperatures.
- To protect the battery, it is recommended to charge it in places with a temperature of 10°C to 35°C. (☞ pg. 57)
- The battery pack is not attached firmly.
- Detach the battery pack once again and re-attach it firmly. (☞ pg. 13)

**"SET DATE/TIME!" appears.**

- The date/time is not set.
- Set the date/time. (☞ pg. 15)
- The built-in clock battery has run out and the previously set date/time has been erased.
- Consult your nearest JVC dealer for replacement.

**Files stored in the memory card cannot be deleted.**

- Files stored in the memory card are protected.
- Remove protection from the files stored in the memory card and delete them. (☞ pg. 28)

**When the image is printed from the printer, a black bar appears at the bottom of the screen.**

- This is not a malfunction.
- By recording with "DIS" activated (☞ pg. 33, 34) this can be avoided.

**When the camcorder is connected via the DV connector, the camcorder does not operate.**

- The DV cable was plugged/unplugged with power turned on.
- Turn the camcorder's power off and on again, then operate it.

**When connected to the PC with a DV cable, the image data is not transferred.**

- The VIDEO/MEMORY switch is set to "MEMORY".
- Set the VIDEO/MEMORY switch to "VIDEO".

**Images on the LCD monitor appear dark or whitish.**

- In places subject to low temperature, images become dark due to the characteristics of the LCD monitor. This is not a malfunction.
- Adjust the brightness and angle of the LCD monitor. (☞ pg. 12, 16)
- When the LCD monitor's fluorescent light reaches the end of its service life, images on the LCD monitor become dark.
- Consult your nearest JVC dealer.

**Coloured bright spots appear all over the LCD monitor.**

- The LCD monitor is made with high-precision technology. However, black spots or bright spots of light (red, green or blue) may appear constantly on the LCD monitor. These spots are not recorded on the tape. This is not due to any defect of the unit. (Effective dots: more than 99.99%)

**The cassette will not load properly.**

- The battery's charge is low.
- Install a fully charged battery. (☞ pg. 13)

**The memory card cannot be removed from the camcorder.**

- Push in the memory card a few more times. (☞ pg. 17)

**Picture does not appear on the LCD monitor.**

- The LCD monitor's brightness setting is too dark.
- Adjust the brightness of the LCD monitor. (☞ pg. 16)

**An error indication (01 – 04 or 06) appears.**

- A malfunction of some kind has occurred. In this case the camcorder's functions become unusable.
- ☞ pg. 56.

**The remote control does not work.**

- "REMOTE" is set to "OFF".
- Set "REMOTE" to "ON". (☞ pg. 33, 35)
- The remote control does not point at the remote sensor.
- Point at the remote sensor. (☞ pg. 23)
- The remote control batteries are exhausted.
- Replace the batteries with fresh ones. (☞ pg. 23)

## 54 EN TROUBLESHOOTING

### Warning Indications



Displays the battery remaining power.

#### Remaining power level

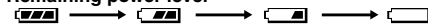

**High** **Exhausted**

As the battery power comes close to nil, the battery remaining power indicator blinks.

When the battery power is exhausted, power turns off automatically.

The battery remaining power indicator display should only be used as a guide.

When the remaining recordable time is more than 30 minutes, it is displayed in 10-minute units and when the time is less than 30 minutes, it is displayed in 5-minute units.



Appears when no tape is loaded. (☞ pg. 16)

#### CHECK TAPE'S ERASE PROTECTION TAB

Appears when the erase protection tab is set to "SAVE" while the power switch is set to "A" or "M" and the VIDEO/MEMORY switch is set to "VIDEO". (☞ pg. 14, 17)

#### USE CLEANING CASSETTE

Appears if dirt is detected on the heads during recording. Use an optional cleaning cassette. (☞ pg. 58)

#### CONDENSATION, OPERATION PAUSED PLEASE WAIT

Appears if condensation occurs. When this indication is displayed, wait more than 1 hour until condensation disappears.

#### TAPE!

Appears if a tape is not loaded when the recording start/stop button or **SNAPSHOT** button is pressed while the power switch is set to "A" or "M" and the VIDEO/MEMORY switch is set to "VIDEO".

#### TAPE END

Appears when the tape ends during recording or playback.

#### SET DATE/TIME!

- Appears when the date/time is not set. (☞ pg. 15)
- The built-in clock battery has run out and the previously set date/time has been erased. Consult your nearest JVC dealer for replacement.

#### LENS CAP

Appears for 5 seconds after power is turned on if the lens cap is attached or when it is dark.

#### A. DUB ERROR!

Appears if audio dubbing is attempted on a blank portion of a tape. (☞ pg. 50)

#### A. DUB ERROR!

<CANNOT DUB ON A LP RECORDED TAPE>  
<CANNOT DUB ON A 16BIT RECORDING>  
<CHECK TAPE'S ERASE PROTECTION TAB>

- Appears if audio dubbing is attempted on a tape recorded in the LP mode. (☞ pg. 50)
- Appears if audio dubbing is attempted on a tape recorded in 16-BIT audio. (☞ pg. 50)
- Appears if **A. DUB** (⊖) on the remote control is pressed when the erase protection tab is set to "SAVE". (☞ pg. 50)

**TROUBLESHOOTING EN 55****INSERT ERROR!**

Appears if insert editing is attempted on a blank portion of a tape. (☞ pg. 49)

**INSERT ERROR!**

<CANNOT EDIT ON A BLANK PORTION>  
<CANNOT EDIT ON A LP RECORDED TAPE>  
<CHECK TAPE'S ERASE PROTECTION TAB>

- Appears if insert editing is attempted on a blank portion of a tape.
- Appears if insert editing is attempted on a tape recorded in the LP mode. (☞ pg. 49)
- Appears if **INSERT** (⏏) on the remote control is pressed when the erase protection tab is set to "SAVE". (☞ pg. 49)

**MEMORY IS FULL**

Appears when the memory card's memory is full and shooting is not possible.

**HDV **

Appears when pictures recorded in the HDV format are detected. The pictures in the HDV format cannot be played back with this camcorder.

**?**

Appears when playing back a file that is not compatible with DCF or a file with a size that is not compatible with this camcorder.

**COPYING FAILED**

- Appears if dubbing of copyguarded signals is attempted while this camcorder is being used as a recorder.
- Appears in the following cases when dubbing from a tape to a memory card (☞ pg. 28):
  - when no memory card is loaded.
  - when the memory card's memory is full.
  - when the memory card is not formatted.
  - when a write-protected SD Memory Card is loaded. (☞ pg. 17)

**MEMORY CARD!**

Appears if there is no memory card loaded when you attempt to record on a memory card or access data on a memory card.

**PLEASE FORMAT**

Appears when there is a problem with a memory card and its memory is corrupt, or it has not been initialised. Initialise the memory card. (☞ pg. 32)

**NO IMAGES STORED**

Appears if there are no image files stored in the memory card when you attempt memory card playback.

**CARD ERROR!**

Appears when the camcorder does not recognise the loaded memory card. Remove the memory card once and insert it again. Repeat these procedures until no indication appears. If the indication still appears, the memory card is corrupted.

**CHECK CARD'S WRITE PROTECTION SWITCH**

Appears when you attempt to shoot digital still images when the write protection tab on the SD Memory Card is set to the "LOCK" position.

**56 EN****UNIT IN SAFEGUARD MODE  
REMOVE AND REATTACH BATTERY**

The error indications (01, 02 or 06) show what type of malfunction has occurred. When an error indication appears, the camcorder turns off automatically. Remove the power supply (battery, etc.) and wait a few minutes for the indication to clear. When it does, you can resume using the camcorder. If the indication remains, consult your nearest JVC dealer.

**UNIT IN SAFEGUARD MODE  
EJECT AND REINSERT TAPE**

The error indications (03 or 04) show what type of malfunction has occurred. When an error indication appears, the camcorder turns off automatically. Eject the cassette once and reinsert it, then check if the indication clears. When it does, you can resume using the camcorder. If the indication remains, consult your nearest JVC dealer.

**USER MAINTENANCE****Cleaning The Camcorder**

Before cleaning, turn off the camcorder and remove the battery pack and AC adapter.

**To clean the exterior**

Wipe gently with a soft cloth. Put the cloth in diluted mild soap and wring it well to wipe off heavy dirt. Then wipe again with a dry cloth.

**To clean the LCD monitor**

Wipe gently with a soft cloth. Be careful not to damage the monitor. Close the LCD monitor.

**To clean the lens**

Blow it with a blower brush, then wipe gently with lens cleaning paper.

**NOTES:**

- Avoid using strong cleaning agents such as benzene or alcohol.
- Cleaning should be done only after the battery pack has been removed or other power units have been disconnected.
- Mould may form if the lens is left dirty.
- When using a cleaner or chemically treated cloth refer to the cautions of each product.



**CAUTIONS EN 57****Battery Packs**

The supplied battery pack is a lithium-ion battery. Before using the supplied battery pack or an optional battery pack, be sure to read the following cautions:

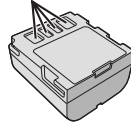
**Terminals**

- **To avoid hazards**

- ...do not burn.
- ...do not short-circuit the terminals. When transporting, make sure the provided battery cap is attached to the battery. If the battery cap is misplaced, carry the battery in a plastic bag.
- ...do not modify or disassemble.
- ...do not expose the battery to temperatures exceeding 60°C, as this may cause the battery to overheat, explode or catch fire.
- ...use only specified chargers.

- **To prevent damage and prolong service life**

- ...do not subject to unnecessary shock.
- ...charge in an environment where temperatures are within the tolerances shown in the chart below. This is a chemical reaction type battery — cooler temperatures impede chemical reaction, while warmer temperatures can prevent complete charging.
- ...store in a cool, dry place. Extended exposure to high temperatures will increase natural discharge and shorten service life.
- ...fully charge and then fully discharge the battery every 6 months when storing the battery pack over a long period time.
- ...remove from charger or powered unit when not in use, as some machines use current even when switched off.

**The Benefits of Lithium-Ion Batteries**

Lithium-ion battery packs are small but have a large power capacity. However, when one is exposed to cold temperatures (below 10°C), its usage time becomes shorter and it may cease to function. If this happens, place the battery pack in your pocket or other warm, protected place for a short time, then re-attach it to the camcorder.

**NOTES:**

- It is normal for the battery pack to be warm after charging, or after use.
- Temperature Range Specifications**
- Charging: 10°C to 35°C
  - Operation: 0°C to 40°C
  - Storage: -20°C to 50°C
- The lower the temperature, the longer recharging takes.
  - Charging times are for a fully discharged battery pack.

**Cassettes**

To properly use and store your cassettes, be sure to read the following cautions:

- **During use**

- ...make sure the cassette bears the Mini DV mark.
- ...be aware that recording onto prerecorded tapes automatically erases the previously recorded video and audio signals.
- ...make sure the cassette is positioned properly when inserting.
- ...do not load and unload the cassette repeatedly without allowing the tape to run at all. This slackens the tape and can result in damage.
- ...do not open the front tape cover. This exposes the tape to fingerprints and dust.

- **Store cassettes**

- ...away from heaters or other heat sources.
- ...out of direct sunlight.
- ...where they won't be subject to unnecessary shock or vibration.
- ...where they won't be exposed to strong magnetic fields (such as those generated by motors, transformers or magnets).
- ...vertically, in their original cases.

## 58 EN CAUTIONS

### Memory Cards

To properly use and store your memory cards, be sure to read the following cautions:

- **During use**
  - ...make sure the memory card bears the SD or MultiMediaCard mark.
  - ...make sure the memory card is positioned properly when inserting.
- **While the memory card is being accessed (during recording, playback, deletion, initialization, etc.)**
  - ...never unload the memory card and never turn off the camcorder.
- **Store memory cards**
  - ...away from heaters or other heat sources.
  - ...out of direct sunlight.
  - ...where they won't be subject to unnecessary shock or vibration.
  - ...where they won't be exposed to strong magnetic fields (such as those generated by motors, transformers or magnets).

### LCD Monitor

- **To prevent damage to the LCD monitor, DO NOT**
  - ...push it strongly or apply any shocks.
  - ...place the camcorder with the LCD monitor on the bottom.
- **To prolong service life**
  - ...avoid rubbing it with coarse cloth.
- **Be aware of the following phenomena for LCD monitor use. These are not malfunctions**
  - ...While using the camcorder, the surface around the LCD monitor and/or the back of the LCD monitor may heat up.
  - ...If you leave power on for a long time, the surface around the LCD monitor becomes hot.

### Main Unit

- **For safety, DO NOT**
  - ...open the camcorder's chassis.
  - ...disassemble or modify the unit.
  - ...short-circuit the terminals of the battery pack. Keep it away from metallic objects when not in use.
  - ...allow inflammables, water or metallic objects to enter the unit.
  - ...remove the battery pack or disconnect the power supply while the power is on.
  - ...leave the battery pack attached when the camcorder is not in use.
- **Avoid using the unit**
  - ...in places subject to excessive humidity or dust.
  - ...in places subject to soot or steam such as near a cooking stove.
  - ...in places subject to excessive shock or vibration.
  - ...near a television set.
  - ...near appliances generating strong magnetic or electric fields (speakers, broadcasting antennas, etc.).
  - ...in places subject to extremely high (over 40°C) or extremely low (under 0°C) temperatures.
- **DO NOT leave the unit**
  - ...in places of over 50°C.
  - ...in places where humidity is extremely low (below 35%) or extremely high (above 80%).
  - ...in direct sunlight.
  - ...in a closed car in summer.
  - ...near a heater.
- **To protect the unit, DO NOT**
  - ...allow it to become wet.
  - ...drop the unit or strike it against hard objects.
  - ...subject it to shock or excessive vibration during transportation.
  - ...keep the lens directed at extremely bright objects for long periods.
  - ...expose the lens to direct sunlight.
  - ...carry it by holding the LCD monitor.
  - ...swing it excessively when using the hand strap or the grip.
  - ...swing the soft camera case excessively when the camcorder is inside it.

**CAUTIONS EN 59**

- **Dirty heads can cause the following problems:**



- ... No picture during playback.
  - ... Blocks of noise appear during playback.
  - ... During recording or playback, the Head Clog Warning indicator "X" appears.
  - ... Recording cannot be performed properly.
- In such cases, use an optional cleaning cassette. Insert it and play back. If the cassette is used more than once consecutively, damage to the video heads may result. After the camcorder plays back for about 20 seconds, it stops automatically. Also refer to the cleaning cassette's instructions.
- If, after using the cleaning cassette, the problems still exist, consult your nearest JVC dealer.
- Mechanical moving parts used to move the video heads and video tape tend to become dirty and worn out over time. In order to maintain a clear picture at all times, periodic check-ups are recommended after using the unit for about 1,000 hours. For periodic check-ups please consult your nearest JVC dealer.

**How To Handle A CD-ROM**

- Take care not to soil or scratch the mirror surface (opposite to the printed surface). Do not write anything or put a sticker on either the front or back surface. If the CD-ROM gets dirty, gently wipe it with a soft cloth outward from the centre hole.
- Do not use conventional disc cleaners or cleaning spray.
- Do not bend the CD-ROM or touch its mirror surface.
- Do not store your CD-ROM in a dusty, hot or humid environment. Keep it away from direct sunlight.

**About moisture condensation**

- You have observed that pouring a cold liquid into a glass will cause drops of water to form on the glass' outer surface. This same phenomenon occurs on the head drum of a camcorder when it is moved from a cool place to a warm place, after heating a cold room, under extremely humid conditions or in a place directly subjected to the cool air from an air conditioner.
- Moisture on the head drum can cause severe damage to the video tape, and can lead to internal damage to the camcorder itself.

**Serious malfunctioning**

If malfunctioning occurs, stop using the unit immediately and consult your local JVC dealer.

The camcorder is a microcomputer-controlled device. External noise and interference (from a TV, a radio, etc.) might prevent it from functioning properly. In such cases, first disconnect its power supply unit (battery pack, AC adapter, etc.) and wait a few minutes and then re-connect it and proceed as usual from the beginning.

**60 EN SPECIFICATIONS****Camcorder****For General****Power supply**

DC 11 V (Using AC adapter)  
DC 7.2 V (Using battery pack)

**Power consumption**

Approx. 4.8 W (LCD backlight off)  
Approx. 5.8 W (LCD backlight on)  
Approx. 6.5 W (Maximum; when charging the battery pack)

**Dimensions (W x H x D)**

88 mm x 89 mm x 93 mm (with the LCD monitor closed)

**Weight**

Approx. 510 g (without battery, cassette, memory card, lens hood and lens cap)  
Approx. 590 g (incl. battery, cassette, memory card, lens hood and lens cap)

**Operating temperature**

0°C to 40°C

**Operating humidity**

35% to 80%

**Storage temperature**

-20°C to 50°C

**Pickup**

1/4.5" (1,330,000 pixels) CCD x 3 (3 CCD)

**Lens**

Video: F 1.8 to 2.4, f = 3.2 mm to 32 mm, 10:1 power zoom lens  
Still: F 1.9 to 2.4, f = 4 mm to 32 mm, 8:1 power zoom lens

**Filter diameter**

ø37 mm

**LCD monitor**

2.5" diagonally measured, LCD panel/TFT active matrix system

**Speaker**

Monaural

**Flash**

Within 2 m (recommended shooting distance)

**For Digital Video Camera****Format**

DV format (SD mode)

**Signal format**

PAL standard

**Recording/Playback format**

Video: Digital component recording  
Audio: PCM digital recording, 32 kHz 4-channel (12-BIT), 48 kHz 2-channel (16-BIT)

**Cassette**

Mini DV cassette

**Tape speed**

SP: 18.8 mm/s, LP: 12.5 mm/s

**Maximum recording time (using 80 min. cassette)**

SP: 80 min., LP: 120 min.

**For Digital Still Camera****Storage media**

SD Memory Card/MultiMediaCard

**Compression system**

JPEG (compatible)

**Image size**

5 modes (2560 x 1920 / 2048 x 1536 / 1600 x 1200 / 1280 x 960 / 640 x 480)

**Picture quality**

2 modes (FINE/STANDARD)

**For Connectors****S/AV****S-Video input:**

Y: 0.8 V to 1.2 V (p-p), 75 Ω, analogue  
C: 0.2 V to 0.4 V (p-p), 75 Ω, analogue

**S-Video output:**

Y: 1.0 V (p-p), 75 Ω, analogue  
C: 0.3 V (p-p), 75 Ω, analogue

Video input: 0.8 V to 1.2 V (p-p), 75 Ω, analogue

Video output: 1.0 V (p-p), 75 Ω, analogue

Audio input: 300 mV (rms), 50 kΩ, analogue, stereo

Audio output: 300 mV (rms), 1 kΩ, analogue, stereo

**Microphone input**

ø3.5 mm, stereo

**Headphone output**

ø3.5 mm, stereo

**DV**

Input/output: 4-pin, IEEE1394 compliant

**USB**

Mini USB-B type, USB 1.1/2.0 (Full speed)

**compliant****AC Adapter****Power requirement**

AC 110 V to 240 V~, 50 Hz/60 Hz

**Output**

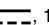
DC 11 V , 1 A

Specifications shown are for SP mode unless otherwise indicated. E & O.E. Design and specifications subject to change without notice.

**SPECIFICATIONS EN 61****Approximate Number of Storable Images**

The number increases or decreases depending on the picture quality/image size, etc.

Image Size/Picture Quality	SD Memory Card						MultiMediaCard
	32* MB	64 MB	128 MB	256 MB	512 MB	1 GB	32 MB
640 x 480/FINE	185	385	780	1555	3140	6040	195
640 x 480/STANDARD	265	550	1115	2225	4490	8635	275
1280 x 960/FINE	50	100	210	420	845	1630	50
1280 x 960/STANDARD	80	170	350	705	1425	2745	85
1600 x 1200/FINE	33	65	140	280	570	1095	35
1600 x 1200/STANDARD	50	110	225	455	920	1775	55
2048 x 1536/FINE	20	42	85	170	350	675	21
2048 x 1536/STANDARD	32	65	135	270	550	1055	34
2560 x 1920/FINE	13	27	55	110	225	435	14
2560 x 1920/STANDARD	21	42	85	175	355	685	22

\* Provided

- The following SD Memory Cards have been confirmed to work with this camcorder.

Capacity	Manufacturer
32 MB, 64 MB, 128 MB, 256 MB, 512 MB, 1 GB	Panasonic, TOSHIBA, SanDisk, pqi

REFERENCES

## 62 EN *TERMS*

<b>A</b>		<b>I</b>	
AC Adapter .....	14	Image Size .....	37
Animation .....	35	Initialising a Memory Card .....	32
Audio Dubbing .....	50	Insert Editing .....	49
<b>B</b>		Interval Shooting .....	26
Backlight Compensation .....	42	Iris Lock .....	42
Battery Pack .....	13, 14, 57	<b>L</b>	
Beep .....	35	LCD Monitor .....	12
Blank Search .....	21	Loading a Cassette .....	16
Bracket Shooting .....	25	Loading a Memory Card .....	17
<b>C</b>		<b>M</b>	
Changing the Menu Settings .....	33 – 38	Manual Focus .....	41
Charging the Battery Pack .....	13	Memory Card .....	17, 58
Connection to a Personal Computer .....	48	<b>N</b>	
Connections to a TV or VCR .....	22	Night-Scope .....	40
Continuous Shooting .....	25, 39	<b>P</b>	
<b>D</b>		Picture Quality .....	36
Data Battery .....	14	Playback Special Effects .....	24
Date/Time Settings .....	15	Power-Linked Operation .....	15
Deleting Files .....	29	Program AE .....	44
Demonstration Mode .....	36	Protecting Files .....	28
Digital Image Stabiliser (DIS) .....	34	<b>Q</b>	
Direct Printing .....	31	Quick Review .....	20
DPOF Setting .....	30, 31	<b>R</b>	
Dubbing .....	28, 46, 47	Recording Capacity	
<b>E</b>		Memory Card .....	61
Exposure Control .....	41	Tape .....	18
<b>F</b>		Recording Media Selection	
Flash .....	39	(REC SELECT) .....	37
<b>H</b>		Remote Control .....	23
Histogram .....	27	Resetting the File Name .....	28



**S**

Self-Timer ..... 40  
 Slow-Motion Playback ..... 24  
 Snapshot Mode ..... 34  
 Sound Mode ..... 34, 37  
 Speaker Volume ..... 20  
 Special Effects ..... 45  
 Specifications ..... 60  
 Spot Exposure Control ..... 42

**T**

Tape Speed (REC MODE) ..... 34, 38  
 Telephoto Setting (TELE MACRO) ..... 35  
 Time Code ..... 19, 36  
 Tripod Mounting ..... 16  
 Troubleshooting ..... 51

**W**

Warning Indications ..... 54  
 White Balance ..... 43  
 Wide Mode ..... 35  
 Wipe or Fader Effects ..... 44

**Z**

Zooming ..... 19, 24, 34

5-Second Recording ..... 35, 40

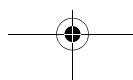
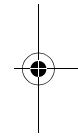
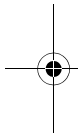

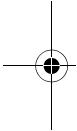
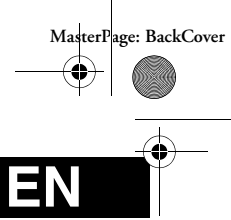
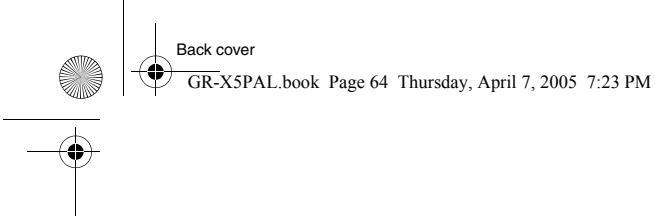

**JVC**

