

**"Cordless" Mickey Mouse Talking
Animated 900MHz Telephone
Instruction Manual**



DM-405-001

IMPORTANT SAFETY INSTRUCTIONS

BEFORE USING YOUR TELEPHONE EQUIPMENT, BASIC SAFETY PRECAUTIONS SHOULD ALWAYS BE FOLLOWED TO REDUCE THE RISK OF FIRE, ELECTRIC SHOCK AND INJURY TO PERSONS, INCLUDING THE FOLLOWING:

1. Read and understand all instructions.
2. Follow all warnings and instructions marked on the product.
3. Unplug this product from the wall telephone jack and power outlet before cleaning.
Do not use liquid CLEANERS OR AEROSOL CLEANERS. Use damp cloth for cleaning.
4. Do not use this product near water; for example, near a bathtub, wash bowl, kitchen sink, laundry tub, swimming pool, or in a wet basement.
5. Do not place this product on an unstable cart, stand or table. The product may fall, causing serious damage to the product.
6. This product should never be placed near or over a radiator or heat register. This product should not be placed in a built-in installation unless proper ventilation is provided.
7. This product should be operated only from the type of power source indicated on the marking label. If you are not sure of the type of power supply to your home, consult your dealer or local power company.
8. Do not allow anything to rest on the power cord. Do not locate this product where the cord will be damaged by persons walking on it.
9. Do not overload wall outlets or extension cords, as this can result in fire or electric shock.
10. Never push objects of any kind into this product through cabinet slots, as they may touch dangerous voltage points or short out parts. This could result in fire or electric shock. Never spill liquid of any kind on this product.
11. To reduce the risk of electric shock, do not disassemble this product. Instead, some repair work is required, take the unit to a qualified technician. Opening or removing covers may expose you to dangerous voltages or other risks.
Incorrect reassembly can cause electric shock when the appliance is subsequently used.
12. unplug this product from the wall outlet and refer servicing to qualified service personnel under the following condition:
 - a. When the power supply cord or plug is damaged or frayed.
 - b. If liquid has been spilled into the product.
 - c. If the product has been exposed to rain or water.
 - d. If the product does not operate normally and proper operating instructions have been followed, adjust only those controls that are covered by the operating instructions. Improper adjustment of other controls may result in damage and will often require extensive work by a qualified technician to restore the product to normal operation.
 - e. If the product has been dropped or cabinet has been damaged.

- f. If the product exhibits a distinct change in performance.
- 13. Avoid using telephone (other than a cordless type) during an electrical storm.
There may be a remote risk of electrical shock from lightning.
- 14. Do not use the telephone to report a gas leak in the vicinity of the leak.

SAVE THESE INSTRUCTIONS

SAFETY INSTRUCTIONS FOR BATTERIES

CAUTION: To reduce the risk of fire or personal injury, read and follow these instructions:

1. Use only the battery pack bundled in package box of your cordless telephone.
2. Do not dispose of the battery(ies) in a fire, as it may explode. Check with local codes for possible special disposal instructions.
3. Do not open or mutilate the battery(ies). Released electrolyte is corrosive and may cause damage to the eyes and skin. It may be toxic if swallowed.
4. Exercise care in handling batteries in order not to short the battery(ies) with conducting materials such as rings, bracelets and keys. The battery or conductive material may overheat and cause burns.
5. Charge the battery (ies) provided with or identified for use with this product only in accordance with the instructions and limitations specified in this manual.

FCC WANTS YOU TO KNOW

This equipment complies with part 68 of the FCC rules. On the bottom of the base of this equipment is a label that contains, among other information, the FCC Registration Number, Ringer Equivalence Number (REN) and the Universal Service Order Code (USOC), which is RJ-11C, for this equipment. You must, upon request, provide this information to your telephone company. The REN is useful to determine the quantity of you may connect to your telephone line and still have all of those devices ring when our telephone number is called. In most, but not all areas, the sum of the REN'S of all devices connected to one line should not exceed five (5.0). To be certain of the number of devices you may connect to your line, as determined by the REN, you should contact your local telephone company to determine the maximum REN or your calling area.

If your telephone equipment causes harm to telephone network, the telephone company may discontinue your service temporarily. If possible, they will notify you in advance. But if advance notice isn't practical, you will be notified as soon as possible. You will be informed of your right to file a complaint with FCC.

Your telephone company may make changes in its facilities, equipment, operations, or procedures that could affect the proper functioning of your equipment. If they do, you will be notified in advance to give you an opportunity to maintain uninterrupted telephone service. If you experience trouble with this telephone equipment, disconnect from the network until the problem has been corrected or until you are sure

that the equipment is not malfunctioning.

This equipment may not be used on coin service provided by the telephone company.

Connection to party lines is subject to state tariffs.

This equipment is hearing aid compatible.

WARNING: Changes or modifications to this unit not expressly approved by the party responsible for compliance could void the user's authority to operate the equipment.

NOTE: this equipment has been tested and found to comply with the limits for a Class B digital device, pursuant to Part 15 of the FCC Rules. These limits are designed to provide reasonable protection against harmful interference in a residential installation. Some cordless telephones operate at frequencies that may cause interference to nearby TV's and VCR's. To minimize or prevent such interference, the base of the cordless telephone should not be placed near or on top of a TV or VCR. If interference is experienced, moving the cordless telephone farther away from the TV or VCR will often reduce or eliminate the interference. However, there is no guarantee that interference will not occur in a particular installation. If this equipment does cause harmful interference to radio or television reception, which can be determined by turning the equipment off and on, the user is encouraged to try to correct the interference by one or more of the following measures:

Relocate the base station.

Increase the separation between the equipment and receiver.

Connect the equipment into an outlet on a circuit different from that to which the receiver is connected.

Consult the dealer or an experienced radio TV technician for help.

INTRODUCTION

Congratulations on your purchase of Disney's MICKEY MOUSE cordless telephone. This quality product is a 900MHz cordless telephone which is a replica of MICKEY MOUSE. Please read this operation manual before using your new telephone and keep it on hand for future reference.

FEATURES

- Choice of a conventional ringer/animation/off
- "Battery low" indicator
- Cordless handset
- ~~40~~-Channel auto/manual scan
- Mute function
- Digital security codes
- Page function (handset locator)
- Auto release tel-line while out of range for 10 seconds
- Memory storage
- Speed dial
- Up to 5 hours talk time

- Tone/pulse switch able
- Battery standby up to 3 days
- Hearing aid compatible
- Last number redial
- FCC approved
- ETL approved

INSTALLATION INSTRUCTIONS

I. Base unit instruction:

- 1.1 Choose an area near an electrical outlet and a telephone jack. Your MICKEY MOUSE cordless telephone uses a standard modular jack RJ11C. Adapters which permit your MICKEY MOUSE telephone to be used with the old 4-prong jacks are available from most telephone accessory stores. If your home has neither a modular jack nor 4-prong wall socket, you may ask your telephone company to install a modular jack type USOC: RJ11C. The telephone company will make a one time charge for this installation.
- 1.2 The telephone line cord has a snap-in plug at each end. To connect your telephone, insert one end of the line cord into the jack at the rear of the base unit. Plug the other end into a wall jack. Make sure the plugs snap securely into place. See Figure 1.
- 1.3 Plug the DC connector into the DC jack at the rear of the base unit and plug the AC power adapter into an electrical outlet. See Figure 1. The "CHARGE" LED will light up to indicate.
CAUTION: Use only the AC adapter provided with your MICKEY MOUSE telephone. This is a Class 2 AC adapter, specifically designed for use with this telephone.
NOTE: Connect the power to the base unit BEFORE placing the handset in the cradle.
- 1.4 There are two types of telephone systems in use. The most common is called TONE dialing. The other is called PULSE or ROTARY dialing. Contact your telephone company to find out which system is used in your area. Your MICKEY MOUSE telephone will operate in either system. Simply set TONE/PULSE MODE switch on base unit (see Figure 1) to "TONE" for tone dialing or "PULSE" for pulse dialing.
- 1.5 OFF/ANIMATION/RINGER switch setup (see Figure 1)
 - a. Set the switch to "OFF": the ringer on base unit will not be activated while an incoming call is coming.
 - b. Set the switch to "ANIMATION": Mickey actuator will be activated and the melody will give off when incoming call is coming.
 - c. Push the switch to "RINGER": A conventional telephone ring will sound from the base unit when incoming call is coming.

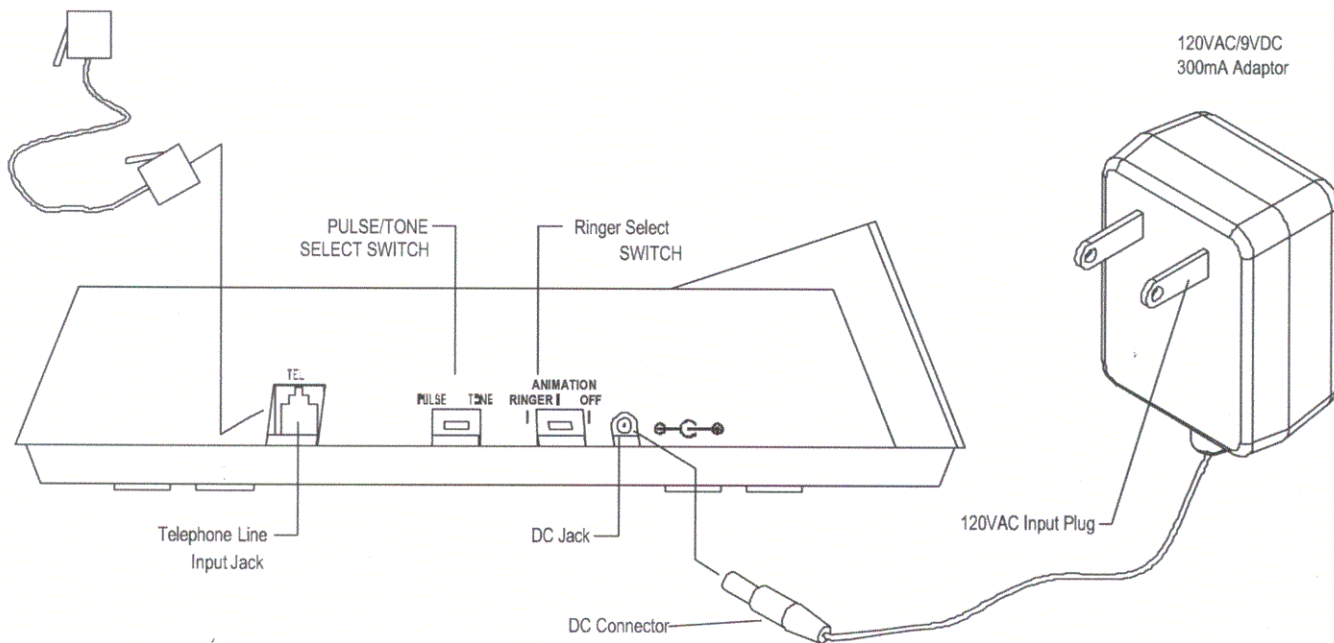

Figure 1 : Back View of Base Unit

II. Remote unit installation: See Figure 2.

- 2.1 Remove the battery case by pressing on the ridged line and sliding downward.
- 2.2 Place the battery pack in the battery compartment, put battery plug into socket located at the left top of the battery compartment.
- 2.3 Replace the battery cover by sliding it into place.

TROUBLESHOOTING

If you experience difficulty operating your cordless phone, try the suggestions below.

The unit will not operate/no dial tone:

Make sure "IN USE" LED is lit.

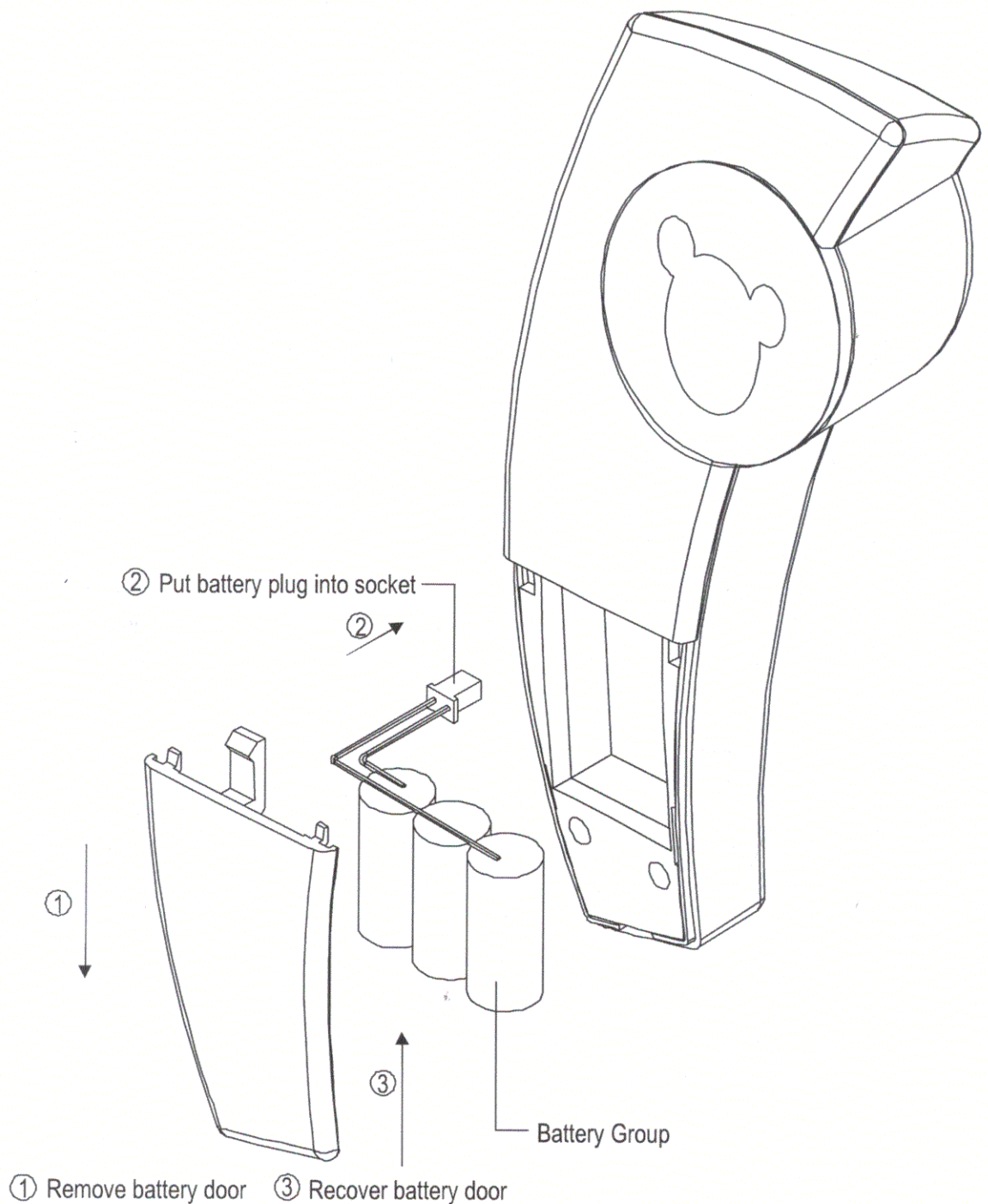

Figure 2 : Install Battery Group

CAUTION:

1. Never install telephone wiring during a lightning storm.
2. Never install telephone jacks in wet locations unless the jack is specifically designed for wet locations.

3. Never touch un-insulated telephone wires or terminal unless the telephone line has been disconnected at the network interface.
4. Use caution when installing or modifying telephone lines.

III. Preparation of some items before use

3.1 Charge the Remote unit batteries before use. The battery of your telephone must be charged for 24 hours before using your phone for the first time. Once you begin using it, the batteries will charge automatically whenever the Remote unit is in the base unit cradle.

IMPORTANT: Whenever the Remote unit battery is removed, the Remote unit must be reinitialized on the base unit after the battery is replaced.

3.2 ID (identification) code setup

Pickup remote unit and put it into the cradle. The “CHARGE” LED on Base unit will flash, ID code setup between the remote unit and the base unit is completed after 5 seconds.

CAUTION:

You should go to setup ID Code between Base unit and Remote unit again, if below cases have happened:

1. The cordless phone is used for the first time.
 2. Base unit 9V/300mA DC supply is disconnected or more for 10 minutes.
 3. Rechargeable battery has been removed from the remote unit, and then is connected again.
- 3.3 Check for a dial tone. After the batteries are charged, pick up the Remote unit and press the TALK key. The IN USE indicator should light up, and you should hear a dial tone.

IV Demo feature

Press the DEMO key (see figure 3) at anytime to see MICKEY MOUSE move and talk.

4.2 Page function

A “Beep Beep” sound will heard from the remote unit when the “PAGE” key (see figure 3) is pressed down on the base unit. This will help to locate the remote unit easily.

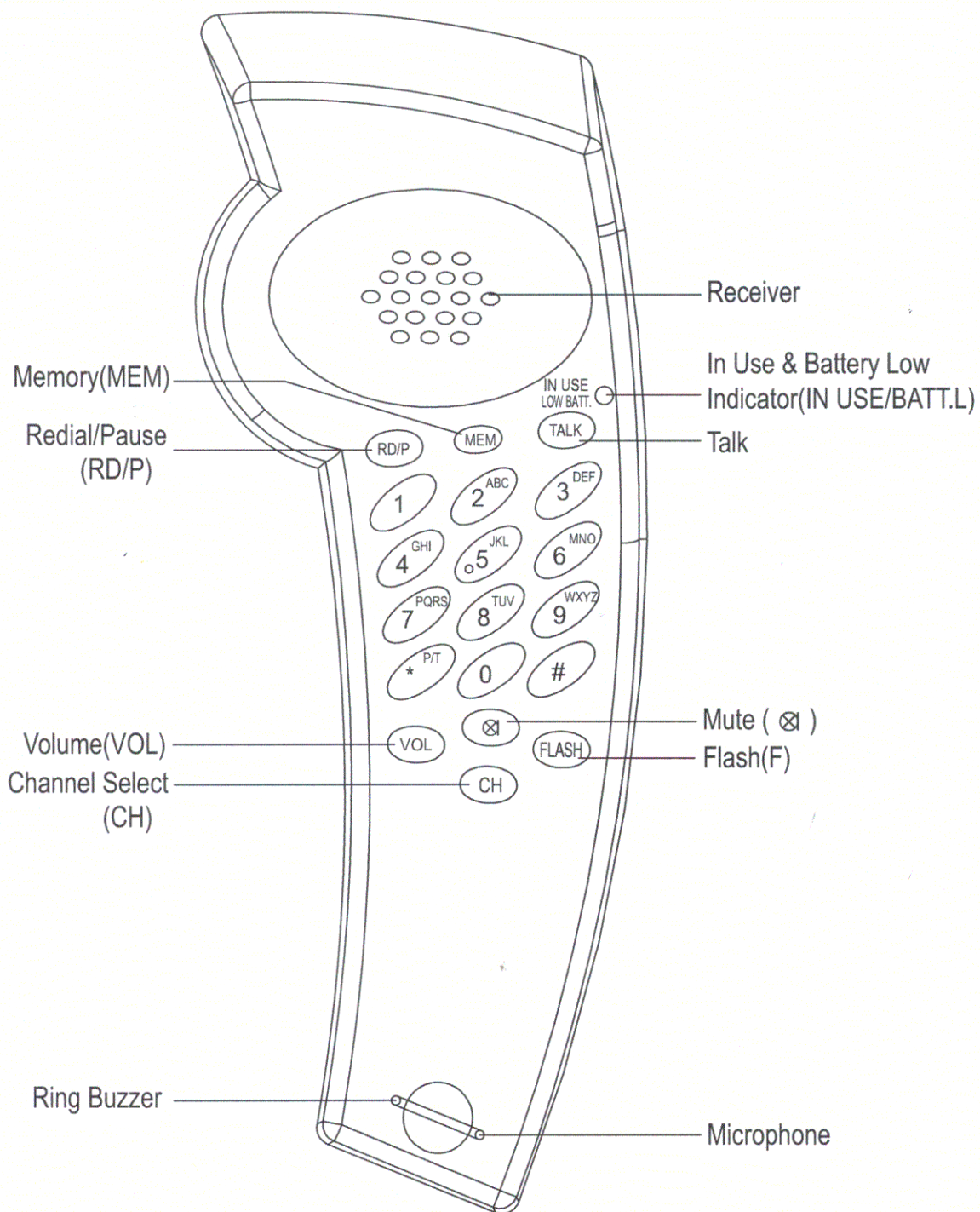

Figure 3: Remote Unit

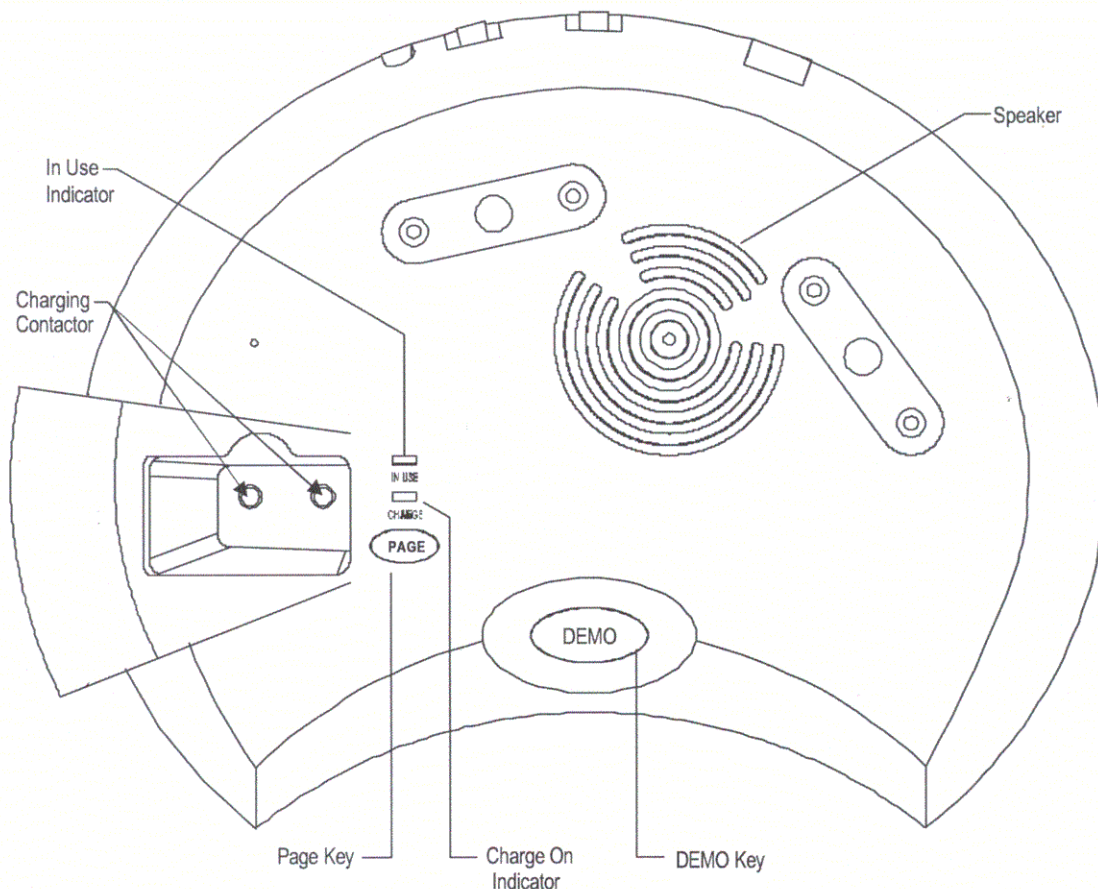

Figure 4 : Top View of Base Unit

V. Operating the telephone

Before operating the telephone, make certain the Remote unit has been properly charged. If the Remote unit is away from the base unit for a long time, the “IN USE/LOW BATT” LED (see figure 3) on the Remote unit will flash. This means the battery needs to be charged. Put the Remote unit back onto base unit. The “CHARGE” LED (see figure 4) will flash to indicate that the battery is recharging. A total charge takes approximately 12 hours.

IMPORTANT: Whenever the Remote unit battery is removed, the Remote unit must be reinitialized on the base unit after the battery is replaced.

5.1 Answer incoming call

When incoming call is coming (if the remote unit is not set on base cradle, the buzzer on the Remote unit will sound). Press “TALK” key. Both “IN USE” LED on the Remote unit (see figure 3) and the base unit (see figure 4) will light up, indicating that telephone line has been connected.

You can press the “VOL” key (see figure 3) to select the appropriate received sound level (high-medium-low) during conversation.

You can press the “CH” key one time (see figure 3) to change the channel if you feel the channel is noisy “ CHARGE” LED will turn off while channel is scanning.

5.2 Outgoing call



Press “TALK” key (see figure 3), “IN-USE” LED on the Remote unit will light up. After you receive the dial tone, you can dial the phone number you want to call.

5.3 Redial and Pause

Press “TALK” key. “IN-USE” LED turns on. After you receive the dial tone, press “RD/P” key (see figure 3). The last number will redial out.

Enter pause by pressing “RD/P” key during dialing if required.

5.4 Mute function

During Talk on mode pressing “” key (see Figure 3) will mute microphone. Pressing “” or other number key again will release muting.

5.5 Memory storing

The Mickey Cordless telephone can store ten 16 digit telephone numbers. Press “MEM” key (see figure 3), then press the telephone number you want to store. After this, press the location (0~9) you want to store the telephone number in.

5.6 Memory dialing

Press the “TALK” key. After you receive the dial tone, press the “MEM” key, then press the location number (0~9), the telephone number in that location will dial out.

5.7 Power down detection and memory retaining

For 10 minutes while 120VAC supply power is disconnected, the base unit can keep memory information with no loss.

5.8 Soft Key P/T

At pulse dialing mode. Press P/T key (see figure 3). All following number you want to call will dial out with DTMF formation.

5.9 Automatic release to telephone line.

When the radio link between Remote unit and Base unit is disconnected incidentally (not by TALK OFF operation), Base unit will release the telephone line after 10 second automatically.

TROUBLE SHOOTING

If you experience difficulty operating your cordless phone, try the suggestions below.

The unit will not operate/no dial tone:

- Make sure in use LED is lit.
- Make sure AC adapter is plugged into base unit and wall outlet.
- Make sure telephone line cord is plugged into wall jack.
- Make sure handset battery is fully charged.
- Make sure you have selected correct dialing mode, tone (touch) or pulse (rotary).
- Make sure you are within usable range of the base station.
- Reset security code by placing handset in base for 5-10 seconds.

The phone does not ring when you receive a call:

- Make sure the “RINGER” select switch on base is not in “OFF”
- Make sure AC adapter is plugged into base unit and wall outlet.
- Make sure telephone line cord is plugged into wall jack.
- Make sure you are within usable range of the base station.
- You might have too many extension phones on your line. Try unplugging a few.

Noise, static, interference or other calls heard while using handset:

Try changing channels.

- Make sure you are within usable range of the base station.
- Make sure AC adapter is not plugged into wall outlet with other appliances.
- Try relocating base unit to another location.
- Make sure handset battery is fully charged.

Phone will not hold charge:

- Make sure charging contacts on the handset and base are free of dust and dirt. Clean contacts with a soft cloth.
- Make sure CHARGE LED on base is lit when handset is in cradle.
- If necessary, replace handset battery. (See Handset Battery Charging)

Difficulty in placing or receiving calls:

- Move closer to base and try again.
- If moving closer doesn't work, you may have lost security code. Reset code by placing handset back on base for 5-10 seconds. (See 3.2 ID Code Setup)
- Make sure you have selected correct dialing mode, tone or pulse.
- Make sure AC adapter is not plugged into wall outlet with other appliances. Disconnect for 5-10 seconds then reconnect. Place handset back on base and then re-plug AC adapter.
- Make sure handset battery is fully charged.