

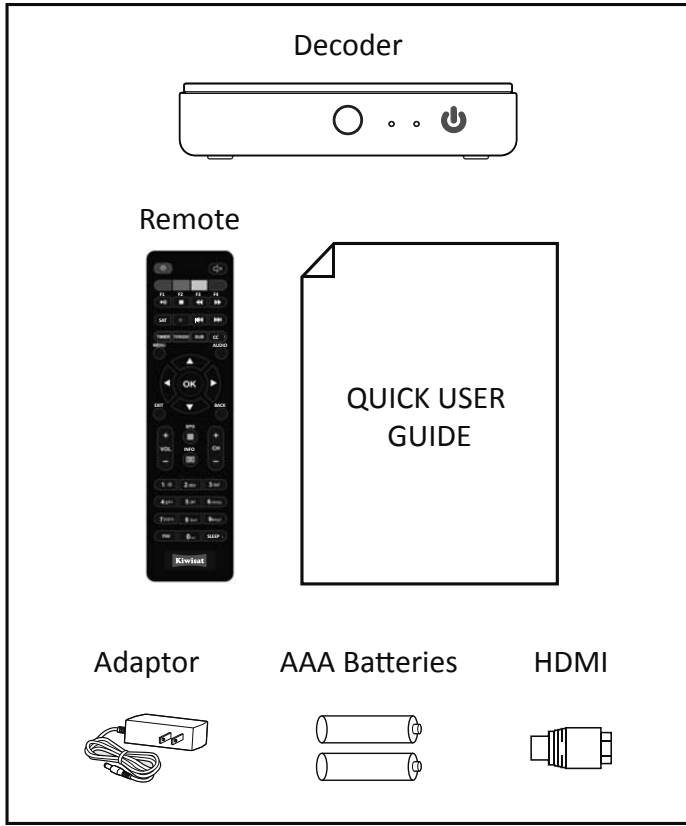

Quick User Guide TELE-P6

WiFi Before using this product please read this guide carefully.

Items in the Box :



Select the source of the signal on the TV



If you connect **HDMI™** select HDMI from Menu

Appearance and Connection of Cables:

Decoder Back

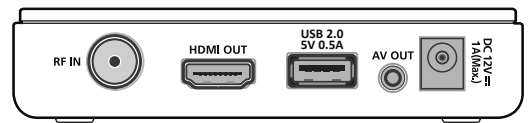

Port	Description
RF IN	Satellite Signal Input
HDMI	HDMI Cable Output
USB	USB 2.0 Port
AV OUT	Connect CVBS / A-L / A-R Output
DC12V	Power Regulator Connector

Decoder Remote Controller:

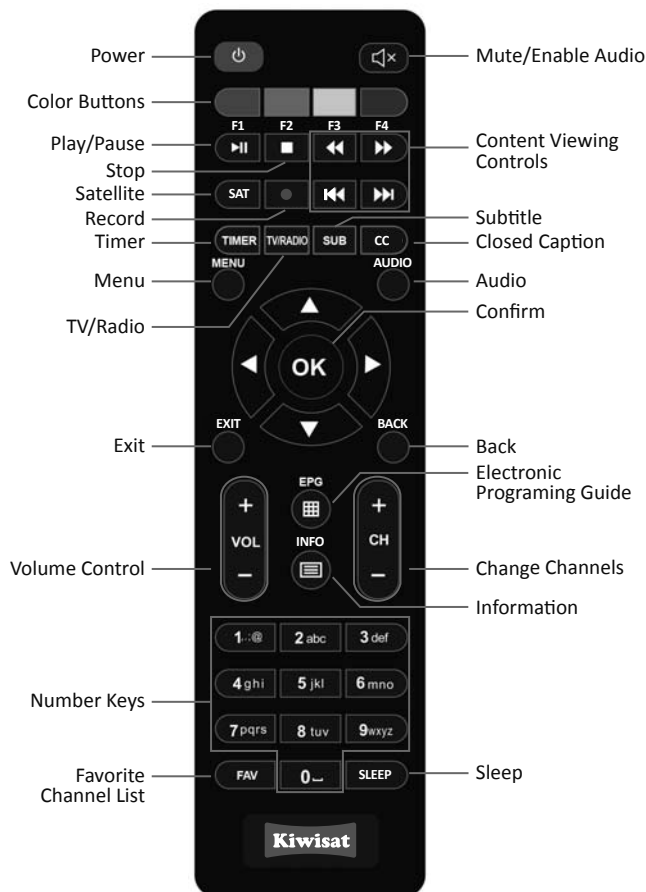

Decoder Front

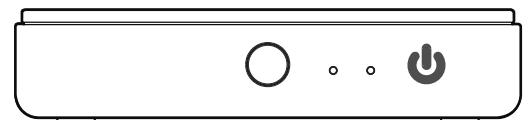



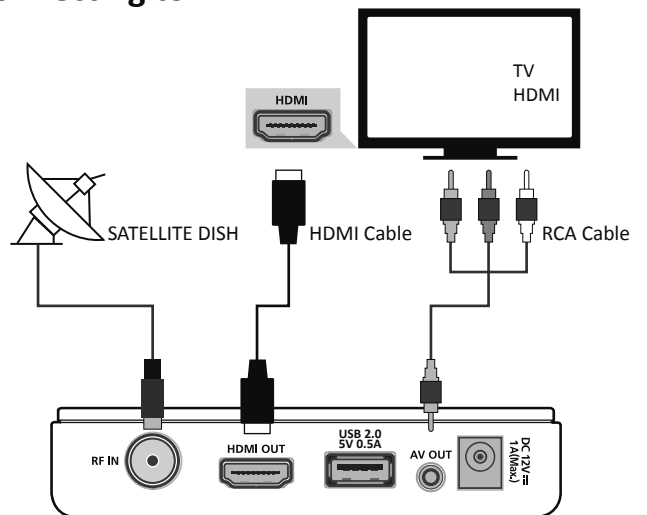

Key	Description
STANDBY	Switch the Decoder ON/Standby
IR	IR Receiver of Decoder Operation
LEDs	indication of Operation Status

Connecting to TV



WARNING

This Set-Top Box (STB) has been manufactured to satisfy international safety standards. Please read the following recommended safety precautions carefully before installing and using the STB

	CAUTION RISK OF ELECTRIC SHOCK DO NOT OPEN	
Presence of un-insulated 'dangerous voltage' within the product's enclosure that may be of sufficient magnitude to constitute a risk of electric shock to persons	To reduce the risk of Electric shock, do not remove cover. No user-serviceable parts inside. Refer servicing to qualified service personnel.	Presence of important operating and maintenance (servicing) instructions in the literature accompanying the product.
 This product should not be disposed with other household wastes. To prevent possible harm to the environment or human health from uncontrolled waste disposal, recycle it responsibly to promote sustainable reuse of material resources. To return your used device, please use the return and collection system or contact the retailer where the product was purchased. They can take this product for environmental safe recycling.	 This Symbol indicates that this product incorporates double insulation between hazardous mains voltage and user accessible parts.	

SAFETY INSTRUCTIONS

- This product is to be used with mains supply of AC 110-240V ~ 50/60Hz only. Operate your product only from the type of power source indicated on the marking label. If you are not sure of the type of power supplied to your home, consult your appliance dealer or local power company.
- To reduce the risk of fire or electric shock, do not expose this unit to rain or moisture.
- Protect the power cord. Power supply cords should be routed so that they won't be walked, on or pinched by objects placed on or against them. Pay particular attention to cords at plugs, convenience receptacles, and the point where they exit from the unit.
- Do not overload wall outlets, extension cords or adapters as this can result in fire or electrical shock.
- Do not block the STB ventilation holes. Ensure that free airflow is maintained around the STB.
- Never store the STB where it is exposed to direct sunlight or near heating equipment e.g. radiator.
- Never stack other electronic equipment on top of the STB. Place the STB at least 30mm from the wall.
- Do not place the product on an unstable cart, stand, tripod, bracket, or table where it can fall.
- Do not use any attachment or accessory that is not recommended by the manufacturer; it may cause a hazard or damage the equipment.
- Unplug the product from the wall outlet and disconnect the antenna or cable system during a lightning storm or when left unattended and unused for long periods of time. This will prevent damage to the unit due to lightning and power-line surges.
- If the STB is installed in an area subject to lightning, protection devices for the STB mains connector is essential. The manufacturer's instruction for safeguarding other equipment, such as TV set, Hi-Fi, etc., connected to the STB must also be followed during lightning or storms.
- RF IN cable carries current to the LNB mounted on the dish antenna. It is therefore recommended that the STB be disconnected from the mains power before connecting or disconnecting this cable. Failure to do so may also damage LNB.
- Avoid overhead power lines above dish antenna as it can fall into such power lines or circuits. When installing an outside antenna system, be extremely careful to keep from touching the power lines or circuits. Contact with such lines can be fatal.
- Keep the small accessories in a location out of reach of children.
- Avoid exposing your device and batteries to very cold or very hot temperatures. Extreme temperatures can cause the deformation of the device and reduce the charging capacity and life of your device and batteries.
- This equipment limits are designed to provide reasonable protection against harmful interference in a residential installation. This equipment generates uses and can radiate radio frequency energy and, if not installed and used in accordance with the instructions, may cause harmful interference to radio communications.
- However, there is no guarantee that interference will not occur in a particular installation. If this equipment does cause harmful interference to radio or television reception, which can be determined by turning the equipment off and on, the user is encouraged to try to correct the interference by one or more of the following measures:
 - re-orient or relocate the receiving antenna.
 - increase the separation between the equipment and receiver.
 - connect the equipment into an outlet on a circuit different from that to which the receiver is connected.
 - consult the dealer or an experienced radio/TV technician for help.
- Battery should not be exposed to direct sunlight.
- Dispose the used batteries at designated place for environment protection.
- Battery should be used only in the orientation that is described in the manual or on the battery slot inside the remote control unit.
- Place the battery in a location that children or infants cannot reach.
- Use only specified standard batteries. Do not use new and used batteries together. This may cause a battery to break or leak and may cause fire injury or contamination (damage).
- When replacing the batteries, insert them with right polarity (+,-).Otherwise, the battery may become damaged or it may cause fire, personal injury or damage due to leakage of the internal liquid.
- Do not attempt to service the product yourself. Refer all servicing to qualified service personnel. Unplug the unit from the wall outlet and refer servicing to qualified service personnel under the following conditions:
 - when the power-supply cord or plug is damaged.
 - if liquid has been spilled on the unit or if objects have fallen into the unit.
 - if the product has been exposed to rain or water.
 - if the product does not operate normally by following the operating instructions.
 - if the product has been dropped or the cabinet has been damaged.
 - when the product exhibits a distinct change in performance.
- Unplug the product from the wall outlet before cleaning. Use a cloth lightly dampened with water (no solvents) to clean the exterior. Use a damp cloth; do not use liquid or aerosol cleaners.
- Keep liquids away from the STB.
- Before cleaning, disconnect the STB from the wall socket.
- Do not insert anything through the openings in the unit, where they can touch dangerous voltage points or damage parts. Never spill liquid of any kind on the product.
- When replacement parts are required, be sure the service technician uses replacement parts specified by the manufacturer or those that have the same characteristics as the original part. Unauthorized substitutions may result in additional damage to the unit.
- Upon completion of any service or repairs to this product, ask the service technician to perform safety checks to determine that the product is in a safe operating condition.

FCC STATEMENT

- This device complies with Part 15 of the FCC Rules. Operation is subject to the following two conditions:
 - (1) This device may not cause harmful interference.
 - (2) This device must accept any interference received, including interference that may cause undesired operation.
 - Changes or modifications not expressly approved by the responsible for compliance could void the user's authority to operate the equipment.
- NOTE: This equipment has been tested and found comply with the limits for a Class B digital, pursuant to Part 15 of the FCC Rules. These limits are designed to provide reasonable protection against harmful interference in a residential installation.

This equipment generates uses and can radiate radio frequency energy and, if not installed and used in accordance with the instructions, may cause harmful interference to radio communications. However, there is not guarantee that interference will not occur in a particular installation. If this equipment does cause harmful interference to radio or television reception, which can be determined by turning the equipment off and on, the user is encouraged to try to correct the interference by one or more of the following measures:

- Reorient or relocate the receiving antenna.
- Increase the separation between the equipment and receiver.
- Connect the equipment into an outlet on a circuit different from that to which the receiver is connected.
- Consult the dealer or an experienced radio/TV technician for help.

FCC Radiation Exposure Statement:

This equipment complies with FCC radiation exposure limits set forth for an uncontrolled environment. In order to avoid the possibility of exceeding the FCC radio frequency exposure limits, Human proximity to the antenna shall not be less than 20cm(8 inches) during normal operation.

Troubleshooting

Symptom	Solution
No display on front panel of STB	Check the main Power is plugged into a suitable power outlet. Ensure power is switched ON on STB if switch is available.
No video and no audio. Blue screen on TV. no signal on TV	Check HDMI or AV cable connected to TV properly. Check if TV source is selected correct. If STB is connected to HDMI port 1, choose HDMI 1 on TV source/input.
No video or audio. black screen on TV	Check if STB is in standby. Power ON using remote control.
No signal on STB	Check if Cable for LNB & receiver is connected correctly. Based on signal Level indicator in Channel Search Menu, adjust antenna position.
Poor picture quality & Picture blocks are displayed	Dish will require re-alignment. If cable length is more or LNB output is weak, connect to signal amplifier. Ask for technician's help.
Remote control unit does not work	Check batteries. Position remote control straight to STB. Replace the Remote.

Technical Specifications

Item	Description
Input frequency	950MHz ~ 2150MHz
Input level	-25dBm ~ -75dBm
LNB power supply	13V / 18VDC / 150mA
DC power input	12V / 1.0A
Operation temperature	0~40°C
Manufacturer	Regent Electron (Dongguan) CO.LTD.
Manufacturer address	400 Quantang Section, Shida Road Quantang Area, Liaobu Town, Dongguan City, Guangdong, P.R.C.
Country of original	Made in China