



## 2 WAY RADIO UP TO 5MILES RANGE Manual

PLEASE READ THIS OWNER'S MANUAL CAREFULLY  
BEFORE USE. KEEP FOR YOUR REFERENCE.



### Function description

1. Batteries: Use 3 "AA" size batteries.
2. Belt clip: The belt clip is attached for easy use.
3. LCD display: Displays current channel selection and other radio status symbols.
4. **Power/Scan** button:  
Press and hold the button to turn your unit on/off.  
Press the button to search for channels.
5. **MENU/LOCK** button:  
Press the button to Channel and function selector.  
Press and hold the button to Lock/unlock the channel.
6. **UP** **DOWN** button:  
Press the button to adjust the volume level and to change channels.
7. **CALL/MON** button:  
Press the button to CALL  
Press and hold the button to Monitor.
8. **LAMP** button:  
Press and hold LAMP button to until sending light.  
Press and hold LAMP button to until off light.
9. **PTT** button: Press PTT button to transmit.
10. **SPK/MIC Socket**: It is compatible with 2.5MM external earphone/microphone. It is excluded in package. It need to purchase separately.
11. **Charge Jack**: The device can support the Micro USB charging (5V, 1A). It is compatible with most of 5V smartphone charger on the market.

	- Transmitting icon, displayed when transmitting a signal.
	- Display of current volume.
	- Displayed during the Channel Scan mode.
	- Keyboard is locked.

1

2

## Getting started

	- Display of the current battery level.
	- Channel number.
	- subchannel (1-121)
	- vox function activated (sound sensor)

### BATTERY INSTALLATION:

- Remove the belt clip by pulling the tab and sliding it up.
- Pull the battery door lock tab down to release the battery cover. Insert 3 "AA" batteries.
- Replace battery cover. Snap the lock tab and belt clip back into place.
- To use the radio, you must install 3 "AA" size batteries.

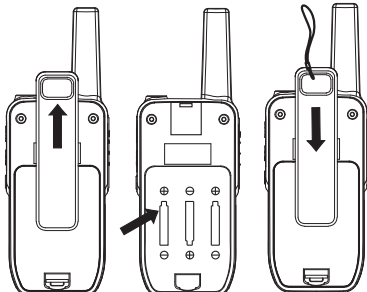

Figure 1

Figure 2

Figure 3

3

## Operation

### Turning the unit ON

Press and hold the button. The unit will beep and the LCD display will display the current channel.

### Turning the unit OFF

Press and hold the button. The unit will beep and the LCD display will turn blank.

### Adjusting the speaker volume

- Press the button to increase the speaker volume.
- Press the button to decrease the speaker volume.
- The speaker volume level is indicated by the number.

### Receiving Communications

- When the walkie-talkie is switched on and not being used for speech or paging, it is always in the receiving mode.
- Pressing the PTT buttons automatically overrides and turns off the receiving mod

### Calling another radio

- Turn the volume up to an audible level.
- Set both units to the same channel.
- Press the button to CALL
- The other unit will make a 2 second call tone. They can then respond to your call by either:
- pressing the PTT button and speaking into the radio, or
- Press the button double times to CALL, which activates a 2 second call tone on your radio.

### Momentary monitor:

- This feature turns off the automatic squelch feature, either momentarily or continuously. It helps in receiving signals to its maximum range, but may pick up static signals, too.
- Press and hold the button until a beep sound is heard
- Release the button to restore the automatic squelch.

### CHANNEL LOCK:

- This feature locks the channel so that the channel cannot be changed accidentally.
- To lock the channel, press and hold the buttons until a beep sound is heard. The lock symbol will appear on the display.

4

## Operation

- To unlock the channel, press and hold the buttons until a beep sound is heard. The lock symbol will disappear.

### Setting the Channels

The walkie-talkies has multi-channels. To change channels:

- Press the button until the current channel Number flash on the LCD display.
- Press the button to move to a higher channel.
- Press the button to move to a lower channel.
- Press the PTT button to choose the desired Channel and return to normal mode, or press the button to next menu.

### Setting the Subchannels

- To avoid disturbing signals nearby, the walkie-talkie has 121 subchannels
- Press the button until the channel number flash on the display
- press the button until the subchannels in the upper right corner of the display begins to flash
- press the or buttons to switch between the 121 subchannel.
- Press and PTT button to confirm the subchannel.
- To deactivate a subchannel, press the Menu button and press the or buttons until "of" is shown in the display.
- Press the PTT button to confirm, or press the button to next menu.

### Setting The VOX function

The vox function reacts to voice and sound

Do not use the function if you are in surroundings with strong winds or a lot of noise.

- Press the button until the channel number flash on the display
- Press the button two times. The VOX function will be shown in the display
- Press the or button to adjust sensitivity to sound (3=most sensitive to sound).
- To deactivate the VOX function, Press the or button, until "of" is shown in the display
- Press the PTT button to confirm, The walkie talkie now returns to normal function, or press the button to next menu.

5

## Operation

### Setting the call ring melody

The walkie talkie has 10 different ring tones

- Press the button until the channel number flash on the display
- Press the button three times until the numbers begin to flash in the upper right corner of the display.
- Press the or button to select your call ring melody.
- To deactivate call, and press the or buttons until "of" is shown in the display.
- Press the PTT button to confirm

### Setting the button tone

- Press the button until the channel number flash on the display
- Press the button four times until the numbers
- Press the or button to select "on" or "of"
- Press and hold PTT button to confirm

### Setting the PTT tone

- Press the button until the channel number flash on the display
- Press the button five times until the numbers
- Press the or button to select "on" or "of"
- Press and hold PTT button to confirm

### Built-in flashlight

As an added feature, your walkie talkie has a built-in flashlight that can be used in sending light signals or for your lighting needs.

- press and hold LAMP buttons until sending light
- press and hold LAMP buttons until off light

### Low battery indicator

When the batteries need to be changed, the battery level icon will flash. To ensure uninterrupted communication, Recharge or replace the batteries as soon as possible.

### Charging the radio

To charge required using 3 AA NI-MH rechargeable, Insert the adapter's microUSB plug to DC IN 5V USB jack Charge the batteries for 12 hours and remove the radio after charging.

6

#### FCC Statement

This device complies with Part 15 of the FCC rules. Operation is subject to the following two conditions: 1) this device may not cause harmful interference, and 2) this device must accept any interference received, including interference that may cause undesired operation.

Note: This equipment has been tested and found to comply with the limits for a Class B digital device, pursuant to part 15 of the FCC Rules. These limits are designed to provide reasonable protection against harmful interference in a residential installation. This equipment generates uses and can radiate radio frequency energy and, if not installed and used in accordance with the instructions, may cause harmful interference to radio communications. However, there is no guarantee that interference will not occur in particular installation. If this equipment does cause harmful interference to radio or television reception, which can be determined by turning the equipment off and on, the user is encouraged to try to correct the interference by one or more of the following measures:

- Reorient or relocate the receiving antenna.
- Increase the separation between the equipment and receiver.
- Connect the equipment into an outlet on a circuit different from that to which the receiver is connected.
- Consult the dealer or an experienced radio/TV technician for help.

Changes or modifications not expressly approved by the party responsible for compliance could void the user's authority to operate the equipment.

This equipment complies with FCC radiation exposure limits set forth for an uncontrolled environment. Hold the transmitter approximately 2 inches (25mm) from your face and speak in a normal voice, with the antenna pointed up and away.

User should avoid un-intended operation of usage when it is collocated with other transmitters or antenna.