

Hardware Installation

- Connect the USB keyboard and USB receiver to your PC (USB port).
- Install two AAA batteries in the mouse.

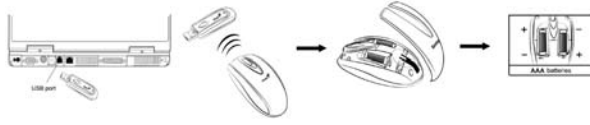

USB Hub notice

Numpad C600 provides a two-port USB Hub 2.0. You can plug an appropriate USB device into a USB port on the keyboard.



Before you start

- The USB port on this keyboard is a “high power, bus-powered device”, not a “self-powered device”; that is the electrical power of this keyboard is supplied by the host computer, not by itself. If the PC system power does not supply 5V and 500mA for the USB port or USB HUB of BUS POWER, it might not be available.
- USB Hubs have additional ports that let you connect multiple devices together. In general, you can connect up to two individual USB peripherals at one time in a PC system, like a mouse, joystick, etc.

FEDERAL COMMUNICATIONS COMMISSION INTERFERENCE STATEMENT

This equipment has been tested and found to comply with the limits for a Class B digital device, pursuant to Part 15 of the FCC Rules. These limits are designed to provide reasonable protection against harmful interference in a residential installation. This equipment generates, uses and can radiate radio frequency energy and, if not installed and used in accordance with the instructions, may cause harmful interference to radio communications. However, there is no guarantee that interference will not occur in a particular installation. If this equipment does cause harmful interference to radio or television reception, which can be determined by turning the equipment off and on, the user is encouraged to try to correct the interference by one or more of the following measures:

- Reorient or relocate the receiving antenna.
- Increase the separation between the equipment and receiver.
- Connect the equipment into an outlet on a circuit different from that to which the receiver is connected.
- Consult the dealer or an experienced radio/TV technician for help.

CAUTION:

Any changes or modifications not expressly approved by the party responsible for compliance could void the user's authority to operate the equipment.

This device complies with Part 15 of the FCC Rules. Operation is subject to the following two conditions:

- (1) This device may not cause harmful interference and
- (2) This device must accept any interference received, including interference that may cause undesired operation.

RF exposure warning ·

This equipment must be installed and operated in accordance with provided instructions and the antenna(s) used for this transmitter must be installed to provide a separation distance of at least 20 cm from all persons and must not be co-located or operating in conjunction with any other antenna or transmitter. End-users and installers must be provide with antenna installation instructions and transmitter operating conditions for satisfying RF exposure compliance.