

270.00 mm

90.0 mm

Ezzy360Pro Quick Start Guide

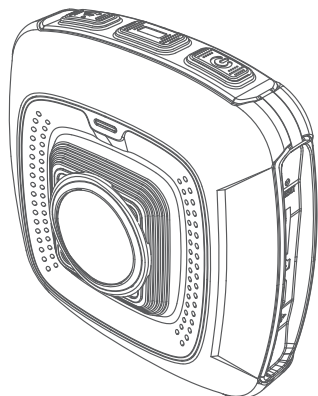

1. Introduction on product parts

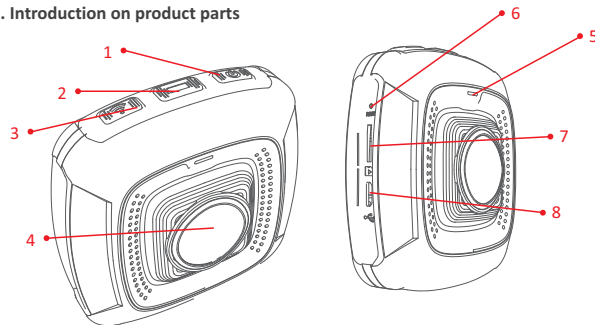

- 1). Power On / Off
- 2). Recording button
- 3). Wi-Fi On / Off
- 4). Lens

- 5). Recording Indicator
- 6). Reset button
- 7). TF card port
- 8). Micro-USB port

2. Recharging

This device can be recharging via USB cable & A/C adaptor or power bank and it is recommended to use rating 5V / 1A or above for this operation

3. Introduction on normal use

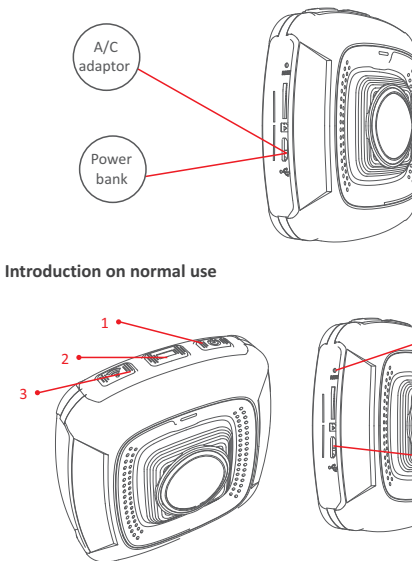

1). Power on / off

Power on: Press the Power button for seconds and all lights turn on

Power off: Press the Power button for seconds again and the red light will flash until turn off

2). Recording

Press the Recording button, it will start recording when red light flash; press the Recording button again, the recording stop. (In case of no card, full or any error, the red light will flash fast)

3). Wi-Fi on / off

Wi-Fi on: Press the Wi-Fi button, blue light turns on and it will flash when data transfer.

Wi-Fi off: Press the Wi-Fi button again, blue light will turn off.

4). Recharging

Connecting with USB cable & A/C adaptor, the Red light will turn on and recharging start; the Red light will turn off when recharging completed. (Recharging is only working when device power off, while it can't work when it power on)

5). Power Cut

Press this button and the camera will power cut.

4. Camera App

Smartphone system should be Android 5.0 or iOS 8 & above.

Android users can download the App Ezzy360Pro from Google play store and iOS users can download the App Ezzy360Pro from App Store.

5. Camera specification

Lens: F2.0 FOV 220°x2

Video format: 2880*1440 30fps

Storage: MicroSD

Input Current: 1A

Input Voltage: 5V

Operating Temperature: - 10°~+50C°

Power: 2.4 Watt

FCC Radiation Exposure Statement

This equipment complies with FCC RF radiation exposure limits set forth for an uncontrolled environment. This transmitter should be installed and operated with a minimum distance of 20 centimeters between the radiator and your body and must not be collocated or operating in conjunction with any antenna or transmitter.

Warning

Changes or modifications to this unit not expressly approved by the party responsible for compliance could void the user's authority to operate the equipment

ROHS

This product is in compliance with Directive 2011/65/EU of the European Parliament and of the Council of 8 June 2011, on the restriction of the use of certain hazardous substances in electrical equipment.

NOTE: This equipment has been tested and found to comply with the limits for a Class B digital device, pursuant to Part 15 of the FCC Rules. These limits are designed to provide reasonable protection against harmful interference in a residential installation. This equipment generates, uses and can radiate radio frequency energy and, if not installed and used in accordance with the instructions, may cause harmful interference to radio communications. However, there is no guarantee that interference will not occur in a particular installation. If this equipment does cause harmful interference to radio or television reception, which can be determined by turning the equipment off and on, the user is encouraged to try to correct the interference by one or more of the following measures:

- oReorient or relocate the receiving antenna.
 - oIncrease the separation between the equipment and receiver.
 - oConnect the equipment into an outlet on a circuit different from that to which the receiver is connected.
 - oConsult the dealer or an experienced radio/TV technician for help.
- This device complies with Part 15 of the FCC Rules. Operation is subject to the following two conditions:
- (1) this device may not cause harmful interference, and
 - (2) this device must accept any interference received, including interference that may cause undesired operation.

