

HyperX CloudX Flight

Wireless Gaming Headset

Quick Start Guide

Overview

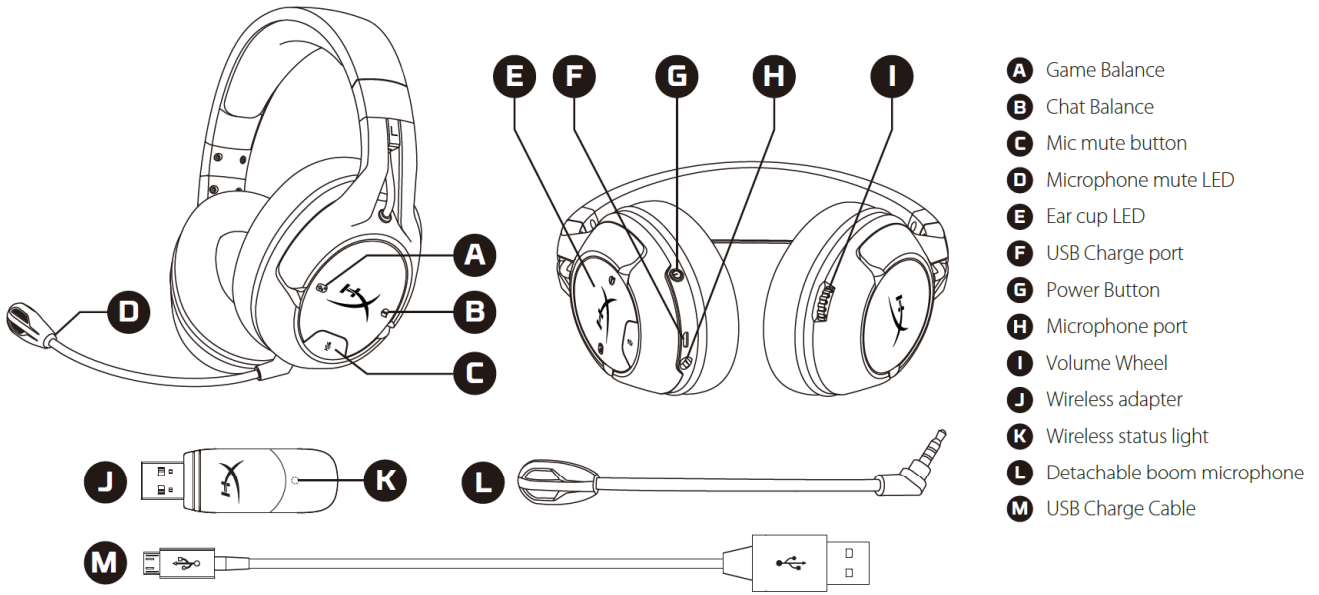

446XXXX

Usage

Charging

It is recommended to fully charge your headset before first use.

EAR CUP LED	CHARGE STATUS
Breathing	Charging
Off	Charging complete

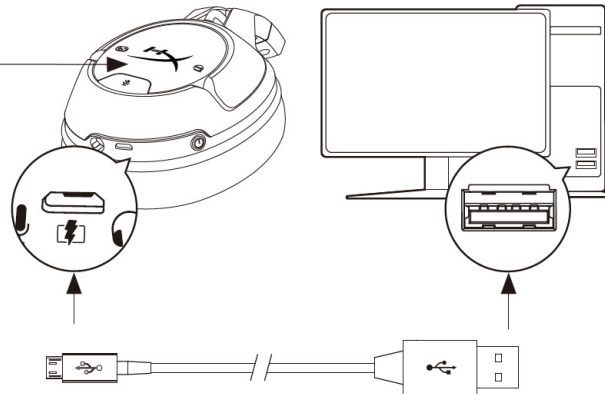

Power Button

Power on/off – Hold power button for 3 seconds
 LED effect – Press power button to cycle LED effect (solid, breathing, and off)

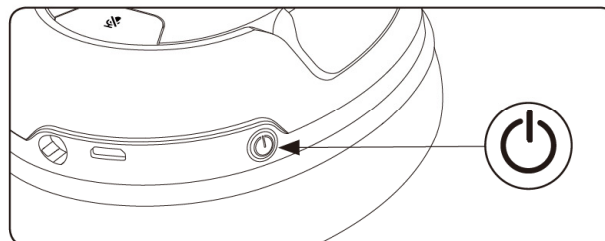

Game/Chat mix buttons

Press to adjust mix between game audio and chat audio.

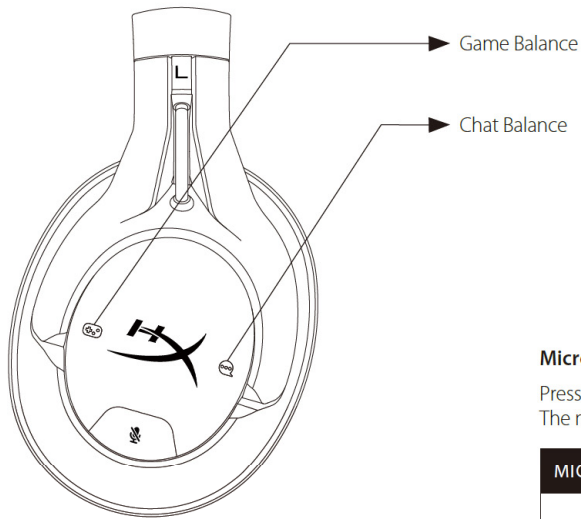

Microphone mute button

Press the microphone mute button to on/off the microphone mute. The microphone mute LED will indicate the current mute status

MICROPHONE MUTE LED	MUTE STATUS
Solid	Mute on
Off	Mute off

Using with Xbox One or PC

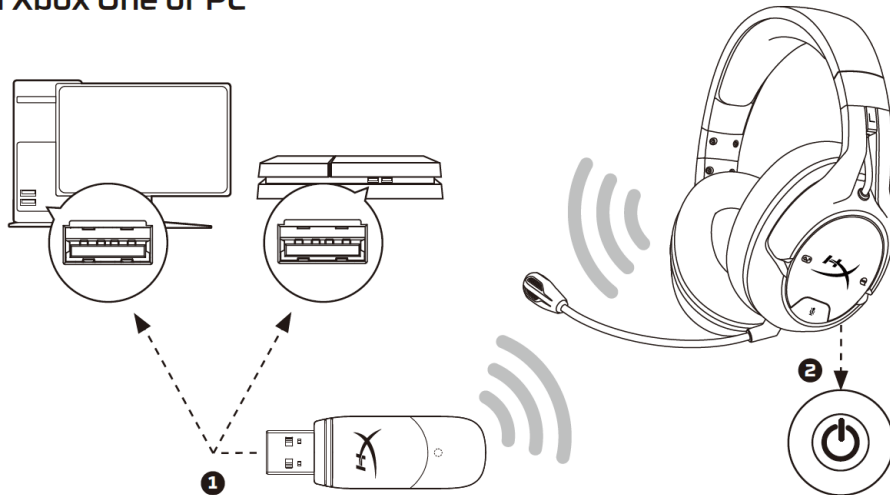

1. Connect the wireless adapter to a USB port on the Xbox One or PC. The wireless adapter status light will blink. 2. Power on the headset.
Note: When the headset is connected to the Xbox One, this will not automatically mute or adjust the sound from the TV.

Questions or Setup Issues?

Contact the HyperX support team or see the user manual at hyperxgaming.com/support/headsets

Battery/TX Power Info

Battery Information	Frequency & TX Power Information
Contains 3.7 V, 1500 mAh Li-ion Battery, 5.55Wh Cannot be replaced by user	Frequency Bands: 2.4GHz (TX Power: <2dBm)

繁體中文

概觀

- A - 遊戲平衡
- B - 語音平衡
- C - 麥克風靜音按鈕
- D - 麥克風靜音指示燈
- E - 耳機指示燈
- F - USB 充電埠
- G - 電源開關
- H - 麥克風插孔
- I - 音量旋鈕
- J - 無線接收器
- K - 無線狀態燈號
- L - 可拆卸吊桿麥克風
- M - USB 充電線

使用說明

充電中

建議您在初次使用耳機前，先把電充滿。

耳機 LED 燈號	充電狀態
呼吸燈	充電中
關閉	充電完成

Taiwan regulatory information(NCC)

依據低功率電波輻射性電機管理辦法

第十二條

經型式認證合格之低功率射頻電機，非經許可，公司、商號或使用者均不得擅自變更頻率、加大功率或變更原設計之特性及功能。

第十四條

低功率射頻電機之使用不得影響飛航安全及干擾合法通信；經發現有干擾現象時，應立即停用，並改善至無干擾時方得繼續使用。前項合法通信，指依電信法規定作業之無線電通信。低功率射頻電機須忍受合法通信或工業、科學及醫療用電波輻射性電機設備之干擾。

The user notifications

English:

This device complies with Industry Canada's license-exempt RSSs. Operation is subject to the following two conditions:

- (1) This device may not cause interference; and
- (2) This device must accept any interference, including interference that may cause undesired operation of the device.

French:

Le présent appareil est conforme aux CNR d'Industrie Canada applicables aux appareils radio exempts de licence. L'exploitation est autorisée aux deux conditions suivantes : (1) l'appareil ne doit pas produire de brouillage, et (2) l'utilisateur de l'appareil doit accepter tout brouillage radioélectrique subi, même si le brouillage est susceptible d'en compromettre le fonctionnement.

電源鍵

電源開閉 - 長按電源鍵 3 秒

LED 效果 按電源按鈕可循環 LED 效悲(恆亮、呼吸和關閉)

遊戲/聊天混合按鈕

按此按鈕可調整遊戲音頻和聊天音頻之間的混音。

麥克風靜音按鈕

按麥克風靜音按鈕打開/關閉麥克風靜音。

麥克風靜音 LED 將指示當前的靜音狀態

麥克風靜音指示燈	靜音狀態
恆亮	靜音中
關閉	靜音關閉

使用於 Xbox One 或個人電腦

1. 將無線接收器連接到 Xbox One 或 PC 上的 USB 端口。無線接收器狀態指示燈將閃爍。
 2. 打開耳機電源
- 注意:當耳機連接到 Xbox One 時，這不會自動靜音或調整電視的聲音。

有任何安裝或使用問題？

請聯絡 HyperX 支援團隊或參閱使用者手冊，網址為：

hyperxgaming.com/support/headsets

電池資訊	頻率與傳輸功率資訊
包含 3.7 V · 1500 mAh 鋰離子電池： 5.55Wh 用戶請勿自行替換	頻段：2.4GHz (TX 功率：<2dBm

Warning statements

15.19:

THIS DEVICE COMPLIES WITH PART 15 OF THE FCC RULES. OPERATION IS SUBJECT TO THE FOLLOWING TWO CONDITIONS: (1) THIS DEVICE MAY NOT CAUSE HARMFUL INTERFERENCE, AND (2) THIS DEVICE MUST ACCEPT ANY INTERFERENCE RECEIVED, INCLUDING INTERFERENCE THAT MAY CAUSE UNDESIRE OPERATION.

15.21:

The user manual for an intentional or unintentional radiator shall caution the user that changes or modifications not expressly approved by the party responsible for compliance could void the user's authority to operate the equipment.

NOTE: THE GRANTEE IS NOT RESPONSIBLE FOR ANY CHANGES OR MODIFICATIONS NOT EXPRESSLY APPROVED BY THE PARTY RESPONSIBLE FOR COMPLIANCE. SUCH MODIFICATIONS COULD VOID THE USER'S AUTHORITY TO OPERATE THE EQUIPMENT.

15.105(b):

NOTE: This equipment has been tested and found to comply with the limits for a Class B digital device, pursuant to part 15 of the FCC Rules. These limits are designed to provide reasonable protection against harmful interference in a residential installation. This equipment generates uses and can radiate radio frequency energy and, if not installed and used in accordance with the instructions, may cause harmful interference to radio communications. However, there is no guarantee that interference will not occur in a particular installation. If this equipment does cause harmful interference to radio or television reception, which can be determined by turning the equipment off and on, the user is encouraged to try to correct the interference by one or more of the following measures:

- Reorient or relocate the receiving antenna.
- Increase the separation between the equipment and receiver.
- Connect the equipment into an outlet on a circuit different from that to which the receiver is connected.
- Consult the dealer or an experienced radio/TV technician for help.