

KitchenAid® COOKTOP PARTS

For Models: KECC507KBL03, KECC507KSS03, KECC507KBT03, KECC507KWW03
(Black) (S.Steel) (Biscuit) (Designer White)

36" ELECTRIC
BUILT-IN
COOKTOP

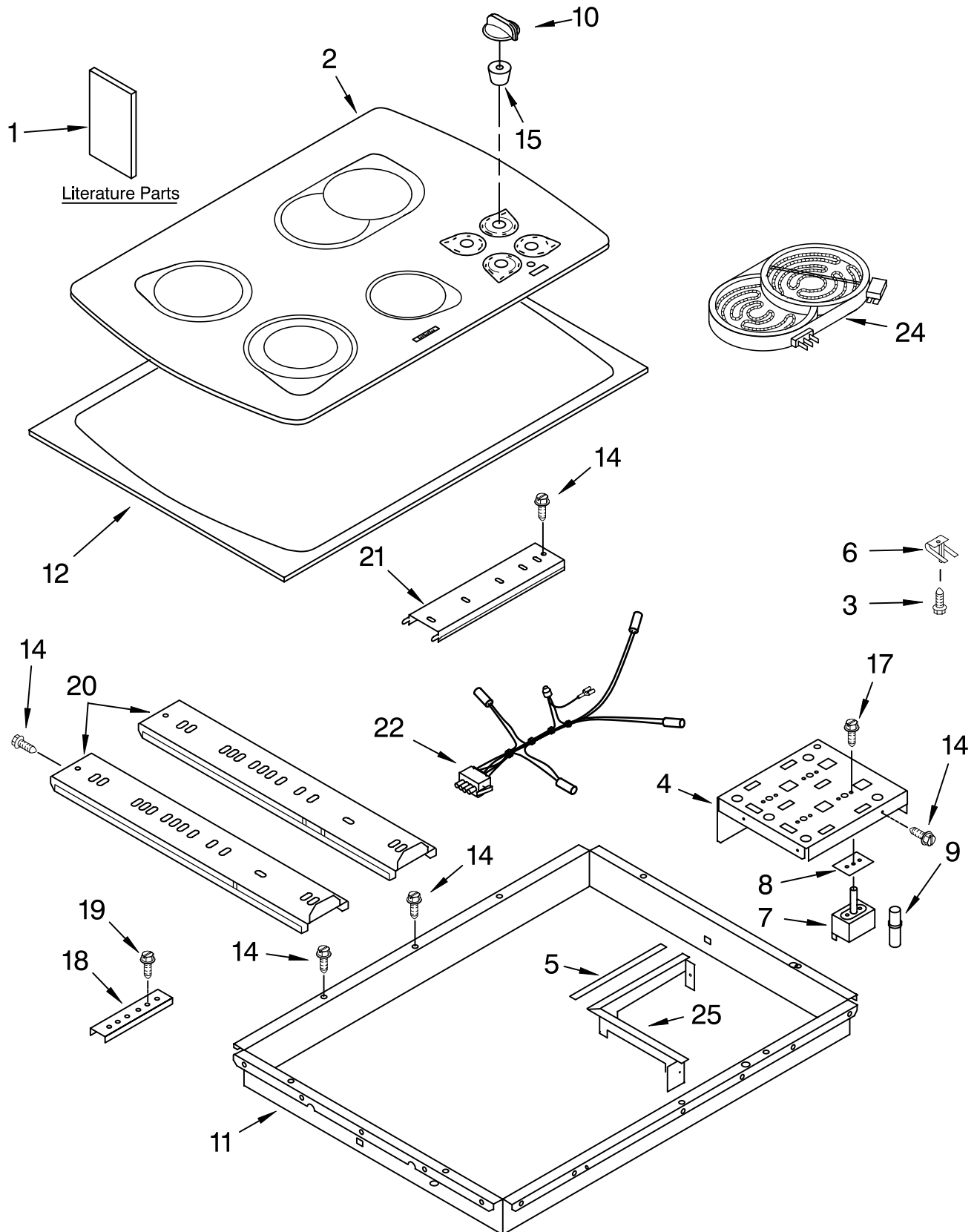

FOR ORDERING INFORMATION REFER TO PARTS PRICE LIST

COOKTOP PARTS

For Models: KECC507KBL03, KECC507KSS03, KECC507KBT03, KECC507KWW03
 (Black) (S.Steel) (Biscuit) (Designer White)

| Illus. No. | Part No. | DESCRIPTION |
|------------|-----------|-------------------------------------|
| 1 | | Literature Parts |
| | 9759087 | Installation Instructions |
| | 9759385 | Wiring Diagram |
| | 8285368 | Use & Care Guide |
| | 9759133 | Safe Cooking Tips |
| | | COOKTOP PARTS |
| 2 | | Cooktop, Glass |
| | 8284887 | Black |
| | 8284890 | Biscuit |
| | 8284889 | Designer White |
| | 8284891 | S.Steel |
| 3 | 246119 | Screw |
| 4 | 4455421 | Bracket, Switch Mounting |
| 5 | 3191839 | Seal, Heat Shield |
| 6 | 9759094 | Spring Locator(8) |
| 7 | | Switch, Infinite |
| | 3191049 | LR – RF |
| | 4456027 | LF – RR |
| 8 | 3183956 | Seal, Switch Shaft |
| 9 | 3191945 | Light, Indicator |
| 10 | | Knob, Control (4) |
| | 9750372FF | Black |
| | 9750372FW | White |
| | 9750372FC | Biscuit |
| 11 | 4456959 | Box, Burner |
| 12 | 8284627 | Frame, Cooktop (S.Steel model only) |
| 14 | 3196537 | Screw |
| 15 | 8285469 | Seal, Switch (5) |
| 17 | 311865 | Screw |
| 18 | 4455917 | Bracket, Mounting |
| 19 | 3400093 | Screw |
| 20 | 9763517 | Rail, Element (2) |
| 21 | 3192268 | Rail, Element (1) |
| 22 | 3191343 | Lamp, Hot Surface Indicator |
| 24 | | Element, Surface |
| | 4453909 | 1200/2400W – LF |
| | 4452742 | 1200W – RF |
| | 4456507 | 1000/1800W – RR |
| | 8523697 | 1500W – LR |
| | 3192737 | Seal, Heat |
| | 3192439 | Seal, Limiter |
| 25 | 4455468 | Shield, Heat |

OPTIONAL PARTS

For Models: KECC507KBL03, KECC507KSS03, KECC507KBT03, KECC507KWW03
(Black) (S.Steel) (Biscuit) (Designer White)

| Illus. No. | Part No. | DESCRIPTION |
|-------------------|-----------------|--------------------|
|-------------------|-----------------|--------------------|

**FOLLOWING PARTS
NOT ILLUSTRATED**

Miscellaneous

3172515 Mtg. Hardware Kit
3192408 Bracket,
Support (2)

SPLICING WIRES--25FT.

LENGTH

242828 Wire, Black
4456028 Jumper, Wire
12 Ga. 150° C
242820 Wire, Black
14 Ga. 150° C
242822 Wire, Blue
14 Ga. 150° C
242830 Wire, Brown
14 Ga. 200° C
242823 Wire, Green
14 Ga. 150° C
242824 Wire, Orange
14 Ga. 150° C
242829 Wire, Red
12 Ga. 150° C
242825 Wire, Red
14 Ga. 150° C
242831 Wire, Red
14 Ga. 200° C
242826 Wire, White
14 Ga. 150° C
242827 Wire, Yellow
14 Ga. 150° C
242832 Wire, Yellow
14 Ga. 200° C

ACCESSORY PARTS

WIRING HARNESS PARTS

4456761 Harness, Main
3400015 Screw, Ground
4456512 Conduit Assy.

FOR ORDERING INFORMATION REFER TO PARTS PRICE LIST