

THANK YOU

Thank you for your purchase of the Klipsch® Music Center KMC 3! The KMC 3 combines legendary Klipsch technology with *Bluetooth*® and aptX™ technology for truly hi-fidelity music playback from your favorite music device. Its contemporary styling compliments any décor and you can take it almost anywhere with both AC and battery-power options.

AC POWER

To operate on AC power plug AC adapter into back of the KMC 3 marked DC IN, then plug AC adaptor into a functioning wall socket. On AC power, if no streaming or connected audio is detected for one hour the KMC 3 will automatically go into standby mode.

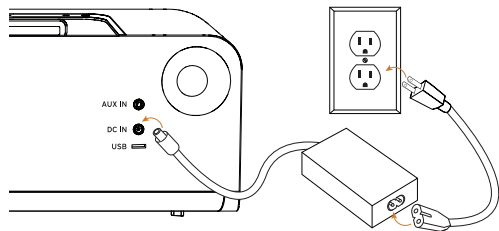

BATTERY POWER

To operate on battery power, install 8 D Cell (LR20) alkaline batteries as shown. If batteries are installed, the KMC 3 operates on battery power unless AC power is utilized. On battery power, if no streaming or connected audio is detected for five minutes, the KMC 3 will automatically power off.

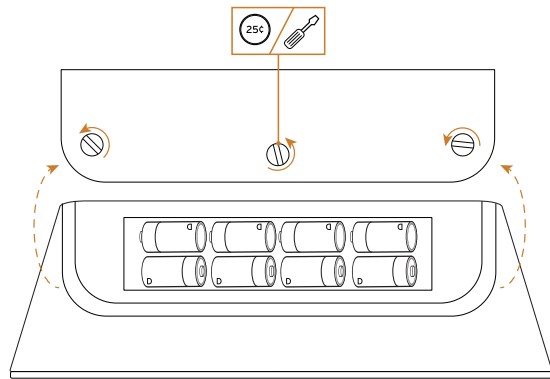

ILLUMINATED CONTROL FUNCTIONS

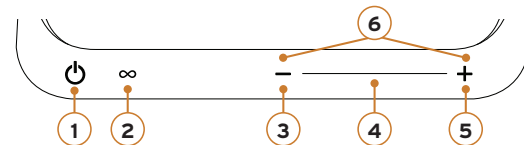

1. **POWER ON / OFF** - Tap to turn on. Hold to turn off. Solid Red indicates Power On, flashes if batteries are weak

2. *BLUETOOTH*

	No Connection		Hold to Pair Tap to Exit	
	Connected		Hold to Disconnect	

3. **VOLUME DOWN**
4. **VOLUME LEVEL INDICATOR**
5. **VOLUME UP**
6. **SOURCE SELECT** - Pressing + and - together toggles between *Bluetooth* mode and AUX (3.5mm input) for playback

REMOTE CONTROL FUNCTIONS

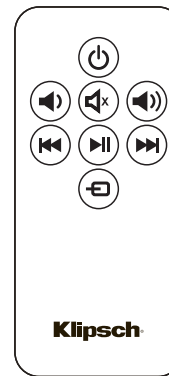

- POWER ON / OFF**
- VOLUME DOWN**
- MUTE**
- VOLUME UP**
- TRACK REVERSE**
(Bluetooth mode only)
- PLAY / PAUSE**
(Bluetooth mode only)
- TRACK FORWARD**
(Bluetooth mode only)
- SOURCE / *BLUETOOTH***
(See Illuminated Control Functions #2)

MUSIC SOURCES

Any paired *Bluetooth* device within a 30 foot (9.1 m) range of the KMC 3 can wirelessly stream music.

Any device with a standard 3.5mm headphone output can be connected to the AUX input (on back) with a mini-to-mini connecting cable (included). Once connected, make sure volume on KMC 3 is just above minimum, adjust volume on your device to maximum and play music. Use SOURCE SELECT to switch to AUX input if necessary. Adjust volume up to desired level.

PAIRING BLUETOOTH DEVICES

Touch the *Bluetooth* button on unit down until it begins to flash (approximately 3 seconds). Do not touch any other buttons on the KMC 3 or its remote during this process. While the *Bluetooth* button flashes blue, activate the *Bluetooth* feature on your music device or phone, setting it up to pair with "Klipsch KMC 3". Once paired, the KMC 3 will automatically select *Bluetooth* as the source. First, adjust the volume of the KMC 3 to the below illustrated range for optimum performance. Then, while streaming music from your device, adjust the device volume to desired level.

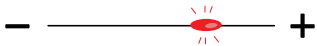

The next time the KMC 3 is powered on it will automatically search for the last paired *Bluetooth* device and, if available, will automatically connect and go to *Bluetooth* as the source. If the last paired *Bluetooth* device is not available or not playing it will automatically choose the AUX (3.5mm input) as the source. The KMC 3 can store up to 8 paired *Bluetooth* devices.

USB CHARGING

NOTE: The USB input is only for CHARGING most music players, phones, and tablets. Using the USB connection end of the charging cable for your device (not included), connect to the USB input on rear of the KMC 3 to charge your device. You can charge your device using either AC or battery power for the KMC 3.

NOTE: Using the USB input to charge your device while the KMC 3 is on battery power will reduce battery life. If batteries in the KMC 3 are too weak, the USB connection will not charge your device.

CARE AND CLEANING

Your KMC 3 music center has a durable finish that should only require dry dusting or cleaning with a dry cloth. Avoid the use of abrasive or solvent-based cleaners and harsh detergents. Adhesive tape will clean up the rubber device area when it has dust and particles on it. Do not rub hard. Window cleaner and a paper towel will clean the surface well.

TROUBLESHOOTING

KMC 3 will not power on

- Make sure AC adapter is plugged tightly into DC input
- Make sure AC adapter is plugged into a live outlet
- If no AC connection make sure all 8 batteries are inserted into battery compartment correctly
- Install fresh batteries if not plugged into DC input

Device will not pair with *Bluetooth* mode

- Make sure KMC 3 is in pairing mode (∞ flashing blue)
- Make sure you are within 30 feet (9.1 m) of KMC 3 while pairing; move closer/make sure you are in the same room
- Make sure your volume settings are correct

Device does not play in *Bluetooth* mode or AUX input

- Make sure volume on device is up to maximum/KMC 3 volume is up at least half way and not MUTED
- If using AUX input, make sure connections are tight
- Touch + and - buttons together to select correct input
- If solid blue touch and hold + and - together to switch inputs

The Bluetooth® word mark is a registered trademark owned by Bluetooth SIG, Inc. and any use of such mark by Klipsch Group, Inc. is under license.

The "aptX™" software is copyright CSR plc or its group companies. All rights reserved. The aptX™ mark and the aptX logo are trade marks of CSR plc or one of its group companies and may be registered in one or more jurisdictions.

Klipsch is a trademark of Klipsch Group, Inc., registered in the U.S. and other countries. All other trademarks are property of their respective owners. Klipsch is a wholly-owned subsidiary of Voxx International Corporation. ©2012, Klipsch Group, Inc.



Canada Statement

This device complies with Industry Canada RSS-210. Operation is subject to the following two conditions: (1) this device may not cause interference, and(2) this device must accept any interference, including interference that may cause undesired operation of the device.

Le présent appareil est conforme aux CNR d'Industrie Canada applicables aux appareils radio RSS-210. L'exploitation est autorisée aux deux conditions suivantes : (1) l'appareil ne doit pas produire de brouillage, et (2) l'utilisateur de l'appareil doit accepter tout brouillage radioélectrique subi, même si le brouillage est susceptible d'en compromettre le fonctionnement.

The device meets the exemption from the routine evaluation limits in section 2.5 of RSS 102 and compliance with RSS-102 RF exposure, users can obtain Canadian information on RF exposure and compliance.

Le dispositif rencontre l'exemption des limites courantes d'évaluation dans la section 2.5 de RSS 102 et la conformité à l'exposition de RSS-102 rf, utilisateurs peut obtenir l'information canadienne sur l'exposition et la conformité de rf.

FCC Statement

This equipment has been tested and found to comply with the limits for a Class B digital device, pursuant to part 15 of the FCC Rules. These limits are designed to provide reasonable protection against harmful interference in a residential installation. This equipment generates, uses and can radiate radio frequency energy and, if not installed and used in accordance with the instructions, may cause harmful interference to radio communications. However, there is no guarantee that interference will not occur in a particular installation. If this equipment does cause harmful interference to radio or television reception, which can be determined by turning the equipment off and on, the user is encouraged to try to correct the interference by one or more of the following measures:

- Reorient or relocate the receiving antenna.
- Increase the separation between the equipment and receiver.
- Connect the equipment into an outlet on a circuit different from that to which the receiver is connected.
- Consult the dealer or an experienced radio/TV technician for help.

FCC Radiation Exposure Statement

This equipment complies with FCC RF radiation exposure limits set forth for an uncontrolled environment. This transmitter must not be co-located or operating in conjunction with any other antenna or transmitter. This equipment should be installed and operated with a minimum distance of 20 centimeters between the radiator and your body.

This equipment complies with Part 15 of the FCC Rules. Operation is subject to the following two conditions:

- (1) This device may not cause harmful interference, and
- (2) This device must accept any interference received, including interference that may cause undesired operation.

Caution!

The manufacturer is not responsible for any radio or TV interference caused by unauthorized modifications to this equipment. Such modifications could void the user authority to operate the equipment.