

# T29ABT-8GB-SL

BLUETOOTH® VIDEO MP4 PLAYER

FCC ID:YH5T29ABT

IC:8012A-T29ABT

## **QUICK START GUIDE**

**T29A**

SERIES / SÉRIE

# Getting started

Thank you for your purchase of this Hipstreet® Bluetooth® Video MP3 player. This manual is designed to help you easily set up and begin using your new device right away. Please read this manually carefully and be sure to retain it for future reference.

We hope this high quality product offers you endless hours of entertainment. Please visit our website at [www.hipstreet.com](http://www.hipstreet.com) for any questions or additional information you may need.

## What's in the box:

- A** 1 x Bluetooth Video Mp4 player
- B** 1 x Earphones
- C** 1 x Mini-USB charging cable
- 1 x User Manual

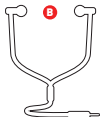
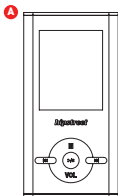

# Getting started

Getting to Know Your Bluetooth® Video MP4 Player:  
Easy-to-Use Controls

## Button Functions:

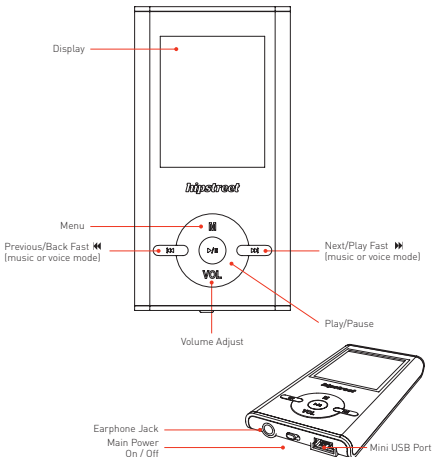

# Getting started

## Power On / Off:

Slide the master power switch to the "ON" position. Press and hold **▶** for 3 seconds to turn the player on, press and hold again to turn it off.



### Note:

The master power can be left on, unless the user intends not to use the player for a long period of time.

When the auto-off timer customized by the user has elapsed, the player will automatically be turned off.



### Note:

This function is invalid when the player is connected to a PC or while charging.

## Charging the player:

When the battery is low, a prompt screen will appear and then the player will automatically shut down.

Use the supplied USB cable to connect player to the computer or AC charger (not included) for charging and file transfer.

The player will prompt you to choose "Charge & transfer" or "Charge & play". "Charge and play", lets you use the player while charging. "Charge & transfer", connects the player your computer for file transfer, as well as charging.

Select your desired choice by pressing **▶** and **◀** to select, then **▶|** to confirm.



### Note:

When charging the player from your computer, be sure the system is on, or charging will not occur.

The battery icon on the top right will show "Full" when the charging is completed. Disconnect the unit when it is done.

## File Transfer:

Your player by default will be displayed as "Removable Disk" on Windows and "NO NAME" on Mac. You can access your player as "Removable Disk" by going to My Computer or Computer on a Windows based system. "NO NAME" is accessible on the Mac desktop.

To add files onto the player, use the drag and drop method to move supported files over from your computer to the player.

## Supported file type:

**Music :**  
MP3, WMA

**Video:**  
Converted files (please refer to the video conversion section)

**Photo:**  
JPG, BMP, GIF

**EBook:**  
TXT



**Note:**  
Do not disconnect the player while it's uploading or downloading files with your computer.

## Music:

Press ◀ and ▶ to browse through the main menu.

Select Music from the main menu, and press ▶ to enter music interface.

In music interface, select **ALL** songs and press ▶ to display a list of all your songs on the player. Press ▶ to begin playing,

and again to pause or stop. You can select a specific song by scrolling through the list with ◀ and ▶ then ▶| to play.

### **During playback:**

Press ▶ to skip next track and ◀ to go back previous track. Hold ◀ and ▶ key to Fast Forward or Fast Reverse.

Press and hold **VOL** to enter volume adjustment mode. Press it one time to exit or return to previous screen

Press **M** to bring up the option menu for **play mode, sound settings, delete**, etc.

### **Video:**

Select **Videos** from the main menu, and press ▶| to enter videos interface.

In video interface, select a file you wish to play by scrolling through the list with ◀ and ▶ then ▶| to play. Press ▶| again to pause or stop.

### **During video playback:**

Press ▶ to skip to the next file and ◀ to go back to the previous file.

Hold ◀ and ▶ key to Fast Forward or Fast Reverse.

Press and hold **VOL** to enter volume adjustment mode. Press it one time to exit or return to previous screen

Press **M** to bring up the option menu for **brightness, repeat**, etc.

### **Recordings:**

Select Recorder from the main menu, and press ▶| to enter

**recorder** interface.

In **recorder** interface, select **Start voice recording** then press ▶| to begin recording. Press ▶| to pause and **VOL** to save the recording.

### **To playback recording:**

In **recorder** interface, select **Recordings library** then press ▶| to display a list of all recorded files on the player. Press ▶| to begin playing and again to pause or stop. You can select a specific file by scrolling through the list with ◀◀ and ▶▶ then ▶| to play.

### **Pictures:**

Select **Pictures** from the main menu, and press ▶| to enter **pictures** interface.

In pictures interface, select a photo you wish to view by scrolling through the list with ◀◀ and ▶▶ then ▶| to open.

### **Viewing photos:**

Press ▶| to start slideshow, and again to pause.

Press ▶▶ to skip to the next photo and ◀◀ to go back to the previous photo.

Press **VOL** to exit or return to previous screen

Press **M** to bring up the option menu for **brightness, slideshow settings, etc.**



## FM Radio:

Select Radio from the main menu, and press ► to enter fm radio interface.

In radio interface, select Manual tune and press ► to enter frequency tuning interface. Press ◀ and ▶ to tune.



### Note:

Headset needs to be plugged in as an antenna for reception.

### To save a channel:

Press **M** to bring up the option menu, select **Save to preset** and press ► to choose a preset slot (1-30) then press ► to save.

### To load a saved channel:

In radio interface, select Presets and press ► to display a list of the preset channels. Scroll through the list with ◀ and ▶ then ► to load the channel.

### To delete a channel:

Select the channel you wish to delete from the preset list, press ► to bring up the option menu, choose Clear preset and press ► to delete.

## EBooks:

Select EBooks from the main menu, and press ► to enter ebooks interface.

In ebooks interface, select a book you wish to read by scrolling through the list with ◀ and ▶ then press ► to open.

### Reading a book:

Press **▶|** will turn the page automatically after a few seconds set by the user.

Press **▶▶** to turn next page and **◀◀** to go back previous page.

Press **VOL** to exit or return to previous screen.

Press **M** to bring up the option menu for **Playsetting**, **Add bookmark**, etc.

### Folder View (Browse):

Select **Browse** from the main menu, and press **▶|** to enter **browse** interface.

In **browse** interface, select a file from the list then press **▶|** to open using the associated function.

### To delete a file:

Select a file from the list, then press **M** to bring up the option menu. Choose **Delete** from the list then press **▶|** to delete.

### Tools (Applications):

Select **Tools** from the main menu, and press **▶|** to enter **tools** interface.

In **tools** interface, select an application from the list then press **▶|** to open.

## **Settings:**

Select **Settings** from the main menu, and press ► to enter **settings** interface.

In **settings** interface, select an option from the list then press ► to enter.

### **Playmode:**

To set repeat and shuffle for music playback.

### **Sound settings:**

To set equalizer, volume limit, and keytone.

### **Sleep timer:**

To set sleep time.

### **Display settings:**

To set brightness, backlight, and screensaver.

### **Date and time:**

To set the date and time.

### **Slideshow settings:**

To configure how photo slideshow should be displayed.

### **Language:**

To change the language on the player.

### **Information:**

To display software version and memory information.

### **Format device:**

To completely delete all data on the player.

### **Factory settings:**

To restore factory settings.

## **Bluetooth® (Bluetooth Setup):**

Select Bluetooth® from the main menu, and press ► to enter Bluetooth® interface.

To turn on Bluetooth®:

In **Bluetooth®** interface, select **BT Control** from the list then press **▶■** to enable or disable Bluetooth®.

### **To pair a Bluetooth® device (e.g. speaker, headphones, etc.):**

Activate pairing mode on the Bluetooth® device you wish to connect with the player (See the user guide of your Bluetooth® device for specific instructions if necessary).

In **Bluetooth®** interface, select **Search Device** from the list then press **▶■** to begin searching for nearby devices. A list of found devices will display, select your Bluetooth device and press **▶■** to pair.

### **To play music with Bluetooth®:**

After pairing is successful, select **BT Now Playing** from the Bluetooth® interface then press **▶■** to begin playing.

### **Video conversion:**

The video conversion tool is used to convert video files into a playable format suited specifically for this player. The video conversion tool is used to convert video files into a playable format suited specifically for this player. Please refer to separate instructions and software provided on the mini DVD included with this device.

### **Troubleshooting:**

If you have problems in operating your player, please check the points below before sending it to the service center.

#### **Player will not start:**

Check whether the battery on the player is low.  
Connect the player to your computer to charge.

**No sound from headset/earphones:**

Check to see if the volume is set to zero.

Check whether the headset/earphones plug has been correctly inserted

**Serious noise:**

Check that the headphone plug is clean - dirt can cause noise. Please check whether the music file is damaged.

Try playing different file. If the file has been damaged, it may lead to serious noise or skips.

**FM reception is poor:**

Please adjust the direction and location of the player.

Make sure that the headphone/earphone cable is stretched out. The cable is your antenna.

Check whether there is interference from other electronic equipment.

**Garbled screen:**

Please check that the correct language setting option has been chosen.

**Cannot download:**

Make sure the computer and the player are properly connected.

Make sure that there is enough storage space in the internal memory.

Make sure the USB cable is not damaged.

## Contact us

**Need assistance? Please contact us!**

For troubleshooting and support, please visit our website at **[www.hipstreet.com](http://www.hipstreet.com)** and check our Support section to view Frequently Asked Questions (FAQ's), video tutorials and more.

If these resources do not quickly resolve the problem, please call or email us. Our Technical Support representatives are ready to help.

Phone: 1-888-456-2426

Monday to Friday: 8:30am – 5:00pm EST

Email: [support@hipstreet.com](mailto:support@hipstreet.com)

Web: [www.hipstreet.com](http://www.hipstreet.com)

We want you to start enjoying your product right away!

### **FCC Warning**

This device complies with part 15 of the FCC Rules. Operation is subject to the following two conditions: (1) This device may not cause harmful interference, and (2) this device must accept any interference received, including interference that may cause undesired operation.

**NOTE 1:** This equipment has been tested and found to comply with the limits for a Class B digital device, pursuant to part 15 of the FCC Rules. These limits are designed to provide reasonable protection against harmful interference in a residential installation. This equipment generates, uses and can radiate radio frequency energy and, if not installed and used in accordance with the instructions, may cause harmful interference to radio communications. However, there is no guarantee that interference will not occur in a particular installation. If this equipment does cause harmful interference to radio or television reception, which can be determined by turning the equipment off and on, the user is encouraged to try to correct the interference by one or more of the following measures:

- Reorient or relocate the receiving antenna.
- Increase the separation between the equipment and receiver.
- Connect the equipment into an outlet on a circuit different from that to which the receiver is connected.
- Consult the dealer or an experienced radio/TV technician for help.

**NOTE 2:** Any changes or modifications to this unit not expressly approved by the party responsible for compliance could void the user's authority to operate the equipment.

### **IC Warning**

This device complies with Industry Canada license-exempt RSS standard(s). Operation is subject to the following two

conditions: (1) this device may not cause interference, and (2) this device must accept any interference, including interference that may cause undesired operation of the device.

Le présent appareil est conforme aux CNR d'Industrie Canada applicables aux appareils radio exempts de licence.

L'exploitation est autorisée aux deux conditions suivantes :

- (1) l'appareil ne doit pas produire de brouillage, et
- (2) l'utilisateur de l'appareil doit accepter tout brouillage radioélectrique subi, même si le brouillage est susceptible d'en compromettre le fonctionnement.

This device complies with Canadian ICES-003 and RSS-210 Battery Statement

## Product and Battery Disposal

This product contains a built-in lithium battery and should not be disposed of in normal household waste. The battery in this device is not intended to be removed by the individual or end user. For disposal and recycling, please contact your local waste management authorities.

The recycling and processing of electronic waste will make a significant contribution towards helping protect the environment.

**Warning:** To reduce the risk of fire and burns; do not disassemble, crush, puncture, short external contacts, or dispose of in fire or water.

# MediaMonkey

## Device is pre-loaded with MediaMonkey

MediaMonkey will help you manage and play very large music collections, consisting of a variety music formats (MP3, WMA, AAC/M4A/M4P, OGG, APE, FLAC, MPC, VQF, WAV files) and/or audio CDs. MediaMonkey gives you a capable, yet nimble tool to organize, tag, create playlists, rename files, convert file formats, sync, level volume, and more.

For questions or support using MediaMonkey, please visit:

**<http://www.mediamonkey.com/support>**



***hipstreet***

North America: **1 888 456 2426**

UK: **0800 051 8330**

Netherlands: **0800 404 0006**

Germany: **0800 180 7686**