



# Electric Kettle BBQ CMEKTLBBQA

## Before use

Please read these instructions and ensure you understand all warnings and instructions. This manual contains important information regarding the use, the security and the maintenance of the appliance. Keep a copy of the instructions handy for future reference.

The appliance must only be used for the intended purpose according to these instructions.

## Product Layout

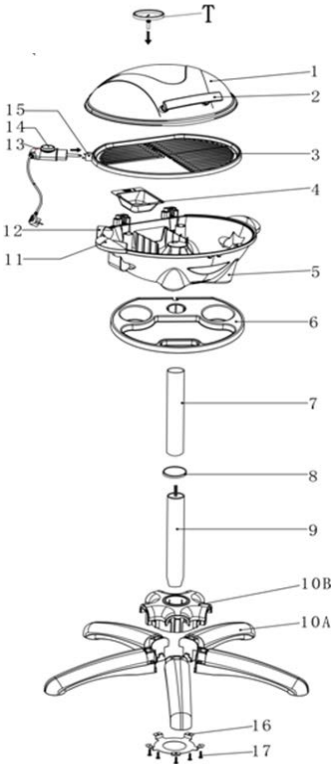

- 1 - Metal Grill Hood
- 2 - Hood Handle
- 3 - Grill Plate
- 4 - Fat Collection Bowl
- 5 - Base
- 6 - Condiment Tray
- 7 - Upper Stand Tube
- 8 - Decorative Ring
- 9 - Nether Stand Tube
- 10A - Stand Foot
- 10B - Stand Base
- 11 - Base Handle
- 12 - Appliance Socket Opening
- 13 - Detachable Temperature Regulator with Cable
- 14 - Temperature Indicator Lamp
- 15 - Appliance Socket
- 16 - Washer
- 17 - Screws
- T - Thermometer

# Safety Warning

Please read these Operation Instructions through carefully before connecting your device to the mains in order to avoid damage due to incorrect use. If you pass this device on to a third party, these Operating Instructions must be handed over.

- This appliance can be used by children aged from 8 years and above and persons with reduced physical, sensory or mental capabilities or lack of experience and knowledge if they have been given supervision or instruction concerning use of the appliance in a safe way and understand the hazards involved.
- Children must not play with the appliance.
- Cleaning and user maintenance should not be performed by children unless they are older than 8 years and supervised.
- If the power supply cord is damaged, it must be replaced by a Kogan.com technician or similarly qualified persons in order to avoid a hazard.
- Regarding the instructions for cleaning the surfaces which come in contact with food, please refer to the paragraph "cleaning and maintenance" of the manual.
- Only appropriate connectors must be used.
- The appliance is suitable for outdoor use.
- The power supply cord should be regularly examined for signs of damage, and if the cord is damaged, the appliance must not be used.
- Keep the appliance and its cord out of reach of children less than 8 years.
- **WARNING!!** Please do not touch surface while in use. The temperature of accessible surfaces may be high when the appliance is operating.
- Incorrect operation and improper use can damage the appliance and cause injury to the user.
- The appliance may be used only for its intended purpose. No responsibility can be taken for any possible damage caused through incorrect or improper handling.
- Do not put the appliance or the plug in water or any other liquid. However if the appliance accidentally falls into water or gets otherwise wet, unplug the appliance immediately and have it checked by a qualified person before using it again. Non-observance could cause a fatal electric shock!
- Never attempt to open the housing yourself.
- Do not place any kind of object into the inside of the housing.
- Do not use the appliance with wet hands, on a damp floor or when the appliance itself is wet.
- Do not touch the plug with wet or damp hands.
- Check the cord and the plug regularly for any possible damage.
- Do not use the appliance if it is dropped or otherwise damaged or if the cord or plug is damaged.
- Never attempt to repair the appliance by yourself. This could cause an electric shock.
- Do not allow the cord to hang over sharp edges and keep it well away from hot objects and naked flames. Remove the plug from the socket only by holding the plug. Never pull on the cord.
- Make sure that there is no danger that the cord or extension cord may inadvertently be pulled or cause anyone to trip when in use.
- If an extension cord is used it must be suited to the power consumption of the appliance, otherwise overheating of the extension cord and/or plug may occur.
- This unit is not suitable for professional operation.
- Never leave the appliance unattended while it is in use.
- Children cannot recognize the dangers involved in the incorrect use of electrical appliances. Therefore never allow children to use household appliances without supervision.
- Always remove the plug from the socket when the appliance is not in use and each time before it is cleaned.
- **Danger!** Nominal voltage is still present in the appliance as long as the appliance is connected to the mains socket.
- Switch off the appliance before disconnecting from the mains.
- Never use the cord to carry the appliance.
- The machine should not be operated by means of an external timer-switch or by means of a separate system with remote control.
- The appliance can be operated outdoors in fine weather. It must never become wet.
- Before use, the appliance must be placed on a firm, flat surface and at least 50 cm away from the nearest wall or any flammable objects.
- **Attention!** The appliance is become very hot! It must cool down completely, before its surface can be touched. Removing and cleaning of the barbecue grill, the control unit and the drip tray may only be done after the appliance has cooled down completely.
- Charcoal or other combustibles may not be used with this appliance.
- The appliance must not be stored outdoors.
- During first use, a small amount of smoke and faint smell might occur.
- **Burn hazard!** Be careful when handling hot oil and fat. Beware of spitting oil and hot steam!
- Do not move the appliance during use.

# Installation Instructions

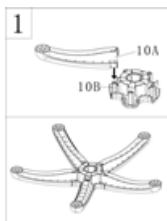

Install the stand foot (10A) into the stand base (10B) properly. There will be a **click** sound when the stand foot is fixed completely.

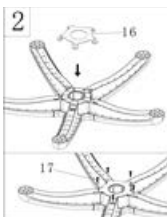

Place the washer (16) onto the stand base, then install the screws (17) into the washer to fix the stand feet and base firmly.

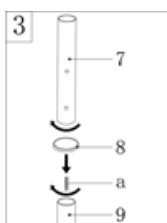

Install half of the threaded rod (a) into the nether tube (9).  
Put the decorative ring (8) onto the nether tube (9), then assembly both tubes together, ensuring they are firmly connected.

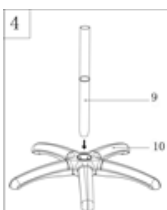

Connect the grill stand base (10) and the nether tube (9) together to form the complete grill stand. (The grill can be used either with or without this stand).

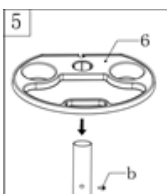

Install the screw (b) into the upper tube (7), then put the condiment tray onto the upper tube, making sure the tray is well secured.

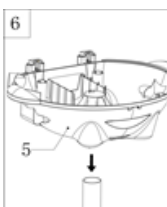

Place the bowl-shaped base (5) onto the grill stand. Make sure the grill stand is already situated on a dry, flat, stable surface.

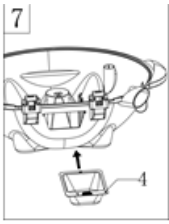

Put the fat collection bowl (4) into the bracket supplied for it in the base. Buckle the fat collecting bowl onto the screws to secure it. (The fat collecting bowl can be filled with a little water to make it easier to clean).



Place the grill plate (3) onto the base (5). Then insert the appliance socket (15) into the opening intended for it (12), then set the grill plate horizontally onto the appliance base.



Install the metal grill hood (1) onto the base (5).  
(If you are using the grill in the open air, position the metal grill hood so that it acts as a wind break)

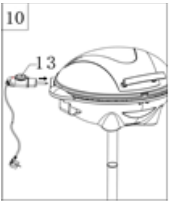

Push the detachable temperature regulator (13) as far as it will go into the grill's appliance socket.

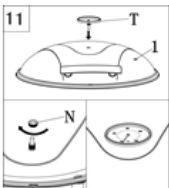

Put the thermometer (T) into the hole on the grill hood (1), then fix it with the screw and nut into the back side of the hood.

#### Before using the appliance for the first time:

- Remove all the packaging materials and wash the grill plate (3), fat collecting bowl (4) and metal grill hood (1) thoroughly. The grill plate and the fat collecting bowl are both dishwasher safe. **Important:** Dry all the different parts thoroughly. This applies especially to the appliance socket (15). Never immerse the detachable temperature regulator (13) in water.
- Heat the grill to its maximum setting for about 3-5 minutes, with the metal grill hood closed and without putting any food on it. Residues left from the manufacturing process may cause some smell and smoke when the appliance is used for the first time.

## Operating the appliance

- Connect the appliance to the mains electricity supply.
- Set the temperature regulator (13) to the required temperature level (it usually takes about 3 minutes to heat up).
- The temperature indicator lamp (14) will go out as soon as the required temperature has been reached.
- Place the food to be grilled on the grill plate (3)

# Cooking Times

The following are recommended cooking times. Different times will be required for different weights and sizes of foods to be grilled, and depending on whether you are grilling with or without the metal grill hood.

Food	Temperature Setting	Cooking Time (minutes)
Steak/beef	5	20-25
Lamb	5	20-25
Chicken drumsticks	5	30-35
Chicken wings	5	20-25
Chops	5	25-30
Fillet of Pork	4-5	9-10
Whole fish	5	15
Kebabs	3-4	10-12
Various sausages	3-4	12-15

## Grilling Tips

- Your meat will be tenderer if you marinade it overnight before cooking (the marinade is always made of oil for moistness, vinegar to tenderize, and a mixture of seasonings).
- Always use tongs or some form of scoop to turn the grilled food (using a fork to turn the food will dry it out and damage the non-stick coating).
- Only turn meat and fish once during grilling. You do not need to turn it more than once and too much turning dries food out.
- Never cook meat for too long. Even pork is better if it is served when it is still somewhat pink and juicy.
- If cooked food sticks to the grill plate, rub the plate with a piece of kitchen paper soaked in oil from time to time.

## Cleaning and Maintenance

1. Disconnect the appliance from the mains electricity supply.
2. Allow the grill to cool completely.
3. Take the detachable temperature regulator (13) out of the appliance socket.
4. Wash the grill plate (3) and fat collecting bowl (4) with hot washing-up water (they are both dishwasher safe). Do not use steel wool pads or abrasives.
5. Wipe the base of the appliance (5) with a damp cloth. Fat splashes can be removed with a mild cleaning agent.

Note: The grill plate has a non-stick coating. Do not scratch this coating during either the grilling or the cleaning stages.

Tip: Use a washing-up brush with plastic bristles to clean the grill plate

Protect the appliance from dust and dirt if it is not to be used for a prolonged length of time by wrapping it in a plastic bag. Store it in a dry place.

If you have any further questions regarding the use of this product, please contact the Kogan.com customer support team.