



KONICA MINOLTA

**MINIMISE ALL. MAXIMISE ALL.**



**bizhub 215/195**



Giving Shape to Ideas

# bizhub 215 / 195

Improve productivity and efficiency while reducing environmental impact and decreasing TCO.

## Introducing an advanced new monochrome MFP for a diverse range of business needs.

The reliable monochrome bizhub 215/195 MFP delivers outstanding environmental performance and helps reduce office costs — ideal as a second device for printing monochrome documents, sharing colour data and keeping printing costs down. bizhub 215/195 is a truly excellent choice for optimising office workflow.

### Maximise information usage while minimising output costs.

Save crisp, highly detailed documents in colour.  
Low-cost output in monochrome.

bizhub 215/195 is a monochrome MFP that minimises output costs while offering colour-scanning functionality. Use it to store documents as digital data and fully leverage its outstanding data control capability.

Share information faster than ever.  
Scan and share without a PC or server.

A wide range of functions let you move data rapidly: Scan to USB memory saves documents quickly on USB flash drives; Scan to FTP is great for sharing large volumes of data; Scan to PC allows you to send data directly to a shared folder on a client PC; and Scan to Email sends a document directly to e-mail addresses selected using the control panel.

#### Optimise document handling

Select colour or monochrome output according to your needs.

When colour output is required, simply scan and temporarily save a document on bizhub 215/195, then print it using a colour printer in the network.

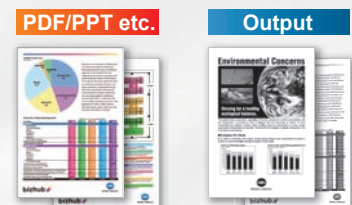

### Enhance work efficiency by saving time and space.

Fast duplex scanning and duplex printing reduce waiting and save power.

Duplex scanning and printing increase scan and print speeds, vastly reducing workloads and costs.

- Maintain efficiency while saving power with warm-up times of 15 sec. or less.
- Eliminate waiting with copy times of 6.5 sec. or less.

#### Optimise document handling

Rationalise devices for a neater office and improved efficiency.

After carefully considering equipment requirements — printer, scanner, fax — install only the colour MFPs you actually need in optimal locations, then integrate them seamlessly with bizhub 215/195. This maximises work efficiency while minimising equipment.



### The optimum working environment for every office.

Konica Minolta's Optimised Print Services rationalise document handling according to different working environments, resulting in more economical and productive operations. Take advantage of OPS to enhance office efficiency and significantly cut TCO.

<http://www.biz.konicaminolta.com/services/ops>





*bizhub 215 with optional items*

## World-class, energy-saving design that is eco friendly and cost efficient.

**Reduce CO<sub>2</sub> and TCO.**  
**Plant-based toner with low-temperature fixing.**

Simitri HD toner with biomass contains small, uniform toner particles that fix at low temperatures, thus saving power. This reduces both environmental impact and TCO.



**Eliminate waste to reduce costs.**  
**Designed for zero-waste as regards toner.**

Other MFPs waste approximately 5 to 10% of toner from a new cartridge. bizhub 215/195's advanced toner loop mechanism eliminates waste by collecting and reusing toner that is not transferred to paper. This lowers wastage to essentially zero, helping to save resources.

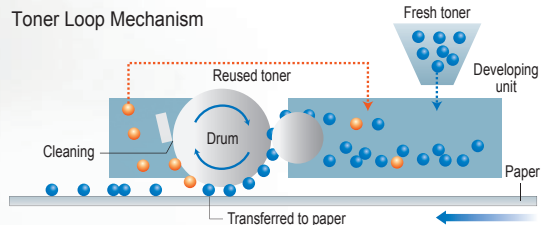

**Significantly less environmental impact and power fees.**  
**TEC\* reduced by approximately 80%.**

Compared to bizhub 211/163, this new bizhub reduces TEC by approximately 80%, significantly easing environmental impact and reducing TCO. bizhub 215/195 is also Energy Star certified.

\* TEC (Typical Electricity Consumption) is a value based on a measurement method defined by the international ENERGY STAR program.

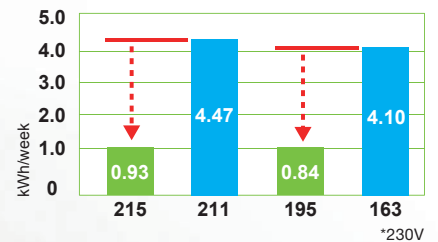

## Comfortable, easy-to-view LCD monitor assures superb usability.

### Duplex copying provides two-in-one efficiency.

The backlit LCD monitor is easier than ever to view and displays simple illustrated guidance. In addition, the control panel has handy buttons like ID Copy: Press it to copy small card-type documents (business cards, IDs, driver's licenses, etc.). Scanned data of one side is temporarily stored while the other side is scanned, with both scans printed as one document.

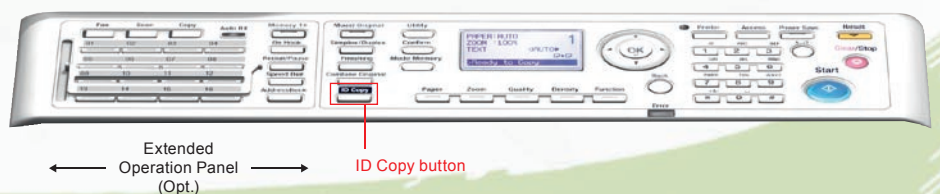
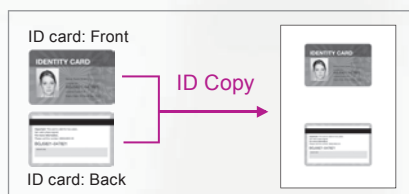

## bizhub 215/195 General Specifications

Product Name	bizhub215/195	
Type	Desktop	
Reading Resolution	600dpi x 600dpi	
Writing Resolution	600dpi x 600dpi	
Memory Capacity	128MB	
Gradation	256 gradations	
Original Type	Sheet, book, 3-dimensional object	
Max. Original Size	A3 or Ledger (11"x17")	
Copy Size	Metric: A3 - A5 Inch: Ledger (11"x17") - Invoice (5.5"x8.5")	
Image Loss	4 mm at each edge (top/ bottom/ right/ left edge)	
Warm-Up Time <sup>1</sup>	Less than 15 sec	
First Copy Out Time <sup>2</sup>	Less than 6.5 sec	
Copy Speed (A4/Letter Crosswise)	bizhub 215: 21ppm <sup>3</sup> bizhub 195: 19ppm	
Copy Magnification	Fixed Ratio	Metric: 0.25/0.50/0.70/0.81/1.00/1.15/1.41/2.00/4.00 Inch: 0.25/0.50/0.64/0.78/1.00/1.21/1.29/2.00/4.00
	Zoom Ratio set by Up/Down key	25-400%
Paper Capacity	Main Body	Standard:250 sheet Universal tray:1tray
	Bypass Tray MB-505	100 sheet Bypass Tray *Depend on each distribution
Paper Weight	Additional cassette PF-507	250 sheet Additional Cassette: Max. 4 trays
	Main Body/Bypass Tray MB-505	64 - 157g/m <sup>2</sup>
Multi Copy Setting	Additional cassette PF-507	64 - 90 g/m <sup>2</sup>
		1 - 999 pages
Max. Power Consumption	1300W (127V only:1350W)	
Dimensions [W] x [D] x [H]		570 x 570 x 458*mm * To the face of platen glass
		570 x 570 x 488**mm ** To the top of original cover
Weight	26.5 kg (Excluding TC/Developer/Original Cover/Bypass unit)	
Space Requirements [W] x [D]	Standard configuration: 570 x 570 mm With Bypass tray: 928 x 570 mm Max required space incl. maintenance space: 999 x 971 mm* *When Bypass tray extended. *When Paper Feed Tray pulled out. (Slide length: 397mm)	
Application Software	PageScope Net Care Device Manager & Plug-in LSU (Local Setting Utility)	

<sup>1</sup> Warm-up time may vary depending on the operating environment and usage.  
The time required to start printing when both the main power and sub-power switches are turned from OFF to ON. (23°C, std. voltage)  
The time required to start printing when the main power switch is ON and the sub-power switch is turned from OFF to ON. (23°C, std. voltage)  
<sup>2</sup> A4/Letter crosswise, full size, using the first tray, scanning from the original glass surface.  
<sup>3</sup> 23 ppm from 2nd Feed Cassette.

## Printer Specification

GDI Image Controller(Standard)		
Type	Embedded	
Print Speed	A4	bizhub 215: 21ppm , bizhub 195: 19ppm
	Letter	bizhub 215: 20ppm , bizhub 195: 19ppm
Resolution	600dpi x 600dpi	
Support OS	Server:	Windows 2003Server / 2008Server / 2008ServerR2 Windows 2003Server x64 Edition / 2008Server x64 Edition
	Client:	Windows XP / Vista / 7 Windows XP / Vista / 7 x64 Edition
Interface	Standard: USB2.0 NC-504(Optional card): Ethernet 10Base-T/100Base-TX	

PCL Controller IC-209 * Optional Video Interface Kit MK-733 is required.		
Type	PCL controller incl. network interface card	
Print Speed	A4	bizhub 215: 21ppm , bizhub 195: 19ppm
	Letter	bizhub 215: 20ppm , bizhub 195: 19ppm
Resolution	1200 or 600 x 600dpi	
Language	PCL6/6e	
Support OS	Server:	Windows 2003Server / 2008Server / 2008ServerR2 Windows 2003Server x64 Edition / 2008Server x64 Edition
	Client:	Windows XP / Vista / 7 Windows XP / Vista / 7 x64 Edition
Interface	Ethernet 10Base-T/100Base-TX	

## Scanning Function Specification

Type	Colour scanner	
Supported Size	Standard: Max. A3 or Ledger (11"x17")	DF-625 (Option ADFR): Max. A3 or Ledger (11"x17")
	Ethernet 10Base-T/100Base-TX (Option card: IC-209 or NC-504)	
Interface	USB 2.0 (Standard) USB Host (Standard: bizhub 215 only)	
Scan Function	TWAIN / WIA: Real Time Mode(Pull) Scan to USB memory(Standard: bizhub 215 only)	
	Network Scan (Option card: IC-209 or NC-504): Scan To FTP, Scan To PC (SMB), Scan To E-mail Network TWAIN	
Driver	TWAIN / WIA driver	
Data format	TIFF, PDF, JPEG	

## System Options

Some products are not available in some areas.

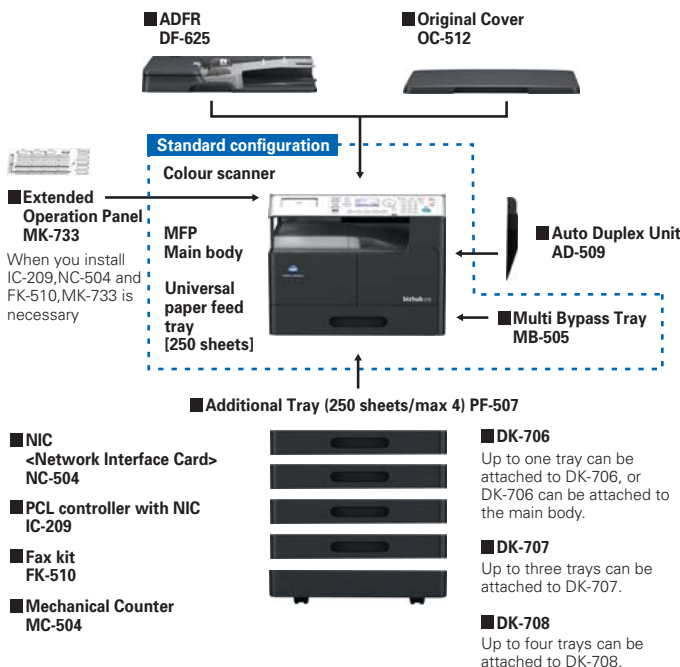

## Fax Kit FK-510

Transmission Standard/ Communication Mode	ECM/G3
Transmission Speed	2.4kbps - 33.6kbps
Data Compression	MH, MR, MMR, JBIG
Transmission Time	Approx. 3 sec (A4, V.34, 33.6kbps, JBIG)
Transmission Size	Scanner: Max. A3 Option DF-625: Max. (W x L) 297 x 1000mm
Recording Size	Max. A3 (Max 1000mm, printed according page partition setting)
Resolution	203 x 196dpi, 203 x 392 dpi, 406 x 392dpi
Abbreviated Dial	250
One Touch Dial	32
Program Dials	4
Sequential Multiple Station Transmission	Max. 255
Driver	PC-FAX driver



# bizhub 215 / 195

215  
B&W  
21  
ppm

195  
B&W  
19  
ppm

Simplex Scan  
ADF  
20 opm

B&W  
A3

Simitri  
with Biomass

For more information please visit the bizhub Web site at [http://www.biz.konicaminolta.com/bw/215\\_195/index.html](http://www.biz.konicaminolta.com/bw/215_195/index.html)

Product appearance, configuration and/or specifications are subject to change without notice.



KONICA MINOLTA, the KONICA MINOLTA logo and symbol mark, and "Giving Shape to Ideas" are registered trademarks or trademarks of KONICA MINOLTA HOLDINGS, INC. bizhub, bizhub PRO, bizhub PRESS, Magicolor, PagePro, PageScope, Simitri, Simitri HD, Simitri HD+, Simitri with Biomass, Emperon, S.E.A.D., S.E.A.D.II, Printgroove and Konica Minolta Optimised Print Services and their respective logos are registered trademarks or trademarks of KONICA MINOLTA BUSINESS TECHNOLOGIES, INC. All other brands and product names are registered trademarks or trademarks of their respective companies or organisations.

### Ecology & Environment

KONICA MINOLTA products are designed with the environment in mind.

- Energy Star
- Eco-friendly Toners



From consulting, system design, to operations, Konica Minolta offers total support to optimise your office output environment.

<http://www.biz.konicaminolta.com/services/ops>

### Requirements for safe use

- Please read and follow the instruction manual to ensure safe operation.
- Only operate using appropriate power supply and voltage.
- Connecting the earth wire to an inappropriate place may cause explosion or electric shock. Please connect accordingly (Taiwan and the Philippines only).

**KONICA MINOLTA  
BUSINESS TECHNOLOGIES, INC.**

1-6-1 Marunouchi Chiyoda-ku, Tokyo, Japan  
<http://www.biz.konicaminolta.com>

9251-3201-11 O1100(E)-A1 Printed in Japan

