

MINOLTA

*VECTIS 300L*

**E** INSTRUCTION MANUAL



Thank you for purchasing the Minolta Vectis 300L. This camera is an easy to operate lens shutter camera from Minolta's line of Advanced Photo System™ cameras, featured with Drop-in Loading and a 24 - 70mm zoom lens. The sleek and compact design gives the Vectis 300L a sophisticated appearance suitable for any occasion. This manual is designed to help you understand the operation of your camera and its functions. Please familiarize yourself with the names of the controls and their locations on the camera, then read this manual thoroughly.

\* Advanced Photo System™ is a trademark of the five system developing companies.

### **Advantages of the Advanced Photo System New print formats...**

Classic C print, wider H print, and panorama P print formats are available with Advanced Photo System cameras.

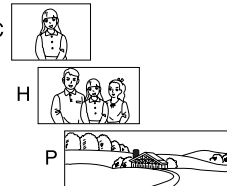

### **Easier to load...**

Advanced Photo System cameras use the new IX240 type film. This new film features Drop-in Loading to make loading your camera simple, the first time, every time. Indicators on the cassette tell you and your camera if the film is unexposed, partially exposed, or processed.

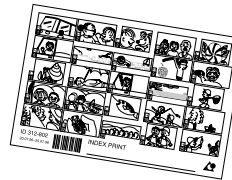

### **New processing...**

In addition to returning your prints in the format you selected, certified photofinishers will return your Advanced Photo System film in its original cassette with an index print. To order reprints, simply choose the images you want from the index print. No more searching through negatives to find the right frame.

## TABLE OF CONTENTS

FOR PROPER AND SAFE USE .....	6
NAMES OF PARTS .....	8
QUICK OPERATION .....	12
<b>BASIC OPERATION</b>	
Attaching the Strap .....	15
Installing the Battery .....	16
Checking the Battery .....	17
Loading Film .....	19
Full-Auto Operation .....	24
Focus Hold.....	28
For Closer Subjects .....	30
Special Focusing Situations .....	33
Rewinding the Film .....	34
Processing .....	36

<b>USING THE BUILT-IN FLASH</b>	
Selecting the Flash Mode .....	38
Flash Range .....	39
Red-eye Reduction .....	40
Fill Flash .....	41
Flash Cancel.....	42
Night Portrait.....	43
Landscape/Night View .....	44
<b>ADDITIONAL FEATURES</b>	
Date Imprinting .....	46
Title Imprinting .....	52
Self-timer.....	60
Remote Control (Sold Separately) .....	62
<b>APPENDIX</b>	
Lab Services .....	68
Caring For Your Camera .....	70
Technical Details.....	76

## FOR PROPER AND SAFE USE

Read and understand all warnings and cautions before using this product.



### WARNING

Batteries may become hot or explode due to improper use.

- Use only the batteries specified in this instruction manual.
- Do not install the batteries with the polarity (+/-) reversed.
- Do not subject batteries to fire or high temperatures.
- Do not attempt to recharge, short, or disassemble.
- Tape over lithium battery contacts to avoid short-circuit when disposing of batteries, and follow local regulations for battery disposal.

Keep batteries or things that could be swallowed away from young children. Contact a doctor immediately if an object is swallowed.

Immediately remove the batteries and discontinue use if...

- the product is dropped or subjected to an impact in which the interior is exposed.
- the product emits a strange smell, heat, or smoke.

Do not disassemble. Electric shock may occur if a high voltage circuit inside the product is touched. Take your camera to a Minolta Service Facility when repairs are required.



### CAUTION

The lens retracts when the camera is turned off or Auto Power Off is activated. Touching the lens barrel while it is retracting may cause injury.

## NAMES OF PARTS

### CAMERA BODY

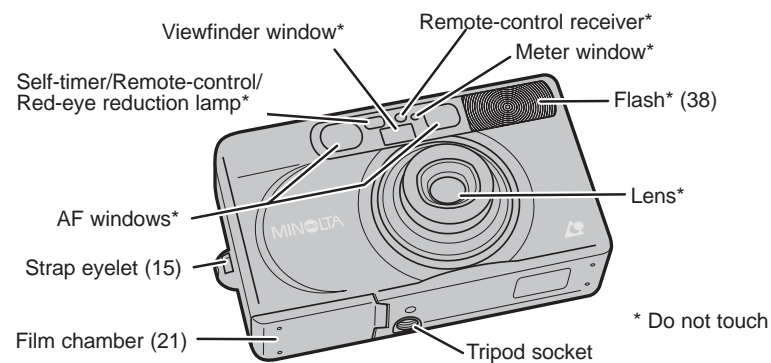

For information on specific parts, refer to the page numbers shown in parenthesis.

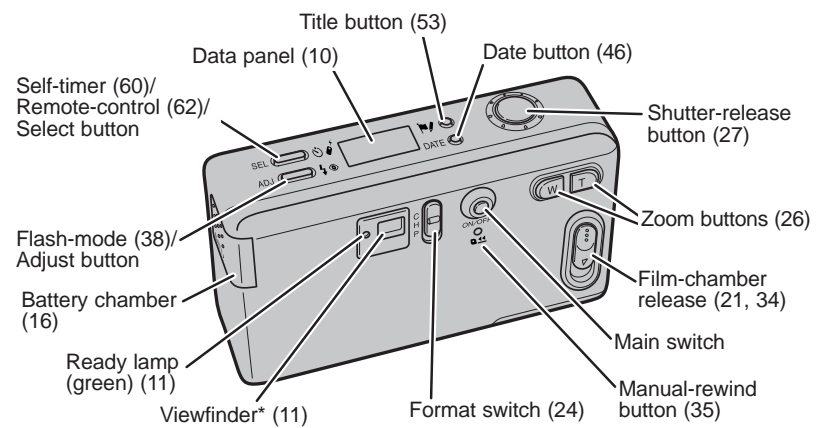

## NAMES OF PARTS

### DATA PANEL

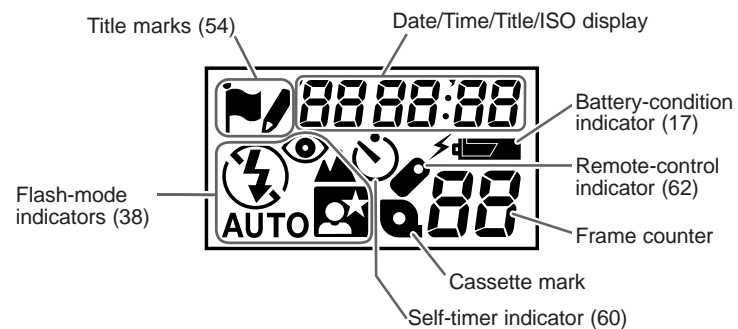

- Only the necessary indicators will appear in the data panel.

### VIEWFINDER

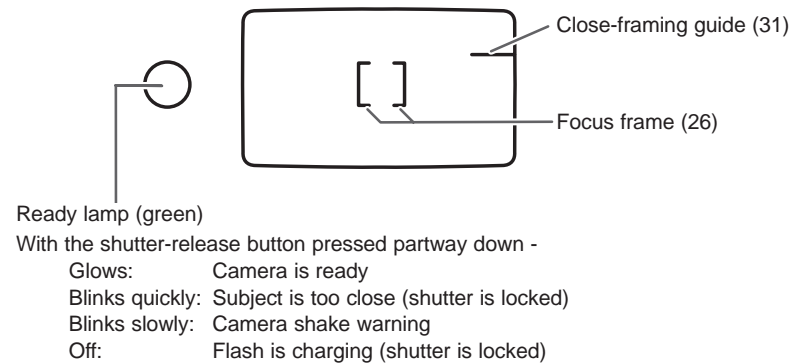

## QUICK OPERATIONS

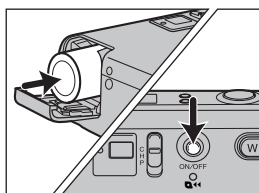

1. Insert the battery (p. 16) and press the main switch (p. 20).

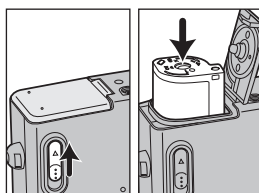

2. Insert the film (p. 21).

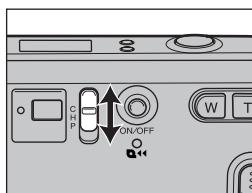

3. Select the print format (p. 24).

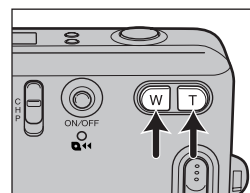

4. Frame the subject as desired (p. 26).

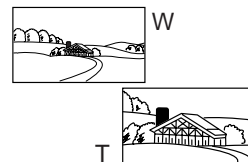

5. Center your subject in the focus frame (p. 26).

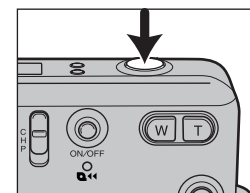

6. Press the shutter-release button all-the-way down to take the picture (p. 27).

## BASIC OPERATION

## ATTACHING THE STRAP

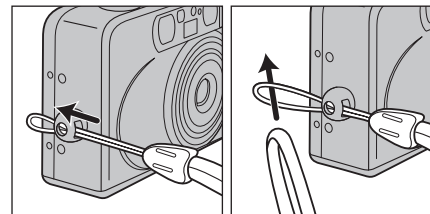

**Attach the strap as shown.**

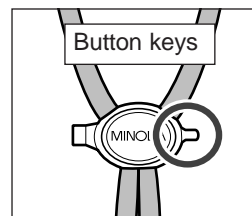

Button keys are included on the strap. Use the smaller key to push the manual-rewind button (p. 35).



## INSTALLING THE BATTERY

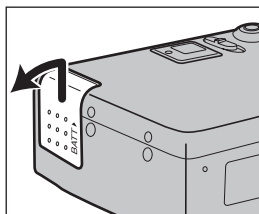

Your camera uses one 3-volt CR-2 lithium battery to supply power for all camera operations.

**1. Open the battery chamber as shown.**

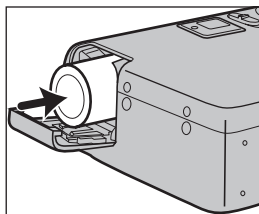

**2. Insert the battery into the chamber as indicated by the + and – marks.**

**3. Close the battery chamber.**

- After installing a new battery, reset the date and time (p. 48).

## CHECKING THE BATTERY

Each time the main switch is turned on, a symbol will appear in the data panel to indicate the power status of the battery.

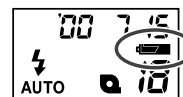

**Briefly appears. Power is sufficient for all camera operations.**

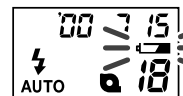

**Power is sufficient, but the battery must be replaced soon.**

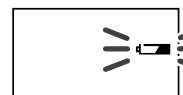

**Replace the battery. The shutter will lock until the battery is replaced.**

Continued on following page.

## CHECKING THE BATTERY

- If no display appears, replace the battery or check that it is inserted correctly.
- Auto Power Off: The data panel will shut off and the lens will retract if the camera is not operated for more than eight minutes. Press the main switch to restore power.
- Do not obstruct the lens while it is retracting.

## LOADING FILM

Your camera uses IX240 type film designed for use in Advanced Photo System cameras.

- Your camera's automatic transport system loads the film, sets the film speed, and advances the film after each exposure.
- Use film from ISO 25-3200. Your camera will automatically set the proper ISO.
- After loading, the film chamber cannot be opened until rewind has been initiated.
- DEP, Double Exposure Prevention, prevents the camera from accepting exposed film.
- This camera will only load film with the ● mark current.

Continued on following page.

## LOADING FILM

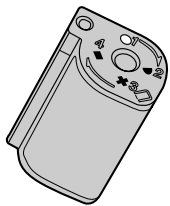

### Visual Exposure Indicators

- The current VEI has a white indicator behind it.

#### VEI MEANING

- UNEXPOSED
- ◐ PARTIALLY EXPOSED
- ✕ EXPOSED
- PROCESSED

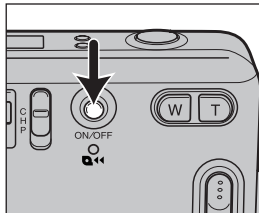

1. Press the main switch to turn the camera on.

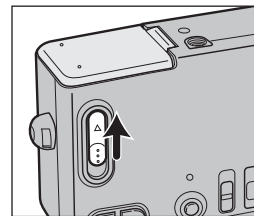

2. Turn the camera upside down, then slide the film-chamber release to open the film door.

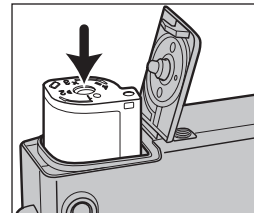

3. Insert the cassette into the film chamber with the VEI on top.
  - Do not use force when opening the film-chamber door.

Continued on following page.

## LOADING FILM

### 4. Press the film-chamber door closed until it clicks.

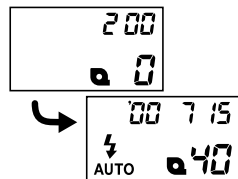

- The data panel will display the cassette mark and the film's ISO, then the number of frames remaining on the roll.

- After the film is loaded, the film chamber cannot be opened until the film has been rewound.
- Film can be loaded when the camera is on or off. If film is loaded with the camera off, all indicators in the data panel will disappear after the number of frames remaining is displayed.



If 0 blinks in the data panel, press the film-chamber release, open the chamber, then remove the film.

- If the film's current VEI is **X**, insert a new roll of film.
- If a partially exposed roll of film was loaded into this camera, the VEI has been changed from **▶** to **X**.
- If a processed roll of film was loaded into this camera, the VEI has been changed from **■** to **X**.
- If the film's current VEI is **●**, remove the film, remove and reinsert the battery, then reload the film. If the film will not load, contact the nearest authorized Minolta Service Facility.

## FULL-AUTO OPERATION

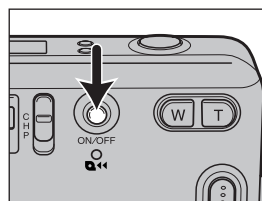

### 1. Press the main switch to turn the camera on.

- The camera is set for fully-automatic operation and the flash will fire automatically when necessary.

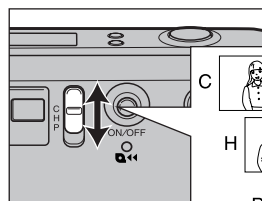

### 2. Select the print format.

- The viewfinder will change to match your selection.

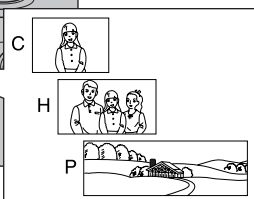

Hold the camera steady, making sure your fingers do not cover the flash, AF windows, or meter window. If you are taking a vertically framed picture, turn the camera so the flash is on top.

Correct

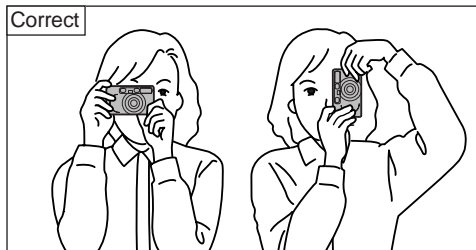

Incorrect

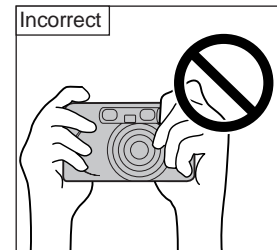

Continued on following page.

## FULL-AUTO OPERATION

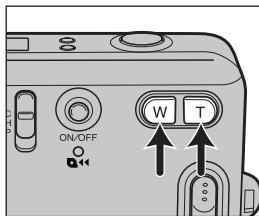

- 3. Looking through the viewfinder, frame the subject as desired. Press the W zoom button to zoom out. Press the T zoom button to zoom in.**

- Do not hold or obstruct the lens barrel.



- 4. Center your subject in the focus frame, then press the shutter-release button partway down.**

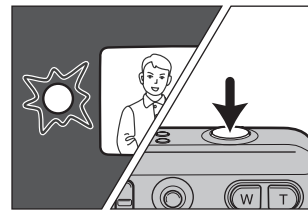
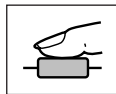

- 5. When the green ready lamp glows, press the shutter-release button all-the-way down to take the picture.**

- Press the shutter-release button with a slow steady squeeze - never a quick jab.

- If the ready lamp does not glow, the flash is not charged. Wait until it glows, then take the picture.
- If the ready lamp blinks quickly and the shutter is locked, your subject is too close (p. 30).
- Zoom position may change a little when the shutter-release button is pressed all-the-way down, but the picture will be taken with your first framing.
- Press the main switch and turn the camera off after use.

## FOCUS HOLD



Subjects outside the focus frame may not be in focus. Use focus hold to ensure accurate focusing.



**1. Center your subject in the focus frame.**

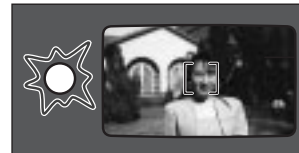

**2. Press and hold the shutter-release button partway down so the green ready lamp glows.**



**3. Without lifting your finger, recompose the picture and press the shutter-release button all-the-way down to take the picture.**

- Lift your finger from the shutter-release button to cancel focus hold.

## FOR CLOSER SUBJECTS

The minimum focus distance of this camera is 50cm (1.6ft.) when the print format is C or H.

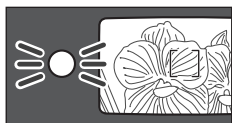

The green ready lamp will blink rapidly and the shutter will lock when you are closer than the minimum focus distance.

- When the print format is P, the minimum focus distance changes with the focal length; 50cm (1.6ft.) at W (24mm), 80cm (2.6ft.) at T (70mm), and middle distance for middle focal length position.
- If the subject is very close, the ready lamp may glow or blink slowly and shutter may be released, but the picture will not be in focus.

## CLOSE-FRAMING GUIDE

If your subject is closer than 1.3m (4.3ft.), parallax will occur and actual image and image seen through the viewfinder do not match. In this case, center your subject in the focus frame, press the shutter-release button partway down, and without lifting your finger, move the camera slightly upward and take the picture (page 28). The amount of parallax is the maximum when the zoom position is tele end and focusing distance is the minimum; in this case, top end is guided by the close-framing guide.

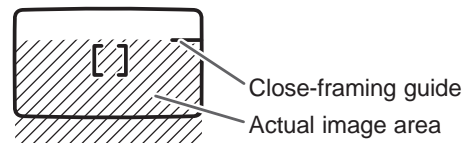

Continued on following page.



## FOR CLOSER SUBJECTS

Example:  
Zoom position: 70mm  
Focus distance: 50cm (1.6ft.)

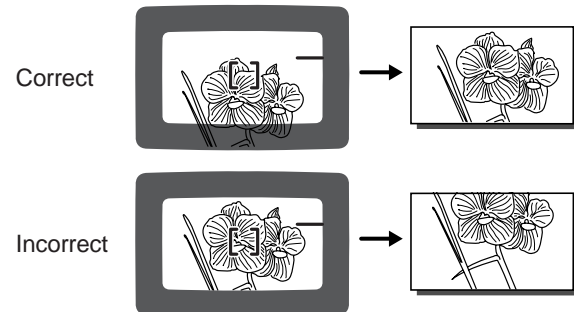

## SPECIAL FOCUSING SITUATIONS

Some scenes or subjects, like the examples below, are difficult for the autofocus system to lock on to. In these shooting situations, focus hold (p. 28) on another object with the same brightness and the same distance from you as your main subject, recompose, then press the shutter-release button all-the-way down to take the picture.

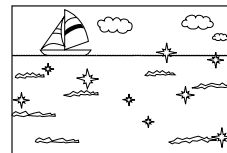

- Bright light sources such as the sun or neon lights
- Highly reflective surfaces such as water, mirrors, etc.
- Flame, fireworks, etc.
- Dark objects and surfaces with low reflectance
- Objects behind glass, bars, or other such as partitions



## REWINDING THE FILM

Your camera automatically rewinds the film into the cassette after the last exposure.



### 1. Wait for the film to completely rewind into the cassette.

- The frame counter will count down during rewind.
- 0 will appear in the frame counter and a small square with a dot will blink when rewind is complete.
- The lens will retract after rewind.

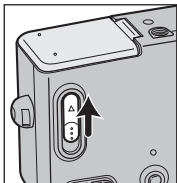

### 2. Turn the camera upside down, then slide the film-chamber release to open the film door.

### 3. Open the film chamber and remove the film.

- The film's VEI indicator will be X.

## MANUAL REWIND

Use manual rewind to rewind the film before the roll is finished.

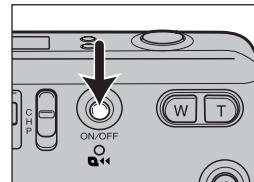

### 1. Press the main switch to turn the camera on.

- Rewind doesn't start if the camera is off.

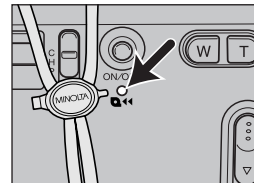

### 2. Gently press the manual-rewind button using the smaller button key on the strap.

### 3. Follow steps 1- 3 from automatic rewind.

## PROCESSING









For best results, take your film to a Certified Advanced Photo System photofinisher displaying this symbol (p. 68).

## USING THE BUILT-IN FLASH

When you turn the camera on, the built-in flash is set to Autoflash or Autoflash with red-eye reduction. The flash will fire automatically when necessary.

SETTING THE FLASH MODE

Autoflash mode  AUTO, Autoflash with red-eye reduction  AUTO, Fill-flash , Flash cancel , Night Portrait , or Landscape/Night View  can be selected.

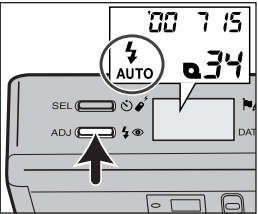

**Press the flash-mode button until the desired indicator appears in the data panel.**

- Flash modes remain selected after the picture is taken.

FLASH RANGE

The range of the built-in flash depends on the film speed and the focal length you are using. To ensure proper exposure, make sure your subject is positioned within the flash range.

Focal length Film speed	Wide 24 mm	Tele 70 mm
ISO 100	0.5 - 3.3 m 1.6 - 10.8 ft.	0.5 - 1.7 m 1.6 - 5.6 ft.
ISO 200	0.5 - 4.7 m 1.6 - 15.4 ft.	0.5 - 2.4 m 1.6 - 7.9 ft.
ISO 400	0.5 - 6.6 m 1.6 - 21.6 ft.	0.5 - 3.4 m 1.6 - 11.1 ft.

## RED-EYE REDUCTION

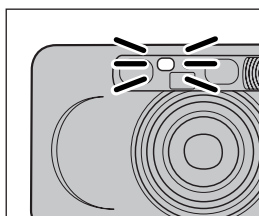

Use the built-in flash's red-eye reduction mode to reduce the red-eye effect when photographing people or animals at night or in low light situations. The red-eye reduction lamp on the front of the camera will blink to reduce the red-eye effect.

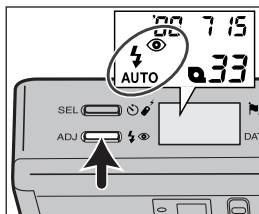

**Press the flash-mode button until the flash icon appears in the data panel.**

- The flash mode will remain selected after you turn the camera off.

## FILL FLASH

The flash will fire when the shutter is released regardless of lighting. Use fill flash to illuminate a backlit subject or to reduce harsh shadows on your subject's face.

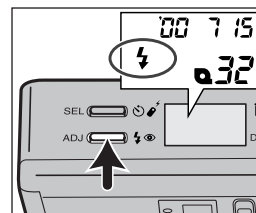

**Press the flash-mode button until the flash icon appears in the data panel.**

- When you turn the camera off, the flash mode will be reset to Autoflash or Autoflash with red-eye reduction, whichever mode was used last.

## FLASH CANCEL

The flash will not fire in this mode. Use flash cancel when you want to photograph subjects that are beyond the flash range or to capture the ambiance of existing light.

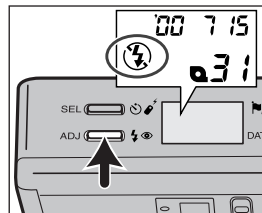

**Press the flash-mode button until the lightning bolt icon appears in the data panel.**

- Shutter speeds may be slow in this mode. Use of a tripod is recommended.
- When you turn the camera off, the flash mode will be reset to Autoflash or Autoflash with red-eye reduction, whichever mode was used last.

## NIGHT PORTRAIT

In this mode, the camera balances the flash and existing light exposure so you can take beautiful pictures of people at sunset or at night. The flash is set to fill flash with red-eye reduction.

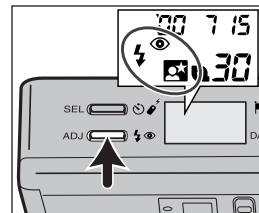

**Press the flash-mode button until the lightning bolt icon with a red eye symbol appears in the data panel.**

- The shutter speed may be slow. Use of a tripod is recommended.
- When you turn the camera off, the flash mode will be reset to Autoflash or Autoflash with red-eye reduction, whichever mode was used last.

## LANDSCAPE / NIGHT VIEW

The flash will not fire in this mode and the focus is set to infinity. It can be used to photograph night scenes, ensure sharp focus for landscapes and other distant subjects, and should be used when photographing through glass.

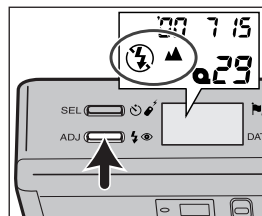

**Press the flash-mode button until  appears in the data panel.**

- The shutter speed may be slow. Use of a tripod is recommended.
- When you turn the camera off, the flash mode will be reset to Autoflash or Autoflash with red-eye reduction, whichever mode was used last.

## ADDITIONAL FEATURES

## DATE IMPRINTING

Your camera records date and time information on the film's magnetic strip that certified photofinishers can imprint in the front and back of your photographs (Date/Time Imprinting).

- Some labs can not imprint date and/or time information on the front of your photographs. See your photofinisher for a full description of available services.

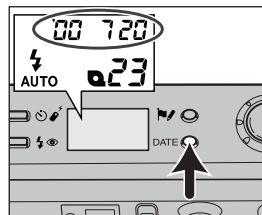

**Before taking the picture:**  
Press the date button until the data panel displays the format you want to see on the print.

The sequence is as follows:

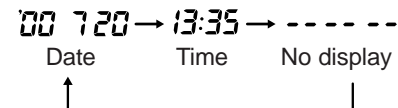

- When ----- is displayed in the data panel, no data will be printed on the front of the print, but the date and time of exposure will be imprinted on the back of the print.
- If the date/time display is blinking, date/time information will not be imprinted. The date/time information needs to be reset (p. 48).



## DATE IMPRINTING - Setting the date and time

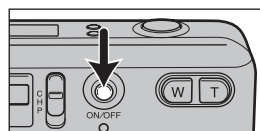

This camera has a quartz clock and automatic calendar through the year 2029.

**1. Press the main switch to turn the camera off.**

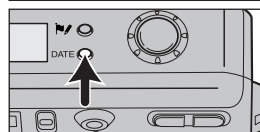

**2. Press the date button.**

- The date display will appear in the data panel.

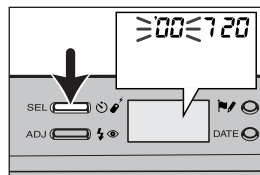

**3. Press the select button until the item you want to adjust blinks.**

- Each press of the select button causes the next item to blink. The sequence is:  
Year - Month - Day - Hour - Minute

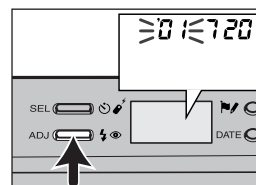

**4. Press the adjust button to change the blinking item.**

- Press and hold the adjust button to change the value rapidly.

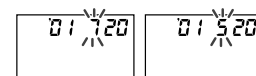

**5. Repeat steps 2 and 3 until all items in the date and time display are correct.**

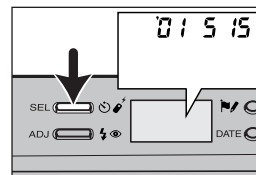

**6. Press the select button until all items stop blinking to set the updated information.**

- The data panel shows the date display for five seconds, then all the indicators will disappear.

## DATE IMPRINTING - Changing the format

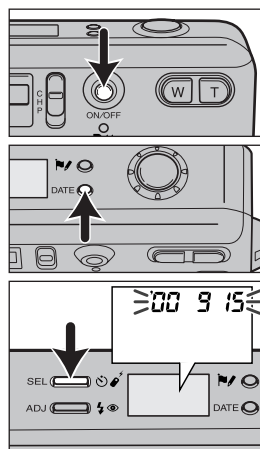

The order of year/month/day can be changed.

**1. Press the main switch to turn the camera off.**

**2. Press the date button.**

- The date display will appear in the data panel.

**3. Press and hold the select button for three seconds.**

- All the items start blinking.

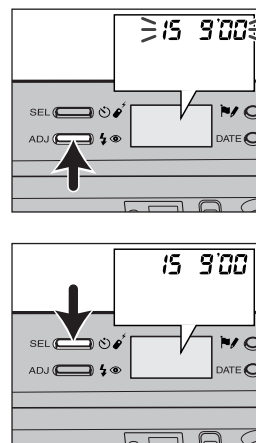

**4. Press the adjust button to change the display format.**

- The format sequences as follows:

00 9 15 → 9 15'00 → 15 9'00  
Y/M/D M/D/Y D/M/Y

**5. Press the select button to set the updated information.**

- The data panel shows the date display for five seconds, then all the indicators will disappear.
- The format will remain after replacing the battery.

## TITLE IMPRINTING

Three titles from the title list can be preset for use while taking pictures. Any one of the three preselected titles can be selected before the picture is taken (User Select Title Imprinting). When selected, the title will be recorded on the film's magnetic data strip. At certified Advanced Photo System labs, the selected title will be printed on the back of the print. See your photofinisher for details. Some labs may not be able to print the titles in all of the available languages.

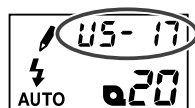

Titles are displayed in the data panel as a title code. Please refer to the Title List sheet for the titles available with this camera. When  appears in the data panel, the title will be recorded on the print.

## TITLE IMPRINTING - Preselecting titles

Three title codes have been set into memory. You can change one or all three title codes at any time.

- 1. Press the main switch to turn the camera off.**
- 2. Select the code for the title you want from the title list.**
- 3. Press the title button to display the title code you want to change.**

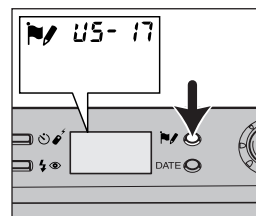

Continued on following page.

## TITLE IMPRINTING - Preselecting titles

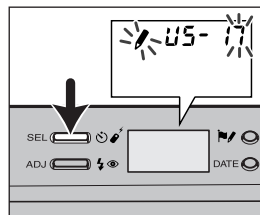

4. Press the select button, the last digit of the title code number will blink.

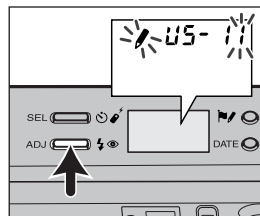

5. Press the adjust button to change its value.  
• Press and hold the adjust button to change the value rapidly.

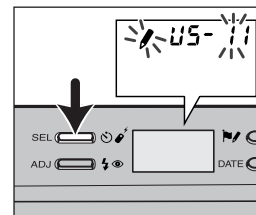

6. Press the select button to make the next digit blink, change its value using the adjust button.

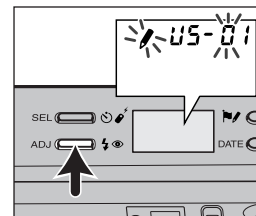

Continued on following page.

## TITLE IMPRINTING - Preselecting titles

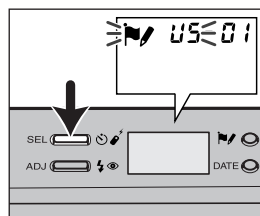

7. Press the select button to make the language code blink.

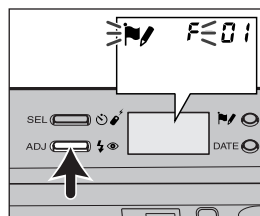

8. Press the adjust button to change the language code.

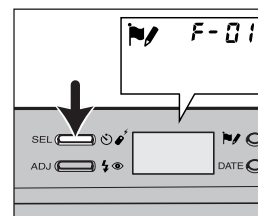

9. Press the select button until all items stop blinking to set the updated information.

- The data panel shows the updated title for eight minutes, then all the indicators will disappear.
- If you press the title button instead of select button, next title can be changed.

## TITLE IMPRINTING - Imprinting titles

Select the title for each frame before taking the picture.

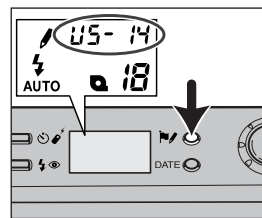

**1. Turn the camera on and press the title button to display the code for the title you want.**

- Each press of the title button changes the title code to the next selection.

*F-01* → *U5-14* → *U5-02* → *7 6'00*  
 ↑ Date/time



- Pressing any other button replaces the title code with date/time display.

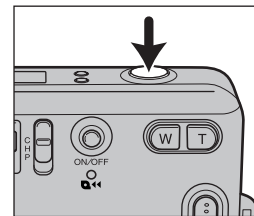

**2. Take the picture. The magnetic data is written and the selection is cancelled for the next frame.**

## SELF-TIMER

The self-timer delays release of the shutter for approximately 10 seconds after you press the shutter-release button.

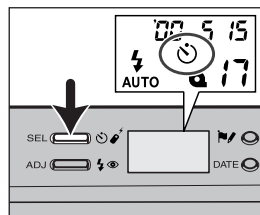

**1. Place the camera on a tripod, then press the self-timer button until  appears in the data panel.**



**2. Center your subject in the focus frame.**

- Use Focus Hold for off-center subjects (p. 28).

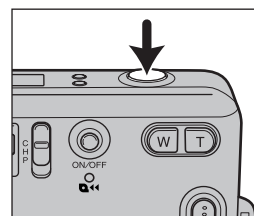

**3. Press the shutter-release button all-the-way down.**

-  will blink in the data panel during countdown.
- The self-timer lamp will blink slowly. Just before the shutter is released, the self-timer lamp will blink rapidly, then glow.
- To cancel the self-timer, press the self-timer button or turn the camera off.
- The self-timer is automatically cancelled after the shutter releases.
- Do not press the shutter-release button while standing in front of the camera.

## REMOTE CONTROL (Sold Separately)

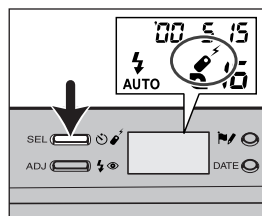
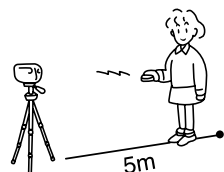



The IR Remote Control RC-3 (not included) allows remote camera operation from up to 5m (16 ft.) away.

- The distance may be shorter or the remote control may not operate with backlit subjects, under fluorescent light, or in extremely bright lighting conditions.

**1. Place the camera on a tripod, then press the remote-control button until  appears in the data panel.**

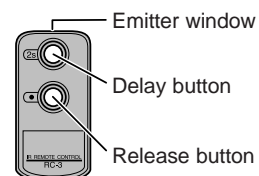
**2. Compose your picture.**



**3. Point the remote control with its emitter window toward the front of the camera and press  or 2s button.**

- Release (): the remote-control lamp will blink once, and the picture is taken immediately.
- Delay (2s): the remote-control lamp will blink for two seconds before the picture is taken.
- Remote control mode will remain selected after the picture is taken.
- To save power, the data panel will shut off and the lens will retract if the remote control is not operated for more than eight minutes.



## REMOTE CONTROL (Sold Separately)

### FOCUS HOLD IN REMOTE CONTROL MODE

1. Set the camera to remote control mode.



2. Center your subject in the focus frame, then press the shutter-release button partway down so the green ready lamp glows.

- Focus is locked.
- Focus will be reset if you press the shutter-release button partway down again.



3. Lift your finger from the shutter-release button, then recompose the picture.

4. Point the remote toward the front of the camera and press • or 2s.

- The green ready lamp keeps glowing and the focus will remain locked after taking a picture.
- Reset the remote-control mode or press the zoom button to cancel focus hold.

Continued on following page.

#### REMOTE CONTROL (Sold Separately)

##### **CHANGING THE BATTERY**

The remote control uses a 3V lithium battery (CR2032). When pressing the remote-control buttons does not release the shutter, the battery must be replaced. A new battery should be sufficient for approximately ten years of operation.

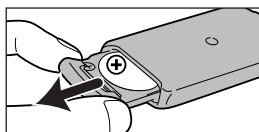

**1. Pull out the battery chamber and remove the old battery.**

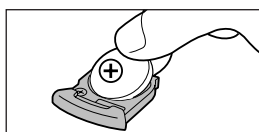

**2. Insert a new battery into the battery chamber with its plus side up.**  
**3. Slide the battery chamber back into the remote control.**

## APPENDIX

## LAB SERVICES



To receive the best possible prints, take your film to a photolab displaying the Certified Advanced Photo System logo. Photofinishers displaying this logo have been certified according to Advanced Photo System guidelines.

Certified photolabs will be able to provide the following five services.

### 1. CHP - Print Format

Your film will be printed according to the format set when the picture was taken.

### 2. Date and Title Imprinting

The date, time, and selected title are printed on the back of the picture in the chosen format.

### 3. PQI - Print Quality Improvement

The lab will compensate (or not compensate) printing according to the data recorded on the magnetic data strips.

### 4. Film is returned in the cassette.

To keep the film dust free and aid in organization, film is returned in its original film cassette. The VEI will be set to ■ to prevent accidental loading.

### 5. Index Print

An index print showing a numbered image of each frame is included with your returned order.

### Reprints

Images are always captured in the H format (High-Vision). You can select any of the three formats when ordering reprints.

## CARING FOR YOUR CAMERA

### OPERATING TEMPERATURE AND CONDITIONS

- This camera is designed for use from  $-10$  to  $40^{\circ}\text{C}$  ( $14$  to  $104^{\circ}\text{F}$ ).
- Never leave your camera where it may be subjected to extreme temperatures such as in the glove compartment of a car.
- At colder temperatures, the data panel response time will be slow. At higher temperatures, the display will temporarily darken, but will restore when the temperature normalizes.
- Never subject the camera to extreme humidity.

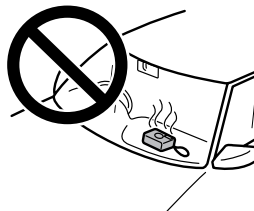

- To prevent condensation from forming, place the camera in a sealed plastic bag when bringing it from the cold environment into a warm environment. Allow it to come to room temperature before removing it from the bag.
- When photographing in cold weather, it is recommend that you keep the camera and spare batteries inside your coat to keep them warm when you are not shooting. Cold batteries will regain some of their charge when they warm up.
- This camera is not water proof, dust-proof, or sand-proof; take care when using it at the beach or near water. Costly or irreparable damage may occur.

## CARING FOR YOUR CAMERA

### CLEANING

- Keep the AF and Meter windows clean or the focus and/or exposure may not be accurate.
- If the camera body is dirty, gently wipe it clean with a soft, clean, dry cloth.
- To clean the lens surface, first brush away any dust or sand then, if necessary, moisten a lens tissue with lens cleaning fluid and gently wipe the lens in a circular motion, starting from the center.
- Never place lens fluid directly on the lens.
- Never touch the lens surface with your fingers.
- Never use alcohol or solvents to clean the camera.

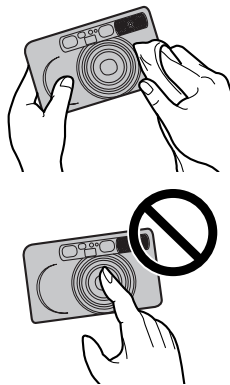

### STORAGE

When storing the camera for extended periods, please follow these guidelines:

- Store the camera in a cool, dry, well-ventilated area away from dust and chemicals. For very long periods, place the camera in an airtight container with a silica gel drying agent.
- Before using after prolonged storage, always check the camera's operation to make sure it is functioning properly.

Continued on following page.

## CARING FOR YOUR CAMERA

### QUESTIONS AND SERVICE

---

- If you have questions about your camera, contact your local camera dealer or write to the Minolta distributor in your area.
- If the camera is damaged or the rewind motor does not operate, do not open the film chamber or forcefully remove the cassette. Contact an authorized Minolta Service Facility.
- Before shipping your camera for repair, please contact an authorized Minolta Service Facility for details.

### BEFORE IMOPRTANT EVENTS

---

- Check camera operation carefully or take test photographs.
- Minolta is not responsible for any loss which may occur due to an equipment malfunction.

### FILM CASSETTE WARNING

---

The film used in Advanced Photo System cameras stores some data magnetically. Do not place the cassette on or near anything that creates a magnetic field, such as a television or stereo speakers.

### CAMERA ERROR

---

If all the indicators in the data panel blink or the data panel is blank and the camera will not function with a fresh battery, remove and reinsert the battery. If normal operation does not resume or the camera malfunctions repeatedly, contact an authorized Minolta Service Facility.

## TECHNICAL DETAILS

<b>Camera Type:</b>	IX240 Lens Shutter Camera
<b>Lens:</b>	24 - 70mm f/5.7 - 11.2 lens (approx. equivalent to 30 - 88mm in 35mm format)
<b>Metering:</b>	Center-weighted metering Range (ISO 200): 24mm: EV 4 - 16, 70mm: EV 4 - 18
<b>Shutter Speed:</b>	7.8 - 1/380 sec.
<b>Film Speed:</b>	Setting: Automatic for DX-coded film Non-DX coded film set to ISO 100 Range: ISO 25 - 3200
<b>Viewfinder:</b>	Magnification: 0.32X - 0.87X Diopter: -1 diopter Field of View (H format): 85% (for subject at 3m)
<b>Flash:</b>	Recycling time: approx. 5.0 sec.

<b>Battery:</b>	One CR-2 3V lithium battery Battery performance: Approx. 12 rolls (Based on Minolta's standard test method using 25 exposure rolls with the flash for 50% of the exposures)
<b>Dimensions:</b>	99 x 59.5 x 29.5 mm (3.9 x 2.3 x 1.2 in.)
<b>Weight:</b>	145 g (5.1 oz.) without battery

Specifications are based on the latest information available at the time of printing and are subject to change without notice.

This device complies with Part 15 of the FCC Rules. Operation is subject to the following two conditions: (1) This device may not cause harmful interference, and (2) this device must accept any interference received, including interference that may cause undesired operation. Changes or modifications not approved by the party responsible for compliance could void the user's authority to operate the equipment. This equipment has been tested and found to comply with the limits for a Class B digital device, pursuant to Part 15 of the FCC Rules. These limits are designed to provide reasonable protection against harmful interference in a residential installation. This equipment generates, uses and can radiate radio frequency energy and, if not installed and used in accordance with the instructions, may cause harmful interference to radio communications. However, there is no guarantee that interference will not occur in a particular installation. If this equipment does cause harmful interference to radio or television reception, which can be determined by turning the equipment off and on, the user is encouraged to try to correct the interference by one or more of the following measures:

- Reorient or relocate the receiving antenna.

- Increase the separation between the equipment and the receiver.
- Connect the equipment to an outlet on a circuit different from that to which the receiver is connected.
- Consult the dealer or an experienced radio/TV technician for help.

This Class B digital apparatus complies with Canadian ICES-003.



This mark on the bottom of your camera is there to inform you that this camera meets the requirements of the EU (European Union) concerning interference causing equipment regulations. CE stands for Conformité Européenne (European Conformity).



<b>Minolta Co., Ltd.</b>	<b>3-13, 2-Chome, Azuchi-Machi, Chuo-Ku, Osaka 541-8556, Japan</b>
<b>Minolta Europe GmbH</b>	Kurt-Fischer-Strasse 50, D-22923 Ahrensburg, Germany
<b>Minolta France S.A.</b>	365 Route de Saint-Germain, F-78420 Carrières-Sur-Seine, France
<b>Minolta (UK) Limited</b>	7 Tanners Drive, Blakelands, Milton Keynes, MK14 5BU, England
<b>Minolta Austria Ges. m.b.H.</b>	Amalienstrasse 59-61, A-1131 Wien, Austria
<b>Minolta Camera Benelux B.V.</b>	Zonnebaan 39, P.O. Box 6000, NL-3600 HA Maarssen, The Netherlands
<b>Belgium Branch</b>	Prins Boudewijnlaan 1, B-2550 Kontich, Belgium
<b>Minolta (Schweiz) AG</b>	Riedstrasse 6, CH-8953 Dietikon, Switzerland
<b>Minolta Svenska AB</b>	Albygatan 114, S-171 54 Solna, Sweden
<b>Finland Branch</b>	Niittykatu 6 PL 37, SF-02201 Espoo, Finland
<b>Minolta Portugal Limitada</b>	Av. do Brasil 33-A, P-1700 Lisboa, Portugal
<b>Minolta Corporation</b>	
<b>Head Office</b>	101 Williams Drive, Ramsey, New Jersey 07446, U.S.A.
<b>Los Angeles Branch</b>	11150 Hope Street Cypress, CA 90630, U.S.A.
<b>Minolta Canada Inc.</b>	
<b>Head Office</b>	369 Britannia Road East, Mississauga, Ontario L4Z 2H5, Canada
<b>Vancouver Branch</b>	230-3771 Jacombs Road, Richmond, B.C. V6V 2L9, Canada
<b>Minolta Hong Kong Limited</b>	Room 208, 2/F, Eastern Center, 1065 King's Road, Quarry Bay, Hong Kong
<b>Minolta Singapore (Pte) Ltd.</b>	10, Teban Gardens Crescent, Singapore 608923
<b>Shanghai Minolta Optical Products Co., Ltd.</b>	368 Minolta Road, Songjiang, Shanghai, China