

HOW TO USE MTX

USER MANUAL

Forget " Pair To Talk "

Enjoy " Open To Talk "

Bluetooth Intercom Headset

LEXIN

V 1.0



Table of Contents

P01 [Download User Manual Online](#)

P02 [Watch Instruction Video Online](#)

P03 [Features](#)

P04 [Package Contents](#)

P05 [Installation Instructions](#)

P08 [General Operation Instructions](#)

P17 [Maintenance & Certification](#)



Download User Manual Online

English

★- For Online User Manual in English, Spanish, German, Italian, French, Japanese, ... Visit **www.lexin-moto.com**, Go to Support - User Manual, and select "MTX".

Français

★- Pour obtenir un mode d'emploi en Anglais, Espagnol, Allemand, Italien, Français Japonais en ligne... Accédez à **www.lexin-moto.com** et trouvez-les sur Support - User Manual, puis sélectionnez "MTX".

Italiano

★- Per il Manuale Utente Online in Inglese, Spagnolo, Tedesco, Italiano, Francese Giapponese ... Visita **www.lexin-moto.com**, vai su Support - User Manual, e seleziona "MTX".

Deutsch

★- Online Bedienungsanweisung auf Englisch, Spanisch, Deutsch Italienisch Französisch, Japanisch usw, besuchen Sie **www.lexin-moto.com** gehen Sie zur Unterstützung - Bedienungsanweisung, dann wählen Sie "MTX".

Español

★- Para el Manual del Usuario en Línea en Inglés, Español, Alemán Italiano, Francés Japonés... Visite **www.lexin-moto.com**, vaya al Soporte - Manual de Usuario, y seleccione "MTX".



Watch Instruction Video Online

English

★★ - Subscribe to our Youtube channel **@lexinmoto**, and find "MTX" Instruction videos.

Français

★★ - Suivez notre chaîne Youtube **@lexinmoto**, Et trouvez les vidéos "MTX" Instruction.

Italiano

★★ - Iscriviti al nostro canale Youtube **@lexinmoto**, e trova i video di "MTX" Instruction.

Deutsch

★★ - Abonnieren Sie unseren YouTube-Kanal **@lexinmoto** und suchen Sie das Video "MTX" Instruction.

Español

★★ - Regístrese nuestro Youtube channel **@lexinmoto**, y encuentre videos "MTX" Instruction Finden Sie das Video " MTX " Instruction.



Features

Thank you for choosing the MTX Motorcycle MESH intercom.

- Mesh intercom conference
Open to talk, easy and friendly use
- MESH 3.0
- Mesh intercom up to 24 people
within 2km range
- USB-C quick charge equipped
- Hands-free calling
- Play music
- Built-in CVC/DSP noise reduction
- Bluetooth 5.3
- Universal pairing with most
Bluetooth Intercom (Bluetooth connection)
- Connect to GPS Navigation
- Siri and other voice assistants
- Music sharing
- Parallel Audio- intercom and stream
music or GPS navigation simultaneously

*** The MTX supports LEXIN MESH 3.0 group intercom.**

Users can use the open-to-talk intercom in public and private domains through the settings of 10 different channels, with no need to pair in advance.

The MTX is compliant with Bluetooth Specification V5.3 supporting the following profiles:

Headset Profile (HSP), Hands-Free Profile (HFP), and Advanced Audio Distribution Profile (A2DP).

It supports universal pairing with almost all Bluetooth headsets on the market.

Headset

The MTX comes with a Lexin pulse high-definition stereo headset and an outstanding built-in CVC /DSP intelligent noise reduction microphone.

These designs are suitable for most open, face-off, full-face, and off-road helmets.

Battery

The MTX features an 800 mAh battery which can provide the intercom device with 18 hours of music or 13 hours of intercom with over one week of standby time.

WARNING

PLEASE CHECK ALL LOCAL LAWS AND REGULATIONS REGARDING THE USE OF IN-HELMET SPEAKERS WHILE OPERATING MOTORIZED VEHICLES.



Package Contents

- MTX Main Unit
- Speakers
- Boom/Button Microphones
- Boom Microphone Holder
- Mounting Bracket
- Clamp Plate
- Add on Mounting Pad
- 3M Tape Bracket
- User Manual/Quick Start Guide
- USB C Cable
- Speaker Pad
- Allen Wrench & Screws *4
- Rubber Pad for Clamp Plate *2
- Dismounting Stick

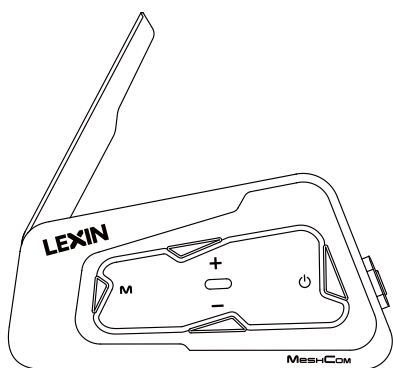

MTX Main Unit

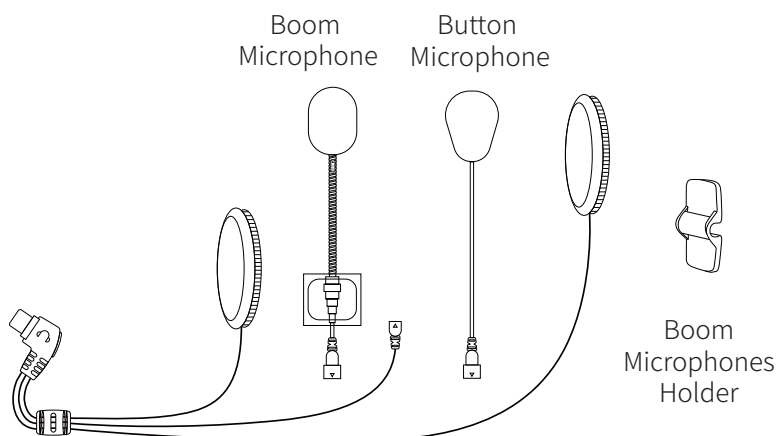

Speakers

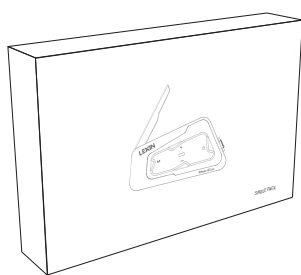
Boom
Microphones
Holder

Packaging



User Manual



Quick Start Guide

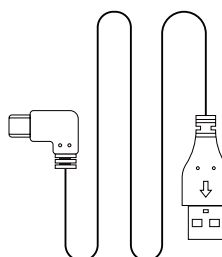

USB C Cable

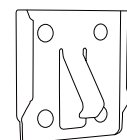

3M Tape Bracket

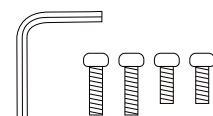
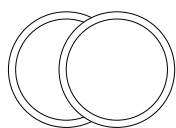
Allen Wrench &
Screws *4

Speaker Pad

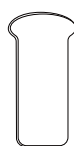
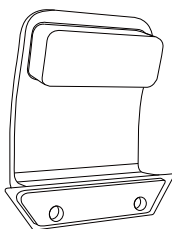
Dismounting
Stick

Clamp Plate

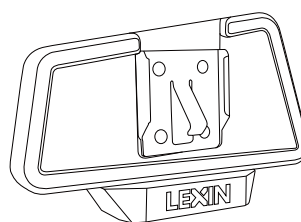

Mounting Bracket

Rubber Pad for
Clamp Plate *2Add on
Mounting Pad

Installation Instructions

Installing Bracket for MTX to Helmet

① With Screws:

Mount the bracket between the internal padding and the external shell of the helmet. Tighten the two screws between the bracket and Mounting pad by using the included Allen wrench.

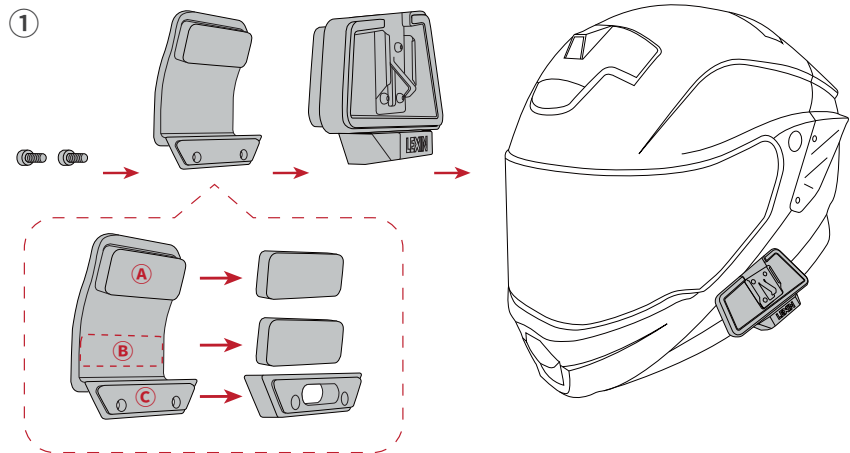

Note: According to the thickness of your helmet shell to add 0-2 pcs rubber pads on the recommended position ① and ②. If you need to add the plastic mounting pad on position ③, please use the two longer screws. If not, please use two shorter screws.

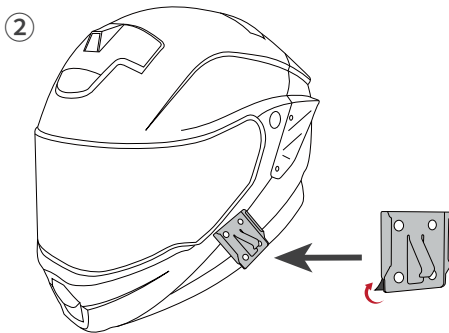

② Install by 3M Tape mounting bracket

You can also use the 3M mounting bracket instead of the alloy mounting bracket. First, tear off the protective paper on the back of the 3M tape, then stick the 3M mounting bracket to a suitable position on the left side of the helmet. Press for 15 seconds to allow the glue 24 hours to dry.

Note: Even though the 3M Tape bracket is provided for convenience, LEXIN recommends using the bracket mounting. The 3M Tape bracket is an option that you may use at your own risk and responsibility. LEXIN does not assume any responsibility for its use.



Mounting/removing the MTX Unit to Bracket

Mount the MTX main unit on the bracket. Slide the main unit down onto the bracket until it clicks firmly into the bottom portion of the bracket.

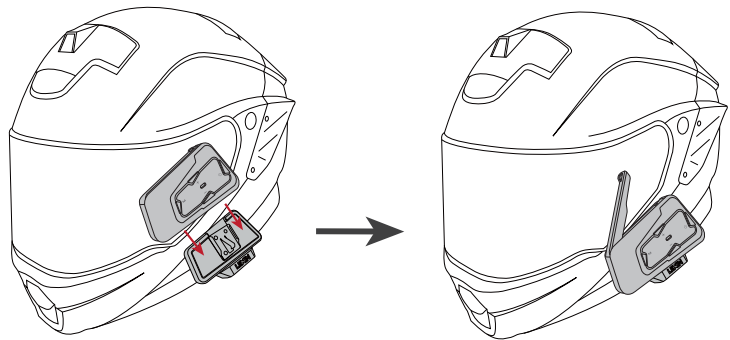

To remove the main unit from the bracket, use the Dismounting Stick to insert it between MTX unit and the mounting bracket, then push the MTX main unit up from the bracket.

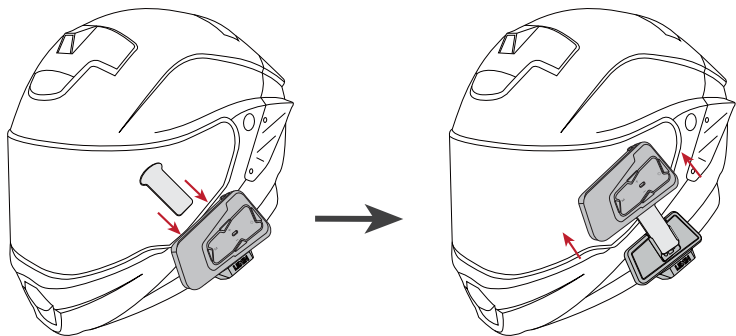

Installing Speakers

Note: The speaker with the shorter wire is for the left ear, and the speaker with the longer wire is for the right ear.

Step 1: Peel off the speaker 3M tape, stick it into the helmet's inner padding.

Step 2: Push the speakers firmly against the velcro pads. If the helmet has deep ear pockets, you can use the provided spacers to closer the speakers.

Step 3: Hide the wires between the helmet liner and shell.

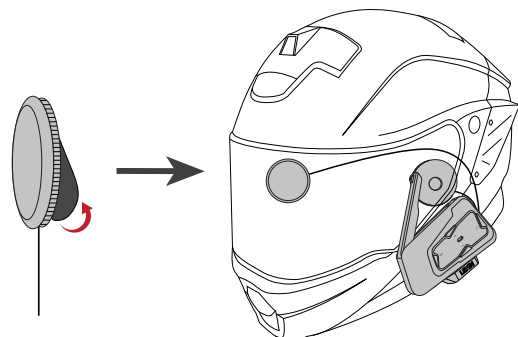



Note: We are equipped with extra speaker pads, there may be some helmets with deep speaker pockets, so you can add the extra speaker pads to increase the thickness of the speakers to make the speakers closer to your ears.

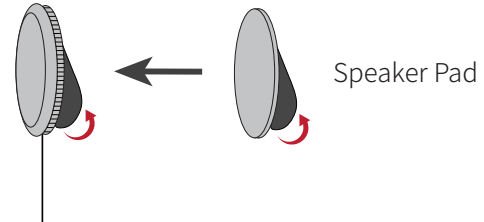

Installing Microphone

Note: The button and boom microphones can be interchanged between full-face or open-face helmets. Choosing between the two is based on your preference and what fits best in the helmet(s).

Full-face Helmet/Button Microphone

Step 1: Locate an area in the center of the mouth section of the helmet to install and adhere half of the microphone velcro pad.

Step 2: Attach the button microphone to the attached velcro.

Step 3: Connect it to the headphone connector from the left.

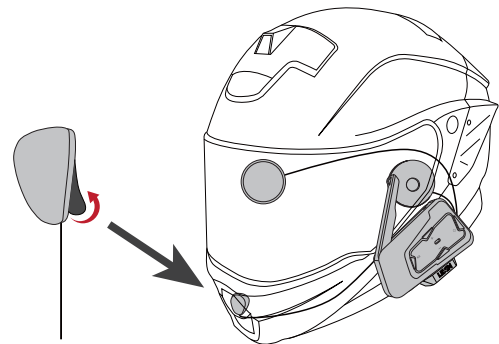

Open Face Helmet/Boom Microphone

Step 1: Adhere one half of the velcro pad to the base of the microphone and the other half to the inside of the helmet underpadding.

Step 2: Adjust the microphone's direction so that the triangular mark on the microphone point towards your mouth.

Step 3: Use the boom microphone holder for additional support to the microphone if necessary.

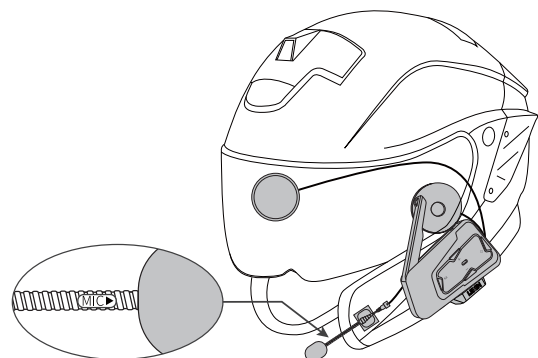



General Operation Instructions

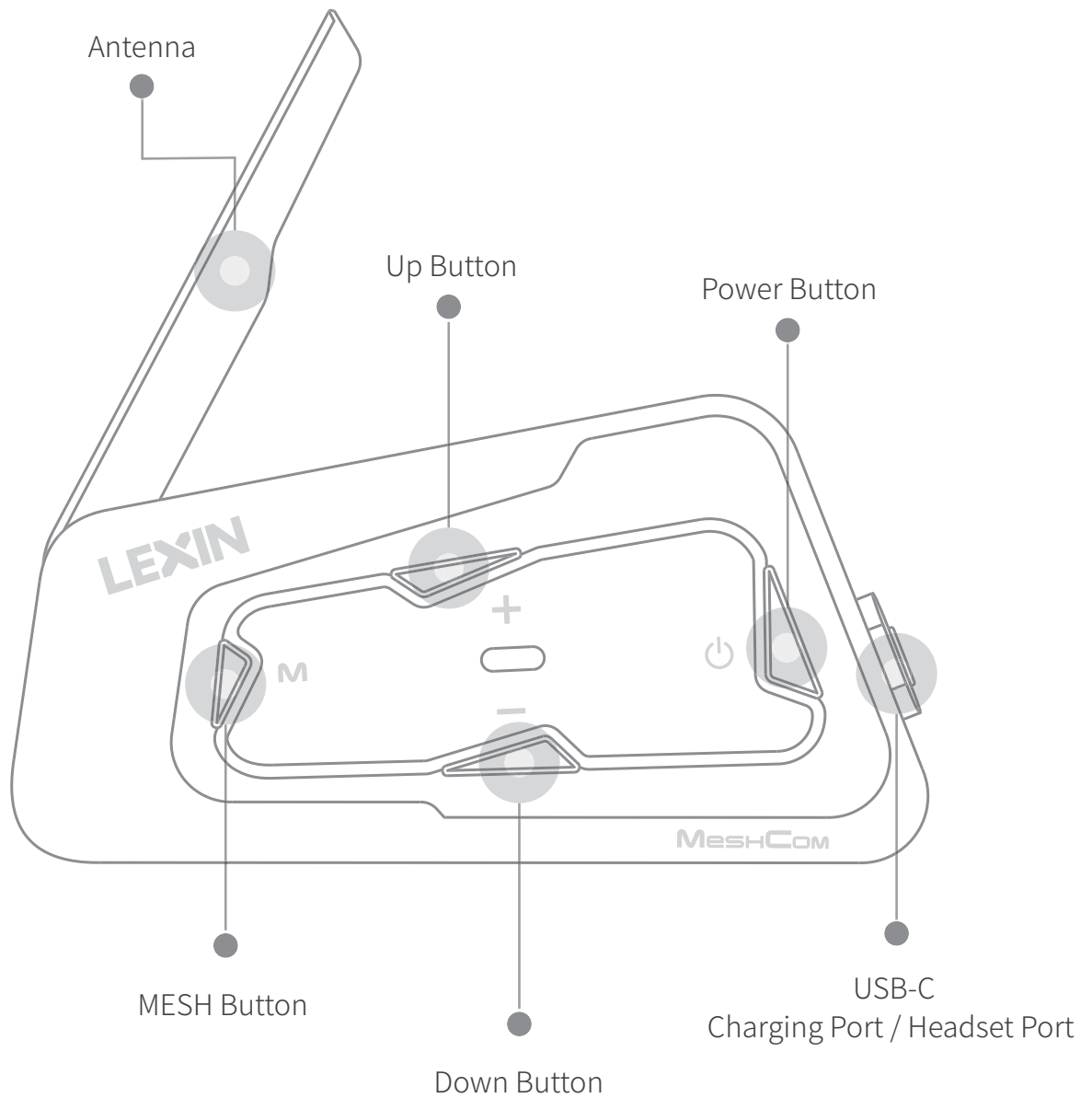



Powering On/Off

Power On: Press and hold the power button for two second.

The LED will blink blue. Voice report "Power on" and the current battery life.

Power Off: Press and hold the power button for two second.

The LED will blink red. Voice report "Power Off."

Battery

Battery Charging: Plug the USB-C cable into the USB-C port to charge by any DC 5V power supply, such as a mobile phone charger, computer, laptop or power bank, Etc.

The LED turns red while charging and then turns blue when the main unit is fully charged. It takes about 2.5 hours to be completely charged.

The battery will report one of five levels:

100%, 80%, 50%, 30%, LOW.

Note: When the battery capacity is below 25%, the device will notify you every fifteen minutes until the device powers off. It indicates that around 1-1.5h of use remaining.

External Mesh Intercom Antenna

Slightly pull out the mesh intercom antenna to unfold it.

Pairing MTX With Bluetooth Devices

Note: A single MTX can connect with up to two devices. (Two mobile phones or one mobile phone and one other Bluetooth device) It can automatically connect to your last paired device when Bluetooth is enabled or in standby mode.

If the device is not automatically connected with your last phone, please press the power button to reconnect it.

Pairing Phone

Step 1: With the unit powered off, press and hold the power button for five seconds until the led flashes red and blue , into pairing mode.

Step 2: Go to Bluetooth settings on your phone, Select "LEXIN MTX".

Some mobile phones may need a PIN. Enter "0000" for the PIN if required.

Step 3: Please confirm on your phone if the pairing is complete.



Note: The LED will blink blue on the MTX device, voice prompt will report "connected," which indicates the connection is complete.

Reconnect with the last paired phone.

When the device is disconnected from the phone, press the power button to reconnect it.

Pairing Bluetooth GPS Navigation

Step 1: While powered off, press and hold the Power Button for about five seconds until the LED light flashes blue and red alternately, the device report "pairing" to enter pairing mode. when the pairing is completed, the indicator light will blink blue, and the voice prompt will report "Bluetooth connected".

Step 2: Follow pairing instructions for your specific GPS Navigation to connect to MTX.

Note: You will be able to listen to Bluetooth voice instructions from Bluetooth GPS navigation once paired.

Phone Calls

Answer phone call: Click the power button to answer a phone call.

Reject phone call: Double click the power button to reject the incoming phone call.

End Call: Click the power button to end the call.

Answer the second call: When the phone is in a call, a second call comes in. Double click the power button to answer.

Reject the second call: When the phone is in a call, a second call comes in, double click the up button to reject.

Voice Dial: While the device is paired with your phone and in standby mode, double click the power button to activate Siri or S-Voice. Speak the name from your phone list to dial.

Music And Volume Control

Volume Control

Click the up/down button to adjust the volume.

Click and hold it to adjust the volume continuously.



You can hear a beep sound which indicates the volume has reached the maximum or minimum.

Parallel Audio

MTX can hear two audio sources simultaneously. For example, in mesh intercom talk while listening to music or GPS, or hear GPS while hearing to music.

Adjust volume under parallel audio:

Click the up/down button to adjust the mesh intercom volume while using the parallel audio function.

Click and hold the up/down button to adjust the Music /GPS volume while using the parallel audio function.

Note: Parallel Audio functions can only be used with mesh intercom, playing music, and GPS navigation.

Music Play/Pause

With the unit powered on, click the Power Button to play a song.

While playing a song, click the Power Button to pause.

Change Song

While playing a song, double click the Up Button for the next song, double click the Down Button for the previous song.

Note: When playing or streaming music, you need to set the mobile device volume simultaneously to adjust the volume.

Music Sharing

A MTX device (A) is playing music and can share music with another MTX device (B).

Step 1: When device A is playing music, double click the Mesh button on device A to enter music sharing mode, and the led flashes red and blue.

Step 2: When device B is in standby mode. double click the Mesh button on device B to search and connect to device A. voice prompt will report pairing successful on device B, and it will play the same music automatically.

Stop Music Sharing

To quit music sharing mode, double click the Mesh button on either device.



MESH Intercom OPEN-TO-TALK

Mesh Intercom On:

When the mesh intercom is enabled, the MTX will automatically connect to nearby MTX users and allow them to talk to each other by pressing the mesh button. Simply open to talking to your folks.
The default channel is channel one.

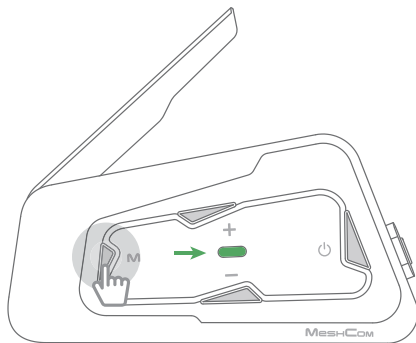

Click the Mesh Button to start mesh intercom, the led will light up green, and the voice prompt will report "Mesh on" and current channel

Mesh Intercom Off:

In mesh intercom conference, click the Mesh Button to exit mesh intercom, the led will flash blue, and the voice prompt will report "Mesh off."

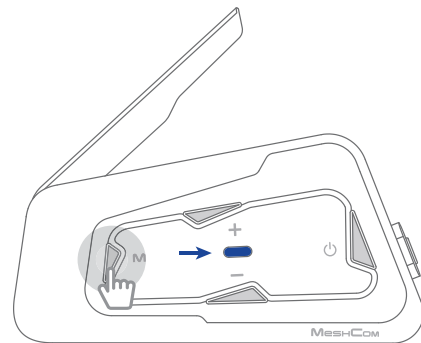

Click the Mesh Button to quit a mesh section

Mesh Channel Setting:

If we want to have another mesh communication group, we can change to another private channel, select from channel 2-10.

Step 1: In standby mode, press and hold the Mesh Button for two seconds to enter channel scanning mode, voice prompt will report "scanning channel."

Step 2: Click the Mesh Button to select channel 1-channel 10, Voice prompt will report channel 1 - channel 10.

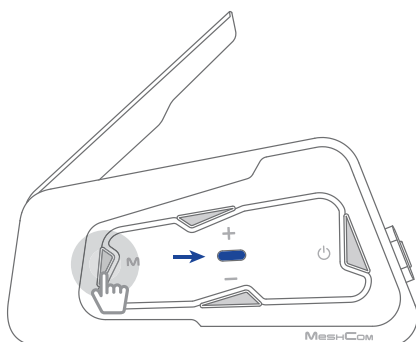

Press and hold the Mesh Button for two seconds into channel setting mode, voice prompt will report "scanning channel".

(Step 1)

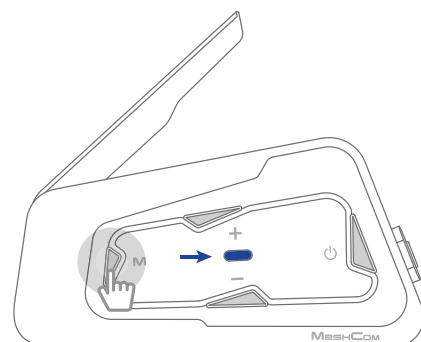

Click the Mesh Button to select channel 1-channel 10, Voice prompt will report channel 1 - channel 10.

(Step 2)



Step 3: Press and hold the Mesh Button for two seconds until it reports "saved" to save the current channel.

If there is no operation for ten seconds, It will automatically exit the channel setting.

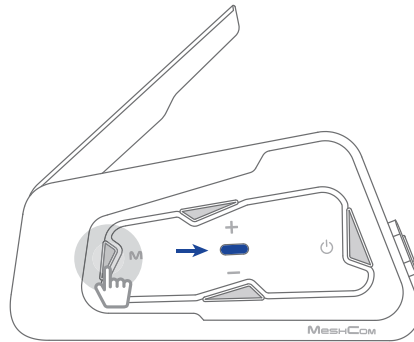

Press and hold the Mesh Button for two seconds, save the current channel, voice prompt will report "saved"

(Step 3)

Note: Next time you turn on the mesh intercom, it will automatically enter the last saved channel.

Reset The Mesh Intercom:

While in standby mode, press and hold the Mesh Button for eight seconds, the indicator light flashes red, and you will hear a beep sound. Mesh group intercom channel will be reset to channel one.

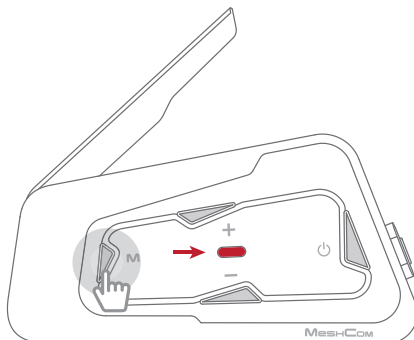

Press and hold the Mesh Button for eight seconds, the indicator light flashes red, and you will hear a beep sound. Mesh group intercom channel will be reset to channel one.



Bluetooth Intercom Paring & Connection

MTX bluetooth headsets are able to do full-duplex Bluetooth intercom talk.

Function priority: (The MTX operates in the following order of priority)

1. Mobile phone
2. Intercom talk
3. Music/FM radio/GPS

Note: In bluetooth intercom mode a lower-priority function is always interrupted by a higher-priority function. For example, stereo music can be interrupted by an intercom call, intercom talk can be interrupted by an incoming phone call.

The following is an example of MTX pairing with B4FM, The method of MTX pairing with Lexin other models like B4FM, FT4PRO, G16, GTX...are the Same: In standby mode, press and hold the power button and down button for two seconds until the led quick flashes red and blue. Voice prompt will report "pairing".

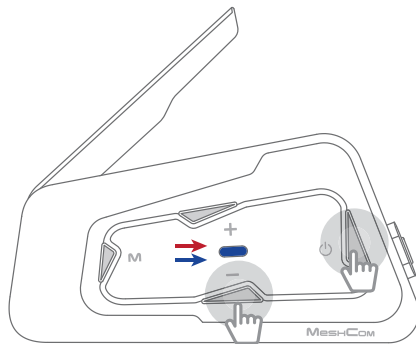

press and hold the power button and down button for two seconds until the led quick flashes red and blue.

Pairing
⋈

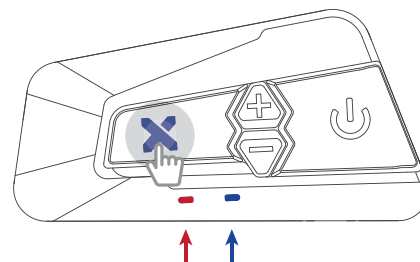

Press and hold the Intercom Button for two seconds until the led quick flashes red and blue.

Pairing successful: Then the Two devices will search and pair automatically, Once the pairing is completed, the LED will blink blue slowly on both two units. The voice prompt will report "pairing successful".

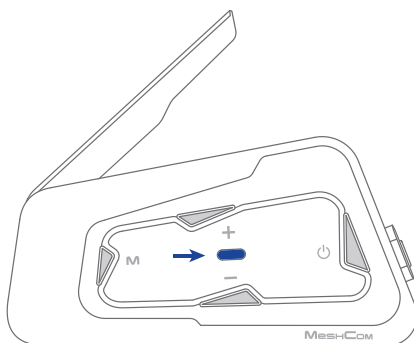

LED flashes blue

Paired
⋈

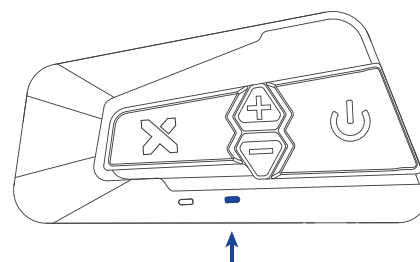

LED flashes blue



Start The Intercom Talk: Once the pairing is successful, click the power button and mesh button on MTX to start an intercom talk.

Once the pairing is successful, click the intercom button on B4FM to start an intercom talk.

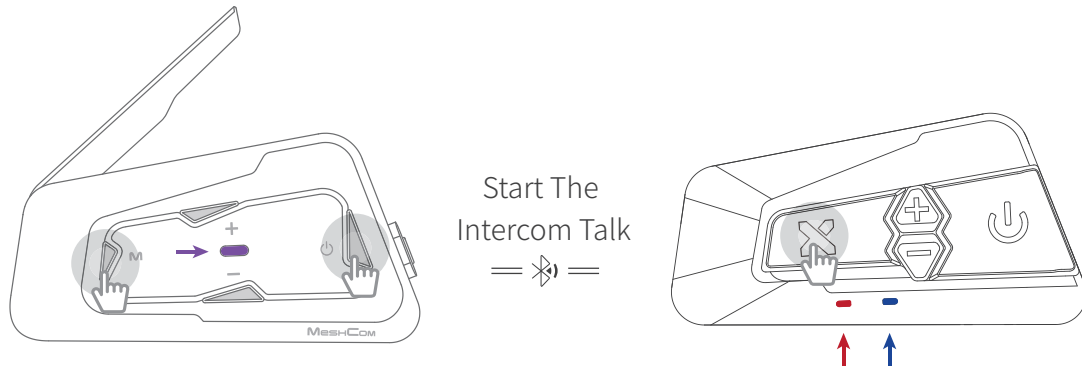

When in intercom mode, the MTX device LED light will blink purple, and the B4FM device will blink red and blue.

Exit The Intercom Talk: In Bluetooth intercom mode, click the power button on either device to end the intercom talk.

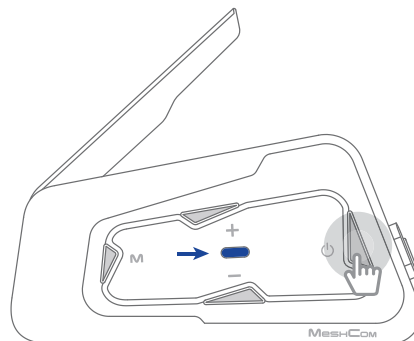

Click power button the led flashes blue

Note: Pair with LEXIN ET COM, please follow the universal pairing instruction below.



To clear existing connections

When in standby mode Long press the up button and down Button for about five seconds, all previous connection will be cleared from the unit.

Note: Double click the power button to exit Bluetooth pairing mode. The device will return to standby mode.

Universal Pairing

Pair With Another Bluetooth Intercom Headset

Step 1: With the unit powered on, press and hold the MTX power button and down button for two seconds. The indicator light flashes blue and red alternately, and the voice prompt will report "pairing. "

Step 2: Follow your other Bluetooth device pairing instructions to enter pairing mode.

Step 3: MTX will automatically search and pair with the other device.

Step 4: After the pairing is completed, the led light blinks blue, and the voice prompt will report "pairing successful. "

Step 5: Click the MTX Up button and down button to start the intercom talk. The led light will flash purple.

Step 6: In the intercom conference, click the MTX Up button and down button to end the intercom talk. The led light will flash blue.

FM Radio

Turn On FM Radio

In standby mode, press and hold the power button and mesh button for two seconds to turn on the radio.

Turn Off FM Radio

When the radio is on, press and hold the power button and mesh button for two seconds to turn off the radio.

FM Radio Station Search

Double click the up/down Button to adjust the radio station.



Maintenance & Certification

Maintenance and Care

NOTE: This equipment has been tested and found to comply with the limits for a Class B digital device, pursuant to part 15 of the FCC Rules. These limits are designed to provide reasonable protection against harmful interference in a residential installation. This equipment generates, uses and can radiate radio frequency energy and, if not installed and used in accordance with the instructions, may cause harmful interference to radio communications. However, there is no guarantee that interference will not occur in a particular installation. If this equipment does cause harmful interference to radio or television reception, which can be determined by turning the equipment off and on, the user is encouraged to try to correct the interference by one or more of the following measures:

- Reorient or relocate the receiving antenna.
- Increase the separation between the equipment and receiver.
- Connect the equipment into an outlet on a circuit different from that to which the receiver is connected.
- Consult the dealer or an experienced radio/TV technician for help.

Changes or modifications not expressly approved by the party responsible for compliance could void the user's authority to operate the equipment.

This device complies with Part 15 of the FCC Rules. Operation is subject to the following two conditions: (1) this device may not cause harmful interference, and (2) this device must accept any interference received, including interference that may cause undesired operation.

This device contains licence-exempt transmitter(s)/receiver(s) that comply with Innovation, Science and Economic Development Canada's licence-exempt RSS(s). Operation is subject to the following two conditions:

- (1) This device may not cause interference.
- (2) This device must accept any interference, including interference that may cause undesired operation of the device.

L'émetteur/récepteur exempt de licence contenu dans le présent appareil est conforme aux CNR d'Innovation, Sciences et Développement économique Canada applicables aux appareils radio exempts de licence. L'exploitation est autorisée aux deux conditions suivantes :

- (1) L'appareil ne doit pas produire de brouillage;
- (2) L'appareil doit accepter tout brouillage radioélectrique subi, même si le brouillage est susceptible d'en compromettre le fonctionnement.

Lexin Electronics Inc.
1(800) 380 - 8248
www.lexin-moto.com

Backed by 2-Year Warranty
For technical support :
tech@lexinmotorcycle.com

   @lexinmoto