

PREPARATION

INSTALLATION METHOD FOR MEDIA BOX

- Image shown may differ from your TV.
- This is a recommended installation type for good wireless connection.

PREPARATION

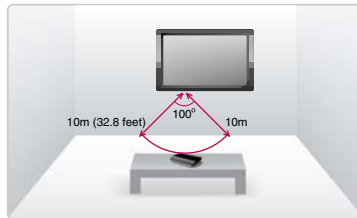
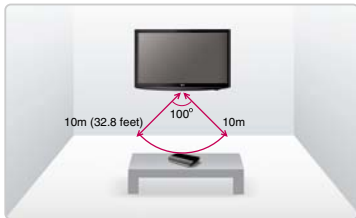

When the Media Box and TV are kept apart and facing each other

Have the RF Receiver/Transmitter of the Media Box and TV face each other. Keep the distance between them to within 32.8 feet (10 m) and maintain the face angle of the TV within 100 degrees.

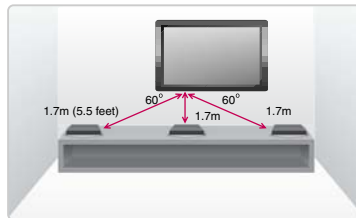
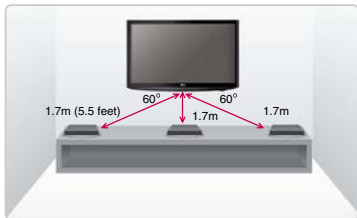

When installing the Media Box and TV on the same wall

Have the Media Box and TV face the front. Keep the distance between them within 5.5 feet (1.7 m) and maintain the face angle of the TV within 60 degrees.

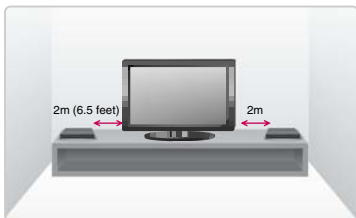
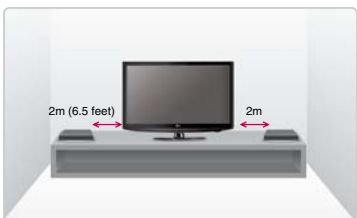

When installing the Media Box and TV side by side

Have the Media Box and TV face the front. Keep the distance between them within 6.5 feet (2 m).

Precaution for installation environment

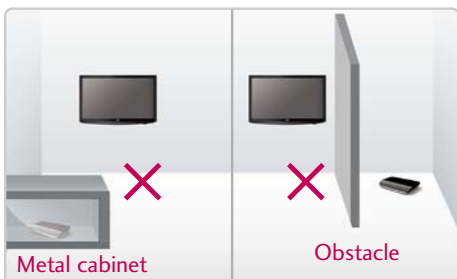

Do not place any obstacle around the RF Receiver/RF Transmitter.

If you install the Media Box inside a metal cabinet, connection may fail.

If there are two wireless TV or Media Boxes within LOS (Line of Sight) 32.8 feet (10 m), they may interfere with each other and wireless connection may fail.

STAND INSTRUCTIONS (For 47/55LH85)

■ Image shown may differ from your TV.

INSTALLATION (For 47LH85)

- 1 Carefully place the TV screen side down on a cushioned surface to protect the screen from damage.

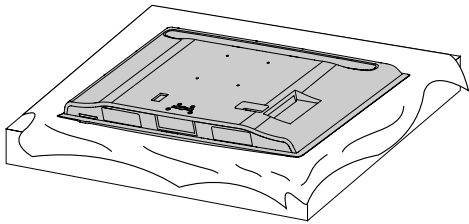

- 2 Assemble the TV as shown.

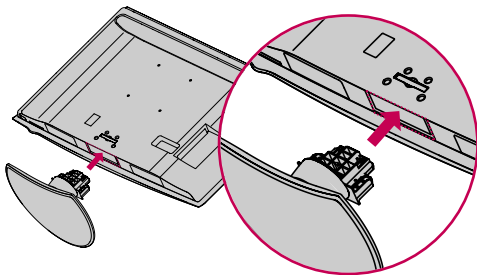

- 3 Fix the 4 screws securely using the holes in the back of the TV.

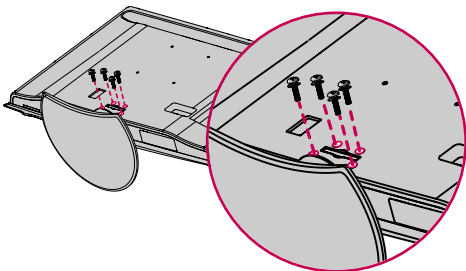

! NOTE

- ▶ When assembling the desk type stand, make sure the screws are fully tightened (If not tightened fully, the TV can tilt forward after the product installation). Do not over tighten.

DETACHMENT

- 1 Carefully place the TV screen side down on a cushioned surface to protect the screen from damage.

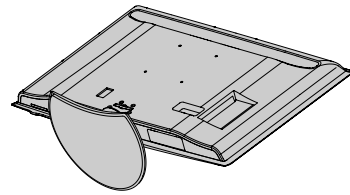

- 2 Remove the screws from the TV.

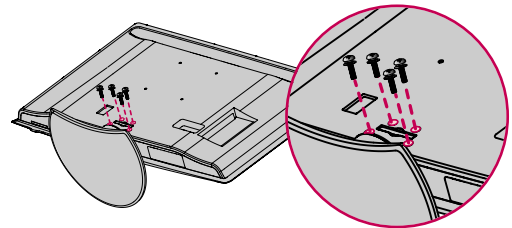

- 3 Detach the stand from TV.

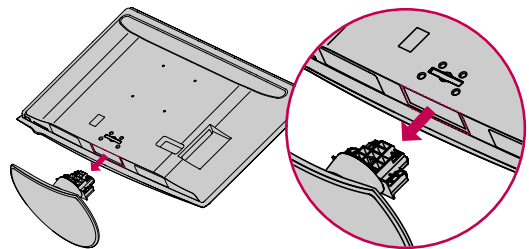

PROTECTION COVER

- 4 After removing the protection paper from the **PROTECTION COVER**, adhere it to the TV as shown.

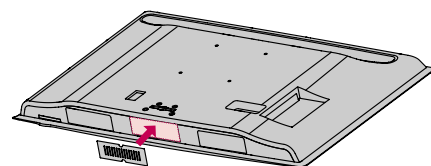

PREPARATION

STAND INSTRUCTIONS (For 55LHX)

PREPARATION

DETACHMENT

- 1 Carefully place the TV screen side down on a cushioned surface to protect the screen from damage.

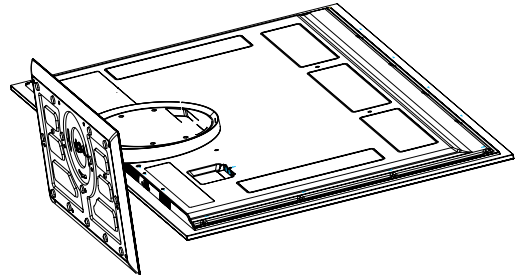

- 2 Remove the screws from the TV.

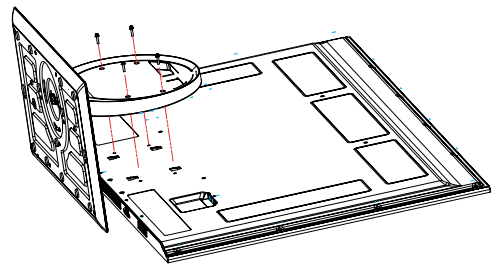

- 3 Detach the stand from TV.

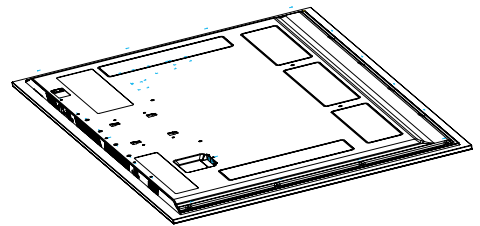

VESA WALL MOUNTING

Install your wall mount on a solid wall perpendicular to the floor. When attaching to other building materials, please contact your nearest installer.

If installed on a ceiling or slanted wall, it may fall and result in severe personal injury.

We recommend that you use an LG brand wall mount when mounting the TV to a wall.

LG recommends that wall mounting be performed by a qualified professional installer.

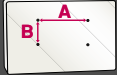
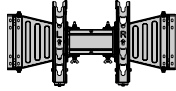
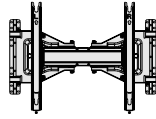
Model	VESA (A * B) 	Standard Screw	Quantity	Wall Mounting Bracket (sold separately)
47LH85	200 * 200	M6	4	 AW-47LG30M
55LH85, 55LHX	400 * 400	M6	4	 AW-55LH40M

! NOTE

- ▶ Screw length needed depends on the wall mount used. For further information, refer to the instructions included with the mount.
- ▶ Standard dimensions for wall mount kits are shown in the table.
- ▶ When purchasing our wall mount kit, a detailed installation manual and all parts necessary for assembly are provided.
- ▶ Do not use screws longer than the standard dimension, as they may cause damage to the inside to the TV.
- ▶ For wall mounts that do not comply with the VESA standard screw specifications, the length of the screws may differ depending on their specifications.
- ▶ Do not use screws that do not comply with the VESA standard screw specifications.
- ▶ Do not use fasten the screws too strongly, this may damage the TV or cause the TV to a fall, leading to personal injury. LG is not liable for these kinds of accidents.
- ▶ LG is not liable for TV damage or personal injury when a non-VESA or non specified wall mount is used or the consumer fails to follow the TV installation instructions.

- ▶ **! CAUTION** ▶ Do not install your wall mount kit while your TV is turned on. It may result in personal injury due to electric shock.

PREPARATION

CABLE MANAGEMENT

■ Image shown may differ from your TV.

For 47/55LH85

- 1 Connect the cables as necessary.
To connect additional equipment, see the **EXTERNAL EQUIPMENT SETUP** section.

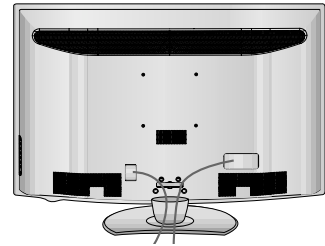

- 2 Open the **CABLE MANAGEMENT CLIP** as shown.

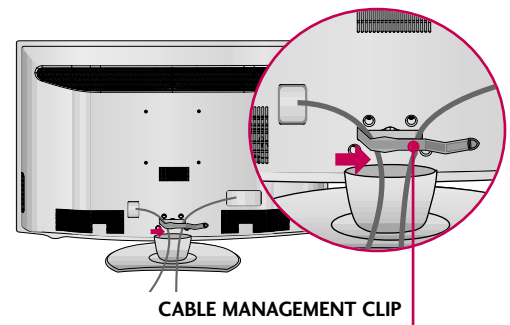

- 3 Put the cables inside the **CABLE MANAGEMENT CLIP** and snap it closed.

