

### **Part 15.21 statement**

" Change or Modifications that are not expressly approved by the manufacturer could void the user's authority to operate the equipment. "

### **Part 15.105 statement**

This equipment has been tested and found to comply with the limits for a class B digital device, pursuant to Part 15 of the FCC Rules.

These limits are designed to provide reasonable protection against harmful interference in a residential installation. This equipment generates uses and can radiate radio frequency energy and, if not installed and used in accordance with the instructions, may cause harmful interference to radio communications. However, there is no guarantee that interference will not occur in a particular installation. If this equipment does cause harmful interference or television reception, which can be determined by turning the equipment off and on, the user is encouraged to try to correct the interference by one or more of the following measures:

- Reorient or relocate the receiving antenna.
- Increase the separation between the equipment and receiver.
- Connect the equipment into an outlet on a circuit different from that to which the receiver is connected.
- Consult the dealer or an experienced radio/TV technician for help.

## **Part 15 Class B Compliance**

This device and its accessories comply with part 15 of FCC rules and ICES-003 Class B digital apparatus requirements for Industry Canada.

Operation is subject to the following two conditions:

- (1) This device & its accessories may not cause harmful interference.
- (2) This device & its accessories must accept any interference received, including interference that may cause undesired operation.

## **Body-worn Operation**

This device has been tested for typical body-worn operations with the distance of 0.79 inches (2.0cm) from the user's body.

To comply with FCC RF exposure requirements, a minimum separation distance of 0.79 inches (2.0cm) must be maintained from the user's body.

Additionally, Belt clips, holsters & other body-worn accessories may not contain metallic components.

# LG-A180a User Guide - English

This guide will help you understand your new mobile phone. It will provide you with useful explanations of features on your phone. Some of the contents in this manual may differ from your phone depending on the software of the phone or your service provider.

## Disposal of your old appliance

- When this crossed-out wheeled bin symbol is attached to a product it means the product is covered by the European Directive 2002/96/EC.
- All electrical and electronic products should be disposed of separately from the municipal waste stream via designated collection facilities appointed by the government or the local authorities.
- The correct disposal of your old appliance will help prevent potential negative consequences for the environment and human health.
- For more detailed information about disposal of your old appliance, please contact your city office, waste disposal service or the shop where you purchased the product.

## Display Information

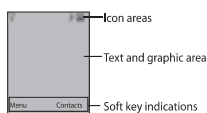

## On-Screen Icons

	Tells you the strength of the network signal.
	Indicates the battery charge level.
	Indicates new text message(s).
	Indicates new voice message(s).
	Indicates the alarm clock is set.
	Indicates your phone uses the silent settings.
	Indicates your phone uses the outdoor settings.
	Indicates your phone uses the headset setting.
	Indicates all calls are diverted to another number.
	Indicates your phone is in flight mode.
	Indicates new schedule(s).

## Making a call from your contacts

- Press (up) to open the address book.
- Using the keypad, enter the first letter of the contact you want to call.
- To scroll through the contacts use up and down navigation keys. And to scroll through their different numbers use left and right navigation keys.
- Press to initiate the call.

## Answering and rejecting a call

When your phone rings, press **Accept** or press to answer the call. While your phone is ringing, select **Silent** to mute the ringing. This is great if you have forgotten to change your profile to **Silent** for a meeting.

Press or **Reject** to reject the incoming call.

**TIP!** You can change the settings on your phone to answer your calls in different ways. Press **Menu**, select **Settings** and choose **Call**. Select **Answer mode** and choose **Flip answer**. Any key or **Send key only**.

- Flip answer** – You can answer a call through the flip on
- Any key** – You can answer a call by pressing any key.

## Menu 1. Messaging

- Templates:** There are pre-defined messages in the list. You can view and edit the template messages or create new messages.
- Settings:** This menu allows you to set features of your network service provider.

### Entering text

You can enter alphanumeric characters using the phone's keypad. For example, storing names in Contacts, writing a message and creating scheduling events in the calendar all require entering text. The following text input methods are available in the phone: T9 predictive mode, ABC manual mode and 123 mode.

**Note:** Some fields may allow only one text input mode (e.g. telephone number in address book fields).

### T9 predictive mode

T9 predictive mode uses a built-in dictionary to recognise words you're writing based on the key sequences you press. Simply press the number key associated with the letter you want to enter, and the dictionary will recognise the word once all the letters are entered.

### ABC manual mode

This mode allows you to enter letters by pressing the key labeled with the required letter once, twice, three or four times until the letter is displayed.

### 123 mode

Type numbers using one keystroke per number. You can also add numbers while remaining in letter modes by pressing and holding the desired key.

- Send key only** – You can answer a call by pressing send key only.

## Changing the call settings

You can set the menu relevant to a call. Press **Menu**, select **Settings** and choose **Call**.

- Call divert** – Select methods of call divert.
- Call waiting** – Select active or cancel call waiting.

## Checking your call history

You can check the record of all, missed, dialled, received calls and call duration. The number and name (if available) are displayed together with the date and time at which the call was made. You can also view the number of times you have called. Press **Menu**, select **Call history**.

## Getting to know your phone

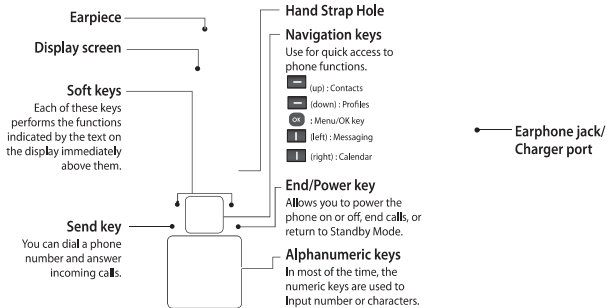

## Menu and Options

Your phone offers a set of functions that allow you to customize it. These functions are arranged in menus and sub-menus, accessed via the left and right soft keys. The label on the bottom of the display screen immediately above the soft keys indicates their current function.

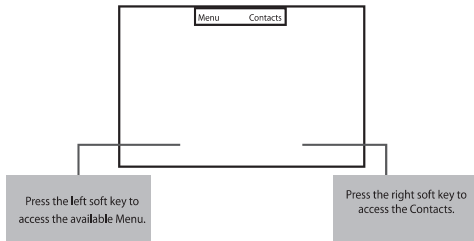

## Menu map

<b>1. Messaging</b> 1.1 New message 1.2 Inbox 1.3 Drafts 1.4 Outbox 1.5 Sent 1.6 Listen voice mail 1.7 Info messages 1.8 Templates 1.9 Settings <b>2. Profiles</b> 2.1 Search 2.2 New contact 2.3 Speed dials 2.4 Copy all 2.5 Delete all 2.6 Memory status 2.7 Information	<b>3. Call history</b> 3.1 All calls 3.2 Missed calls 3.3 Dialed calls 3.4 Received calls 3.5 Call duration <b>4. Games</b> 4.1 Space ball <b>5. FM radio</b> 5.1 General 5.2 Silent 5.3 Vibrate only 5.4 Outdoor 5.5 Flight mode 5.6 Headset <b>7. Tools</b> 7.1 Fake call 7.2 Calculator	7.3 Stopwatch 7.4 Unit converter 7.5 World clock <b>8. Organizer</b> 8.1 Alarm 8.2 Calendar 8.3 Memo <b>9. Settings</b> 9.1 Date & Time 9.2 Language 9.3 Display 9.4 Call 9.5 Security 9.6 Power save 9.7 Network selection 9.8 Reset settings 9.9 Memory status
--	---	--

## Menu 2. Contacts

You can search for a contact in your contacts.

- Press **Contacts** and choose **Search**, select **Contacts** from the **Menu** screen or press (up) from the standby screen.
- Using the keypad enter the first letter of the contact you want to call.
- To scroll through the contacts use up and down navigation key and to scroll through their different numbers use left and right navigation keys.
- New contact:** You can add phonebook entries by using this menu.
  - Speed dial:** Assign contacts to any of keys between 2 and 8.
  - SOS Message:** (Speed dial-> Ok->Key 9) An emergency message can be sent to the predefined number's (3 maximum) by long press of 9 Key. On long press of 9 key, a popup comes, 'Set SOS message?'. Press 'Yes' then type the required message and input 3 numbers for which you want to send the message in emergency mode and press Save/Done.
- Copy all:** You can copy all entries from SIM card memory to Phone memory and also from Phone memory to SIM card memory.
- Delete all:** You can delete all entries from SIM card memory or Phone memory.
- Memory status:** You can check the memory status about your SIM and phone.
- Information**
  - > **Service dial number:** Access the list of service numbers assigned by service provider safely.
  - > **Own number:** You can save and check your own numbers in SIM card.
  - > **Business card:** You can save and check your business card containing information about your name, mobile, home, office and email and send it via message.

## Installing the SIM Card and Charging the Battery

### Installing the SIM Card

When you subscribe to a cellular network, you are provided with a plug-in SIM card loaded with your subscription details, such as your PIN, any optional services available and many others.

**Important!** The plug-in SIM card and its contacts can be easily damaged by scratches or bending, so be careful when handling, inserting or removing the card. Keep all SIM cards out of the reach of small children. Only 2G/2.5G SIM supported

### Illustrations

- Open battery cover
- Remove the battery
- Insert your SIM
- Insert the battery
- Close the battery cover
- Charge your battery

**WARNING:** Do not remove the battery when the phone is switched on, as this may damage the phone.

## Entering Text

You can enter alphanumeric characters by using the phone's keypad. To change modes, press the key.

### T9 Mode

This mode allows you to enter words with only one keystroke per letter. Each key on the keypad has more than one letter. The T9 mode automatically compares your keystrokes with an internal linguistic dictionary to determine the correct word, thus requiring far fewer keystrokes than the traditional ABC mode.

The input method is display at the upper right corner of your phone.

Indicator	Function (English Smart mode)
	T9 Smart abc
	T9 Smart abcd
	T9 Smart ABC
	Numeric

Indicator	Function (English Smart mode)
	Multitap abc
	Multitap abcd
	Multitap ABC

## Turning Your Phone On and Off

You can power on and power off the phone by pressing or holding the power key.

## Making a call

- Key in the number using the keypad.
- Press to initiate the call.
- To end the call, press .

**TIP!** To enter + when making an international call, press and hold 0.

## Quick feature reference

### Menu 1. Messaging

#### Sending a message

- Press **Menu**, select **Messaging** and choose **New message**.
- A new message editor will open. The default setting of the message editor is SMS mode.
- Enter your message using either the T9 predictive mode or ABC manual mode. You can switch text input mode by pressing .
- Press **Options** and choose **Insert** to add a **Symbol**, **Template**, **Contact**, **Business card**.
- Press **Send**.
- Enter the phone number or press **Options** and select **Contacts** or **Recent list** to open your contacts list select the number and press insert then option.
- Press **Send**.
- Inbox:** You will be alerted when you have received a message. And it will be saved here.
- Drafts:** This menu shows the saved message.
- Outbox:** This menu allows you to view the message which is about to be sent or has failed to be sent.
- Sent:** This menu allows you to view the messages which have already been sent, including time and content.
- Listen to voicemail:** This menu provides you with a quick way of accessing your voice mailbox.
- Info message:** Info service messages are text messages delivered by the network to your handset.

### Menu 3. Call history

You can check the record of all, missed, dialled, received calls and call duration. The number and name (if available) are displayed together with the date and time at which the call was made. You can also view the number of times you have called.

- All calls:** Displays all the lists of three types (Received/Dialed/Missed calls) by time.
- Missed calls:** This option lets you view the last 20 unanswered calls.
- Dialed calls:** This option lets you view the last 20 outgoing calls (called or attempted).
- Received calls:** This option lets you view the last 20 incoming calls.
- Call duration:** Allows you to view the duration of your incoming and outgoing calls.

### Menu 4. Game

Your LG-A180 comes with preloaded games to keep you amused when you have time to spare. Press **Menu** and select **Games**.

### Menu 5. FM radio





Attach the headset into earphone jack / charger port and press 'OK' to enter radio.

### Menu 6. Profiles

You change your profile, then choose from General, Silent, Vibrate only, Outdoor, Flight mode and Headset.

- General:** After setting up this profile, the indicator will be displayed on the standby screen.

## Menu 6. Profiles

- **Silent:** Ring tone and vibrator is set to be off. After setting up this profile, the indicator  will be displayed on the standby screen.
- **Vibrate only:** Ring tone is set to be off and vibrator is only set to be on. After setting up this profile, the indicator  will be displayed on the standby screen.
- **Outdoor:** This is the default profile. Ring tone and key tone volume is set to maximum. After setting up this profile, the indicator  will be displayed on the standby screen.
- **Flight Mode:** Use this function to switch the flight mode On or Off. You will not be able to make calls and send messages when Flight mode is switched On.
- **Headset:** When the headset is connected to the phone, the indicator  will be displayed on the standby screen. You can personalise call alert type, ring tones, ring volume, message alert type, message tones, message volume, keypad tones, keypad volume, flip tones, effect sound volume and power on/off volume.

## Menu 7. Tools

- **Fake call:** You can set a fake incoming call which will come after specific time with name and number you set. To set fake call, Goto Fake call in settings. Set fake call to ON. Select the time from the options when the set Fake call should Invoke. Give the Name and Number from whom the Fake call should come and finally Press save to save the settings. Now to invoke the fake call press:  from idle screen.
- **Calculator:** This contains the standard functions such as Addition, Subtraction, Multiplication and Division.
- **Stopwatch:** This option allows you to use the function of a stopwatch.

## Menu 7. Tools

- **Unit converter:** This converts any measurement into a unit you want.
- **World clock:** Allows you to determine the current time in another time zone or country.

## Menu 8. Organiser

- **Alarm:** You can set up to 3 alarm clocks to go off at a specified time.
- **Calendar:** When you enter this menu, a calendar appears. A square cursor is located on the current date. You can move the cursor to another date using the navigation keys.
- **Memo:** You can register your own memos here.

## Settings Menu 9

- **Date & Time:** You can set functions relating to the date and time.
- **Languages:** You can change the language for the display texts in your phone. This change will also affect the Language Input mode.
- **Display:** You can adjust settings for the phone display.
  - > LED Lighting - When you select LED Lighting On, LED display on the front cover works.
    - Power on/off, Folder open/close, Incoming SMS: Flash 1 cycle.
    - Incoming call: Keep flashing until ring tone ends.
    - Alarm: Keep flashing until you turn it off or the end of alarm duration.
    - Battery charging: Keep the light on. When the battery is full, LED turns off.

## Settings Menu 9

- **Call:** You can set the menu relevant to a call.
- **Security:** This menu allows you to set the phone safely.
  - > **Pin code request** - Choose a PIN code to be requested when you turn your phone on.
  - > **Phone lock** - Choose a security code to lock your phone, When power on, When SIM changed or Immediately.
  - > **Call barring** - Choose a barring password for all outgoing calls, outgoing international, outgoing international when roaming, all incoming calls, or incoming when roaming.
  - > **Fixed dial number** - Choose a PIN2 code to enable fixed dial number lets you restrict calls to only those in contacts.
  - > **Anti-theft mobile tracker** - When the handset is stolen, handset sends the SMS to the numbers configured by real owner. User has to configure the ATMT settings with name, primary phone number, secondary number. User has to Set ATMT ON to activate the ATMT feature. Default ATMT code is "0000". ATMT SMS will contain information about the stolen phone IMEI, current location & number of the person who is using that handset.
  - > **Change codes** - Changing your security code or PIN1 code or PIN2 code, ATMT code, enter the old code followed by the new code.
- **Power save:** If you set Always on, you can save the battery power when you don't use the phone. Choose to switch the power save settings: Always on, Night only or Off.
- **Network selection:** You can select a network that will be registered either automatically or manually.
- **Reset settings:** Use Reset to reset all the settings to their factory definitions. You need the security code to activate this function. The default number is "0000".
- **Memory status:** You can check free space and memory usage of each repository.